



HEARTLAND®

SUNDANCE  
ULTRA LITE

2022 Sundance East • 2022 Sundance West



LIGHTWEIGHT  
TRAVEL TRAILERS



**SUNDANCE**  
ULTRA LITE EAST COAST

 BROUGHT TO YOU BY  
**HEARTLAND**



## TOP 5

# EXTERIOR FEATURES

- 1| Azdel Laminated Sidewalls are half the weight of wood yet more durable and easy on the environment. Weather and temperature resistant. Azdel acts as a sound barrier while providing good insulation value.
- 2| Colossal Storage - Exterior pass-thru storage compartment with motion LED lighting provides you ample space to take everything you need.
- 3| Griddle in all outside kitchens with upgraded metal countertops. More versatile than a two-burner stove.
- 4| Automotive painted and stylish front cap.
- 5| Tire pressure monitoring prep allowing for simple customer upgrades.

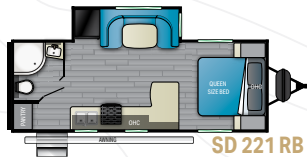

SD 221 RB

LENGTH: 25'10" | HEIGHT: 10'11" | HITCH: 430 lbs.  
 DRY: 4,725 lbs. | GVWR: 7,430 lbs | SLEEP CAPACITY: 3-4

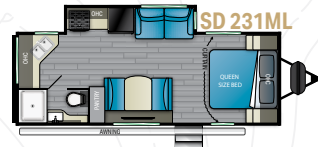

SD 231 ML

LENGTH: 26'11" | HEIGHT: 10'11" | HITCH: 532 lbs.  
 DRY: 5,090 lbs. | GVWR: 7,532 lbs. | SLEEP CAPACITY: 5-6



SD 255 BH

LENGTH: 29' 9" | HEIGHT: 11'2" | HITCH: 846 lbs.  
 DRY: 5,922 lbs. | GVWR: 7,846 lbs. | SLEEP CAPACITY: 7-8

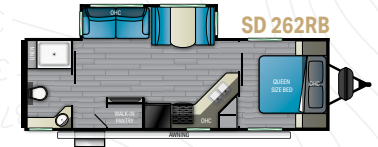

SD 262 RB

LENGTH: 30'10" | HEIGHT: 10'11" | HITCH: 780 lbs.  
 DRY: 5,920 lbs. | GVWR: 7,780 lbs. | SLEEP CAPACITY: TBD

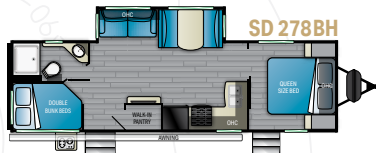

SD 278 BH

LENGTH: 32'10" | HEIGHT: 11'2" | HITCH: 660 lbs.  
 DRY: 6,565 lbs. | GVWR: 9,460 lbs. | SLEEP CAPACITY: 9+

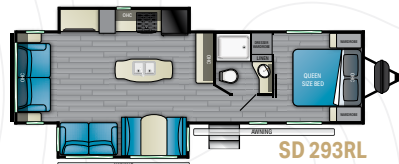

SD 293 RL

LENGTH: 34'2" | HEIGHT: 11'2" | HITCH: 954 lbs.  
 DRY: 7,069 lbs. | GVWR: 9,754 lbs. | SLEEP CAPACITY: 7-8

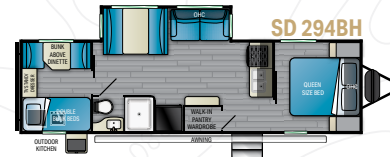

SD 294 BH

LENGTH: 33'6" | HEIGHT: 11'2" | HITCH: 860 lbs.  
 DRY: 6,460 lbs. | GVWR: 9,660 lbs. | SLEEP CAPACITY: 9+

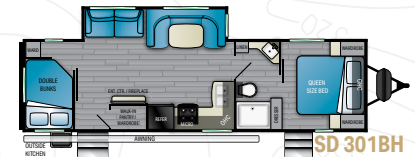

SD 301 BH

LENGTH: 33'11" | HEIGHT: 11'2" | HITCH: TBD.  
 DRY: TBD | GVWR: TBD | SLEEP CAPACITY: 7-8

## TOP 5 INTERIOR FEATURES

- 1 Privacy roller shades on all windows with a clean design.
- 2 6'9" tall vaulted ceilings allowing for the feeling of more space.
- 3 Dream Dinette and fireplace (most floor plans) providing you all the comforts of your home.
- 4 Woven flooring in all slide outs making it family and dog friendly.
- 5 12V refrigerator perfect for holding everything you need for the family barbecue.

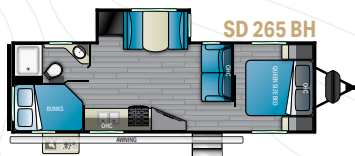

**LENGTH: 30'11" | HEIGHT: 10'11" | HITCH: 748 lbs.**  
**DRY: 5,638 lbs. | GVWR: 7,748 lbs. | SLEEP CAPACITY: TBD**

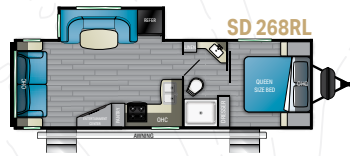

**LENGTH: 30'11" | HEIGHT: 10'11" | HITCH: 800 lbs.**  
**DRY: 5,800 lbs. | GVWR: 7,800 lbs. | SLEEP CAPACITY: 5-6**

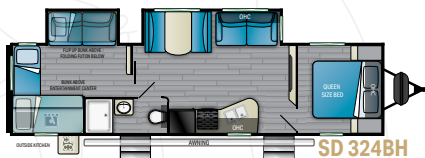

**LENGTH: 36'6" | HEIGHT: 11'2" | HITCH: 1,036 lbs.**  
**DRY: 7,312 lbs. | GVWR: 9,836 lbs. | SLEEP CAPACITY: 9+**





## SUNDANCE ULTRLITE EXTERIOR PACKAGE:

- Radial Tires on Aluminum Rims
- LED Lit Pass-Thru Storage
- Radial Spare Tire and Carrier
- Entry Assist Handle
- 13.5 K BTU Ducted A/C
- Alpha Super Flex TPO Walkable Roof
- Electric Awning
- EZ Lube Axles
- LED Awning Light
- Painted Front Cap
- 6 Gallon DSI Gas / Electric Water Heater
- Detachable Power Cord
- Fiberglass Exterior
- Outside Spray-Port with Hose & Sprayer
- Triple Aluminum Entry Steps
- TV Antenna and Cable Hookup
- 30" Wide Primary Entry Door
- Solar Prep
- Upgraded Graphics Package
- Backup Camera Prep
- Black Tank Flush System
- Smart Key System
- Tinted Safety Glass Windows

## HEATING AND COOLING UPGRADES:

- 15,000 A/C BTU IPO 13,500 A/C
- 50 AMP SVC (262RB and larger)
- 2nd 13.5 BTU A/C (Requires 50 AMP)

## SUNDANCE CAMPING IN COMFORT PACKAGE:

- Heated and Enclosed Underbelly
- 3 Burner Furrrion High Output Range
- 2" Duct from Furnace into Underbelly
- Microwave Oven
- High Output Furnace with Ducting
- Heavy Duty Flooring
- Vaulted Interior Ceiling
- R2X Stain Resistance Treated Carpet
- LED Ceiling Lights
- Radius Shower Enclosure in Tub Curtain
- Solid Hardwood Framed Cabinet Doors
- Skylight Over Shower or Tub
- Designer Valances with Fabric Night Shades
- CD, DVD, AM, FM Stereo with Bluetooth
- Secure Entry Step
- Residential Style Furniture
- Upgraded Mattress with Comforter
- Tri-Fold Sofa
- Teddy Bear Bunk Mats
- Full Extension Drawer Glides

## EXTERIOR OPTIONS:

- Power Tongue Jack
- 2nd Awning forced on 293RL Only

## INTERIOR OPTIONS:

- 32" LED TV (189 Only)
- 40" LED TV (N/A 189)
- CU FT Gas / Electric Refrigerator

## SPECIAL FEATURES



Undermount Sink



Luxury Fireplace

## INTERIOR FABRIC DECOR OPTIONS

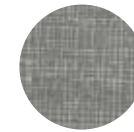

Urban Loft

## VISIT US ONLINE



For more information and to take a virtual walk-through, visit [www.heartlandrvs.com](http://www.heartlandrvs.com)

Your authorized Heartland dealer:

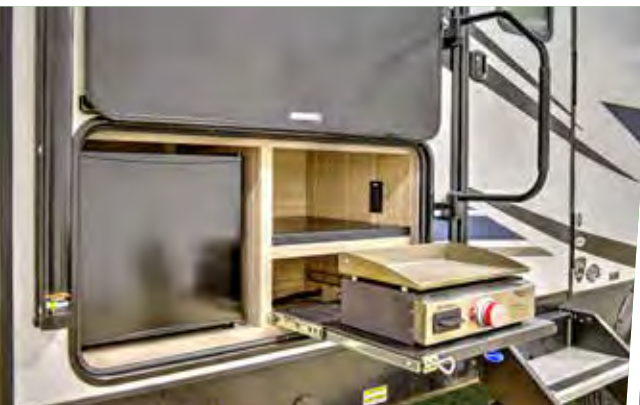

LIGHTWEIGHT  
TRAVEL TRAILERS



\*Please note the West Coast front cap is slightly different than pictured above.

**SUNDANCE**  
ULTRA LITE WEST COAST

BROUGHT TO YOU BY  
**HEARTLAND**



## TOP 5

# EXTERIOR FEATURES

- 1| Azdel Laminated Sidewalls are half the weight of wood yet more durable and easy on the environment. Weather and temperature resistant. Azdel acts as a sound barrier while providing good insulation value.
- 2| Colossal Storage - Exterior pass-thru storage compartment with motion LED lighting provides you ample space to take everything you need.
- 3| Griddle in all outside kitchens with upgraded metal countertops. More versatile than a two-burner stove.
- 4| Automotive painted and stylish front cap.
- 5| Tire pressure monitoring prep allowing for simple customer upgrades.

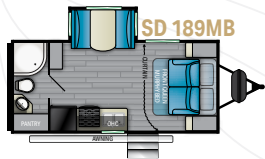

**LENGTH:** 22'0" | **HEIGHT:** 10'11" | **HITCH:** 560 lbs.  
**DRY:** 4,394 lbs. | **GVWR:** 6,160 lbs. | **SLEEP CAPACITY:** 3-4

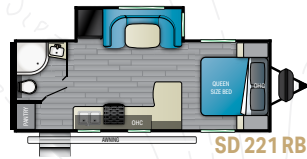

**LENGTH:** 25'10" | **HEIGHT:** 10'11" | **HITCH:** 430 lbs.  
**DRY:** 4,725 lbs. | **GVWR:** 7,430 lbs. | **SLEEP CAPACITY:** 3-4

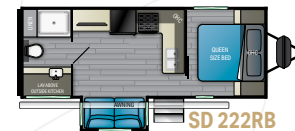

**LENGTH:** 25'11" | **HEIGHT:** 10'11" | **HITCH:** TBD  
**DRY:** TBD | **GVWR:** TBD | **SLEEP CAPACITY:** 3-4

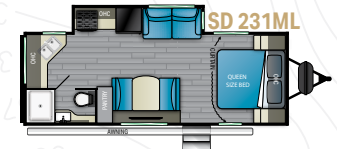

**LENGTH:** 26'11" | **HEIGHT:** 10'11" | **HITCH:** 532 lbs.  
**DRY:** 5,090 lbs. | **GVWR:** 7,532 lbs. | **SLEEP CAPACITY:** 5-6

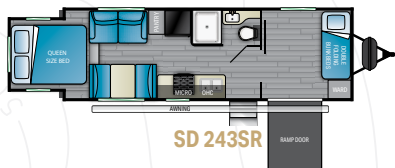

**LENGTH:** TBD | **HEIGHT:** TBD | **HITCH:** TBD  
**DRY:** TBD. | **GVWR:** TBD | **SLEEP CAPACITY:** TBD

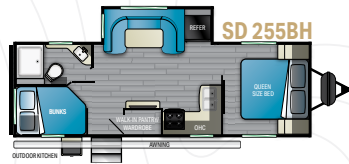

**LENGTH:** 29' 9" | **HEIGHT:** 11'2" | **HITCH:** 846 lbs.  
**DRY:** 5,922 lbs. | **GVWR:** 7,846 lbs. | **SLEEP CAPACITY:** 7-8

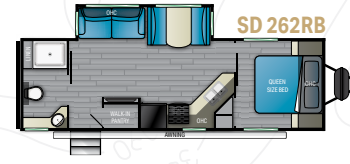

**LENGTH:** 30'10" | **HEIGHT:** 10'11" | **HITCH:** 780 lbs.  
**DRY:** 5,920 lbs. | **GVWR:** 7,780 lbs. | **SLEEP CAPACITY:** TBD

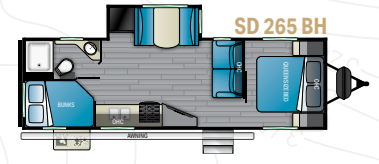

**LENGTH:** 30'11" | **HEIGHT:** 10'11" | **HITCH:** 748 lbs.  
**DRY:** 5,638 lbs. | **GVWR:** 7,748 lbs. | **SLEEP CAPACITY:** TBD

## TOP 5 INTERIOR FEATURES

- 1 Privacy roller shades on all windows with a clean design.
- 2 6'9" tall vaulted ceilings allowing for the feeling of more space.
- 3 Dream Dinette and fireplace (most floor plans) providing you all the comforts of your home.
- 4 Woven flooring in all slide outs making it family and dog friendly.
- 5 12V refrigerator perfect for holding everything you need for the family barbecue.

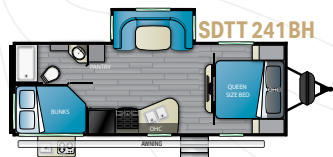

**LENGTH:** 27'7" | **HEIGHT:** 10'11" | **HITCH:** 560 lbs.  
**DRY:** 5,265 lbs. | **GVWR:** 7,560 lbs. | **SLEEP CAPACITY:** 7-8

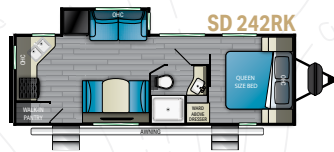

**LENGTH:** 28'11" | **HEIGHT:** 10'11" | **HITCH:** 494 lbs.  
**DRY:** 5,638 lbs. | **GVWR:** 7,494 lbs. | **SLEEP CAPACITY:** 5-6

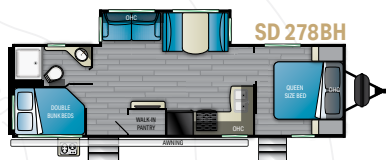

**LENGTH:** 32'10" | **HEIGHT:** 11'2" | **HITCH:** 660 lbs.  
**DRY:** 6,565 lbs. | **GVWR:** 9,460 lbs. | **SLEEP CAPACITY:** 9+

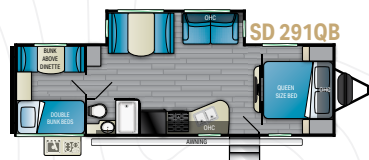

**LENGTH:** 31'11" | **HEIGHT:** 10'11" | **HITCH:** 710 lbs.  
**DRY:** 5,930 lbs. | **GVWR:** 7,710 lbs. | **SLEEP CAPACITY:** 9+





## SUNDANCE ULTRLITE EXTERIOR PACKAGE:

- Radial Tires on Aluminum Rims
- LED Lit Pass-Thru Storage
- Radial Spare Tire and Carrier
- Entry Assist Handle
- 13.5 K BTU Ducted A/C
- Alpha Super Flex TPO Walkable Roof
- Electric Awning
- EZ Lube Axles
- LED Awning Light
- Painted Front Cap
- 6 Gallon DSI Gas / Electric Water Heater
- Detachable Power Cord
- Fiberglass Exterior
- Outside Spray-Port with Hose & Sprayer
- Triple Aluminum Entry Steps
- TV Antenna and Cable Hookup
- 30" Wide Primary Entry Door
- Solar Prep
- Upgraded Graphics Package
- Backup Camera Prep
- Black Tank Flush System
- Smart Key System
- Tinted Safety Glass Windows

## HEATING AND COOLING UPGRADES:

- 15,000 A/C BTU IPO 13,500 A/C
- 50 AMP SVC (262RB and larger)
- 2nd 13.5 BTU A/C (Requires 50 AMP)

## SUNDANCE CAMPING IN COMFORT PACKAGE:

- Heated and Enclosed Underbelly
- 3 Burner Furrrion High Output Range
- 2" Duct from Furnace into Underbelly
- Microwave Oven
- High Output Furnace with Ducting
- Heavy Duty Flooring
- Vaulted Interior Ceiling
- R2X Stain Resistance Treated Carpet
- LED Ceiling Lights
- Radius Shower Enclosure in Tub Curtain
- Solid Hardwood Framed Cabinet Doors
- Skylight Over Shower or Tub
- Designer Valances with Fabric Night Shades
- CD, DVD, AM, FM Stereo with Bluetooth
- Secure Entry Step
- Residential Style Furniture
- Upgraded Mattress with Comforter
- Tri-Fold Sofa
- Teddy Bear Bunk Mats
- Full Extension Drawer Glides

## EXTERIOR OPTIONS:

- Power Tongue Jack
- 2nd Awning forced on 293RL Only

## INTERIOR OPTIONS:

- 32" LED TV (189 Only)
- 40" LED TV (N/A 189)
- 8 CU FT Gas / Electric Refrigerator

## SPECIAL FEATURES



Undermount Sink



Luxury Fireplace

## INTERIOR FABRIC DECOR OPTIONS

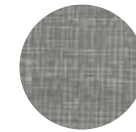

Urban Loft

## VISIT US ONLINE



For more information and to take a virtual walk-through, visit [www.heartlandrvs.com](http://www.heartlandrvs.com)

Your authorized Heartland dealer:

