

**DYNAMAX** 

A DIVISION OF FOREST RIVER

DIFFERENT BY DESIGN

2022



*europa*



## STANDARD FEATURES &

### CHASSIS

- Freightliner® M2 106B Chassis (33,000-lbs. GVWR / 46,000-lbs. GCWR)
- Cummins® B 6.7 Turbo Diesel Engine (360hp / 800 lb.-ft. of Torque)
- Allison® 3200 TRV Six-Speed Automatic Transmission
- 100-Gallon Fuel Capacity (Twin 50-Gallon Aluminum Fuel Tanks)
- 6-Gallon Diesel Exhaust Fluid Tank
- Trailer Hitch (12,000 Tow lbs. / 1,200 Tongue lbs.) with 7-Way Round Tow Connection
- Weigh Safe® Trailer Hitch Receiver
- Brake Controller
- Cummins® VG Exhaust Brake System with Dash Switch
- Airliner® 21,000-lb. Rear Suspension
- Manual Air Suspension Dump Valve Switch on Dash
- 160-Amp Alternator
- Quick Disconnect Fitting with Tire Inflation Kit
- Air Brakes with 4-Wheel ABS
- SACHS® Front Shock Absorbers
- Equiflo™ Inboard Fuel System (Dual Supply – Dual Return)
- Fuel Filter / Water Separator with Primer Pump
- Engine Block Heater
- Steel-Reinforced, Aluminum Cab
- Chrome Grille and Air Intake Grille
- Front and Rear Tires: Michelin® XZE2 275 / 80R22.5 (14 Ply Radials)
- Alcoa® Aluminum Wheels (22.5" x 8.25")
- Valve Extensions
- 5.56 Rear Axle Ratio
- Daytime Running Lights
- LED Headlights
- Tinted Door Glass and Operating Wing Windows
- Chassis Battery Shut Off Switch in Cab
- Leatherette Driver and Passenger Air Ride Seats with Swivel Bases
- Quad-View Camera System (Right Side, Left Side, Hitch, and Rear Horizon Views)
- Kenwood® 7" Touch Screen Dash Infotainment System with AM/FM, Bluetooth®, Sirius / XM® (tuner and antenna), and Apple® CarPlay™ / Android® Auto™ Functionality, and Garmin® RV Navigation
- Air Horn



Europa's clean, contemporary styling features modern Graymist cabinetry with Dusk décor and is equipped with all the comforts of home, including a standard 16 cu. ft. residential refrigerator, a solid surface kitchen countertop, an eye-catching trifold sleeper sofa and a roomy dream dinette.

### OPTIONS

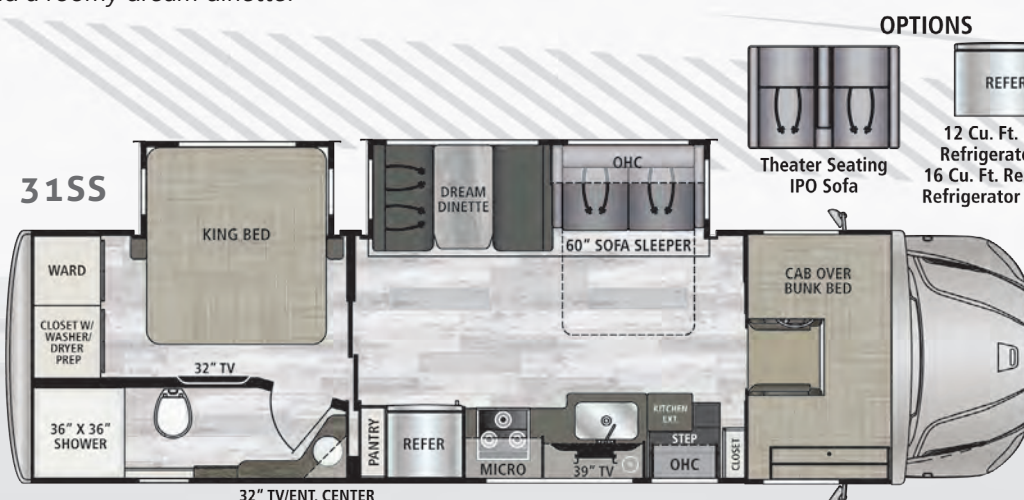

Dimensions	31SS
GVWR	33,000 lbs.
GCWR	46,000 lbs.
GAWR - Front	12,000 lbs.
GAWR - Rear	21,000 lbs.
UVW*	20,281 lbs.
Overall Length	33' 5"
Exterior Width	101"
Wheelbase	245"
Overall Exterior Height (w/15,000 BTU Roof A/C)	12' 9"
Interior Height	84"
Fuel Capacity	100 Gal.
Water Capacities (Gal.) Fresh/Gray/Black	95/52/52
LPG Capacity (WC)	20.3 Gal./ 86 lb.
Awning Length	16'



## OPTIONS

Dynamax often makes running changes, (changes made outside of model year timing) to improve the reliability, performance or capacity. Please refer to [www.dynamaxcorp.com](http://www.dynamaxcorp.com) for the most current specifications.

- 12V Accessory Ports
- One Valve Parking Brake System with Warning Indicator
- Engine After-Treatment Device, Automatic Over-the-Road Regeneration, and Dash-Mounted Regeneration Switch
- Momentary Battery Booster Switch for Connecting Chassis and House Batteries
- Marker Lights with Separate Interrupter Switch
- Low Air Pressure Light and Buzzer
- Cruise Control
- Adjustable Steering Column
- Hydrographic Woodgrain Cab Accents
- 18" Leather-Wrapped Steering Wheel
- Power and Heated Exterior Mirrors
- Power Windows and Locks
- 3-Point Seat Belts
- Dual Reading Lights
- Two (2) Cup Holders in Dash

### CONSTRUCTION

- 2" Aluminum-Framed, Laminated Sidewalls with Dow® Block Foam Insulation
- Gel-Coat Fiberglass Walls with Azdel® Backing
- Aluminum-Framed Floor
- Aluminum-Framed Roof Trusses
- Crowned, One-Piece Fiberglass Roof
- Foil-Lined Ductwork Throughout
- Fiberglass Front Cap, Rear Cap, and Front Wing Panels
- Automatic, 4-Point Hydraulic Leveling Jacks
- Dual-Pane, Dark-Tinted, Frameless Windows
- Seamless Rotocast Storage Compartments with LED Lighting
- Side-Hinged, Locking Aluminum Exterior Storage Doors with Paddle Latches

### EXTERIOR

- Custom Full Body Paint Package
- Premium Cut and Buffed Paint Finish
- Front-End Diamond Shield® Paint Protection
- Dual-Pitch, Armless Patio Awning with LED Lighting and Motion-Activated Retraction
- Aluminum-Wrapped Slideout Toppers
- LED Patio Light
- Power Entry Steps
- Entry Door with Rotary Latch, Dark-Tinted, Frameless Window, and Integrated Shade
- Keyless Entry Touch Pad at Entry Door
- Lighted Acrylic Entry Grab Handle

- Exterior Wall-Mounted Entertainment Center with 32" LED Smart TV and Sound Bar
- Front and Rear LED Clearance and Marker Lighting
- Rear Docking Lights
- Black Steel Cab Step Treads
- Rear "DYNAMAX" Rock Guard

### INTERIOR

- Front Cab-Over Bunk Area with Mattress (50" x 79") and Privacy Curtain
- Premium Vinyl Flooring Throughout
- Entry with Non-Skid Rubber Steps and Risers
- LED Recessed Ceiling Lights
- Booth Dinette
- Coordinating Window Treatments
- Day/Night Roller Shades
- Hardwood Shaker-Style Cabinetry
- Full Extension, Soft-Closing Drawer Guides (where applicable)
- Hidden Hinges
- 39" LED Smart TV (Living Area)
- Sound Bar
- Thermal, Reflective Front Privacy Shades
- USB Charging Ports

### KITCHEN

- 16 cu. ft. Residential Refrigerator with Ice Maker (Double-Door)
- Sealed Gas Range with Glass Cover
- Convection Microwave Oven
- Solid Surface Countertops with LED Edge Lighting and Backsplash
- Stainless Steel Sink with Solid Surface Covers
- Residential Black Spring Gooseneck Faucet
- Pantry
- Under-Cabinet Lighting
- MaxxAir® Power Vent with Built-In Rain Cover

### BEDROOM

- King Bed with Gel-Infused Memory Foam Mattress (70" x 75")
- Designer Bedding Package
- 32" LED Smart TV
- Cedar-Lined Wardrobe
- LED Reading Lights
- USB Charging Ports

### BATHROOM

- Acrylic Shower Surround
- Shower Skylight
- Glass Shower Door

- Oxygenics Body Spa® RV Shower Head
- Top-Mount Sink with Residential Faucet
- Porcelain Foot-Flush Toilet
- MaxxAir® Power Vent with Built-In Rain Cover

### UTILITIES

- Single 12V 8D AGM Deep-Cycle, Maintenance-Free Battery
  - Multiplex Wiring with Touch Screen Command Center, Switch Panels, and Bluetooth® Smart Phone App Control
  - Battery Disconnect
  - Solar Panels - Two 100 Watt with 30 Amp Controller
  - 50-Amp Service with Power Cord Reel
  - 3,000W Hybrid Pure Sine Wave Inverter / Charger (3,500 Peak Watts)
  - 8kW Onan® Diesel Generator with Auto Transfer Switch (Mounted on Isolator Pads)
  - Automatic Generator Start
  - Dual Ducted, Low-Profile 15,000-BTU Air Conditioners with Heat Pump
  - 40,000-BTU LP Furnace with Electronic Ignition
  - Combo Washer / Dryer Prep
  - On-Demand Water Heater (LP)
  - 20.3-Gallon LP Tank (WC)
  - LP Quick Connect
  - Water Filtration System
  - Exterior Shower in Service Bay
  - Exterior GFCI Receptacle
  - Winegard® AIR 360+™ Dome Antenna (WiFi Extender, 4G LTE, Omnidirectional VHF/UHF OTA, FM, SIM Card Port)
  - 4X4 HDMI Matrix
  - Cable TV/Satellite Hookup in Service Bay
  - Thetford Sanicon Turbo Macerator System
  - Black Tank Flush
  - Furnace-Heated Utility Compartment
  - Enclosed and Furnace-Heated Holding Tanks
  - Upgraded 12V On-Demand Water Pump (4 gallons per minute)
  - Carbon-Monoxide, LP, and Smoke Detectors
  - Fire Extinguisher
  - Winegard® In-Motion T4 Satellite (Dish® SD-HD, DirecTV® SD, BellTV® SD-HD)
- ### OPTIONS
- 12 cu. ft. 2-Way Refrigerator in place of Standard Refrigerator and Side Pantry
  - Dual, Power Reclining Theater Seats in Place of Sofa
  - Tire Pressure Monitoring System

## FULL BODY PAINT PACKAGES

With Front-End Diamond Shield Paint Protection



Admiral Blue



Khaki



Merlot



Quicksilver



Stone Ridge

# europa

## KEY FEATURES

- Freightliner® M2-106B Chassis (33,000 lbs. GVWR / 46,000 lbs. GCWR) with Cummins B 6.7L Turbo Diesel Engine (360hp/800 ft.-lbs. of Torque)
- Allison® 3200 TRV Six-Speed Automatic Transmission
- 12,000 lb. Trailer Hitch and Brake Controller
- Leatherette Driver and Passenger Air Ride Seats with Swivel Bases
- Short Floor Plan (31SS: 33'5") – for enhanced cargo carrying capacity and maneuverability
- Cab-Over Bed (Extended Front Cap) Standard
- Multiplex Wiring with Touch Screen Command Center, Switch Panels, and Bluetooth® Smart Phone App Control
- Single 12V 8D AGM Deep-Cycle, Maintenance-Free House Battery + Two 100W Solar Panels with 30 Amp Controller
- 3,000W Hybrid Pure Sine Wave Inverter / Charger (3,500 Peak Watts)
- On-Demand Water Heater (LP)
- Washer / Dryer Combo Prep

## DÉCOR

### DUSK

Valance with Accent

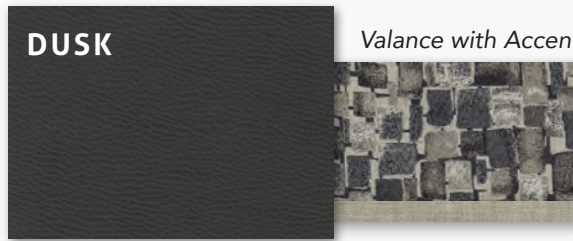

Main

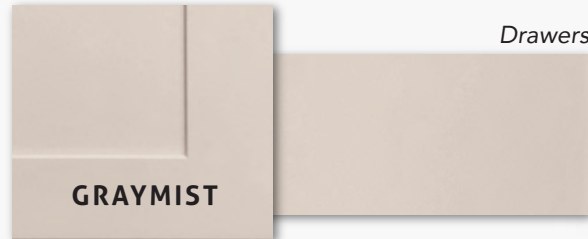

Drawers

GRAYMIST

Countertop



Flooring



**DYNAMAX**  
A DIVISION OF FOREST RIVER

DIFFERENT BY DESIGN

2745 Northland Dr. ■ Elkhart IN 46514  
888-295-7859 ■ [www.dynamaxcorp.com](http://www.dynamaxcorp.com)

Your Authorized Europa Dealer

**GVWR (Gross Vehicle Weight Rating)** - is the maximum permissible weight of the unit when fully loaded. It includes all weights, inclusive of all fluids, occupants, cargo, optional equipment and accessories. For safety and product performance do NOT exceed the GVWR.  
**GCWR (Gross Combined Weight Rating)** - is the maximum permissible loaded weight of your motor home and any towed trailer or towed vehicle. Actual GCWR of this vehicle may be limited by the sum of the GVWR and the installed hitch receiver maximum capacity rating; see hitch rating label for detail.

**GAWR (Gross Axle Weight Rating)** - is the maximum permissible weight, including cargo, fluids, optional equipment and accessories that can be safely supported by each axle.

**UVW (Unloaded Vehicle Weight)** - is the typical weight of the unit as manufactured at the factory. It includes all weight at the unit's axle(s), including full fuel, all fluids and LP Gas. The UVW does not include cargo, fresh potable water, additional optional equipment or dealer installed accessories.

\*Estimated Average based on standard build optional equipment.

**CCC (Cargo Carrying Capacity)** - is the amount of weight available for fresh potable water, cargo, passengers, additional optional equipment and accessories. CCC is equal to GVWR minus UVW. Available CCC should accommodate fresh potable water (8.3 lbs per gallon). Before filling the fresh water tank, empty the black and gray tanks to provide for more cargo capacity.

\*\*Estimated average based on standard build optional equipment.

Each Forest River RV is weighed at the manufacturing facility prior to shipping. A label identifying the unloaded vehicle weight of the actual unit and the cargo carrying capacity is applied to every Forest River RV prior to leaving our facilities.

The load capacity of your unit is designated by weight, not by volume, so you cannot necessarily use all available space when loading your unit. Actual towing capacity is dependent upon your particular loading and towing circumstances, which includes the GVWR, GAWR and GCWR as well as adequate trailer brakes. Please refer to the Operator's Manual of your vehicle for further towing information.

All information contained in this brochure is believed to be accurate at the time of publication. However, during the model year, it may be necessary to make revisions and Forest River, Inc., reserves the right to make all such changes without notice, including prices, colors, materials, equipment and specifications as well as the addition of new models and the discontinuance of models shown in this brochure. Therefore, please consult with your Forest River dealer and confirm the existence of any materials, design or specifications that are material to your purchase decision. ©2021 Dynamax, a Division of Forest River, Inc., a Berkshire Hathaway company. All Rights Reserved. 10/21



## PRE-DELIVERY INSPECTION FACILITY

20,000 square feet of quality assurance. The bare essentials for a premium product. This state-of-the-art facility gives immediate daily feedback to production for quality assurance in every unit built.



### 24/7 EMERGENCY ROADSIDE ASSISTANCE WITH VEHICLE PURCHASE\*

TOWING  
JUMP-STARTS  
TIRE CHANGES  
FLUID DELIVERY  
LOCKOUT  
SERVICE

WINCH-OUT  
MOBILE MECHANIC  
TECHNICAL  
SUPPORT  
DEALER LOCATOR  
SERVICES



\*VALID FOR 1 YEAR FROM DATE OF PURCHASE



## Dynamax Owner "Digital Kit" App

Now you can have your Owner's Manual with you wherever you are. Download our FREE App from the App Store or Google Play and you'll have the information right at your fingertips.



## Paint Video

<https://www.youtube.com/watch?v=sLgLoR26jfs>

## Factory Video Tour

<https://www.youtube.com/watch?v=q5cG43PD75E>



**Learn More**  
Scan this barcode using a QR Reader on your smart phone to learn more about Forest River.



A Berkshire Hathaway company.