

2022 ENTEGRA COACH LAUNCH

LAUNCH

DIESEL CLASS B MOTORHOME



2022



ENTEGRA
COACH®



FLOORPLAN

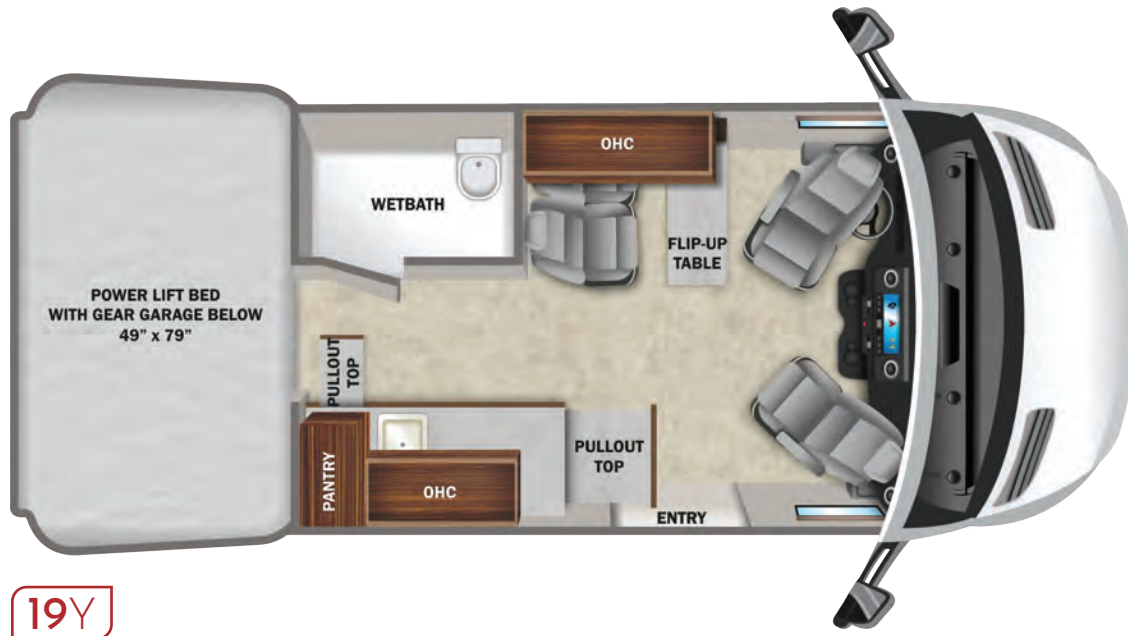

19Y

EXTERIOR SELECTIONS



Standard Exterior (silver or sandstone)



Aztec Partial Paint (silver van only)



Forest Glade Partial Paint (sandstone van only)

CUSTOMER VALUE PACKAGE

E-Z DRIVE™: Koni® shocks, heavy-duty rear stabilizer bar
 Carefree armless patio awning with LED light strip and wind sensor
 Double roof rack and moveable roof ladder
 Front and rear wind deflectors with front LED light bar
 Hydronic heating system with LED touchscreen control
 48V Coleman®-Mach® 10 air conditioner
 Black aluminum wheels with BFGoodrich® All-Terrain T/A® KO2® tires

STANDARD CHASSIS EQUIPMENT

Mercedes-Benz® Sprinter 2500 4x4 van with 144-in. wheelbase
 GVWR - 9,050 lb.
 GCWR - 13,550 lb.
 3.0L V6 engine with 188HP and 325 ft.-lb. torque
 7-speed automatic transmission
 220-amp alternator
 Daytime running headlamps
 Power folding/heated side-view mirrors
 3,500-lb. rear hitch receiver with dual 4/7 pin connector
 12V chassis battery
 24.5-gal. fuel tank (diesel)
 5.8-gal DEF Tank

HEAT, A/C, POWER & WATER EQUIPMENT

48V - 210 amp hour smart lithium battery providing 10.2 KW hours of power
 3500-watt inverter
 2nd 48V alternator dedicated to lithium battery
 30-amp electrical service with detachable power cord
 200 watts of roof-mounted solar panels
 Slow charge solar panel for chassis battery
 Utility center with water controls and outside hose
 Winterization drain system
 12V demand water pump
 Water filtration system
 House battery disconnect switch
 Aqua View® SHOWERMISER™ water management system
 Heated grey tank (12V pad) with skid plate
 Interior-mounted fresh water tank

STANDARD EXTERIOR EQUIPMENT

LED-lit running boards for cab and entry doors
 110V exterior outlet
 Portable solar plug
 LED-lit holding tank valves
 Side screen door with magnetic and zipper close-offs
 Rear screen door with roll-up and blackout capabilities
 Fold-down exterior table
 On-board air compressor with front and rear chucks

COCKPIT AMENITIES

10.25-in. MBUX infotainment center
 Power windows and door locks
 A/C and adaptive cruise control
 Active brake assist
 Heated power swivel driver/passenger seats
 Smartphone tray with wireless charging
 Rain-sensing wiper system
 Lane keeping assist
 Blind spot assist
 Traffic sign assist
 Leather-wrapped tilt steering wheel with integrated controls
 Cab area privacy shade
 Remote keyless entry

STANDARD INTERIOR EQUIPMENT

Custom-molded, vinyl-wrapped ABS interior wall panels
 Soft-touch vinyl ceiling
 High-intensity LED ceiling lights
 Tecnoform® European-style cabinetry
 Tecnoform® pull-out kitchen countertop extension
 Pantry with Tecnoform® pull-out extension
 Durable rubber flooring
 Firefly Multiplex system
 (2) sliding vented windows with cassette shades
 Rear dual-pane acrylic window with cassette shades
 MaxxAir Deluxe roof vent
 (2) additional cab bucket seats with slide and recline features
 BOSS® dual-zone radio with Bluetooth®
 Collapsible dinette table
 3-cu.ft. DC refrigerator

Portable induction cooktop
 Stainless-steel sink
 110V/USB outlets throughout
 Drop-down overhead bed with 750-lb. capacity
 Fiberglass side pods create larger sleeping surface
 Rear garage under bed with L-track mounts for securing cargo
 (2) recessed under-bed storage bags
 RAM® Tough-Track™ mounts throughout
 All-in-one wet bath with shower and cassette toilet
 Removable bamboo shelves in wet bath
 Powered roof vent in bathroom
 Retractable clothes line in shower

STANDARD SAFETY EQUIPMENT

Seatbelts at all designated seating locations
 Driver and passenger airbags
 Smoke alarm
 Carbon monoxide detector
 Fire extinguisher

WARRANTY

2
YEAR
 LIMITED
WARRANTY

At Entegra Coach, we build our RVs to handle every adventure, then back them with an outstanding warranty. Our 2-year limited warranty has you covered for 2 camping seasons. That's 730 days. For a copy of our 2-year limited warranty with complete terms and conditions, please contact your local Entegra Coach dealer.

It is important for your safety and enjoyment that you are aware of the weights and tow ratings of the RV you select. Consult a competent advisor for questions or advice. Whether you are new to RVing or a veteran, get a feel for the performance of your RV before heading out on the roadways. When you tow a vehicle with your RV, you must drive differently than when you drive a single vehicle. Practice hooking up, driving, backing up and braking in a safe environment or seek out professional instruction. Jayco affixes a weight label to each RV which lists weight information for that vehicle. Refer to that label to verify the vehicle will meet your requirements. Gross Vehicle Weight Rating (GVWR): The maximum permissible weight of the motorhome, including the Unloaded Vehicle Weight (UUV) plus passengers, personal items, all cargo, fluids, options and dealer-installed accessories. The GVWR is equal to or greater than the sum of the UUV and the Cargo Carrying Capacity. Gross Combined Weight Rating (GCWR): The maximum allowable combined weight of the motorhome used as a tow vehicle and the attached towed vehicle.

Floorplan	GVWR (lbs.)	GCWR (lbs.)	Wheel Base	Overall Length	Exterior Height w/ A/C & Satellite	Exterior Width	Interior Height	Fresh Water Capacity (gal.)	Grey Waste Water Capacity (gal.)	Black Waste Water Capacity (gal.)
19Y	9,050	13,550	144"	19' 7"	10' 1"	85"	73"	22	20	4.75