

OWN THE OUTDOORS



2022 Light 290RLS



FLOORPLANS



290RLS

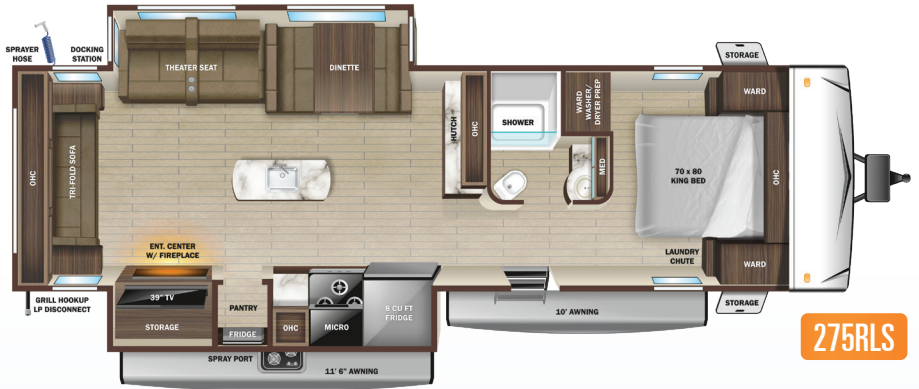

275RLS

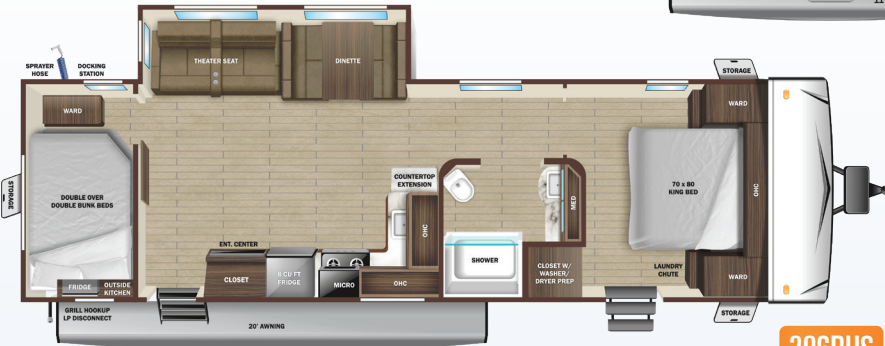

296BHS



313RLS



321BHS

STANDARD INTERIOR EQUIPMENT

- » 75 lb. ball bearing drawer guides
- » Bedroom night stands with accessible storage cubbies (n/a 313RLS)
- » Cable and satellite prep
- » Crowned ceiling
- » Electrical outlets and USB ports in master bedroom
- » Flush floor slides with residential vinyl flooring
- » Glass shower doors
- » Hardwood cabinet doors
- » Kid and pet friendly - residential vinyl flooring throughout, vinyl furniture, no floor heat registers
- » Kitchen sink covers
- » Laundry chute in bedroom
- » LED interior lighting
- » Pocket-screwed lumbercore cabinet construction
- » Pressed membrane countertops
- » Range hood vented outside
- » Residential high-rise faucet with pull-down sprayer
- » Roller blackout night shades
- » Stainless steel under-mount sinks (kitchen and bath)
- » TravellINK™ - Smart RV system that allows for Bluetooth® control of awnings, lighting, slides, heating, cooling and more

STANDARD EXTERIOR EQUIPMENT

- » 120 GFCI protected receptacle
- » 5/8" main floor decking
- » 50 amp service
- » Class leading I-beam chassis and draw bar sizes
- » Equa-Flex® axle suspension
- » Exterior grill hookup quick connect port
- » Fully-walkable roof
- » In-frame battery rack
- » Magnetic baggage door catches
- » Marine grade exterior speakers (2)
- » PVC roofing membrane (lifetime limited warranty)
- » Rain gutturing with molded drip spouts

- » Self-adjusting electric brakes
- » Side camera prep marker lights
- » Solid swing-down entry steps
- » Thermal Seal - enclosed, insulated, and heated underbelly and fully insulated roof with a PVC roofing membrane
- » TuffShell™ - vacuum bonded laminated construction, reinforced with heavy-duty fiberglass and welded aluminum frames

PLATINUM PACKAGE (MANDATORY)

- » 15,000 BTU roof mounted A/C
- » 2-30 lb. LP bottles with cover
- » 3-burner range and 17" oven with LED lighting and flush mount glass cover
- » 4" tube storage bumper
- » 8 cu. ft. refrigerator
- » AM/FM/HDMI/USB/AUX Bluetooth® sound bar stereo with indoor/outdoor zoned speakers
- » Bedspread
- » Dome style digital TV antenna with Wi-Fi prep
- » EZ-store detachable shore cord
- » Gas/electric DSI water heater
- » Keyed-Alike™ entry and baggage doors
- » Large grab handle on main entry door
- » Large pot and pan drawer below oven
- » LED HDTV on swing arm
- » Microwave
- » Observation camera prep
- » Oversized pass-through storage with motion lighting
- » Porcelain foot flush toilet
- » Power awning with LED lighting
- » Residential furniture
- » Stainless steel appliances
- » Storage doors in dinette base
- » Tinted safety-glass windows throughout
- » Water heater bypass

CUSTOMER CONVENIENCE PACKAGE (MANDATORY)

- » Battery disconnect switch
- » Enclosed exterior docking station with black tank flush
- » Kitchen sink covers
- » Molded front cap with LED lighting and stoneguard protection
- » Power tongue jack
- » Radial tires with aluminum rims
- » Rear roof access ladder
- » Solar prep
- » Spare tire with bracket and cover

OPTIONS

- » 13,500 BTU ducted 2nd A/C
- » 70" theater seats ipo standard tri-fold Sofa (275RLS, 290RLS)
- » BBQ grill with bumper bracket
- » King bed (313RLS)
- » Off-grid solar package - 12V TV, 180 watt panel, 30 amp controller
- » Power front and rear stabilizer jacks
- » Residential 10 cu. ft. refrigerator (12V)
- » Table with 2 chairs and bench ipo standard booth*
- » Table with 4 chairs ipo standard booth*
- » Tri-fold sofa ipo standard theater seats (312BHS)
- » U-lounge ipo standard theater seats and booth (275RLS, 312BHS)
- » Wi-Fi router

* N/A with U-Lounge



We want you to spend less time worrying and more time owning the outdoors. That's why we're proud to back our products with a 3-Year Limited Structural Warranty, plus a 1-Year Limited Manufacturer's Warranty.

SPECIFICATIONS

May Include Estimated Values

	290RLS**	275RLS	296BHS	313RLS**	321BHS
Unloaded Vehicle Weight (lbs.)	7,045	7,220	TBD	7,810	TBD
Dry Hitch Weight (lbs.)	830	970	TBD	810	TBD
Gross Vehicle Weight Rating (GVWR)	8,800	8,995	TBD	9,250	TBD
Cargo (Gross)	1,755	1,775	TBD	1,440	TBD
Exterior Length (Overall)	33' 5"	33' 11"	TBD	36' 11"	TBD
Exterior Height	11' 3"	11' 3"	TBD	11' 3"	TBD
Exterior Width	8' 1"	8' 1"	TBD	8' 1"	TBD
Exterior Width (Slides Out)	13' 0"	13' 0"	TBD	13' 2"	TBD
Interior Height (Overall)	6' 9"	6' 9"	TBD	6' 9"	TBD
Fresh Water Capacity (Gal.)*	51	51	TBD	51	TBD
Gray Waste Water Capacity (Gal.)	58	58	TBD	58	TBD
Black Waste Water Capacity (Gal.)	29	29	TBD	29	TBD
LP Capacity (lbs.)	60	60	TBD	60	TBD
Tire Size	15"	15"	TBD	15"	TBD
Awning Size	11', 10'	11' 6", 10'	20'	11', 14'	11', 10'

*Includes Water Heater

**Specifications, weights, measurements, and capacities above are from model year 2021 and are estimates only for model year 2022. Actual specs, weights, measurements, and capacities may be different for model year 2022 than what is listed above. For the most up-to-date model year 2022 specs, please speak with your local Highland Ridge dealer, visit <http://www.HighlandRidgeRV.com>, and check the yellow sticker on the door of your Highland Ridge RV before purchasing, operating, and towing the RV.

LOCAL DEALER INFO

TO LEARN MORE VISIT
highlandridgerv.com/light-travel-trailers



Highland Ridge RV – Part of the Jayco Family of Companies



Due to continual research and advances, manufacturer reserves the right to change specifications, design, price, and equipment without notice, and assumes no responsibility for any error in the literature. Some items shown are not included as standard or optional equipment.