

# LANDMARK



MAKE YOUR SOMEDAY NOW

 BROUGHT TO YOU BY  
**HEARTLAND®**



## TOP 5 EXTERIOR FEATURES

1. "Super Ride" 8,000lb Dexter axles on H-range tires with 3 3/8" brakes, MORryde LRE 4000 and gas shocks.
2. Lightweight, non-wood Azdel laminated sidewalls with laminated slide-out and rear end walls.
3. Super Store-More 3-sided accessed basement with 40% more storage and slam latch doors.
4. 45,000 BTU air conditioning system with whole house surge guard and energy management.
5. Standard 12-step finishing "Top Shine" full body paint.



The Azdel composite and aluminum components of our sidewalls create a strong, lightweight, quiet, weather and temperature resistant wall that will increase the life of your RV.



New enticing bathroom features a large glass shower with a foldable teak wood seat and 6'4" ceiling height.

## TOP 5 INTERIOR OPTIONS

1. Walk-in closets with deep shelves, double hanging rods, cedar lining and washer/dryer prep.
2. Motorhome-based multiplex coach controls including HVAC and dimmers.
3. "Spa Baths" with solid surface sinks, marble look shower, removable shower head and teak wood seat.
4. "Best Bedroom" MORryde power tilting king bed for 22" of extra floor space and 22" deep residential dressers. (most floorplans)
5. Privacy track hardwood window trim and hardwood window sills.



The beautifully redesigned Landmark interior features 2-tone black and tan maple cabinetry, solid surfaced countertops with a farmhouse sink, residential size refrigerator, 3 burner gas cook top with oversized oven, 30" microwave and many more beautifully designed standard features.



The luxurious bedroom suite features a king bed with under-the-bed storage, cedar lined built-in closet system featuring hanging clothes rod and recessed shelving, along with washer/ dryer prep.



For more information and to take a virtual walk-through, visit [www.heartlandrvs.com](http://www.heartlandrvs.com)





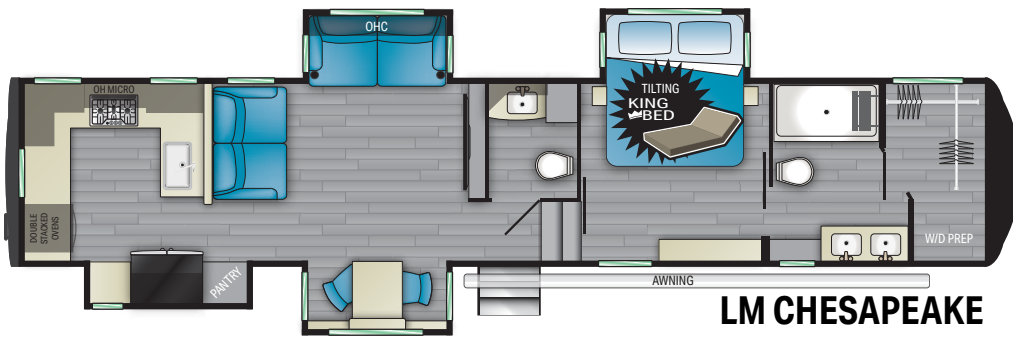

**LM CHESAPEAKE**

Length – 43' 1"  
 Dry – TBD  
 Hitch – TBD  
 Height – 13' 3"  
 GVWR – 18,000 lbs.

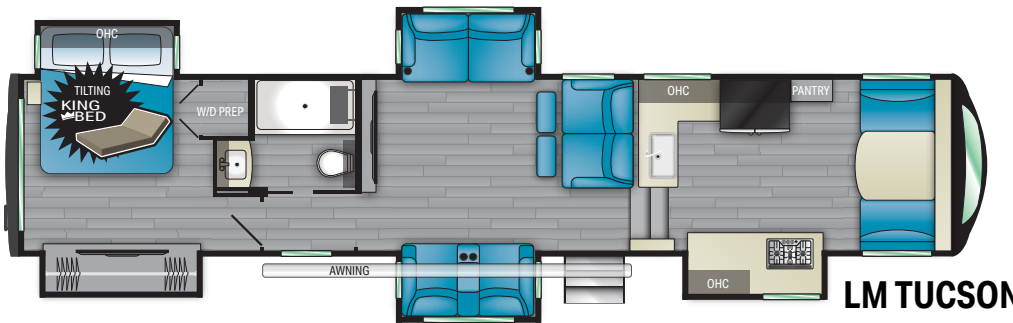

**LM TUCSON**

Length – 43' 9"  
 Dry – 15,657 lbs.  
 Hitch – 3,745 lbs.  
 Height – 13' 3"  
 GVWR – 18,000 lbs.

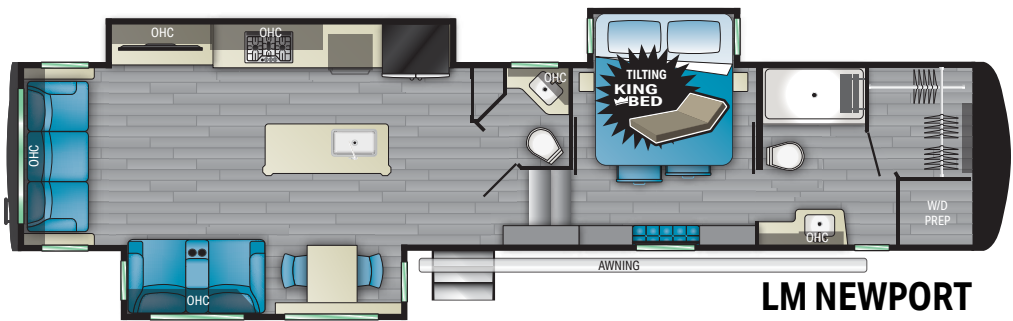

**LM NEWPORT**

Length – 43' 6"  
 Dry – 14,843 lbs.  
 Hitch – 3,048 lbs.  
 Height – 13' 3"  
 GVWR – 18,000 lbs.

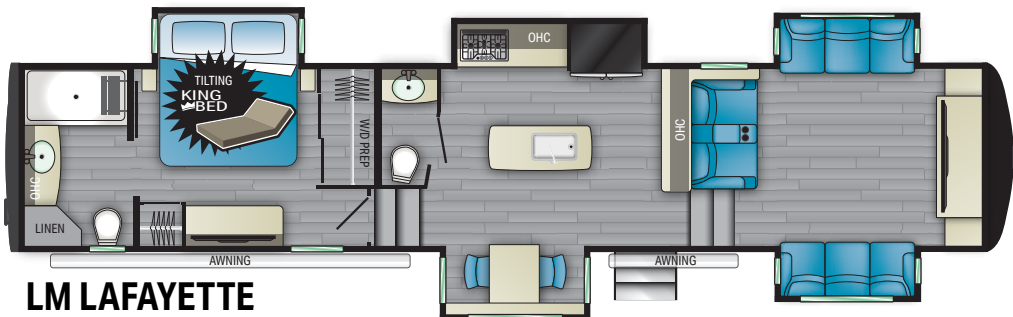

**LM LAFAYETTE**

Length – 43' 6"  
 Dry – 15,251 lbs.  
 Hitch – 3,918 lbs.  
 Height – 13' 3"  
 GVWR – 18,000 lbs.



[WWW.HEARTLANDRVS.COM](http://WWW.HEARTLANDRVS.COM)



Product information is as accurate as possible as of the date of publication of this brochure. Due to Heartland's commitment to continuous product improvement, floorplans, materials, components, features, measurements, specifications, options, etc. are subject to change at any time without notice or obligation. In certain conditions some additional equipment may be needed. Photos may show optional equipment or props used for photography purposes only. Heartland has listed the approximate base weight of the trailer without the optional equipment included. Optional equipment will impact the weight of the trailer. Please locate the weight sticker attached to the trailer you are considering for the most accurate trailer weight. Tow Vehicle Caution: Owners of Heartland recreational vehicles are solely responsible for the selection and proper use of tow vehicles. All customers should consult with the motor vehicle manufacturer or their dealer concerning the purchase and use of suitable tow vehicles for Heartland products. Heartland disclaims any liability or damages suffered as a result of the selection, operation, use or misuse of a tow vehicle. Heartland's limited warranty does not cover damage to the recreational vehicle or the tow vehicle as a result of the selection of the tow vehicle. Overall length for a Fifth Wheels is defined as the body length of the trailer excluding hitch meaning bumper to cap. The overall length for a Travel Trailer is defined as the body length of the trailer including hitch, meaning bumper to hitch(pin). It does not include rear ladder or spare tire. Optional pin boxes will affect overall length.