

INDEPENDENCE TRAIL

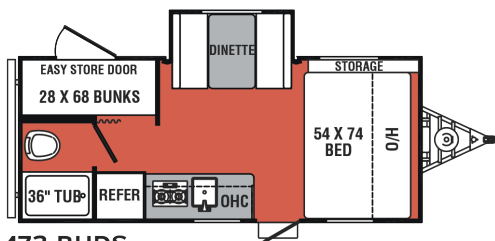

172 BHDS

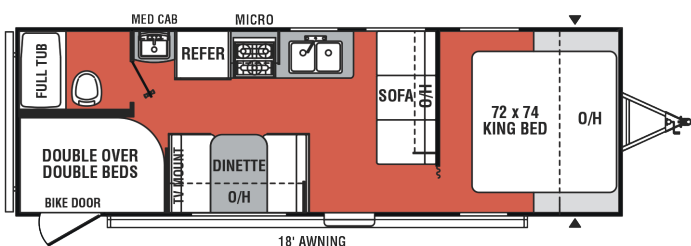

262 BH

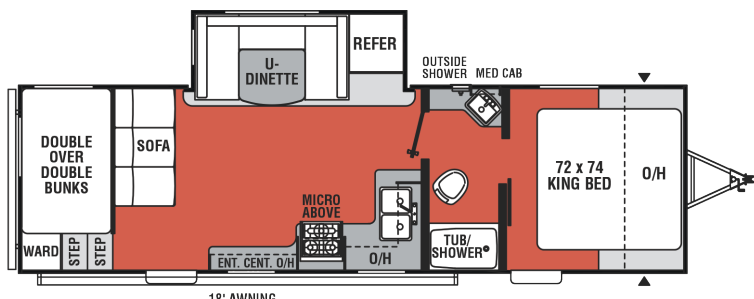

262 DBS

Independence Trail	172BHDS	262BH	262DBS
Sleeps	6	8	8
Slides	1	0	1
Length	21' 4"	29' 3"	32'
Exterior Width	88"	102"	102"
Exterior Height	9' 10"	TBD	TBD
Hitch Weight	425 lbs	TBD	TBD
Gross Weight	TBD	TBD	TBD
Dry Weight	TBD	TBD	TBD
Cargo Weight	988 lbs	TBD	TBD
Fresh Water Capacity	33 gal	40 gal	40 gal
Grey Water Capacity	25 gal	27 gal	27 gal
Black Water Capacity	25 gal	32 gal	32 gal
Axle Weight	3012 lbs	TBD	TBD
LP Tank Capacity	40#	40#	40#
Awning Length	10'	18'	18'
Axle Count	1	2	2
Electrical Service	30 AMP	30 AMP	30 AMP

PRODUCT DESIGN

Exterior Construction

- ▶ Floor: single axle 2x2 16" O.C., Tandem axle 2x3 16" O.C., 5/8" T&G plywood
- ▶ Walls: 2x2 16" O.C., .024 Mesa exterior (side and end walls), .030 Smooth and diamond plate lower (front wall)
- ▶ Roof: tapered truss with 1/4" luan (single axles), 1/2" O.S.B. (Tandem axles), alpha alpha flex TPC membrane
- ▶ Doors and windows: radius with tinted safety glass

Interior Construction

- ▶ Floor covering: congoleum diamond floor
- ▶ Décor board: maloney cream, ceiling board: adobe arctic
- ▶ Cabinet construction: stile fronts cross drilled and screwed
- ▶ Cabinet doors: M&T flat panel
- ▶ Cabinet hardware: knobs
- ▶ Countertops: thermofoil (color TBD)
- ▶ Soft goods: 4" cushions (color TBD)
- ▶ Window treatments: night shades where applicable
- ▶ Toilet: AMV foot flush

Systems & Appliances

- ▶ Water heater: 6 gallon gas DSI
- ▶ Exterior shower: standard
- ▶ LP system: 2 20# bottles all models
- ▶ Air conditioner: 13,500 BTU Coleman Mach (ducted on tandem axles)
- ▶ Furnace: single axle (20,000 BTU), tandem axle: (30,000 BTU ducted)
- ▶ Microwave: .9 Cu. Ft.
- ▶ Cooking: 2 burner drop in stove (single axles), 3 burner w/oven tandem axles
- ▶ Range hood: standard
- ▶ Refer: domestic 3 cu. Ft. 2 Way (single axles), norcold 7 cu. ft. double door (tandem axles)
- ▶ Lighting: dream lighting LED wall switch controlled
- ▶ Systems controls: kib control panel