

FOREST RIVER
IMPRESSION



BUILT BY EXPERIENCED RVERS

FLOORPLANS

NEW
240RE

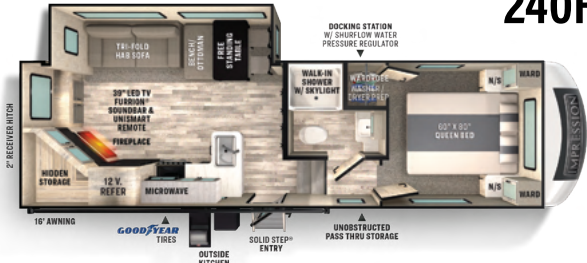

NEW
270RK



NEW
280RL

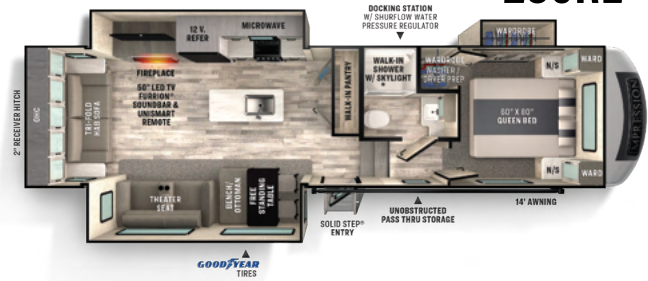

NEW
290VB

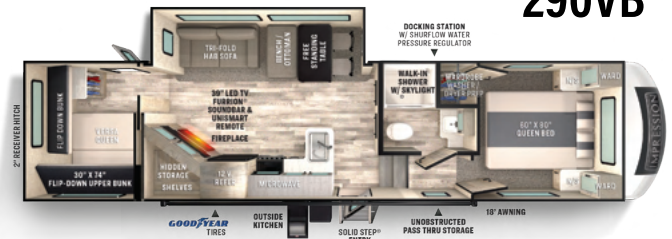

NEW
315MB

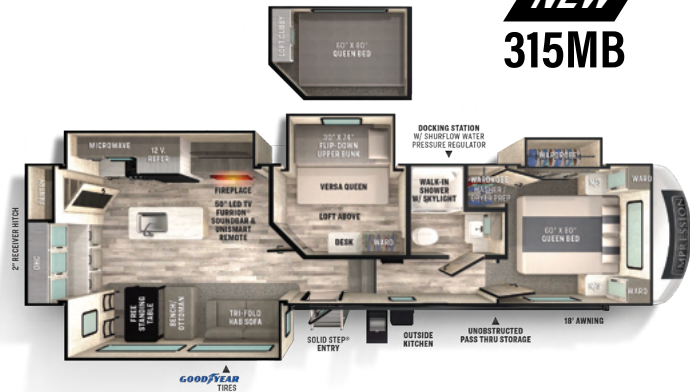

NEW
320FL

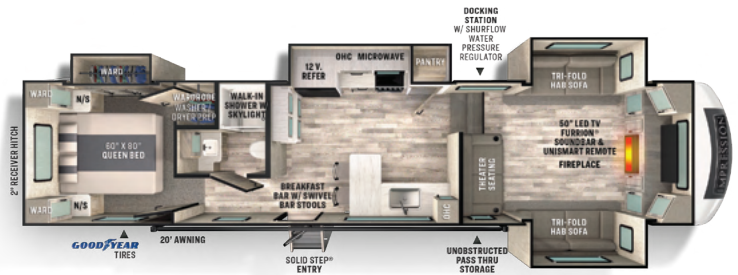

NEW
330BH

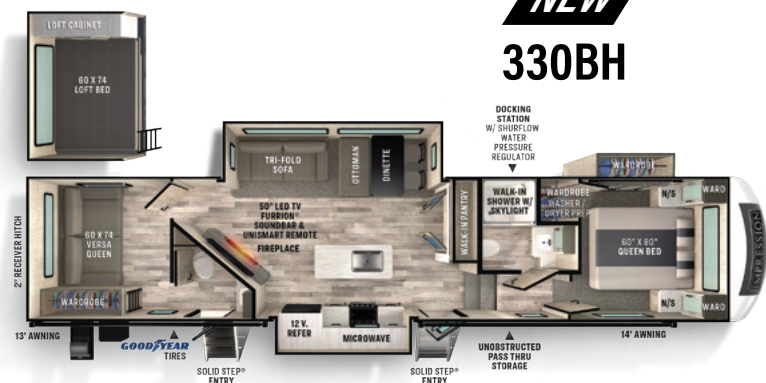

290VB

STANDARDS & OPTIONS

Construction

- "Aluma-Frame" Structure
- Laminated Aluminum Front Wall
- Laminated Aluminum Sidewalls
- Laminated Aluminum Slide Boxes
- Laminated Aluminum Floor
- 5" Truss Rafters 16" OC
- Fully Walkable Roof
- One-Piece Tufflex™ PVC Roofing
- LCI Space Saver Upper Deck™ & LCI Rhino Box™ Frame Construction with Additional Steel in Upper Deck. (*Vertical Tubular Frame for Strength, with Additional Gussets to Increase Headroom*)
- 100% PDI Quality Inspection Check Points Throughout the Production Process, Plus a Separate, Stand-Alone Inspection Before Shipping to the Dealer

Exterior Features

- Upgraded E-Rated Goodyear Endurance Tires (*Made in The U.S.A*)
- One Touch Automatic Leveling System
- Gel Coat Fiberglass Front Cap with Automotive Windshield & LED Lights
- Shurflo Water Pressure Regulator
- Enclosed Docking Station
- Black Tank Flush, Winterization and Sanitation
- Outside Shower
- Easy Access Water Heater Bypass
- Solar Prep and Pre-Wired for Invertor for Off-Grid Camping
- Solid Entry Step
- 2" Receiver Hitch #300 Capacity
- Enclosed Spare Tire & Carrier (*Full Size*)
- Dexter EZ Lube Axles with Never Adjust Brakes
- Insulated Exterior Slam Latch Baggage Door
- Battery Disconnect in Pass Through
- Custom Aluminum Rims
- Marine Grade Outdoor Speakers
- Factory Installed Roof Ladder
- Furrion Observation Back Up Camera Prep
- Adjustable Power Awning with LED Lights
- Slide Topper/Awning Prep
- Gas/Electic DSI Water Heater
- Friction Hinge Entry Door
- Detachable Power Cord
- LED Exterior Lighting
- Custom Exterior Graphics Package

Interior Features

- Blackout Roller Shade Window Covering
- Ductless Flooring Throughout for Easy Sweeping
- Centralized Command Center with Built-In Tank Monitoring
- USB Port Charging Stations
- 4G LTE and WIFI Prep, Digital TV Antenna
- Predrilled & Screwed Cabinetry
- Full Extension Drawer Glides
- Shaw Residential Carpeting with Stain Guard Protection
- Shaw Residential Linoleum
- Flex Pex Plumbing
- Carbon Monoxide/LP Detector
- LED Interior Lighting Throughout

Kitchen

- 12v Refrigerator
- Midnight Glass Recessed Range with Glass Cover
- Midnight Glass Microwave with Exhaust Vent
- Tile Backsplash
- Stainless Steel Undermount Single Bowl Sink
- High Rise Faucet with Pulldown Sprayer
- Sink Drying Rack
- Floor to Ceiling Pantry
- Natural Lighting From Skylight

Living Room

- Living Room 39" or 50" LED TV VBM
- Electric Fireplace/Space Heater (*5,500 Watt Heats Up To 400 SQ. FT.*)
- Furrion Soundbar
- Furrion UniSmart Remote (*Controls TV, Soundbar, & Fireplace*)
- Oversized Opening Windows
- Trifold Hide A Bed with Residential Sleep Surface (*Select Models*)
- Theater Seating with USB Charge Ports (*Select Models*)
- Free Standing Table with Storage Bench/Ottoman

Bathroom

- Porcelain Foot Flush Toilet
- Walk In Shower with Skylight
- Anti-Bacterial Shower Door
- Large Medicine Cabinet with Mirror
- Hanging Basket Storage

Bedroom

- 6'3" Bedroom Height
- 60x80 Mattress with Residential Bedspread & Pillows

Bedroom (continued)

- Gas Strut Assisted Bed Lift with Storage
- Full Size Stackable Washer/Dryer Prep
- Directional and Closable A/C Vents
- Bedroom Head Registers
- 110 Outlet and 12v Charging Ports Beside Bed
- C-Pap Machine Ready
- Cable/Satellite Prep

Heating and Cooling

- Industry Leading 15k A/C
- A/C Larger Return Air Vents with Accessible Filters
- 35K BTU Furnace
- Continuous Loop Insulated A/C Ducting to Maximize Cooling Efficiency
- Heated & Enclosed AccessiBelly (*with Removable Underbelly Panels*)
- 12v Heat Pads for Holding Tanks

Elite Package

- Upgraded E-Rated Goodyear Tires
- Gel Coat Fiberglass Front Cap with Automotive Windshield
- "Aluma-Frame" Structure
- LED TV
- Furrion Soundbar
- Electric Fireplace/Space Heater (*5500 Watt heats up to 400 SQ. FT.*)
- Furrion UniSmart Remote
- Industry Leading 15k Whisper Quiet A/C
- 12v Refrigerator
- Superior Insulation w/ Astrofoil and 12v Tank Heat Pads
- Heated & Enclosed AccessiBelly (*with Removable Underbelly Panels*)
- Oversized Opening Windows
- 2" Receiver Hitch for Storage Rack
- Solid Entry Step
- Enclosed Convenient Docking Station
- Shurflo Water Pressure Regulator
- Insulated Exterior Slam Latch Door
- Solar Roof Prep for Off-Grid Camping

Options

- 50 Amp with Second A/C Prep and Washer/Dryer Prep
- Second 13.5k Ducted A/C
- 8 CU FT Gas/Elec Refer in Place of 12v 10 CU FT Refer
- Off-Grid Solar/Inverter Package

SPECIFICATIONS

	240RE	270RK	280RL	290VB	315MB	320FL	330BH
LENGTH	31' 0"	34' 5"	TBD	36' 8"	38' 0"	40' 2"	TBD
HEIGHT	12' 11"	12' 11"	TBD	12' 11"	12' 11"	12' 11"	TBD
HITCH WEIGHT	1,350 LB.	1,515 LB.	TBD	2,000 LB.	1,935 LB.	2,535 LB.	TBD
UVW	8,243 LB.	8,948 LB.	TBD	8,933 LB.	10,338 LB.	10,303 LB.	TBD
CCC	3,307 LB.	2,767 LB.	TBD	3,267 LB.	3,597 LB.	4,232 LB.	TBD
FRESH WATER	57 GAL.	57 GAL.	TBD	57 GAL.	57 GAL.	57 GAL.	TBD
GREY WATER	60 GAL.	62 GAL.	TBD	62 GAL.	62 GAL.	60 GAL.	TBD
BLACK WATER	30 GAL.	30 GAL.	TBD	30 GAL.	30 GAL.	32 GAL.	TBD
AWNING	16'	14'	14'	18'	18'	20'	13' & 14'



PRE-DELIVERY INSPECTION FACILITY
 20,000 square feet of quality assurance. The bare essentials for a premium product. This state-of-the-art facility gives immediate daily feedback to production for quality assurance in every unit built.



www.ForestRiverBuyLocal.com

Download our Forest River mobile app or visit our dynamic online manual to enhance your ownership experience. These interactive options provide incredible ease and insight into use, maintenance and enjoyment of your Forest River product.

Ranging from "How-To" videos, pictures and illustrations of various components, systems and features, to fully searchable content and downloadable PDFs for individual component owner's manuals, answers are always just a click away. View the online manual at www.forestriverinc.com/OnlineManual or download our FREE app from the App Store or Google Play!



GVWR (Gross Vehicle Weight Rating) - is the maximum permissible weight of the unit when fully loaded. It includes all weights, inclusive of all fluids, cargo, optional equipment and accessories. For safety and product performance do NOT exceed the GVWR.

GAWR (Gross Axle Weight Rating) - is the maximum permissible weight, including cargo, fluids, optional equipment and accessories that can be safely supported by a combination of all axles.

UVW (Unloaded Vehicle Weight)* - is the typical weight of the unit as manufactured at the factory. It includes all weight at the unit's axle(s) and tongue or pin and LP Gas. The UVW does not include cargo, fresh potable water, additional optional equipment or dealer installed accessories.

CCC (Cargo Carrying Capacity)** - is the amount of weight available for fresh potable water, cargo, additional optional equipment and accessories. CCC is equal to GVWR minus UVW. Available CCC should accommodate fresh potable water (8.3 lbs per gallon). Before filling the fresh water tank, empty black and gray tanks for more cargo capacity.

*Estimated Average based on standard build optional equipment. ** Estimated average based on standard build optional equipment. Values estimated at time of printing.

Each Forest River RV is weighed at the manufacturing facility prior to shipping. A label identifying the unloaded vehicle weight of the actual unit and the cargo carrying capacity is applied to every Forest River RV prior to leaving our facilities. The load capacity of your unit is designated by weight, not by volume, so you cannot necessarily use all available space when loading your unit.

All information contained in this brochure is believed to be accurate at the time of publication. However, during the model year, it may be necessary to make revisions and Forest River, Inc., reserves the right to make all such changes without notice, including prices, colors, materials, equipment and specifications as well as the addition of new models and the discontinuance of models shown in this brochure. Therefore, please consult with your Forest River, Inc., dealer and confirm the existence of any materials, design or specifications that are material to your purchase decision. ©2021 Impression, a division of Forest River Inc., a Berkshire Hathaway company.

FREE MEMBERSHIP
 to Forest River Owners' Group

www.forestriverfrog.com



**24/7 EMERGENCY
 ROADSIDE ASSISTANCE
 WITH VEHICLE PURCHASE***

<p>TOWING JUMP-STARTS TIRE CHANGES FLUID DELIVERY LOCKOUT SERVICE</p>	<p>WINCH-OUT MOBILE MECHANIC TECHNICAL SUPPORT DEALER LOCATOR SERVICES</p>
--	---

**SAFERIDER RV
 MOTOR CLUB**

*VALID FOR 1 YEAR FROM DATE OF PURCHASE



Learn More
 Scan this barcode using a QR Reader on your smart phone to learn more about Forest River.



A Berkshire Hathaway company.