

# HIKE TRAVEL TRAILER



Legendary quality.  
Bound by what's next



**WINNEBAGO.**  
TOWABLES



## HIKE

---

### WINNEBAGO NOW GIVES YOU MORE THAN EVER BEFORE

---

Introducing a towable built for beyond. Beyond the beaten path, with offset wheels that pack all the stability of larger towables in a 6.5 ft frame. Updated exterior styling—built to accommodate outdoor enthusiasts and a flexible storage system take the Hike well beyond the expectations of everyday.

- **Off-road tires and fenders:** Off-road tires, offset wheels, and robust fenders make easy work of tough roads.
- **Multi-use gear storage:** Pack in more adventure in the durable, convenient front storage. With space for a battery, LP tanks, or adventure gear.
- **Exoskeleton:** Bikes, kayaks, and other tools of the trek can be securely attached to the Hike's rugged exoskeleton.
- **Flexible Floorplans:** Choose from five flexible floorplans—all under 4,500 lbs—to fit your lifestyle.
- **Modern interior:** Contemporary styling, clean lines, and quality interior furnishings make the Hike's interior as inviting as it is innovative.



### 1 ROOF CONSTRUCTION

- Walkable roof, with 3/8" decking and rafters on 16" centers
- TPO exterior
- Double insulation; fiberglass insulation and Extreme Weather Radiant Foil insulation

### 2 LAMINATED SIDEWALL

- Max Fiberglass Sidewall by Crane Composites
- Aluminum frame structure
- Multi-layer design including Azdel composite panel & block foam insulation

### 3 FLOOR CONSTRUCTION

- Tongue & groove plywood flooring
- Aluminum frame structure
- Double insulated multi-layer design including fiberglass and Extreme Weather Radiant Foil insulation
- Heated and enclosed underbelly
- Heated holding tanks (select models)



### 4 FULLY INSULATED FRONT CAP WITH FIBERGLASS AND EXTREME WEATHER RADIANT FOIL INSULATION

### 5 BAL NXG CHASSIS

### 6 POWER FRONT TONGUE JACK

### 7 POWER AWNING

### 8 INSULATED SLAM LATCH BAGGAGE DOORS

### 9 NITRO FILL TIRES WITH ALUMINUM RIMS

### 10 STANDARD REAR LADDER (SELECT MODELS)



#### TPO ROOFING

A durable, bacteria-resistant material protects against debris, algae, ultraviolet and chemical exposure. Its flexible membrane allows it to withstand punctures, tears, and impact-related damage.



#### ROOF-MOUNTED SOLAR PREP

Prewired for this quiet alternative to generators, this system offers flexible camping options, and lower emissions while providing uninterrupted power to lights, furnaces, fans, and DC appliances.



#### COLOR-CODED WIRING

Easy-to-trace circuits simplify electrical and other system troubleshooting, reducing service time.



#### AZDEL MATERIALS

A durable, lightweight material protects from moisture and high temperatures to increase RV lifespan by reducing the risk of mold, decay and rot.

Every Towable is equipped with Winnebago's Comfort Tech and Explorer Packages.

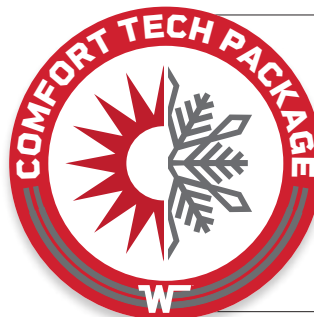

- Laminated, block foam sidewalls
- Extreme Weather Radiant Foil wrapping
- Roof-mount A/C systems
- Insulated heating ducts
- Heated tanks
- Enclosed underbelly



- Roof-mount solar prep
- Larger, off-road tires
- Propane heating system
- Heavy duty axles & suspension
- WiFi prep
- Battery disconnect
- Awning with LED lighting

WINNEBAGO

# HIKE TRAVEL TRAILER

WINNEBAGO NOW GIVES YOU MORE THAN EVER BEFORE



All Hike models are dry baths, giving you maximum functionality in a compact trailer.

- i** Visit [Winnebago.com](http://Winnebago.com) for more info
- +** Join a boundless community of adventurers at [Witclub.com](http://Witclub.com)



Hike is standard with White exterior and Slate interior décor



Recessed cooktops, convection microwaves & gas/electric refrigerators are standard and complimented with Crank Style accent cabinets



The light décor is complimented w/ larger windows for natural light and cross ventilation

## H170S /

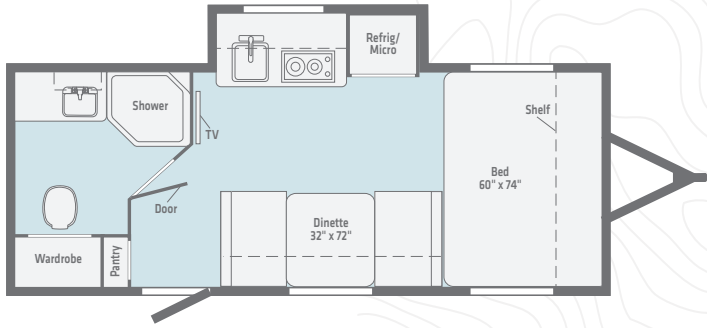

## H171DB /

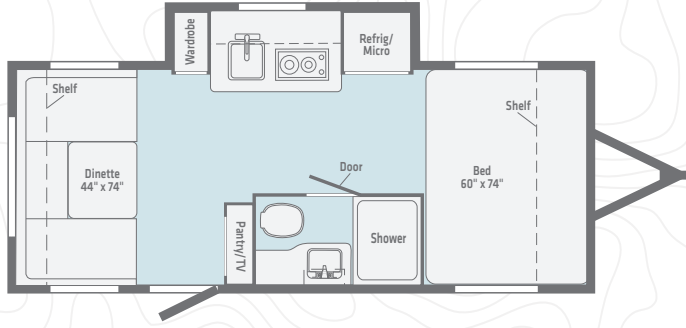

## H172BH /

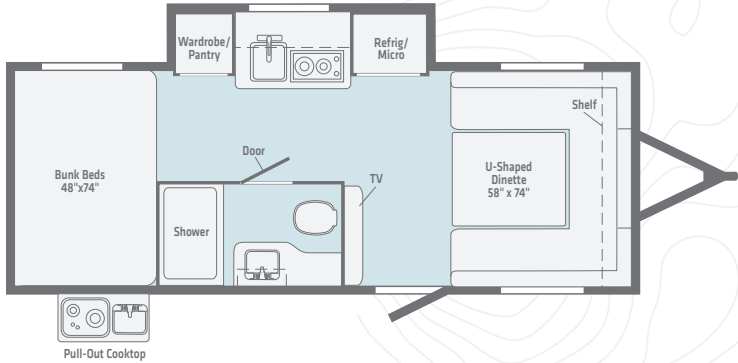

## H210RB /

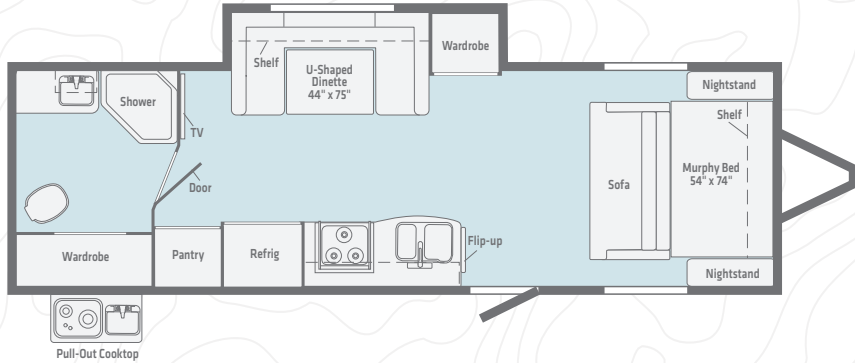

## H215HS /

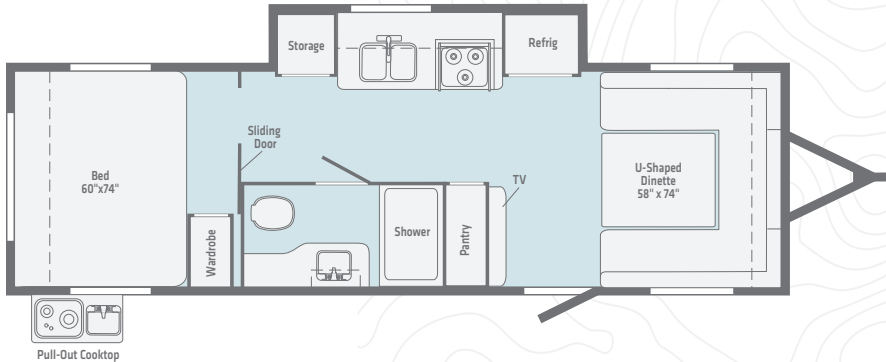

## STANDARD FEATURES

- NXG Engineered frame
- Exterior fiberglass w/ Azdel
- One-piece fiberglass roof
- 13.5K low profile A/C
- Convection microwave
- Gas/electric refrigerator
- 6 gallon gas/electric/DSI water heater
- (2) 20lb. LP tanks
- Aluminum wheel assemblies
- Spare tire
- Power awning w/ LED lighting
- Roof mount solar prep
- Power tongue jack
- Recessed 3 burner cooktop w/ backlit knobs & glass cover (H215HS, H210RB only)
- Recessed 2 burner cooktop w/ glass cover (H170S, H171DB, H172BH only)
- 15" off-road tires/axle lift
- Torflex Dexter axle(s)
- LED exterior lighting
- Enclosed tanks
- Radiant foil insulation
- Exterior powder coated rack system
- Large powder coated wheel wells
- Large powder coated LP/ battery/gear storage box
- Accessory receiver/hitch
- AV System AM/FM/CD/DVD/USB/Bluetooth
- USB charge ports
- TV antenna
- Exterior speakers
- LED TV
- Backup camera prep
- Wifi prep
- Wireless cell phone charger

# SPECIFICATIONS

## HIKE



	Exterior Length	Exterior Height (including A/C)	Exterior Width	Interior Height	GVWR (lbs.)	Dry Weight (lbs.)	Dry Hitch Weight (lbs.)	Axles (lbs.)	Tire Size	Fresh Water (Tank only)(gal.)	Black Tank Capacity (gal.)	Gray Tank Capacity (gal.)	LP Capacity (lbs.)	Awning Length	Furnace (BTU)	Water Heater (gal.)
<b>H170S</b>	20'7.5"	10'2"	8'0"	6'5"	4,200	3,260	400	1@4,000	235/75R15	31	25	25	40	10'	18,000	6
<b>H171DB</b>	20'7.5"	10'2"	8'0"	6'5"	4,200	3,340	420	1@4,000	235/75R15	31	25	25	40	10'	18,000	6
<b>H172BH</b>	20'7.5"	10'2"	8'0"	6'5"	4,200	3,400	620	1@4,000	235/75R15	31	25	25	40	7'	18,000	6
<b>H210RB</b>	25'	10'2"	8'0"	6'5"	6,000	4,160	480	2@4,000	235/75R15	37	25	43	40	12'	18,000	6
<b>H215HS</b>	25'	10'2"	8'0"	6'5"	6,000	4,360	660	2@4,000	235/75R15	37	25	43	40	12'	18,000	6



### 3 Year Limited Structural Warranty:

The Winnebago Towables Limited Structural Warranty covers your RV for a period of three (3) years from the date of purchase by the original owner. This structural warranty covers the workmanship attributable to Winnebago's manufacturing and assembly of the structural portions of your RV. Structural coverage includes:

- Main steel frame
- Steel frame outriggers and cross members
- Skeletal framing (wall studs, floor joists, roof rafters)
- Sidewall assembly
- Roof assembly
- Roof materials installation
- Flooring assembly
- All slideout boxes and applicable structural assembly
- Fiberglass front caps (paint fade cracking)

### 1 Year Limited Base Warranty:

In addition to the 3-Year Limited Structural Warranty, the Winnebago Towables Limited Base Warranty covers your RV for a period of one (1) year from the date of purchase by the original owner. This limited warranty covers defects in materials and workmanship supplied by and attributed to Winnebago's manufacturing and assembly of the RV.

# TOWABLES BRAND STORY

## Brand Promise

Winnebago gives you a community to belong to that pushes the boundaries of every adventure.

## The Winnebago Towable Legacy

Towables are in Winnebago's DNA. In fact, Winnebago was founded in 1958, originally as a travel trailer manufacturer. Since then, we have evolved our towables offering to not just meet, but exceed, the demands of our consumers. Inspired by our founder, industry pioneer John K. Hanson, we continue to push what's possible in the towable category through relentless innovation.

## Our Brand Positioning: United and Boundless

We are for the boundless adventurers and travelers who have a drive for experiencing what's next with those who matter to us most. Winnebago provides a community united by pride and a sense of belonging. With our commitment to quality, innovation and consumer trust, we take you further, for longer. So that you can always be bound by the adventure ahead.

## Committed to Dealer Success

When a dealer partners with Winnebago, they experience support that is unmatched by any other. We only allow one dealer per market. This means less competition, greater return on the dealer's investment, and a consistent customer experience. Better point of service, and response time, translates into happy customers. Our owner communities are passionate and unlike any other, and that is directly influenced by their satisfaction and advocacy for our brand.



## You Don't Just Buy Winnebago, You Join Winnebago

### A COMMUNITY UNITED BY BRAND PRIDE

- A community of proud Winnebago owners with support and advice
- Pre-planned and curated community adventures
- WIT Club—A passionate club of boundless adventurers

## Towables Point of Differentiation

### A HISTORY OF INNOVATIVE FIRSTS IN THE CATEGORY

- Innovative floorplans and design for spacious living and storage
- Equipped with industry-leading technology
- Unmistakable interior and exterior style

### RELY ON THE W FOR SUPERIOR SERVICE AND SUPPORT

- Dedicated parts and service teams
- Experienced technical support professionals
- Unparalleled dealer relations

### HIGH QUALITY CONSTRUCTION, BUILT TO GO FURTHER

- Superior, cutting-edge construction
- Thoughtfully designed service access
- Commitment to high-quality materials



Are you a towable owner? Join our WIT TOWS owners group on Facebook.



Connect with other Hike owners on the **Winnebago** Facebook page and other social media platforms



**WIT**  
**CLUB**

[www.witclub.com](http://www.witclub.com)



Have a question about the Minnie Family?  
Email [SalesWOI@WGO.net](mailto:SalesWOI@WGO.net).



**Coach-Net**

1-Year Roadside Assistance Included with vehicle purchase.

Learn more at [www.coach-net.com/winntow](http://www.coach-net.com/winntow).

**WINNEBAGO**  
**TOWABLES**

**Winnebago Towables**

201 14th Street  
Middlebury, IN 46540

(574) 825-5250

[www.Winnebago.com](http://www.Winnebago.com)

Your Winnebago Dealer

