

# BULLET

CROSSFIRE, BULLET & PREMIER TRAVEL TRAILERS

EASTERN + WESTERN



**KEYSTONE**  
RV COMPANY

**LIVE IT OUT.**



# EASTERN BULLET

CROSSFIRE, BULLET & PREMIER TRAVEL TRAILERS



**KEYSTONE**  
RV COMPANY

**LIVE IT OUT.**



# BULLET



CROSSFIRE | BULLET | PREMIER

## Bullet has the ultimate lineup for any adventure.

Bullet is the ultra-light coach with a luxurious look and feel, an abundance of practical features, innovative floorplans, and unrivaled towability at the lightest weight possible. It truly is the original luxury lightweight RV. With the request for more amenities in new floorplans, Bullet delivered once again with the Bullet Premier. Since its inception, Bullet has always been committed to listening to the customer and building what they want most. That simple approach not only built the brand into the #1 selling travel trailer in its segment, it resulted in the easiest to tow ultra-light that truly feels like home.

For more information, please visit [keystonerv.com/Bullet](http://keystonerv.com/Bullet)

# KEYSTONE EXCLUSIVE INNOVATIONS

Designed to deliver superior performance, quality, and a best-in-class camping experience, every Bullet model includes engineering innovations available EXCLUSIVELY to Keystone owners. For more information about these features and the Keystone Innovation Lab, visit us online at [www.keystonerv.com/innovations](http://www.keystonerv.com/innovations).



## HyperDeck™ High-Performance, Water-Resistant RV Floor

The HyperDeck RV floor is more resilient, stronger and lighter than traditional laminated wood construction – and it resists water and water damages.



## Blade™ High-Performance Air Flow System & Tuf-Lok™ A/C Duct Joiners

Blade™ & Tuf-Lok™ are designed to accelerate air flow, eliminate leakage and failure points, and deliver 360° circulation.



## 4G LTE and Wi-Fi Prep

All units are equipped with a new antenna that integrates 4G LTE and Wi-Fi with standard VHF/UHF/AM/FM reception.



## Tru-fit™ Slide Construction

A more durable slide room design that minimizes functional motor and structural stress and resists leaking.



## Color-Coded Unified Wiring Standard

Easy-to-trace circuits simplify electrical and entertainment system troubleshooting.



## KeyTV™

No more connection guesswork or poor reception. KeyTV offers a game-changing, single point of control of over-the-air, cable, and satellite feeds.



## 3-YEAR LIMITED STRUCTURAL WARRANTY, 1-YEAR LIMITED BASE WARRANTY

Every new Keystone RV comes with the industry's best three-year limited structural warranty AND a one-year limited base warranty. Ask your dealer, visit [keystonerv.com](http://keystonerv.com), or call Keystone Owner Relations for details.





## BULLET INTERIORS: COASTAL COTTAGE

Taking cues from east coast cottage style, gray-painted cabinetry and wall coverings are paired with weathered wood-inspired resilient flooring. Crisp white marbled countertops, glass panel doors and stainless steel fixtures and appliances complete a fresh and tranquil environment for your family.







more product detail at  
[www.keystonerv.com/Bullet](http://www.keystonerv.com/Bullet)



## CROSSFIRE COMFORT TRAVEL TRAILERS

With the addition of the 2430BH, 2500RK and 2730BH, Crossfire now offers larger floorplans and more bunkhouses for larger families. Other new and notable features include:

- One-piece Murphy bed mattress (Murphy bed models)
- Central control panel
- Sink cover for expanded counter space
- Battery disconnect
- Roof ladder backer
- Black tank flush
- Larger entry grab handle



### Electric Stabilizer Jacks

All units now come standard with electric stabilizer jacks.



### Power Tongue Jack

Work smart, not hard. Less effort and less time.



### XL Grab Handle

Provides a safe and comfortable entry.



### Stainless Steel Sink w/ Cover

Won't chip, crack, or fade.



### Central Control Panel

Light switches, awning, and more are all easily controlled in one location.



### 100% Hardwood Cabinet Doors

A modern touch that provides design versatility and durability.



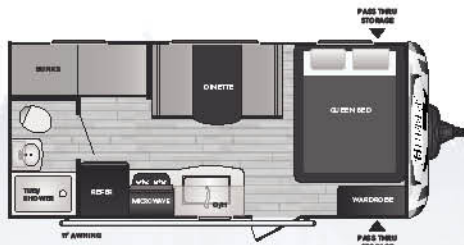

**1700BH** | Bunks, single axle



**1800RB** | Rear bath, Murphy bed, single axle



**1850RB** | Rear bath, sofa slide, single axle

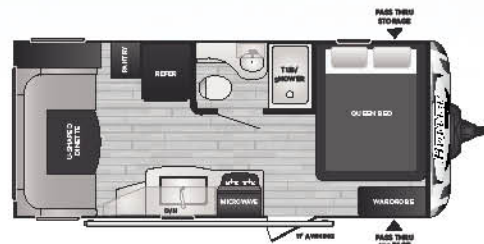

**1900RD** | Rear dinette, single axle

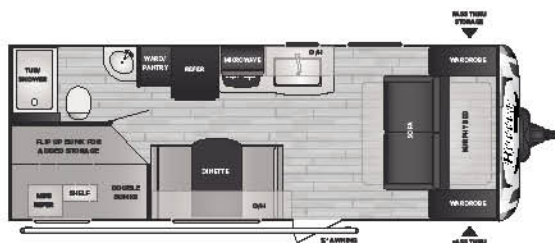

**2200BH** | Double bunks, Murphy bed, outside kitchen

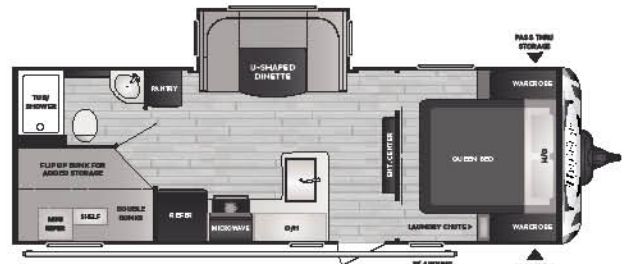

**NEW!** **2430BH** | Double bunks, dinette slide, outside kitchen

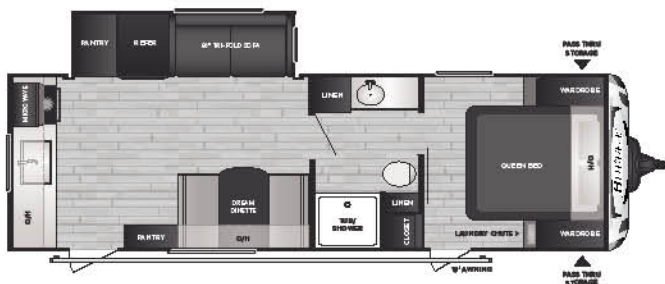

**NEW!** **2500RK** | Rear kitchen, sofa slide

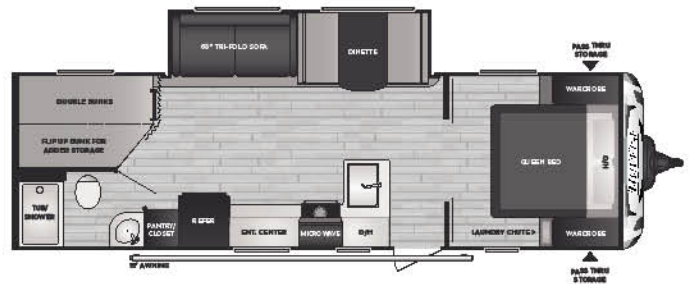

**NEW!** **2730BH** | Double bunks, super slide





more product detail at  
[www.keystonerv.com/Bullet](http://www.keystonerv.com/Bullet)



## BULLET PREMIUM TRAVEL TRAILERS

Bullet travel trailers are literally raising the roof with the introduction of vaulted ceilings in all models. This more open feel is perfectly suited for campers who are taking longer, more frequent camping trips. New Zamp solar power prep and optional OTG solar power package also supports this trend. Other new and notable features include:

- Vaulted ceilings
- Seamless dinette and bathroom countertops
- Built-in spice rack
- Larger radius shower (select models)
- 10 cu. ft. 12V refrigerator and optional 8 cu. ft. RV refrigerator
- Redesigned front cap to create more usable interior space
- Zamp solar prep and optional OTG solar package
- Roof ladder
- Expanded docking station w/ water heater bypass valve, winterization valve, and antifreeze inlet makes winterization much easier



### Zamp Solar Prep and Optional "OTG" Solar Package

OTG package includes 170W solar panel (expandable up to 510W), 30 AMP solar charger, 1200W inverter, and 3 inverted outlets.



### Roof Ladder

Easy access for maintenance and cleaning.



### 51 cu. ft. Pass-Through Storage

25% more storage space and a 40% wider door mean easier access and more room for supplies.



### Vaulted Ceilings

Spacious headroom with nearly 7' in ceiling height.



### Redesigned Sofas and Theater Seating

Adds appeal, comfort, and storage to your entertainment space.



### Woven Flooring in Slideouts

This highly durable marine-grade flooring eliminates carpet and makes cleaning a breeze.



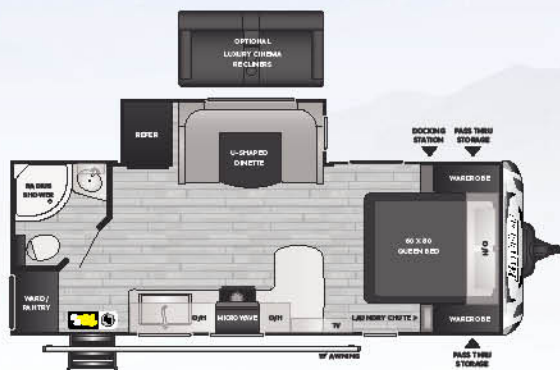

**221RBS** | Rear bath, dinette slide

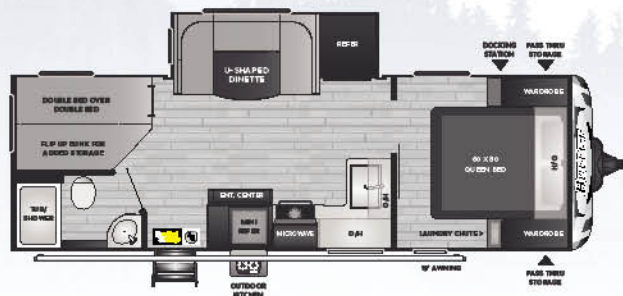

**NEW!** **250BH** | Double bunks, dinette slide, outside kitchen

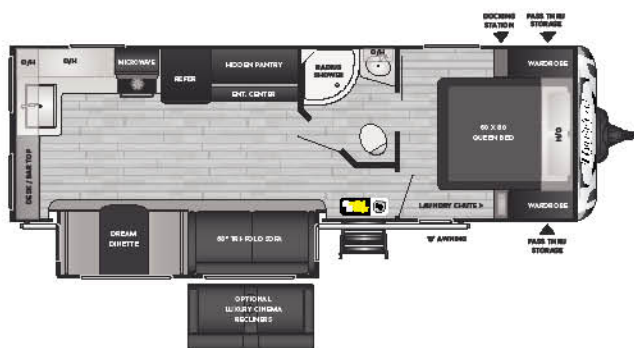

**258RKS** | Rear kitchen, super slide, hidden pantry

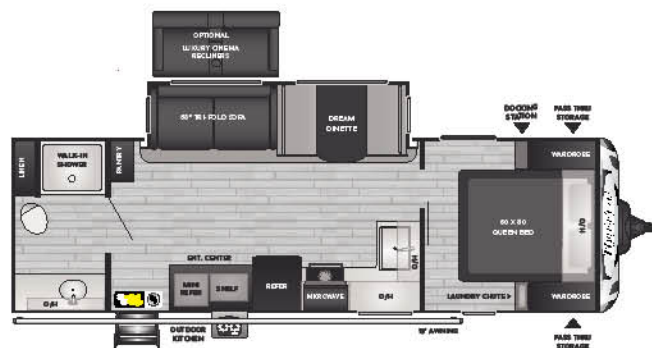

**261RBS** | Rear bath, super slide, outside kitchen

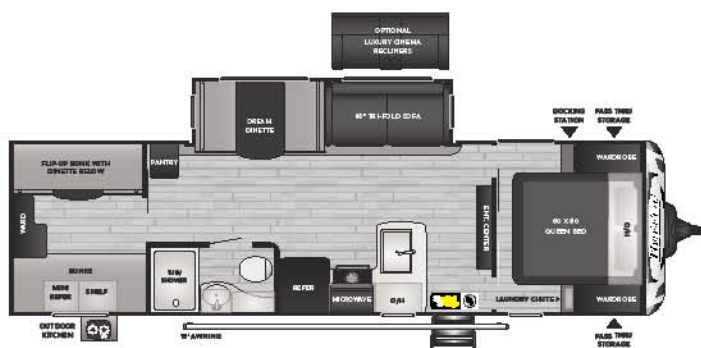

**287QBS** | Quad bunkroom, super slide, outside kitchen

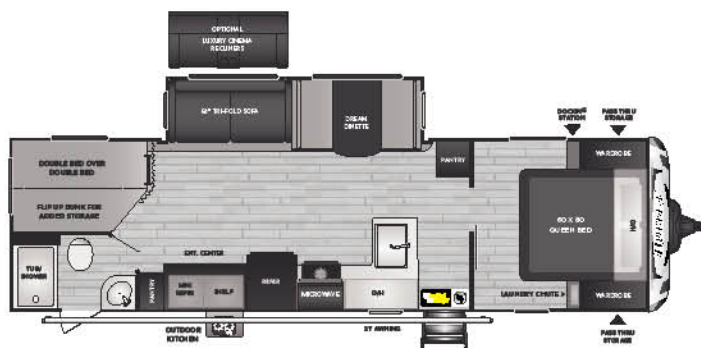

**290BHS** | Double bunks, super slide, outside kitchen



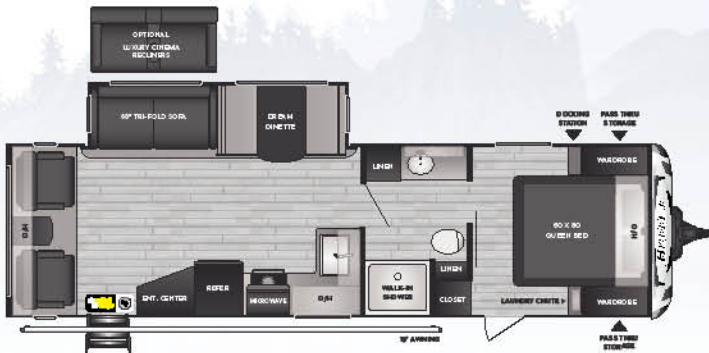

**291RLS** | Rear living, super slide

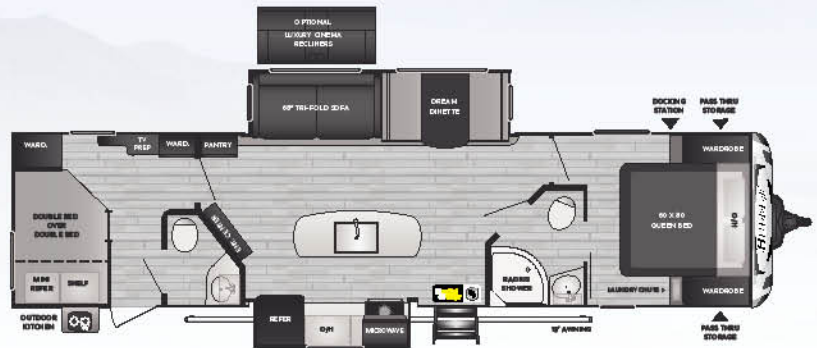

**330BHS** | Double bunks, 1 1/2 baths, island kitchen

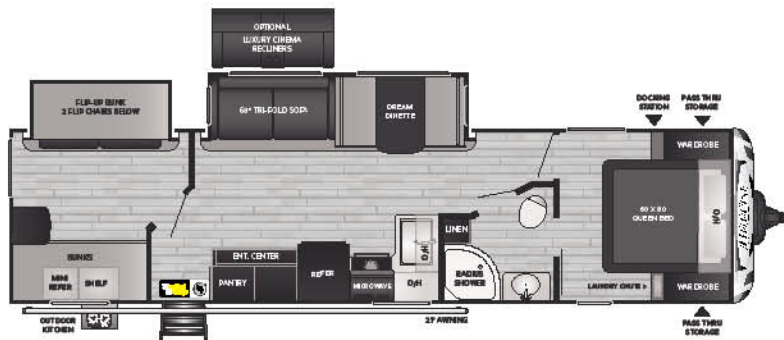

**331BHS** | Bunkroom w/ slide, super slide, outside kitchen

**More to come!** Be sure to check out [www.keystonerv.com/Bullet](http://www.keystonerv.com/Bullet) for more information.





more product detail at  
[www.keystonerv.com/Premier](http://www.keystonerv.com/Premier)



## PREMIER LUXURY TRAVEL TRAILERS

Luxury meets lightweight towability. Premier offers an exceptionally rich feature set including amenities like:

- Roller shades that replace pleated shades
- Seamless dinette and bathroom countertops
- Larger radius shower (select models)
- Shower skylights
- Redesigned table and chairs (optional)
- New pendant lighting fixtures (island models)
- Stainless steel roll-up sink cover in kitchen
- 10 cu. ft. 12V refrigerator and optional 8 cu. ft. RV refrigerator
- Built-in spice rack
- Under-range cookware drawer (select models)
- Roof ladder
- Redesigned front cap with protective liner to create more usable interior space
- Zamp solar prep and optional OTG solar package
- Expanded docking station w/ water heater bypass valve, winterization valve, and antifreeze inlet making winterization much easier



### Full Fiberglass Front Cap

Equipped with Line-X® rock guard to help Premier endure the rigors of the road.



### Docking Station

Easily accessible convenience center with water connections, water heater bypass, KeyTV™ hookups, stabilizer jack switches, and winterization access.



### 10 cu. ft. 12V Refrigerators (Optional 8 cu. ft. RV refrigerator)

An extra 2 cu. ft. of space to bring along plenty of food for the road.



### LG® Solid Surface Kitchen Countertop

This upgraded countertop is made of nonporous materials that reduce bacteria growth and is easy to maintain.



### Roller Shades

Allow you to control light and privacy levels at anytime.



### Shower Skylights

Usher in an abundance of natural light and provide additional headroom.



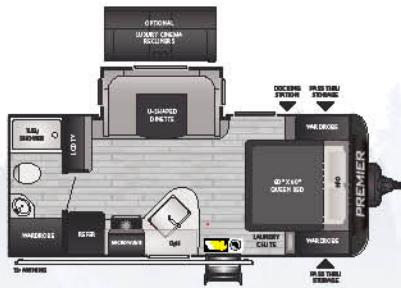

**19FBPR** | Rear bath, dinette slide

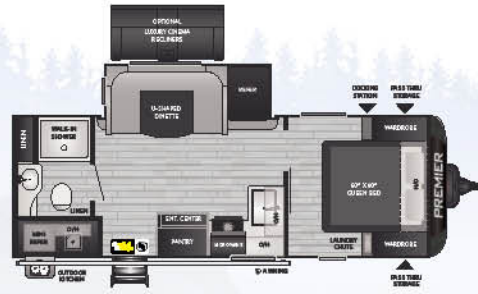

**23RBPR** | Rear bath, dinette slide, outside kitchen

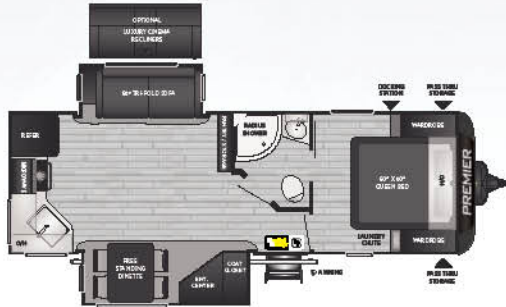

**24RKPR** | Rear kitchen, opposing slides

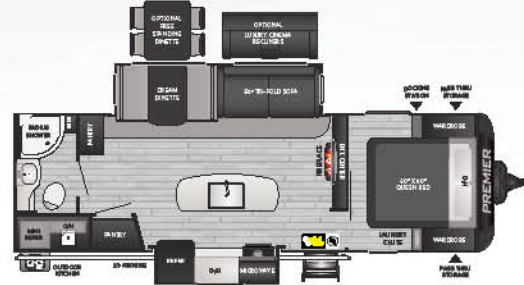

**26RBPR** | Rear bath, island kitchen, outside kitchen

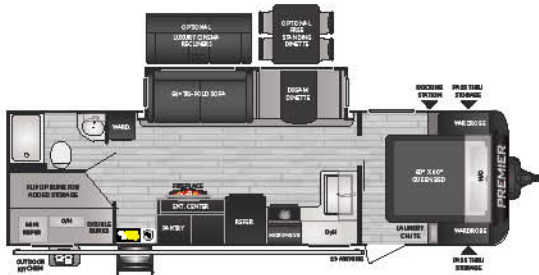

**29BHPR** | Double bunks, super slide, outside kitchen

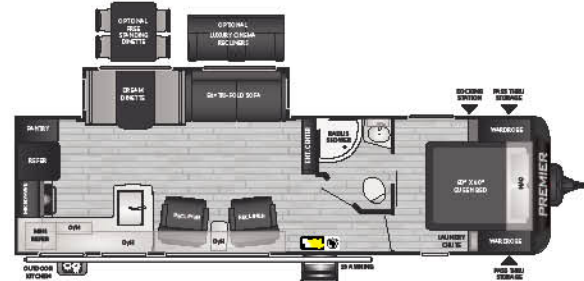

**29RKPR** | Rear kitchen, super slide, outside kitchen

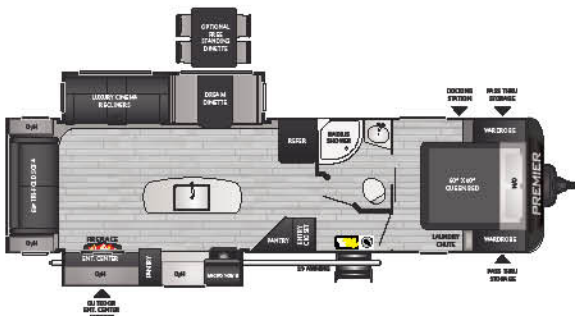

**30RIPR** | Rear living, island kitchen, outside entertainment



**34BIPR** | Bunkroom w/ slide, island kitchen, outside entertainment

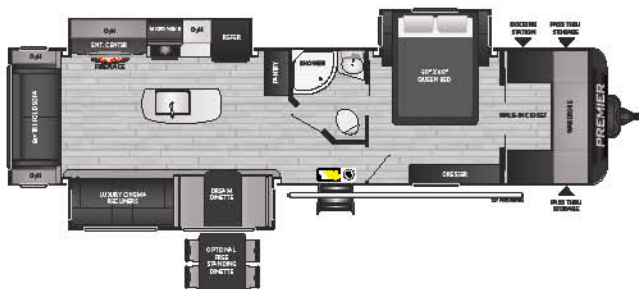

**34RIPR** | Rear living, island kitchen, bed slide

**More to come!** Be sure to check out [www.keystonerv.com/Bullet](http://www.keystonerv.com/Bullet) for more information.



## CROSSFIRE TRAVEL TRAILERS

MODEL	WEIGHT	CARRYING CAPACITY	HITCH WEIGHT	FRESH WATER	WASTE WATER	GRAY WATER	LPG	LENGTH*	WIDTH	HEIGHT	AWNING
1700BH	3377	1323	375	43	30	30	40	21' 4"	8'	10' 4"	11'
1800RB	3314	1086	480	43	30	30	40	21' 4"	8'	10' 5"	11'
1850RB	3950	750	430	43	30	30	40	22' 4"	8'	10' 10"	11'
1900RD	3477	1223	490	43	30	30	40	21' 11"	8'	10' 5"	11'
2200BH	4126	2174	425	43	30	30	40	25' 4"	8'	10' 4"	15'
2430BH	5020	1480	615	43	30	30	40	28' 3"	8'	10' 8"	19'
2500RK	TBD	TBD	TBD	43	30	60	40	29' 11"	8'	10' 8"	19'
2730BH	5475	2125	630	43	30	30	40	31' 2"	8'	10' 8"	15'

## BULLET EASTERN TRAVEL TRAILERS

MODEL	WEIGHT	CARRYING CAPACITY	HITCH WEIGHT	FRESH WATER	WASTE WATER	GRAY WATER	LPG	LENGTH*	WIDTH	HEIGHT	AWNING
221RBS	4657	1743	545	43	30	30	40	26' 8"	8'	10' 8"	15'
250BHS	5630	1770	715	43	30	60	40	29' 8"	8'	10' 8"	19'
258RKS	5491	2109	650	43	30	60	40	29' 11"	8'	10' 8"	19'
261RBS	5513	2087	600	43	30	60	40	31' 0"	8'	10' 8"	19'
287QBS	5837	1763	735	43	30	30	40	33' 10"	8'	10' 8"	15'
290BHS	5819	1781	705	43	30	60	40	33' 9"	8'	10' 8"	21'
291RLS	5954	1646	700	43	30	30	40	33' 11"	8'	10' 8"	19'
330BHS	7032	1568	800	43	60	30	40	37' 8"	8'	10' 11"	19'
331BHS	6803	2397	790	43	30	30	40	37' 6"	8'	10' 11"	21'

## PREMIER TRAVEL TRAILERS

MODEL	WEIGHT	CARRYING CAPACITY	HITCH WEIGHT	FRESH WATER	WASTE WATER	GRAY WATER	LPG	LENGTH*	WIDTH	HEIGHT	AWNING
19FBPR	4402	2098	480	43	30	30	40	24' 3"	8'	11' 0"	12'
23RBPR	5265	1735	655	43	30	60	40	27' 6"	8'	11' 0"	15'
24RKPR	5604	1896	655	43	30	60	40	29' 6"	8'	11' 0"	15'
26RBPR	6178	1322	755	43	30	60	40	32' 0"	8'	11' 0"	21'
29BHPR	6000	1600	745	43	30	60	40	33' 4"	8'	11' 1"	21'
29RKPR	6154	1446	685	43	30	60	40	34' 5"	8'	11' 1"	21'
30RIPR	6871	1329	865	43	30	60	40	35' 11"	8'	11' 2"	21'
34BIPR	7398	2002	975	43	30	30	40	38' 1"	8'	11' 4"	19'
34RIPR	7494	1906	980	43	30	60	40	38' 3"	8'	11' 4"	12'

DISCLAIMER: Product information is as accurate as possible as of the date of publication of this brochure. All features, floor plans, and specifications in this brochure are subject to change without notice. Please also consult Keystone's web site at [www.keystonerv.com](http://www.keystonerv.com) for more current product information and specifications. Tow Vehicle Disclaimer: CAUTION: Owners of Keystone recreational vehicles are solely responsible for the selection and proper use of tow vehicles. All customers should consult with a motor vehicle manufacturer or their dealer concerning the purchase and use of suitable tow vehicles for Keystone products. Keystone disclaims any liability or damages suffered as a result of the selection, operation, use or misuse of a tow vehicle. KEYSTONE'S LIMITED WARRANTY DOES NOT COVER DAMAGE TO THE RECREATIONAL VEHICLE OR THE TOW VEHICLE AS A RESULT OF THE SELECTION, OPERATION, USE OR MISUSE OF THE TOW VEHICLE. \*Length is defined as the distance from the centerline of hitch pin/coupler to rear bumper of trailer. Please review owner's manual prior to purchase for more information on service warranties, extended use, towing and maintenance. Owner's manuals can be found at [keystonerv.com](http://keystonerv.com).

### BULLET OPTIONS

- 15,000 BTU A/C (Also available on 2430BH, 2500RK, 2730BH)
- 50 AMP service w/2nd A/C prep (287QBS & up)
- 2nd 13,500 BTU A/C (287QBS & up)
- 8 cu. ft. RV refrigerator
- Theater seat IPO tri-fold sofa
- Theater seat IPO u-shaped dinette
- OTG Solar Camping Package

### PREMIER OPTIONS

- 50 AMP service w/2nd A/C prep (N/A 19FBPR, 23RBPR, 24RKPR)
- 2nd 13,500 BTU A/C (N/A 19FBPR, 23RBPR, 24RKPR)
- 8 cu. ft. RV refrigerator
- Theater seat IPO tri-fold sofa (N/A on 30RIPR and 34RIPR)
- Theater seat IPO u-shaped dinette (19FBPR, 23RBPR only)
- Table and chairs (N/A 19FBPR, 23RBPR)
- OTG Solar Camping Package



# WESTERN BULLET

CROSSFIRE, BULLET & PREMIER TRAVEL TRAILERS



**KEYSTONE**  
RV COMPANY

**LIVE IT OUT.**



# BULLET



CROSSFIRE | BULLET | PREMIER

## Bullet has the ultimate lineup for any adventure.

Bullet is the ultra-light coach with a luxurious look and feel, an abundance of practical features, innovative floorplans, and unrivaled towability at the lightest weight possible. It truly is the original luxury lightweight RV. With the request for more amenities in new floorplans, Bullet delivered once again with the Bullet Premier. Since its inception, Bullet has always been committed to listening to the customer and building what they want most. That simple approach not only built the brand into the #1 selling travel trailer in its segment, it resulted in the easiest to tow ultra-light that truly feels like home.

For more information, please visit [keystonerv.com/Bullet](http://keystonerv.com/Bullet)



# KEYSTONE EXCLUSIVE INNOVATIONS

Designed to deliver superior performance, quality, and a best-in-class camping experience, every Bullet model includes engineering innovations available EXCLUSIVELY to Keystone owners. For more information about these features and the Keystone Innovation Lab, visit us online at [www.keystonerv.com/innovations](http://www.keystonerv.com/innovations).



## HyperDeck™ High-Performance, Water-Resistant RV Floor

The HyperDeck RV floor is more resilient, stronger and lighter than traditional laminated wood construction – and it resists water and water damages.



## Blade™ High-Performance Air Flow System & Tuf-Lok™ A/C Duct Joiners

Blade™ & Tuf-Lok™ are designed to accelerate air flow, eliminate leakage and failure points, and deliver 360° circulation.



## 4G LTE and Wi-Fi Prep

All units are equipped with a new antenna that integrates 4G LTE and Wi-Fi with standard VHF/UHF/AM/FM reception.



## Tru-fit™ Slide Construction

A more durable slide room design that minimizes functional motor and structural stress and resists leaking.



## Color-Coded Unified Wiring Standard

Easy-to-trace circuits simplify electrical and entertainment system troubleshooting.



## KeyTV™

No more connection guesswork or poor reception. KeyTV offers a game-changing, single point of control of over-the-air, cable, and satellite feeds.



## 3-YEAR LIMITED STRUCTURAL WARRANTY, 1-YEAR LIMITED BASE WARRANTY

Every new Keystone RV comes with the industry's best three-year limited structural warranty AND a one-year limited base warranty. Ask your dealer, visit [keystonerv.com](http://keystonerv.com), or call Keystone Owner Relations for details.





## BULLET INTERIORS: COASTAL COTTAGE

Taking cues from east coast cottage style, gray-painted cabinetry and wall coverings are paired with weathered wood-inspired resilient flooring. Crisp white marbled countertops, glass panel doors and stainless steel fixtures and appliances complete a fresh and tranquil environment for your family.







more product detail at  
[www.keystonerv.com/Bullet](http://www.keystonerv.com/Bullet)



## CROSSFIRE COMFORT TRAVEL TRAILERS

With the addition of the 2430BH, 2500RK and 2730BH, Crossfire now offers larger floorplans and more bunkhouses for larger families. Other new and notable features include:

- One-piece Murphy bed mattress (Murphy bed models)
- Central control panel
- Sink cover for expanded counter space
- Battery disconnect
- Roof ladder backer
- Black tank flush
- Larger entry grab handle



### Electric Stabilizer Jacks

All units now come standard with electric stabilizer jacks.



### Power Tongue Jack

Work smart, not hard. Less effort and less time.



### XL Grab Handle

Provides a safe and comfortable entry.



### Stainless Steel Sink w/ Cover

Won't chip, crack, or fade.



### Central Control Panel

Light switches, awning, and more are all easily controlled in one location.



### 100% Hardwood Cabinet Doors

A modern touch that provides design versatility and durability.

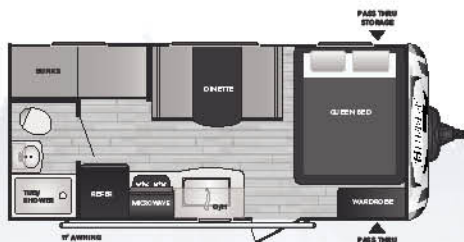

**1700BH** | Bunks, single axle



**1800RB** | Rear bath, Murphy bed, single axle



**1850RB** | Rear bath, sofa slide, single axle

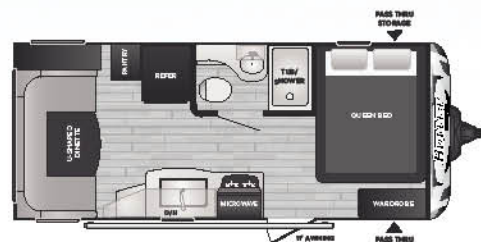

**1900RD** | Rear dinette, single axle



**2200BH** | Double bunks, Murphy bed, outside kitchen

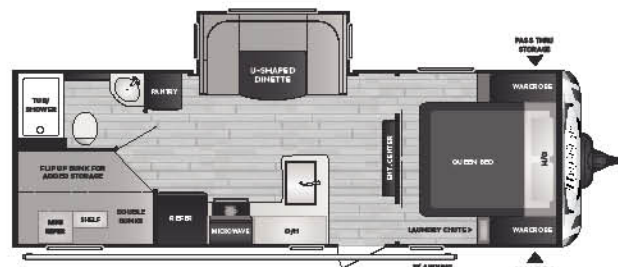

**NEW!** **2430BH** | Double bunks, dinette slide, outside kitchen

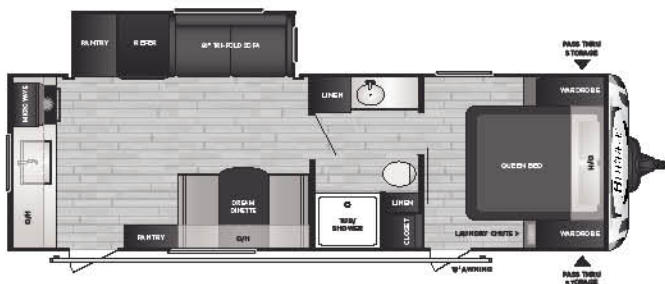

**NEW!** **2500RK** | Rear kitchen, sofa slide



**NEW!** **2730BH** | Double bunks, super slide





more product detail at  
[www.keystonerv.com/Bullet](http://www.keystonerv.com/Bullet)



## BULLET PREMIUM TRAVEL TRAILERS

Bullet travel trailers are literally raising the roof with the introduction of vaulted ceilings in all models. This more open feel is perfectly suited for campers who are taking longer, more frequent camping trips. New Zamp solar power prep and optional OTG solar power package also supports this trend. Other new and notable features include:

- Vaulted ceilings
- Seamless dinette and bathroom countertops
- Built-in spice rack
- Larger radius shower (select models)
- 10 cu. ft. 12V refrigerator and optional 8 cu. ft. RV refrigerator
- Redesigned front cap to create more usable interior space
- Zamp solar prep and optional OTG solar package
- Roof ladder
- Expanded docking station w/ water heater bypass valve, winterization valve, and antifreeze inlet makes winterization much easier



### Zamp Solar Prep and Optional "OTG" Solar Package

OTG package includes 170W solar panel (expandable up to 510W), 30 AMP solar charger, 1200W inverter, and 3 inverted outlets.



### Roof Ladder

Easy access for maintenance and cleaning.



### 51 cu. ft. Pass-Through Storage

25% more storage space and a 40% wider door mean easier access and more room for supplies.



### Vaulted Ceilings

Spacious headroom with nearly 7' in ceiling height.



### Redesigned Sofas and Theater Seating

Adds appeal, comfort, and storage to your entertainment space.



### Woven Flooring in Slideouts

This highly durable marine-grade flooring eliminates carpet and makes cleaning a breeze.

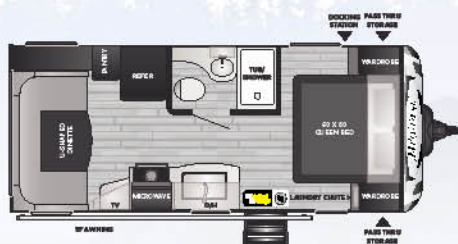

**210RUDWE** | Rear dinette, walkaround queen

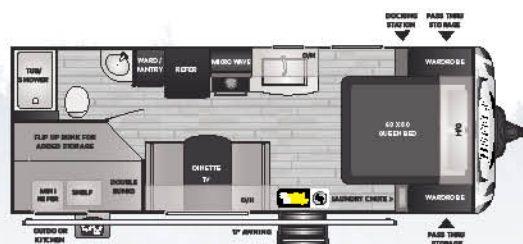

**211BHSWE** | Double bunks, walkaround queen, outside kitchen

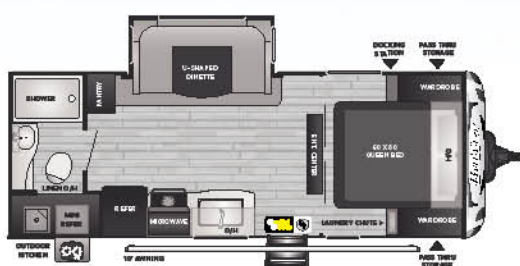

**212RBSWE** | Rear bath, dinette slide, outside kitchen

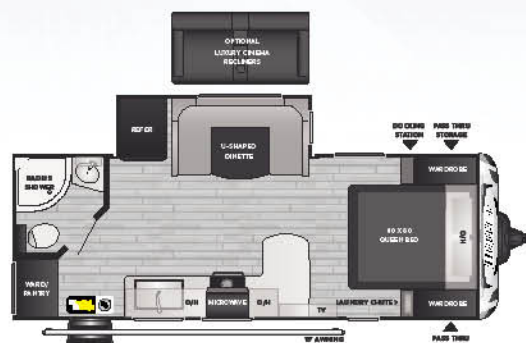

**221RBSWE** | Rear bath, dinette slide

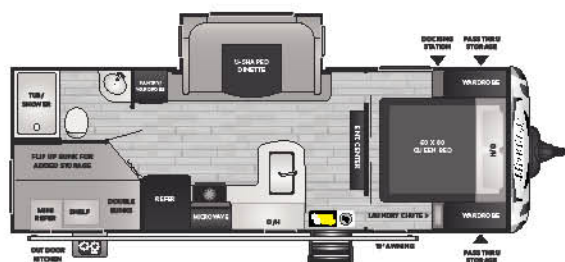

**243BHSWE** | Double bunks, dinette slide, outside kitchen

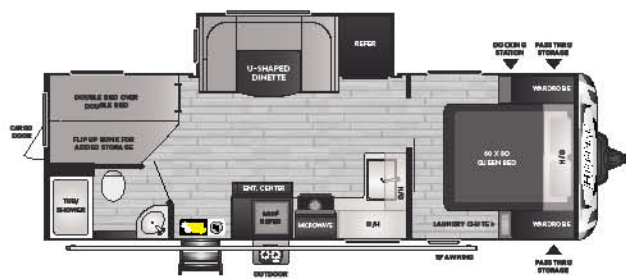

**NEW! 250BHWE** | Double bunks, dinette slide, outside kitchen

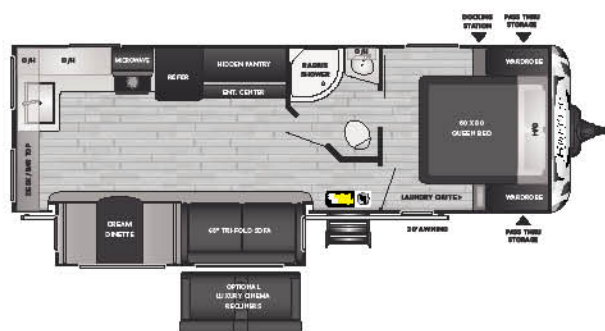

**258RKSWE** | Rear kitchen, super slide, hidden pantry

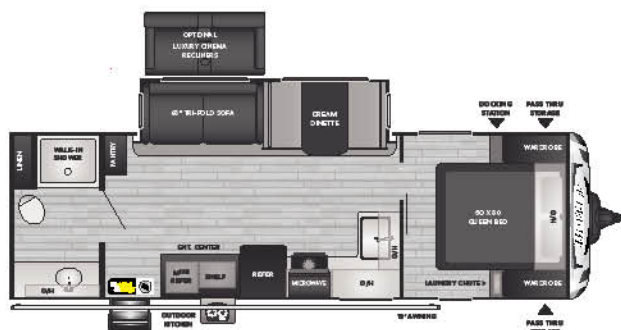

**261RBSWE** | Rear bath, super slide, outside kitchen



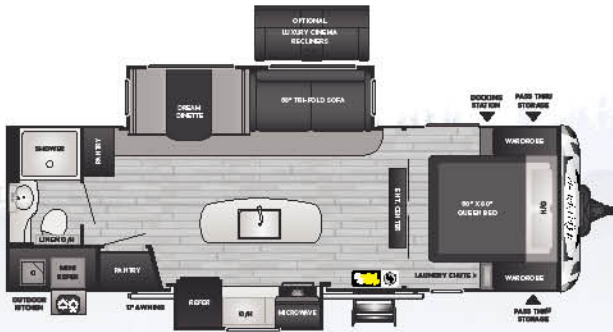

**265RBIWE** | Rear bath, island kitchen, outside kitchen

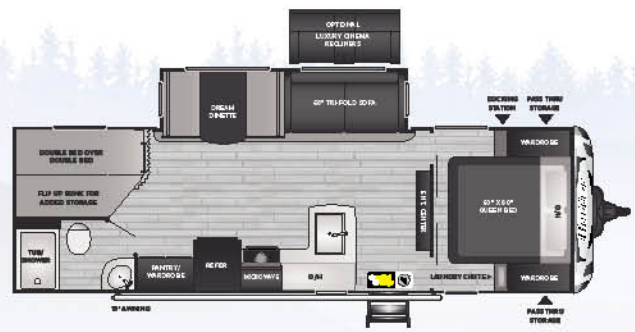

**273BHSWE** | Double bunks, super slide

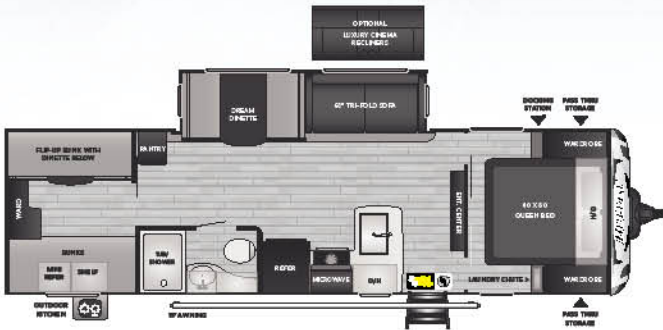

**287QBSWE** | Quad bunkroom, super slide, outside kitchen

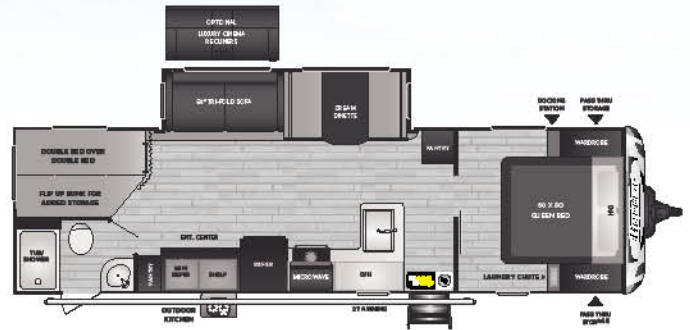

**290BHSWE** | Double bunks, super slide, outside kitchen

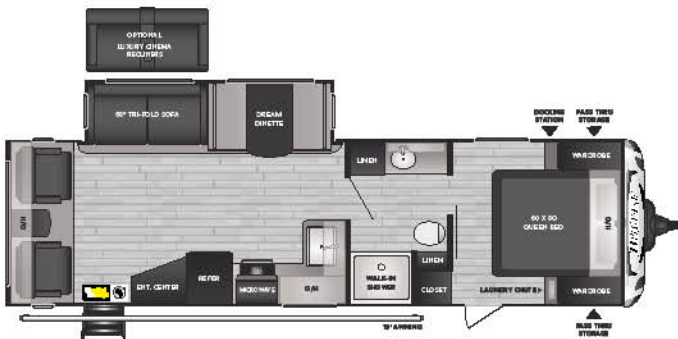

**291RLSWE** | Rear living, super slide

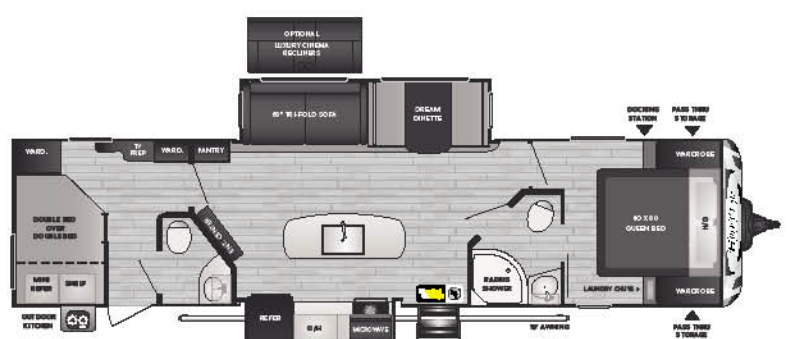

**330BHS** | Double bunks, 1 1/2 baths, island kitchen

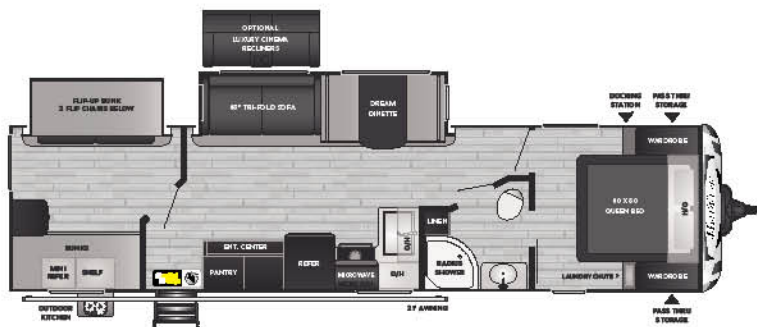

**331BHSWE** | Bunkroom w/ slide, super slide, outside kitchen

**More to come!** Be sure to check out [www.keystonerv.com/Bullet](http://www.keystonerv.com/Bullet) for more information.



more product detail at  
[www.keystonerv.com/Premier](http://www.keystonerv.com/Premier)



## PREMIER LUXURY TRAVEL TRAILERS

Luxury meets lightweight towability. Premier offers an exceptionally rich feature set including amenities like:

- Roller shades that replace pleated shades
- Seamless dinette and bathroom countertops
- Larger radius shower (select models)
- Shower skylights
- Redesigned table and chairs (optional)
- New pendant lighting fixtures (island models)
- Stainless steel roll-up sink cover in kitchen
- 10 cu. ft. 12V refrigerator and optional 8 cu. ft. RV refrigerator
- Built-in spice rack
- Under-range cookware drawer (select models)
- Roof ladder
- Redesigned front cap with protective liner to create more usable interior space
- Zamp solar prep and optional OTG solar package
- Expanded docking station w/ water heater bypass valve, winterization valve, and antifreeze inlet making winterization much easier



### Full Fiberglass Front Cap

Equipped with Line-X® rock guard to help Premier endure the rigors of the road.



### Docking Station

Easily accessible convenience center with water connections, water heater bypass, KeyTV™ hookups, stabilizer jack switches, and winterization access.



### 10 cu. ft. 12V Refrigerators (Optional 8 cu. ft. RV refrigerator)

An extra 2 cu. ft. of space to bring along plenty of food for the road.



### LG® Solid Surface Kitchen Countertop

This upgraded countertop is made of nonporous materials that reduce bacteria growth and is easy to maintain.



### Roller Shades

Allow you to control light and privacy levels at anytime.



### Shower Skylights

Usher in an abundance of natural light and provide additional headroom.



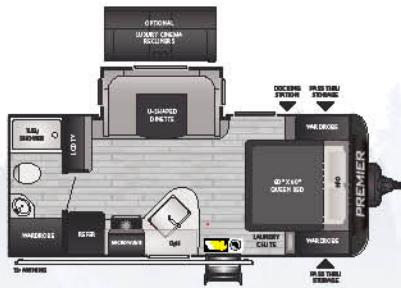

**19FBPR** | Rear bath, dinette slide

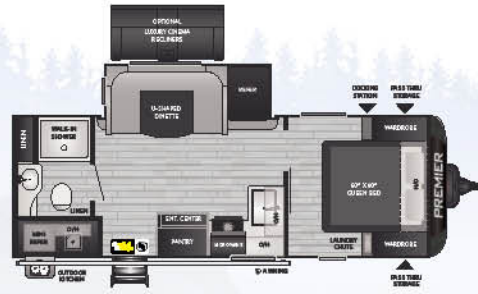

**23RBPR** | Rear bath, dinette slide, outside kitchen

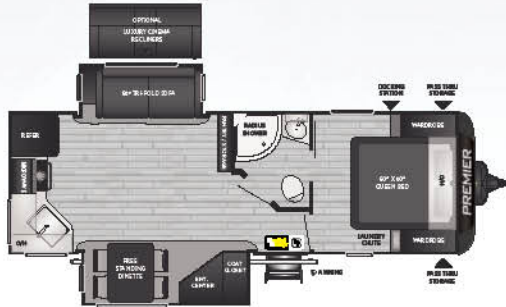

**24RKPR** | Rear kitchen, opposing slides

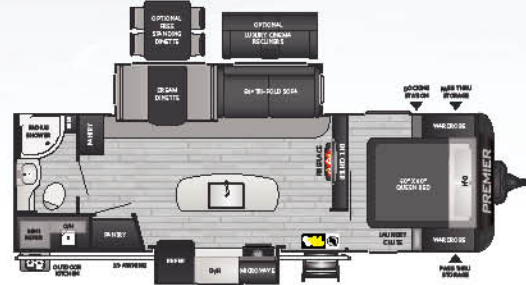

**26RBPR** | Rear bath, island kitchen, outside kitchen

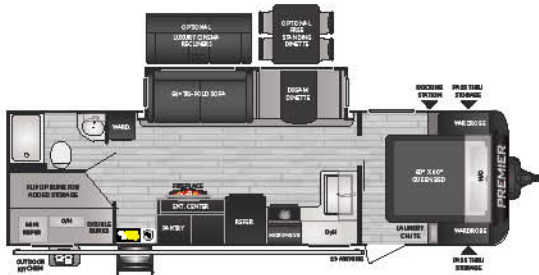

**29BHPR** | Double bunks, super slide, outside kitchen

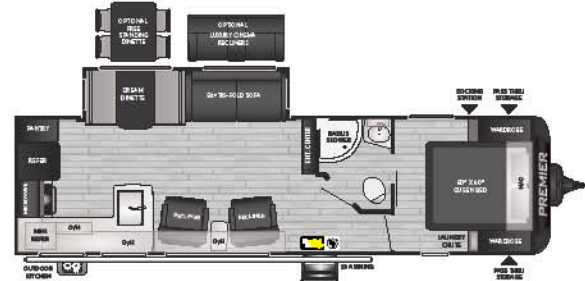

**29RKPR** | Rear kitchen, super slide, outside kitchen

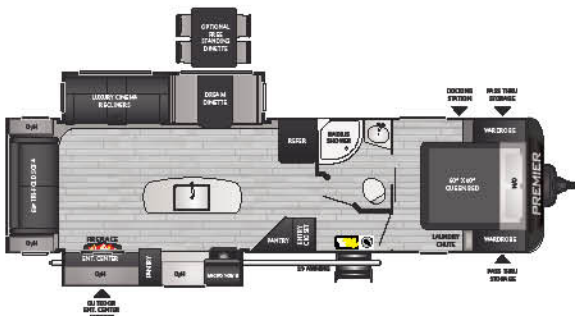

**30RIPR** | Rear living, island kitchen, outside entertainment



**34BIPR** | Bunkroom w/ slide, island kitchen, outside entertainment

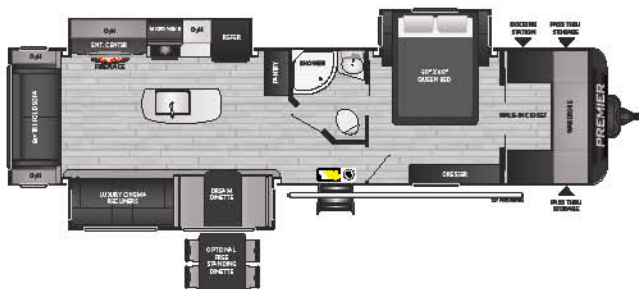

**34RIPR** | Rear living, island kitchen, bed slide

**More to come!** Be sure to check out [www.keystonerv.com/Bullet](http://www.keystonerv.com/Bullet) for more information.

## CROSSFIRE TRAVEL TRAILERS

MODEL	WEIGHT	CARRYING CAPACITY	HITCH WEIGHT	FRESH WATER	WASTE WATER	GRAY WATER	LPG	LENGTH*	WIDTH	HEIGHT	AWNING
1700BH	3377	1323	375	43	30	30	40	21' 4"	8'	10' 4"	11'
1800RB	3314	1086	480	43	30	30	40	21' 4"	8'	10' 5"	11'
1850RB	3950	750	430	43	30	30	40	22' 4"	8'	10' 10"	11'
1900RD	3477	1223	490	43	30	30	40	21' 11"	8'	10' 5"	11'
2200BH	4126	2174	425	43	30	30	40	25' 4"	8'	10' 4"	15'
2430BH	5020	1480	615	43	30	30	40	28' 3"	8'	10' 8"	19'
2500RK	TBD	TBD	TBD	43	30	60	40	29' 11"	8'	10' 8"	19'
2730BH	5475	2125	630	43	30	30	40	31' 2"	8'	10' 8"	15'

## BULLET WESTERN TRAVEL TRAILERS

MODEL	WEIGHT	CARRYING CAPACITY	HITCH WEIGHT	FRESH WATER	WASTE WATER	GRAY WATER	LPG	LENGTH*	WIDTH	HEIGHT	AWNING
210RUDWE	4286	2114	510	43	30	30	40	26' 5"	8'	10' 10"	15'
211BHSWE	4370	2030	470	43	30	30	40	26' 1"	8'	10' 9"	17'
212RBSWE	4826	1974	614	43	30	30	40	26' 6"	8'	10' 9"	10'
221RBSWE	4680	1720	490	43	30	30	40	26' 8"	8'	10' 9"	15'
243BHSWE	5082	1418	630	43	30	30	40	28' 10"	8'	10' 9"	19'
250BHSWE	TBD	TBD	TBD	43	30	60	40	29' 8"	8'	10' 8"	19'
258RKSW	5430	2170	670	43	30	60	40	29' 11"	8'	10' 10"	19'
261RBSWE	5680	1920	610	43	30	60	40	31' 0"	8'	10' 9"	19'
265RBIWE	5996	1604	600	43	30	60	40	30' 10"	8'	10' 8"	17'
273BHSWE	5498	2102	675	43	30	30	40	31' 9"	8'	10' 9"	15'
287QBSWE	5914	1686	746	43	30	30	40	33' 10"	8'	10' 8"	15'
290BHSWE	5978	1622	690	43	30	60	40	33' 9"	8'	10' 8"	21'
291RLSWE	5970	1630	690	43	30	30	40	33' 11"	8'	10' 8"	19'
330BHS	7032	1568	800	43	60	30	40	37' 8"	8'	10' 11"	19'
331BHSWE	TBD	TBD	TBD	43	30	30	40	37' 6"	8'	10' 10"	21'

## PREMIER TRAVEL TRAILERS

MODEL	WEIGHT	CARRYING CAPACITY	HITCH WEIGHT	FRESH WATER	WASTE WATER	GRAY WATER	LPG	LENGTH*	WIDTH	HEIGHT	AWNING
19FBPR	4402	2098	480	43	30	30	40	24' 3"	8'	11' 0"	12'
23RBPR	5265	1735	655	43	30	60	40	27' 6"	8'	11' 0"	15'
24RKPR	5604	1896	655	43	30	60	40	29' 6"	8'	11' 0"	15'
26RBPR	6178	1322	755	43	30	60	40	32' 0"	8'	11' 0"	21'
29BHPR	6000	1600	745	43	30	60	40	33' 4"	8'	11' 1"	21'
29RKPR	6154	1446	685	43	30	60	40	34' 5"	8'	11' 1"	21'
30RIPR	6871	1329	865	43	30	60	40	35' 11"	8'	11' 2"	21'
34BIPR	7398	2002	975	43	30	30	40	38' 1"	8'	11' 4"	19'
34RIPR	7494	1906	980	43	30	60	40	38' 3"	8'	11' 4"	12'

DISCLAIMER: Product information is as accurate as possible as of the date of publication of this brochure. All features, floor plans, and specifications in this brochure are subject to change without notice. Please also consult Keystone's web site at [www.keystonerv.com](http://www.keystonerv.com) for more current product information and specifications. Tow Vehicle Disclaimer: CAUTION: Owners of Keystone recreational vehicles are solely responsible for the selection and proper use of tow vehicles. All customers should consult with a motor vehicle manufacturer or their dealer concerning the purchase and use of suitable tow vehicles for Keystone products. Keystone disclaims any liability or damages suffered as a result of the selection, operation, use or misuse of a tow vehicle. KEYSTONE'S LIMITED WARRANTY DOES NOT COVER DAMAGE TO THE RECREATIONAL VEHICLE OR THE TOW VEHICLE AS A RESULT OF THE SELECTION, OPERATION, USE OR MISUSE OF THE TOW VEHICLE. \*Length is defined as the distance from the centerline of hitch pin/coupler to rear bumper of trailer. Please review owner's manual prior to purchase for more information on service warranties, extended use, towing and maintenance. Owner's manuals can be found at [keystonerv.com](http://keystonerv.com).

## BULLET OPTIONS

- 15,000 BTU A/C (Also available on 2430BHW, 2500RKWE, 2730BHW)
- Theater seat IPO tri-fold sofa
- Theater seat IPO u-shaped dinette (221RBSWE, 250BHSWE)
- OTG Solar Camping Package

## PREMIER OPTIONS

- 50 AMP service w/2nd A/C prep (N/A 19FBPR, 23RBPR, 24RKPR)
- 2nd 13,500 BTU A/C (N/A 19FBPR, 23RBPR, 24RKPR)
- 8 cu. ft. RV refrigerator
- Theater seat IPO tri-fold sofa (N/A on 30RIPR and 34RIPR)
- Theater seat IPO u-shaped dinette (19FBPR, 23RBPR only)
- Table and chairs (N/A 19FBPR, 23RBPR)
- OTG Solar Camping Package