





Fleetwood RV and Freightliner Custom Chassis have teamed up to bring you the ultimate in luxury, power and performance. Introducing the newly re-engineered Freedom Bridge® foundation.

Freedom Bridge foundation combines the unrivaled strength and storage capacity of Fleetwood RV's exclusive modular design with the high-performance innovation of a Freightliner chassis—all backed by the nation's largest service support network. The new Freedom Bridge® brings performance and peace of mind together, perfectly.



DriveTech rolls together FCCC's latest innovations—like the OptiView all-digital LCD dash display and FCCC's all-new ergonomic steering wheel and column-mounted controls—into one comfortable, easy-to-use driver console.



RV OWNERCARE

Limited one-year/15,000-mile coach warranty and three-year/45,000-mile structural warranty, whichever occurs first, and it is fully transferable for the first 12 months. RV OWNERCARE is one of the RV industry's most comprehensive programs and includes systems, appliances, components and construction, with no deductible and no service charge.

Chassis Warranty provided by Freightliner Custom Chassis Corporation®



**INTRODUCING DRIVETECH**—the most advanced display and control system in the RV industry. DriveTech is the first RV driving system to prioritize safety by putting every command in one easy-to-reach location. The all-new ergonomic steering wheel and column-mounted controls are paired with OptiView's all-digital gauge display to create a more automotive-like feel and set the industry standard for luxury RV driving. And it's only from Freightliner Custom Chassis.

**PRIORITIZING DRIVER SAFETY**  
A recent study reported that 80% of collisions and 65% of near collisions involved some form of driver distraction, often from using electronic devices while driving. DriveTech prioritizes driver safety by streamlining and simplifying controls to help drivers focus their full attention on maneuvering and piloting the coach.

**CONNECTING WITH RV DRIVER EXPECTATIONS**  
The world is changing. By 2021, more than 90% of cars sold will be connected—equipped with Internet access and a wireless network to share data with devices both inside and outside the vehicle. DriveTech updates the RV driver's station to align with that of the automotive industry, delivering the luxury experience modern drivers expect.



**We build strength and quality from the inside out.**

Fleetwood's exclusive Powerlock™ system is integrated into all Fleetwood RV Class A Diesel models.



At Fleetwood, we don't settle for anything less than the best and neither should you. That is why every Fleetwood features industry-leading materials and construction standards.

- 1 PowerLock System™ Interlocking Floors, Walls, Ceiling**  
Fleetwood's interlocking aluminum extrusion wall-joint system integrates floor, sidewall and roof assembly into one locked-together overall structure for long-term performance and durability.
- 2 Precision Welded Joints**  
The all aluminum hull structure is engineered and built to precise tolerances and then precision welded to ensure strength and durability on even the roughest road trip.

**At Fleetwood RV, it's not just what you see that matters. It's what you don't.**

- 3 Tuff-Coat Fiberglass Walls**  
Thicker than other manufacturers, our Tuff-Coat fiberglass walls provide a durable skin and is the perfect surface for an automotive style finish.
- 4 Thick Robust Floor**  
Thicker than the industry standard, Fleetwood engineered the floor for more sound deadening and more insulation which results in a quieter, more comfortable ride no matter the weather or terrain outside.
- 5 Solid Bead-Foam Insulation™**  
Fleetwood's above-standard insulation material and process doesn't allow settling or air gaps to form. There is no forcing the precision cut insulation into position like the roll-type pink fiberglass insulation used by other manufacturers.
- 6 Loctite® Industrial Adhesive**  
Engineered to meet bonding, sealing and assembly requirements for a durable structure with no de-lamination.
- 7 No Wood Substrate**  
Unlike most Class A motorhome manufacturers, you won't find any wood substrate on the exterior walls.
- 8 1/2" Plywood Subfloor**  
Thicker than most competitors who use OSB or chip board, the integrated 1/2" subfloor provides a solid surface for flooring and eliminates movement and flexing while traveling.

- 9 Vacu-Bond™ Construction**  
Fully sealed and weather-resistant, the vacuum-bonded assemblies combine materials and construction for a straight, solid integrated wall that is better suited to withstand the rigors of the road. An adhesive bonding process applies up to 415,000 pounds of vacuum pressure to the welded-aluminum sidewall frame, bead-foam insulation, thick Tuff-Coat fiberglass skin and inner wall materials, far exceeding industry standards.
- 10 CNC Precision Routed Walls and Floors**  
Computer driven routers precisely route walls and floors to fit exact specifications to eliminate gaps, misalignments and provide for a more solid integrated overall structure.

Each of these advantages have been engineered to deliver superior reliability, durability and most of all, customer satisfaction.





### BRINGING GROUP FUN ON THE ROAD.

Take your world everywhere it needs to go in the Pace Arrow. Starting at just 33-feet, this compact Class A diesel makes the most of the space it offers. Most of our five well-thought-out floorplans sleep seven people, and one can even accommodate eight. Don't worry about extra gear that comes with added guests—with the XCS chassis from Freightliner Custom Chassis, and up to 340HP Cummins engine, it can tow up to 10,000-pounds.

Gadgets and technology abound in the Pace Arrow. Control your whole home with the Illumplex System with touch screen and app controls. Enjoy the outdoors in comfort under the electric awning, complete with lightning and wind sensor retract. And keep everyone entertained with an exterior entertainment center, complete with a 50-inch TV and Bluetooth® soundbar. New options for 2021 include a power passenger seat with power footrest and a central vacuum system.

More stuff? More people? Pace Arrow means you don't have to compromise. Floorplans available 33D, 35QS, 35RB, 35S and 36U.





PACE ARROW 36U  
Shown in Alloy Decor with Greystone Cabinetry



PACE ARROW 35RB  
Shown in Mystic Decor with Oxford Cabinetry





**1** Facing booth dinette with Dreameasy® dinette table converted to additional sleeping space

**2** All hardwood cabinetry

**3** New Heritage painted hardwood cabinetry option adds a classic look to any decor

**4** Residential style kitchen with all the amenities of home and stylish tile backsplash

**5** Induction cooktop comes standard

**6** 33D has an electric fireplace in the master bedroom to keep you cozy at night in your queen bed, also featuring a LG 39" LED TV televisor and expansive wardrobe

**7** Designated pantry areas

**8** Accent nightlights in the 35RB offering a beautiful but practical lavvy sink



1



2



3



4



5



6



7

**1** Motion power lounge option with deep storage and cupholders available on 33D, 35RB, 35S & 36U

**2** Frosted inserts in the hand-crafted hardwood cabinetry adds to the attention to detail plus tons of storage in the galley area. Shown on 35RB with a panoramic window view

**3** Meal prep with ease with solid surface countertops and sink covers provide additional countertop space

**4** Deep storage caddy in the motion power lounge option along with additional storage in the armrests

**5** Motion power lounge upgrade makes your RV a home and allowing you to kick back and relax, stylish and comfortable

**6** Using all available space for storage. Shown in 35RB

**7** Feature wall with an electric fireplace, soundbar and 39" LED TV. Additional storage above the TV with solid surface mantel



PACE ARROW 36U  
Shown in Alloy Decor with Greystone Cabinetry





PACE ARROW 36U  
Shown in Alloy Decor with Greystone Cabinetry

**PACE ARROW**   
**INTERIOR DESIGNER RECOMMENDS:**

- Alloy Decor with Heritage or Greystone Cabinetry
- Mystic Decor with Heritage or Greystone Cabinetry
- Vapor Decor with Cappuccino or Oxford Cabinetry

*Create a customized look that reflects your personal style.*



**1** Tons of wardrobe and closet space in the 36U

**2** Vanity storage in the 36U wardrobe

**3** Master bathroom in the 36U has tons of storage and full-size fiberglass shower surround with a glass door and shower skylight

**4** 33D and 35QS has a complete wall of wardrobe storage and closet space along with full mirrors

**5** 35RB is a very unique layout with a closed stool and shower with a sink and a spacious lavy area adjoining allowing two areas with the additional sink for hygiene

**6** 33D has an electric fireplace in the master bedroom to keep you cozy at night in your queen bed, also featuring a LG 39" LED TV televotor and expansive wardrobe with mirrors

**7** Upgrade with a washer and dryer on any floorplan

EXTERIOR GRAPHICS — Premium Four Color, Full Body Paint



ADORA

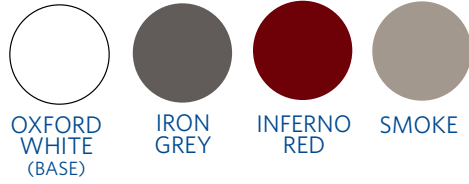

FROSTLINE

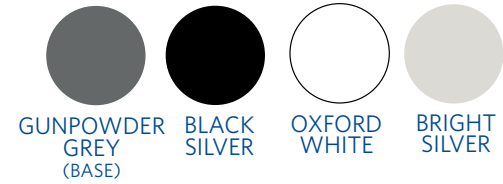

MAHOGANY



ODYSSEY

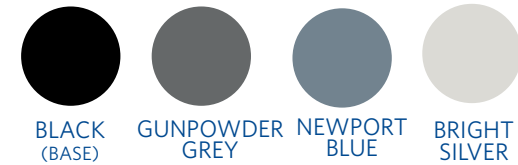

INTERIOR DECOR

ALLOY

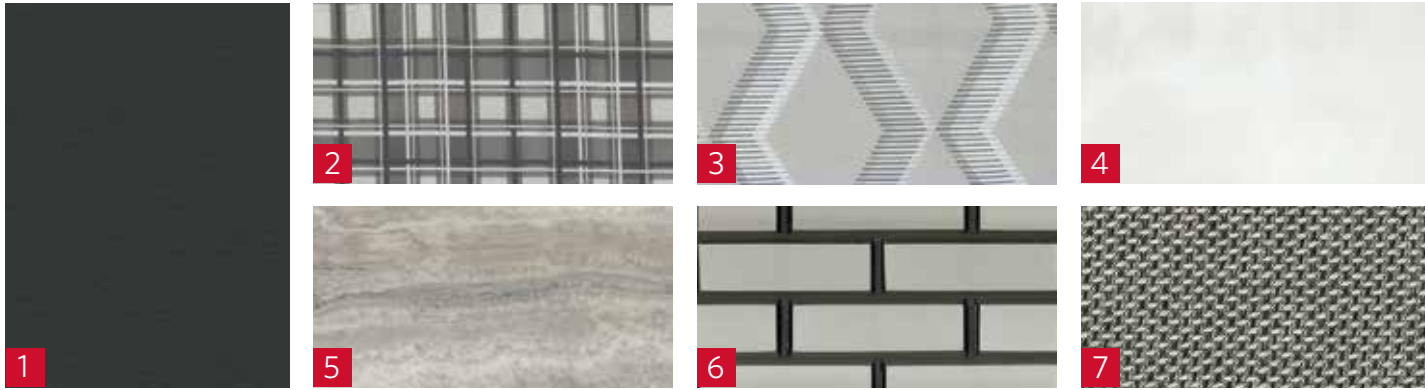

CAPPUCCINO

MYSTIC

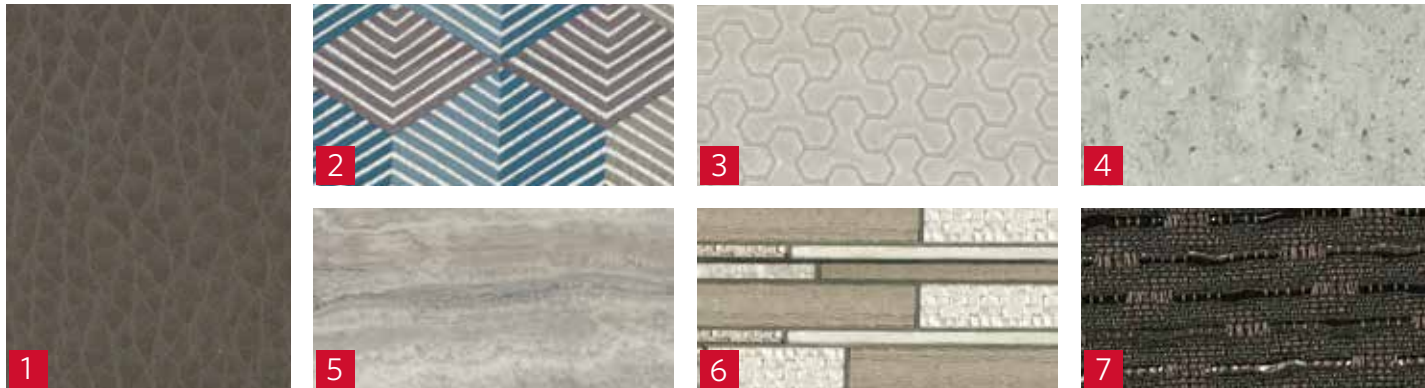

GREYSTONE

VAPOR

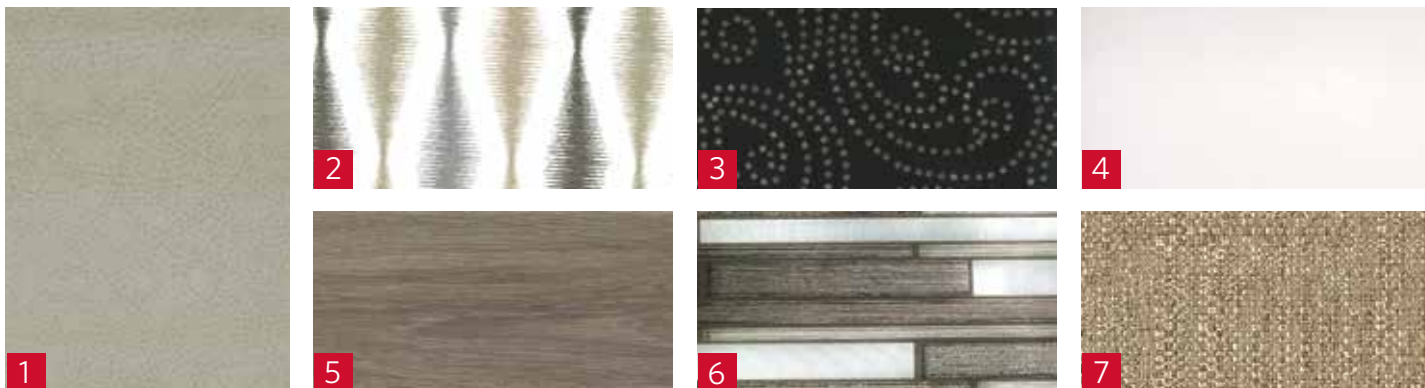

HERITAGE



OXFORD

- 1 SOFA
- 2 LIVING ACCENT
- 3 BEDSPREAD
- 4 COUNTERTOP
- 5 FLOORING
- 6 BACKPLASH
- 7 VALANCE

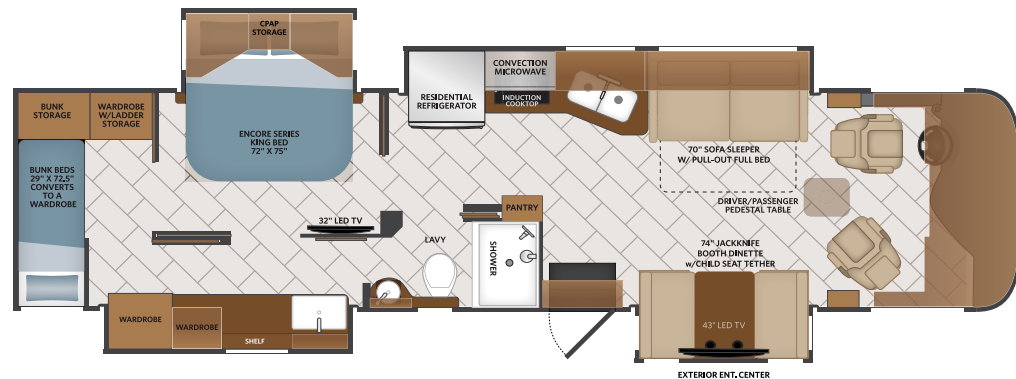
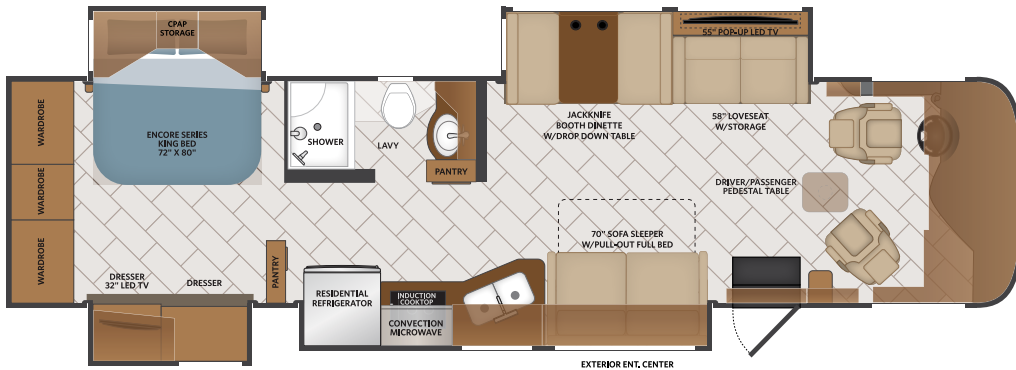
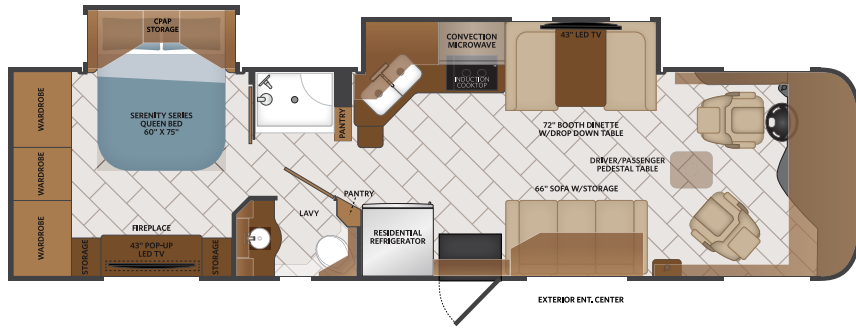

### 33D

Options: 096, 110, 126, 147, 209, 217, 563, 572, 815

#### TOP FLOORPLAN FEATURES

- Sleeps up to 5
- Family Friendly Small Footprint
- Sofa w/Footrest
- Queen Bed
- Fireplace in Bedroom
- Full-Back Wall is a Wardrobe

### 35QS

Options: 096, 110, 126, 130, 147, 211, 217, 219, 345, 563, 572, 833

#### TOP FLOORPLAN FEATURES

- Sleeps up to 7
- Room for Everyone
- Solid Surface Galley Top
- Tarkett® Flooring
- Pop-Up 55" LED TV-Living Room
- Two Dressers in the Bedroom

### 35RB

Options: 096, 110, 126, 131, 147, 209, 217, 219, 563, 572

#### TOP FLOORPLAN FEATURES

- Sleeps up to 8
- Private Bunk Area & Master Bedroom
- Articulating King Bed
- Private Bunk Beds that Convert to a Roomy Wardrobe
- Additional Large Lavy Sink in Bed Slide
- 70" Sofa Sleeper

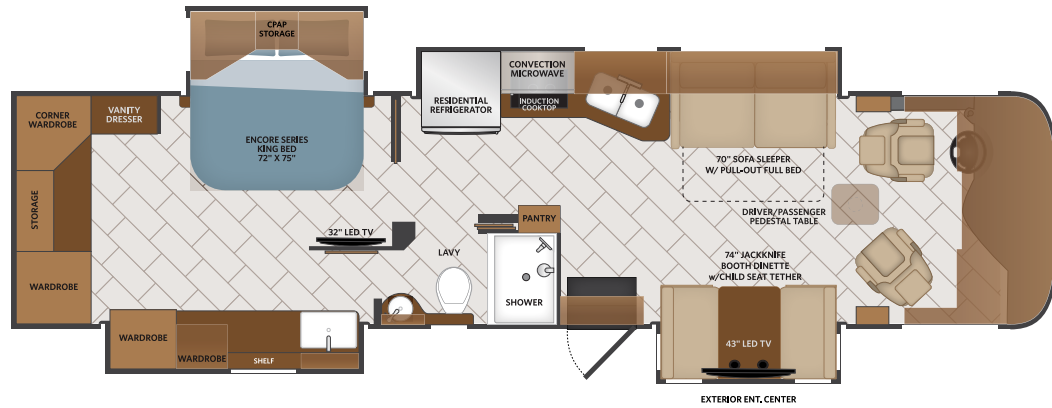

## 35S

Options: 096, 110, 126, 131, 147, 209, 217, 219, 563, 572

### TOP FLOORPLAN FEATURES

- Sleeps up to 7
- Large Master Suite
- Jackknife Dinette
- Residential Refrigerator
- C-PAP Storage in Bedroom Over Bed Cabinetry

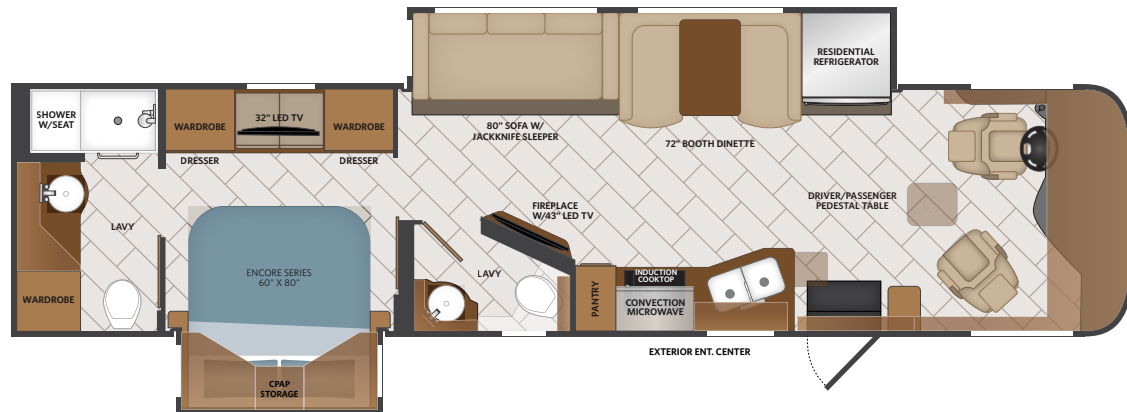

## 36U

Options: 096, 130, 147, 209, 217, 563, 572, 830

### TOP FLOORPLAN FEATURES

- Sleeps up to 7
- Bath-and-a-half
- Fireplace w/43\"/>
- Driver and Passenger Seats Swivel

### PACE ARROW OPTIONS

096	KING® Universal Satellite System	217	Hide-A-Loft™ Drop Down Queen Bed
110	Tankless Water Heater	219	Queen Bed
126	Washer/Dryer — All in One Combo	345	Mid-Ship LED TV
130	Washer/Dryer — Side-by-Side	563	Technology Package
131	Washer/Dryer — Stackable	572	Central Vacuum System
147	Dash Stereo Upgrade Kenwood®	815	Fold Away Sofa
209	Motion Power Lounge	830	Facing Dinette
211	Theater Seating System w/Opposing Foldaway Loveseat	833	Free Standing Dinette w/Credenza



OPT. 217  
HIDE-A-LOFT™  
DROP-DOWN  
QUEEN BED

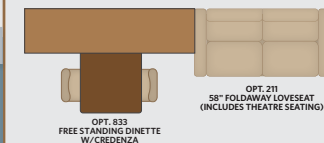

OPT. 833  
FREE STANDING  
DINETTE  
W/CREDEZZA

OPT. 211  
58\"/>



OPT. 345  
49\"/>

OPT. 830  
FACING  
DINETTE

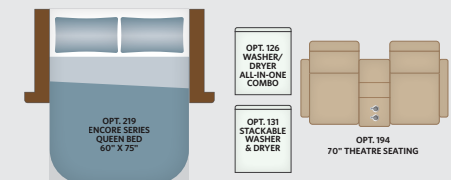

OPT. 219  
ENCORE SERIES  
QUEEN BED  
60\"/>

OPT. 126  
WASHER/  
DRYER  
ALL-IN-ONE  
COMBO

OPT. 131  
STACKABLE  
WASHER  
& DRYER

OPT. 194  
70\"/>

OPT. 130  
SIDE-BY-SIDE  
WASHER  
& DRYER

# PACE ARROW

EXTERIOR	33D	35QS	35RB	35S	36U
Aerodynamic Fiberglass Cap with Automotive-Style Headlights	S	S	S	S	S
Hood Insert and Seamless Mounting	S	S	S	S	S
Rear Fiberglass Cap with Fiberglass Rear Engine Access, Automotive-Style Lighting and Grill	S	S	S	S	S
Fiberglass Wheel Well Trims	S	S	S	S	S
TPO Roof	S	S	S	S	S
4-Color Premier Full-Body Paint w/ Front Clear Mask	S	S	S	S	S
Electric Patio Awning w/LED Lighting and Wind Sensor Retract	S	S	S	S	S
Slideout Awning Toppers above all Slideouts	S	S	S	S	S
Radius Door w/Screendoor, Latch, Deadbolt Lock, and Frameless Window	S	S	S	S	S
Acrylic Grab Handle at Entry Door	S	S	S	S	S
Exterior Power Entry-Step	S	S	S	S	S
Side-Swing Aluminum Bus-Style Baggage Doors	S	S	S	S	S
Large Dark-Tinted Frameless Windows	S	S	S	S	S
LED Patio Light	S	S	S	S	S
LED Clearance and Marker Lighting at Front, Side, and Rear	S	S	S	S	S
Exterior Service Station w/Water Pump Switch, Exterior Shower, Black Tank Flush, City Water Hookup, Towel Holder, and Drainage Valves	S	S	S	S	S
Exterior Park Cable and Satellite Hook-Up	S	S	S	S	S
Hitch: 10,000 lb. Capacity w/7-Way Round Tow Connection	S	S	S	S	S
Underhood Utility Light	S	S	S	S	S
Unidirectional KING® Controls Jack Antenna	S	S	S	S	S
Battery Disconnect	S	S	S	S	S
Metal Interior Grab Handle at Entry Door	S	S	S	S	S
Automatic Leveling Jacks Control	S	S	S	S	S
Entry Door w/ Manual Roller Shade	S	S	S	S	S

Satellite Ready	S	S	S	S	S
KING® Satellite to the Universal Satellite w/o Receivers	O	O	O	O	O
Roof Vent Rain Covers	S	S	S	S	S
Solar Panel Prep	S	S	S	S	S
<b>CAB EXTERIOR</b>	<b>33D</b>	<b>35QS</b>	<b>35RB</b>	<b>35S</b>	<b>36U</b>
Automotive-Style One-Piece Windshield	S	S	S	S	S
Daytime Running Lights	S	S	S	S	S
Remote Power and Heated Mirrors w/ Turn Signals and Side Cameras, Black	S	S	S	S	S
Tinted Frameless Slider Driver and Passenger Windows	S	S	S	S	S
Fog Lamps	S	S	S	S	S
Automotive-Style Windshield Wiper System	S	S	S	S	S
<b>CAB INTERIOR</b>	<b>33D</b>	<b>35QS</b>	<b>35RB</b>	<b>35S</b>	<b>36U</b>
Black Instrument Gauges w/ Electronic Information Center	S	S	S	S	S
High-Output Dash Air Conditioning and Heat	S	S	S	S	S
Air Suspension Deflation System	S	S	S	S	S
Electronic Cruise Control	S	S	S	S	S
Windshield Wipers w/Delay	S	S	S	S	S
Switch for Power/Heated Mirrors	S	S	S	S	S
Steering Wheel w/Tilt and Telescoping Column	S	S	S	S	S
Driver Console w/Lower Storage Bin	S	S	S	S	S
6" MobileVision® Color Monitor for Side and Rear Cameras	S	S	S	S	S
Pioneer® Touch Screen Radio w/ AM/FM/CD/DVD/Bluetooth®	S	S	S	S	S
SiriusXM® Satellite Radio Ready (Requires Subscription)	S	S	S	S	S
USB and Auxiliary Inputs	S	S	S	S	S
Driver Chair w/Reclining Back, Swivel, and 6-Way Power Controls	S	S	S	S	S
Passenger Chair w/Reclining Back, Swivel, and Footrest	S	S	S	S	S
3-Point Driver and Passenger Seatbelts w/Adjustable Straps	S	S	S	S	S
12V Accessory Ports	S	S	S	S	S
110V AC Outlet at Dash and Passenger Area	S	S	S	S	S

Automotive-Style Wrap-Around Dash	S	S	S	S	S
Passenger Armrest	S	S	S	S	S
Driver and Passenger Cupholders	S	S	S	S	S
Front Power Roller Shade	S	S	S	S	S
Driver and Passenger Pedestal Table	S	S	S	S	S
Privacy Curtains for Driver and Passenger Windows	S	S	S	S	S
Radio Switch Auxiliary Power at Dash	S	S	S	S	S
Generator On/Off Switch	S	S	S	S	S
Battery Booster Switch	S	S	S	S	S
Premium Stereo Upgrade, Kenwood®	O	O	O	O	O
<b>INTERIOR</b>	<b>33D</b>	<b>35QS</b>	<b>35RB</b>	<b>35S</b>	<b>36U</b>
66" Loveseat w/Storage	S	—	—	—	—
80" Jackknife Sofa w/Footrests	—	—	—	—	S
58" Loveseat w/Storage	—	S	—	—	—
70" Sofa Sleep w/Full-Sized Bed	—	S	S	S	—
66" Sofa Rest Assured w/ Detachable Arms	O	—	—	—	—
Sofa: Theater Seating w/Foldout Loveseat	—	O	—	—	—
Sofa: Theater Seating w/70" Motion Power Lounger	—	O	—	—	—
66" Motion Power Lounger	O	—	—	—	—
70" Motion Power Lounger	—	—	O	O	—
80" Motion Power Lounger	—	—	—	—	O
Booth Dinette	S	—	—	—	S
Surf(x)® Dinette Tops	S	S	S	S	S
Jackknife Facing Dinette	—	S	S	S	O
Drop-Down Queen-Sized Bed	O	O	O	O	O
Electric Fireplace	S	—	—	—	S
Interior Flat Soft-Touch Vinyl Ceiling	S	S	S	S	S
Composite Tile Flooring	S	S	S	S	S
Composite Tile Flooring in Slideout	S	S	S	S	—
Hidden Cabinet Door Hinges Throughout	S	S	S	S	S
Solid Wood Raised-Panel Cabinet Doors: Upper and Lower	S	S	S	S	S
Solid Wood Drawer Fronts	S	S	S	S	S

Fabric Valances	S	S	S	S	S
Solid Wood Slideout Trims	S	S	S	S	S
Manual Day/Night Roller Shades	S	S	S	S	S
Energy-Efficient LED 3" Puck Flush-Mounted Ceiling and Under Cabinet Lighting	S	S	S	S	S
<b>INTERIOR ENTRY</b>	<b>33D</b>	<b>35QS</b>	<b>35RB</b>	<b>35S</b>	<b>36U</b>
30" Wide Entry Door	S	S	S	S	S
Entry Step w/LED Accent Lighting	S	S	S	S	S
Battery Disconnect	S	S	S	S	S
Metal Interior Grab Handle at Entry Door	S	S	S	S	S
<b>KITCHEN</b>	<b>33D</b>	<b>35QS</b>	<b>35RB</b>	<b>35S</b>	<b>36U</b>
Refrigerator: 18.7 cu.ft. Residential w/ Bottom Freezer, Stainless Steel	—	S	S	S	S
Refrigerator: 19 cu.ft. Residential, Stainless Steel	S	—	—	—	—
2-Burner Recessed Induction Cooktop	S	S	S	S	S
Stainless Steel Over-the-Range Convection Microwave	S	S	S	S	S
Solid-Surface Galley Countertop	S	S	S	S	S
Tile Backsplash	S	S	—	—	S
Shadow Box Glass Tile Backsplash w/Window and Shade	—	—	S	S	—
Sink: Stainless Steel, Deep Double Bowl, Undermount	S	S	S	S	S
Polished Solid-Surface Sink Covers	S	S	S	S	S
Residential Single-Handled Faucet w/Pull-Out Sprayer	S	S	S	S	S
Adjustable Shelves Throughout	S	S	S	S	S
Full-Extension Drawer Guides w/Latches	S	S	S	S	S
Fan-Tastic® Power Vent w/Wall Switch	S	S	S	S	S
Wastebasket	S	S	S	S	S
<b>BEDROOM OR BUNK AREA</b>	<b>33D</b>	<b>35QS</b>	<b>35RB</b>	<b>35S</b>	<b>36U</b>
Queen-Sized Bed: Serenity Memory Foam Mattress	S	O	—	—	—
King-Sized Dreameasy Serenity Memory Foam Mattress w/ Adjustable Head	—	S	—	—	S

Queen-Sized Dreameasy Serenity Memory Foam Mattress w/Adjustable Head	—	O	S	S	—
Bunk Beds	—	—	S	—	—
Designer Bedspread/Pillows w/Shams	S	S	S	S	S
Coordinating Fabric Window Treatments and Lambrequins	S	S	S	S	S
Surf(x)® Nightstand Tops	S	S	S	S	S
Solid Wood Nightstand Tops	—	S	—	—	—
Electric Fireplace	S	—	—	—	—
Inline Washer and Dryer	—	O	O	O	—
Side-by-Side Washer and Dryer	—	—	—	—	O
Combo Washer and Dryer	O	O	O	O	—
C-PAP Prep in Bedroom Overhead	S	S	S	S	S
<b>BATHROOM</b>	<b>33D</b>	<b>35QS</b>	<b>35RB</b>	<b>35S</b>	<b>36U</b>
Surf(x)® Countertop and Backsplash in Bathroom	S	S	S	S	S
Residential Brushed-Nickel Double-Handled Faucet	S	S	S	S	S
Deluxe Hardwood Medicine Cabinet w/Mirror	S	S	S	S	S
Fiberglass Shower Surround	S	S	S	S	S
Glass Shower Door	S	S	S	S	S
Shower Skylight	S	S	S	S	S
Metal Shower Head w/Sliding Adjustable Bar, Soap Dish, and Matching Single-Valve Faucet	S	S	S	S	S
Macerator Toilet	S	—	S	S	S
Porcelain Standard Toilet	—	S	—	—	—
Fan-Tastic® Power Vent w/Wall Switch	S	S	S	S	S
Towel Ring(s)	S	S	S	S	S
<b>ENTERTAINMENT</b>	<b>33D</b>	<b>35QS</b>	<b>35RB</b>	<b>35S</b>	<b>36U</b>
LG® 32" LED TV (Bedroom)	S	S	S	S	S
LG 39" LED TV (Living Area)	S	S	S	S	S
LG 50" LED TV (Living Area - Televator)	—	S	—	—	—
LG 39" LED TV (Bedroom Area - Televator)	S	—	—	—	—
HDMI Video Distribution	S	S	S	S	S
Bluetooth® Soundbar	S	S	S	S	S

Exterior Entertainment Center: 50" LED TV and Bluetooth® Soundbar	S	S	S	S	S
<b>ELECTRIC AND UTILITIES</b>	<b>33D</b>	<b>35QS</b>	<b>35RB</b>	<b>35S</b>	<b>36U</b>
Technology Package: WiFiRanger™ SkyPro w/LTE and GPS, Cell Booster, 265W Solar Panel, Upgraded Kenwood® Radio, and Mobile Eye Collision Mitigation Camera	O	O	O	O	O
Dual Roof-Mounted High-Efficiency Ducted 15,000-BTU AC Units w/ Chill Grill and Rear Heat Pump	S	S	S	S	S
25,000/20,000 BTU Furnace	S	—	—	—	—
30,000/20,000 BTU Furnace	—	S	S	S	S
Service: 50-amp	S	S	S	S	S
Converter: 60 AMP Power Converter	S	S	S	S	S
Inverter: Single 2000W Pure Sine	S	S	S	S	S
Neutral Loss Protection	S	S	S	S	S
Generator: 6kW Onan Quiet Diesel	S	S	S	S	S
Automatic Generator Start	S	S	S	S	S
(4) 6V Auxillary Batteries	S	S	S	S	S
Master Battery Disconnect Switch	S	S	S	S	S
Water Pump: 12V 3GPM High-Capacity Shurflo Water Pump	S	S	S	S	S
Water Purification System (Whole Coach)	S	S	S	S	S
Exterior Shower	S	S	S	S	S
Cable TV and Satellite Hook-Up	S	S	S	S	S
Toilet Tank San-T-Flush™ System	S	S	S	S	S
Multiplex Wiring Control System w/Touch Screen and App Control	S	S	S	S	S
LP, Carbon Monoxide, and Smoke Detector Combo, Fire Extinguisher	S	S	S	S	S
Exterior GFCI Receptacle in Exterior Storage	S	S	S	S	S
Central Vacuum System	O	O	O	O	O
Solar Prep on Roof	S	S	S	S	S



Subscribe to our YouTube channel  
 Fleetwood RV  
 See our factory tour videos





## PACE ARROW — OUTSTANDING STANDARDS AND OPTIONS



### COOL OR WARM ADVENTURS? WE HAVE YOU COVERED

Dual-roof mounted high efficiency ducted 15,000-BTU AC Units with chill and grill and rear heat pump is standard.

33D- 25,000/20,000 BTU furnace  
35QS/35RB/35S/36U -30,000/20,000 BTU furnace.



### C-PAP READY

This convenient storage solution is specifically designed to organize and conceal C-PAP machines while allowing for easy access and opening for hoses.



### TOUCH PAD ELECTRONICS PANEL

Easily operate your RV's systems and accessories with this modern LCD touchscreen control panel and app control.



### AUTOMOTIVE-INSPIRED DASH

Drive in comfort with an LCD digital dash that can be controlled from the integrated steering wheel, electronic cruise control, auto headlights, steering wheel tilt and telescoping column. Pioneer® touch screen stereo with AM/FM/CD/DVD/Bluetooth® is standard with an upgrade option to a Kenwood®. The Kenwood stereo system is an automatic upgrade with the technology package option.



### HIGH-END APPLIANCES

All the comforts of home with high-end residential appliances including a refrigerator/freezer and stainless steel over the range convection microwave. A two-burner recessed induction cooktop with polished solid surface covers. A deep double bowl undermount stainless steel sink with residential single-handled faucet with pull-out sprayer and polished solid-surface sink covers. Electric fireplace is available on the 33D and 36U floorplans.

All Pace Arrows may upgrade to a central vacuum system for convenience.



### ON-DEMAND WATER HEATER

Provides continuous hot water. A much more efficient alternative to traditional tank style water heaters. Optional upgrade.



### POWER CONTROLLED COCKPIT SEATING

Driver cockpit seating is reclining back, swivel plus 6-way power controls. Passenger seating is reclining back, swivel and footrest! Expand your seating and entertaining options with the standard pedestal table between the cockpit chairs. So many options!



### HIDE-A-LOFT™ DROP DOWN QUEEN BED

Invite more guests on your road trip without compromising space featuring industry-leading headroom and up to 600lb. capacity. Optional upgrade.



### PACE ARROW 35RB BUNK BEDS/ WARDROBE SPACE SAVING

Plenty of room for more guests on your road trip without compromising space. The Pace Arrow 35RB offers bunk beds with a dual purpose so when not in use, just flip the bunk for additional wardrobe/storage space.



**50-INCH EXTERIOR LED TV & SOUNDBAR**  
This feature adds an extra outdoor TV room with a 50-inch LED TV and exterior soundbar with Bluetooth®.

## PACE ARROW SPECIFICATIONS

CHASSIS	33D	35RB	35QS	35S	36U
Wheelbase (inches)	208"	252"	252"	252"	252"
Front GAWR (lbs)	10,500	10,500	10,500	10,500	10,500
Rear GAWR (lbs)	17,500	19,000	19,000	19,000	19,000
GCWR (lbs)	30,000	33,000	33,000	33,000	33,000
Hitch Rating Weight (lbs)	10,000	10,000	10,000	10,000	10,000
Tongue Weight (lbs)	1,000	1,000	1,000	1,000	1,000
Fuel Capacity (gal)	90	90	90	90	90

DIMENSIONS AND CAPACITIES	33D	35RB	35QS	35S	36U
Overall Length (inches)	33' 11"	37' 7"	37' 7"	37' 7"	37' 7"
Overall Height (with A/C)	12' 2"	12' 2"	12' 2"	12' 2"	12' 2"
Overall Width (maximum)	102"	102"	102"	102"	102"
Interior Height (maximum)	84"	84"	84"	84"	84"
Interior Width (maximum)	96"	96"	96"	96"	96"
Patio Awning Width (ft.)	17' 0"	16' 0"	14' 0"	16' 0"	17' 0"
Second Patio Awning Width (ft./in.)	NA	11' 0"	NA	11' 0"	NA
Exterior Storage (cu. ft.)	133	164	112	164	164
Interior Storage (cu. ft.)	140	164	144	164	164
Fresh Water Holding Tank (gal)	77	100	100	100	77
Grey Water Holding Tank (gal)	60	52	60	52	60
Black Water Holding Tank (gal)	32	40	32	40	32
Appliance Propane Tank (gal)	28.6	28.6	28.6	28.6	28.6
Water Heater Tank (gal)	6	6	6	6	6

Product information, photography, illustrations included in this publication were as accurate as possible at the time of printing.

## FREEDOM BRIDGE® CHASSIS

33D — 300HP

Model: Freightliner® XCS Series

Engine: Cummins ISB 6.7L

Transmission: Allison® 2,100 MH 6-Speed w/Electronic Shifter

Alternator: Delcom Remy 160 Amp

Torque: 660 lb.-ft. @ 1,600 RPM

Horsepower: 300HP

35RB, 35S, 35QS, 36U — 340HP

Model: Freightliner® XCS Series

Engine: Cummins ISB 6.7L

Transmission: Allison® 2,500 MH 6-Speed w/Electronic Shifter

Alternator: Delcom Remy 160 Amp

Torque: 700 lb.-ft. @ 1,600 RPM

Horsepower: 340HP



### DISCLAIMERS

1. GVWR (Gross Vehicle Weight Rating) is the maximum permissible weight of this fully loaded motorhome. The GVWR is equal to or greater than the sum of the (UVW) unloaded vehicle weight plus the (OCCC) occupant cargo-carrying capacity.

2. GAWR (Gross Axle Weight Rating) is the maximum permissible loaded weight a specific axle is designed to carry.

3. GCWR (Gross Combined Weight Rating) is the value specified by the motor home manufacturer as the maximum allowable loaded weight of this motorhome with its towed vehicle. Towing and braking capacities may be different. Refer to Fleetwood and chassis manufacturer's manuals for complete information.

4. Length measured from front bumper to rear bumper (excludes accessories).

5. Excludes safety equipment and awnings.

6. Motorhomes feature a body width over 96" which will restrict your access to certain roads. Before purchasing, you should research any state and/or province road laws which may affect your usage.

7. Tank manufacturer's listed water capacity (WC). Actual propane capacity is 80% of water listing as required by the safety code.

† The chassis manufacturer recommends the installation of a supplemental brake control system to activate the brakes on the vehicle or trailer you are towing. Hitch receiver ratings expressed are maximum for the hitch receiver installed and may require the purchase of additional equipment that is dependent on the weight of the towed load. Consult with hitch receiver manufacturer for further information.

\* UVW and OCCC are found on the label containing the federal certification tag in each RV.

\*\*\* All 2021 REV Recreation Group motorhomes include a limited one year/15,000-mile coach warranty and three-year/45,000-mile structural warranty, whichever occurs first, and is fully transferable for the first 12 months.

### FLEETWOOD MOTORHOME ASSOCIATION

As a Fleetwood RV owner, you're invited to become a member of the Fleetwood Motorhome Association (FMA).

Becoming a member is the perfect way to meet other Fleetwood owners who love to travel across America and share in the RV lifestyle. Visit the FMA website at [www.fma4fun.org](http://www.fma4fun.org) to learn more and join the fun.

### CONTACT US

To locate a dealer near you, visit our website at [www.fleetwoodrv.com](http://www.fleetwoodrv.com) or call 1-800-322-8216.

We can also be contacted at Fleetwood RV Customer Relations, P.O. Box 1007, Decatur, IN 46733.

**IMPORTANT—PLEASE READ:** Product information, photography and illustrations included in this publication were as accurate as possible at the time of printing. For further product information and changes, please visit our website at [www.fleetwoodrv.com](http://www.fleetwoodrv.com) or contact your local Fleetwood RV dealer. Prices, materials, design and specifications are subject to change without notice. All weights, fuel, liquid capacities and dimensions are approximate. Fleetwood RV has designed its recreational vehicles to provide a variety of uses for its customers. Each vehicle features optimal seating, sleeping, storage and fluid capacities. The user is responsible for selecting the proper combination of loads (i.e., occupants, equipment, fluids, cargo, etc.) to ensure that the vehicle's capacities are not exceeded.

YOUR LOCAL DEALER

Explore Your World Like Never Before



About REV Group, Inc.



REV Group® (REVG) is a leading designer, manufacturer, and distributor of specialty vehicles and related aftermarket parts and services. We serve a diversified customer base, primarily in the United States, through three segments: Fire & Emergency, Commercial, and Recreation. We provide customized vehicle solutions for applications, including essential needs for public services (ambulances, fire apparatus, school buses, and transit buses), commercial infrastructure (terminal trucks and industrial sweepers) and consumer leisure (recreational vehicles). Our diverse portfolio is made up of well-established principal vehicle brands, including many of the most recognizable names within their industry. Several of our brands pioneered their specialty vehicle product categories and date back more than 50 years. REV Group trades on the NYSE under the symbol REVG. Investors-REVG

IMPORTANT—PLEASE READ: Product information, photography and illustrations included in this publication were as accurate as possible at the time of printing. For further product information and changes, please visit our website at [www.fleetwoodrv.com](http://www.fleetwoodrv.com) or contact your local Fleetwood RV dealer. Prices, materials, design and specifications are subject to change without notice. All weights, fuel, liquid capacities and dimensions are approximate. Fleetwood RV has designed its recreational vehicles to provide a variety of uses for its customers. Each vehicle features optimal seating, sleeping, storage and fluid capacities. The user is responsible for selecting the proper combination of loads (i.e., occupants, equipment, fluids, cargo, etc.) to ensure that the vehicle's capacities are not exceeded.

**FleetwoodRV.com**

©2020 REV Group, Inc. Printed in the USA. 11/20. Model Year 2021, First Edition.

Part #: L93-0022-21



### OUR VERY OWN FLEETWOOD RV MOTORHOME SERVICE CENTERS

At Fleetwood RV, we strive to deliver peace-of-mind at every turn. Our devotion to customer service starts with our trusted dealer network and spans to our own staff of motorhome service professionals at REV Recreation Group's regional technical centers. The motorhome service centers are strategically located throughout the United States to provide you convenient service wherever the road takes you.

Below, you'll find the closest motorhome service center, as well as a list of the other centers. Please visit [www.fleetwoodrv.com/motorhome-service-centers](http://www.fleetwoodrv.com/motorhome-service-centers) to schedule a Service Appointment.

#### East Coast

REV RV SERVICE & REPAIR  
800-509-3417

#### West Coast

REV RV SERVICE & REPAIR  
877-466-6226

### ROADSIDE ASSISTANCE. ANYWHERE. ANYTIME.

24/7 CUSTOMER SUPPORT FOR:

- FUEL
- BATTERY
- LOCKSMITH
- TOWING
- SLIDE-OUT ISSUES
- AND MUCH MORE!

**1-855-268-0414**



One-year of REV Assist is free with the purchase of any new 2021 Fleetwood. You may extend your coverage after the first year at [www.revgroup.com/rev-assist](http://www.revgroup.com/rev-assist).