



Highland RIDGE RV

Own the Outdoors



2021 FIFTH WHEELS

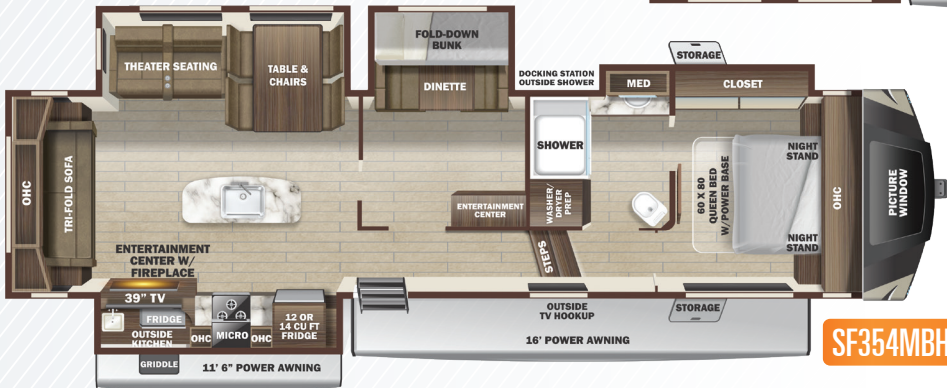
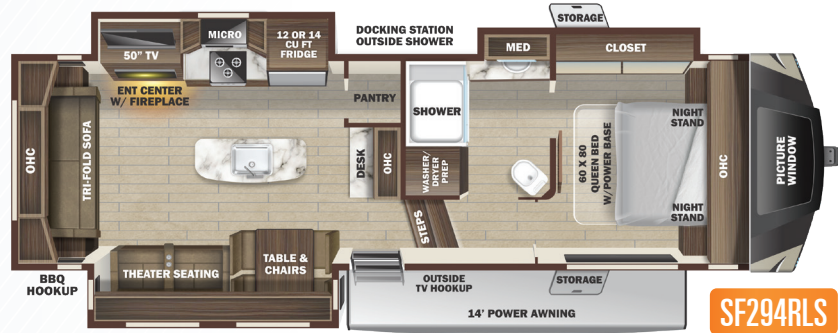
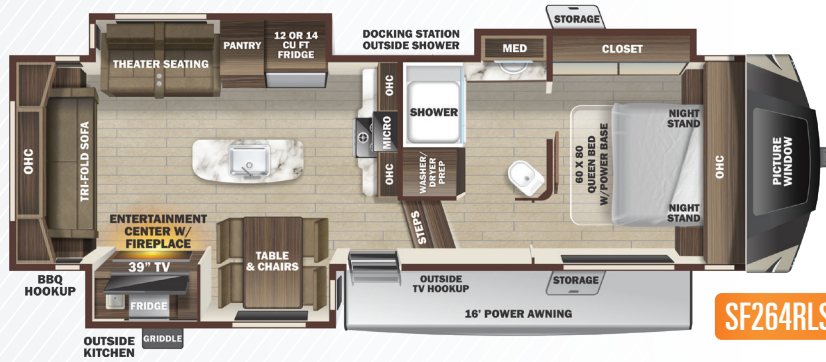

EXPLORE OUR BRANDS AT
HIGHLANDRIDGERV.COM

Please Note: Information on this flyer is the latest available at the time of publication approval. Highland Ridge reserves the right to make changes and to discontinue models without notice or obligation. RVs built for sale in Canada may differ to conform to Canadian codes. HIGHLAND RIDGE RV is a registered trademark of Jayco, Inc. ©2020 Highland Ridge



2021 FIFTH WHEELS



STANDARDS

- » 100" Wide Body Frame
- » 15,000 BTU A/C
- » 2" Receiver Hitch
- » 75lb. Full Extension Drawer Guides
- » 76" x 28" Entrance Door
- » 78" Slideout Height
- » ACCU-SLIDE™ Slide System (42" Deep with 4-Corner Compression)
- » Battery Disconnect
- » Cutting Board & Sink Strainer
- » Equa-Flex® Axle Suspension
- » Flush Floor Slides with Vinyl Flooring (No Carpet)
- » Hardwood Cabinet Doors
- » Keyed-Alike™ Entry & Baggage Doors
- » Large Oven & 3-Burner Range with Glass Cover
- » LED HDTV
- » LED Lighting
- » LevelLoc™ - 4 Point Auto Leveling with JT's Strong Arm™ Stabilizers
- » Max Comfort Queen Bed with Adjustable Power Base
- » Motion Detector Lights in Bedroom & Hallway
- » Night Roller Shades

- » Observation Camera Prep
- » Painted Fiberglass Frontcap with Automotive Tinted Window
- » Power Awning with LED Lighting
- » PVC Roofing Membrane (15 Year Limited Warranty/Non-Prorated)
- » Residential Vinyl Flooring Throughout
- » RidgeLINK™ - Bluetooth® Control of Slides, Lighting & More
- » Roof Ladder
- » Seamless Solid-Surface Kitchen Countertops
- » Self-Adjusting Electric Breaks
- » Solar Prep
- » Solid Swing-Down Entry Steps
- » Stainless Steel Appliances
- » Stainless Steel Under-Mount Kitchen Sink
- » Theater Seats with Heat & Massage
- » Tinted Safety-Glass Windows
- » USB Ports in Master Bedroom
- » Washer/Dryer Prep
- » Wi-Fi Ready

OPTIONS

- » 12 cu. ft. Gas/Electric Refrigerator
- » 14 cu. ft. Residential Refrigerator
- » 2nd A/C - 13,500 BTU Ducted
- » 32" TV - Bunk Room (354, 364)
- » 32" TV - Main Bedroom
- » BBQ Grill
- » Booth Dinette with Theater Seating (N/A 264)
- » Fan - Wall Control Power Vent in Bathroom
- » Folding Dinette Chairs (2) (N/A with U-Lounge Option)
- » Frameless Dual Pane Windows
- » Observation Camera
- » Slideout Awnings
- » TV Trays (Only Available with Theater Seating)
- » U-Lounge Sofa ipo Theater Seats & Table (354, 364)

FEATURES

SPECIFICATIONS

| | SF264RLS | SF294RLS | SF354MBH | SF364BHS |
|------------------------------------|----------|----------|-------------|----------|
| Unloaded Vehicle Weight (lbs.) | 9,350 | 9,690 | 11,105 | 10,895 |
| Dry Hitch Weight (lbs.) | 1,670 | 1,805 | 2,070 | 2,050 |
| Gross Vehicle Weight Rating (GVWR) | 11,500 | 12,000 | 13,500 | 13,500 |
| Cargo (Gross) | 2,150 | 2,310 | 2,395 | 2,605 |
| Exterior Length (Pin to Rear) | 31' 11" | 33' 10" | 38' 6" | 39' 0" |
| Exterior Length (Overall) | 32' 7" | 34' 6" | 39' 3" | 39' 8" |
| Exterior Height | 12' 5" | 12' 5" | 12' 8" | 13' 1" |
| Exterior Width | 8' 4" | 8' 4" | 8' 4" | 8' 4" |
| Exterior Width (Slides Out) | 14' 0" | 13' 11" | 13' 11" | 13' 11" |
| Interior Height (Upper Deck) | 6' 4" | 6' 4" | 6' 4" | 6' 4" |
| Interior Height (Overall) | 8' 2" | 8' 2" | 8' 2" | 8' 2" |
| Fresh Water Capacity (Gal.)* | 81 | 81 | 81 | 81 |
| Gray Waste Water Capacity (Gal.) | 97 | 97 | 97 | 115 |
| Black Waste Water Capacity (Gal.) | 40 | 40 | 40 | 80 |
| LP Capacity (lbs.) | 60 | 60 | 60 | 60 |
| Tire Size | 16" | 16" | 16" | 16" |
| Awning Size | 16' | 14' | 11' 6", 16' | 12', 14' |

*Includes Water Heater

LOCAL DEALER INFO



Due to continual research and advances, manufacturer reserves the right to change specifications, design, price, and equipment without notice, and assumes no responsibility for any error in the literature. Some items shown are not included as standard or optional equipment.