

2021 FALL UPDATES



NEW FOR 2021

FUZION UNVEILS NEW HEART-PUMPING STYLE

Already a favorite among the power sports crowd for its pioneering floorplans and innovative features, Keystone Fuzion introduces new on-point interior styling this fall. With a focus on brighter and more authentic finishes, the new design maintains Fuzion's contemporary vibe but with a warmer, more universal appeal.

New & Noteworthy

- Lighter wallboard, paired with soft gray cabinetry in a smooth-grained wood finish, and dark charcoal trim
- Shiplap accents on fireplace and headboard
- Subway tile inspired backsplash
- East/West bed slides in every Fuzion floorplan
- Upgraded to 20k GVWR on all triple axles
- 6-point EQ Smart-Level by Equilizer Systems
- Sharp diamond-tufted furniture with contrasting welt trim
- Rough-hewn flooring detail
- Optional cinema package
- NEW Glacier décor option

blade

HIGH-PERFORMANCE AIR FLOW SYSTEM



BLADE™ HIGH PERFORMANCE AIR HANDLING SYSTEMS

Engineered to maximize the output from today's high-performance RV air conditioners, Keystone's NEW patented air handling system delivers an average of 20% more cooling power and is built to withstand the rigors of the road. The Blade™ system is designed to accelerate air flow, eliminate leakage and failure points, deliver 360° circulation in the cabin, and withstand environmental and road stressors that lead to reduced performance.

NEW FULL-BODY PAINT DESIGN

Full-body paint is hotter than ever with Fuzion buyers. Fuzion ups the ante with an exhilarating new design in blue, red, orange and gold colorways.



COLOR OPTIONS



FUZION

FIFTH WHEEL TOY HAULERS

2021
FALL
UPDATES



LIVE IT OUT.

PRINT 8.2020



LIVE IT OUT.

FUZION | FIFTH WHEEL TOY HAULER FLOORPLANS

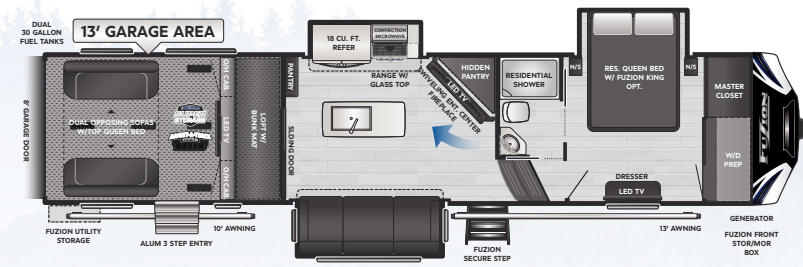

357 | Kitchen island, hidden pantry, tandem-axle, 13' garage

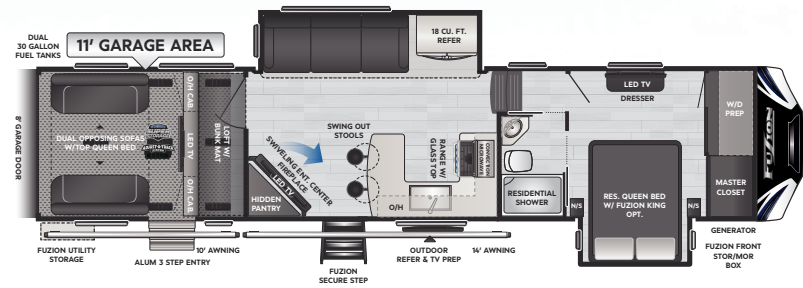

369 | Bar top seating, hidden pantry, tandem-axe, 11' garage

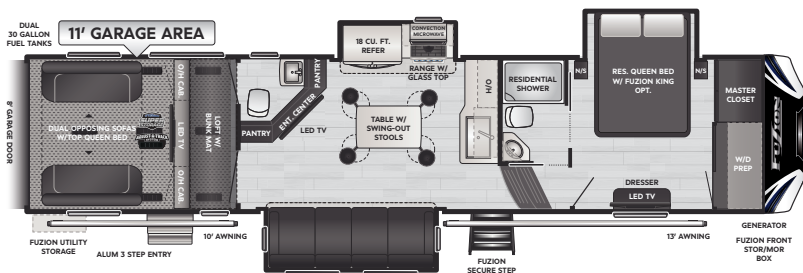

373 | Kitchen island, swing out stools, 1 1/2 baths, tandem-axe, 11' garage

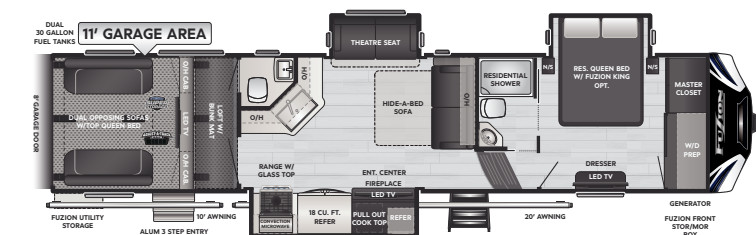

NEW! 379 | Cross conversational seating, 1 1/2 baths, outdoor kitchen, 11' garage

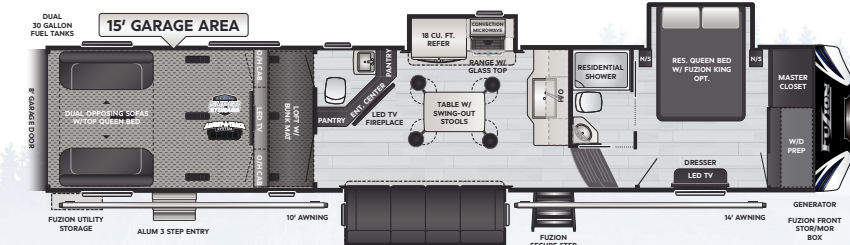

419 | Kitchen island, swing out stools, 1 1/2 baths, triple-axe, 15' garage

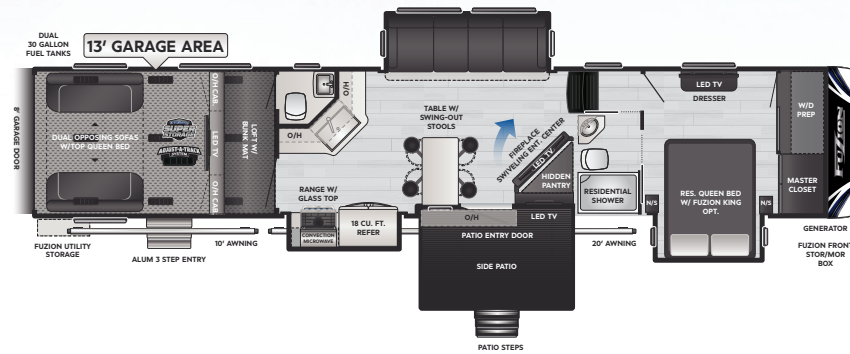

424 | Side patio, 1 1/2 baths, triple-axe, 13' garage

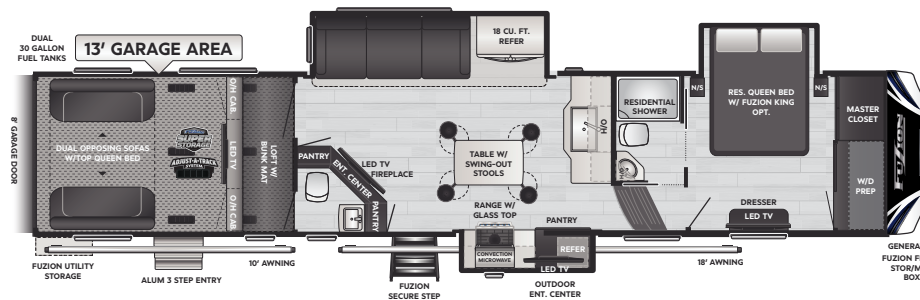

427 | 1 1/2 baths, outdoor kitchen, triple-axe, 13' garage

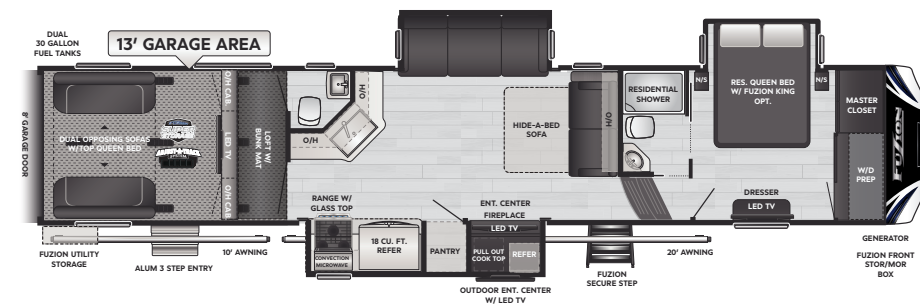

NEW! 428 | Cross conversational seating, 1 1/2 baths, outdoor kitchen, 13' garage

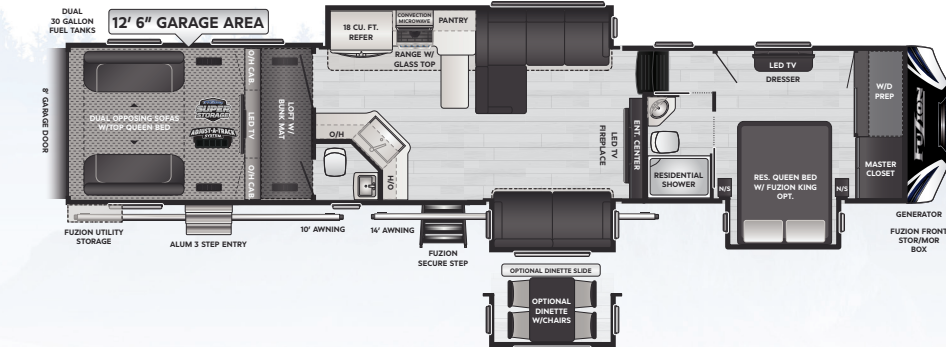

429 | L-shaped sofa, 1 1/2 baths, triple-axe, 12' 6" garage

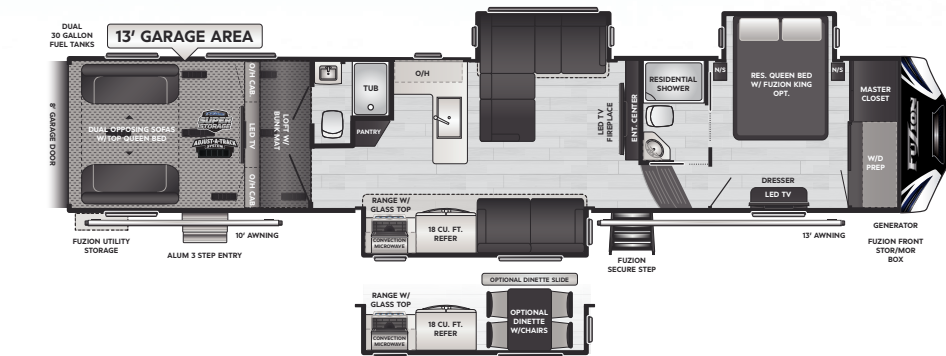

NEW! 430 | L-shaped sofa, 2 full baths, triple-axe, 13' garage

FUZION | MODEL SPECIFICATIONS

MODEL	WEIGHT	CARRYING CAPACITY	HITCH WEIGHT	FRESH WATER	WASTE WATER	GRAY WATER	LPG	LENGTH*	WIDTH	HEIGHT	AWNING
357	13646	3354	3165	106	44	88	60	39' 0"	8' 4"	13' 1"	10'/13'
369	13599	3575	3015	106	44	88	60	39' 0"	8' 4"	13' 1"	18'/12'
373	14195	2805	3120	106	88	88	60	39' 0"	8' 4"	13' 1"	10'/13'
379	14485	2515	3155	106	88	88	60	39' 6"	8' 4"	13' 1"	10'/20'
419	15456	3544	3395	106	88	88	60	44' 0"	8' 4"	13' 3"	10'/14'
424	16177	3040	3525	106	88	88	60	44' 0"	8' 4"	13' 3"	10'/20'
427	15600	3400	3380	106	88	88	60	43' 6"	8' 4"	13' 3"	10'/18'
428	TBD	TBD	TBD	106	88	88	60	44' 0"	8' 4"	13' 3"	10'/20'
429	15609	3391	3455	106	88	88	60	44' 0"	8' 4"	13' 3"	10'/14'
430	15475	3525	3325	106	88	88	60	43' 3"	8' 4"	13' 3"	10'/13'

DISCLAIMER: Product information is as accurate as possible as of the date of publication of this brochure. All features, floor plans, and specifications in this brochure are subject to change without notice. Please also consult Keystone's web site at www.keystonerv.com for more current product information and specifications. Tow Vehicle Disclaimer. CAUTION: Owners of Keystone recreational vehicles are solely responsible for the selection and proper use of tow vehicles. All customers should consult with a motor vehicle manufacturer or their dealer concerning the purchase and use of suitable tow vehicles for Keystone products. Keystone disclaims any liability or damages suffered as a result of the selection, operation, use or misuse of a tow vehicle. KEYSTONE'S LIMITED WARRANTY DOES NOT COVER DAMAGE TO THE RECREATIONAL VEHICLE OR THE TOW VEHICLE AS A RESULT OF THE SELECTION, OPERATION, USE OR MISUSE OF THE TOW VEHICLE. *Length is defined as the distance from the centerline of hitch pin/coupler to rear bumper of trailer. Please review owner's manual prior to purchase for more information on service warranties, extended use, towing and maintenance. Owner's manuals can be found at keystonerv.com.