

PUMA

TRAVEL TRAILERS / FIFTH WHEELS / TOY HAULERS / DESTINATION TRAILERS

PUMA

BY PALOMINO – SINCE 1968



**GET
INTO THE
WILD**

PUMA TRAVEL TRAILERS

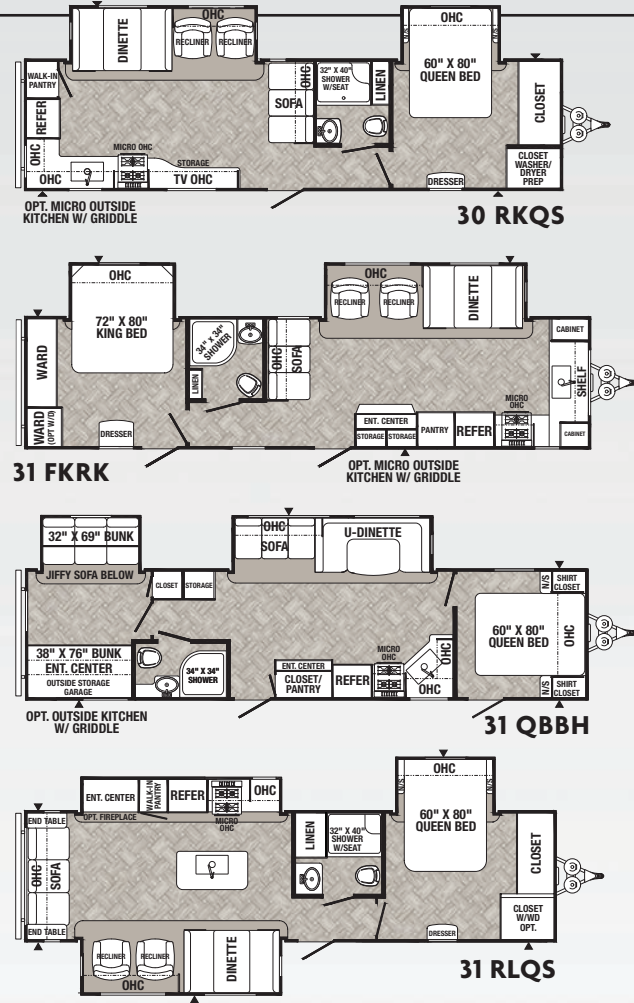
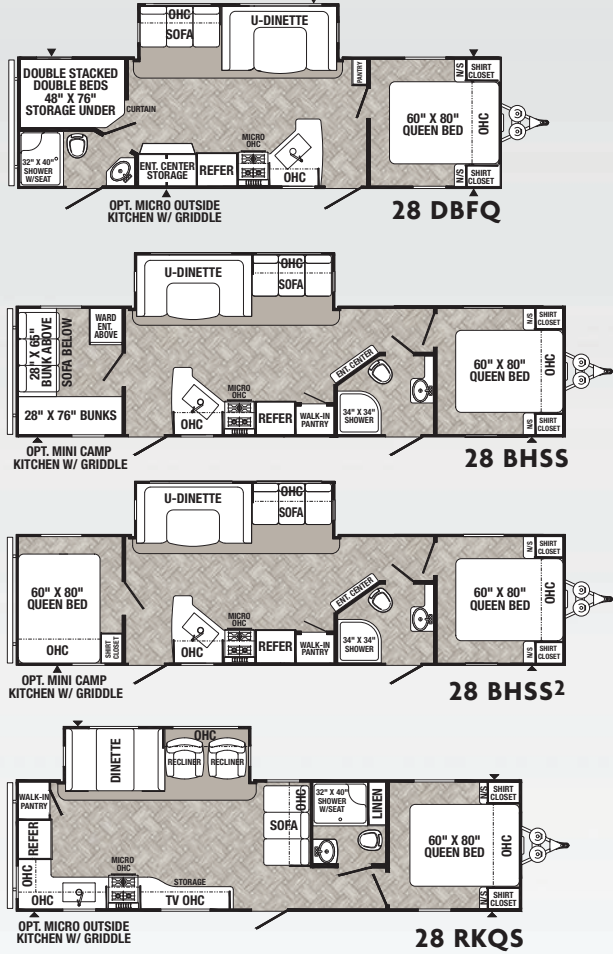
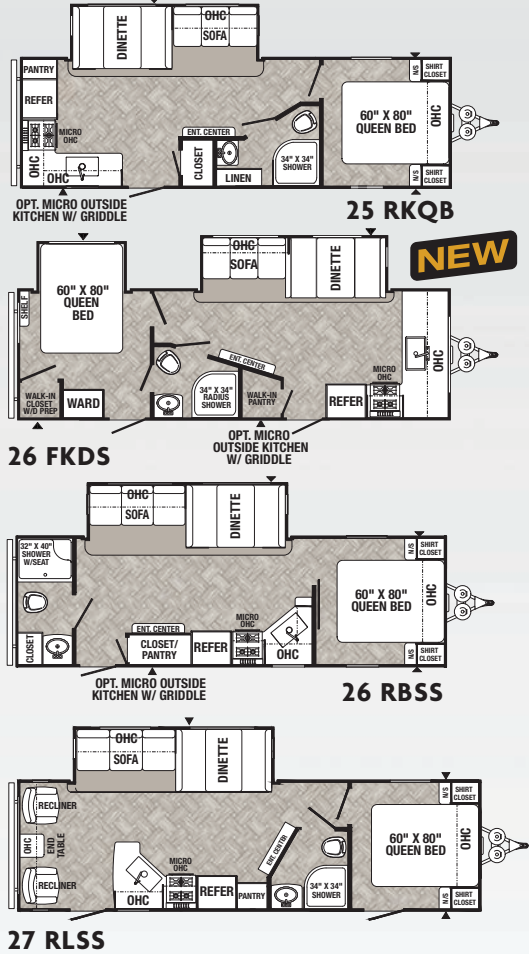

PUMA TRAVEL TRAILERS

MODEL	25 RKQB	26 FKDS	26 RBSS	27 RLSS	28 DBFQ	28 BHSS	28 BHSS ²	28 RKQS	30 RKQS	31 FKRK	31 QBBH	31 RLQS	32 BHDB	32 BHIS	32 BHKS	32 BHFS	32 BHQS	32 DBTS	32 MBDS	32 RBFQ	32 RBFQ ²
Hitch Weight (lbs)	670	1045	610	756	694	835	843	870	1085	1195	1049	975	928	964	932	TBD	1045	1029	1090	948	932
Axle Weight (lbs)	5340	6010	5385	5409	6136	6640	6670	6345	6830	7460	7144	7795	7759	7620	7667	TBD	7968	8075	7705	8012	8106
UVW (lbs)	6048	7093	6033	6203	6868	7513	7574	7253	7974	8693	8231	8808	8725	8643	8637	TBD	9072	9128	8833	8998	9237
GVWR (lbs)	7598	8693	7610	7756	8500	9063	9063	8800	9600	9995	9995	10500	9995	9995	9995	TBD	10800	11215	10533	10500	10500
Cargo Capacity (lbs)	1550	1600	1577	1553	1632	1550	1489	1547	1626	1302	1764	1692	1270	1352	1358	TBD	1726	2087	1700	1502	1263
Exterior Length	29' 7"	29' 11"	29' 10"	31' 7"	32' 10"	36' 10"	36' 10"	34' 5"	36' 1"	37' 10"	37' 10"	36' 1"	38' 4"	37' 1"	36' 7"	38' 9"	38' 9"	38' 8"	38' 9"	36' 11"	36' 11"
Exterior Height w/AC	11' 1"	11' 1"	11' 1"	11' 1"	11' 1"	11' 1"	11' 1"	11' 1"	11' 1"	11' 1"	11' 1"	11' 1"	11' 1"	11' 1"	11' 1"	11' 1"	11' 1"	11' 1"	11' 1"	11' 1"	11' 1"
Water Heater Cap. (gal)	6	6	6	6	6	6	6	6	6	6	6	6	6	6	6	6	6	6	6	6	6
Fresh Water Cap. (gal)	43	43	43	43	43	43	43	43	43	43	43	43	43	43	43	43	43	43	43	43	43
Black Water Cap. (gal)	35	35	35	35	35	35	35	35	35	32	35	35	67	67	35	32	64	34	35	35	35
Grey Water Cap. (gal)	70	70	70	35	67	67	67	70	67	67	70	35	70	70	35	70	70	64	35	67	67
Tire Size (in)	15"	15"	15"	15"	15"	15"	15"	15"	15"	15"	15"	15"	15"	15"	15"	15"	15"	15"	15"	15"	15"
Awning Size (ft)	20'	21'	21'	21'	21'	20'	20'	21'	21'	21'	21'	13'	21'	19'	19'	21'	19'	20'	15'	21'	21'

Refer to back cover for chart definitions.

PUMA TRAVEL TRAILERS

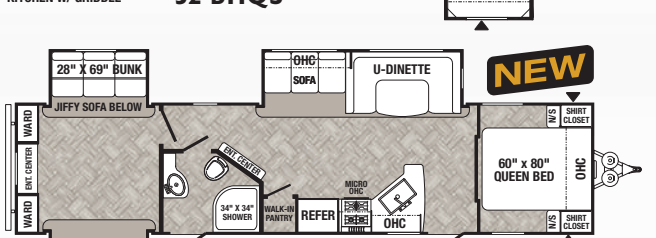
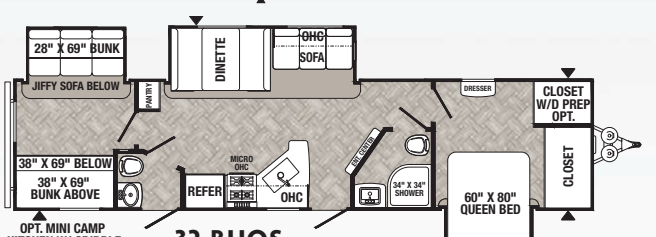
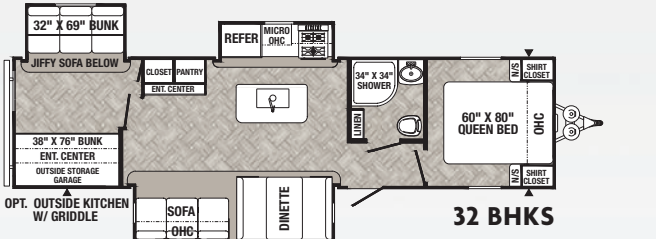
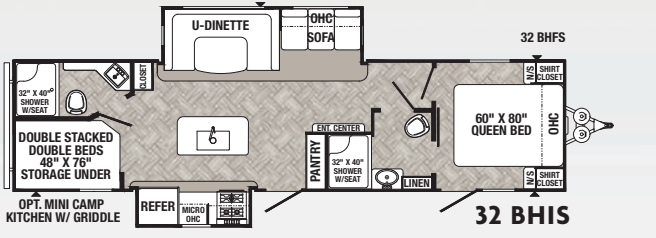
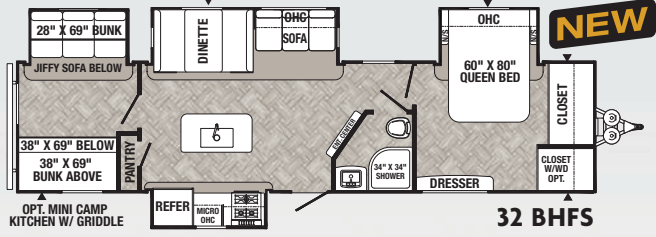
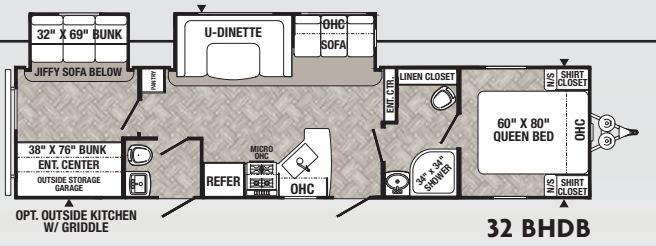

PUMA

Whether it's just the two of you, a family set on adventure, or a getaway with a group of friends, these well equipped Travel Trailers, Fifth Wheels, Destination Trailers and Toy Haulers enhance your vacation adventures. Puma is loaded with these comforts: a 21" oven with LED backlit controls and a glass range cover, a pull-down faucet with stainless steel undermount sink and covers, an 11 cu. ft. 12V refrigerator, a 1.3 cu. ft. stainless steel microwave, adjustable roller shades, and a spacious walk-in pantry. A 5100 BTU color changing electric fireplace adds warmth – and is included in the Limited Edition Package.

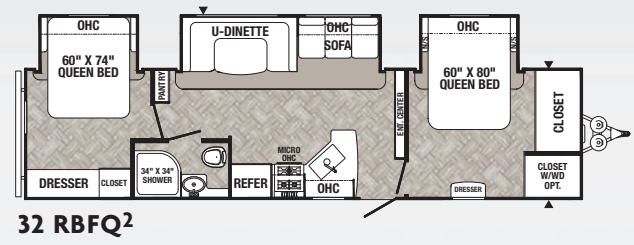
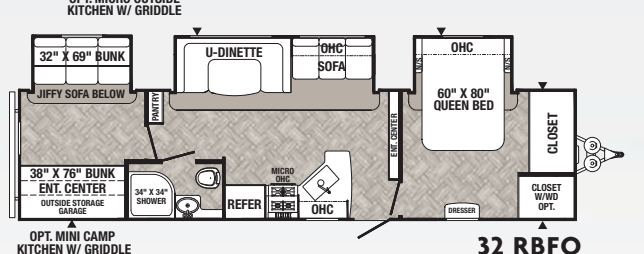
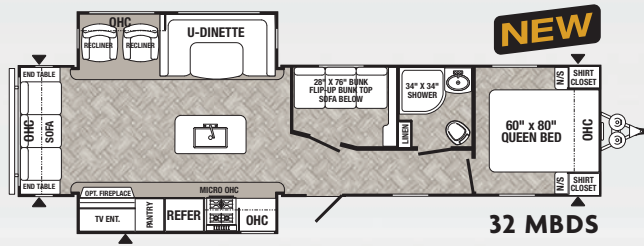

TOY HAULER TRAVEL TRAILER

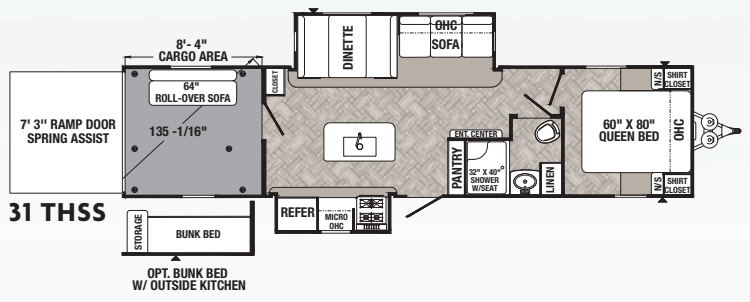

TRAVEL TRAILER OPTIONS Available on select models.

- OUTSIDE KITCHEN OPTION W/ GRIDDLE**
- 31 QBH • 32 BHDB
 - 32 BHKS • 32 DBTS
 - 32 RBFQ • 31 THSS

- MINI CAMP KITCHEN OPTION W/ GRIDDLE**
- 28 BHSS • 28 BHSS2
 - 31 QBH • 32 BHIS
 - 32 BHDB • 32 BHFS
 - 32 BHKS • 32 BHQS
 - 32 RBFQ • 31 THSS

- MICRO OUTSIDE KITCHEN OPTION W/ GRIDDLE**
- 25 RKQB • 26 FKDS
 - 26 RBSS • 28 DBFQ
 - 28 RKQS • 30 RKQS
 - 31 FKRK • 32 MBDS

TOY HAULER TRAVEL TRAILER

MODEL	31 THSS
Hitch Weight (lbs)	1525
Axle Weight (lbs)	7340
UVW (lbs)	8924
GVWR (lbs)	11200
Cargo Capacity (lbs)	2276
Exterior Length	37' 9"
Exterior Height w/AC	11' 2"
Water Heater Cap. (gal)	6
Fresh Water Cap. (gal)	43
Black Water Cap. (gal)	32
Grey Water Cap. (gal)	35
Tire Size (in)	15"
Awning Size (ft)	19'

Refer to back cover for chart definitions.

PUMA FIFTH WHEELS

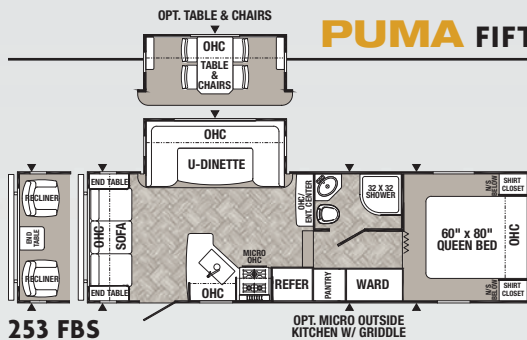

253 FBS

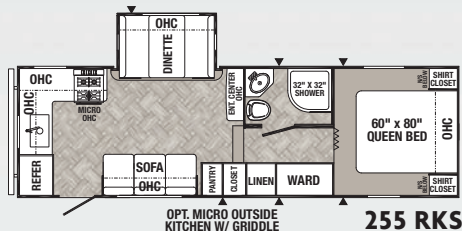

255 RKS

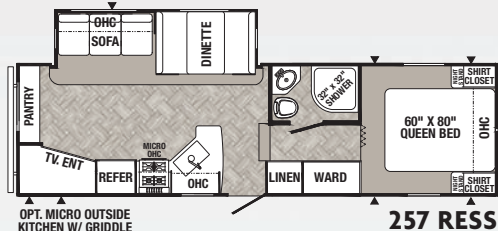

257 RESS

FIFTH WHEEL OPTIONS

Available on select models.

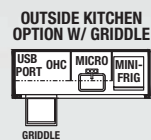

295 BHSS



289 BHS
295 BHSS



253 FBS + 255 RKS
257 RESS + 265 RDS

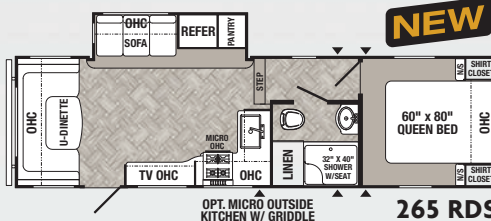

265 RDS

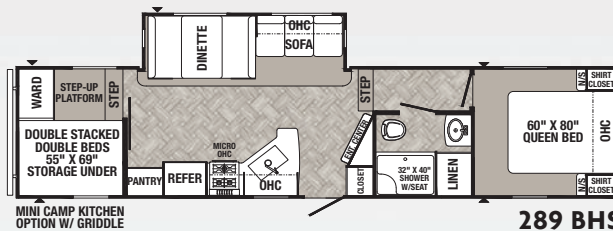

289 BHS

PUMA FIFTH WHEELS

MODEL	253 FBS	255 RKS	257 RESS	265 RDS	289 BHS	295 BHSS
Hitch Weight (lbs)	1128	1102	1262	1480	1455	1358
Axle Weight (lbs)	5757	5614	6186	5845	6875	7336
UVW (lbs)	6788	6754	7419	7363	8389	8732
GVWR (lbs)	8800	8800	9400	9363	10350	10750
Cargo Capacity (lbs)	2012	2046	1981	2000	1961	2018
Exterior Length	28'	28' 5"	30' 8"	30' 5"	34' 11"	34' 4"
Exterior Height w/AC	12' 2"	12' 2"	12' 2"	12' 2"	12' 2"	12' 4"
Water Heater Cap. (gal)	6	6	6	6	6	6
Fresh Water Cap. (gal)	43	43	43	43	43	43
Black Water Cap. (gal)	32	32	32	30	35	32
Grey Water Cap. (gal)	70	70	70	35	70	35
Tire Size (in)	15"	15"	15"	15"	15"	15"
Awning Size (ft)	17'	18'	18'	17'	18'	18'

Refer to back cover for chart definitions.

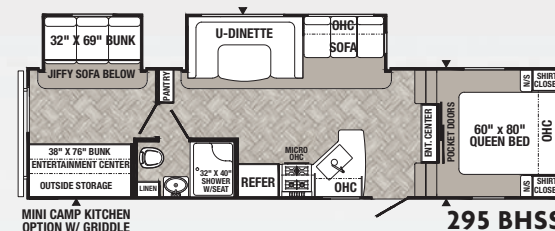

295 BHSS

PUMA UNLEASHED FIFTH WHEEL TOY HAULERS

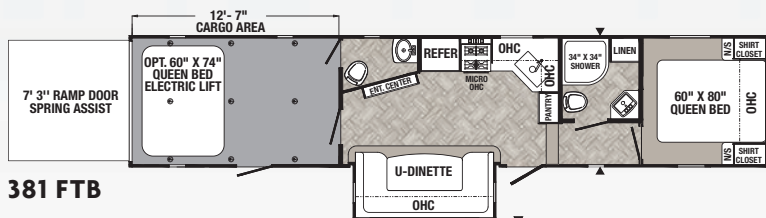

381 FTB

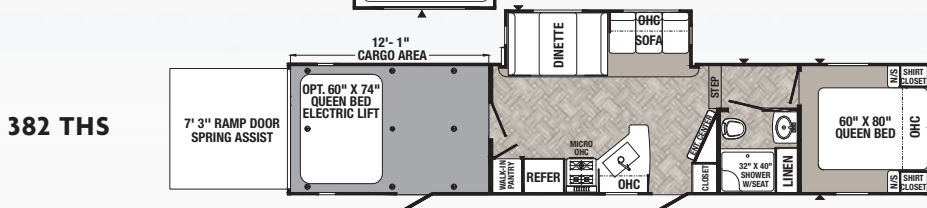

382 THS

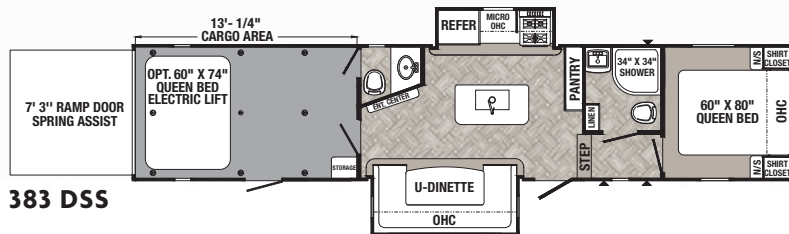

383 DSS

FIFTH WHEEL TOY HAULER OPTIONS

Available on select models.

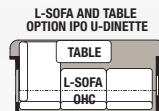

381 FTB

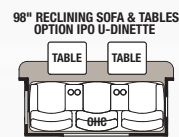

381 FTB + 383 DSS

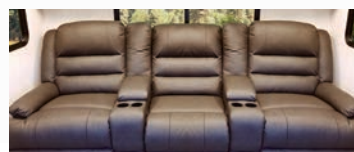

PUMA TOY HAULER FIFTH WHEELS

MODEL	381 FTB	382 THS	383 DSS
Hitch Weight (lbs)	1760	1900	1895
Axle Weight (lbs)	8335	8280	8825
UVW (lbs)	10133	10218	10758
GVWR (lbs)	14123	13900	13895
Cargo Capacity	3990	3682	3137
Exterior Length	39' 10"	39' 10"	39' 10"
Exterior Height w/AC	12' 8"	12' 8"	12' 8"
Water Heater Cap. (gal)	12	12	12
Fresh Water Cap. (gal)	100	100	100
Black Water Cap. (gal)	70	35	67
Grey Water Cap. (gal)	35	70	67
Tire Size (in)	16"	16"	16"
Awning Size (ft)	21'	21'	21'

Refer to back cover for chart definitions.

PUMA



37 PFL

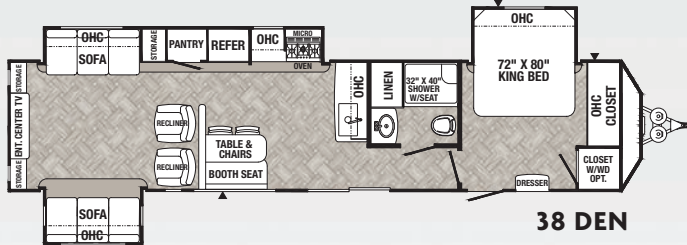

38 DEN

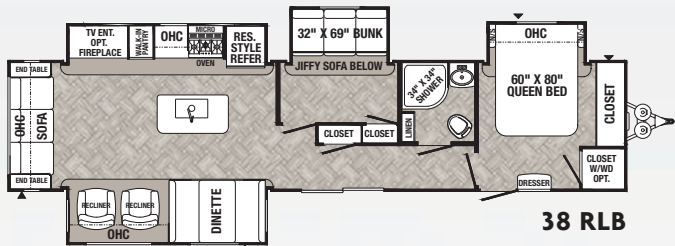

38 RLB



38 RLQ

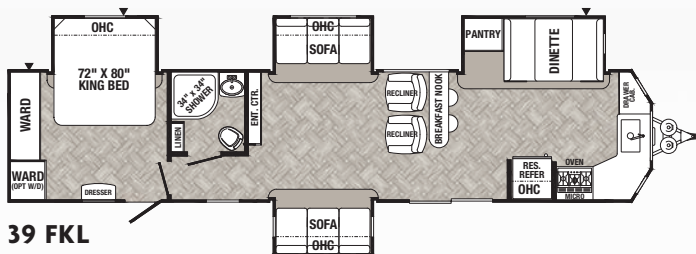

39 FKL

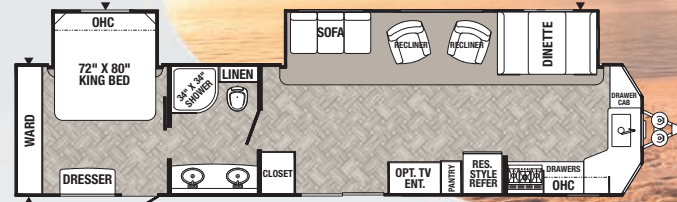

39 PFK

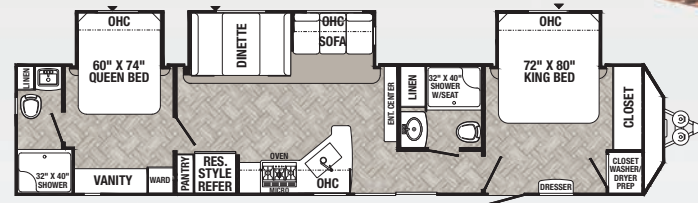

39 DBT

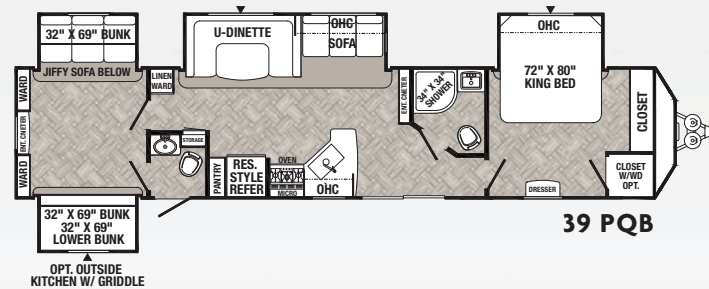

39 PQB

DESTINATION TRAILER OPTIONS
Available on select models.

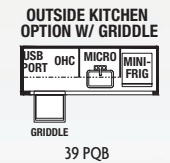

PUMA DESTINATION TRAILERS

MODEL	37 PFL	38 DEN	38 RLB	38 RLQ	39 FKL	39 PFK	39 DBT	39 PQB
Hitch Weight (lbs)	1780	1295	1525	1469	1540	1392	1439	1413
Axle Weight (lbs)	7914	8684	8656	7937	8856	8553	8664	9237
UVW (lbs)	9753	9979	10240	9468	10455	10004	10162	10709
GVWR (lbs)	11940	11500	11685	11629	11700	11592	12000	13413
Capacity (lbs)	2227	1521	1445	2161	1245	1588	1838	2704
Exterior Length	40' 8"	40' 6"	41' 10"	39' 9"	42' 1"	40' 8"	42' 4"	42' 3"
Exterior Height w/AC	11' 9"	11' 9"	11' 9"	11' 9"	11' 9"	11' 9"	11' 9"	11' 9"
Water Heater Cap. (gal)	12	12	12	12	12	12	12	12
Fresh Water Cap. (gal)	43	43	43	43	43	43	43	43
Black Water Cap. (gal)	35	35	35	35	32	35	64	67
Grey Water Cap. (gal)	35	35	70	35	70	65	105	105
Tire Size (in)	15"	15"	16"	15"	15"	15"	16"	16"
Awning Size (ft) OPT.	19'	18'	19'	18'	21'	21'	21'	21'

Refer to back cover for chart definitions.

STYLE / SELECTION / VALUE

PUMA PACKAGES

TRAVEL TRAILERS

VALUE SHOPPER PACKAGE (Required)

- Jack Knife Sofa w/Pull-Down Center Drink Tray & Storage Underneath
- Electric Awning w/LED Light Strip
- Pre-wired for Solar System
- LED Lighting
- 13,500 BTU Ducted A/C
- Beauflor Linoleum
- Bedspread
- Bedroom TV Hook-up
- TV Antenna w/Booster & Cable Hook-up
- Tub Surround
- WiFi Prep
- AM/FM/Bluetooth Stereo
- Glass Range Cover
- Undermount Sink w/Cover

ADVANTAGE PACKAGE (Required)

- 1.3 Cu. Ft. Stainless Steel Microwave
- Enclosed Underbelly
- 2 Outside Speakers
- 6 gal. Gas/Electric Water Heater
- Outside Shower
- Spare Tire
- 21" Stainless Steel Oven & Range Hood
- Folding Grab Handle
- Bath Skylight
- 11 Cu. Ft. (12V) Stainless Steel Residential Refrigerator
- Upgrade Faucet w/Pull Down Sprayer
- Roller Shades

ELECTRIC POWER PACKAGE (FW) (Required)

- 2 Power Front Jacks
- 2 Electric Stabilizer Jacks

OPTIONAL PACKAGES

ELECTRIC POWER PACKAGE (TT)

- 4 Electric Stabilizer Jacks
- 3,500 Lb. Electric Tongue Jack

LIMITED EDITION PACKAGE

- 50 Amp Service (Second A/C prep, includes bedroom roof vent)
- Roof Ladder
- 15,000 BTU Ducted A/C IPO 13,500 BTU
- Black Tank Flush
- Aluminum Solid Triple Step
- Fireplace w/Textured Tile

FIFTH WHEELS

VALUE SHOPPER PACKAGE (Required)

- Jack Knife Sofa w/Pull-Down Center Drink Tray & Storage Underneath
- Electric Awning w/LED Light Strip
- Pre-wired for Solar System
- LED Lighting
- 13,500 BTU Ducted A/C
- Beauflor Linoleum
- Bedspread
- Bedroom TV Hook-up
- TV Antenna w/Booster & Cable Hook-up
- Tub Surround
- WiFi Prep
- AM/FM/Bluetooth Stereo
- Glass Range Cover
- Undermount Sink w/Cover

ADVANTAGE PACKAGE (Required)

- 1.3 Cu. Ft. Stainless Steel Microwave
- Enclosed Underbelly
- 2 Outside Speakers
- 6 gal. Gas/Electric Water Heater
- Outside Shower
- Spare Tire
- 21" Stainless Steel Oven & Range Hood
- Folding Grab Handle
- Bath Skylight
- 11 Cu. Ft. (12V) Stainless Steel Residential Refrigerator
- Upgrade Faucet w/Pull Down Sprayer
- Roller Shades

ELECTRIC POWER PACKAGE (FW) (Required)

- 2 Power Front Jacks
- 2 Electric Stabilizer Jacks

OPTIONAL PACKAGES

ELECTRIC POWER PACKAGE (TT)

- 4 Electric Stabilizer Jacks
- 3,500 Lb. Electric Tongue Jack

LIMITED EDITION PACKAGE

- 50 Amp Service (Second A/C prep, includes bedroom roof vent)
- Roof Ladder
- 15,000 BTU Ducted A/C IPO 13,500 BTU
- Black Tank Flush
- Aluminum Solid Triple Step
- Fireplace w/Textured Tile

UNLEASHED TOY HAULERS

VALUE SHOPPER PACKAGE (Required)

- Jack Knife Sofa w/Pull-Down Drink Tray & Storage Underneath
- Electric Awning w/LED Light Strip
- Pre-wired for Solar System
- LED Lighting
- 13,500 BTU Ducted A/C
- Zip Screen
- 40" LED TV
- Beauflor Linoleum
- Bedspread
- Bedroom TV Hook-up
- TV Antenna w/Booster & Cable Hook-up
- Tub Surround
- AM/FM/Bluetooth Stereo
- WiFi Prep
- Glass Range Cover
- Undermount Sink w/Cover

ELECTRIC POWER PACKAGE (Required)

- 2 Power Front Jacks
- 2 Electric Stabilizer Jacks

ADVANTAGE PACKAGE (Required)

- 1.3 Cu. Ft. Stainless Steel Microwave
- Enclosed Underbelly
- (2) Outside Speakers
- 12 Gal. Gas/Electric Water Heater
- Outside Shower
- Roller Shades
- Spare Tire
- 21" Stainless Steel Oven & Range Hood
- Folding Grab Handle
- Bath Skylight
- 11 Cu. Ft. (12V) Stainless Steel Residential Refrigerator
- Upgrade Faucet w/Pull Down Sprayer

OPTIONAL PACKAGES

XL EDITION PACKAGE

- 30 lb Gas bottles
- 50 AMP Service (Second A/C Prep in garage - Includes roof vent)
- Roof Ladder
- 15,000 BTU Ducted A/C In Living Area
- 30 Gal Fuel Pump Station
- Aluminum Solid Triple Step IPO Std Step
- Black Tank Flush
- Fireplace w/Textured Tile
- Mission Aluminum Modified Rims/Radial Tires

DESTINATION TRAILERS

VALUE SHOPPER PACKAGE (Required)

- Pre-wired for Solar System
- Folding Grab Handle
- Roller Shades
- LED Lighting
- 13,500 BTU Ducted A/C
- 18 Cu. Ft. Stainless Steel Residential Refrigerator w/Ice Maker
- 1.3 Cu. Ft. Microwave
- 21" Stainless Steel Oven w/Cooktop
- Cooktop & Range Hood
- Beauflor Linoleum
- Bedspread
- Bedroom TV Hook-up
- TV Antenna w/Booster & Cable Hook-up
- ABS Tub Surround
- 12 Gal Gas/Electric DSI Water Heater
- AM/FM/Bluetooth Stereo
- Undermount Sink w/Cover
- Upgrade Kitchen Faucet
- Black Tank Flush
- Patio Door
- WiFi Prep

OPTIONAL PACKAGES

MARQUIS EDITION PACKAGE

- 4 Stabilizer Jacks
- 30 lb Gas Bottles & Cover
- 50 AMP Service (Second A/C Prep)
- 15,000 BTU Ducted A/C IPO 13,500
- Outside Shower
- Solid Surface Countertop
- Table & Chairs IPO Dinette
- 12V Ceiling Fan in Living Room
- 2 Exterior Speakers
- Fireplace w/Textured Tile
- Tri-Fold Sofa IPO Jackknife in Living Room
- Roller Shades

**GET
INTO THE
WILD**

PUMA STANDARD FEATURES

EXTERIOR

- Friction Hinged Radius Entry Doors
- Powder Coated Frames
- Super Lube Axles
- Tinted Safety Glass
- Clamp Ring Windows
- Double Entry Doors (Where applicable)
- Pass-Thru Storage (Where applicable)
- Power Awning w/LED Light Strip (Optional on Destination Trailers)
- Front Fiberglass Cap w/Diamond Plate (FW)
- DiFlex II™ TPO Roof by Dacor – 12 Year Manufacturer's Limited Warranty
- 4 Manual Stabilizer Jacks
- 9" Three-tier Steps
- Rain Gutters w/Large Downspouts
- ABS Automotive Style Fender Skirts
- Radius Baggage Doors
- Darco Wrapped Underbelly
- 5/8" Araucopy Plywood Floor Decking (25 Year manufacturer's limited warranty)
- 2" x 3" Flush Floor Joists on 12" Centers
- Pass-Thru Exterior Baggage Compartments (Where applicable)
- 2-20 Lb. Gas Bottles
- 6 Gal. DSI Hot Water Heater
- Rack & Pinion Electric Slide System w/Manual Override (Standard on all slide outs)
- Clamp Ring Luggage Doors
- Large Front Pass Thru Baggage Door (TT only)
- Front Fiberglass Cap w/LED Lighting (31FKRK only)
- Back-up Camera Prep
- Solar Prep

INTERIOR

- 80" Interior Height
- Floor Ducted Heat
- USB Charging Ports
- 35,000 BTU Furnace
- 14" Deep Overhead Cabinets in Super-Slide Models
- Decorative Kitchen Backsplash
- Kitchen Ball Bearing Drawer Guides
- Spice Rack (Kitchen)
- Divided Silverware Drawer
- High-rise, Pull-down Kitchen Faucet
- 3-Burner, High Output Range
- Undermount Stainless Steel Sink
- Routed Metal Backsplash
- Roll-up Stainless Steel Sink Covers
- New Hardware Black Handles & Hinges (Kitchen, Living Room)
- Glass Range Cover
- Built-in Knife Rack
- LED Ceiling Lights
- 55 Amp Converter w/Battery Charger
- AM/FM/Bluetooth Stereo
- King Antenna w/WiFi Prep

- Jack Knife Sofa w/Pull-down Center Drink Tray – Storage Underneath
- Jack Knife Sofa Under Bunks
- Push-back Recliner(s)*
- Wood Medicine Cabinet with Mirrored Door
- Power Vent in Bath
- Glass Shower Door*
- 12V Shower LED Light

- 60" x 80" Queen Beds
- High Density Foam Mattress
- Bedroom Carpet (FW)
- Upgraded Soft Teddy Bear Bunk Mats
- Shirt Closet in Front Bedrooms
- Nightstands in Front Bedrooms
- Two Interior Decors
- Coat Hooks in Entry Way (Most models)

- Square Dinette Seat Bases w/Cabinet Storage
- Residential Carpet with pad
- Designer Window Treatments (Living room)

SAFETY FEATURES

- CO₂ Detector
- LP Leak Detector
- Fire Extinguisher
- Smoke Detector

*Available on select models.

PUMA CONSTRUCTION – LONGER LASTING BETTER BUILT



Smooth, aerodynamic radius front metal with diamond plate

- A.** Rubber Roof (12 year limited warranty)
- B.** King HD TV Antenna
- C.** 3/8" Roof Decking
- D.** 4-1/2" Crowned Truss Roof Rafters
- E.** Insulated Wrapped Ducted Air Conditioning Runs
- F.** Molded ABS Fender Skirt
- G.** Sturdy .024 and .030 Gauge Aluminum Skin
- H.** Lighted LED Speakers
- I.** Color Band Metal Enhances Exterior Looks
- J.** Radius Exterior Doors

- K.** R-7 Fiberglass Insulation Cut and Glued Between Sidewall Studs
- L.** Sidewall Studs Spaced 16" Apart
- M.** Silicone Sealed Radius Compartment Doors
- N.** Front Diamond Plate
- O.** Smooth, Aerodynamic Radius Front Metal with Bold Exterior Graphics
- P.** Molded ABS LP Tank Cover
- Q.** Optional Lighted Power Jack
- R.** Rugged, Powder Coated Steel I-Beam Frame

- S.** Floor Ducted Heat
- T.** Puma Next Generation™ Enclosed Water Tanks
- U.** Beauflor® Linoleum Flooring with 7-Year Cold Crack Warranty
- V.** Longitudinal Floor Studding Spaced 12" Apart
- W.** 51 Gallon Fresh Water Tank
- X.** Steel Crossmembers for Added Support
- Y.** Residential Grade Carpet with Pad on Slide Outs
- Z.** 5/8" Araucopy Plywood Floor Decking (25 Year manufacturer's limited warranty)

PUMA DECOR OPTIONS

Puma offers two contemporary decor packages.

CAFE LATTE



SLATE



BEDROOM



FLOORING

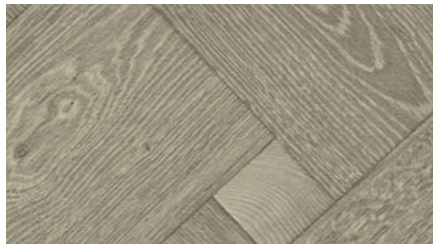

PALOMINO
P U M A

Puma by Palomino, a Division of Forest River, Inc.
2551 Century Drive • Goshen, IN 46528
www.palominorv.com

YOUR **PUMA** DEALER



AN RV FOR EVERY LIFESTYLE

Puma has built its success by offering the broadest selection of RV's for every lifestyle, while incorporating the latest in industry innovations. Customer driven features lead Puma's line-up with floorplans that capitalize on the most popular features, in bunk, non-bunk, Toy Hauler and Destination trailers. Puma's selection of popular packages adds value for years of fun with friends and family. Campers get a lot of comfort for their investment with many popular standard features.



GVWR (Gross Vehicle Weight Rating) - is the maximum permissible weight of the unit when fully loaded. It includes all weights, inclusive of all fluids, cargo, optional equipment and accessories. For safety and product performance do NOT exceed the GVWR.

GAWR (Gross Axle Weight Rating) - is the maximum permissible weight, including cargo, fluids, optional equipment and accessories that can be safely supported by a combination of all axes.

UVW (Unloaded Vehicle Weight)* - is the typical weight of the unit as manufactured at the factory. It includes all weight at the unit's axle(s) and tongue or pin and LP Gas. The UVW does not include cargo, fresh potable water, additional optional equipment or dealer installed accessories.

*Estimated Average based on standard build optional equipment.

CCC (Cargo Carrying Capacity)** - is the amount of weight available for fresh potable water, cargo, additional optional equipment and accessories. CCC is equal to GVWR minus UVW. Available CCC should accommodate fresh potable water (8.3 lbs per gallon). Before filling the fresh water tank, empty the black and gray tanks to provide for more cargo capacity.

**Estimated average based on standard build optional equipment.

Each Forest River RV is weighed at the manufacturing facility prior to shipping. A label identifying the unloaded vehicle weight of the actual unit and the cargo carrying capacity is applied to every Forest River RV prior to leaving our facilities. The load capacity of your unit is designated by weight, not by volume, so you cannot necessarily use all available space when loading your unit.

All information contained in this brochure is believed to be accurate at the time of publication. However, during the model year, it may be necessary to make revisions and Forest River, Inc., reserves the right to make all such changes without notice, including prices, colors, materials, equipment and specifications as well as the addition of new models and the discontinuance of models shown in this brochure. Therefore, please consult with your Forest River dealer and confirm the existence of any materials, design or specifications that are material to your purchase decision. ©2020 Puma by Palomino a Division of Forest River, Inc., a Berkshire Hathaway company. All Rights Reserved. 11/20



PRE-DELIVERY INSPECTION FACILITY

20,000 square feet of quality assurance. The bare essentials for a premium product. This state-of-the-art facility gives immediate daily feedback to production for quality assurance in every unit built.

24/7 EMERGENCY ROADSIDE ASSISTANCE WITH VEHICLE PURCHASE*

TOWING
JUMP-STARTS
TIRE CHANGES
FLUID DELIVERY
LOCKOUT
SERVICE

WINCH-OUT
MOBILE MECHANIC
TECHNICAL
SUPPORT
DEALER LOCATOR
SERVICES

*VALID FOR 1 YEAR FROM DATE OF PURCHASE

WWW.KOACARECAMPS.ORG

Fighting + Making
Cancer + Memories

CUSTOMER SATISFACTION

FOREST RIVER
encourages you to
BUY LOCAL

PRODUCT INFORMATION

www.ForestRiverBuyLocal.com

FREE MEMBERSHIP
to Forest River Owners' Group

www.forestriverfrog.com

Find us on
Facebook



Learn More
Scan this barcode using
a QR Reader on your
smart phone to learn
more about Forest River.

A Berkshire Hathaway company.