

# MICRO MINNIE + MINNIE



Legendary quality.  
Bound by what's next

**WINNEBAGO**  
BOUND BY THE W™



## MICRO MINNIE

### THE COMPACT CAMPER WITHOUT COMPROMISE

The compact camper without compromise, Micro Minnie is big on features and ready for wayfaring. At seven feet wide and with multiple open floorplans to choose from, experience the camper life the way you want.

- **Spacious Kitchen** Ample galley space, a sink, double door refrigerator, microwave and even a cooktop makes cooking its own rewarding adventure.
- **Rest Fresh** Built to be a breath of fresh air, every Micro Minnie floorplan hosts a spacious mattress and windows designed for cross ventilation and a great night's sleep.
- **Open-Air Entertainment** Patio speakers and a power awning featuring
- **LED lighting** let you take the fun outside with the touch of a button.
- **Flexible Storage** Each of the 11 versatile floorplans are packed with enough added exterior storage that packing is a snap.
- **Responsive Size** Leave cumbersome extended mirrors behind. At 7-ft.-wide, Micro Minnie offers the greater visibility that makes towing and turning a snap.





## MINNIE

### COMPACT CAMPER. BIG ADVENTURE.

It may go by Minnie, but it's designed for big outdoor adventure. An easy-to-pull, lightweight camper, Minnie maximizes its compact space with features that challenge the conventional idea of what a travel trailer can be.

- **Maximum Comfort** Whatever creatures you meet outdoors, don't forget your creature comforts inside. With Minnie's queen bed, spacious galley, and large private bathroom, relax and rest easy.
- **Stunning Surfaces** Full, easy-to-clean linoleum surfaces and a light, stylish interior will brighten any trip.
- **Sizzling Showcase** The double-door gas/elec refrigerator, microwave, stainless steel sink and three-burner cooktop with oven are just some of the many stars of the full kitchen.
- **Entertainment Score** From game night to the big game, bring your entertainment outdoors with external patio speakers and external TV hookup.
- **Class-Leading Storage** Master packing day and leave nothing behind with 44 cu. ft. of exterior storage - the best in its class.

WINNEBAGO

# MICRO MINNIE

## TRAVEL TRAILER

THE COMPACT CAMPER WITHOUT COMPROMISE



Interior photos are of the 1708FB floorplan with Pearl decor.  
Exterior photo is of the 2100BH floorplan.



Galley features modern cooking amenities now with full waterfall style back-splash

- i** Visit [Winnebago.com](http://Winnebago.com) for more info
- +** Join a boundless community of adventurers at [Witclub.com](http://Witclub.com)



Light interior decor and large windows make the Micro Minnie feel open and spacious



Standard LED TV, AV system, and WiFi prep for all your entertainment needs



1708FB /

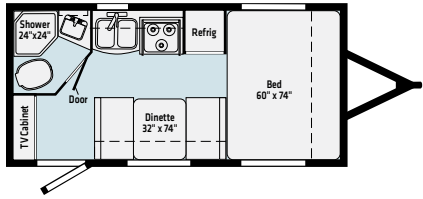

1808FBS /

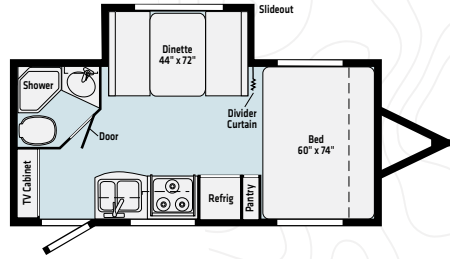

1700BH /

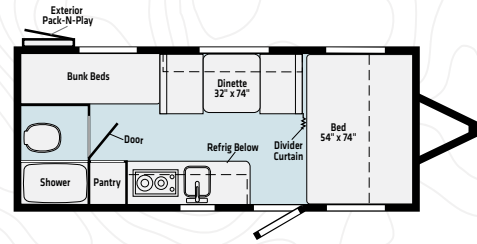

1800BH /

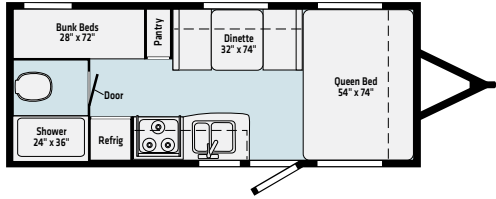

2100BH /

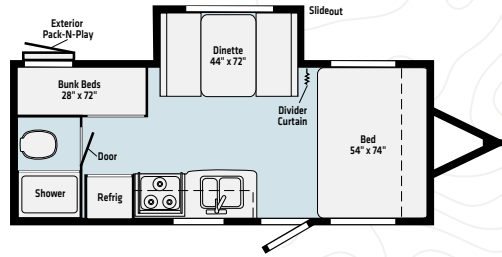

2106FBS /

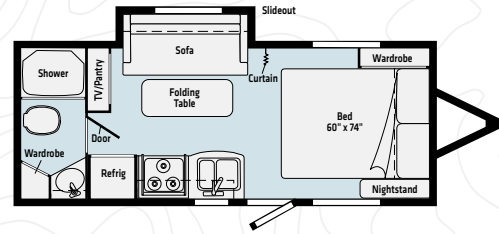

2106DS /

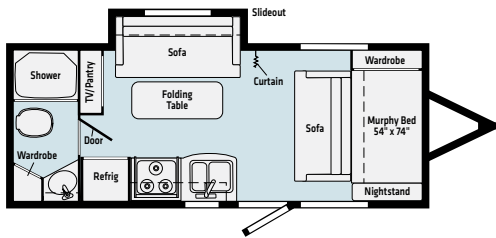

2108DS /

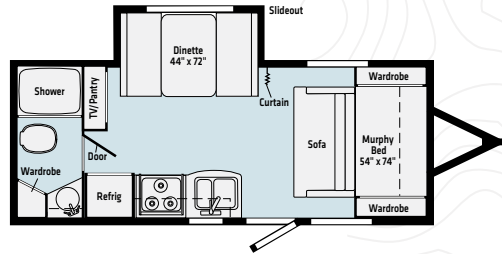

2108FBS /

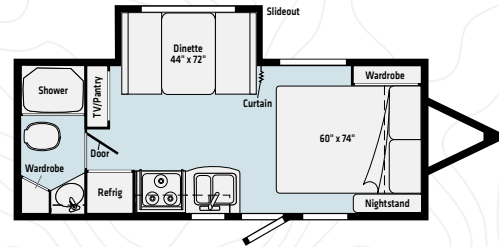

2108TB /

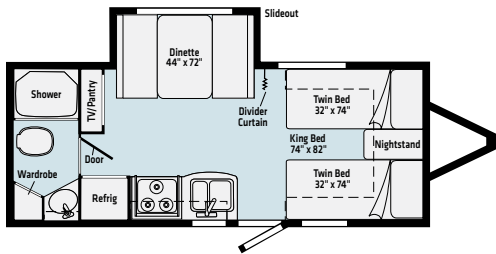

2306BHS /

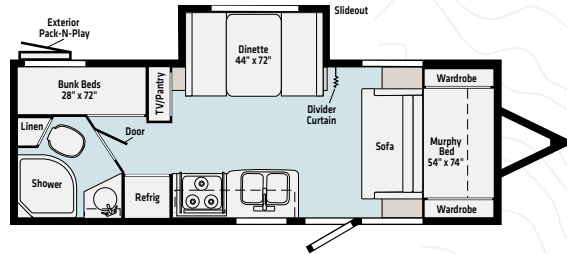

## STANDARD FEATURES

- NXG Engineered Chassis
- Exterior Fiberglass Sidewalls
- 13.5 BTU A/C
- Microwave
- Gas/Electric Refrigerator
- 6 Gallon Gas/Electric/DSI Water Heater
- Aluminum Wheel Assemblies
- Power Awning w/ LED Lighting
- Roof Mount Solar Charger Prep
- Power Tongue Jack
- Drop-In Two Burner Cooktop (1700BH Only)
- Recessed Three Burner Range w/ Glass Top & Oven
- 15" Offroad Tire/Axle Lift
- 3,700lb. Torsion Axles
- LED Exterior Lighting
- Heated & Enclosed Tanks
- Radiant Foil Insulation
- TPO Roof
- Gel-Coat Fiberglass Front Cap
- AV System AM/FM/CD/DVD/USB/Bluetooth
- USB Charge Ports
- TV Antenna
- Exterior Speakers
- LED TV
- Backup Camera Prep
- Wifi Prep
- Wireless Cell Phone Charger
- Convection Microwave (1700BH only)

## OPTIONS

- 15.0 BTU A/C upgrade

BOUND BY THE



WINNEBAGO

# MINNIE TRAVEL TRAILER

COMPACT CAMPER. BIG ADVENTURE.



Standard 60"x80" sleeping areas in all floorplans

- i** Visit [Winnebago.com](http://Winnebago.com) for more info
- +** Join a boundless community of adventurers at [Witclub.com](http://Witclub.com)

Interior photos are of the 2202RBS floorplan with Pearl decor. Exterior photo is of the 2500RL floorplan.



Maximize your cooking experience with Minnie's flush-mount range and large stainless steel sink



Sliderooms expand the Minnie's livable space



**2201MB /**

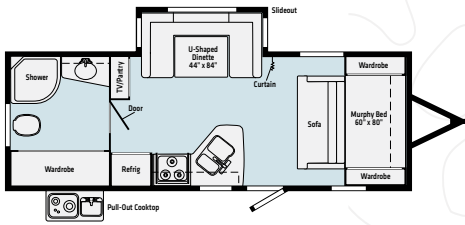

**2401RG /**

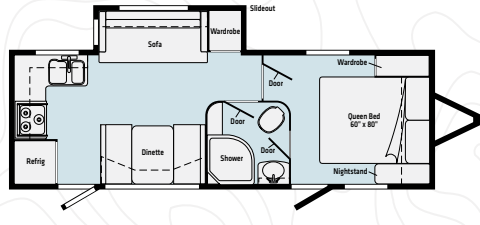

**2455BHS /**

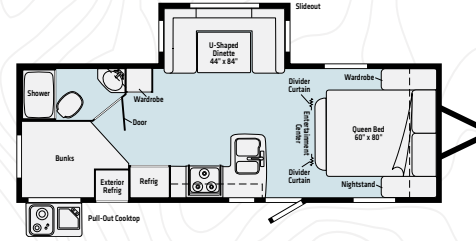

**2500FL /**

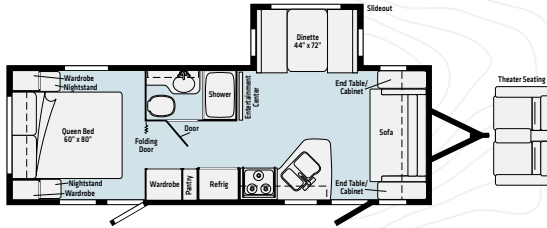

**2500RL /**

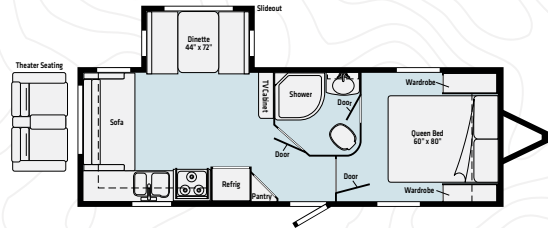

**2701RBS /** — **NEW**

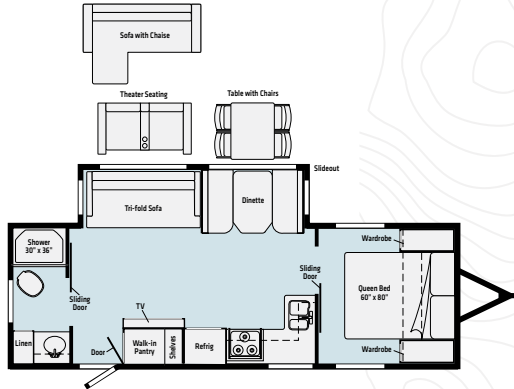

**2801BHS /** — **NEW**

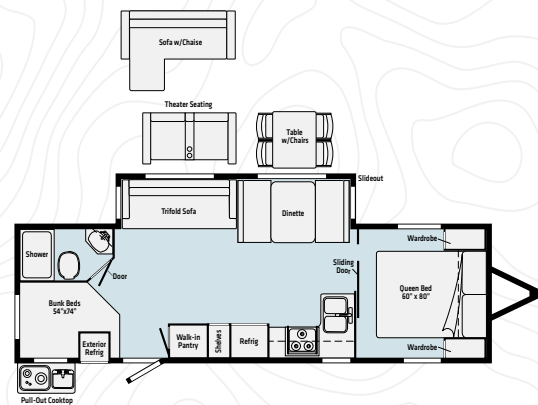

**2202RBS /** — **NEW**

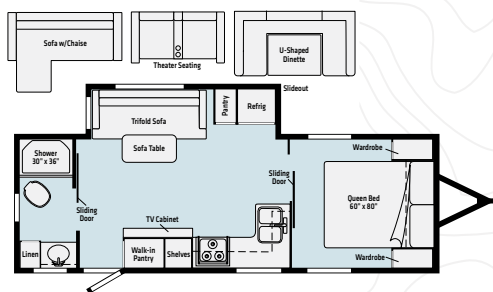

**2301BHS /** — **NEW**

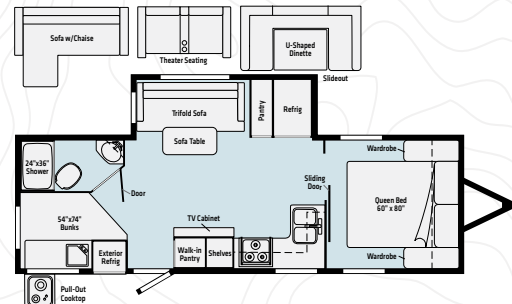

## STANDARD FEATURES

- NXG Engineered Chassis
- Exterior Fiberglass Sidewalls w/ Azdel
- One Piece TPO Roof Membrane
- Fiberglass Front Cap
- 13.5 BTU Roof A/C
- Microwave
- Flush Mount Three Burner Range w/ Glass Top and Oven
- Gas Electric Refrigerator
- 6 Gallon Gas/Electric/DSI Water Heater
- Aluminium Wheel Assemblies
- Heated & Enclosed Tanks
- Power Awning w/ LED Lighting
- Roof Mount Solar Charger Prep
- Power Tongue Jack
- LED Exterior Lights
- Radiant Foil Insulation
- AV System AM/FM/CD/DVD/USB/Bluetooth
- USB Charge Ports
- TV Antenna
- LED TV
- Exterior Speakers
- Backup Camera Prep
- WiFi Prep
- Wireless Cell Phone Charger

## OPTIONS

- L-Chaise Lounge (2701RBS/2801BHS/2202RBS/2301BHS only)
- Theater Seating IPO Sofa (2701RBS, 2801BHS, 2202RBS, 2301BHS only)
- Theater Seating IPO Sofa (2500FL, 2500RL only)
- Freestanding Table w/ 4 Chairs (2701RBS, 2801BHS only)
- 19" LED Bedroom TV (N/A 2201DS, 2201MB)
- U-Shape Dinette (2202RBS, 2301BHS only)
- 30# LP Tanks
- 15.0 BTU A/C Upgrade

**BOUND BY THE**



# SPECIFICATIONS

## MICRO MINNIE



|                   | Exterior Length | Exterior Height<br>(including A/C) | Exterior Width | Interior Height | GVWR<br>(lbs.) | Dry Weight<br>(lbs.) | Dry Hitch<br>Weight (lbs.) | Axles<br>(lbs.) | Tire Size   | Fresh Water<br>(Tank only)(gal.) | Black Tank<br>Capacity (gal.) | Gray Tank<br>Capacity (gal.) | LP Capacity<br>(lbs.) | Awning Length | Furnace (BTU) | Water Heater<br>(gal.) |
|-------------------|-----------------|------------------------------------|----------------|-----------------|----------------|----------------------|----------------------------|-----------------|-------------|----------------------------------|-------------------------------|------------------------------|-----------------------|---------------|---------------|------------------------|
| <b>NEW 1708FB</b> | 19'4.5"         | 10'5"                              | 7'0"           | 6'4"            | 7,000          | 3,360                | 340                        | 2@3,700         | ST235/75R15 | 31                               | 25                            | 25                           | 40                    | 10'           | 18,000        | 6                      |
| <b>1808FBS</b>    | 20'0"           | 10'5"                              | 7'0"           | 6'4"            | 7,000          | 3,760                | 390                        | 2@3,700         | ST235/75R15 | 31                               | 25                            | 25                           | 40                    | 10'           | 18,000        | 6                      |
| <b>1700BH</b>     | 20'9"           | 10'5"                              | 7'0"           | 6'4"            | 3,700          | 3,280                | 380                        | 1@3,700         | ST235/75R15 | 31                               | 25                            | 25                           | 40                    | 12'           | 18,000        | 6                      |
| <b>NEW 1800BH</b> | 21'11"          | 10'5"                              | 7'0"           | 6'4"            | 7,000          | 3,660                | 382                        | 2@3,700         | ST235/75R15 | 31                               | 25                            | 25                           | 40                    | 13'           | 18,000        | 6                      |
| <b>2100BH</b>     | 21'11"          | 10'5"                              | 7'0"           | 6'4"            | 7,000          | 3,860                | 430                        | 2@3,700         | ST235/75R15 | 31                               | 25                            | 25                           | 40                    | 13'           | 18,000        | 6                      |
| <b>2106FBS</b>    | 21'11"          | 10'5"                              | 7'0"           | 6'4"            | 7,000          | 3,840                | 360                        | 2@3,700         | ST235/75R15 | 31                               | 25                            | 25                           | 40                    | 12'           | 18,000        | 6                      |
| <b>2106DS</b>     | 21'11"          | 10'5"                              | 7'0"           | 6'4"            | 7,000          | 3,980                | 360                        | 2@3,700         | ST235/75R15 | 31                               | 25                            | 25                           | 40                    | 13'           | 18,000        | 6                      |
| <b>2108DS</b>     | 22'5"           | 10'5"                              | 7'0"           | 6'4"            | 7,000          | 4,140                | 410                        | 2@3,700         | ST235/75R15 | 31                               | 25                            | 25                           | 40                    | 12'           | 18,000        | 6                      |
| <b>2108FBS</b>    | 22'5"           | 10'5"                              | 7'0"           | 6'4"            | 7,000          | 4,000                | 410                        | 2@3,700         | ST235/75R15 | 31                               | 25                            | 25                           | 40                    | 12'           | 18,000        | 6                      |
| <b>2108TB</b>     | 22'5"           | 10'5"                              | 7'0"           | 6'4"            | 7,000          | 4,040                | 435                        | 2@3,700         | ST235/75R15 | 31                               | 25                            | 25                           | 40                    | 12'           | 18,000        | 6                      |
| <b>2306BHS</b>    | 25'5"           | 10'5"                              | 7'0"           | 6'4"            | 7,000          | 4,500                | 495                        | 2@3,700         | ST235/75R15 | 31                               | 25                            | 25                           | 40                    | 15'           | 18,000        | 6                      |



### 3 Year Limited Structural Warranty:

The Winnebago Towables Limited Structural Warranty covers your RV for a period of three (3) years from the date of purchase by the original owner. This structural warranty covers the workmanship attributable to Winnebago's manufacturing and assembly of the structural portions of your RV. Structural coverage includes:

- Main steel frame
- Steel frame outriggers and cross members
- Skeletal framing (wall studs, floor joists, roof rafters)
- Sidewall assembly
- Roof assembly
- Roof materials installation
- Flooring assembly
- All slideout boxes and applicable structural assembly
- Fiberglass front caps (paint fade cracking)

### 1 Year Limited Base Warranty:

In addition to the 3-Year Limited Structural Warranty, the Winnebago Towables Limited Base Warranty covers your RV for a period of one (1) year from the date of purchase by the original owner. This limited warranty covers defects in materials and workmanship supplied by and attributed to Winnebago's manufacturing and assembly of the RV.



## MINNIE



|                    | Exterior Length |       | Exterior Height<br>(Including A/C) |      | Exterior Width |       | Interior Height |           | GVWR (lbs.)    |    | Dry Weight (lbs.) |    | Dry Hitch Weight (lbs.) |     | Axles (lbs.) |   | Tire Size |  | Fresh Water<br>(Tank only)(gal.) |  | Black Tank<br>Capacity (gal.) |  | Gray Tank<br>Capacity (gal.) |  | LP Capacity (lbs.) |  | Awning Length |  | Furnace (BTU) |  | Water Heater<br>(gal.) |  |
|--------------------|-----------------|-------|------------------------------------|------|----------------|-------|-----------------|-----------|----------------|----|-------------------|----|-------------------------|-----|--------------|---|-----------|--|----------------------------------|--|-------------------------------|--|------------------------------|--|--------------------|--|---------------|--|---------------|--|------------------------|--|
| <b>2201MB</b>      | 26'9"           | 10'9" | 8'0"                               | 6'5" | 7,000          | 4,900 | 575             | 2 @ 3,500 | ST205/75R-14D  | 37 | 25                | 41 | 40                      | 17' | 25,000       | 6 |           |  |                                  |  |                               |  |                              |  |                    |  |               |  |               |  |                        |  |
| <b>2401RG</b>      | 27'11"          | 10'9" | 8'0"                               | 6'5" | 7,000          | 5,060 | 640             | 2 @ 3,500 | ST225/75R-14D  | 37 | 25                | 50 | 40                      | 19' | 25,000       | 6 |           |  |                                  |  |                               |  |                              |  |                    |  |               |  |               |  |                        |  |
| <b>2455BHS</b>     | 27'11"          | 10'9" | 8'0"                               | 6'5" | 7,000          | 5,320 | 660             | 2 @ 3,500 | ST205/75-14D   | 37 | 25                | 41 | 40                      | 19' | 25,000       | 6 |           |  |                                  |  |                               |  |                              |  |                    |  |               |  |               |  |                        |  |
| <b>2500FL</b>      | 27'11"          | 10'9" | 8'0"                               | 6'5" | 7,000          | 5,140 | 700             | 2 @ 3,500 | ST205/75R-14D  | 37 | 25                | 41 | 40                      | 18' | 25,000       | 6 |           |  |                                  |  |                               |  |                              |  |                    |  |               |  |               |  |                        |  |
| <b>2500RL</b>      | 27'11"          | 10'9" | 8'0"                               | 6'5" | 7,000          | 5,080 | 700             | 2 @ 3,500 | ST205/75R-14D  | 37 | 25                | 41 | 40                      | 20' | 25,000       | 6 |           |  |                                  |  |                               |  |                              |  |                    |  |               |  |               |  |                        |  |
| <b>NEW 2701RBS</b> | 29'6"           | 11'   | 8'0"                               | 6'5" | 8,800          | 6,300 | 660             | 2 @ 4,400 | ST225/75R-15 E | 37 | 28                | 69 | 40                      | 14' | 30,000       | 6 |           |  |                                  |  |                               |  |                              |  |                    |  |               |  |               |  |                        |  |
| <b>NEW 2801BHS</b> | 32'7.5"         | 11'   | 8'0"                               | 6'5" | 8,800          | 6,510 | 820             | 2 @ 4,400 | ST225/75R-15 E | 43 | 28                | 82 | 40                      | 21' | 30,000       | 6 |           |  |                                  |  |                               |  |                              |  |                    |  |               |  |               |  |                        |  |
| <b>NEW 2202RBS</b> | 27'1"           | 11'   | 8'0"                               | 6'5" | 8,800          | 5,620 | 580             | 2 @ 4,400 | ST225/75R-15 E | 37 | 28                | 69 | 40                      | 14' | 30,000       | 6 |           |  |                                  |  |                               |  |                              |  |                    |  |               |  |               |  |                        |  |
| <b>NEW 2301BHS</b> | 29'10"          | 11'   | 8'0"                               | 6'5" | 8,800          | 5,960 | 660             | 2 @ 4,400 | ST225/75R-15 E | 37 | 28                | 82 | 40                      | 18' | 30,000       | 6 |           |  |                                  |  |                               |  |                              |  |                    |  |               |  |               |  |                        |  |

## EXTERIOR COLOR OPTIONS



Brilliant Silver



White

## 1 ROOF CONSTRUCTION

- Walkable roof, with 3/8" decking and rafters on 16" centers
- TPO exterior
- Double insulation; fiberglass insulation and Extreme Weather Radiant Foil insulation

## 2 LAMINATED SIDEWALL

- Max Fiberglass Sidewall by Crane Composites
- Aluminum frame structure
- Multi-layer design including Azdel composite panel & block foam insulation

## 3 FLOOR CONSTRUCTION

- Tongue & groove plywood flooring
- Aluminum frame structure
- Double insulated multi-layer design including fiberglass and Extreme Weather Radiant Foil insulation
- Heated and enclosed underbelly
- Heated holding tanks (select models)



## 4 FULLY INSULATED FRONT CAP WITH FIBERGLASS AND EXTREME WEATHER RADIANT FOIL INSULATION

## 5 BAL NXG CHASSIS

## 6 POWER FRONT TONGUE JACK

## 7 POWER AWNING

## 8 INSULATED SLAM LATCH BAGGAGE DOORS

## 9 NITRO FILL TIRES WITH ALUMINUM RIMS

## 10 STANDARD REAR LADDER (SELECT MODELS)



### TPO ROOFING

A durable, bacteria-resistant material protects against debris, algae, ultraviolet and chemical exposure. Its flexible membrane allows it to withstand punctures, tears, and impact-related damage.

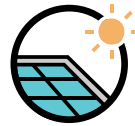

### ROOF-MOUNTED SOLAR PREP

Prewired for this quiet alternative to generators, this system offers flexible camping options, and lower emissions while providing uninterrupted power to lights, furnaces, fans, and DC appliances.



### COLOR-CODED WIRING

Easy-to-trace circuits simplify electrical and other system troubleshooting, reducing service time.



### AZDEL MATERIALS

A durable, lightweight material protects from moisture and high temperatures to increase RV lifespan by reducing the risk of mold, decay and rot.

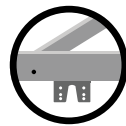

### ADJUSTABLE FRAME

Increased axle height allows owners to travel off the beaten path.

- Maintenance points are easier to access when the axles are set in high position.
- The axle can be lowered to provide several extra inches of clearance.

Every Towable is equipped with Winnebago's Comfort Tech and Explorer Packages.

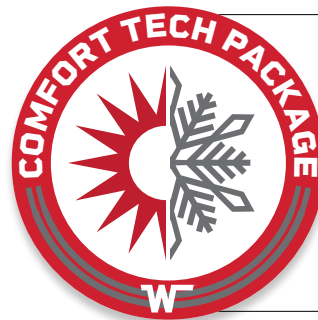

- Laminated, block foam sidewalls
- Extreme Weather Radiant Foil wrapping
- Roof-mount A/C systems
- Insulated heating ducts
- Heated tanks
- Enclosed underbelly



- Roof-mount solar prep
- Larger, off-road tires
- Propane heating system
- Heavy duty axles & suspension
- WiFi prep
- Battery disconnect
- Awning with LED lighting



# TOWABLES BRAND STORY

## Brand Promise

Winnebago gives you a community to belong to that pushes the boundaries of every adventure.

## The Winnebago Towable Legacy

Towables are in Winnebago's DNA. In fact, Winnebago was founded in 1958, originally as a travel trailer manufacturer. Since then, we have evolved our towables offering to not just meet, but exceed, the demands of our consumers. Inspired by our founder, industry pioneer John K. Hanson, we continue to push what's possible in the towable category through relentless innovation.

## Our Brand Positioning: United and Boundless

We are for the boundless adventurers and travelers who have a drive for experiencing what's next with those who matter to us most. Winnebago provides a community united by pride and a sense of belonging. With our commitment to quality, innovation and consumer trust, we take you further, for longer. So that you can always be bound by the adventure ahead.

## Committed to Dealer Success

When a dealer partners with Winnebago, they experience support that is unmatched by any other. We only allow one dealer per market. This means less competition, greater return on the dealer's investment, and a consistent customer experience. Better point of service, and response time, translates into happy customers. Our owner communities are passionate and unlike any other, and that is directly influenced by their satisfaction and advocacy for our brand.



## You Don't Just Buy Winnebago, You Join Winnebago

### A COMMUNITY UNITED BY BRAND PRIDE

- A community of proud Winnebago owners with support and advice
- Pre-planned and curated community adventures
- WIT Club—A passionate club of boundless adventurers

## Towables Point of Differentiation

### A HISTORY OF INNOVATIVE FIRSTS IN THE CATEGORY

- Innovative floorplans and design for spacious living and storage
- Equipped with industry-leading technology
- Unmistakable interior and exterior style

### RELY ON THE W FOR SUPERIOR SERVICE AND SUPPORT

- Dedicated parts and service teams
- Experienced technical support professionals
- Unparalleled dealer relations

### HIGH QUALITY CONSTRUCTION, BUILT TO GO FURTHER

- Superior, cutting-edge construction
- Thoughtfully designed service access
- Commitment to high-quality materials





Are you a Winnebago towables owner? Join our WIT TOWS owners group & tour the factory! Email [ceby@wgo.net](mailto:ceby@wgo.net) for more information.



**Coach-Net**

**1-Year Roadside Assistance Included with vehicle purchase.**

*Learn more at [www.coach-net.com/winntow](http://www.coach-net.com/winntow).*



Connect with other Micro Minnie and Minnie owners on the **Winnebago** Facebook page and other social media platforms



**WIT  
CLUB**

[www.witclub.com](http://www.witclub.com)



**Have a question about the Minnie Family?**  
*Email [SalesWOI@WGO.net](mailto:SalesWOI@WGO.net).*

**WINNEBAGO**  
**BOUND BY THE W™**

**Winnebago Towables**

201 14th Street  
Middlebury, IN 46540

(574) 825-5250

[www.Winnebago.com](http://www.Winnebago.com)

**Your Winnebago Dealer**

