

# ARCTIC FOX

North Fork Travel Trailers & Grande Ronde Fifth Wheels



**EXPLORE**  
**QUALITY**



SEE ALL THAT'S NEW AT OUR WEBSITE  
[WWW.NORTHWOODMFG.COM](http://WWW.NORTHWOODMFG.COM)

# EXPLORE QUALITY



WINDSWEEP SERENITY INTERIOR



**SOLITAIRE AZUL INTERIOR**



**DESERT PALMS INTERIOR**



**EXPLORE  
QUALITY**

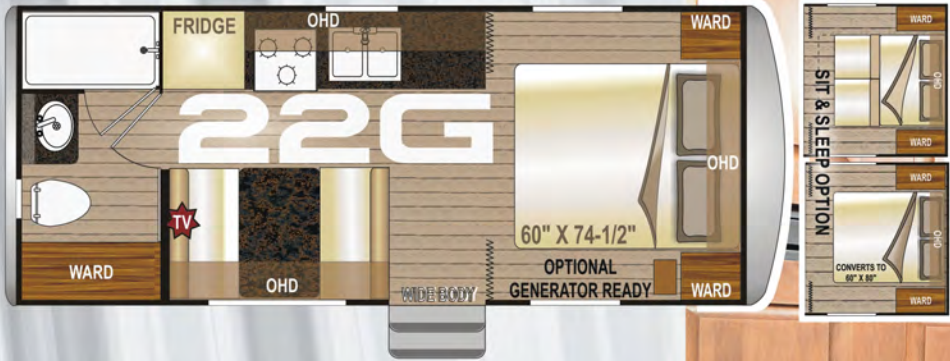

# ARCTIC FOX NORTH FORK TRAVEL TRAILERS



22G WINDSWEPT SERENITY



25R SOLITAIRE AZUL



ARCTIC FOX NORTH



25W SOLITAIRE AZUL

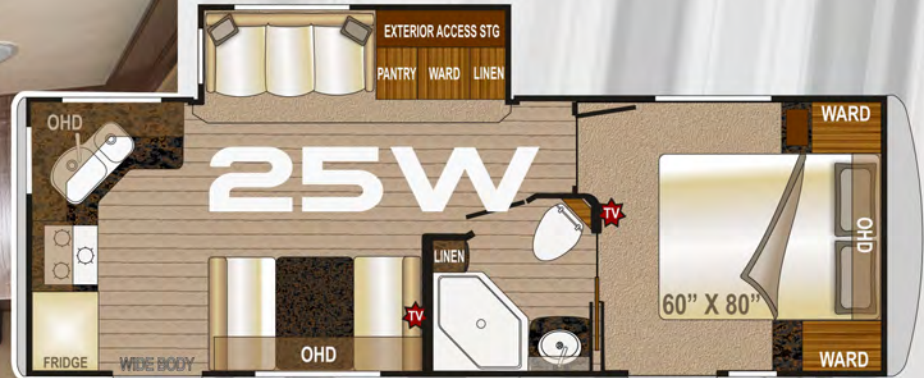

EXPLORE  
QUALITY



25Y WINDSWEPT SERENITY

FORK TRAVEL TRAILERS

EXPLORE  
QUALITY



28F DESERT PALMS

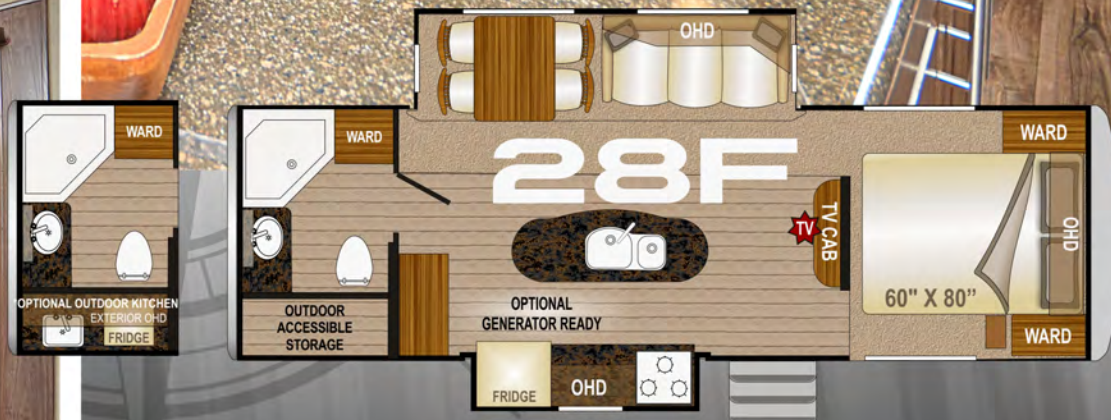

ARCTIC FOX NORTH



# NORTH FORK



32A WINDSWEPT SERENITY



FORK TRAVEL TRAILERS



EXPLORE  
QUALITY



# What is ABSOLUTE NORTHWOOD?

Our Commitment to:



**QUALITY  
STRENGTH  
DURABILITY**

When you purchase an Arctic Fox, you are investing in the best quality materials, construction and craftsmanship. That is why the resale value in an Arctic Fox remains higher, and your investment retains its value longer. If you ever decide to trade in your Fox, you will get top dollar. That is why you don't see many used Arctic Foxes on the market, folks buy them up as quickly as they become available because Arctic Fox has a reputation for durability and longevity.



## CHASSIS

Custom Built, Tested, Certified



## FRAME

Thick Wall Aluminum w/Solid Anchor Blocking



## ROOF

Full Walk On, Bonded Roof Truss System



## CABINETS

Wall & Ceiling Mounted, Face Frame Construction



## INSULATION

A True 4 Season Coach

# NORTHWOOD BUILT CERTIFIED CHASSIS

## CERTIFIED CHASSIS



### PACIFIC WEST ASSOCIATES, INC

UTILIZING AEROSPACE INTERFACE GRID TECHNOLOGY DESIGN ANALYSIS FOR OPTIMUM PERFORMANCE AND SAFETY

### BUILT BY NORTHWOOD

## WE BUILD OUR OWN HEAVY DUTY STRUCTURAL STEEL OFF-ROAD CHASSIS

We are one of the few manufacturers that build their own chassis. The name NORTHWOOD is known throughout the industry for quality chassis and we certify ours through an independent testing laboratory for quality assurance.



# THICK WALL TUBULAR ALUMINUM SUPERSTRUCTURE

.060"-.125"  
(Up to 1/8" Thick)  
heavy gauge thick wall aluminum tubing in our travel trailers & fifth wheels.



## SOLID CORE ANCHOR BLOCKING AND CONTINUOUS WELDS

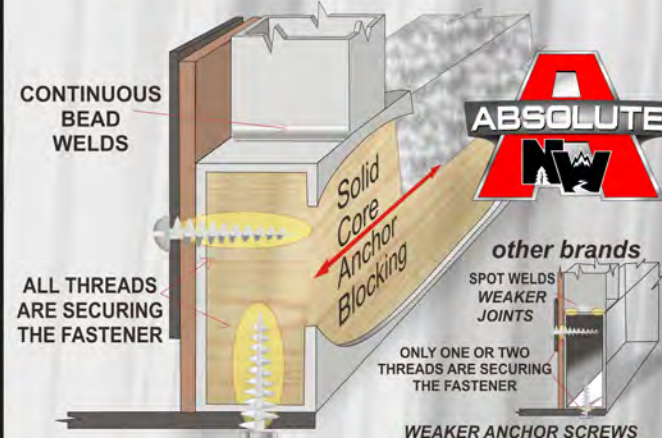

# Now that's an ABSOLUTE Quality Superstructure!



# BONDED ROOF TRUSS/ FULL WALK-ON ROOF

BONDED ROOF TRUSS SYSTEM WITH CATHEDRAL ARCHED CEILING



UP TO 4" OF EXTRA HEADROOM

The Northwood Bonded Roof Truss System bonds all the components of the roof structure together as a unit. The ceiling, trusses and roof plywood are unified in a bonded system that gives superior load distribution and maximum load bearing capacity.

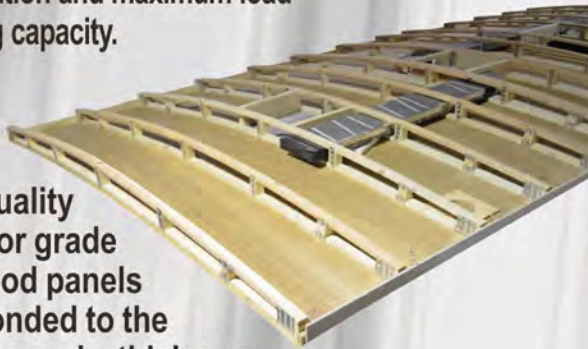

Top quality exterior grade plywood panels are bonded to the trusses and a thick one piece roofing membrane is then applied for a durable, long lasting seal to protect you and your coach from the elements.



# CUSTOM BUILT FACE FRAME CABINETS

CABINERY w/SOLID WOOD DOORS,  
BUILT USING RESIDENTIAL FACE FRAME  
CONSTRUCTION METHODS &  
INTEGRATED WITH THE WALL & CEILING.

## BEAUTIFUL & STRONG



MATERIALS



CONSTRUCTION



INSTALLATION

Solid Wood  
cabinet doors ensure  
lasting beauty and  
regged strength.



Face Frame  
construction gives our  
cabinets 'high end'  
residential quality.



Structurally Integrated  
cabinetry is  
anchored to the  
walls and ceiling  
structure of our  
coaches making both  
the RV and the  
cabinets stronger.

# A TRUE FOUR SEASON ALL CONDITIONS UNIT



HEATED ENCLOSED HOLDING TANKS & DUMP VALVES  
DESIGNED FOR COLD NORTHERN/HOT SOUTHERN CLIMATES

Northwood builds true 4-Season Coaches. Our fully insulated holding tank area circulates warm air around the suspended tanks providing the best protection from freezing. Our knife valves are also enclosed to keep them from freezing. Our 4-Season coaches are insulated with various types of residential quality Rigid Foam, Batten & Reflective Foil insulation to protect you from the winter cold & summer heat.



27-5L SOLITAIRE AZUL



**ARCTIC FOX  
GRANDE RONDE  
5TH WHEELS**

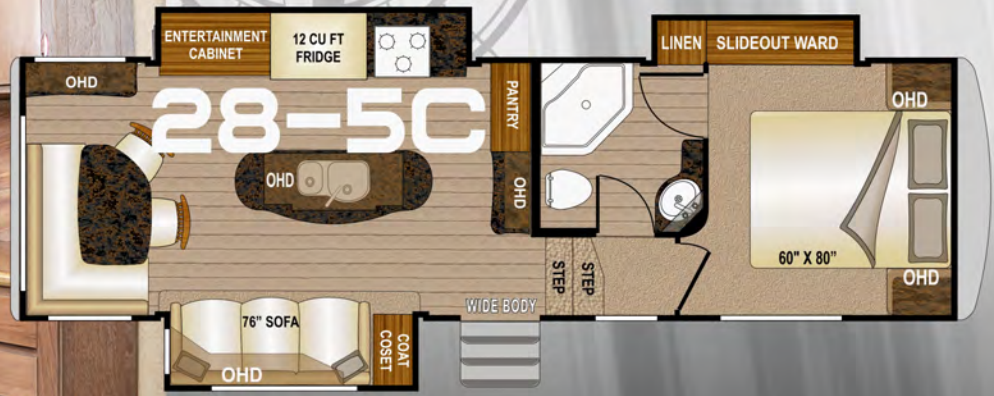

28-5C DESERT PALMS

**ARCTIC FOX GRANDE**

29-5K WINDSWEPT SERENITY

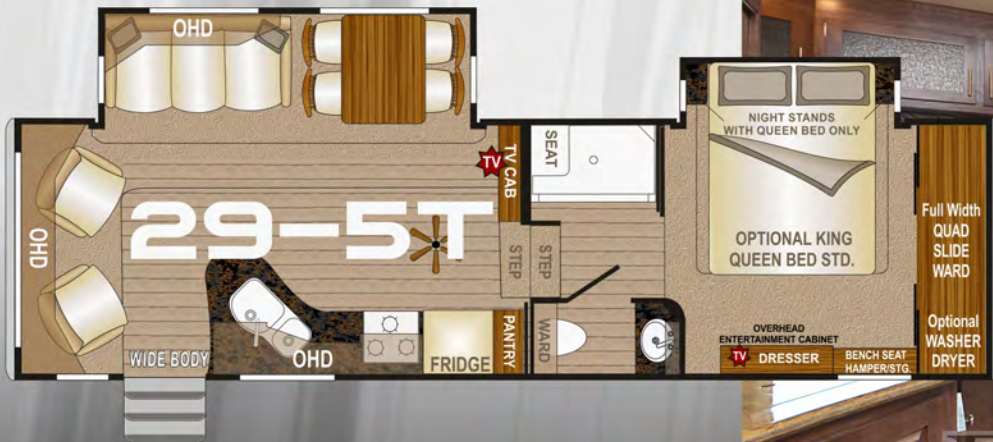
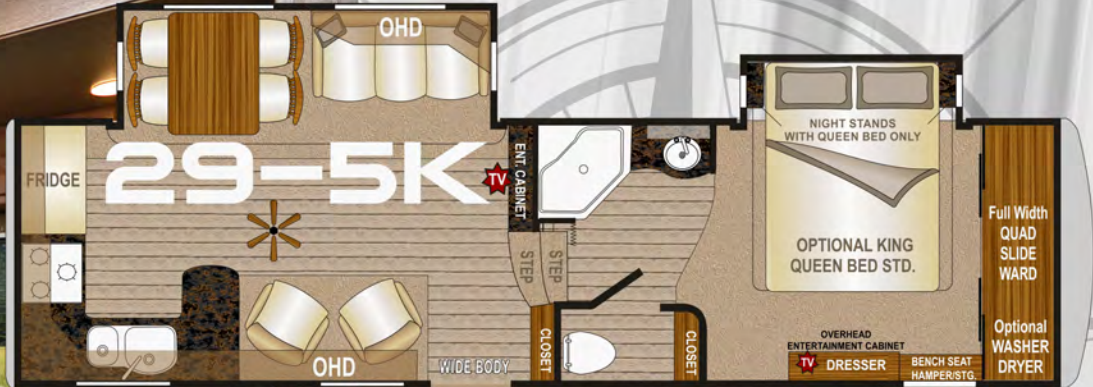

EXPLORE  
QUALITY

29-5T DESERT PALMS

RONDE 5TH WHEELS

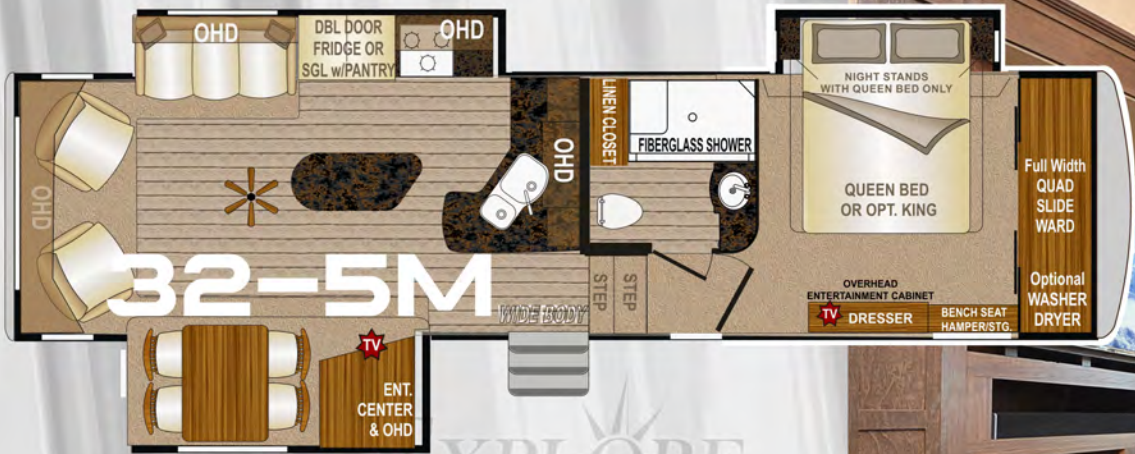

# ARCTIC FOX GRANDE RONDE 5TH WHEELS



# GRANDE RONDE

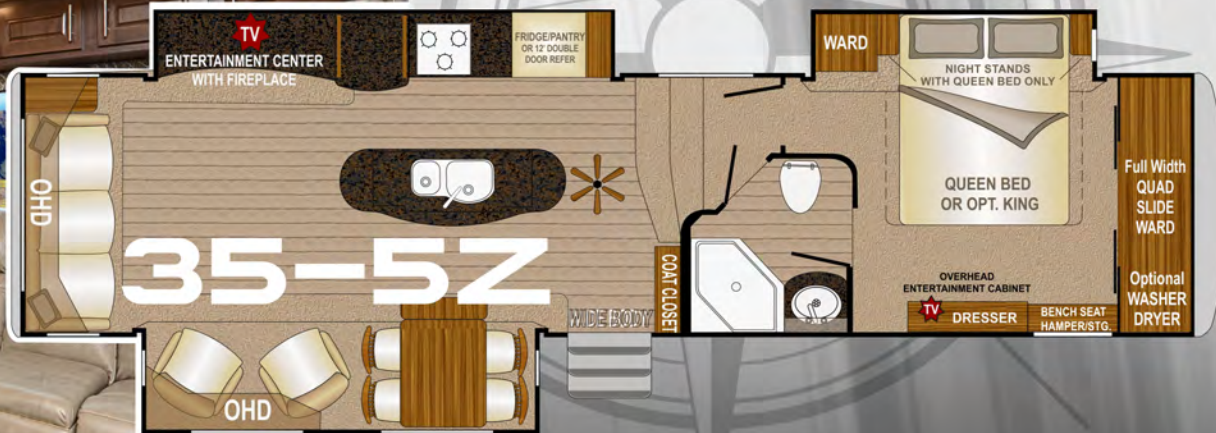



# EXPLORE NORTHWOOD QUALITY



## ROOF

Full Walk On Roof with Bonded Roof Truss System

## FRAME

Thick Wall Aluminum w/Solid Anchor Blocking

## SLIDE OUTS

4 Seals, Dual Rack & Pinion Rams (main slides) Insulated, Cross Ventilating Windows

## FLOORS

Commercial Grade Linoleum, Fully Insulated Tongue and Groove Plywood (not chipboard)

## CHASSIS

Custom Built, Independently Tested & Certified

## CABINETS

Wall & Ceiling Mounted, Face Frame Construction

## INSULATION

A True 4 Season Coach

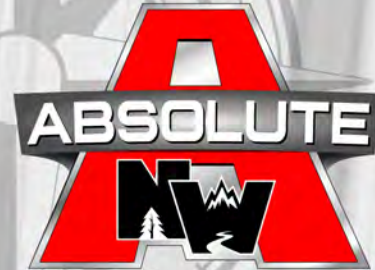

### D DUAL RACK & PINION RAM MAIN SLIDE ROOM

- 22 Gray Accent Fiberglass Finish on Slide Out Side Wall
- 23 4 Seal System
- 24 w/Inner & Outer Bulb Seal ...including Wiper Seal
- 25 Continual Seal in Any Position ...and Outer Bulb Seals

### A NORTHWOOD ROOF TRUSS SYSTEM

- 1 Heavy Gauge One Piece Roof Membrane
- 2 3/8" Plywood Sheathing (Bonded to Trusses)
- 3 R-15 Reflective 'Arctic' Foil Insulation
- 4 R-18 Dual Layer Fiberglass Insulation
- 5 Bow Style Roof Trusses (Bonded to Ceiling)
- 6 Interior Lamination Grade Luan Plywood
- 7 Ozite Ceiling Carpet Finish (Silver Fox only)

### B HIGH DENSITY ONE PIECE LAMINATED WALLS

- 9 Designer Interior Decor Finish Paneling
- 10 Heavy Gauge Fully Welded Aluminum Superstructure
- 11 Solid Wood Fill - Full Thread Depth Anchor Blocking
- 12 Virgin 2 lb Rigid Dense Block Foam Insulation
- 13 Steel Inlaid Bonderizer Anchor Strips
- 14 Lamination Grade Luan Plywood Exterior Wall Layer
- 15 Second Luan Layer
- 16 Corona Treated High Durability Fiberglass Outer Layer

### C ULTIMATE DURABILITY FLOOR STRUCTURE

- 17 Residential Quality Plush Commercial Carpeting
- 18 Commercial Grade Linoleum with 20 mil Surface
- 19 5/8" T&G Plywood Decking (not chipboard)
- 20 R-7 Residential Grade Fiberglass Insulation
- 21 Reinforced Woven Highway Moisture Barrier

### E MORE ABSOLUTE NORTHWOOD QUALITY FEATURES

- 26 Independently Certified Custom Built Northwood Chassis
- 27 R-7 Residential Quality Formaldehyde Free Fiberglass Insulation
- 28 Corrugated Underbelly Panels
- 29 Heated and Insulated Large Capacity Holding Tanks
- 30 Easy Lube Axles and Shocks
- 31 Heavy Duty Radial Tires
- 32 Sealed All Metal Heat Ducts
- 33 Aerodynamic Fiberglass Front Cap
- 34 Mor/ryde RPB pin box
- 35 All Foam Condensation Resistant A/C Ducts
- 36 Extra Large 'Starlite' Bedroom Skylight
- 37 Large Skylight
- 38 Hi Output Roof Mount A/C
- 39 Roto Molded High Durability Wheel Skirts
- 40 Diamond Scored Sidewall Skirts
- 41 Diamond Plate Gravel Guard

*Our Northwood Built Chassis are Independently Tested & Certified by Pacific West Associates, Inc.*

*Arctic Fox is a True Four Season Coach*



EXPLORE QUALITY



My wife and I retired in 2015 and decided to be fulltime RVers. So we purchased a new 2015 Arctic Fox 32-5M which has served us well. We have lived in it fulltime and traveled over 40,000 miles mostly in the western states. Then we got the urge to visit Alaska in a smaller RV. So we purchased a new 2017 Arctic 865 truck camper. So we parked the fifth wheel in southern Arizona and took off on a 5 month 12,000 mile adventure to a Alaska. We are back in our fifth wheel home now and just wanted to let you know that neither RV as ever been to a shop for repairs. We are happy campers. Doak Walker

07 12 2016



Bill Zawlocki



Attached are several photos I took during a recent camping and fishing trip to Bishop Creek Canyon in the Inyo National Forest in California. There are several campgrounds in the canyon. I stayed at Big Trees Campground, a small beautiful campground located adjacent to Bishop creek. The Arctic Fox performed flawlessly!  
Robert Tranter



This will be our third "real" winter. With proper preparation, our Arctic Fox keeps us warm and comfortable all winter long. We have already weathered a few nights this winter below zero and have not had any problems. We don't stop playing because we grow older, we grow older because we stop playing. Arleen & Shawn Prochazka

2018 NROA Rally Photo Contest Winner

We are on an eleven week Canada / Alaska excursion with our 2016 Arctic Fox 29-5T. Cold, heat, rain, Yukon roads, dust, our Arctic Fox has handled it all with flying colors!  
Dave & Donna, Rocklin, California

EXPLORE  
QUALITY





**ABSOLUTE  
NORTHWOOD**

Our Commitment to  
 ✓ QUALITY  
 ✓ STRENGTH  
 ✓ DURABILITY



## ARCTIC FOX NORTH FORK TRAVEL TRAILERS

| Standard Features                                          | Options                               |
|------------------------------------------------------------|---------------------------------------|
| Northwood Built, Independently Certified, Off-Road Chassis | Powered Scissor Jacks, Front and Rear |
| Fully Welded, Thick-Wall Aluminum Frame Construction       | Battery Box Kit                       |
| One-Piece, Corona Treated, Continuous Fiberglass           | Alumaguard Main Awning                |
| Hot, Polyurethane Laminated Multi-Layered Substrate Walls  | 15K Low Pro Air Conditioner w/Ducting |
| High Density Block Foam Insulation                         | 15K Air Conditioner w/ Ducting        |
| Wide-Body Floorplan                                        | Holding Tank Heat Pads (All Tanks)    |
| E-Z Lube Axles w/NeV-R Adjust Forward                      | Bedroom Carpet w/Pad                  |
| Self Adjusting Brakes                                      | 2.5 Onan LP Gen---                    |
| Aluminum Wheels / Tires & White Mod Spare                  | ---(tied to 11K A/C option)           |
| Shocks On All Four Wheels                                  | 100 Watt Solar Panel                  |
| Stabilizer Jacks / MORryde Step Above w/Strut Assist       | 170 Watt Solar Panel                  |
| All-Conditions/Four Seasons Insulation With R-18 Ceiling   | Winegard Carryout G2+ Sat Dish---     |
| R-15 Reflective Foil Insulation in Roof                    | ---(DISH/DIRECT)                      |
| Heated Holding Tanks / Cathedral Arched Ceiling            | 11K Pwr Saver A/C---                  |
| Aerodynamic One Piece Front Cap w/BackRoad Armor           | ---(use w/2.5 Generator option)       |
| 2 Independently Switched LED Hitch Lights                  | Aussie Grill w/Stand                  |
| Easy Access LP Cover / Diamond Plate Bumper Wrap           | Rear View Camera                      |
| LED Interior & Exterior Lighting                           | Gateway Router                        |
| Roof Rack & Ladder / Omni-Directional TV Antenna           |                                       |
| SLAM Door Latches on Pass Thru Storage Doors               |                                       |
| 12V Light in Storage Compartment                           |                                       |
| LPG Quick Connect & Black Water Flush System               |                                       |
| Large Exterior Entry Grab Handle                           |                                       |
| Entry Door Friction Hinge                                  |                                       |
| Exterior Shower / 2 Afox Logo Director's Chairs            |                                       |
| Semi-Automatic Winterization/By-Pass System                |                                       |
| 10 Gal DSI Gas/Elect Quick Recovery Water Heater           |                                       |
| 13.5m BTU Air Conditioner w/Condensation-Resistant Ducting |                                       |
| Carefree Travel'R 12V LED Awning w/Adjustable Pitch HW     |                                       |
| 20 Watt Solar Panel / Sidewall Solar Port                  |                                       |
| 12-Volt Power Tongue Jack                                  |                                       |
| Outside Speakers / Battery Disconnect                      |                                       |
| Thermal Pane Windows                                       |                                       |
| Generator Ready / Satellite Ready / Solar Ready            |                                       |
| Interior Command Center                                    |                                       |
| AFox Signature Throw Blanket                               |                                       |
| Roller Bearing Drawer Glides                               |                                       |
| Fabric Night Shade Window Treatments                       |                                       |
| 12v LED TV & AM/FM/CD/DVD Player w/Bluetooth               |                                       |
| Smoke, LPG & CO Leak Detectors                             |                                       |
| Solid Surface Kitchen Countertops                          |                                       |
| Charge Wizard / Digital Thermostat                         |                                       |
| Residential, Built-In Microwave / Range Cover              |                                       |
| Large Fridge (10 Cu Ft) w/ Multiple Raised Panels          |                                       |
| Arctic Fox Signature Clock & Entry Mat                     |                                       |
| Solid Surface Bathroom Countertops w/SS Sink               |                                       |
| Daylitter Kitchen Skylight w/ Shade                        |                                       |
| FanTastic Vent (Bedroom)                                   |                                       |
| Porcelain, Foot-Pedal Toilet / Bath Skylight               |                                       |
| FanTastic Vent - Bathroom (Exhaust Only)                   |                                       |
| Glass Shower Enclosure / Shower Pan                        |                                       |
| NW TruRest Queen Mattress w/ Bedspring                     |                                       |
| Recessed Storage Headboard w/LED Accent Lighting           |                                       |
| Built-In Laundry Chute                                     |                                       |
| USB Charging Ports on Both Sides of Bed                    |                                       |



## ARCTIC FOX GRANDE RONDE 5TH WHEELS

| Standard Features                                            | Options                                  |
|--------------------------------------------------------------|------------------------------------------|
| Northwood Built, Independently Certified, Off-Road Chassis   | 32" 110V LED Smart TV Bedroom            |
| Fully Welded, Thick-Wall Aluminum Frame Construction         | Surround-Soundbar                        |
| One-Piece, Corona Treated, Continuous Fiberglass             | Slide-Out Topper                         |
| Hot, Polyurethane Laminated Multi-Layered Substrate Walls    | Alumaguard Main Awning                   |
| High Density Block Foam Insulation                           | 15K Low Pro Air Conditioner w/Ducting--- |
| Wide-Body Floorplan/MORryde Step Above w/Strut Assist        | ---50 Amp Service Required               |
| E-Z Lube Axles w/NeV-R Adjust Forward, Self Adjusting Brakes | 15K Air Conditioner w/ Ducting           |
| Heavy Duty Greaseable Suspension                             | 2nd A/C (Low Pro 13.5K)---               |
| 16" Aluminum Wheels / Tires & White Mod Spare                | ---Replaces Bdrm Fan Vent                |
| MORryde RPB Pin Box / Leveling System                        | 50 Amp Service                           |
| All-Conditions/Four Seasons Insulation With R-18 Ceiling     | Slow Rise Night Shades                   |
| R-15 Reflective Foil Insulation in Roof / Slides             | Holding Tank Heat Pads (All Tanks)       |
| Heated Holding Tanks / Cathedral Arched Ceiling              | Powered Sliding Stab Jacks, Rear         |
| Aerodynamic One Piece Front Cap                              | 3.6 Onan LP Generator                    |
| 2 Independently Switched LED Hitch Lights                    | 5.5 Onan Gold LP Gen...                  |
| Fiberglass Rear Cap / LED Cap Accent Lights                  | ...50 Amp Service Required               |
| LED Interior & Exterior Lighting                             | 100 Watt Solar Panel                     |
| Roof Rack & Ladder / 20 Watt Solar Panel                     | 170 Watt Solar Panel                     |
| Exterior Convenience Center / Sidewall Solar Port            | Winegard Carryout G2+...                 |
| SLAM Latch Luggage Doors                                     | ...Sat Dish (DISH/DIRECT)                |
| Magnetic Lugg Door Catches                                   | (HD Sat-Call For Options)                |
| LPG Quick Connect & Black Water Flush System                 | Aussie Grill w/Stand                     |
| Large Exterior Entry Grab Handle                             | Rear View Camera                         |
| Entry Door Friction Hinge                                    | Gateway Router                           |
| Exterior Shower / 2 Afox Logo Director's Chairs              |                                          |
| Semi-Automatic Winterization/By-Pass System                  |                                          |
| 16 Gal DSI Gas/Elect Quick Recovery Water Heater             |                                          |
| 13.5m BTU Air Conditioner w/Condensation-Resistant Ducting   |                                          |
| Carefree Travel'R 12V LED Awning w/Adjustable Pitch HW       |                                          |
| 12v Power Landing Gear                                       |                                          |
| Omni-Directional TV Antenna                                  |                                          |
| Outside Speakers/Battery Disconnect                          |                                          |
| Thermal Pane Windows / Exterior Security Lights              |                                          |
| Generator Ready / Satellite Ready / Solar Ready              |                                          |
| Livingroom & Bedroom Carpet w/ Pad                           |                                          |
| Interior Command Center                                      |                                          |
| AFox Signature Throw Blanket                                 |                                          |
| Digital Thermostat                                           |                                          |
| Roller Bearing Drawer Glides                                 |                                          |
| Fabric Night Shade Window Treatments                         |                                          |
| 110 LED Smart TV & AM/FM/CD/DVD Player w/Bluetooth           |                                          |
| Solid Surface Kitchen Countertops                            |                                          |
| Furrion Cooking Suite                                        |                                          |
| 1.5 Cu Ft Over-The-Range                                     |                                          |
| Smoke, LPG & CO Leak Detectors / Charge Wizard               |                                          |
| Convection Micro w/Range Hood                                |                                          |
| Free-Standing Table With 4 Chairs (most models)              |                                          |
| Extra Large Fridge w/ Multiple Raised Panels                 |                                          |
| Lighted Toe Kick                                             |                                          |
| Arctic Fox Signature Clock & Entry Mat                       |                                          |
| Daylitter Kitchen Skylight w/ Shade / Ceiling Fan            |                                          |
| FanTastic Vent w/Remote/Tstat/Rain Sensor (Kitchen)          |                                          |
| Solid Surface Bathroom Countertops w/SS Sink                 |                                          |
| Exhaust Only Fan Vent - Bathroom                             |                                          |
| Porcelain, Foot-Pedal Toilet / Bath Skylight                 |                                          |
| Telescoping Lighted Vanity Mirror / Lock Box                 |                                          |
| NW TruRest Mattress w/ UltraDeck Sleep System                |                                          |
| Glass Shower Enclosure                                       |                                          |
| Bathroom Courtesy Light                                      |                                          |
| FanTastic Vent w/Remote                                      |                                          |
| Tstat/Rain Sen (Bedroom)                                     |                                          |
| Bedroom Starlite w/ Shade                                    |                                          |
| USB Charging Ports on Both Sides of Bed                      |                                          |



| Description                                | Travel Trailers |                |                |                |                |                | Fifth Wheels   |                |                |                |                |                |
|--------------------------------------------|-----------------|----------------|----------------|----------------|----------------|----------------|----------------|----------------|----------------|----------------|----------------|----------------|
|                                            | 22G             | 25R            | 25W            | 25Y            | 28F            | 32A            | 27-5L          | 28-5C          | 29-5K          | 29-5T          | 32-5M          | 35-5Z          |
| Model Number                               | 22G             | 25R            | 25W            | 25Y            | 28F            | 32A            | 27-5L          | 28-5C          | 29-5K          | 29-5T          | 32-5M          | 35-5Z          |
| Dry Axle Weight (approx. Lbs.)             | 4936            | 5898           | 6831           | 6640           | 7533           | 7864           | 8689           | 9725           | 10059          | 10140          | 10563          | 11599          |
| Dry Hitch Weight (approx. Lbs.)            | 599             | 711            | 764            | 802            | 769            | 1030           | 2246           | 2364           | 2895           | 2490           | 2928           | 2795           |
| Net Carrying Capacity                      | 1965            | 4091           | 3105           | 3258           | 2698           | 2106           | 2665           | 3611           | 3346           | 3170           | 2809           | 1706           |
| Gross Dry Weight-lbs (approx. Lbs.)        | 5535            | 6609           | 7595           | 7442           | 8302           | 8894           | 10935          | 12089          | 12954          | 12630          | 13491          | 14394          |
| Gross Vehicle Weight Rating (GVWR)-Lbs.    | 7500            | 10700          | 10700          | 10700          | 11000          | 11000          | 13600          | 15700          | 16300          | 15800          | 16300          | 16100          |
| Exterior Length (approx. w/hitch)          | 23'10"          | 27'3"          | 29'6"          | 30'0"          | 30'0"          | 34'4"          | 29'9"          | 32'2"          | 35'10"         | 34'7"          | 36'10"         | 39'8"          |
| Exterior Height (approx. incl. AC unit)    | 11'4"           | 11'7"          | 11'7"          | 11'7"          | 11'11"         | 11'11"         | 13'5"          | 13'4"          | 13'6"          | 13'4"          | 13'5"          | 13'5"          |
| Exterior Width (approx. w/o awning)        | 8'6"            | 8'6"           | 8'6"           | 8'6"           | 8'0"           | 8'0"           | 8'6"           | 8'6"           | 8'6"           | 8'6"           | 8'6"           | 8'6"           |
| Tire Size                                  | ST205<br>75R15  | ST225<br>75R15 | ST225<br>75R15 | ST225<br>75R15 | ST235<br>80R16 | ST235<br>80R16 | ST235<br>80R16 | LT235<br>85R16 | LT235<br>85R16 | ST235<br>85R16 | LT235<br>85R16 | LT235<br>85R16 |
| Load Range                                 | D               | E              | E              | E              | E              | E              | E              | G              | G              | G              | G              | G              |
| Fresh Water w/ Water Heater (approx. gal.) | 50              | 63             | 57             | 57             | 58             | 67             | 88             | 80             | 82             | 82             | 82             | 82             |
| Gray Water Tank (approx. gal.)             | 42              | 44             | 35/35          | 47             | 40             | 55             | 67/35          | 54             | 67/35          | 67             | 67             | 67             |
| Black Water Tank (approx. gal.)            | 35              | 35             | 35             | 35             | 35             | 42             | 65             | 42             | 65             | 65             | 65             | 65             |
| LPG Capacity (approx. gal.)                | 14              | 14             | 14             | 14             | 14             | 14             | 20             | 20             | 20             | 20             | 20             | 20             |
| CSA - Canadian Dealers Only                | YES             | YES            | YES            | YES            | YES            | YES            | YES            | YES            | YES            | YES            | YES            | YES            |
| Auto Ignition Furnace (1,000 BTU's)        | 25              | 25             | 30             | 30             | 30             | 30             | 35             | 35             | 35             | 35             | 35             | 35             |

Send us your testimonial with your pictures and you may be featured in our future promotions. Send your information to: [feedback@northwoodmail.com](mailto:feedback@northwoodmail.com)

