

MALLARD



Spread your wings ...

Visit HEARTLAND on:



Standard Features



1.



2.



3.



4.

1. Power Stabilizer Jacks (N/A M185)
2. Aluminum Rims
3. Spare Tire
4. Black Tank Flush
5. Painted front cap with LED accent lights (N/A M185)
6. Power Awning with LED lighting



5



6

- Arched ceiling with A/C and dual ducts
- Aluminum construction
- 2" Laminated sidewalls
- Pull-out kitchen faucet
- Large double door refer
- Skylight in shower
- Night shades
- Tinted safety windows
- Power Stabilizer jacks
- Leaf spring suspension
- King bed
- Dual 20# LP tanks w/auto change over
- Medicine cabinet
- Fire extinguisher
- Power vent in bathroom
- Foot flush toilet
- Gas/electric DSI water heater
- Quick store bed base
- Cable ready hookup
- 12 volt Radio/CD/DVD player with indoor and outdoor speakers
- Shower / Tub surround
- Large 51 gallon fresh water capacity (Includes 6 gallon hot water heater)
- 55 amp 12 volt power converter
- Solar Prep
- Steel ball bearing drawer guides
- Wide trax axle system
- E-Z lube hubs
- Bumper w/hose storage
- Forced air heated and enclosed underbelly
- Black tank flush
- Spare tire
- Aluminum rims
- Electric awning with LED lights
- Finished and insulated pass-through storage
- Slam baggage doors with magnetic latches
- 13,500 BTU air conditioner
- 50 Amp service with second A/C prep in model M301 and larger
- Friction hinge entry door

MALLARD

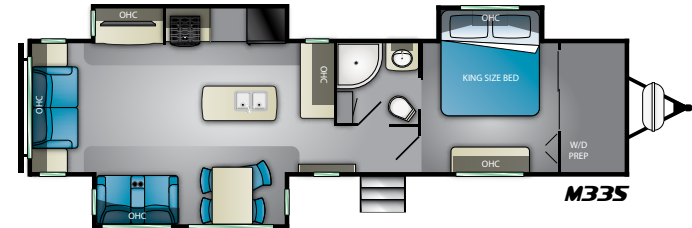
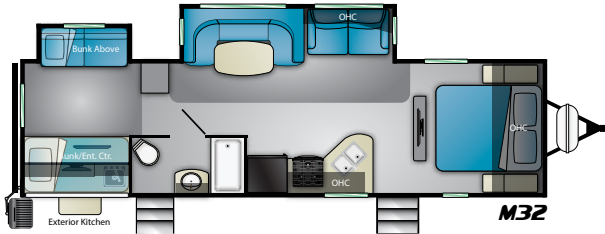
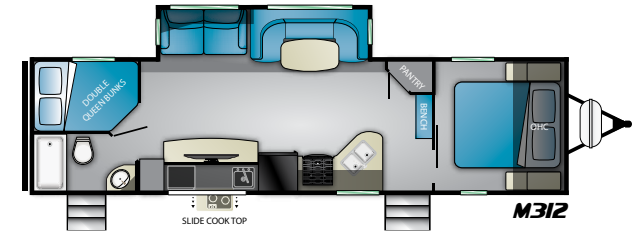
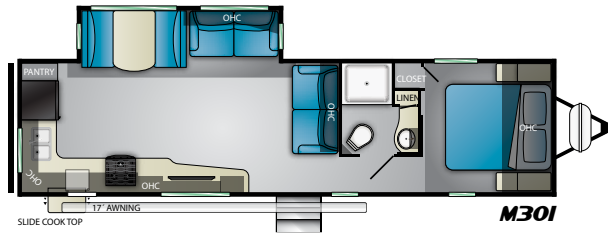
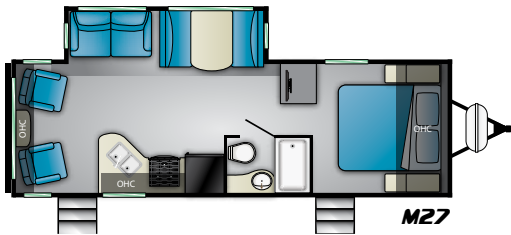
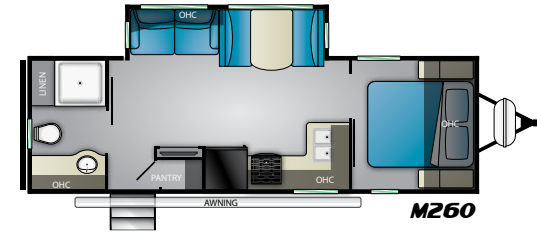
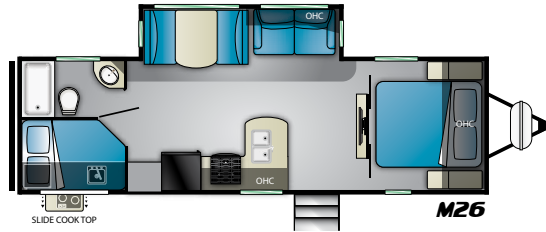
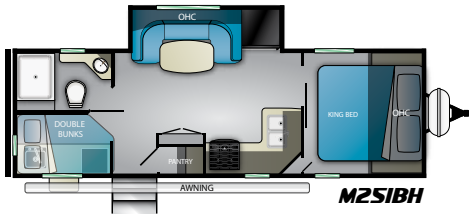
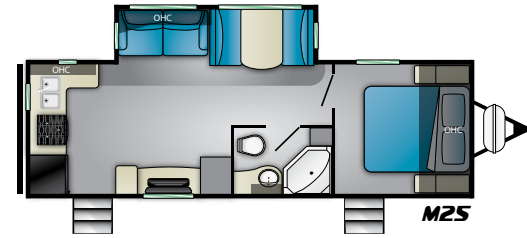
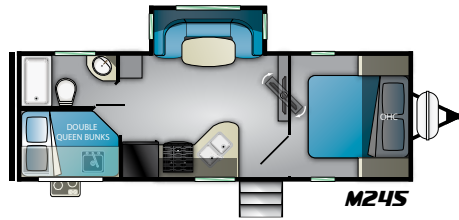
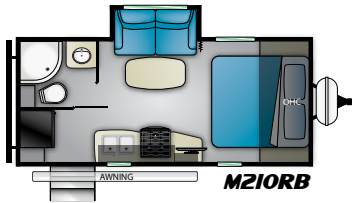

	M21ORB	M245	M25	M251BH	M26	M260	M27	M301	M312	M32	M33	M335
HEIGHT	11'4"	11'4"	11'4"	11'4"	11'4"	11'4"	11'4"	11'4"	11'4"	11'4"	11'6"	11'8"
LENGTH	22'½"	28'9"	30'9"	29'4½"	32'½"	31'0"	30'4"	35'11½"	36'0"	34'9½"	36'11½"	39'8"
DRY	4,598	5,518	5,968	5,920	6,416	5,866	5,672	6,874	7,012	6,926	7,746	8,840
HITCH	550	624	640	760	660	674	638	698	672	670	702	780
GVWR	6,900	6,900	7,400	7,760	8,600	6,900	6,900	8,600	8,600	8,600	9,600	9,900
TANKS	45° 40° 40° ^B	45° 40° 40° ^B	45° 80° 40° ^B	45° 80° 40° ^B	45° 40° 40° ^B	45° 80° 40° ^B	45° 40° 40° ^B	45° 80° 40° ^B	45° 40° 40° ^B	45° 40° 40° ^B	45° 80° 40° ^B	45° 40° 40° ^B

HEARTLAND

Heartland Recreational Vehicles

2831 Dexter Drive • Elkhart, Indiana 46514 • 574-262-5992

Community. Convenience. Close-to-home.

Where you purchase your recreational vehicle is ultimately your decision but Heartland urges you to consider buying at your local dealer. Dealers are part of your community, providing jobs and contributing to your local economy. These dealers are under obligation to provide warranty service for products they sell, but are not legally required to service products purchased from other dealers. At some point, you may need to return to the dealer you buy from - why not stay close to home? After all, home is where your Heartland is!

BENEFITS OF PURCHASING YOUR RV LOCALLY:

- You enjoy valuable relationship building with Dealer Representatives, close to your home, who will explain the features and benefits of the product.
- You receive a full product orientation prior to delivery, which includes hands-on directions for many of the coach's systems and functions. You are also introduced to the Dealership's Service/Parts/Warranty personnel who are ready to help you with any issues you may encounter, now and in the future.
- You enjoy customer PRIORITY. Dealerships generally service their purchasing customers first - others may experience long delays and missed opportunities to use their RV. What is it worth for you to have a dealership's full attention and help you when you need service - in a timely manner?
- Valuable TAX dollars and jobs stay in YOUR community which pays for your roads, schools, police and fire departments.

DON'T UNDERESTIMATE CUSTOMER SERVICE AND PERSONAL CARE!

For Canadian Residents: If you purchase an RV out-of-country, there are additional fees, taxes and inspections that must be met before bringing your product home. Your local Canadian dealers are experts in these provisions.

Visit HEARTLAND on:



Your Authorized Heartland Dealer:

HEARTLAND PROUDLY PARTNERS WITH THE HIGHEST QUALITY VENDORS:



MALLARD

FAST TRACK
PARTS • SERVICE • WARRANTY

HEARTLAND CUSTOMER SERVICE WE'VE GOT YOUR BACK!

Over 40 men and women located in a dedicated facility servicing our customers every day. With a dealer network of over 400 locations across the U.S. and Canada, you're never far from an authorized Heartland dealer.

www.HEARTLANDRVS.com

Do More!

Experience:
 Product Walk-Through Videos
 Side By Side Comparisons
 Feature Videos - Photo Galleries
 Virtual 360° Tours
 Detailed Floor Plans
 News - Testimonials
 Dealer Locator - Owners Club
 Customer Service - Service Locator
 and More at our Informative Web Site

www.heartlandrvs.com
FOR ADDITIONAL INFORMATION

Product information is as accurate as possible as of the date of publication of this brochure. Due to Heartland's commitment to continuous product improvement - floorplans, materials, components, features, measurements, specifications, options, etc. are subject to change at any time without notice or obligation. In certain conditions some additional equipment may be needed. Photos may show optional equipment or props used for photography purposes only.

Heartland has listed the approximate base weight of the trailer without the option equipment included. Optional equipment will impact the weight of the trailer. Please locate the weight sticker attached to the trailer you are considering for the most accurate trailer weight.

Tow Vehicle Caution: Owners of Heartland recreational vehicles are solely responsible for the selection and proper use of tow vehicles. All customers should consult with a motor vehicle manufacturer or their dealer concerning the purchase and use of suitable tow vehicles for Heartland products. Heartland disclaims any liability or damages suffered as a result of the selection, operation, use or misuse of a tow vehicle. Heartland's limited warranty does not cover damage to the recreational vehicle or the tow vehicle as a result of the selection of the tow vehicle.