

WARRANTY FOR  
FULL TIME RVING\*

\*REFERENCE KEYSTONE RV COMPANY OWNERS MANUAL FOR LIMITED WARRANTY DETAILS

MID-PROFILE FIFTH WHEELS  
HALF-TON FIFTH WHEELS & TRAVEL TRAILERS

[keystonerv.com/cougar](http://keystonerv.com/cougar)

# COUGAR

## EASTERN / WESTERN



**Keystone RV  
Company**

The ultimate  
ownership experience.

WARRANTY FOR  
FULL TIME RVING\*

\*REFERENCE KEYSTONE RV COMPANY OWNERS MANUAL FOR LIMITED WARRANTY DETAILS

MID-PROFILE FIFTH WHEELS  
HALF-TON FIFTH WHEELS & TRAVEL TRAILERS

[keystonerv.com/cougar](http://keystonerv.com/cougar)

# COUGAR

## EASTERN



**Keystone RV  
Company**

The ultimate  
ownership experience.



# The ultimate ownership experience.

The goal of Keystone RV Company is to surprise and delight our owners at each and every touchpoint. We're happy when our campers are happy, and we are committed to providing the very best ownership experience in the industry.



**Keystone RV  
Company**

## 1 EASIER SHOPPING.

At Keystone, we make choosing an RV as easy as finding the Big Dipper on a dark summer night. With comprehensive online product information, Key Connect™ product advisors, and an unparalleled dealer network, we will help you select the perfect RV for your family's adventure.

## 2 INNOVATIVE THINKING.

The road's a nicer place when you have the industry's smartest features behind you. Keystone leads the pack in patented innovations that make our RVs safer, more comfortable, and easier to operate.

## 3 LONG HAUL QUALITY.

To keep you on the road, there are certain things we just won't build a Keystone RV without. Game-changing features like our Unified Wiring Standard, Tru-Fit™ five-point slide construction, and no-fail Tuf-Lok™ A/C duct joiners combined with exhaustive testing and inspections are some of the reasons why Keystone is able to offer our owners the industry's best 3-year limited structural warranty.

## 4 WORRY-FREE CUSTOMER SERVICE.

Wherever the road takes you, you're never too far from an authorized Keystone service center. We also offer live service assistance, ultra-fast parts shipping, online maintenance tips and tricks, and a single-point warranty claims policy. *That's* peace of mind.

## 5 KEYSTONE NATION.

When you choose Keystone, you become a part of one of the largest camping families in the country. We're Keystone Nation. A friendly community where people share photos, travel tips and amazing stories – all in the spirit of camaraderie and adventure. Come join us.

Experience the Cougar lifestyle by visiting [#keystonecougar](https://www.instagram.com/keystonecougar)



# COUGAR

#1 SELLING MID-PROFILE FIFTH WHEEL AND LUXURY  
TRAVEL TRAILER FOR OVER TWO DECADES.



MID-PROFILE FIFTH WHEELS | HALF-TON FIFTH WHEELS | HALF-TON TRAVEL TRAILERS

## Engineering and design that starts with the customer.

Committed to innovation, quality, style and affordability, Keystone's Cougar brand sells more mid-profile fifth wheels and luxury travel trailers than any other brand. The Cougar line-up is designed to grow with your family, from your first RV to your last. Cougar takes the time to understand how you travel in each life stage, so that we can provide families with the best camping experiences, year after year, Cougar after Cougar. You can count on every Cougar to deliver user-friendly floorplans, unparalleled towability, innovative features and luxurious touches that make it America's most-awarded RV brand.





# Keystone EXCLUSIVE Innovations

Year after year, Keystone RV's experienced team delivers Built For the Long Haul quality you expect and exclusive innovations you won't find anywhere else.



## 3-year Limited Structural Warranty, 1-year Limited Base Warranty

Every new Keystone RV comes with the industry's best three-year limited structural warranty AND a one-year limited base warranty. Ask your dealer, visit [keystonerv.com](http://keystonerv.com), or call Keystone Owner Relations for details.



## 4G LTE and Wi-Fi Prep

All Cougars are equipped with a new antenna that integrates 4G LTE and Wi-Fi with standard VHF/UHF/AM/FM reception.



## KeyTV™

No more connection guesswork or poor reception. KeyTV offers a game-changing, single point of control of over-the-air, cable, and satellite feeds. Visit us online for more information.



## Color-Coded Wiring Standard

Easy-to-trace circuits simplify electrical and entertainment system troubleshooting.

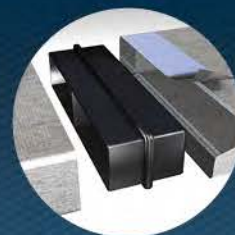

## Tuf-Lok™ A/C Duct Joiners

Crush-resistant design securely joins A/C ductwork, drastically reducing chilled-air leaks and boosting cooling efficiency and comfort.



## In-floor Heating Ducts

Distributes heat evenly for greater comfort.



## Road Armor™ Suspension

Equalizes axle load to dampen shock and vibration.



## Tru-Fit™ Slide Construction

A more durable slide room design that minimizes functional motor and structural stress, resists leaking.





**Multiple 12V USB charging centers in every floorplan**  
Enjoy the convenient locations to charge your mobile devices.



**NEW iN-Command® Generation 3 w/ Global Connect**  
Gives owners total control over power, slide rooms, awnings, HVAC and more, from a convenient master control panel as well as an enabled smartphone app.



**Ultra-stable and Secure MORryde® Step Above™ Steps**  
Ultra-stable and secure MORryde® Step Above™ steps with Keystone kick plate.



**Ground Control® 3.0 Auto Leveling System**  
Leveling jacks automatically level your RV within two minutes. Simply with the touch of a button (most models).

# THE COUGAR DIFFERENCE — PREMIUM FEATURES



**2" Accessory Receiver Hitch**  
Every Cougar comes standard with a 300 lb. carrying capacity receiver hitch. Perfect for use with any accessory approved for RV use. Check accessory owner's manual.



**Furrion® Safety Observation Prep**  
Includes left and right side camera prep, plus rear camera prep.



**Road Armor™ Suspension and Pin Box (fifth wheels only)**  
Equalizes axle load to dampen shock and vibration (fifth wheel only). Also helps to absorb towing shock and reduce the transfer of forces from fifth wheel to truck.



**New Theater Seats**  
All theater seats now have heated and massaging seats and LED Lights.







**Slide Topper Ready**  
All Cougars have been engineered to add slide toppers.



**Largest In Class Fresh Water Tank Capacities**  
81 gallons in mid-profile fifth wheels. 60 gallons in half-ton series travel trailers and fifth wheels.













-  **Heat-deflecting White Sidewalls, Membrane and A/C** – redesigned exterior provides an additional shield to the summer heat.
-  **Standard 15,000 BTU Main A/C and Exclusive Tuf-Lok™ Duct Joiners** – Exclusive Tuf-Lok thermoplastic duct-joiners allow maximum airflow from roof-installed ductwork.
-  **Optional 13,500 BTU Ducted Second A/C (N/A 22RBS)** – Cougars have an optional ducted and thermostatically controlled 2nd A/C.
-  **Radiant Foil Barrier in Front Cap** – Radiant foil reduces amount of radiant heat that can come from the units front cap during summer months.

# Hot & Cold Weather Protection

All models to a tested temperature rating up to 110°F and down to 0°F\*



-   **Remote Temperature Probes and Gen. 3 In-Command** – Provides more accurate temperature readings, has timed on/off procedures, and can be monitored and controlled from anywhere with a smartphone.
-   **Double Insulated Laminated Rear Wall** – Cougar's exclusive design combines rolled fiberglass and a second layer of styrene insulation providing the best insulation for the RV.
-   **Insulated Gooseneck, Bulkhead divider, and Sealed Pin Box (5th Wheels)** – Cougar comes with a fiberglass insulated gooseneck, bulkhead divider wall, and a foam gasket sealed pin box moderating the upper deck temperature.
-   **Insulated Slide Floors** – Unlike basic radiant foil, Astro-Foil has air pockets for insulation installed into the slide floors, keeping the warm air in, and cold air out.
-   **Two Roof Attic Vents** – In hot climates, attic vents help release hot air that often gets trapped under the roof decking. In cold climates attic vents help to release moisture, reducing the amount of condensation.

-  **Heated Pass-Through Storage (fifth wheels)** – Cougar places a heat register behind the convenience center in the pass-through storage to prevent water lines from freezing.
-  **12 Volt Electric Heat Pads on All Holding Tanks** – Provides additional heat to the holding tanks while camping in cold climates and can also be used while in transit.
-  **35,000 BTU Furnace, and 5,500 BTU Electric Fireplace (most models)** – Unlike most competitors, Cougars have a 35,000 BTU furnace and most models have a 5,500 BTU fireplace, providing over 40,000 BTU's of heat.
-  **Heated and Enclosed Underbelly** – The sealed Coroplast underbelly has a layer of Astro-Foil insulation beneath the holding tanks, and fiberglass insulation above the tanks, while a heat duct is ran adjacent to the waterlines where heat is dumped around the fresh tank, keeping your tanks, waterlines, and gate valves from freezing.
-  **PEX Plumbing** – Resistant to corrosion, pitting, and scaling, this residential plumbing is installed using fewer fittings, reducing potential leak points. PEX retains more heat in the hot water lines, while lessening condensation in the cold water lines than traditional copper or CPVC plumbing. PEX also expands up to three times its diameter if water in the lines freeze.



ALL FIFTH WHEELS AND TRAVEL TRAILERS COME WITH ROOF AND SIDE SOLAR PREP WITH INVERTER PREP.

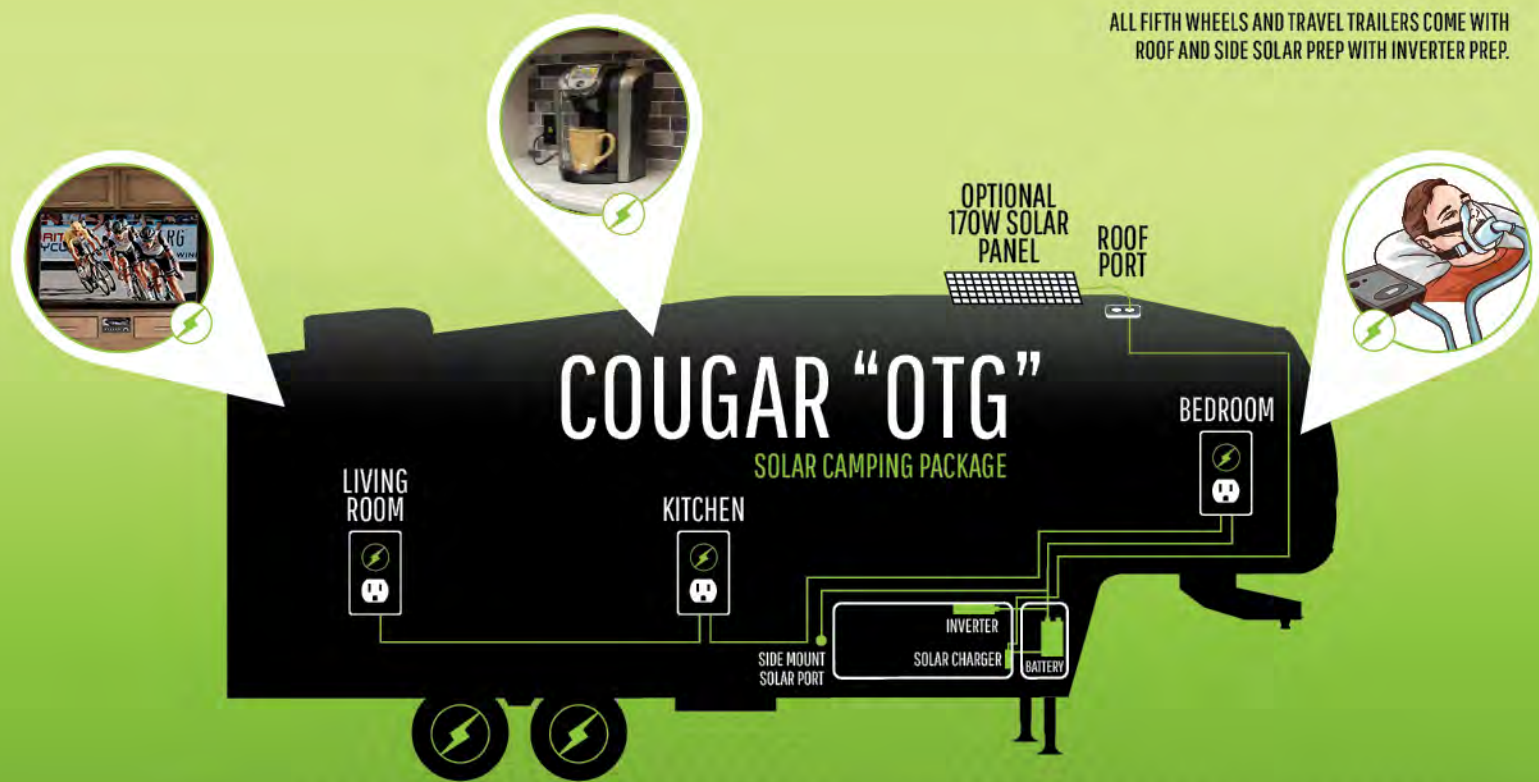

## Benefits of Solar Power

- No more dead batteries. Solar charging minimizes the need to plug into shore power to recharge batteries, helps maintain batteries, and increases battery life.
- Camping off-the-grid. Designed to make it easy to boondock off the grid for a weekend or full time.
- Solar power is quieter, cleaner and requires a lower upfront investment than traditional RV generators. A solar power system quickly pays for itself by eliminating on-going costs associated with generators, like gas, oil and other required maintenance.

### Cougar "OTG" Solar/Inverter Prep (standard)

1. Roof mounted, dual-port access with solar charger prep located in pass-through storage compartment for roof mounted applications
2. Sidewall port access for portable solar panel systems
3. Inverter prep conveniently located in the pass-through storage compartment
4. 3 - 110V Outlets on every unit are prepped for inverted use with wiring conveniently terminated in the pass-through compartment for an optional inverter

### Cougar "OTG" Solar Camping Package (option)

1. 1 - 170 watt Zamp roof mounted solar panel (expandable up to 510 watts in the aftermarket)
2. 1 - 30 amp Zamp solar charging system
3. 1 - 1200 watt pure sine inverter
4. 3 inverted outlets inside the trailer (bedroom, kitchen, living room TV)





29MBS LIVING AND ENTERTAINMENT

## Featured Floorplan: 29MBS

Light-filled rear chef's kitchen and versatile enclosed bonus room  
(all images feature Twig décor).





more product detail at  
[www.keystonerv.com/Cougar-Half-Ton](http://www.keystonerv.com/Cougar-Half-Ton)



29MBS KITCHEN



29MBS BUNKROOM



29MBS BATHROOM



29MBS BEDROOM





## Featured Floorplan: 364BHL

Master suite, 1 1/2 baths and lofted second bedroom with two double beds.

Weight: 11225 LBS. | Length: 39' 3"







more product detail at  
[www.keystonerv.com/Cougar](http://www.keystonerv.com/Cougar)



364BHL SOFA/DINETTE (SHOWN IN STORM DECOR)



364BHL MASTER SUITE



364BHL BUNKROOM



364BHL 1/2 BATHROOM





more product detail at  
[www.keystonerv.com/Cougar](http://www.keystonerv.com/Cougar)

# Cougar

## MID-PROFILE FIFTH WHEELS

- EXCLUSIVE 90° plus MaxTurn Technology™ frame and hitch design for unparalleled maneuverability
- EXCLUSIVE Hitch Vision™ for faster and easier hook-up
- NEW iN-Command® Generation 3 w/ Global Connect control system gives owners total control over power, slide rooms, awnings, HVAC and more, from a convenient master control panel as well as an enabled smartphone application
- Climate Guard Protection Package: Zero to 110 degree rated, larger heating and cooling units, with in-floor heat ducting, 12V heat pads, racetrack A/C ducting, and increased insulation
- Exceptionally durable and waterproof patent-pending automotive windshield design (select models)
- Ultra-stable and secure MORryde® Step Above™ steps
- Best-in-class unobstructed exterior pass-through storage and oversized baggage doors
- EXCLUSIVE Road Armor™ suspension equalizes axle load to dampen shock and vibration
- Road Armor™ pin box - rubberized torsion compound absorbs motion and vibration caused by road shock
- Best-in-class holding tank capacities
- Upgraded 30" wide entry door and slim shade prep
- Standard Ground Control® 3.0 auto leveling system
- 50" 4K living room television (all models)
- Self-adjusting brakes, reverse taillights and backup/side camera prep
- 35,000 BTU furnace and 15,000 BTU air conditioner
- Dyna Span® seamless floor decking with 25-year warranty
- 2" accessory hitch receiver with 300 lb. capacity
- NEW modern interior styling with pillow-top seating, fold-flat sofa, and dimmable LED lighting in main slide
- KeyTV™: A simplified multisource signal controller that distributes satellite, cable, and over-the-air feeds via a single coax cable to every television
- Gas/electric, oversized four-door refrigerator
- Standard bedroom slide-out with optional king bed (N/A 302RLS, 307RES, 353SRX, 364BHL)
- 30" x 50" residential-sized shower with seat (N/A 302RLS, 307RES, 353SRX, 364BHL, 367FLS)
- Washer/dryer prep standard (most models)
- Furrion® range and 22" oven with glass cooktop cover and Piezo ignition

**PATENTED MAX TURN TECHNOLOGY**

**SHORT BED AVAILABLE**

**Competition**

MAX TURN EXPECTED TURNING RADIUS (6'6" TRUCK BED)		
Length of Truck Bed	Standard Fifth Wheel Hitch	Sliding Fifth Wheel Hitch
6' 6"	83.33°	95.66°

EXCLUSIVE 90° plus MaxTurn Technology™  
 Frame and hitch design for unparalleled maneuverability.



EXCLUSIVE Hitch Vision™  
 No looking back convenience.



## MID-PROFILE FIFTH WHEEL FLOORPLANS

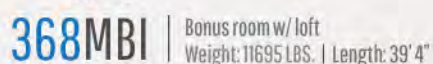
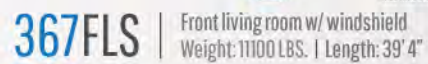
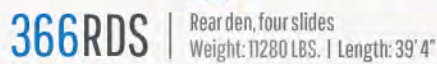
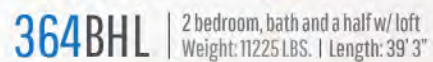
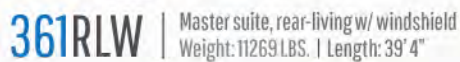
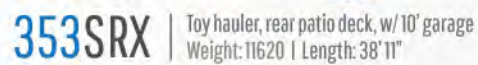





more product detail at  
[www.keystonerv.com/Cougar-Half-Ton](http://www.keystonerv.com/Cougar-Half-Ton)

## Cougar | HALF-TON FIFTH WHEELS

- EXCLUSIVE 90° plus MaxTurn Technology™ frame and hitch design for unparalleled maneuverability
- EXCLUSIVE Hitch Vision™ for faster and easier hook-up
- NEW iN-Command® Generation 3 w/ Global Connect control system gives owners total control over power, slide rooms, awnings, HVAC and more, from a convenient master control panel as well as an enabled smartphone application
- Climate Guard Protection Package: Zero to 110 degree rated, larger heating and cooling units, with in-floor heat ducting, 12V heat pads, racetrack A/C ducting, and increased insulation
- Ultra-stable and secure MORryde® Step Above™ steps
- Best-in-class holding tank capacities
- Upgraded 26" wide entry door and slim shade prep
- Best-in-class unobstructed exterior pass-through storage and oversized baggage doors
- EXCLUSIVE Road Armor™ suspension equalizes axle load to damping shock and vibration
- Road Armor™ pin box - rubberized torsion compound absorbs motion and vibration caused by road shock
- Upgraded exterior Capital Grill BBQ (outside kitchen models)
- Standard level up Ground Control 3.0 Auto Leveling System
- Interior and exterior LED lights
- 35,000 BTU furnace and 15,000 BTU air conditioner
- 50" 4K living room television ( most models)
- Self-adjusting brakes, reverse taillights and backup/side camera prep
- 2" accessory hitch receiver with 300 lb. capacity
- Walkable roof with rear-wall ladder for easy maintenance
- KeyTV™: A simplified multisource signal controller that distributes satellite, cable, and over-the-air feeds via a single coax cable to every television
- NEW modern interior styling with pillow-top seating, fold-flat sofa, and dimmable lighting
- 30" x 50" residential-sized shower w/seat (N/A 32BHS)
- Furrion® range and 22" oven with glass cooktop cover and Piezo ignition

**PATENTED MAX TURN TECHNOLOGY**

**MAX TURN EXPECTED TURNING RADIUS (6'6" TRUCK BED)**

Length of Truck Bed	Standard Fifth Wheel Hitch	Sliding Fifth Wheel Hitch
6' 6"	83.33°	95.66°

EXCLUSIVE 90° plus MaxTurn Technology™  
 Frame and hitch design for unparalleled maneuverability.



EXCLUSIVE Hitch Vision™  
 No looking back convenience.



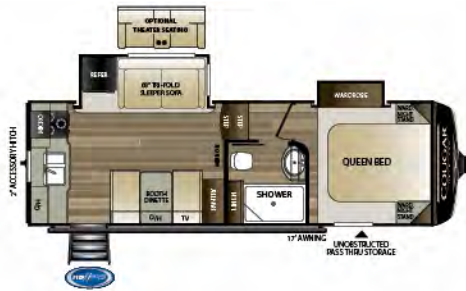

**23MLS** | Short, rear kitchen w/ wardrobe slide  
Weight: 7140 LBS. | Length: 26'10"

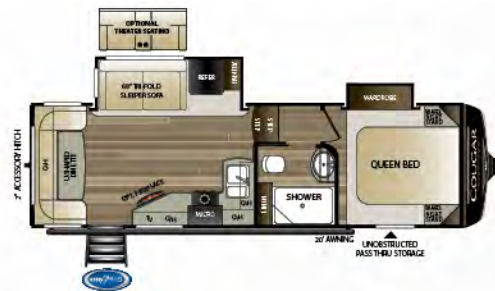

**24RDS** | Rear dinette, two slides  
Weight: 7300 LBS. | Length: 28'6"



**25RES** | Rear entertainment, outside kitchen  
Weight: 7582 LBS. | Length: 28'10"



**27SGS** | Rear living room w/ mid-entry  
Weight: 8046 LBS. | Length: 31'4"



**29MBS** | Rear, private double bunkhouse  
Weight: 8760 LBS. | Length: 32'10"



**29RKS** | Rear kitchen, open concept w/ outside kitchen  
Weight: 8801 LBS. | Length: 32'10"



**30RLS** | Rear living room, gourmet kitchen  
Weight: 9023 LBS. | Length: 33'6"



**32BHS** | 1 1/2 bath bunkhouse  
Weight: 9336 LBS. | Length: 35'9"





## Cougar

- Upgraded 26" wide entry door and slim shade prep
- Exceptionally durable and waterproof patent-pending automotive windshield design (select models)
- Self-adjusting brakes, reverse taillights and backup/side camera prep
- Standard level up Ground Control 3.0 Auto Leveling System (N/A 22RBS)
- Walkable roof with rear-wall ladder for easy maintenance
- KeyTV™ – A simplified multisource signal controller that distributes satellite, cable, and over-the-air feeds via a single coax cable to every television
- NEW modern interior styling with pillow-top seating, fold-flat sofa, and dimmable lighting
- Furrion® range and 22" oven with glass cooktop cover
- Best-in-class holding tank capacities

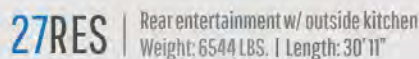
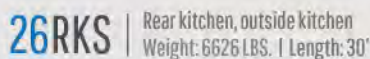
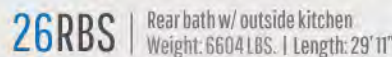
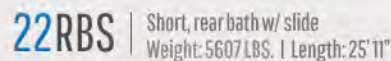



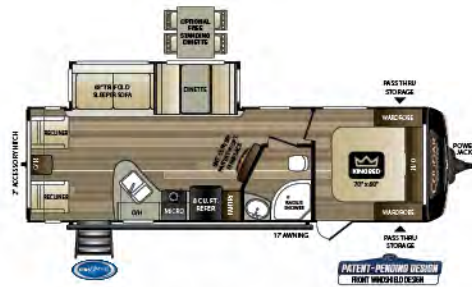

**27SAB** | Rear living room, side-aisle bath  
Weight: 6679 LBS. | Length: 31' 5"



**29BHS** | Double bunkhouse, outside kitchen  
Weight: 7008 LBS. | Length: 34' 1"



**29FKD** | Front kitchen, 2 slides w/bed slide  
Weight: 7265 LBS. | Length: 33' 1"



**29RLD** | Rear living room, bed slide w/ large front closet  
Weight: 7446 LBS. | Length: 33' 5"

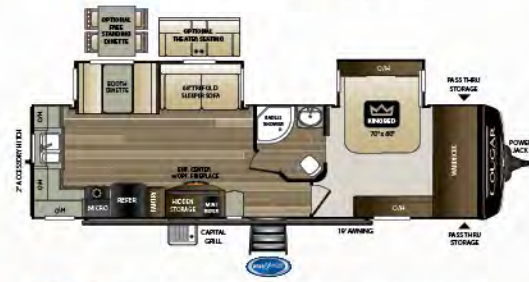

**30RKD** | Rear kitchen, bed slide w/ large front closet  
Weight: 7500 LBS. | Length: 34' 9"

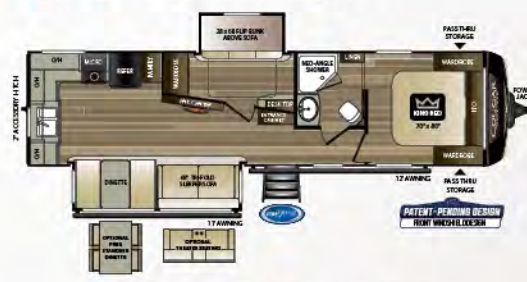

**31MBS** | Rear kitchen, mid bunkhouse  
Weight: 7875 LBS. | Length: 35' 3"

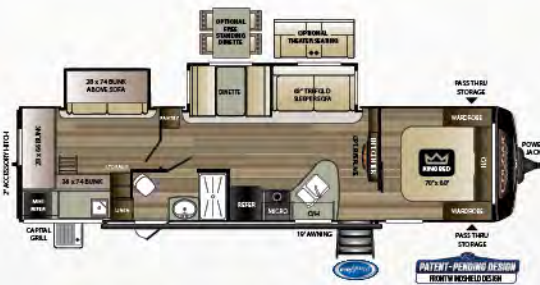

**32RDB** | Huge rear bunk room, outside kitchen  
Weight: 7935 LBS. | Length: 32' 10"



**32RLI** | Rear living room, three slides w/ bedroom slide  
Weight: 8801 LBS. | Length: 32' 10"



**34TSB** | Three-slide bunk house w/ outside kitchen  
Weight: 8563 LBS. | Length: 37' 5"



### MID-PROFILE FIFTH WHEELS

MODEL	WEIGHT	CARRYING CAPACITY	HITCH WEIGHT	FRESH WATER	WASTE WATER	GRAY WATER	LPG	LENGTH*	HEIGHT 1-A/C	HEIGHT 2-A/C
302RLS	10110	2050	1765	81	38	76	60	34' 7"	12' 6"	13' 5"
307RES	10005	2175	1775	81	38	76	60	34' 7"	12' 6"	13' 5"
315RLS	10562	1828	1995	81	38	76	60	35' 8"	12' 6"	13' 5"
353SRX	11620	4780	2440	81	76	76	60	38' 11"	13' 5"	13' 5"
361RLW	11269	2711	1980	81	38	76	60	39' 4"	12' 3"	13' 2"
364BHL	11225	2775	2200	81	76	76	60	39' 3"	13' 5"	13' 5"
366RDS	11280	2720	2400	81	38	76	60	39' 4"	12' 6"	13' 5"
367FLS	11100	2900	2455	81	38	76	60	39' 4"	12' 5"	13' 5"
368MBI	11695	2285	1980	81	38	76	60	39' 4"	12' 7"	13' 5"

### HALF-TON FIFTH WHEELS

MODEL	WEIGHT	CARRYING CAPACITY	HITCH WEIGHT	FRESH WATER	WASTE WATER	GRAY WATER	LPG	LENGTH*	HEIGHT 1-A/C	HEIGHT 2-A/C
23MLS	7140	2860	1335	60	30	60	60	26' 10"	11' 10"	12' 11"
24RDS	7355	2645	1370	60	30	60	60	28' 6"	11' 10"	12' 11"
25RES	7582	2418	1505	60	30	60	60	28' 10"	11' 8"	12' 8"
27SGS	8046	2244	1495	60	30	60	60	31' 4"	11' 7"	12' 8"
29MBS	8760	2240	1630	60	30	60	60	32' 10"	11' 7"	12' 8"
29RKS	8801	1599	1605	60	30	60	60	32' 10"	11' 7"	12' 8"
30RLS	9023	1977	1545	60	30	60	60	33' 6"	11' 9"	12' 10"
32BHS	9336	2164	1570	60	60	60	60	35' 9"	11' 9"	12' 10"

### HALF-TON TRAVEL TRAILERS

MODEL	WEIGHT	CARRYING CAPACITY	HITCH WEIGHT	FRESH WATER	WASTE WATER	GRAY WATER	LPG	LENGTH*	HEIGHT
22RBS	5607	1593	630	60	30	30	60	25' 11"	11' 4"
26RBS	6604	2196	880	60	30	60	60	29' 11"	11' 4"
26RKS	6626	2174	810	60	30	60	60	30' 0"	11' 4"
27RES	6544	2256	835	60	30	60	60	30' 11"	11' 4"
27SAB	6679	2121	975	60	30	60	60	31' 5"	11' 4"
29BHS	7008	1792	765	60	30	60	60	34' 1"	11' 4"
29FKD	7265	2235	910	60	30	60	60	33' 11"	11' 5"
29RLD	7446	2054	1085	60	30	60	60	33' 5"	11' 4"
30RKD	7500	2000	955	60	30	60	60	34' 9"	11' 4"
31MBS	7815	1685	835	60	30	60	60	35' 3"	11' 4"
32RDB	7935	2565	885	60	30	60	60	36' 4"	11' 4"
32RLI	8416	2084	1165	60	30	60	60	35' 11"	11' 4"
34TSB	8563	1937	1150	60	30	60	60	37' 5"	11' 4"

DISCLAIMER: Product information is as accurate as possible as of the date of publication of this brochure. All features, floor plans, and specifications in this brochure are subject to change without notice. Please also consult Keystone's web site at [www.keystonerv.com](http://www.keystonerv.com) for more current product information and specifications. Tow Vehicle Disclaimer. CAUTION: Owners of Keystone recreational vehicles are solely responsible for the selection and proper use of tow vehicles. All customers should consult with a motor vehicle manufacturer or their dealer concerning the purchase and use of suitable tow vehicles for Keystone products. Keystone disclaims any liability or damages suffered as a result of the selection, operation, use or misuse of a tow vehicle. KEYSTONE'S LIMITED WARRANTY DOES NOT COVER DAMAGE TO THE RECREATIONAL VEHICLE OR THE TOW VEHICLE AS A RESULT OF THE SELECTION, OPERATION, USE OR MISUSE OF THE TOW VEHICLE. \*Length is defined as the distance from the centerline of hitch pin/coupler to rear bumper of trailer. Please review owner's manual prior to purchase for more information on service warranties, extended use, towing and maintenance. Owner's manuals can be found at [keystonerv.com](http://keystonerv.com).



## STANDARDS AND OPTIONS

### Mid-Profile Fifth Wheel

CAMPING IN STYLE PACKAGE
Laminated side walls with 5 sided aluminum superstructure
Painted fiberglass front cap w/ hitch vision & led lights
Cougar vintage maple glazed hardwood
Cabinet doors with residential hardware
12,000 Btu rapid recovery 6 gallon
Gas/electric water heater
Aluminum wheels and full size spare tire
Battery disconnect switch
Led interior and exterior lighting
MORyde® Step Above® on main entry
Friction hinge entry door
COUGAR ANNIVERSARY PACKAGE
12 cu. ft. refrigerator (N/A 353SRX)
1.6 cu. ft. microwave upgrade
Washer/dryer prep (N/A 302RLS, 307RES, 353SRX, 364BHL)
21" Furrion® range w/ Piezo ignition and glass stovetop cover
LG solid surface countertop and stainless steel undermount kitchen sink with chef's faucet and sprayer
2" accessory hitch with 300 lb. capacity
Upgraded Road Armour™ equalizer and pin box
COUGAR COMFORT PACKAGE
15,000 BTU ducted air conditioner
50 AMP electric, pre-wired and braced for ducted bedroom A/C option
35K BTU ducted furnace
Dual 30 lb. LP tanks
1,000 CFM four-speed "Fantastic Fan" exhaust fan with rain sensor and wall-mounted controls
DELUXE ENTERTAINMENT/ TECHNOLOGY PACKAGE
50" LED HDTV in Living Area
12V AM/FM/CD/DVD/MP3/Bluetooth player with HDMI ARC control
Worry-free omni-directional digital TV antenna and WiFi prep
Exterior TV hookup
5,500 BTU electric fireplace with thermostat control and remote
Furrion® backup-observation/side camera prep
12 Volt USB charging centers
CLIMATE GUARD PROTECTION PACKAGE
Astrofoil insulated slide floors and underbelly
Reflective foil insulated front cap
Forced-air heated and enclosed underbelly
12V heat pads on holding tanks
Heated and enclosed dump valves and convenience center
Dual attic vents
SMART CAMPING
In-Command® Pro Series Gen. 3 with Global Connect
4g LTE and Wi-Fi prep
Cougar "Off the Grid" roof and side-mounted solar and inverter prep
OPTIONS
Second power awning (MANDATORY, N/A 366RDS, 367FLS)
13.5 BTU ducted bedroom A/C with thermostat (mandatory 353SRX)
70" x 80" king bed (N/A 302RLS, 307RES, 353SRX, 364BHL)
Free-standing dinette and chairs (N/A 353SRX)
Dual-pane frameless windows
Theater seat IPO tri-fold sofa (364BHL Only)
Slide topper package
Cougar "Off the Grid" solar camping package (MANDATORY 353SRX)
Ramp door patio package (MANDATORY 353SRX only)
CSA construction and seal

### Half-Ton Fifth Wheel

CAMPING IN STYLE PACKAGE
Laminated side walls with 5 sided aluminum superstructure
3/8" walkable roof decking
Painted fiberglass front cap with HitchVision™ and LED lights
Cougar Vintage Maple glazed hardwood cabinetry
Cabinet doors with residential hardware
12,000 BTU rapid recovery 6-gallon gas/electric water heater
Aluminum wheels and full size spare tire
Battery disconnect switch
LED interior and exterior lighting
MorRyde® Solid Step™ at main entry
Friction-hinge entry door
HALF-TON FW ANNIVERSARY PACKAGE
8 cu. ft. refrigerator
0.9 cu. ft. microwave
21" Furrion® range w/ Piezo ignition and glass stovetop cover
Foil-wrapped seamless galley and lavatory counter tops
Stainless steel undermount kitchen sink with chef's faucet and sprayer
2" accessory hitch with 300 lb. capacity
HALF-TON FW COMFORT PACKAGE
15,000 BTU ducted air conditioner
50 AMP electric, pre-wired and braced for ducted bedroom A/C option
35K BTU ducted furnace
Dual 30 lb. LP tanks
CLIMATE GUARD PROTECTION PACKAGE
Astrofoil insulated slide floors and underbelly
Reflective foil insulated front cap
Forced-air heated and enclosed underbelly
12V heat pads on holding tanks
Heated and enclosed dump valves and convenience center
Dual attic vents
SMART CAMPING
iN-Command® Pro Series Gen. 3 with Global Connect
4G LTE and Wi-Fi prep
Cougar "Off the Grid" roof and side-mounted solar and inverter prep
OPTIONS
Electric, four-point leveling system (MANDATORY)
Second power awning (MANDATORY 29MBS, 30RLS; N/A all other models)
Dual-pane frameless windows
13.5 BTU ducted bedroom A/C
Fireplace (MANDATORY 29MBS, 30RLS; N/A 23MLS)
Free-standing dinette and chairs (N/A 23MLS, 24RDS)
Theater seat IPO tri-fold (23MLS, 24RDS, 25RES, 29MBS, 32BHS Only)
Cougar "Off the Grid" solar camping package
CSA construction and seal

### Half-Ton Travel Trailers

CAMPING IN STYLE PACKAGE
Laminated side walls with 5 sided aluminum superstructure
3/8" walkable roof decking
Painted fiberglass front cap with HitchVision™ and LED lights
Cougar Vintage Maple glazed hardwood cabinetry
Cabinet doors with residential hardware
12,000 BTU rapid recovery 6-gallon gas/electric water heater
Aluminum wheels and full size spare tire
Battery disconnect switch
LED interior and exterior lighting
MorRyde® Solid Step™ at main entry
Friction-hinge entry door
HALF-TON TT ANNIVERSARY PACKAGE
8 cu. ft. refrigerator
0.9 cu. ft. microwave
21" Furrion® range w/ Piezo ignition and glass stovetop cover
Foil-wrapped seamless galley and lavatory countertops
Gourmet stainless steel undermount kitchen sink with upgraded chef's faucet and sprayer
2" accessory hitch with 300 lb. capacity
HALF-TON TT COMFORT PACKAGE
15,000 BTU ducted air conditioner
35K BTU ducted furnace
Dual 30 lb. LP tanks
CLIMATE GUARD PROTECTION PACKAGE
Astrofoil insulated slide floors and underbelly
Reflective foil insulated front cap
Forced-air heated and enclosed underbelly
12V heat pads on holding tanks
Heated and enclosed dump valves
Dual attic vents
SMART CAMPING
iN-Command® Pro Series Gen. 3 with Global Connect
Furrion 4G LTE and Wi-Fi prep
Cougar "Off the Grid" roof and side-mounted solar and inverter prep
OPTIONS
Electric rear stabilizer jacks (MANDATORY 22RBS)
Automatic leveling system MANDATORY (N/A 22RBS)
Second power awning (MANDATORY 32RLI, 34TSB, 31MBS, N/A all other models)
Dual-pane frameless windows
13.5 BTU A/C, bedroom ducted (N/A 22RBS)
50 amp service/wire and brace for 2nd A/C MANDATORY (N/A 22RBS)
Fireplace (N/A 22RBS)
Free standing dinette and chairs
Theater seat IPO tri-fold (N/A 22RBS, 27SAB, 29RLD, 32RLI)
Theater seats in place of dinette (22RBS ONLY)
Cougar "Off The Grid" Solar Camping Package
CSA construction and seal



# BUILT FOR THE LONG HAUL



PRINT 10.2019





WARRANTY FOR  
FULL TIME RVING\*

\*REFERENCE KEYSTONE RV COMPANY OWNERS MANUAL FOR LIMITED WARRANTY DETAILS

MID-PROFILE FIFTH WHEELS  
HALF-TON FIFTH WHEELS & TRAVEL TRAILERS

[keystonerv.com/cougar](http://keystonerv.com/cougar)

# COUGAR

## WESTERN



**Keystone RV  
Company**

The ultimate  
ownership experience.



# The ultimate ownership experience.

The goal of Keystone RV Company is to surprise and delight our owners at each and every touchpoint. We're happy when our campers are happy, and we are committed to providing the very best ownership experience in the industry.



**Keystone RV  
Company**

## 1 EASIER SHOPPING.

At Keystone, we make choosing an RV as easy as finding the Big Dipper on a dark summer night. With comprehensive online product information, Key Connect™ product advisors, and an unparalleled dealer network, we will help you select the perfect RV for your family's adventure.

## 2 INNOVATIVE THINKING.

The road's a nicer place when you have the industry's smartest features behind you. Keystone leads the pack in patented innovations that make our RVs safer, more comfortable, and easier to operate.

## 3 LONG HAUL QUALITY.

To keep you on the road, there are certain things we just won't build a Keystone RV without. Game-changing features like our Unified Wiring Standard, Tru-Fit™ five-point slide construction, and no-fail Tuf-Lok™ A/C duct joiners combined with exhaustive testing and inspections are some of the reasons why Keystone is able to offer our owners the industry's best 3-year limited structural warranty.

## 4 WORRY-FREE CUSTOMER SERVICE.

Wherever the road takes you, you're never too far from an authorized Keystone service center. We also offer live service assistance, ultra-fast parts shipping, online maintenance tips and tricks, and a single-point warranty claims policy. *That's* peace of mind.

## 5 KEYSTONE NATION.

When you choose Keystone, you become a part of one of the largest camping families in the country. We're Keystone Nation. A friendly community where people share photos, travel tips and amazing stories – all in the spirit of camaraderie and adventure. Come join us.

Experience the Cougar lifestyle by visiting [#keystonecougar](https://www.instagram.com/keystonecougar)





# COUGAR

#1 SELLING MID-PROFILE FIFTH WHEEL AND LUXURY  
TRAVEL TRAILER FOR OVER TWO DECADES.



MID-PROFILE FIFTH WHEELS | HALF-TON FIFTH WHEELS | HALF-TON TRAVEL TRAILERS

## Engineering and design that starts with the customer.

Committed to innovation, quality, style and affordability, Keystone's Cougar brand sells more mid-profile fifth wheels and luxury travel trailers than any other brand. The Cougar line-up is designed to grow with your family, from your first RV to your last. Cougar takes the time to understand how you travel in each life stage, so that we can provide families with the best camping experiences, year after year, Cougar after Cougar. You can count on every Cougar to deliver user-friendly floorplans, unparalleled towability, innovative features and luxurious touches that make it America's most-awarded RV brand.





# Keystone EXCLUSIVE Innovations

Year after year, Keystone RV's experienced team delivers Built For the Long Haul quality you expect and exclusive innovations you won't find anywhere else.



## 3-year Limited Structural Warranty, 1-year Limited Base Warranty

Every new Keystone RV comes with the industry's best three-year limited structural warranty AND a one-year limited base warranty. Ask your dealer, visit [keystonerv.com](http://keystonerv.com), or call Keystone Owner Relations for details.



## 4G LTE and Wi-Fi Prep

All Cougars are equipped with a new antenna that integrates 4G LTE and Wi-Fi with standard VHF/UHF/AM/FM reception.



## KeyTV™

No more connection guesswork or poor reception. KeyTV offers a game-changing, single point of control of over-the-air, cable, and satellite feeds. Visit us online for more information.



## Color-Coded Wiring Standard

Easy-to-trace circuits simplify electrical and entertainment system troubleshooting.

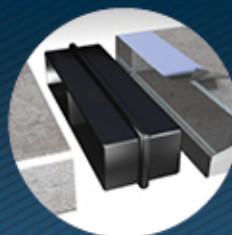

## Tuf-Lok™ A/C Duct Joiners

Crush-resistant design securely joins A/C ductwork, drastically reducing chilled-air leaks and boosting cooling efficiency and comfort.



## In-floor Heating Ducts

Distributes heat evenly for greater comfort.



## Road Armor™ Suspension

Equalizes axle load to dampen shock and vibration.



## Tru-Fit™ Slide Construction

A more durable slide room design that minimizes functional motor and structural stress, resists leaking.





Multiple 12V USB charging centers in every floorplan. Enjoy the convenient locations to charge your mobile devices.



**NEW iN-Command® Generation 3 w/ Global Connect**  
Gives owners total control over power, slide rooms, awnings, HVAC and more, from a convenient master control panel as well as an enabled smartphone app.

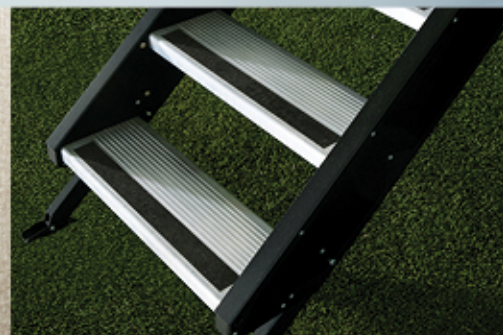

**Ultra-stable and Secure MORryde® Step Above™ Steps**  
Ultra-stable and secure MORryde® Step Above™ steps with Keystone kick plate.



**Ground Control® 3.0 Auto Leveling System**  
Leveling jacks automatically level your RV within two minutes. Simply with the touch of a button (most models).

# THE COUGAR DIFFERENCE — PREMIUM FEATURES



**2" Accessory Receiver Hitch**  
Every Cougar comes standard with a 300 lb. carrying capacity receiver hitch. Perfect for use with any accessory approved for RV use. Check accessory owner's manual.



**Furrion® Safety Observation Prep**  
Includes left and right side camera prep, plus rear camera prep.



**Road Armor™ Suspension and Pin Box (fifth wheels only)**  
Equalizes axle load to dampen shock and vibration (fifth wheel only). Also helps to absorb towing shock and reduce the transfer of forces from fifth wheel to truck.



**New Theater Seats**  
All theater seats now have heated and massaging seats and LED Lights.





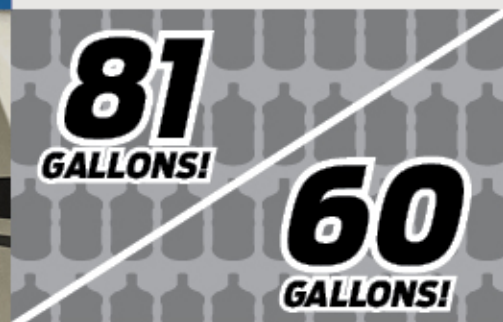

**Slide Topper Ready**  
All Cougars have been engineered to add slide toppers.



**Largest In Class Fresh Water Tank Capacities**  
81 gallons in mid-profile fifth wheels. 60 gallons in half-ton series travel trailers and fifth wheels.

















-  **Heat-deflecting White Sidewalls, Membrane and A/C** – redesigned exterior provides an additional shield to the summer heat.
-  **Standard 15,000 BTU Main A/C and Exclusive Tuf-Lok™ Duct Joiners** – Exclusive Tuf-Lok thermoplastic duct-joiners allow maximum airflow from roof-installed ductwork.
-  **Optional 13,500 BTU Ducted Second A/C (N/A 22RBS)** – Cougars have an optional ducted and thermostatically controlled 2nd A/C.
-  **Radiant Foil Barrier in Front Cap** – Radiant foil reduces amount of radiant heat that can come from the units front cap during summer months.

## Hot & Cold Weather Protection

All models to a tested temperature rating up to 110°F and down to 0°F\*



-   **Remote Temperature Probes and Gen. 3 In-Command** – Provides more accurate temperature readings, has timed on/off procedures, and can be monitored and controlled from anywhere with a smartphone.
-   **Double Insulated Laminated Rear Wall** – Cougar's exclusive design combines rolled fiberglass and a second layer of styrene insulation providing the best insulation for the RV.
-   **Insulated Gooseneck, Bulkhead divider, and Sealed Pin Box (5th Wheels)** – Cougar comes with a fiberglass insulated gooseneck, bulkhead divider wall, and a foam gasket sealed pin box moderating the upper deck temperature.
-   **Insulated Slide Floors** – Unlike basic radiant foil, Astro-Foil has air pockets for insulation installed into the slide floors, keeping the warm air in, and cold air out.
-   **Two Roof Attic Vents** – In hot climates, attic vents help release hot air that often gets trapped under the roof decking. In cold climates attic vents help to release moisture, reducing the amount of condensation.

-  **Heated Pass-Through Storage (fifth wheels)** – Cougar places a heat register behind the convenience center in the pass-through storage to prevent water lines from freezing.
-  **12 Volt Electric Heat Pads on All Holding Tanks** – Provides additional heat to the holding tanks while camping in cold climates and can also be used while in transit.
-  **35,000 BTU Furnace, and 5,500 BTU Electric Fireplace (most models)** – Unlike most competitors, Cougars have a 35,000 BTU furnace and most models have a 5,500 BTU fireplace, providing over 40,000 BTU's of heat.
-  **Heated and Enclosed Underbelly** – The sealed Coroplast underbelly has a layer of Astro-Foil insulation beneath the holding tanks, and fiberglass insulation above the tanks, while a heat duct is ran adjacent to the waterlines where heat is dumped around the fresh tank, keeping your tanks, waterlines, and gate valves from freezing.
-  **PEX Plumbing** – Resistant to corrosion, pitting, and scaling, this residential plumbing is installed using fewer fittings, reducing potential leak points. PEX retains more heat in the hot water lines, while lessening condensation in the cold water lines than traditional copper or CPVC plumbing. PEX also expands up to three times its diameter if water in the lines freeze.



ALL FIFTH WHEELS AND TRAVEL TRAILERS COME WITH ROOF AND SIDE SOLAR PREP WITH INVERTER PREP.

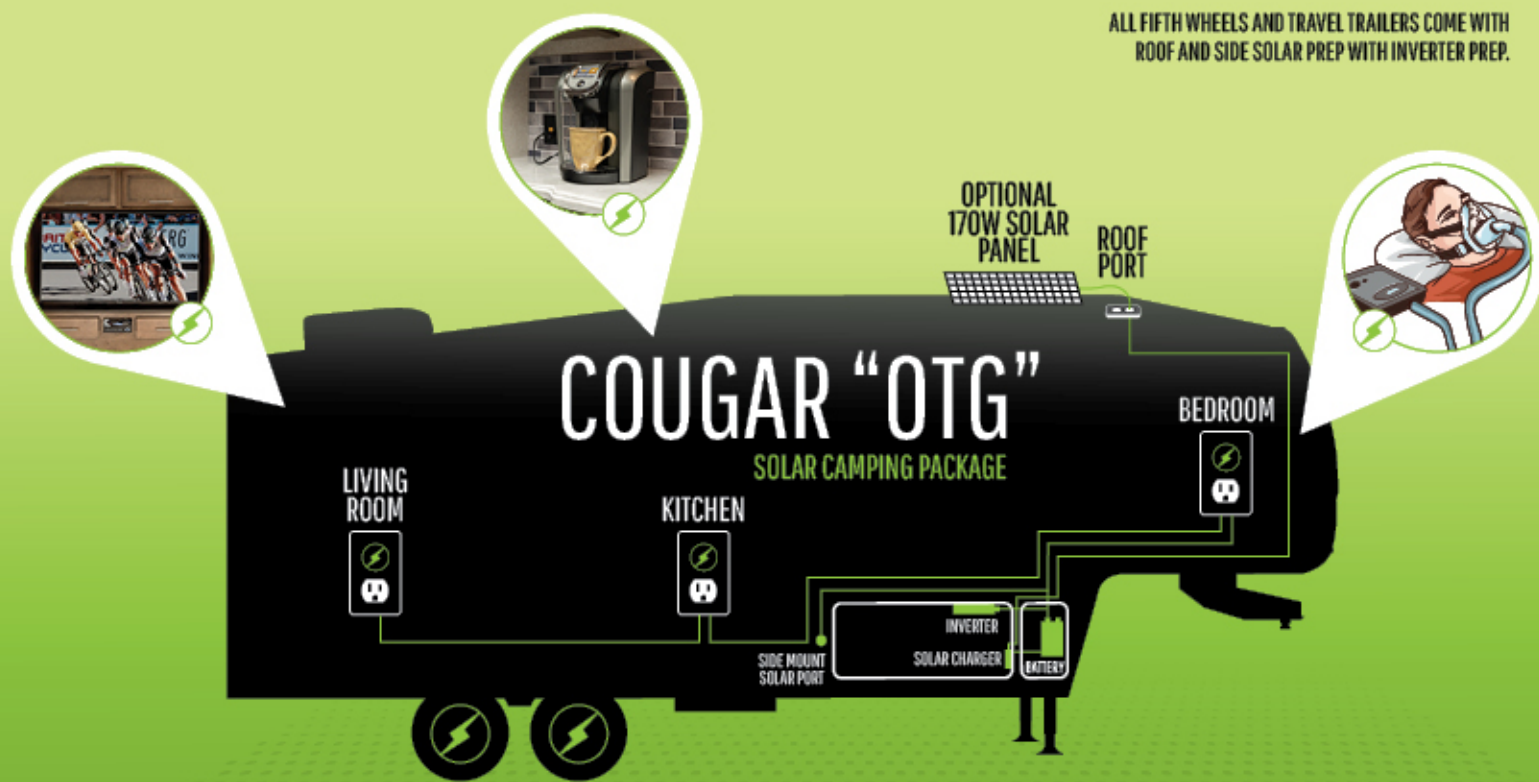

## Benefits of Solar Power

- No more dead batteries. Solar charging minimizes the need to plug into shore power to recharge batteries, helps maintain batteries, and increases battery life.
- Camping off-the-grid. Designed to make it easy to boondock off the grid for a weekend or full time.
- Solar power is quieter, cleaner and requires a lower upfront investment than traditional RV generators. A solar power system quickly pays for itself by eliminating on-going costs associated with generators, like gas, oil and other required maintenance.

### Cougar "OTG" Solar/Inverter Prep (standard)

1. Roof mounted, dual-port access with solar charger prep located in pass-through storage compartment for roof mounted applications
2. Sidewall port access for portable solar panel systems
3. Inverter prep conveniently located in the pass-through storage compartment
4. 3 - 110V Outlets on every unit are prepped for inverted use with wiring conveniently terminated in the pass-through compartment for an optional inverter

### Cougar "OTG" Solar Camping Package (option)

1. 1 - 170 watt Zamp roof mounted solar panel (expandable up to 510 watts in the aftermarket)
2. 1 - 30 amp Zamp solar charging system
3. 1 - 1200 watt pure sine inverter
4. 3 inverted outlets inside the trailer (bedroom, kitchen, living room TV)





29MBS LIVING AND ENTERTAINMENT

## Featured Floorplan: 29MBS

Light-filled rear chef's kitchen and versatile enclosed bonus room  
(all images feature Twig décor).





more product detail at  
[www.keystonerv.com/Cougar-Half-Ton](http://www.keystonerv.com/Cougar-Half-Ton)



29MBS KITCHEN



29MBS BUNKROOM



29MBS BATHROOM



29MBS BEDROOM





## Featured Floorplan: 364BHL

Master suite, 1 1/2 baths and lofted second bedroom with two double beds.







more product detail at  
[www.keystonerv.com/Cougar](http://www.keystonerv.com/Cougar)



364BHL SOFA/DINETTE (SHOWN IN STORM DECOR)



364BHL MASTER SUITE



364BHL BUNKROOM



364BHL 1/2 BATHROOM





more product detail at  
[www.keystonerv.com/Cougar](http://www.keystonerv.com/Cougar)

## Cougar | MID-PROFILE FIFTH WHEELS

- EXCLUSIVE 90° plus MaxTurn Technology™ frame and hitch design for unparalleled maneuverability
- EXCLUSIVE Hitch Vision™ for faster and easier hook-up
- NEW iN-Command® Generation 3 w/ Global Connect control system gives owners total control over power, slide rooms, awnings, HVAC and more, from a convenient master control panel as well as an enabled smartphone application
- Climate Guard Protection Package: Zero to 110 degree rated, larger heating and cooling units, with in-floor heat ducting, 12V heat pads, racetrack A/C ducting, and increased insulation
- Exceptionally durable and waterproof patent-pending automotive windshield design (select models)
- Ultra-stable and secure MORryde® Step Above™ steps
- Best-in-class unobstructed exterior pass-through storage and oversized baggage doors
- EXCLUSIVE Road Armor™ suspension equalizes axle load to dampen shock and vibration
- Road Armor™ pin box - rubberized torsion compound absorbs motion and vibration caused by road shock
- Best-in-class holding tank capacities
- Upgraded 30" wide entry door and slim shade prep
- Standard Ground Control® 3.0 auto leveling system
- 50" 4K living room television (all models)
- Self-adjusting brakes, reverse taillights and backup/side camera prep
- 35,000 BTU furnace and 15,000 BTU air conditioner
- Dyna Span® seamless floor decking with 25-year warranty
- 2" accessory hitch receiver with 300 lb. capacity
- NEW modern interior styling with pillow-top seating, fold-flat sofa, and dimmable LED lighting in main slide
- KeyTV™: A simplified multisource signal controller that distributes satellite, cable, and over-the-air feeds via a single coax cable to every television
- Gas/electric, oversized four-door refrigerator
- Standard bedroom slide-out with optional king bed (N/A 302RLS, 307RES, 353SRX, 364BHL)
- 30" x 50" residential-sized shower with seat (N/A 302RLS, 307RES, 353SRX, 364BHL, 367FLS)
- Washer/dryer prep standard (most models)
- Furrion® range and 22" oven with glass cooktop cover and Piezo ignition

**PATENTED MAX TURN TECHNOLOGY**

**MAX TURN EXPECTED TURNING RADIUS (6'6" TRUCK BED)**

Length of Truck Bed	Standard Fifth Wheel Hitch	Sliding Fifth Wheel Hitch
6'6"	93.33°	95.95°

**Competition**

EXCLUSIVE 90° plus MaxTurn Technology™  
 Frame and hitch design for unparalleled maneuverability.



EXCLUSIVE Hitch Vision™  
 No looking back convenience.



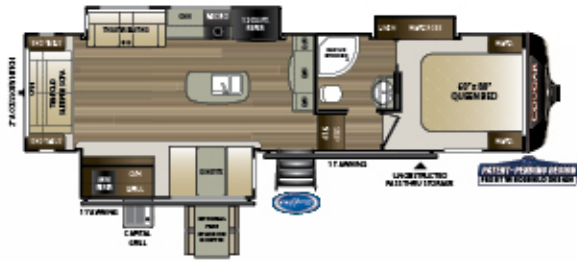

**302RLS** | Rear living room, three slides  
Weight: 10110 LBS. | Length: 34' 7"

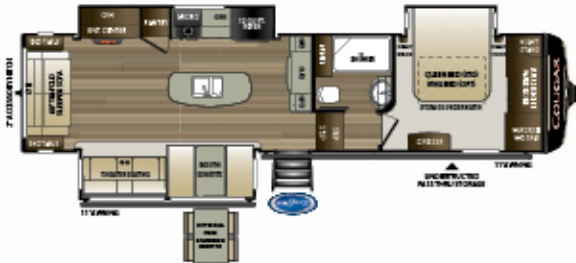

**315RLS** | Rear living room, three slides  
Weight: 10562 LBS. | Length: 35' 8"



**361RLW** | Master suite, rear living w/ windshield  
Weight: 11269 LBS. | Length: 39' 4"

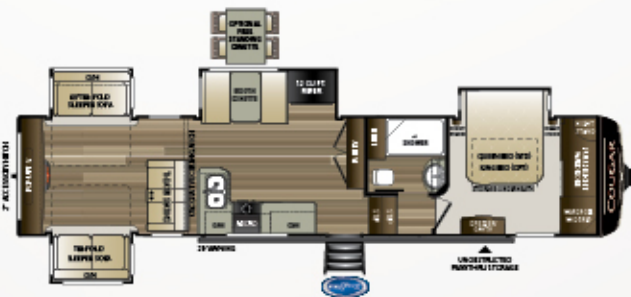

**366RDS** | Rear den, four slides  
Weight: 11280 LBS. | Length: 39' 4"

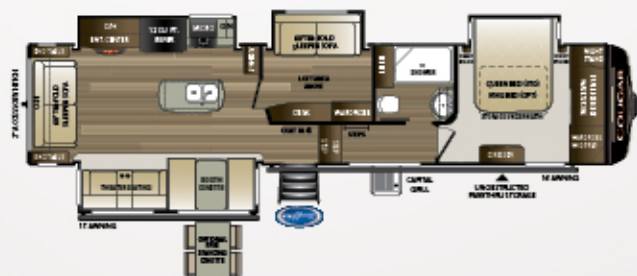

**368MBI** | Bonus room w/ loft  
Weight: 11695 LBS. | Length: 39' 4"



**307RES** | Rear living room, three slides  
Weight: 10055 LBS. | Length: 34' 7"

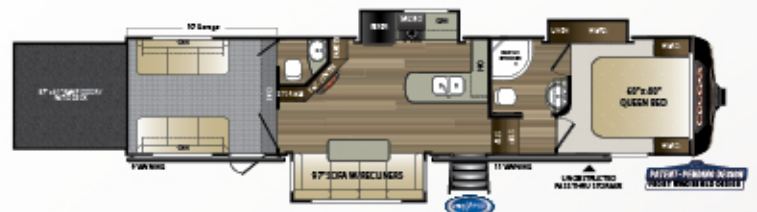

**353SRX** | Toy hauler, rear patio deck, w/ 10' garage  
Weight: 11620 | Length: 38' 11"



**364BHL** | 2 bedroom, bath and a half w/ loft  
Weight: 11225 LBS. | Length: 39' 3"

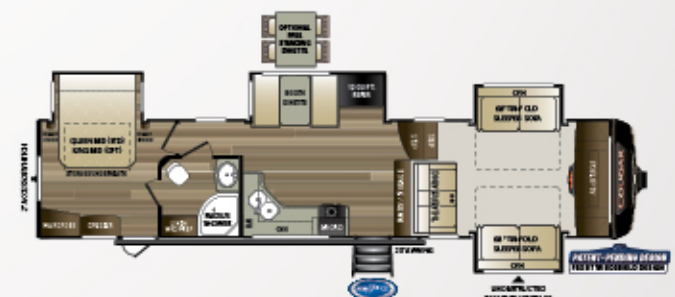

**367FLS** | Front living room w/ windshield  
Weight: 11100 LBS. | Length: 39' 4"





more product detail at  
[www.keystonerv.com/Cougar-Half-Ton](http://www.keystonerv.com/Cougar-Half-Ton)

## Cougar | HALF-TON FIFTH WHEELS

- EXCLUSIVE 90° plus MaxTurn Technology™ frame and hitch design for unparalleled maneuverability
- EXCLUSIVE Hitch Vision™ for faster and easier hook-up
- NEW iN-Command® Generation 3 w/ Global Connect control system gives owners total control over power, slide rooms, awnings, HVAC and more, from a convenient master control panel as well as an enabled smartphone application
- Climate Guard Protection Package: Zero to 110 degree rated, larger heating and cooling units, with in-floor heat ducting, 12V heat pads, racetrack A/C ducting, and increased insulation
- Ultra-stable and secure MORryde® Step Above™ steps
- Best-in-class holding tank capacities
- Upgraded 26" wide entry door and slim shade prep
- Best-in-class unobstructed exterior pass-through storage and oversized baggage doors
- EXCLUSIVE Road Armor™ suspension equalizes axle load to damping shock and vibration
- Road Armor™ pin box - rubberized torsion compound absorbs motion and vibration caused by road shock
- Upgraded exterior Capital Grill BBQ (outside kitchen models)
- Standard Ground Control® 3.0 auto leveling system
- Interior and exterior LED lights
- 35,000 BTU furnace and 15,000 BTU air conditioner
- 50" 4K living room television (most models)
- Self-adjusting brakes, reverse taillights and backup/side camera prep
- 2" accessory hitch receiver with 300 lb. capacity
- Walkable roof with rear-wall ladder for easy maintenance
- KeyTV™: A simplified multisource signal controller that distributes satellite, cable, and over-the-air feeds via a single coax cable to every television
- NEW modern interior styling with pillow-top seating, fold-flat sofa, and dimmable lighting
- 30" x 50" residential-sized shower w/seat (N/A 32BHS)
- Furrion® range and 22" oven with glass cooktop cover and Piezo ignition

**PATENTED MAX TURN TECHNOLOGY**

**MAX TURN EXPECTED TURNING RADIUS (6'6" TRUCK BED)**

Length of Truck Bed	Standard Fifth Wheel Hitch	Sliding Fifth Wheel Hitch
6'6"	83.33'	56.95'

EXCLUSIVE 90° plus MaxTurn Technology™  
 Frame and hitch design for unparalleled maneuverability.



EXCLUSIVE Hitch Vision™  
 No looking back convenience.



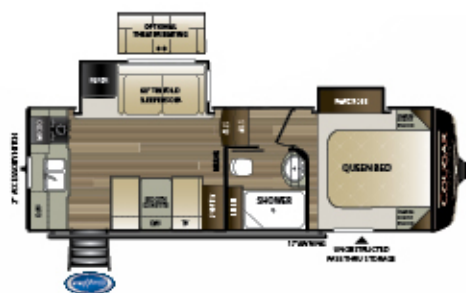

**23MLS** | Short, rear kitchen w/ wardrobe slide  
Weight: 7140 LBS. | Length: 26' 10"

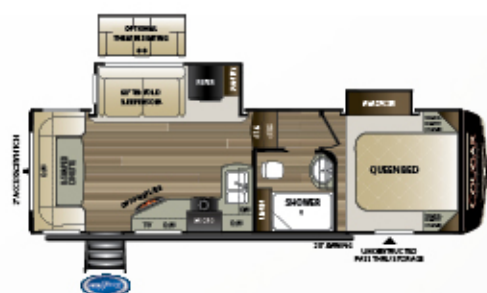

**24RDS** | Rear dinette, two slides  
Weight: 7300 LBS. | Length: 28' 6"



**25RES** | Rear entertainment, outside kitchen  
Weight: 7582 LBS. | Length: 28' 10"

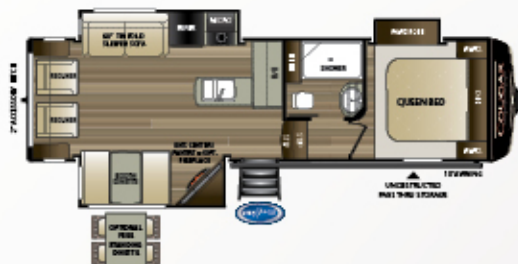

**27SGS** | Rear living room w/ mid-entry  
Weight: 8046 LBS. | Length: 31' 4"

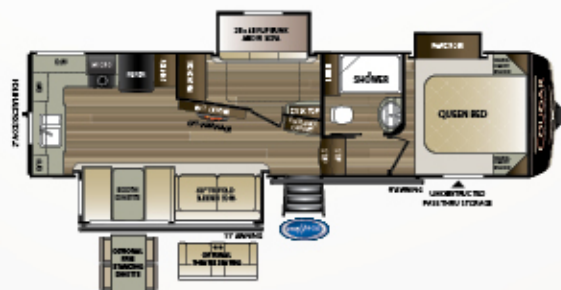

**29MBS** | Rear, private double bunkhouse  
Weight: 8760 LBS. | Length: 32' 10"

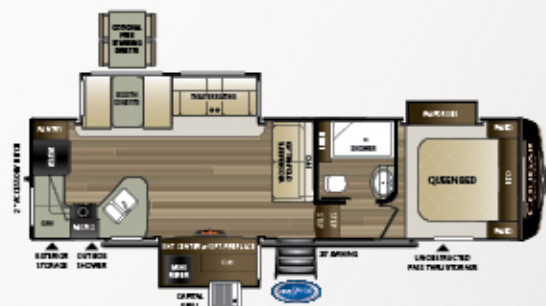

**29RKS** | Rear kitchen, open concept w/ outside kitchen  
Weight: 8801 LBS. | Length: 32' 10"



**30RLS** | Rear living room, gourmet kitchen  
Weight: 9023 LBS. | Length: 33' 6"



**32BHS** | 1 1/2 bath bunkhouse  
Weight: 9336 LBS. | Length: 35' 9"





more product detail at  
[www.keystonerv.com/Cougar-Half-Ton](http://www.keystonerv.com/Cougar-Half-Ton)

## Cougar | HALF-TON TRAVEL TRAILERS

- NEW iN-Command™ Generation 3 with Global Connect gives owners total control over power, slides, awnings, HVAC and more
- Climate Guard protection package – larger heating and cooling units, residential in-floor heat ducting, and increased insulation. Zero-degree rated
- Ultra-stable and secure MORryde® Step Above™ steps
- Upgraded exterior Capital Grill BBQ (outside kitchen models)
- Interior and exterior LED lights
- 35,000 BTU furnace and 15,000 BTU air conditioner
- 50" living room television on most models
- 70" x 80" standard king bed
- Arched rafters with 84" ceiling height
- 2" accessory hitch receiver
- Upgraded 26" wide entry door and slim shade prep
- Exceptionally durable and waterproof patent-pending automotive windshield design (select models)
- Self-adjusting brakes, reverse taillights and backup/side camera prep
- Standard Ground Control® 3.0 auto leveling system (N/A 22RBSWE, 24SABWE, 25BHSWE)
- Walkable roof with rear-wall ladder for easy maintenance
- KeyTV™ – A simplified multisource signal controller that distributes satellite, cable, and over-the-air feeds via a single coax cable to every television
- NEW modern interior styling with pillow-top seating, fold-flat sofa, and dimmable lighting
- Furion® range and 22" oven with glass cooktop cover
- Best-in-class holding tank capacities

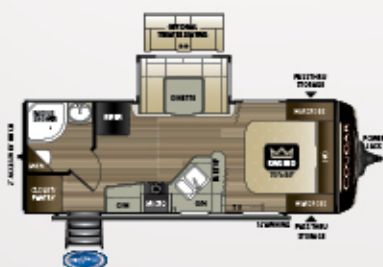

**22RBSWE** | Short rear bathroom with slide  
 Weight: 5541 LBS. | Length: 25' 11"



**24SABWE** | Dual entry rear kitchen with slide  
 Weight: 6061 LBS. | Length: 28' 4"

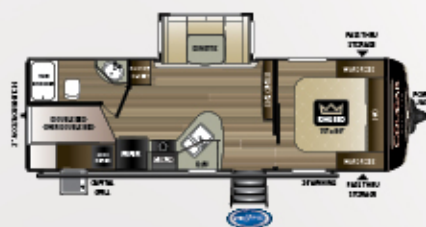

**25BHSWE** | Short double bunk house with outside kitchen  
 Weight: 6073 LBS. | Length: 29' 4"



**26RBSWE** | Rear bath with slide and outside kitchen  
 Weight: 6471 LBS. | Length: 29' 11"



**27RESWE** | Rear entertainment with outside kitchen  
 Weight: 6494 LBS. | Length: 30' 11"



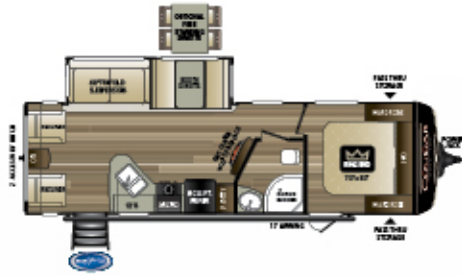

**27SABWE** | Real living with side aisle bath  
Weight: 6581 LBS. | Length: 31' 6"

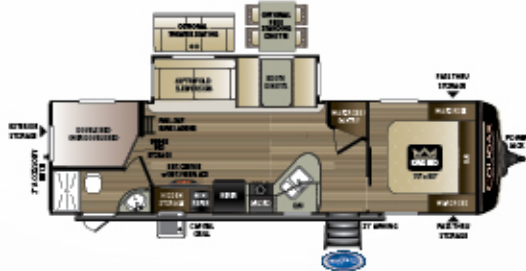

**29BHSWE** | Double bunkhouse, outside kitchen  
Weight: 6875 LBS. | Length: 34' 11"

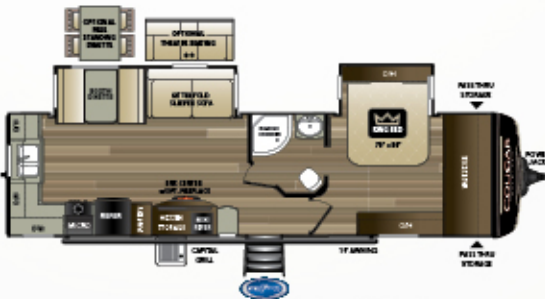

**30RKDWE** | Rear kitchen with outside kitchen  
Weight: 7620 LBS. | Length: 34' 9"

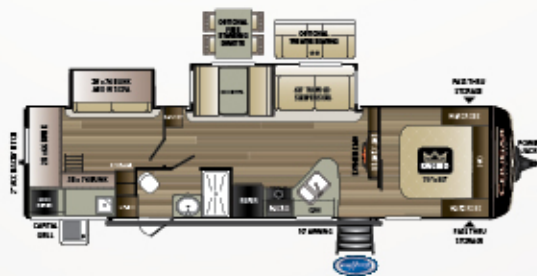

**32RDBWE** | Huge rear bunk room, outside kitchen  
Weight: 7840 LBS. | Length: 36' 4"



**32RLI** | Rear living room, three slides w/ bedroom slide  
Weight: 8416 LBS. | Length: 35' 11"

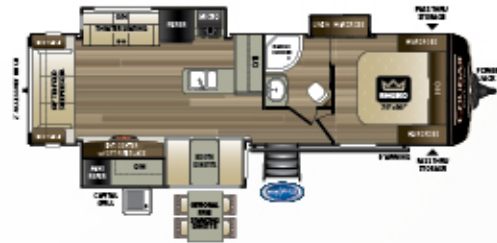

**29RLKWE** | Rear living room, outside kitchen, wardrobe slide  
Weight: 7500 LBS. | Length: 33' 3"

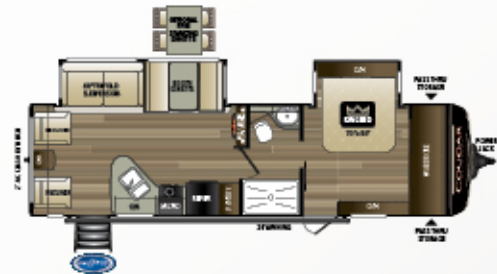

**29RLDWE** | Rear living room with bed slide  
Weight: 7381 LBS. | Length: 33' 5"



**31BHKWE** | Huge rear bunk room double slide  
Weight: 7393 LBS. | Length: 34' 9"



**29FKD** | Front kitchen, 2 slides w/ bed slide  
Weight: 7265 LBS. | Length: 33' 11"

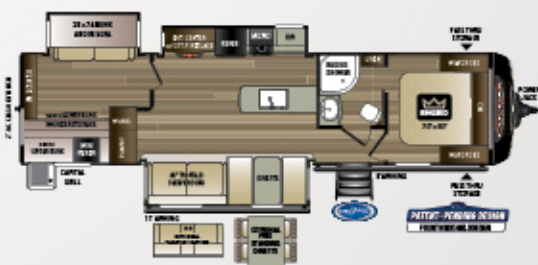

**34TSB** | Three-slide bunk house w/ outside kitchen  
Weight: 8563 LBS. | Length: 37' 5"



### MID-PROFILE FIFTH WHEELS

MODEL	WEIGHT	CARRYING CAPACITY	HITCH WEIGHT	FRESH WATER	WASTE WATER	GRAY WATER	LPG	LENGTH*	HEIGHT 1-A/C	HEIGHT 2-A/C
302RLS	10110	2050	1765	81	38	76	60	34' 7"	12' 6"	13' 5"
307RES	10005	2175	1775	81	38	76	60	34' 7"	12' 6"	13' 5"
315RLS	10562	1828	1995	81	38	76	60	35' 8"	12' 6"	13' 5"
353SRX	11620	4780	2440	81	76	76	60	38' 11"	13' 5"	13' 5"
361RLW	11269	2711	1980	81	38	76	60	33' 4"	12' 3"	13' 2"
364BHL	11225	2775	2200	81	76	76	60	39' 3"	13' 5"	13' 5"
366RDS	11280	2720	2400	81	38	76	60	33' 4"	12' 6"	13' 5"
367FLS	11100	2900	2455	81	38	76	60	33' 4"	12' 5"	13' 5"
368MBI	11695	2285	1980	81	38	76	60	33' 4"	12' 7"	13' 5"

### HALF-TON FIFTH WHEELS

MODEL	WEIGHT	CARRYING CAPACITY	HITCH WEIGHT	FRESH WATER	WASTE WATER	GRAY WATER	LPG	LENGTH*	HEIGHT 1-A/C	HEIGHT 2-A/C
23MLS	7140	2860	1335	60	30	60	60	26' 10"	11' 10"	12' 11"
24RDS	7355	2645	1370	60	30	60	60	28' 6"	11' 10"	12' 11"
25RES	7582	2418	1505	60	30	60	60	28' 10"	11' 8"	12' 8"
27SGS	8046	2244	1495	60	30	60	60	31' 4"	11' 7"	12' 8"
29MBS	8760	2240	1630	60	30	60	60	32' 10"	11' 7"	12' 8"
29RKS	8801	1599	1605	60	30	60	60	32' 10"	11' 7"	12' 8"
30RLS	9023	1977	1545	60	30	60	60	33' 6"	11' 9"	12' 10"
32BHS	9336	2164	1570	60	60	60	60	35' 9"	11' 9"	12' 10"

### HALF-TON TRAVEL TRAILERS

MODEL	WEIGHT	CARRYING CAPACITY	HITCH WEIGHT	FRESH WATER	WASTE WATER	GRAY WATER	LPG	LENGTH*	HEIGHT
22RBSWE	5541	1659	580	60	38	76	60	25' 11"	11' 3"
24SABWE	6061	1739	640	60	38	76	60	28' 4"	11' 3"
25BHSWE	6073	1927	620	60	38	76	60	29' 4"	11' 3"
26RBSWE	6471	2329	690	60	38	76	60	29' 11"	11' 3"
27RESWE	6494	2306	650	60	38	76	60	30' 11"	11' 3"
27SABWE	6581	2219	700	60	38	76	60	31' 6"	11' 3"
29RLKWE	7500	2000	810	60	38	76	60	33' 3"	11' 3"
29BHSWE	6875	1925	820	60	38	76	60	34' 1"	11' 3"
29RLDWE	7381	2119	750	60	38	76	60	33' 5"	11' 3"
30RKDWE	7620	1880	980	60	38	76	60	34' 9"	11' 3"
31BHKWE	7393	2107	810	60	38	76	60	34' 9"	11' 3"
32RDBWE	7840	2660	900	60	38	76	60	36' 4"	11' 5"
29FKD	7265	2235	910	60	30	60	60	33' 11"	11' 5"
32RLI	8416	2084	1165	60	30	60	60	35' 11"	11' 4"
34TSB	8563	1937	1150	60	30	60	60	37' 5"	11' 4"

DISCLAIMER: Product information is as accurate as possible as of the date of publication of this brochure. All features, floor plans, and specifications in this brochure are subject to change without notice. Please also consult Keystone's web site at [www.keystonerv.com](http://www.keystonerv.com) for more current product information and specifications. Tow Vehicle Disclaimer. CAUTION: Owners of Keystone recreational vehicles are solely responsible for the selection and proper use of tow vehicles. All customers should consult with a motor vehicle manufacturer or their dealer concerning the purchase and use of suitable tow vehicles for Keystone products. Keystone disclaims any liability or damages suffered as a result of the selection, operation, use or misuse of a tow vehicle. KEYSTONE'S LIMITED WARRANTY DOES NOT COVER DAMAGE TO THE RECREATIONAL VEHICLE OR THE TOW VEHICLE AS A RESULT OF THE SELECTION, OPERATION, USE OR MISUSE OF THE TOW VEHICLE. \*Length is defined as the distance from the centerline of hitch pin/coupler to rear bumper of trailer. Please review owner's manual prior to purchase for more information on service warranties, extended use, towing and maintenance. Owner's manuals can be found at [keystonerv.com](http://keystonerv.com).



## STANDARDS AND OPTIONS

### Mid-Profile Fifth Wheel

CAMPING IN STYLE PACKAGE
Laminated side walls with 5 sided aluminum superstructure
Painted fiberglass front cap w/ hitch vision & led lights
Cougar vintage maple glazed hardwood
Cabinet doors with residential hardware
12,000 Btu rapid recovery 6 gallon
Gas/electric water heater
Aluminum wheels and full size spare tire
Battery disconnect switch
Led interior and exterior lighting
MORyde® Step Above™ on main entry
Friction hinge entry door
COUGAR ANNIVERSARY PACKAGE
12 cu. ft. refrigerator (N/A 353SRX)
1.6 cu. ft. microwave upgrade
Washer/dryer prep (N/A 302RLS, 307RES, 353SRX, 364BHL)
21" Furrion® range w/ Piezo ignition and glass stovetop cover
LG solid surface countertop and stainless steel undermount kitchen sink with chef's faucet and sprayer
2" accessory hitch with 300 lb. capacity
Upgraded Road Armour™ equalizer and pin box
COUGAR COMFORT PACKAGE
15,000 BTU ducted air conditioner
50 AMP electric, pre-wired and braced for ducted bedroom A/C option
35K BTU ducted furnace
Dual 30 lb. LP tanks
1,000 CFM four-speed "Fantastic Fan" exhaust fan with rain sensor and wall-mounted controls
DELUXE ENTERTAINMENT/ TECHNOLOGY PACKAGE
50" LED HDTV in Living Area
12V AM/FM/CD/DVD/MP3/Bluetooth player with HDMI ARC control
Worry-free omni-directional digital TV antenna and WiFi prep
Exterior TV hookup
5,500 BTU electric fireplace with thermostat control and remote
Furrion® backup-observation/side camera prep
12 Volt USB charging centers
CLIMATE GUARD PROTECTION PACKAGE
Astrofoil insulated slide floors and underbelly
Reflective foil insulated front cap
Forced-air heated and enclosed underbelly
12V heat pads on holding tanks
Heated and enclosed dump valves and convenience center
Dual attic vents
SMART CAMPING
In-Command® Pro Series Gen. 3 with Global Connect
4g LTE and Wi-Fi prep
Cougar "Off the Grid" roof and side-mounted solar and inverter prep
OPTIONS
Second power awning - MANDATORY (N/A 366RDS, 367FLS)
13.5 BTU ducted bedroom A/C with thermostat (MANDATORY 353SRX)
70" x 80" king bed (N/A 302RLS, 307RES, 353SRX, 364BHL)
Free-standing dinette and chairs (N/A 353SRX)
Dual-pane frameless windows
Theater seat IPO tri-fold sofa (364BHL Only)
Slide topper package
Cougar "Off the Grid" solar camping package (MANDATORY: 353SRX)
Ramp door patio package (MANDATORY: 353SRX only)
CSA construction and seal

### Half-Ton Fifth Wheel

CAMPING IN STYLE PACKAGE
Laminated side walls with 5 sided aluminum superstructure
3/8" walkable roof decking
Painted fiberglass front cap with HitchVision™ and LED lights
Cougar Vintage Maple glazed hardwood cabinetry
Cabinet doors with residential hardware
12,000 BTU rapid recovery 6-gallon gas/electric water heater
Aluminum wheels and full size spare tire
Battery disconnect switch
LED interior and exterior lighting
MORyde® Solid Step™ at main entry
Friction-hinge entry door
HALF TON FW ANNIVERSARY PACKAGE
8 cu. ft. refrigerator
0.9 cu. ft. microwave
21" Furrion® range w/ Piezo ignition and glass stovetop cover
Foil-wrapped seamless galley and lavatory counter tops
Stainless steel undermount kitchen sink with chef's faucet and sprayer
2" accessory hitch with 300 lb. capacity
HALF TON FW COMFORT PACKAGE
15,000 BTU ducted air conditioner
50 AMP electric, pre-wired and braced for ducted bedroom A/C option
35K BTU ducted furnace
Dual 30 lb. LP tanks
CLIMATE GUARD PROTECTION PACKAGE
Astrofoil insulated slide floors and underbelly
Reflective foil insulated front cap
Forced-air heated and enclosed underbelly
12V heat pads on holding tanks
Heated and enclosed dump valves and convenience center
Dual attic vents
SMART CAMPING
In-Command® Pro Series Gen. 3 with Global Connect
4G LTE and Wi-Fi prep
Cougar "Off the Grid" roof and side-mounted solar and inverter prep
OPTIONS
Electric, four-point leveling system (MANDATORY)
Second power awning (MANDATORY 29MBS, 30RLS; N/A all other models)
Dual-pane frameless windows
13.5 BTU ducted bedroom A/C
Fireplace (MANDATORY 29MBS, 30RLS; N/A 23MLS)
Free-standing dinette and chairs (N/A 23MLS, 24RDS)
Theater seat IPO tri-fold (23MLS, 24RDS, 25RES, 29MBS, 32BHS Only)
Cougar "Off the Grid" solar camping package
CSA construction and seal

### Half-Ton Travel Trailers

CAMPING IN STYLE PACKAGE
Laminated side walls with 5 sided aluminum superstructure
3/8" walkable roof decking
Painted fiberglass front cap with HitchVision™ and LED lights
Cougar Vintage Maple glazed hardwood cabinetry
Cabinet doors with residential hardware
12,000 BTU rapid recovery 6-gallon gas/electric water heater
Aluminum wheels and full size spare tire
Battery disconnect switch
LED interior and exterior lighting
MORyde® Solid Step™ at main entry
Friction-hinge entry door
HALF TON TT ANNIVERSARY PACKAGE
8 cu. ft. refrigerator
0.9 cu. ft. microwave
21" Furrion® range w/ Piezo ignition and glass stovetop cover
Foil-wrapped seamless galley and lavatory countertops
Gourmet stainless steel undermount kitchen sink with upgraded chef's faucet and sprayer
2" accessory hitch with 300 lb. capacity
HALF TON TT COMFORT PACKAGE
15,000 BTU ducted air conditioner
35K BTU ducted furnace
Dual 30 lb. LP tanks
CLIMATE GUARD PROTECTION PACKAGE
Astrofoil insulated slide floors and underbelly
Reflective foil insulated front cap
Forced-air heated and enclosed underbelly
12V heat pads on holding tanks
Heated and enclosed dump valves
Dual attic vents
SMART CAMPING
In-Command® Pro Series Gen. 3 with Global Connect
Furrion 4G LTE and Wi-Fi prep
Cougar "Off the Grid" roof and side-mounted solar and inverter prep
OPTIONS
Electric rear stabilizer jacks (MANDATORY 22RBSWE, 24SABWE, 25BHSWE)
Automatic leveling system MANDATORY (N/A 22RBSWE, 24SABWE, 25BHSWE)
Second Power Awning (MANDATORY 32RLI, 34TSB, 31MBS, N/A all Other Models)
Dual pane frameless windows
13.5 BTU A/C, bedroom ducted (50 amp required N/A 22RBSWE, 24SABWE, 25BHSWE)
50 amp service/wire and brace for 2nd A/C MANDATORY (N/A 22RBSWE, 24SABWE, 25BHSWE)
Fireplace (N/A 22RBSWE, 24SABWE, 25BHSWE)
Free standing dinette and chairs
Theater Seat IPO Tri-Fold (N/A 27SABWE, 29RLDWE, 29RLKWE, 32RLI)
Theater seats in place of dinette (22RBSWE ONLY)
Cougar "Off The Grid" Solar Camping Package
CSA construction and seal



# BUILT FOR THE LONG HAUL



PRINT 10.2019

