

SANDSTORM TOYHAULERS

SANDSTORM

EXPLORE THE GREAT OUTDOORS.



LIVING AREA

282SLR
INTERIOR COLOR
SMOKE



RECESSED GLASS COOKTOP



GLASS SHOWER



QUEEN BED

DRY WEIGHT
8,212 LBS.

SHOWN WITH 39" TV AND CARPET
KIT OPTION

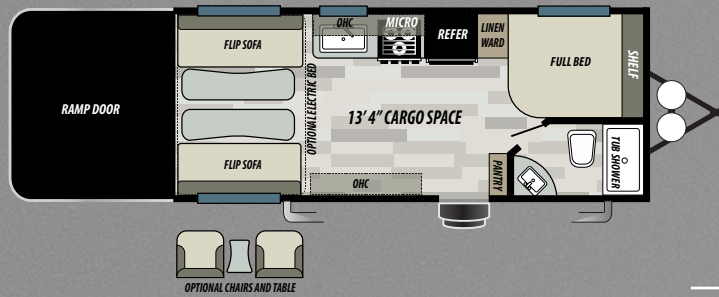

181SLC
 DRY WEIGHT
 6,399 LBS

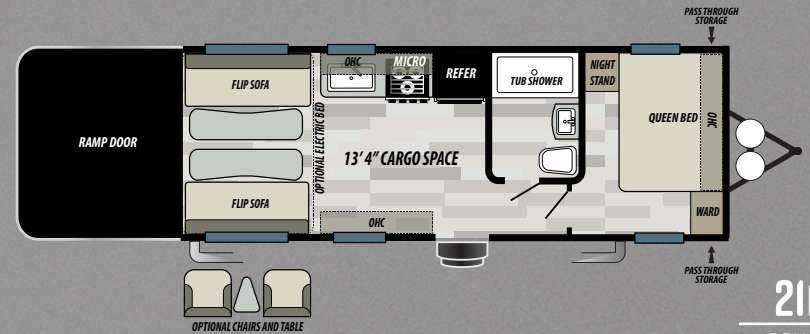

211SLC
 DRY WEIGHT
 6,611 LBS

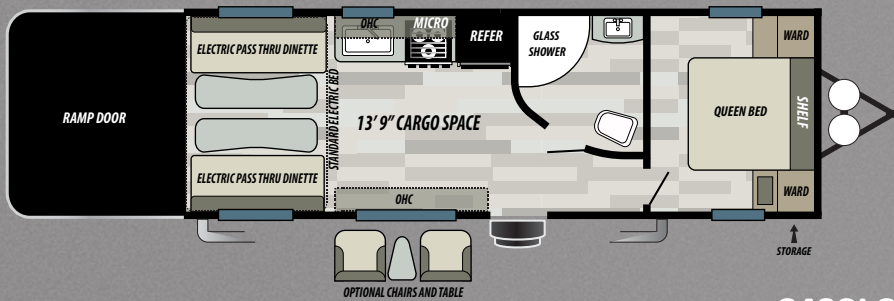

242SLC
 DRY WEIGHT
 6,859 LBS

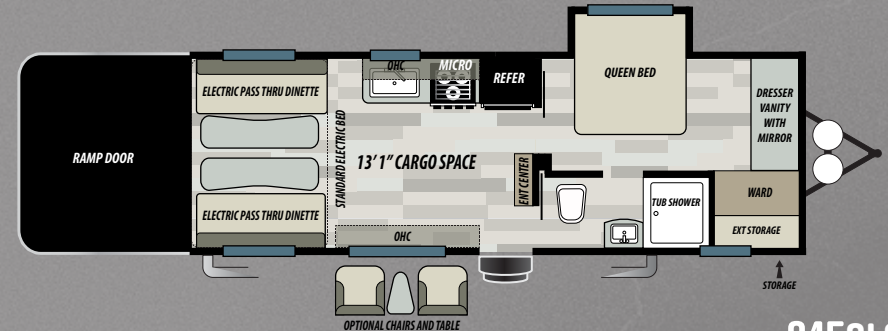

245SLC
 DRY WEIGHT
 7,274 LBS

FLOORPLAN KEY

- OHC
- OVERHEAD CABINET
- WARD
- WARDROBE
- MICRO
- MICROWAVE
- REFER
- REFRIGERATOR

| | 181SLC | 211SLC | 242SLC | 245SLC | 251SLC | 271GSLR/272SLC | 282SLR | 283SLR | 292GSLR | 293GSLR | 313GSLR | 303GSLR |
|------------------------------------|--------|---------|--------|---------|--------|----------------|--------|--------|---------|---------|---------|---------|
| HITCH WEIGHT (LBS.) | 853 | 913 | 1,087 | 1,080 | 1,207 | 1,092 | 1,174 | 1,351 | 1,415 | 1,360 | 1,630 | 1,505 |
| GROSS VEHICLE WEIGHT RATING (LBS.) | 9,999 | 9,999 | 9,999 | 9,999 | 9,999 | 9,999/10,999* | 12,100 | 6,000 | 13,000 | 13,360 | 13,630 | 13,000 |
| UNLOADED VEHICLE WEIGHT (LBS.) | 6,399 | 6,611 | 6,859 | 7,274 | 7,099 | 7,750 | 8,212 | 8,567 | 9,479 | 9,108 | 10,322 | 10,051 |
| CARGO CARRYING CAPACITY (LBS.) | 3,600 | 3,388 | 3,140 | 2,725 | 2,900 | 2,249/3245* | 3,888 | 4,746 | 3,521 | 4,252 | 3,270 | 2,949 |
| EXTERIOR LENGTH (FT.) | 25' 7" | 27' 11" | 30' 4" | 28' 11" | 30' 7" | 33' 6" | 35' | 36' 4" | 35' 10" | 35' 10" | 36' 10" | 36' 8" |
| EXTERIOR HEIGHT (FT.) | 12' | 12' | 12' | 12' | 12' | 12' 7" | 12' 7" | 12' 7" | 12' 4" | 12' 9" | 12' 9" | 12' 4" |
| FRESH WATER (GAL.) | 86 | 86 | 146 | 86 | 146 | 146 | 150 | 150 | 150 | 150 | 150 | 150 |
| GREY WATER (GAL.) | 65 | 65 | 65 | 80 | 65 | 65 | 65 | 65 | 65 | 80 | 65 | 80 |
| BLACK WATER (GAL.) | 35 | 40 | 40 | 40 | 40 | 40 | 40 | 40 | 40 | 40 | 40 | 40 |
| TIRE SIZE (IN.) | 15" | 15" | 15" | 15" | 15" | 15" | 16" | 16" | 16" | 16" | 16" | 16" |

271GSLR *

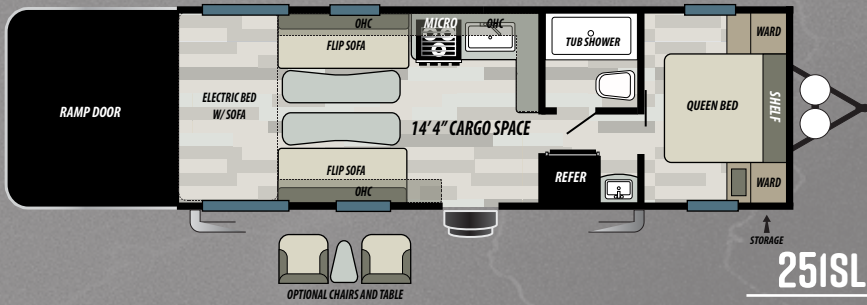

251SLC
 DRY WEIGHT
 7,099 LBS

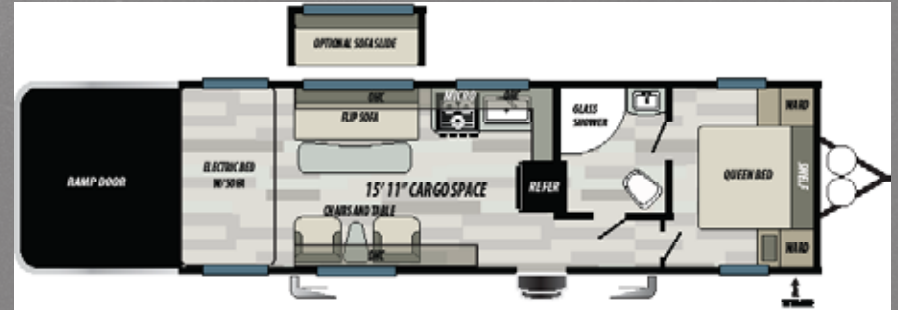

271GSLR/272SLC
 DRY WEIGHT
 7,750 LBS

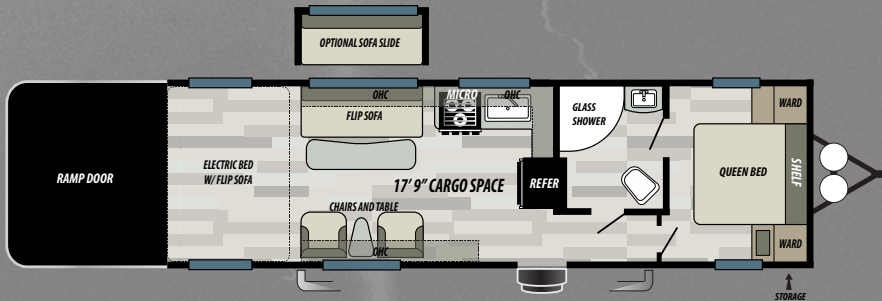

282SLR
 DRY WEIGHT
 8,212 LBS

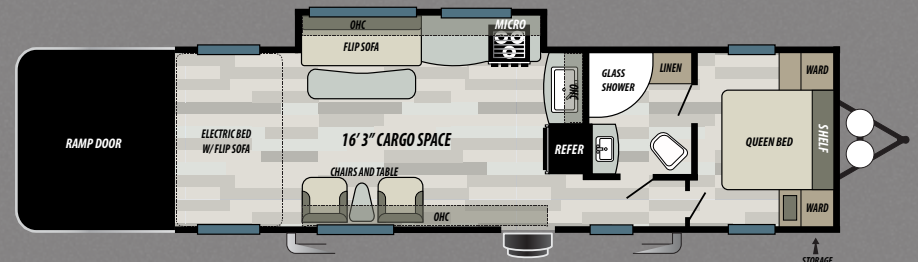

283SLR
 DRY WEIGHT
 8,567 LBS

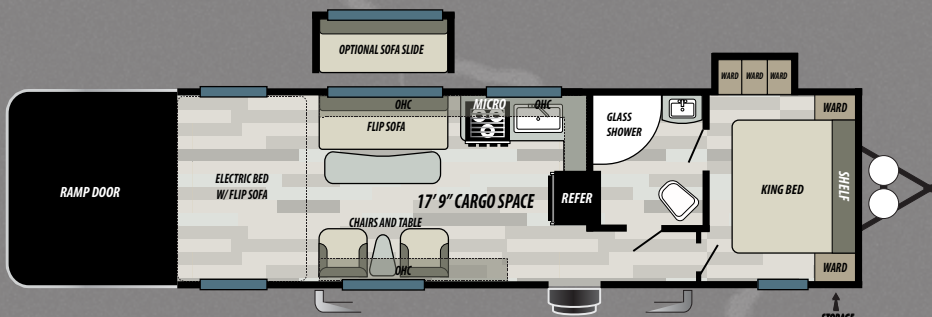

292GSLR
 DRY WEIGHT
 9,479 LBS

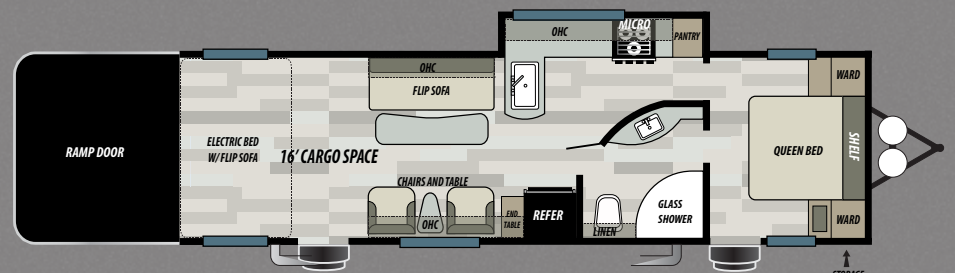

293GSLR
 DRY WEIGHT
 9,108 LBS

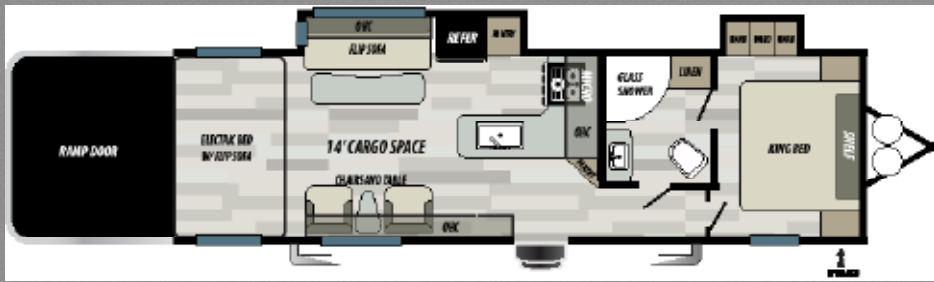

313GSLR

DRY WEIGHT
10,322 LBS

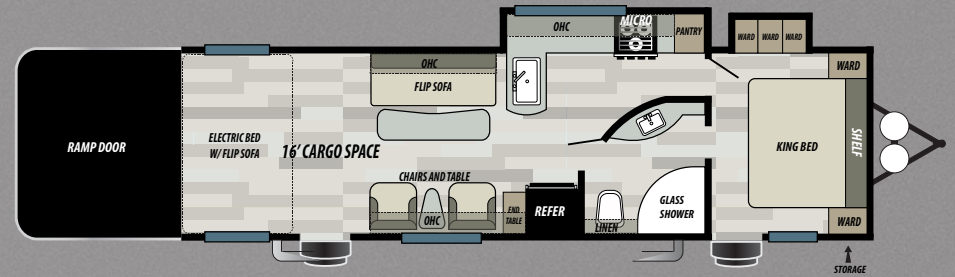

303GSLR

DRY WEIGHT
10,051 LBS

242SLC
INTERIOR COLOR
SMOKE



DRY WEIGHT
6,859 LBS.

24FQMX SHOWN IN SLATE INTERIOR

SLC SERIES

POPULAR FEATURES

- 60" X 80" RESIDENTIAL QUEEN MATTRESS – MAIN BEDROOM
- HEATED & ENCLOSED TANKS
- 35 GALLON FUEL STATION
- 6 GALLON GAS & ELECTRIC WATER HEATER
- 13,500 BTU DUCTED AIR CONDITIONER
- 30,000 BTU FURNACE
- 8 CU FT DOUBLE DOOR REFRIGERATOR
- 102" WIDE BODY CONSTRUCTION
- BEAVER TAIL FLOOR (PER FP)
- TIE DOWNS MOUNTED TO STEEL
- 3,000 LB. RADIUS RAMP DOOR
- SINGLE ELECTRIC BED (PER FP)
- OUTSIDE SHOWER
- DRIVE-ON WHEEL WELL (DOOR SIDE)
- GLASS SHOWER DOOR
- ELECTRONIC CHARGING STATIONS (3)
- 2" FULLY INSULATED FLOOR
- AM/FM BLUETOOTH RADIO WITH INTERIOR & EXTERIOR SPEAKERS
- 220 WATT SOLAR PANEL & REGULATOR
- STABILIZER JACKS ALL 4 CORNERS
- CAPITAL PILLOW TOP MATTRESS
- LG SOLID SURFACE KITCHEN COUNTERTOP
- ALUMINUM WHEELS

- 22" CHEF'S OVEN WITH RECESSED GLASS TOP
- STAINLESS STEEL APPEARANCE APPLIANCES
- RAMP DOOR PATIO CABLES
- LED AWNING LIGHT STRIP
- FRICTION HINGE ENTRY DOORS
- MAGNETIC BAGGAGE DOOR LATCHES

G-SERIES PACKAGE

- ALUMA-WALL FIBERGLASS
- NIGHT SHADES
- POWER AWNING

AVAILABLE OPTIONS

- 2 CHAIRS WITH BAY WINDOW IN PLACE OF C/S SOFA (PER FP)
- 4.0 ONAN GENERATOR
- 8 CU FT DOUBLE DOOR REFRIGERATOR IN PLACE OF 6 CU FT
- DUAL 30# LP BOTTLES IN PLACE OF 20# BOTTLES
- 1,500 WATT 60 POWER INVERTER
- 39" LED TV IN LIVING ROOM
- 28" TV IN BEDROOM
- 15,000 BTU AIR CONDITIONER IPO 13,500 BTU
- CARPET KIT
- ELECTRIC PASS THROUGH DINETTE – (PER FP)
- GREY FIBERGLASS EXTERIOR IN PLACE OF WHITE FIBERGLASS

- FIBERGLASS MOLDED FRONT CAP
- KENWOOD AUDIO SOUND SYSTEM
- NIGHT SHADES IPO MINI BLINDS
- POWER AWNING WITH ADJUSTABLE LEGS – STANDARD IN G-SERIES
- POWER TONGUE JACK
- RAMP DOOR PLAYPEN
- TOUGH PLY FLOORING IN CARGO AREA
- TOYLOK DOOR SIDE
- ARCTIC PACKAGE – RADIANT FOIL INSULATION IN THE ROOF AND FLOOR

COMFORT & CONVENIENCE PACKAGE

- ADD-A-WALL
- BLACK TANK FLUSH
- ENTRY SWING AWAY HANDLE
- MATCHING ALUMINUM SPARE TIRE
- RETRACTABLE ROOF LADDER
- BBQ HOOK UP CONNECTION
- WATER HEATER BYPASS

SLR SERIES

POPULAR FEATURES

- 4.0 ONAN GENERATOR
- 35 GALLON FUEL STATION
- 2 CHAIRS WITH BAY WINDOW
- 60" X 80" RESIDENTIAL QUEEN MATTRESS (PER FP)
- RESIDENTIAL KING SIZE MATTRESS (PER FP)
- 8 CU FT REFRIGERATOR
- HEATED & ENCLOSED UNDERBELLY
- 146 GALLON FRESH WATER CAPACITY
- 60 GALLON GREY TANK (80 IN T291)/ 40 GALLON BLACK TANK
- 6 GALLON GAS & ELECTRIC WATER HEATER
- 30,000 BTU FURNACE
- 102" WIDE BODY CONSTRUCTION
- TIE DOWNS MOUNTED TO STEEL
- 3,000 LB. RADIUS RAMP DOOR
- BEAVER TAIL FLOOR
- ELECTRIC AWNING WITH ADJUSTABLE LEGS
- ELECTRIC BED AND BOTTOM FLIP SOFA
- OUTSIDE SHOWER
- DRIVE-ON WHEEL WELL (DOOR SIDE)
- GLASS SHOWER DOOR
- ELECTRONIC CHARGING STATIONS (3)
- 2" FULLY INSULATED FLOOR
- AM/FM BLUETOOTH RADIO WITH INTERIOR & EXTERIOR SPEAKERS
- 220 WATT SOLAR PANEL & REGULATOR
- STABILIZER JACKS ALL 4 CORNERS

- CAPITAL PILLOW TOP MATTRESS
- LIGHTED LG SOLID SURFACE KITCHEN COUNTERTOP
- ALUMINUM WHEELS
- 1.6 CU FT STAINLESS STEEL MICROWAVE
- 22" CHEF'S OVEN WITH RECESSED GLASS TOP
- STAINLESS STEEL APPEARANCE APPLIANCES
- RAMP DOOR PATIO CABLES
- FRICTION HINGE ENTRY DOORS
- MAGNETIC BAGGAGE DOOR LATCHES
- LED AWNING LIGHT STRIP

G-SERIES PACKAGE

- ALUMA-WALL FIBERGLASS
- NIGHT SHADES
- POWER AWNING
- 10 GALLON WATER HEATER
- FENDER SKIRTS W/ RADIUS AUTO MOLD

POPULAR OPTIONS

- 5.5 ONAN GENERATOR W/ 50 AMP SERVICE AND 13,500 BTU AC IN BEDROOM
- 10 GAL WATER HEATER IN PLACE OF 6 GALLON – STANDARD G-SERIES
- DUAL 30# LP BOTTLES IN PLACE OF 20# BOTTLES
- 1,500 WATT 60 POWER INVERTER
- CARPET KIT
- ELECTRIC PASS THROUGH DINETTE IN PLACE OF ELECTRIC BED SOFA
- 39" LED TV IN LIVING ROOM

- 28" TV IN BEDROOM
- FIBERGLASS MOLDED FRONT CAP
- GREY FIBERGLASS EXTERIOR IPO WHITE FIBERGLASS
- KENWOOD AUDIO SOUND SYSTEM
- NIGHT SHADES IN PLACE OF MINI BLINDS – MANDATORY ON METAL UNITS. STANDARD IN G-SERIES
- POWER TONGUE JACK
- RAMP DOOR PLAYPEN
- SOFA SLIDE-OUT WITH CABINETS (PER FP)
- TOUGH PLY FLOORING IN CARGO
- TOYLOK DOOR SIDE
- ARCTIC PACKAGE – RADIANT FOIL INSULATION IN THE ROOF AND FLOOR
- POWER STABILIZER JACKS

COMFORT & CONVENIENCE PACKAGE

- ADD-A-WALL
- BLACK TANK FLUSH
- ENTRY SWING AWAY HANDLE
- MATCHING ALUMINUM SPARE TIRE
- RETRACTABLE ROOF LADDER
- BBQ HOOK UP CONNECTION
- WATER HEATER BYPASS
- 15,000 BTU AIR CONDITIONER

SANDSTORM SPORT SERIES

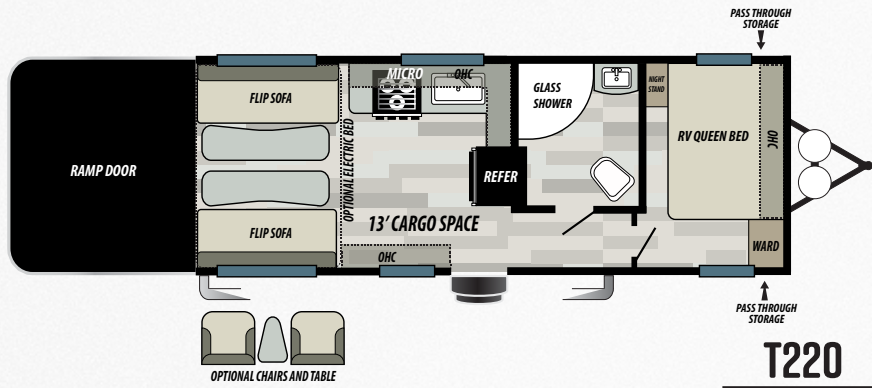

T220
DRY WEIGHT
6,126 LBS

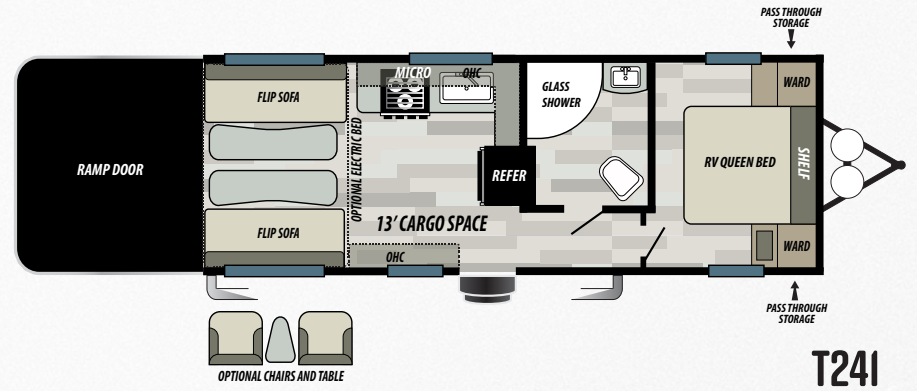

T241
DRY WEIGHT
6,251 LBS



STANDARDS & OPTIONS

POPULAR FEATURES

- HEATED & ENCLOSED TANKS
- 86 GALLON FRESH WATER CAPACITY
- 40 GALLON GREY TANK / 40 GALLON BLACK TANK
- 6 GALLON GAS & ELECTRIC WATER HEATER
- 13,500 BTU DUCTED AIR CONDITIONER
- 30,000 BTU FURNACE
- 8 CU FT DOUBLE DOOR REFRIGERATOR
- 102" WIDE BODY CONSTRUCTION
- TIE DOWNS MOUNTED TO STEEL

- 3,000 LB. RADIUS RAMP DOOR
- 2" FULLY INSULATED FLOOR
- THERMAFOIL COUNTERTOPS

POPULAR OPTIONS

- 2 CHAIRS WITH BAY WINDOW IN PLACE OF SOFA
- DUAL 30# LP BOTTLES IN PLACE OF 20# BOTTLES
- 15,000 BTU AIR CONDITIONER IPO 13,500 BTU
- RETRACTABLE EXTERIOR ROOF LADDER
- WATER HEATER BYPASS
- 135W SOLAR PANEL W/ REGULATOR

- POWER AWNING WITH ADJUSTABLE LEGS
- ARCTIC PACKAGE – RADIANT FOIL INSULATION IN THE ROOF AND FLOOR

ENTERTAINMENT PACKAGE

- BLUETOOTH STEREO W/ INTERIOR & EXTERIOR SPEAKERS
- TV ANTENNA W/ BOOSTER
- ELECTRIC CHARGING STATIONS (3)

COMFORT AND CONVENIENCE PACKAGE

- BLACK TANK FLUSH
- STABILIZER JACKS (4)
- MATCHING ALUMINUM SPARE TIRE
- SINGLE ELECTRIC BED
- SOLAR PREP
- 20 GALLON FUEL STATION
- CAPITAL PILLOWTOP MATTRESS
- NIGHT SHADES

| | T220 | T24I |
|------------------------------------|---------|--------|
| HITCH WEIGHT (LBS.) | 918 | 871 |
| GROSS VEHICLE WEIGHT RATING (LBS.) | 9,999 | 9,999 |
| UNLOADED VEHICLE WEIGHT (LBS.) | 6,126 | 6,251 |
| CARGO CARRYING CAPACITY (LBS.) | 3,873 | 3,748 |
| EXTERIOR LENGTH (FT.) | 28' 11" | 30' 1" |
| EXTERIOR HEIGHT (FT.) | 12' 1" | 12' 1" |
| FRESH WATER (GAL.) | 86 | 86 |
| GREY WATER (GAL.) | 40 | 40 |
| BLACK WATER (GAL.) | 40 | 40 |
| TIRE SIZE (IN.) | 15" | 15" |



F286GSLR
INTERIOR COLOR
SIENNA



DRY WEIGHT
9,640 LBS.

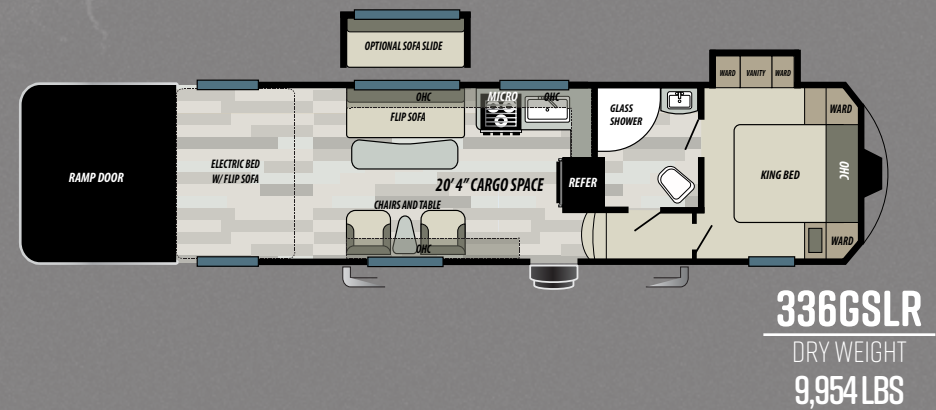
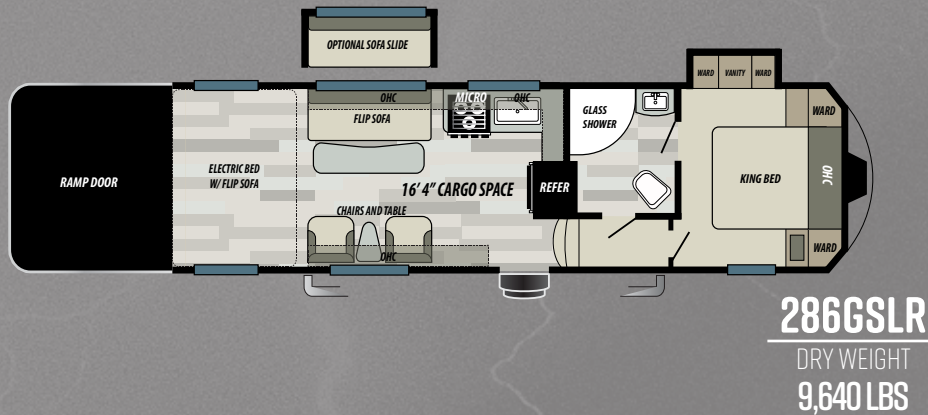

STANDARDS & OPTIONS

POPULAR FEATURES

- 4.0 ONAN GENERATOR
- 35 GALLON FUEL STATION
- 2 CHAIRS WITH BAY WINDOW
- RESIDENTIAL KING MATTRESS - MAIN BEDROOM
- HEATED & ENCLOSED TANKS
- 146 GALLON FRESH WATER CAPACITY
- 65 GALLON GREY TANK / 40 GALLON BLACK TANK
- 30,000 BTU FURNACE
- 15,000 BTU DUCTED A/C
- 8 CU FT DOUBLE DOOR REFRIGERATOR
- 102" WIDE BODY CONSTRUCTION
- TIE DOWNS MOUNTED TO STEEL
- 3,000 LB. RADIUS RAMP DOOR
- BEAVER TAIL FLOOR
- ELECTRIC AWNING WITH ADJUSTABLE LEGS
- ELECTRIC BED AND BOTTOM FLIP SOFA
- OUTSIDE SHOWER
- DRIVE-ON WHEEL WELL (DOOR SIDE)
- GLASS SHOWER DOOR
- ELECTRONIC CHARGING STATIONS (3)
- 2" FULLY INSULATED FLOOR
- KENWOOD TOUCH DVD PLAYER WITH INTERIOR & EXTERIOR SPEAKERS
- BLACK TANK FLUSH
- BBQ HOOK UP CONNECTION
- 220 WATT SOLAR PANEL & REGULATOR

- STABILIZER JACKS REAR
- CAPITAL PILLOW TOP MATTRESS
- LIGHTED LG SOLID SURFACE KITCHEN COUNTERTOP
- ALUMINUM WHEELS
- 1.6 CU FT STAINLESS STEEL MICROWAVE
- 22" CHEF'S OVEN WITH RECESSED GLASS TOP
- RAMP DOOR PATIO CABLES
- LED AWNING LIGHT STRIP
- 10 GALLON WATER HEATER
- FLIPPED AXLES
- BEDROOM SLIDEOUT

POPULAR OPTIONS

- 5.5 ONAN GENERATOR W/ 50 AMP SERVICE AND 13,500 BTU AC IN BEDROOM
- 1,500 WATT GO POWER INVERTER
- CARPET KIT
- ELECTRIC PASS THROUGH DINETTE IN PLACE OF ELECTRIC BED SOFA
- 39" LED TV IN LIVING ROOM
- 28" TV IN BEDROOM
- GREY FIBERGLASS EXTERIOR IN PLACE OF WHITE FIBERGLASS
- RAMP DOOR PLAYPEN
- SOFA SLIDE-OUT WITH CABINETS
- TOUGH PLY FLOORING IN CARGO
- TOYLOK DOOR SIDE
- ARCTIC PACKAGE - RADIANT FOIL INSULATION IN THE ROOF AND FLOOR

COMFORT & CONVENIENCE PACKAGE

- ADD-A-WALL
- ENTRY SWING AWAY HANDLE
- MATCHING ALUMINUM SPARE TIRE
- RETRACTABLE ROOF LADDER
- WATER HEATER BYPASS

| | 286GSLR | 336GSLR |
|------------------------------------|---------|---------|
| HITCH WEIGHT (LBS.) | 2,210 | 2,458 |
| GROSS VEHICLE WEIGHT RATING (LBS.) | 14,210 | 14,999 |
| UNLOADED VEHICLE WEIGHT (LBS.) | 9,640 | 9,954 |
| CARGO CARRYING CAPACITY (LBS.) | 4,570 | 5,045 |
| EXTERIOR LENGTH (FT.) | 32' 6" | 36' 6" |
| EXTERIOR HEIGHT (FT.) | 13' 4" | 13' 4" |
| FRESH WATER (GAL.) | 150 | 150 |
| GREY WATER (GAL.) | 65 | 65 |
| BLACK WATER (GAL.) | 40 | 40 |
| TIRE SIZE (IN.) | 16" | 16" |

SANDSTORM

FREE MEMBERSHIP
to Forest River Owners' Group

www.forestriverfrog.com



Learn More
Scan this barcode using
a QR Reader on your
smart phone to learn
more about Forest River.



A Berkshire Hathaway company.

FOREST RIVER INC., 255 S PEPPER AVE RIALTO, CA 92376 | (909) 873-3777
WWW.FORESTRIVERINC.COM/SANDSTORM | WWW.FORESTRIVERACCESSORIES.COM

YOUR SANDSTORM DEALER



www.ForestRiverBuyLocal.com

Specification Definitions

GVWR (Gross Vehicle Weight Rating) - is the maximum permissible weight of the unit when fully loaded. It includes all weights, inclusive of all fluids, cargo, optional equipment and accessories. For safety and product performance do NOT exceed the GVWR.

GAWR (Gross Axle Weight Rating) - is the maximum permissible weight, including cargo, fluids, optional equipment and accessories that can be safely supported by a combination of all axles.

UVW (Unloaded Vehicle Weight)* - is the typical weight of the unit as manufactured at the factory. It includes all weight at the unit's axle(s) and tongue or pin and LP Gas. The UVW does not include cargo, fresh potable water, additional optional equipment or dealer installed accessories.

*Estimated average based on standard build optional equipment.

CCC (Cargo Carrying Capacity)** - is the amount of weight available for fresh potable water, cargo, additional optional equipment and accessories. CCC is equal to GVWR minus UVW. Available CCC should accommodate fresh potable water (8.3 lbs per gallon). Before filling the fresh water tank, empty the black and gray tanks to provide for more cargo capacity. ** Estimated average based on standard build optional equipment

Each Forest River RV is weighed at the manufacturing facility prior to shipping. A label identifying the unloaded vehicle weight of the actual unit and the cargo carrying capacity is applied to every Forest River RV prior to leaving our facilities. The load capacity of your unit is designated by weight, not by volume, so you cannot necessarily use all available space when loading your unit.

All information contained in this brochure is believed to be accurate at the time of publication. However, during the model year, it may be necessary to make revisions and Forest River, Inc., reserves the right to make all such changes without notice, including prices, colors, materials, equipment and specifications as well as the addition of new models and the discontinuance of models shown in this brochure. Therefore, please consult with your Forest River dealer and confirm the existence of any materials, design or specifications that are material to your purchase decision. Litho. U.S.A. FOR 1420 P/W: 2019.3.1