

# Prism

Prism



# PRISM: THE PERFECT BLEND OF VALUE, LUXURY AND MERCEDES BENZ DRIVEABILITY.

BUILT ON THE MERCEDES 3500 SPRINTER CHASSIS, PRISM IS A FAVORITE OF CAMPERS LOOKING FOR BOTH SHORT AND EXTENDED TRIPS. OFFERING THE DRIVEABILITY YOU DESIRE, THIS MULTI-USE TOURING VEHICLE SETS THE STANDARD FOR CONVENIENCE, ABUNDANT CAPACITIES AND AFFORDABILITY. IT'S THE PERFECT COMBINATION BETWEEN EXPERIENCE, DEPENDABILITY AND VALUE FROM THE INDUSTRY'S PREMIER CLASS C MOTORHOME MANUFACTURER WITH THE FUEL ECONOMY AND PRESTIGE OF THE MERCEDES BENZ DIESEL CHASSIS.



## EXTERIOR FEATURES

- Mercedes-Benz® Chassis**  
 Reliable and fuel efficient, the Mercedes-Benz® Sprinter chassis has set the standard for driveability and safety
- 2" Vacuum Bond Laminated Sidewalls**  
 The thickest Azdel™ in its class, assuring a lifetime of structural integrity
- Lamilux™ 4000 Color Infused Fiberglass**  
 Industry leading Lamilux™ thickness provides a high gloss finish for years to come
- Azdel "SuperLite" substrate with Aluminum Framing**  
 Made in America, the Azdel is dry rot resistant, contains higher R-values, and is formaldehyde free
- CrossFlex Roof Membrane**  
 The synthetic thermoplastic roof membrane provides three times more puncture resistance than the competition
- Solar Prep**  
 Charge your coach battery with an optional aftermarket solar panel, increasing the amount of sunlight reaching your coach
- Exterior Storage**  
 The Prism maximizes its exterior storage providing abundant space for necessities and toys.
- Propane Capacity**  
 With 85 lbs of LP, the Prism eliminates the need for frequent refills while traveling
- Fresh Water Capacity**  
 With up to 50 gallons capacity, the Prism holds 20% more water than any other model built on the Mercedes Benz Sprinter Chassis
- Hydraulic Leveling Jacks (Optional)**  
 Stabilize and level your coach automatically and quickly with the touch of a button
- Camping Cozy Package (Optional)**  
 Dual Pane Windows and Heated Tank Pads provide extra comfort in multiple seasons and weather conditions
- Exterior Entertainment (Optional)**  
 Enjoy your favorite movie or sporting event under your awning and in the fresh air



## FULL BODY PAINT OPTIONS



CRIMSON



SHADOW



UNIQUE

2200FS SHOWN WITH MOCHA DECOR AND OPTIONAL DUAL RECLINERS

STYLING

## INTERIOR FEATURES

- Unique Floorplans**  
 Functional floorplans with the customer's camping needs in mind
- Slide-in-Slide Entertainment Center (2200FS Only)**  
 Multiple viewing angles for maximum comfort as well as privacy between the bedroom and living areas
- Thermofoil Countertops**  
 Easy to clean seamless countertops
- Large Closets**  
 Best in class closet space for optimal organization
- Conventional Oven**  
 Multiple cooking options with oven/range combination



2200FS SHOWN WITH MOCHA DECOR



2300DS SHOWN WITH MOCHA DECOR



2300DS SHOWN

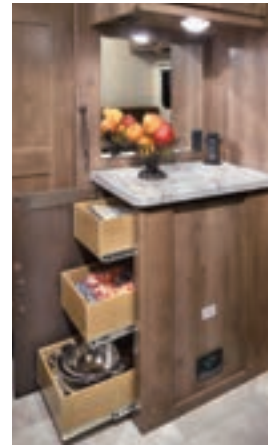

2300DS SHOWN WITH MOCHA DECOR

## INTERIOR FEATURES

- Even Cool A/C Ducting System**  
 Insulated duct work system with mold inhibitor provides superior air quality with more efficient and consistent cooling
- Wi-Fi Ranger Sky4**  
 Boosts weak Wi-Fi signal, secure network with Safesurf VPN, single login for all devices, auto-reconnect and LTE data ready
- Cabover Bunk**  
 Large cabover bunk allows for more sleeping and storage capabilities
- Large Sliding Windows**  
 Provide better ventilation by allowing air to flow more naturally
- Day/Night Window Shades**  
 Creates a range of comfort and privacy options



CREAM



MOCHA

DECOR

# FLOOR PLANS

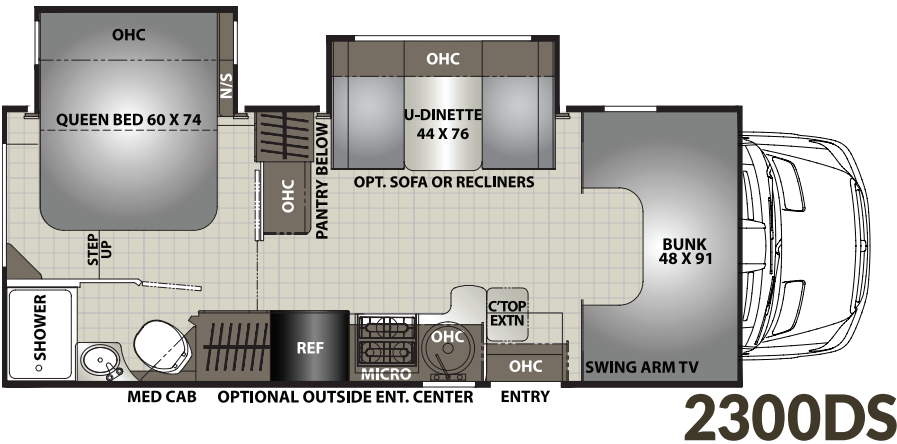
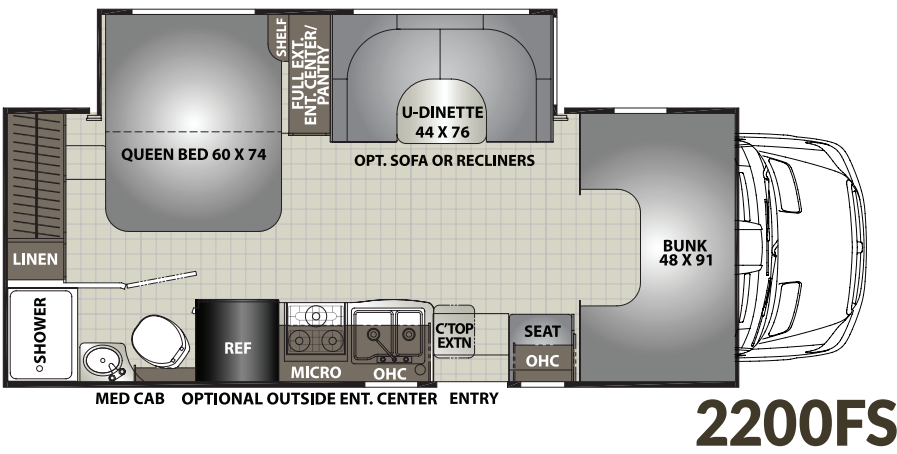
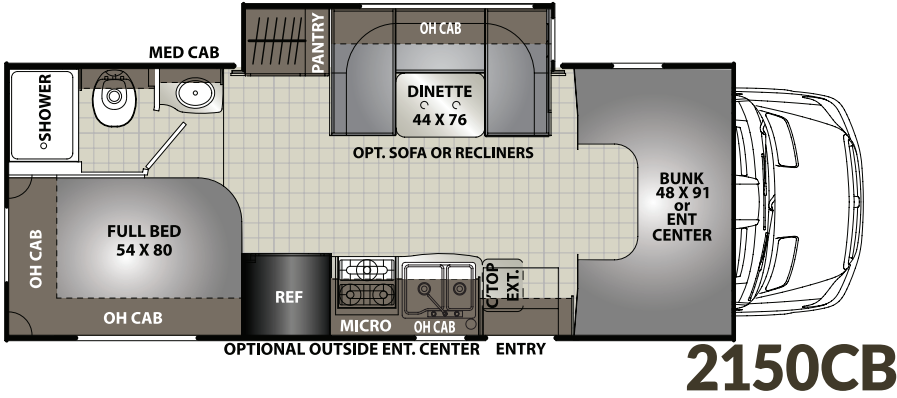

Optional Sofa



Optional Recliner

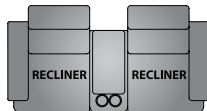

Standard Driver/Passenger Swivel Seats



Coachmen Owner "Digital Kit" App  
 Now you can have your Owner's Manual with you wherever you are. Download our FREE App from the App Store or Google Play and you'll have the information right at your fingertips.

# PRISM SPECIFICATIONS

	2150CB	2200FS	2300DS
CHASSIS	3500 SPRINTER	3500 SPRINTER	3500 SPRINTER
ENGINE	V6 3.0L	V6 3.0L	V6 3.0L
HORSE POWER	188	188	188
TORQUE	325	325	325
WHEEL BASE	170"	170"	170"
GVWR (LBS.)	11,030	11,030	11,030
GCWR (LBS.)	15,250	15,250	15,250
UVW (APPROX. LBS.)	9,517	9,756	9,650
CCC (APPROX. LBS.)	1,513	1,274	1,380
GAWR FRONT (LBS.)	4,410	4,410	4,410
GAWR REAR (LBS.)	7,720	7,720	7,720
INTERIOR HEIGHT	6' 10"	6' 10"	6' 10"
EXTERIOR WIDTH	7' 11"	7' 11"	7' 11"
EXTERIOR HEIGHT (WITH A/C)	11' 4"	11' 4"	11' 4"
EXTERIOR LENGTH (WITH HITCH)	25' 1"	25' 1"	25' 1"
HITCH WEIGHT (LBS.)	5,000	5,000	5,000
FUEL CAPACITY (GAL.)	26	26	26
LP CAPACITY (LBS.)	85	85	85
FRESH WATER CAPACITY (GAL.)	50	38	38
WATER HEATER CAPACITY (GAL.)	6	6	6
GREY TANK CAPACITY (GAL.)	28	28	32
BLACK TANK CAPACITY (GAL.)	28	28	28
EXTERIOR STORAGE (CU. FT.)	88	52	55
AWNING LENGTH	16'	16'	16'

GVWR (Gross Vehicle Weight Rating) is the maximum permissible weight of the unit when fully loaded. It includes all weights, inclusive of all fluids, occupants, cargo, optional equipment and accessories. For safety and product performance do NOT exceed the GVWR.

GCWR (Gross Combined Weight Rating) is the maximum permissible loaded weight of your motor home and any towed trailer or towed vehicle. Actual GCWR of this vehicle may be limited by the sum of the GVWR and the installed hitch receiver maximum capacity rating; see hitch rating label for detail.

GAWR (Gross Axle Weight Rating) is the maximum permissible weight, including cargo, fluids, optional equipment and accessories that can be safely supported by each axle.

UVW (Unloaded Vehicle Weight) \* is the typical weight of the unit as manufactured at the factory. It includes all weight at the unit's axle(s), including full fuel, all fluids and LP Gas. The UVW does not include cargo, fresh potable water, additional optional equipment or dealer installed accessories.

\*Estimated Average based on standard build optional equipment.

CCC (Cargo Carrying Capacity) \*\* is the amount of weight available for fresh potable water, cargo, passengers, additional optional equipment and accessories. CCC is equal to GVWR minus UVW. Available CCC should accommodate fresh potable water (8.3 lbs per gallon). Before filling the fresh water tank, empty the black and gray tanks to provide for more cargo capacity.

\*\* Estimated average based on standard build optional equipment

Each Coachmen motorhome is weighed at the manufacturing facility prior to shipping. A label identifying the unloaded vehicle weight of the actual unit and the cargo carrying capacity is applied to every Coachmen motorhome prior to leaving our facilities.

The load capacity of your unit is designated by weight, not by volume, so you cannot necessarily use all available space when loading your unit.

Actual towing capacity is dependent upon your particular loading and towing circumstances, which includes the GVWR, GAWR and GCWR as well as adequate trailer brakes. Please refer to the Operator's Manual of your vehicle for further towing information.

All information contained in this brochure is believed to be accurate at the time of publication. However, during the model year, it may be necessary to make revisions and Coachmen reserves the right to make all such changes without notice, including prices, colors, materials, equipment and specifications as well as the addition of new models and the discontinuance of models shown in this brochure. Therefore, please consult with your Coachmen dealer and confirm the existence of any materials, design or specifications that are material to your purchase decision. 2/19

©Copyright 2019 Coachmen RV a Division of Forest River Inc. - All Rights Reserved.

## YOUR PRISM DEALER

### CUSTOMER SATISFACTION



**FREE MEMBERSHIP**  
www.coachmenowners.com

www.ForestRiverBuyLocal.com

### 24/7 EMERGENCY ROADSIDE ASSISTANCE WITH VEHICLE PURCHASE\*

TOWING	WINCH-OUT
JUMP-STARTS	MOBILE MECHANIC
TIRE CHANGES	TECHNICAL
FLUID DELIVERY	SUPPORT
LOCKOUT	DEALER LOCATOR
SERVICE	SERVICES



\*VALID FOR 1 YEAR FROM DATE OF PURCHASE



**Learn More**  
Scan this barcode using a QR Reader on your smart phone to learn more about Forest River.



A Berkshire Hathaway company.



Coachmen RV, a Division of Forest River, Inc.,  
A Berkshire Hathaway Company

423 N. Main St., P.O. Box 30, Middlebury, IN 46540

To learn more about Coachmen RV and our products and see how Coachmen is making the easy life easier, visit [www.coachmenrv.com](http://www.coachmenrv.com)