

# **INNSBRUCK** Lite



***The Great Outdoors is calling . . . Let your adventure begin!***

# Combine your love of the outdoors with our legacy of quality and value in an Ultra-Lite travel trailer from Innsbruck Lite

**A.** Our main living areas promise comfort, convenience, and style, wherever you go.

**B.** Entertainment center with optional HDTV, Blue Tooth multi-function Sound Bar, and electric fireplace.

**C.** Master bedroom is a peaceful refuge, with closets, nightstands, reading lights, under-bed storage, and hookups for HDTV.

**D.** Huge picture windows and open living areas bring families together to enjoy the great outdoors.





**E**



**F**



**G**

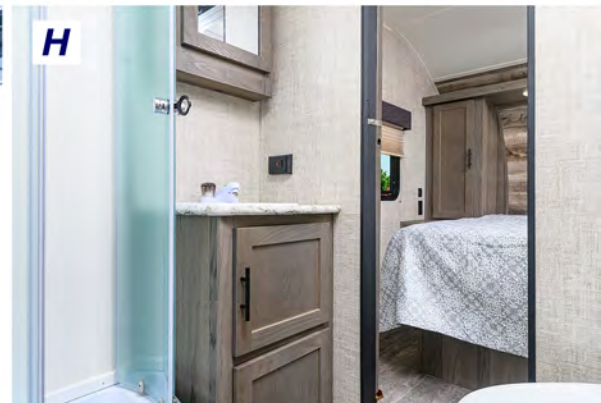

**H**

**E.** Sunlit sofa in main living area is a popular spot to relax. Tri-fold Sofa Bed also available.

**F.** Family-style U-shaped dinette with under-seat storage, picture window views, privacy pleated shades, and handy power outlets.

**G.** From casual snacks to dinner parties, our kitchens offer everything you need to feed family and friends.

**H.** Roomy baths include wood medicine cabinets with mirrors, GFI outlets, skylights, powered vents, and hand-held shower wands.



See 360Tours at [www.gulfstreamcoach.com](http://www.gulfstreamcoach.com)

# Ultra-Lite Floor Plans

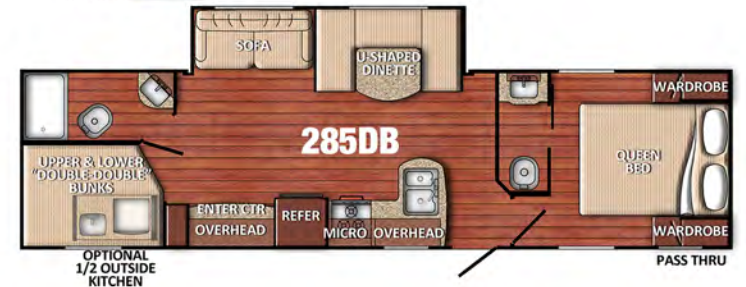
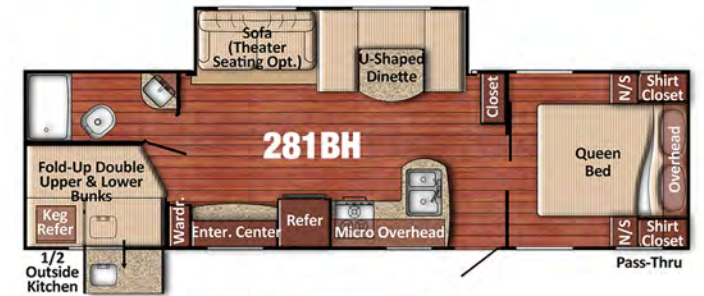
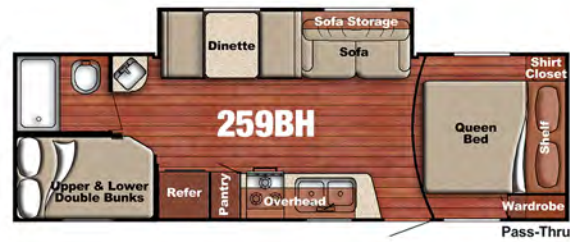
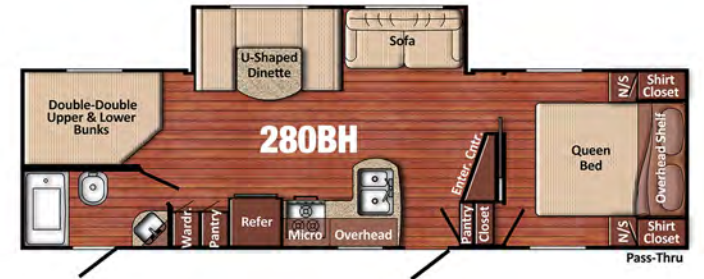
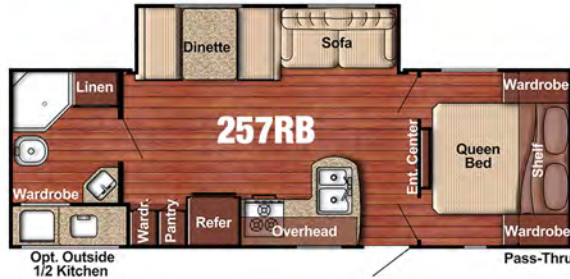
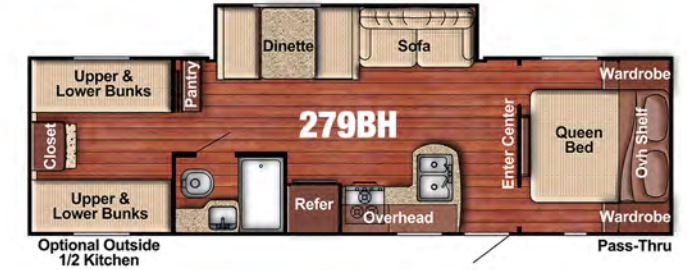
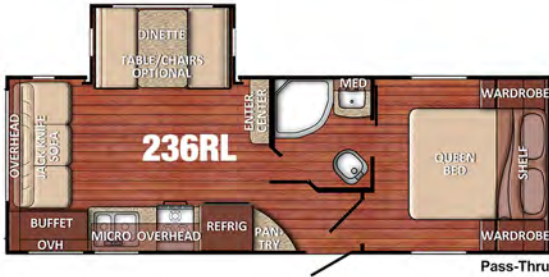
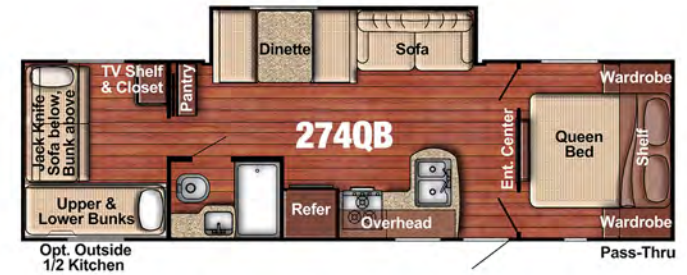

# Specifications

Specifications approximate and subject to change. For actual weights, check weight sticker in each unit. Fresh water capacity includes fresh water tank & hot water heater.

	Length	Width	Ext. Height	Int. Height	Base Weight	Hitch Weight	Nt Carry Capacity	Fresh Water	Grey Tank	Black Tank	Furnace BTU	Water Heater	LP lbs.
<b>Ultra-Lite Trailers</b>													
218MB	22'7"	96"	9'10"	80"	3,685	400	3,715	36	36	36	16,000	6 Gal	2 x 20
236RL	28'1"	96"	11'3"	80"	5,100	890	2,790	36	36	36	16,000	6 Gal	2 x 20
238RK	27'11"	96"	11'1"	80"	4,815	640	2,865	36	36	36	16,000	6 Gal	2 x 20
241RB	26'5"	96"	9'10"	80"	4,031	478	1,828	36	36	36	16,000	6 Gal	2 x 20
248BH	26'11"	96"	9'10"	80"	3,899	500	3,601	36	36	36	16,000	6 Gal	2 x 20
250RL	30'11"	96"	11'1"	80"	5,664	790	2,126	51	36	36	16,000	6 Gal	2 x 20
255BH	29'1"	90"	11'1"	80"	4,880	620	2,879	51	36	36	16,000	6 Gal	2 x 20
257RB	28'1"	96"	11'1"	80"	5,512	740	2,228	36	36	36	16,000	6 Gal	2 x 20
259BH	29'1"	90"	11'1"	80"	4,900	550	2,650	51	36	36	16,000	6 Gal	2 x 20
268BH	29'6"	96"	11'1"	80"	5,177	660	2,483	36	36	36	16,000	6 Gal	2 x 20
274QB	32'3"	96"	11'1"	80"	5,802	720	1,918	36	36	36	16,000	6 Gal	2 x 20
279BH	32'3"	96"	11'1"	80"	5,273	730	2,457	36	36	36	16,000	6 Gal	2 x 20
280BH	33'0"	96"	11'3"	80"	5,440	850	2,710	36	36	36	16,000	6 Gal	2 x 20
281BH	33'0"	96"	11'1"	80"	6,230	820	2,410	36	72	38	16,000	6 Gal	2 x 20
285DB	35'0"	96"	11'3"	80"	6,660	1,060	1,300	36	72	74	16,000	6 Gal	2 x 20
<b>Super Lite Trailers</b>													
16RE	15'10"	90"	11'3"	80"	2,820	220	1,030	36	36	17	16,000	6 Gal	2 x 20
16BHC	18'10"	84"	10'1"	80"	2,590	330	460	36	36	36	16,000	6 Gal	2 x 20
188RB	20'11"	96"	9'11"	80"	3,010	344	1,019	36	36	36	16,000	6 Gal	2 x 20
189DD	20'11"	96"	9'10"	80"	2,996	350	854	36	36	36	16,000	6 Gal	2 x 20
197BH	22'11"	96"	11'3"	80"	3,663	638	1,395	36	36	36	16,000	6 Gal	2 x 20
198BH	20'11"	96"	9'11"	80"	2,790	350	900	36	36	36	16,000	6 Gal	2 x 20
199DD	20'11"	96"	10'0"	80"	3,160	360	1,158	36	36	36	16,000	6 Gal	2 x 20
199RK	20'11"	96"	10'0"	80"	3,452	470	1,238	36	36	36	16,000	6 Gal	2 x 20
19DS	21'1"	84"	10'2"	80"	3,100	460	760	36	36	36	16,000	6 Gal	2 x 20
19RD	23'2"	96"	11'3"	80"	3,552	370	1,418	36	36	36	16,000	6 Gal	2 x 20

# Super Lite Standard Features & Packages

As our most affordable series, Super Lites feature their own list of features, specifications, and floor plans, ideal for tight family budgets, first-timers, and casual campers. See pictures on Page 7 and explore 360Tours at [www.gulfstreamcoach.com](http://www.gulfstreamcoach.com).

## Standard Features

- High-Performance Vinyl Flooring throughout
- Fabric-Wrapped Box Valances
- Craft-made Cabinetry w/Designer Pulls
- Laminated Countertops w/Vinyl T-Molding
- White Kitchen Sink
- 30 Amp Svc w/45 Amp Converter/Charger
- Wall-Mount Fire Extinguisher
- Combo CO/LP Detector
- Smoke Detector
- Monitor Panel
- Pleated Shades
- Seamless Synthetic Vinyl Roof
- Diamond Plate Lower Front
- Radius Safety Glass Windows
- Safety Chains
- Single Entry Step

## Camping Pkg. (included, required)

- 2-Burner Gas Cooktop
- Microwave Oven
- 6-Gal Gas DSI Water Heater
- 13,500 BTU Roof Air Conditioner
- Electric Refrigerator
- 20 lb. LP Gas Tank
- Shower & Toilet
- (2) Rear Stabilizer Jacks
- Power Awning
- Teddy Bear Mattress (Bunk models)
- Wood Ceiling Trim
- 6'8" Interior Height
- High-Rise Kitchen Faucet
- Friction Hinge Entry Door
- Central Control Panel
- Radial Tires
- LED Interior Lights
- 16,000 BTU Furnace
- Multiple USB Ports

## Convenience Package (required 16RE, 189DD, 197BH, 199RK, 19DS, 19RD)

- 6 cu. ft. Double Door Refrigerator
- TV Antenna
- Swing-Away Grab Handle
- Pots & Pans Drawer (189DD, 199RK, 19RD)

## Rocky Mountain Edition (188RB, 198BH only)

- Overslung Axle
- Knobby Tires
- Fender Covers, Wheel Wells
- Double Entry Step
- Aluminum Wheels
- Bottom Diamond Plate Metal

## Super Lite Options

- Blue Tooth Radio w/(2) Interior & (2) Exterior Speakers, Solar Prep, Backup Camera Prep
- Bedspread
- 6 Gal Gas/Elec 110V DSI Water Heater
- Spare Tire
- Grey Fiberglass Walls
- Double SolidStep® Entry Step
- 3 cu. ft. Gas/Electric Refrigerator (16BHC, 188RB, 198BH)

## Super Lite Floor Plans

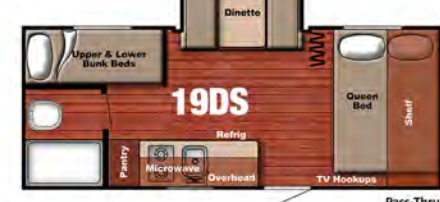

# CONSTRUCTION

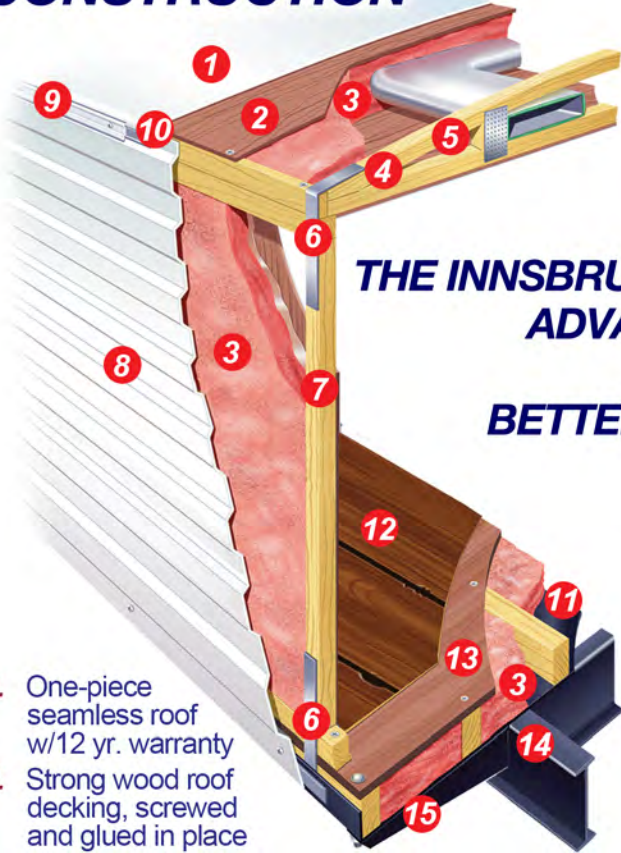

**THE INNSBRUCK LITE  
ADVANTAGE:  
SIMPLY  
BETTER BUILT!**

1. One-piece seamless roof w/12 yr. warranty
2. Strong wood roof decking, screwed and glued in place
3. Thick energy-saving blankets of hand-cut fiberglass insulation in ceiling, walls & floors; insulation bonded to walls to prevent settling
4. Engineered wood rafters (Solid rafters in 218MB, 248BH)
5. "Attic" space for fiberglass insulation and air conditioning ducts (ducts n/a in 218MB, 248BH)
6. Galvanized steel straps to increase roof-to-sidewall & sidewall-to-floor strength
7. Sturdy wood wall studs 16" on center, set on floor & screwed in for maximum strength
8. Aluminum siding w/baked enamel finish
9. Butyl caulk for better seal, fewer streaks
10. Drip rail to direct rain runoff away from unit
11. Tough polymax underbelly overlaps sides & ends to protect against moisture & debris
12. Durable heavy-gauge vinyl floor covering
13. 5/8" floor decking screwed & glued to floor joists, 13" on center
14. I-beam steel frame (Tubular steel on Super Lite floor plans)
15. Full-width steel outriggers for superior strength and support



*The electric fireplace/heater option takes the chill off cool mornings; adds a peaceful evening glow; available on several floor plans*



*This stainless steel gas oven option opens up a world of delicious possibilities*

## LOOK FOR THESE KEY FEATURES & OPTIONS



*Craft-made cabinets provide stylish storage in all the right places*



*Multiple 110 volt and USB power outlets are found in the handiest places*



*Our Light Value Package automatically upgrades your Ultra-Lite with molded counters and a double under-mount kitchen sink*

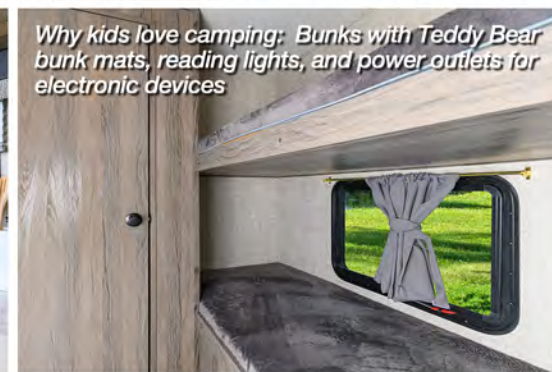

*Why kids love camping: Bunks with Teddy Bear bunk mats, reading lights, and power outlets for electronic devices*



*Outdoor kitchens make it easy to serve meals, snacks, and beverages outside.*



*Our SolidStep option gives you a firm, stable, rock-solid footing; folds easily out of the way.*

# Super Lite travel trailers: The perfect way to inspire a lifetime of unforgettable memories



**A**

**A.** Super-light weight, nimble, and easily towed by smaller vehicles, our Super Lite travel trailers are ideal for quick getaways; efficient for extended adventures.

**B.** Our well-planned kitchens make it easy to create everything from quick snacks to gourmet meals

**C.** Your Super Lite gives you the ideal spot to enjoy the beauty of nature and the company of family and friends.

**D.** Refined by decades of experience and benefitting from the latest technology, our Super Lite floor plans set a standard other small trailers simply can't reach.



**B**



**C**



**D**

## Ultra-Lite Standard Features and Lite Value Package

### Interior

- White Vinyl-Clad Ceiling Panels
- Easy-Care Vinyl Wallcovering
- Craft-made Cabinetry w/Designer Drawer & Door Pulls
- Hardwood Cabinet Doors with Mortise & Tenon Joints
- High-Performance Vinyl Flooring throughout
- Fabric-Wrapped Box Valances

### Heating & Cooling

- 16,000 BTU Gas Furnace
- Ducting for Value Package Air Conditioning (N/A 218MB)

### Safety

- Wall-Mount Fire Extinguisher
- Combined CO/LP Detector
- Smoke Detector
- Safety Chains

### Electrical

- 30 Amp Service w/45 Amp Converter & Charger
- Cable-Ready Connection
- Central Control Panel

### Furnishings

- Booth-Style Dinette
- Queen Bed & Bedspread
- Mini-Blinds in Kitchen Window
- Privacy Drape(s)
- Electric Slide-Out for Sofa/Dinette (250RL, 255BH, 257BH, 259BH, 268BH, 274QB, 279BH, 280BH, 2281BH)
- Sofa Slide-Out (238RK)
- Dinette Slide-Out (236RL)
- (2) Barrel Chairs (250RL)

### Appliances

- Power Range Hood w/Light
- 6 cu. ft. 2-Door Dometic Refrigerator/Freezer
- 3-Burner Gas Range

### Bath

- Foot-Flush Toilet
- Power Bath Vent
- Neo-Angle Shower w/Glass Shower Door (218MB, 236RL, 238RK, 241RB, 250RL, 257RB)
- Skylight over Tub
- Shower Curtain

### Exterior

- Pass-Thru Storage (most models)
- Diamond Plate lower front
- One-Piece Synthetic Vinyl Roof
- Radius Safety Glass Windows
- (4) 14" Tires/Rims
- 2 x 20 lb. LP Bottle & Cover

### Lite Value Pkg. (incl, required)

- Radiant LED Interior Lighting Package
- Electric Awning
- LED Awning Light (N/A 218MB, 241RB, 248BH)
- 10.7 cu. ft. Everchill Refrigerator/Freezer (N/A 218MB, 241RB, 248BH)
- Molded Countertops w/Undermount Sink (N/A 218MB, 241RB, 248BH)
- 6 Gal DSI Water Heater
- Front Power Hitch Jack
- Blue Tooth Radio w/(2) Internal & (2) External Speakers
- Pleated Privacy Shades
- Microwave Oven
- Digital TV Antenna w/Power Booster
- (4) Stabilizer Jacks
- Radial Tires
- 13,500 BTU Air Conditioner
- Pull-Out Kitchen Sprayer Faucet
- Swing-Away Grab Handle
- Frosted Glass Window in Entry Door
- Designer Backsplash in Kitchen
- Bath Skylight

### Lite Value Pkg. (continued)

- Tech-Ready Upgrades
  - Wi-Fi ready connections
  - Solar Panel Prep
  - Back-Up Camera Hookups
  - Satellite TV Ready
  - Multiple USB ports
- Friction Hinge Entry Door
- Tinted Windows
- Upgraded Exterior Graphics
- Sofa Bolsters
- Teddy Bear Bunk Mats (Bunk floor plans)
- Frosted Glass Kitchen Cabinet Doors
- Upgraded Furniture Package

### Ultra-Lite Options

- Spare Tire & Wheel
- 3-Burner Range w/Oven and Glass Top
- Battery Disconnect Switch
- Sink Cover (N/A 218MB, 241RB, 248BH)
- SolidStep® Entry Step
- 6 Gal Gas/Electric 110V DSI Water Heater
- 15,000 BTU Air Conditioner
- Blue Tooth Soundbar in place of Radio (N/A 218MB, 241RB, 248BH)
- 1/2 Outside Kitchen (257RB, 274QB, 281BH, 285DB)
- Full Outside Kitchen (279BH)
- Murphy Bed (218MB, 248BH)
- Theater Seating in place of Jack Knife Sofa (236RL, 238RK, 281BH, 285DB)
- Aluminum Wheels
- Outside Hot & Cold Shower
- Tub Surround
- Fiberglass Exterior Walls w/Fender Skirt
- Shower Pan in place of Tub
- Second Swing-Away Grab Handle

## INNSBRUCK Lite

**Relax - You're Covered!**  
**With Our Exclusive Three-Year**  
**Limited Structural Warranty**



In addition to a standard one-year warranty against defects in materials and/or workmanship in construction and original components under normal use, our exclusive Gulf Stream Coach Warranty gives you THREE YEARS of coverage on key structural components (side-walls, front and rear walls, roof, and floor) of your new Innsbruck Lite Ultra-Lite travel trailer. (One year warranty on Super Lite products)

In addition, extended protection is offered by many manufacturers that supply components for Innsbruck Lite units, including the refrigerator, antenna, furnace, water heater, air conditioner, awning, range, microwave, and more. See complete warranty statement for details.



QUALITY • VALUE • INNOVATION

Family owned since 1983 • [www.gulfstreamcoach.com](http://www.gulfstreamcoach.com) • Nappanee, IN



See 360Tours at [www.gulfstreamcoach.com](http://www.gulfstreamcoach.com)

Specifications, materials, and features are subject to change without notice. Some optional equipment shown. Not responsible for typographical errors. Contact your dealer or visit [www.gulfstreamcoach.com](http://www.gulfstreamcoach.com) for more information ©2019 Gulf Stream Coach, Inc., Nappanee IN USA. #INNLIT2019.

Your Gulf Stream Coach Dealer: