

luxury
fifth wheel
toy haulers

VENOM

KZ

Est. 1972

VENOM V-SERIES & VENOM

luxury fifth wheel toy haulers



ALL-NEW & AFFORDABLE

VENOM V-SERIES is an affordable 101-inch wide-body. Several versatile, spacious floorplans include cargo areas from 11 to 21 feet in length, and also offer a variety of living, kitchen and sleeping spaces.

Standards include:

- auto-leveling
- generator prep
- king beds
- residential kitchen

Options available:

- central vac
- 3rd 15,000 BTU A/C
- Party Patio Package



V3411TK : Slate décor

ENTERTAINMENT CENTER

- LED TV
- 40" wideview fireplace
- stainless steel kitchen sink
- glass accent cabinets

DÉCOR OPTIONS

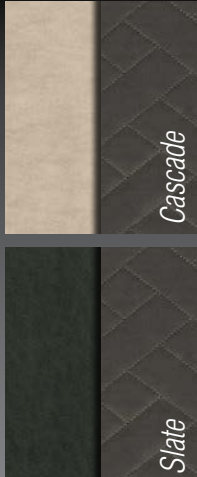

Cascade

Slate



Heavy-Duty 100 LB
DRAWER GLIDES



STORAGE
Spacious, deep-shelved pantries on some models



STD 12 CU FT GAS/ELECTRIC
refrigerator with (4) doors and temperature controls (F/P specific)



THEATER SEATING
with heat, massage, and LED lighted cupholders (on select models)





Maple-glazed, burnished-door cabinetry

Glass-front accents add elegant flair

COMPLETE KITCHEN

- drop-in gas range
- built-in oven
- 30-inch stainless steel convection microwave
- skylight



↑ GENEROUS REFRIGERATOR
standard 8 or 12 CU FT, with optional 18 CU FT residential model (on most floorplans) (V3517DK shown)

↓ SOLID SURFACE COUNTERTOPS
and deep-seated, under-mount stainless steel sink with pull-down sprayer faucet.



↑ LED-LIT KNOBS
control drop-in gas range (with glass cover) and built-in oven

BEDROOMS feature residential-grade carpeting, standard 72 x 80-inch king bed with **↓** padded headboard and designer bedspread, multiple USB ports and outlets, CPAP-accommodating bedside cabinets and massive under-bed storage. (V3517DK shown)



V3517DK : Slate décor

CONSTRUCTION FEATURES

- 101" Wide-Body Construction
- Extra-Reinforced, Heavy Duty, High-Gloss Front Cap
- Radius Aerodynamic Front Cap (provides better turning radius & increased fuel economy)
- 2" x 3" Fully Welded Aluminum Floor Joists
- 2" x 2" Fully Welded Aluminum Sidewall Framing
- Lamilux® Gelcoat Fiberglass
- Double-Insulated & Heated Holding Tanks (R-38 above & below tanks)
- R-11 2" Sidewalls (w/EGS metal backing strips to hold up all interior cabinets)
- Roof Membrane w/12-Year Limited Warranty
- Fully Vented Attic System
- 3/8" Roof Decking (fully walkable)
- 5/8" Tongue & Groove, Screwed & Glued Plywood Floor Deck
- Pex® In-Floor Heated Waterlines & Kitchen Gray Pipes (all waterlines & drains are located above all insulation)
- Fully-Enclosed & Heated Underbelly w/ Directly Heated Holding Tanks

EXTERIOR FEATURES

- 7,000# Dexter® Axles w/Auto-Adjusting Brakes
- 8-Lug Heavy-Duty Aluminum Rims w/16" G-Range Nitro-Filled Radial Tires
- 100% Exterior LED Running Lights, Taillights & Backup Lights
- Electric Power Awning w/LED Lights
- Propane Bottles (2 x 30 LBS.) on Same Side of Coach for Easy Access
- Side Slam Latch Baggage Doors (where applicable) w/Magnet Catches for Full Access to Storage
- 3" x 14" In-Floor Straight Line Heating System w/35,000 BTU Furnace
- 12 GAL Gas/Electric Hot Water Heater
- Ramp Door LED Lighting
- LED Docking Light & Sewer Hookup Light
- Dual Swing-Away Assist Grab Handle
- Underneath Spare Tire w/Hoist
- Roof Ladder

- Heated Water Convenience Center (includes black tank flush, power fresh tank water fill, winterizing system, outside shower)
- Fully-Finished, Heated & Sealed Basement Storage Compartment (only available w/All-Weather Insulation PKG)
- Heated & Enclosed Dump Valves
- Satellite Pre-Wire in Both the Convenience Center & Roof
- LED Lighted Outside Speakers
- LP Quick Connect

LIVING ROOM/KITCHEN FEATURES

- Built-In Silverware Drawer
- Storage Shelf under Kitchen Sink
- All Kitchen OH Cabinets have Shelf & Extra-Tall Slide Lips
- Heavy-Duty 100# Drawer Glides on Every Drawer
- Baltic Birch Drawer Boxes
- Decorative Lighting above Many Cabinets
- Window in Kitchen (in most models)
- 5" Stainless Steel Cabinet Hardware
- Window Roller Shades Throughout
- 3/8" Re-Bond Carpet Pad w/22 OZ Residential Carpet
- Stainless Steel Appliances
- Extra-Large Light Switches
- Ceiling Crown Molding
- 100% LED Ceiling & Cabinet Lights w/ Multiple On/Off Switches
- Deluxe Residential-Style Furniture
- Living Room HD Flat Panel TV on Bracket (includes exterior mount)

GARAGE/RAMP AREA FEATURES

- Multiple D-Rings to Tie Down Cargo
- Built-In Dovetail
- Garage Entry Door (model specific)
- (2) Garage Ceiling Speakers

BATHROOM/BEDROOM FEATURES

- Skylight Over Shower
- Porcelain Foot-Flush Toilet
- Extra-Wide Hall (going up into bedroom & pocket door from hall into the bathroom – most models)

- Towel Bar in Bathroom (where applicable)
- 12V Fan in Bathroom
- Extra-Large Under-Bed Storage
- Luxurious Bedspread
- Padded Headboard w/Hidden Storage

OPTIONS (EXTERIOR)

- 3rd 15K BTU Ducted A/C w/Load Management System
- Dual Pane Windows (frameless)
- Wireless Backup Camera System - Observation
- "Off the Grid" Solar Package*
- Roto Flex Rubberized Pin Box
- 2nd LED Lighted Power Awning
- Slideout Cover Package (double slides)
- Slideout Cover Package (triple slides)
- Party Patio Package (railing only)
- Three Season Patio Door IPO Screen Wall
- 5.5KW Gas Onan Generator

OPTIONS (INTERIOR)

- 32" Bedroom LED TV
- Theater Seating w/Heat & Massage Features & 2-Person Table & Chairs IPO Super Sofa (3411, 3413, 3815, 3916)
- Residential Refrigerator w/1200W Inverter (18 CU FT) IPO 12 CU FT Gas/Electric Refrigerator (N/A CSA option) (N/A 3214, 3517)
- Power Vent Fan in Bathroom
- Power Vent Fan in Garage (N/A 3rd A/C option)
- Queen Black Label Pillowtop Mattress 60" x 80"
- Central Vac System
- Happi-Jac Power Bed w/Roll Over Sofas & Table

**Cannot get Residential Refrigerator w/"Off the Grid" Solar Package*

KZ ADVANTAGE PACKAGE (MANDATORY OPTION)**EXTERIOR**

- 6-Point Auto Electric Leveling
- Polar White Gelcoat Exterior Fiberglass
- Partial Painted Fiberglass Front Cap

- 6-Sided Aluminum Framing
- Flip-Up Entry Steps (main entry)
- 50 AMP Service
- (2) 15K Ducted A/Cs
- 5/8" T&G Plywood Floor
- Key-Alike for Baggage & Entry Doors
- Friction Hinge Entry Door
- Screenshot Feature on Entry Door
- Large Folding Grab Handle
- Undermount Spare Tire
- Equa-Flex® Suspension
- Nitrogen-Filled Tires
- Exterior Speakers
- Battery Disconnect
- Black Tank Flush
- Backup Camera Prep
- Roof Mounted Solar Prep
- All Weather Insulation Package (heated, insulated & enclosed underbelly plus foil in floor, roof, front, rear)
- Roof Ladder
- Fully Vented Attic System w/2 Attic Vents
- Toy Lok®
- Generator Prep w/30 Gal. Fuel Tank & Pump Station
- Retractable Screen Wall

INTERIOR

- Maple Glazed Cabinetry
- Glazed Solid Hardwood Slideout Fascia
- Solid Surface Countertops w/Deep Undermount Stainless Steel Kitchen Sink w/Sink Cover
- Drop-In Cooktop w/Glass Cover & Oven
- 30" Convection Microwave
- Kitchen Skylight w/Shade
- Power Vent Fan in Main Area
- Super Sofa (select models)
- 3 Motion Sensor Lights (entry, closet, basement)
- 40" Wideview Fireplace
- LED TV
- Multiple Media Stereo w/DVD/Bluetooth/NFC Wireless Connectivity
- 12V Dual USB Charging Station
- Night Roller Shades

- Porcelain Foot-Flush Toilet
- Stainless Steel Oval Bathroom Sink
- Plywood Bed Base
- Upgraded King Black Label Pillowtop Mattress 72" x 80"
- 12 Gal. Gas/Electric Water Heater

KZ CONVENIENCE PACKAGE (MANDATORY OPTION)**EXTERIOR**

- Power Awning w/LED Light Strip
- 16" Tires w/Aluminum Wheels
- Magnetic Catches for Baggage Doors
- Directional HDTV Antenna
- LED Lights in Exterior Speakers

INTERIOR

- Residential Grade Linoleum
- 12 CU FT Gas/Electric Refrigerator w/ Temperature Controls (8 CU FT gas/electric refrigerator in 3214, 3517 only)
- Stainless Steel Residential Kitchen Faucet w/Pulldown Sprayer
- Surfex Wood Step in FW Hallway
- Dark Accent Trim on Corners/Entry Doors
- (2) Bar Stools (island models)

BONUS FEATURES

- 2-year Limited Warranty (see flyer)
- One of the lightest weight high-profile, wide-body, luxury Toy Hauler fifth wheels in the industry
- KZ RV has won the coveted DSI award 18 years.
- KZ RV's 47 years of building experience, coupled with its stable and dedicated Amish workforce and commitment to superb quality, and low overhead, allows us to produce the lowest-priced fully-featured fifth wheel available.

VENOM V-SERIES Fifth Wheels	V3214DK	V3411TK	V3413TK	V3517DK	V3815TK	V3916TK
UVW (Unloaded Vehicle Weight)*	10,470	12,200	12,310	10,780	13,360	13,340
Dry Hitch Weight*	2,780	2,450	2,580	2,640	2,290	2,730
Dry Axle Weight*	7,690	9,750	9,730	8,140	11,070	10,610
NCC (Net Carrying Capacity)	4,525	2,795	2,685	4,215	4,640	4,660
GVWR	14,995	14,995	14,995	14,995	18,000	18,000
Interior Height	102"	102"	102"	102"	102"	102"
Exterior Height w/ A/C	13' 4"	13' 4"	13' 4"	13' 4"	13' 4"	13' 4"
Exterior Width	101"	101"	101"	101"	101"	101"
Exterior Length**	34' 11"	38' 9"	40' 8"	37' 11"	42' 9"	43' 8"
Refrigerator (cu. feet)	8	12	12	8	12	12
Water Heater Cap. (gal. G/E w/DSI)	12	12	12	12	12	12
Fresh Water Cap. (gal.) [Including Water Heater Capacity]	116	116	116	116	116	116
Waste Water Cap. (gal.)	53	53	53	53	53	53
Gray Water Cap. (gal.)	53	53	53	53	53	53
1/2 Bath Cap. (gal.)	N/A	40	N/A	N/A	40	N/A
LP Gas Cap. (lbs.)	60	60	60	60	60	60
Furnace BTUs (1,000s)	35	35	35	35	35	35
Tire Size	16"	16"	16"	16"	16"	16"
Awning	16'	14'	14'	16'	14'	14'
Optional 2nd Awning	15'	10'	12'	18'	14'	15'

*This weight reflects the rolling average unit weight for each model. Your trailer weight will vary according to optional equipment.

**Exterior length is measured from center of hitch pin to rear wall.



SOLAR POWER

Harness the power of the sun to run your TV and outlets. Roof mounted solar prep standard.

Optional "Off the Grid" solar package includes 170W panel, 1200W inverter and interior control center.



Two attic vents in each RV, providing vital escape routes for unwanted moisture that accumulates during use.



Heated, insulated & enclosed underbelly plus foil in floor, roof, front, rear!
R-11 sidewalls, R-38 roof, floor, and end walls.

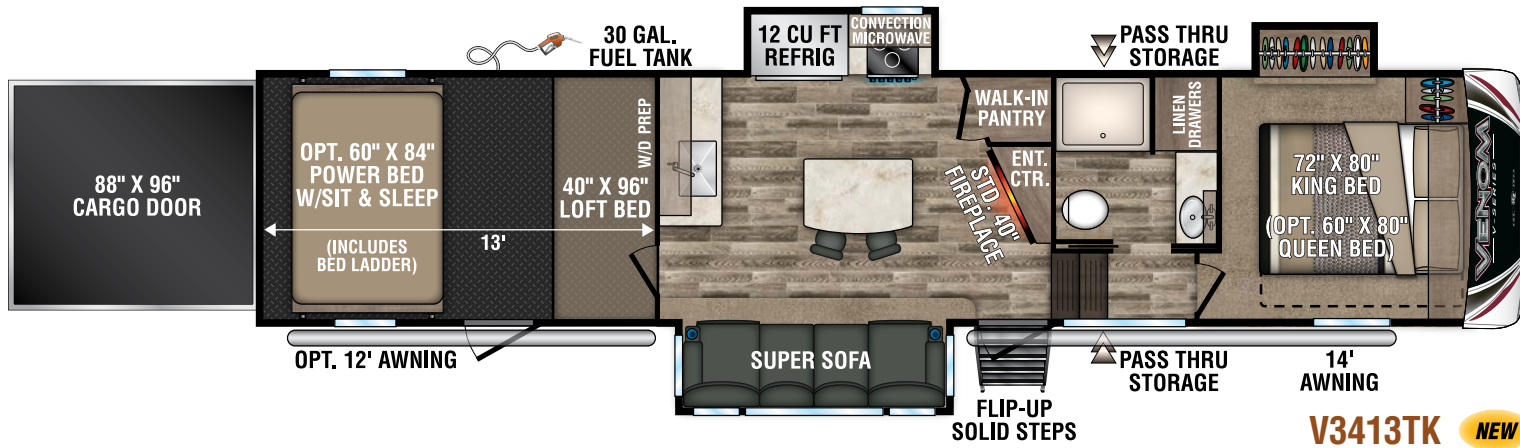
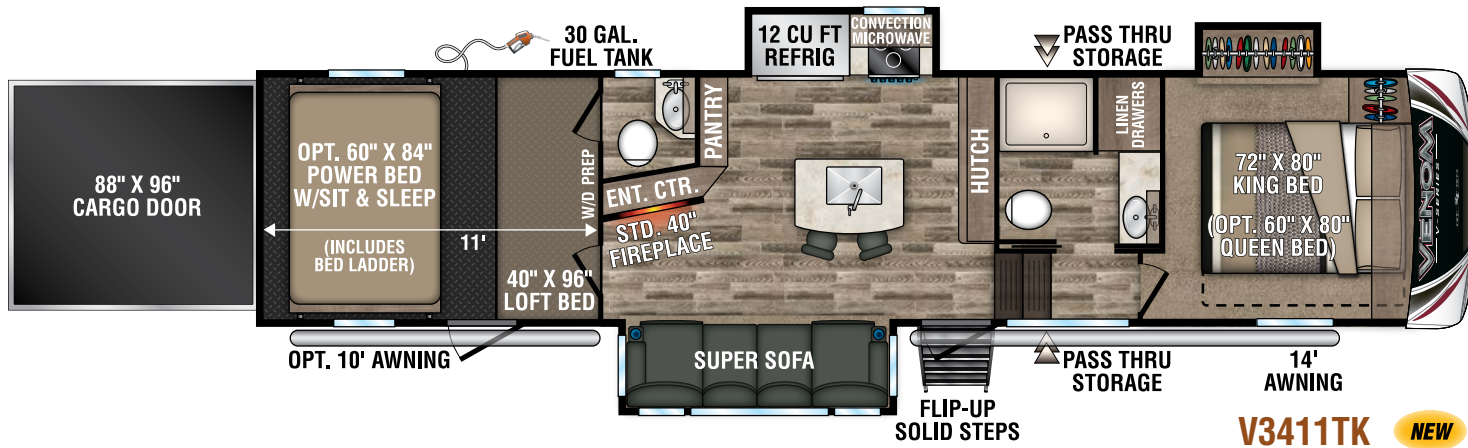
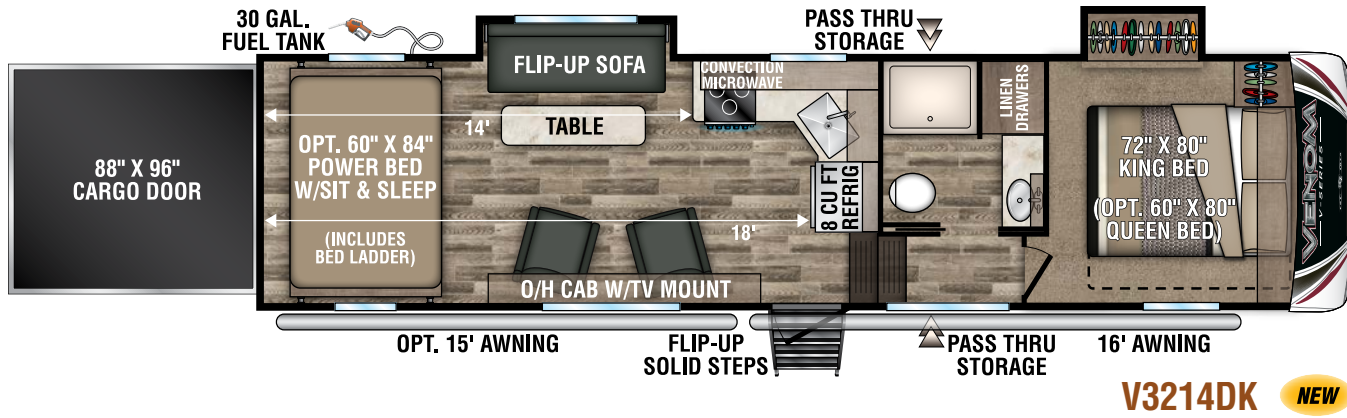

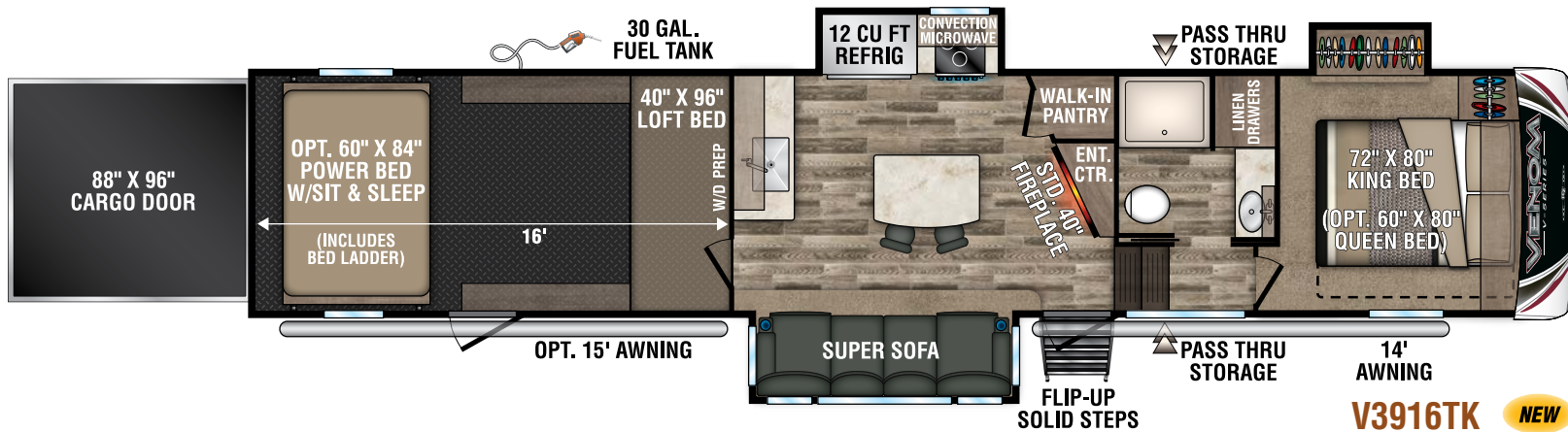
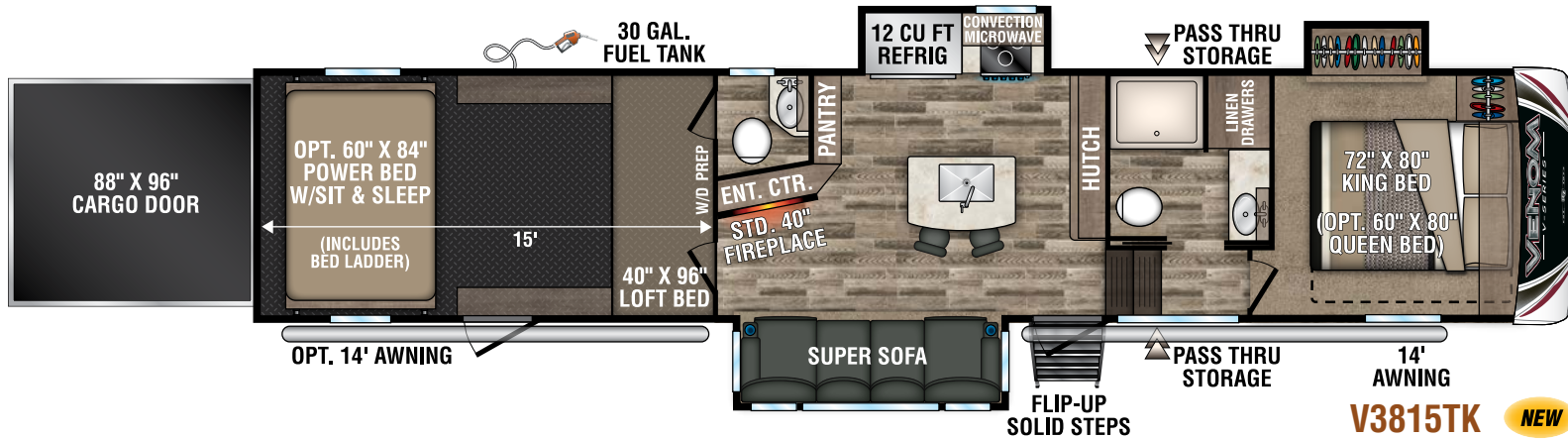
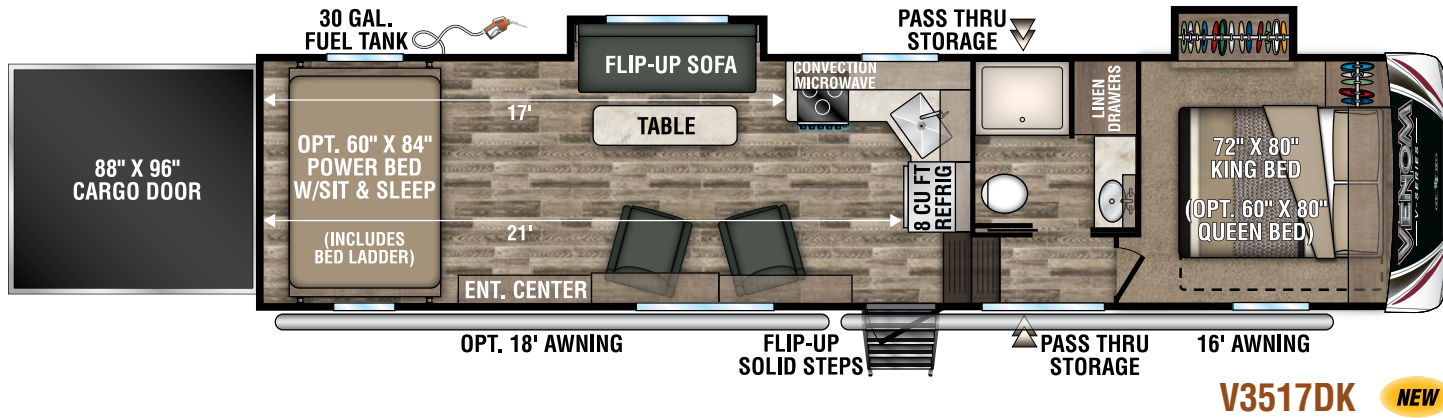

UPSCALE standards & LUXURIOUS options

VENOM's 101-inch wide-body toy hauler comes with standards like all-weather insulation, chef's kitchen, glazed maple cabinetry, a 40-inch fireplace and central vacuum system.

Venom is offered in several floorplans, some with washer/dryer prep, all with multiple spacious slides. And our 2-year hitch-to-bumper full-timer's warranty ensures complete peace of mind.



Solid hardwood slideout fascia

V3911TK : Slate décor

One-piece residential fiberglass **SHOWER** with glass door and built-in seat. (V3911TK shown)



DECORATIVE DETAILS

- frosted passage door
- glass-front accent cabinets
- 40-inch fireplace
- 50-inch LED TV

KITCHEN CONVENIENCES

- seamless solid surface countertops
- deep stainless steel under-mount sink
- pull-down sprayer

LUXURIOUS BATH

- XL solid-surface vanity with stainless steel sink
- porcelain foot-flush toilet
- XL linen closet
- shower skylight
- power vent with wall switch (V3911TK shown)



V3911TK : Slate décor

Overhead pendant lights

Tile backsplash

KITCHEN

includes maple-glazed, handcrafted solid wood cabinetry, large pantry and hutch.

✓ **18 CU FT GAS/ELECTRIC REFRIGERATOR** with four doors and temperature controls



- ✓ **COMFORTABLE BEDROOM**
- generous cabinets
 - solid-wood slide fascia
 - mirrored sliding closet doors
 - residential padded carpet
 - 72 x 80-inch king bed
 - under-bed storage
 - 32-inch flat-panel TV
 - designer valances (V3911TK shown)

Built-in dresser offers **HIDDEN STORAGE FOR VALUABLES** (V4013TK shown) ✓

▶ **CHEF'S APPLIANCE PACKAGE**

featuring stainless steel gas cooktop with glass cover and built-in oven, along with a 30-inch convection microwave and tons of storage. (V3911TK shown)



CONSTRUCTION STANDARDS

- 101" Wide-Body Construction
- 6-Sided aluminum frame, including welded aluminum fore & aft floor joists, sidewall framing, & roof trusses
- Extra Reinforced Heavy-Duty Front Fiberglass Cap
- Radius Aerodynamic Front Cap
- 2" x 3" Fully-Welded Aluminum Floor Framing
- 2" x 2" Fully-Welded Aluminum Sidewall Framing
- 5" Welded Aluminum Roof Trusses
- Lippert® Hydraulic Slide System w/ Selector Valves
- 12" Powder-Coated Steel I-Beam w/ Drop Frame (160 SQ FT pass-thru storage)
- Lamilux 4,000® High-Gloss Fiberglass Sidewalls
- All Weather Insulation Package to R38 (roof, floor, garage floor end caps, holding tanks)
- Double Insulated & Heated Holding Tanks (R38 above & below tanks)
- Additional Outside Frame-to-Wall Floor Insulation
- R11 2" Sidewalls (w/EGS metal backing strips)
- One-Piece ABS Slideroom Bottoms
- Roof Membrane (TPO/rubber hybrid, limited 12-year warranty)
- 45-Degree Radius Aluminum Roof Edge
- Fully Vented Attic System
- 3/8" Fully Walk-On Roof Decking
- 5/8" Tongue & Groove Screwed & Glued Plywood Floor Decking
- Pex® In-Floor Heated Waterlines & Kitchen Gray Pipes (all waterlines & drains located above all insulation)
- Fully-Enclosed & Heated Underbelly w/ Direct-Heated Holding Tanks

EXTERIOR STANDARDS

- 7,000 LB Dexter® Axles w/Self Adjusting Brakes & Height Adjusting Hangers
- 8-Lug Heavy-Duty Aluminum Rims w/16" G-Range Radial Tires
- 100% Exterior LED Running & Taillights
- Propane Bottles (2 x 30 lbs.) on Same Side for Easy Access
- Sealed Battery Storage Compartment (no battery boxes required)
- Triple Front Slam-Latch Baggage Doors
- Side Slam-Latch Baggage Doors w/ Dual Locks
- Fully Painted Front Cap w/LED Accent Lights
- Frameless Windows

- 35,000 BTU Furnace w/3" x 14" In-Floor Straight Line Heating System
- 12 GAL Gas/Electric Hot Water Heater
- Ramp Door w/LED Lighting
- LED Docking & Sewer Hookup Lights
- Sewer Hose Storage Tube
- Dual Swing-Away Assist Grab Handle
- Under-Frame Spare Tire w/Hoist
- Roof Ladder
- Heated Water Convenience Center (incl. black tank flush, power fresh tank water fill, winterizing system, outside shower, & dry-camping water siphon)
- Fully-Finished Heated & Sealed Basement Storage Compartment
- Camp Table & Patio Chairs Storage Compartment
- Heated & Enclosed Dump Valves
- Satellite Pre-Wire in Convenience Center & Roof
- LP Quick Connect

KITCHEN STANDARDS

- Large Dining Table w/Removable Leaf & 2 Heavy-Duty Chairs (2 additional folding chairs V3911TK, V4114TK)
- Power Vent Kitchen Fan w/Wall Controls
- XL Residential Size Pullout Trashcan (where applicable)
- Removable Silverware Tray
- Under-Sink Storage Shelf
- OH Cabinets incl. Shelf & Extra-Tall Slide Lips
- Hidden Cabinet Door Hinges
- 5" Stainless Steel Cabinet Hardware
- Baltic Birch Drawer Boxes
- Heavy-Duty 100 LB Drawer Glides
- LED Kitchen Cabinet Toe-Kicks (where applicable)
- Kitchen Window (most models)

INTERIOR STANDARDS

- 22 OZ Residential Carpet w/3/8" Re-bond Padding
- XL Ceiling Crown Molding
- 100% LED Ceiling & Cabinet Lights w/ Multiple On/Off Switches
- Extra-Large Light Switches
- Removable Pedestal Tables in Front of Seating (based on model)
- USB Charging Station & 12V Power Outlet

BEDROOM STANDARDS

- XL Deep Closet w/Shoe Storage Rack (V3911TK, V4013TK)
- Dual Washer/Dryer Prep (stacked or side-by-side)
- XL Under-Bed Storage
- Luxurious Bedspread & Pillow Shams
- Flat Panel TV on Swing Arm

BATH STANDARDS

- Residential One-Piece FG Shower Stall w/Glass Doors & Built-In Seat
- Shower Skylight
- XL Solid Surface Bath Vanity w/ Stainless Steel Sink
- Porcelain Foot-Flush Toilet
- XL Linen Cabinet
- XL Deep Closet w/Shoe Storage Rack (V3911TK & V4013TK)
- Extra-Wide Hallway & Pocket Door
- Power Vent w/Wall Switch
- Towel Bar & Towel Ring

GARAGE STANDARDS

- Roll-Down Screen Wall
- E-Track Tie-Down System
- Built-In Dovetail
- 24" Diamond Plate Wall Guards
- Garage Entry Door
- HD Flat Panel Garage TV on Swing Arm
- (2) Garage Ceiling Speakers
- Zero Gravity Ramp Door w/Easy-Lift Assist

OPTIONS (EXTERIOR)

- Dual Pane Windows (frameless)
- Wireless Backup Camera System - Observation
- "Off the Grid" Solar Package*
- Flex-Air Pin Box
- 2nd LED Lighted Power Awning
- Slideout Cover Package (triple slides)
- Ramp Door Patio Package w/Step & Awning
- Three Season Patio Door IPO Screen Wall
- 5.5KW Gas Onan Generator

OPTIONS (INTERIOR)

- Theater Seating w/Heat & Massage Features & 2-Person Table & Chairs IPO Super Sofa (4013TK)
- Residential Refrigerator w/1200W Inverter (18 CU FT) IPO 12 CU FT Gas/ Electric Refrigerator (N/A CSA option)
- Power Vent Fan in Bathroom
- Power Vent Fan in 1/2 Bath

- Denver Trek Queen Pillowtop Mattress 60" x 80"
 - Happi-Jac Power Bed w/Roll Over Sofas & Table
- *Cannot get Residential Refrigerator w/"Off the Grid" Solar Package*

KZ ADVANTAGE PACKAGE (MANDATORY OPTION) EXTERIOR

- 6-Point Hydraulic Auto Leveling
- Polar White High Gloss Gelcoat Exterior Fiberglass
- Painted Fiberglass Front Cap
- 6-Sided Aluminum Framing
- Flip-Up Entry Steps (main entry)
- 50 AMP Service
- (3) 15K Ducted A/Cs w/Load Management System
- 5/8" T&G Plywood Floor
- Key-Alike for Baggage & Entry Doors
- Friction Hinge Entry Door
- Shade Prep & Screenshot Feature on Entry Door
- Large Folding Grab Handle
- Undermount Spare Tire
- Trail-Air Rota Flex Pin Box
- Equa-Flex® Suspension
- Nitrogen-Filled Tires
- Battery Disconnect
- Black Tank Flush
- Backup Camera Prep
- Roof Mounted Solar Prep
- All Weather Insulation Package (heated, insulated & enclosed underbelly plus foil in floor, roof, front, rear)
- Roof Ladder
- Fully Vented Attic System w/2 Attic Vents
- Toy Lok®
- Generator Prep w/Dedicated 30 Gal. Fuel Tank Plus 40 Gal. Fuel Tank & Pump Station
- Retractable Screen Wall

INTERIOR

- Maple Glazed Cabinetry
- Glazed Solid Hardwood Slideout Fascia
- Solid Surface Countertops w/Deep Undermount Stainless Steel Kitchen Sink w/Sink Cover
- Chef's Appliance Package (2-piece SS gas cooktop w/built-in oven & 30" convection microwave)
- Central Vac System w/Attachments
- Power Vent Fan in Main Area
- Super Sofa (select models)

- (3) Motion Sensor Lights (entry, closet, basement)
- 40" Wideview Fireplace
- LED TV
- Multiple Media Stereo w/DVD/Bluetooth
- JBL Performance Package (6 JBL speakers & sub)
- 12V Dual USB Charging Station
- Dual Day/Night Roller Shades
- Porcelain Foot-Flush Toilet
- Stainless Steel Oval Bathroom Sink
- Plywood Bed Base
- Denver Trek King Pillowtop Mattress 72" x 80"
- 32" Bedroom LED TV
- 12 GAL. Gas/Electric Water Heater
- 32" LED TV in Garage Area

KZ CONVENIENCE PACKAGE (MANDATORY OPTION) EXTERIOR

- 7" MyRV® One Touch Control Panel (monitors tank levels & battery levels, controls slide rooms, leveling system, awnings, inside/outside lighting)
- Power Awning w/LED Light Strip
- 16" G-Range Tires w/Aluminum Wheels
- Magnetic Catches for Baggage Doors
- Directional HDTV Antenna
- LED Lights in Exterior Speakers

INTERIOR

- Residential Grade Linoleum
- 18 CU FT Gas/Electric Refrigerator w/ Temperature Controls
- Stainless Steel Residential Kitchen Faucet w/Pulldown Sprayer
- Surfex Wood Step in FW Hallway
- Dark Accent Trim on Corners/Entry Doors

BONUS FEATURES

- 2-Year Limited Warranty (see flyer)
- One of the Lightest, High-Profile, Wide-Body, Luxury Toy Hauler Fifth Wheels in the Industry
- KZ has received the Dealer Satisfaction Index Award for 18 years
- KZ's 47 years of stable, dedicated manufacturing experience, coupled with its predominantly Amish workforce, heritage and commitment to superb quality, allow us to produce the lowest-priced luxury fifth wheel available.

GARAGE FEATURES



E-TRACK

universal track system with different fittings that allow you to quickly snap in and secure your load.



Rubber diamond flooring 



24-inch diamond plate wall guards 

QUICKLY TRANSFORM

the garage from hauling your toys into a lounge area and a roomy bedroom, with optional 60 x 84-inch sit-and-sleep power bed. Add options like ramp door patio rails, three season patio door (*V3911TK shown*).



PUMP STATION

allows easy access to the 40-gallon tank, and the **GENERATOR PREP** includes a dedicated 30-gallon tank.



101-inch WIDE BODY

ZERO GRAVITY RAMP DOOR

ACCESS YOUR TOYS WITH THE LIFT OF A FINGER. NO MORE HASSLE OF LIFTING THE HEAVY BULKY DOOR.

includes electric locks 

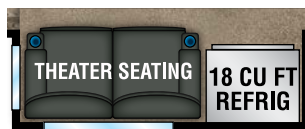
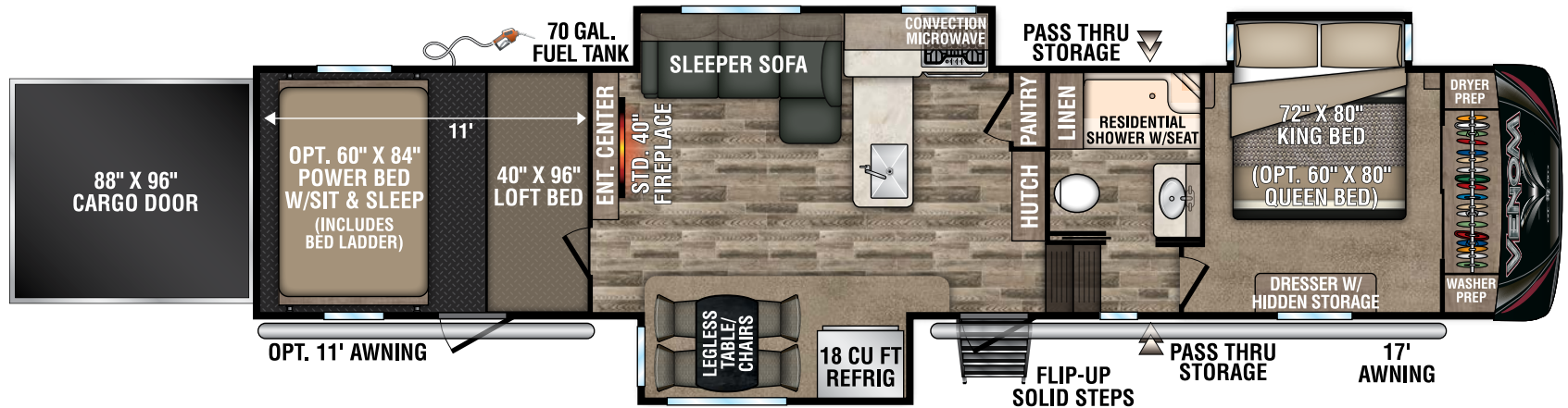

V3911TK
Slideout Option

V3911TK

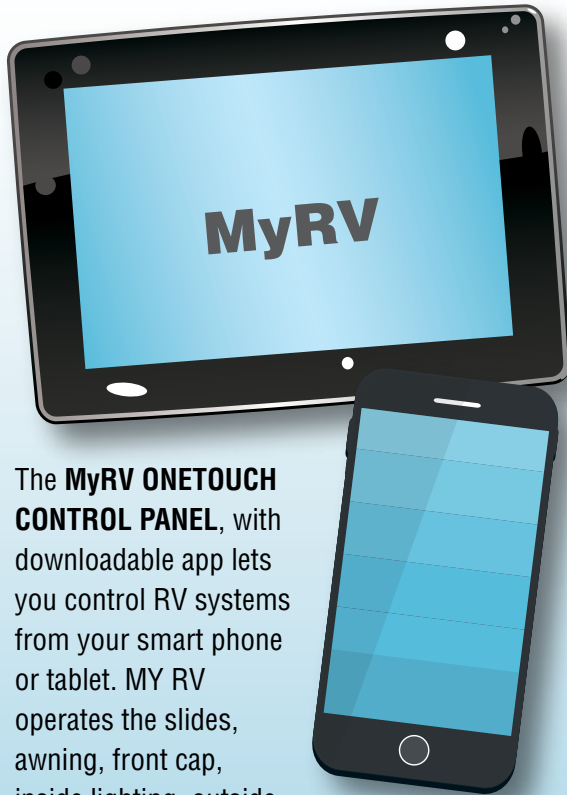
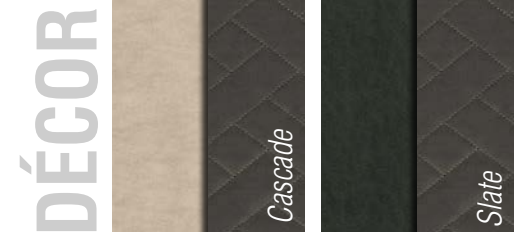

The **MyRV ONETOUCH CONTROL PANEL**, with downloadable app lets you control RV systems from your smart phone or tablet. MY RV operates the slides, awning, front cap, inside lighting, outside lighting, AC's, generator start and hydraulic auto-leveling system!

VENOM Fifth Wheels	V3911TK	V4012TK	V4013TK	V4114TK
UVW (Unloaded Vehicle Weight)*	14,050	15,310	15,100	14,400
Dry Hitch Weight*	3,070	3,190	3,100	3,130
Dry Axle Weight*	10,980	12,120	12,000	11,270
NCC (Net Carrying Capacity)	4,950	3,690	3,900	4,600
GVWR	19,000	19,000	19,000	19,000
Interior Height	102"	102"	102"	102"
Exterior Height w/ A/C	13' 4"	13' 4"	13' 4"	13' 4"
Exterior Width	101"	101"	101"	101"
Exterior Length**	42' 7"	43' 7"	43' 4"	43' 4"
Refrigerator (cu. feet)	18	18	18	18
Water Heater Cap. (gal. G/E w/DSI)	12	12	12	12
Fresh Water Cap. (gal.) [Including Water Heater Capacity]	112	112	112	112
Waste Water Cap. (gal.)	53	53	73	53
Gray Water Cap. (gal.)	93	93	93	93
1/2 Bath Cap. (gal.)	N/A	40	N/A	N/A
LP Gas Cap. (lbs.)	60	60	60	60
Furnace BTUs (1,000s)	35	35	35	35
Tire Size	16"	16"	16"	16"
Awning	17'	15'	17'	15'
Optional 2nd Awning	11'	16'	11'	15'

*This weight reflects the rolling average unit weight for each model. Your trailer weight will vary according to optional equipment.
**Exterior length is measured from center of hitch pin to rear wall.

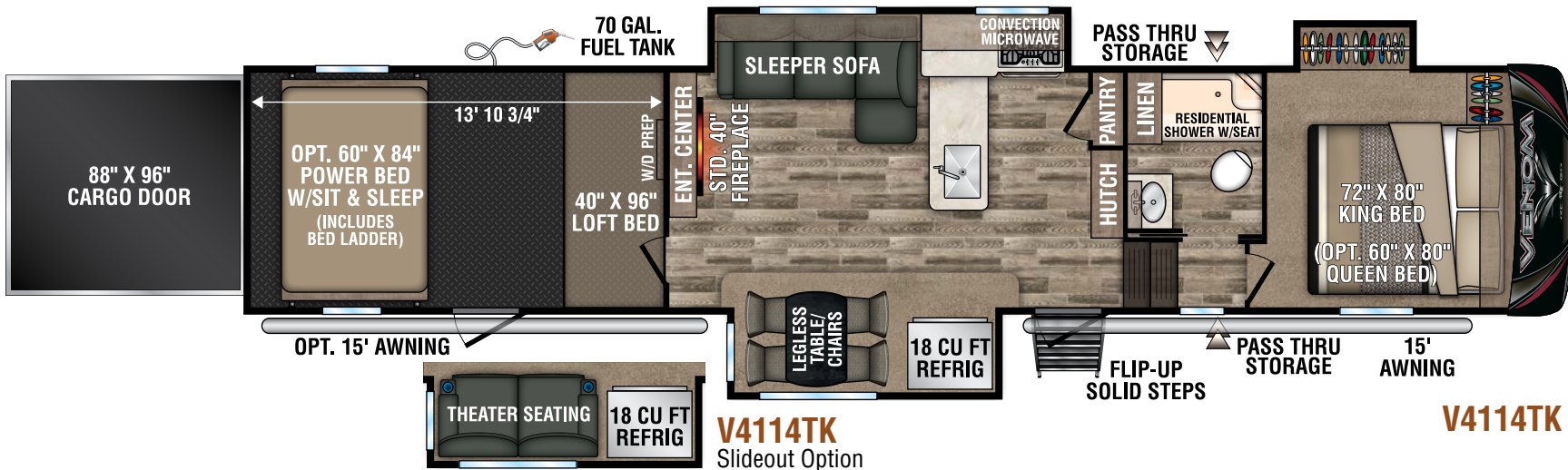
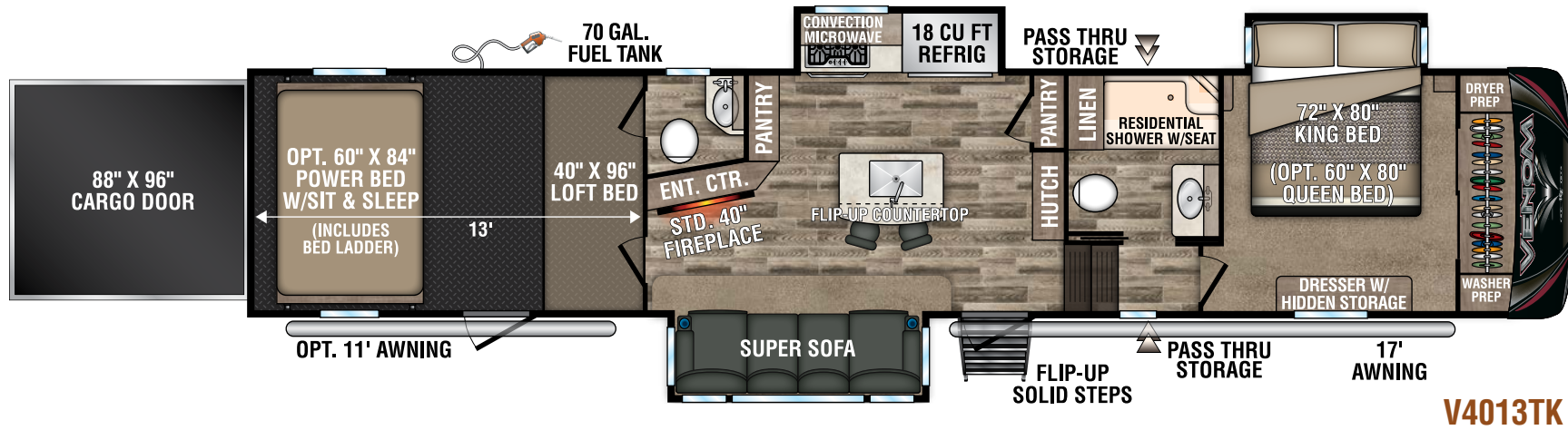
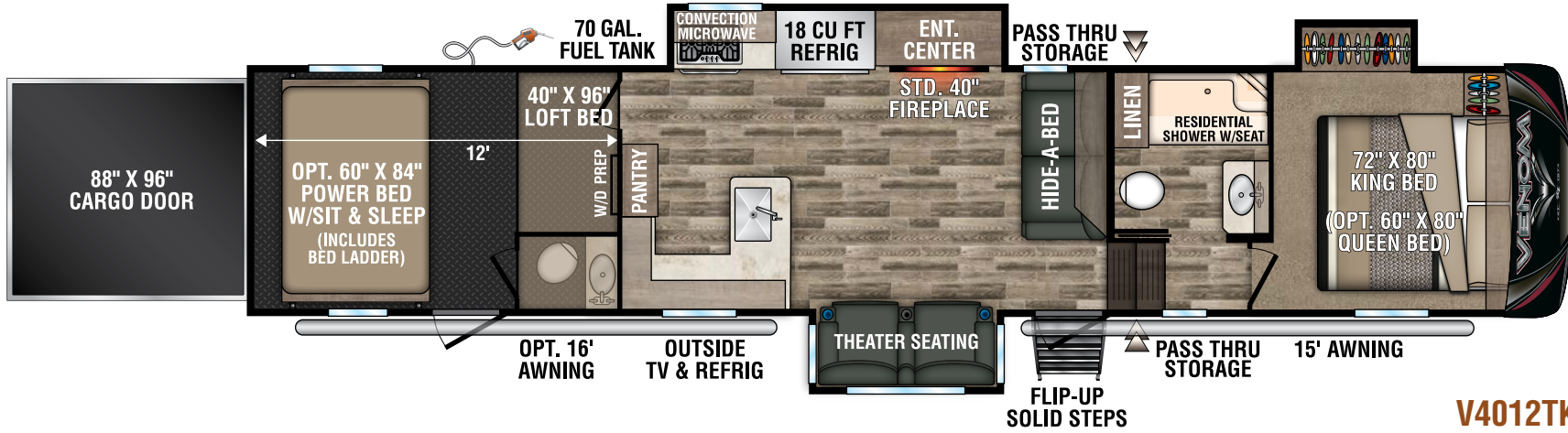

VENOM

EXTERIOR FEATURES



STANDARD FLIP-UP ENTRY STEP with grab handle deploys squarely to provide solid footing. Steps flip up in one easy motion. Handy friction door hinge and screenshot auto-door-close features make usage a breeze



STANDARD 6-POINT HYDRAULIC AUTO-LEVELING SYSTEM does all the work



STANDARD POWER AWNING WITH LED LIGHT STRIP creates the perfect outdoor gathering space for friends and family.



WATER COMMAND CENTER convenient, well-lit centralized spot



BACKUP CAMERA PREP ready for wireless observation camera system



HEATING & COOLING

Standard 3 x 14-inch foam-core in-floor straight-line heating system with 35K BTU furnace and (3) 15K BTU ducted roof A/Cs w/Whisper Quiet cooling system.



160 CUBIC FOOT FULLY-FINISHED PASS-THROUGH COMPARTMENT

rugged diamond-plate flooring and dual-lock slam-latch doors

LUXURY *fifth wheel* TOY HAULERS



- 1** R-11 LAMINATED SIDEWALLS
aluminum framed with high density solid block insulation
- 2** ALL WEATHER INSULATION PACKAGE
heated, insulated and enclosed underbelly plus foil in floor/roof/front/rear. (dedicated heat duct in the underbelly)
- 3** R-38 INSULATED FLOOR AND UNDERBELLY
- 4** R-38 INSULATED ROOF
- 5** R-38 INSULATED FRONT AND REAR WALLS
- 6** 5/8" TONGUE AND GROOVE PLYWOOD
some of our competitors use OSB board
- 7** 1" THICK BAGGAGE DOORS WITH SLAM LATCH
some of our competitors have 1/2" baggage doors
- 8** FULLY VENTED ATTIC SYSTEM w/ 2 attic vents
- 9** 101" WIDE BODY

**6-SIDED
100%
ALUMINUM
FRAME**

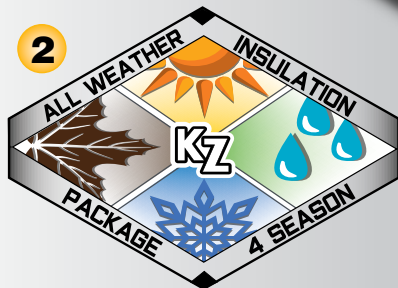

DOWNLOAD YOUR FREE

KZ RV APP TODAY!

Owning and operating an RV has never been easier. Everything you need is now in the palm of your hand.



Track RV Maintenance



Keep RV Service Close



Set Custom Notifications



Reference Checklists for RV Trips



DOWNLOAD NOW!



VISIT KZ-APP.COM TO LEARN MORE.



True 2-Year Limited Warranty!

KZ's 24-month hitch-to-bumper limited warranty umbrella is the best two-year warranty in the business, covering more than 1,500 operation codes for a full two years and approved for full-time living, thus protecting your investment while you enjoy your RV.

You've found the RV that fits your needs... now you want total confidence in your selection. Because KZ has total confidence in the products we build, we can pass that along to the original purchaser, starting from the date of delivery. Rest easy... you've partnered with the right manufacturer!

KZ Recreational Vehicles... *A History in Progress*

Sam King and Daryl Zook built a truck camper in 1972, with founding principles of quality, fairness, courtesy and integrity. Nearly 50 years later, our 625 employees build your recreational vehicles, on our 100+ acre campus in Shipshewana, IN.

When you communicate with KZ, you'll always be speaking with someone who takes you seriously and treats you with respect. Thank you for considering KZ, and welcome to our world-wide family of satisfied customers!



Portions of this brochure were used with the expressed authority of Dexter Axle, but Dexter Axle is not responsible for the accuracy of the information contained herein.



Dealer:



985 N 900 W • Shipshewana, IN 46565
E-mail kz@kz-rv.com • www.kz-rv.com

Due to continual research and advances, manufacturer reserves the right to change specifications, design, price and equipment without notice, and assumes no responsibility for any error in this literature. Some items shown are not included as standard or optional equipment. ©2019KZ | 02/13/19 | 60M