

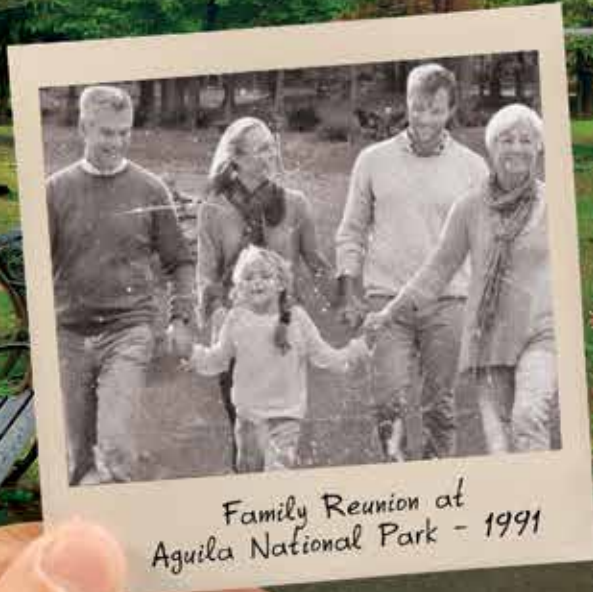

2019 EAGLE TRAVEL TRAILERS



Family Reunion at
Aguila National Park - 1991



2
YEAR
LIMITED
WARRANTY



284BHOK OUTSIDE KITCHEN

The new Eagle HT half-ton towable travel trailer series is available in 2 unique interior designs: MODERN FARMHOUSE, a fresh look inspired by residential trends, features Farmhouse White wood tones, custom hardware, countertops, and flooring, with retro lighting, rustic accents, and more. Shown here with optional fireplace.



284BHOK MAIN INTERIOR



EAGLE HT BEDROOM





324BHTS MAIN INTERIOR



Beautiful hand-glazed brown maple woodwork with chocolate accents and rustic flooring enhances Eagle's other new interior design, *American Tradition*. Optional LED fireplace and MORryde entry steps provide luxury features on shorter, lighter floorplans.



284BHOK BATHROOM



324BHTS KITCHEN



MORRYDE STEPABOVE®

EAGLE HT TRAVEL TRAILER FLOORPLANS



262RBOK OPTION: E



272RBOK OPTIONS: A, B, F



264BHOK OPTION: E



280RSOK OPTIONS: A, D



270RLDS OPTIONS: A, C



284BHOK OPTIONS: A, B, F



324BHTS OPTIONS: A, B, F, G

LEGEND

	STORAGE	MICRO	MICROWAVE
	TRAILER HITCH	OVC	OVERHEAD CABINETS
LAV	BATHROOM SINK	FRIDGE	REFRIGERATOR
MED	MEDICINE CABINET	WARD	WARDROBE

OPTIONS

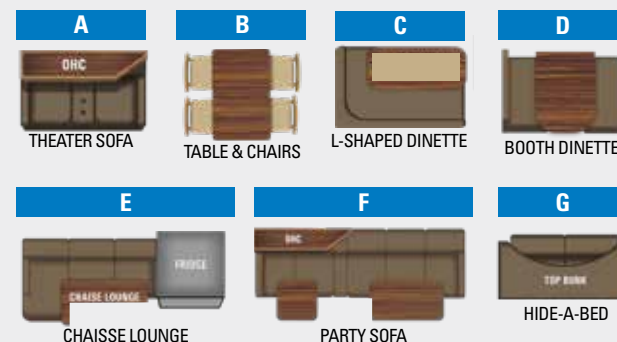

EAGLE HT TRAVEL TRAILER SPECS

FLOORPLAN	EXTERIOR TRAVEL LENGTH	EXTERIOR WIDTH	EXTERIOR HEIGHT (WITH A/C)	INTERIOR HEIGHT	UNLOADED VEHICLE WEIGHT	DRY HITCH WEIGHT	GROSS VEHICLE WEIGHT RATING	CARGO CARRYING CAPACITY	FRESH WATER CAPACITY (INCLUDES WATER HEATER)	GREY WASTE WATER CAPACITY*	BLACK WASTE WATER CAPACITY	SLEEP CAPACITY
262RBOK	30' 1"	8' 1"	11' 10"	7' 0"	7,090	675	9,995	2,905	49	65*	32.5	3 - 4
264BHOK	32' 10"	8' 1"	11' 10"	7' 0"	7,410	760	9,995	2,585	49	65*	32.5	7 - 8
270RLDS	33' 11"	8' 1"	11' 10"	7' 0"	7,800	990	9,995	2,195	49	65*	32.5	4
272RBOK	32' 6"	8' 1"	11' 9"	7' 0"	7,515	825	9,995	2,480	49	65*	32.5	5 - 6
280RSOK	35' 11"	8' 1"	11' 9"	7' 0"	8,465	1,130	9,995	1,530	81	65*	32.5	4 - 6
284BHOK	35' 3"	8' 1"	11' 9"	7' 0"	7,990	985	9,995	2,005	81	65*	32.5	8 - 10
324BHTS	38' 5"	8' 0"	11' 6"	7' 0"	8,605	930	10,950	2,345	81	65*	32.5	6 - 8

* Split tank

It is important for your safety and enjoyment that your tow vehicle be adequately sized and equipped to tow and handle the GVWR of the RV you select. Review weights and rating of your tow vehicle and consult a competent advisor for questions or advice. Whether you are new to RVing or a veteran, get a feel for the performance of your tow vehicle before heading out on the roadways. When you tow an RV, you must drive differently than when you drive a single vehicle. Practice hooking up, driving, backing up and braking in a safe environment or seek out professional instruction. Jayco affixes a weight label to each RV which lists weight information for that vehicle. See specifications chart above.

Unloaded Vehicle Weight (UVW): Sometimes referred to as "Dry Weight," UVW means the typical weight of this trailer as built at the factory; The UVW, as used in product literature and other promotional materials, does not include cargo, fresh water, propane, options or dealer-installed accessories.

Gross Vehicle Weight Rating (GVWR): GVWR means the maximum permissible weight of the trailer, including the UVW plus personal items, all cargo, fluids, options and dealer-installed accessories. The GVWR is equal to or greater than the sum of the UVW and the CCC.

Cargo Carrying Capacity (CCC): CCC means the maximum weight of personal items, food, fresh water, propane, tools, other cargo and dealer-installed accessories that can be carried by the trailer. CCC is equal to or less than GVWR minus UVW. The addition of options will decrease the CCC.

Hitch Weight (HW): The hitch weight, as used in product literature and other promotional materials, does not include cargo, fresh water, propane gas, options or dealer-installed accessories. The addition of these types of items will either add to or subtract from the stated hitch weight.



322RLOK OUTSIDE KITCHEN

Eagle's luxurious rear living with outside kitchen floor plan, featuring MODERN FARMHOUSE décor, mixes contemporary kitchen styling with highly usable, custom furniture for a warm and welcoming home away from home (optional 21 cu. ft. residential refrigerator and rolling island pantry shown).



322RLOK MAIN INTERIOR



322RLOK MAIN INTERIOR



322RLOK KITCHEN



322RLOK MAIN INTERIOR
EAGLE BEDROOM



Raised-panel cabinetry, custom hardwood maple ribbon trim, and contrasting chocolate accents highlight the *Americian Tradition* décor. An available rolling island pantry provides additional countertop and storage space while the optional Simmons® BeautyRest® king-sized bed upgrades Eagle's expansive bedroom suite.



322RLOK MAIN INTERIOR



EAGLE TRAVEL TRAILER FLOORPLANS



322RLOK OPTIONS: C, D, E



338RETS OPTIONS: A, B, C, D, E



330RSTS OPTIONS: A, B, C, D, E

LEGEND

- STORAGE
- TRAILER HITCH
- LAV BATHROOM SINK
- MED MEDICINE CABINET
- MICRO MICROWAVE
- OHC OVERHEAD CABINETS
- FRIDGE REFRIGERATOR
- WARD WARDROBE

OPTIONS

- A** DINETTE
- B** SECOND TRI-FOLD SOFA OPTION
- C** KING BED
- D** OPTION
- E** 13 CU. FT. FRIDGE

EAGLE TRAVEL TRAILER SPECS

FLOORPLAN	EXTERIOR TRAVEL LENGTH	EXTERIOR WIDTH	EXTERIOR HEIGHT (WITH A/C)	INTERIOR HEIGHT	UNLOADED VEHICLE WEIGHT	DRY HITCH WEIGHT	GROSS VEHICLE WEIGHT RATING	CARGO CARRYING CAPACITY	FRESH WATER CAPACITY (INCLUDES WATER HEATER)	GREY WASTE WATER CAPACITY*	BLACK WASTE WATER CAPACITY	SLEEP CAPACITY
322RLOK	38' 7"	8' 0"	11' 10"	7' 3"	9,575	1,230	11,750	2,175	81	97.5	32.5	4
330RSTS	39' 4"	8' 0"	12' 0"	7' 3"	9,780	1,395	11,750	1,920	81	97.5	32.5	4 - 6
338RETS	39' 4"	8' 0"	12' 0"	7' 3"	9,645	1,350	11,700	2,055	81	97.5	32.5	4 - 8

* split tank

It is important for your safety and enjoyment that your tow vehicle be adequately sized and equipped to tow and handle the GVWR of the RV you select. Review weights and rating of your tow vehicle and consult a competent advisor for questions or advice. Whether you are new to RVing or a veteran, get a feel for the performance of your tow vehicle before heading out on the roadways. When you tow an RV, you must drive differently than when you drive a single vehicle. Practice hooking up, driving, backing up and braking in a safe environment or seek out professional instruction. Jayco affixes a weight label to each RV which lists weight information for that vehicle. See specifications chart above.

Unloaded Vehicle Weight (UVW): Sometimes referred to as "Dry Weight," UVW means the typical weight of this trailer as built at the factory; The UVW, as used in product literature and other promotional materials, does not include cargo, fresh water, propane, options or dealer-installed accessories.

Gross Vehicle Weight Rating (GVWR): GVWR means the maximum permissible weight of the trailer, including the UVW plus personal items, all cargo, fluids, options and dealer-installed accessories. The GVWR is equal to or greater than the sum of the UVW and the CCC.

Cargo Carrying Capacity (CCC): CCC means the maximum weight of personal items, food, fresh water, propane, tools, other cargo and dealer-installed accessories that can be carried by the trailer. CCC is equal to or less than GVWR minus UVW. The addition of options will decrease the CCC.

Hitch Weight (HW): The hitch weight, as used in product literature and other promotional materials, does not include cargo, fresh water, propane gas, options or dealer-installed accessories. The addition of these types of items will either add to or subtract from the stated hitch weight.

Travel Trailers Built Like Fifth Wheels

Based on customer demands for a “flat-floored fifth wheel” build, Eagle travel trailers share the following:

- 4-Star Handling Package
- 2” Accessory Receiver
- Shared Slide-Room Heights
- Shared Floorplans
- Taller Ceiling Heights
- Larger Tank Capacities
- Larger Pass-Through Storage
- Full Fiberglass Front Caps
- Upgraded Running Gear
- Luxury Options



270RLDS

322RL0K

Two Unique & Beautiful Concepts

True interior design. More choice. Mindful craftsmanship.

Every fixture, fabric and feature has been carefully selected and expertly installed. The result is an aesthetic that’s extraordinary — with Jayco’s famous high level of livability. Designer-selected patterns and fabrics enhance the overall look and feel, while unique furniture designs and contrasting hand-picked hardware and lighting enhance each exclusive decor package.



Led by Interior Designer Stacy Stewart, our design, product development and engineering teams set out to answer the call for more choice in RV interiors and developed a market-disrupting design concept that could be expertly crafted without hampering production.

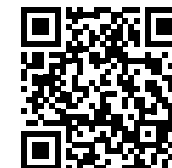

SCAN TO LEARN MORE ABOUT
EAGLE'S INTERIOR DESIGN

		American Tradition	MODERN FARMHOUSE			
Furniture					Furniture	
	Window Treatment					Window Treatment
Cabinetry					Cabinetry	
	Trim					Trim
	Accent					Accent
Fascia					Fascia	
	Main					Main

STANDARDS & OPTIONS

Eagle HT			Eagle HT			Eagle HT						
Eagle			Eagle			Eagle						
Customer Value Package (Mandatory)												
Goodyear® Endurance® Tires (Made in U.S.A. I Load Range 'E')	CVP	CVP	High gloss, fiberglass front cap with built-in specialty LED lighting			•	•	Residential quilted bedspread and pillows	•	•		
Dexter® Axles with Nev-R-Adjust® brakes and E-Z Lube® hubs	CVP	CVP	LED exterior lighting package			•	•	Smart LED Reading Lights (with blue nightlight mode)	•	•		
MORryde® CRE-3000™ rubberized suspension	CVP	CVP	Custom automotive-grade vinyl exterior graphics package			•	•	CPAP prepped bedroom	•	•		
15,000 BTU "Whisper Quiet" A/C	CVP	CVP	Power service with detachable Powersmart™ LED shore power cord			30AMP	50AMP	Carbon monoxide and LP detector	•	•		
Quick recovery gas/electric DSI water heater (17.8 gallon per hour)	CVP	CVP	Dual 30 lb. propane bottles with auto regulator			•	•	Options				
Residential Queen (60 inch x 80 inch) Simmons® mattress with under-bed storage	CVP	CVP	Sturdy, anti-slip aluminum entrance steps (Made in U.S.A.!) with blue LED light			•	•	Canadian Standards	OPT	OPT		
Electric patio awning with integrated LED lights	CVP	CVP	Pass-through storage with Slam-latch™ baggage doors			•	•	Custom contemporary or traditional interior design (Industry First!)	OPT	OPT		
Custom machined aluminum rims	CVP	CVP	Digital TV antenna			•	•	16" Goodyear Endurance Tire Upgrade	OPT	STD		
Rear 2 inch receiver	CVP	CVP	Exterior marine-grade speakers			•	•	Freestanding Rustic Table with Leaf and 2 Storage & 2 Folding Chairs	OPT	OPT		
LED HDTV with fully digital HDMI output	40"	50"	Fully enclosed, LED lit universal docking center with quick connect outside shower, city water connection, and black tank flush			•	•	Booth Dinette (select models)	OPT	OPT		
12V AM/FM/CD/DVD/USB A/V system with Bluetooth® and HDMI®	CVP	CVP	Independent satellite and whole coach cable hookups			•	•	L-Shaped Booth Dinette (270RLDS)	OPT	N/A		
Stainless steel range with glass cover	CVP	CVP	Battery disconnect			•	•	Chaise Lounge Dinette (262RBOK & 264BHOK)	OPT	N/A		
Stainless steel microwave with exhaust fan	CVP	CVP	Water heater bypass			•	•	Party Sofa with Stowable Tables and Hide-a-bed (select models)	OPT	N/A		
Hidden hinges	CVP	CVP	Under-mounted spare tire			•	•	LED fireplace, 5,000 BTU electric heater (requires 50 amp service)	OPT	LUX PKG		
Rain-proof EZ Breeze™ 350CFM bathroom power vent (patent pending, a class exclusive)	CVP	CVP	LP quick connect (outside grill prep)			•	•	Wall hugger theater seating (select models, STD on 322RLOK)	OPT	OPT		
Rooftop and ground solar prep by Go Power® (an industry first!)	CVP	CVP	Roof ladder			•	•	2nd Tri-fold Hide-A-Bed Sofa (select models)	OPT	OPT		
Upgraded friction hinge entrance door with XL grab handle	CVP	CVP	"Industry's BEST" outside kitchen (select models)			•	•	LG HI-MACS® solid-surface kitchen countertops	OPT	LUX PKG		
Wireless remote control system	CVP	CVP	Front electric tongue jack			•	•	Rear electric stabilizer jacks	OPT	STD		
Keyed Alike™ lock system	CVP	CVP	Front electric stabilizer jacks			OPT	•	MORryde StepAbove entrance steps (STD select models)	OPT	OPT		
Backup camera prep (rear observation)	CVP	CVP	Rear electric stabilizer jacks			OPT	•	Electric auto-leveling system (in place of rear electric jacks)	OPT	OPT		
Bluetooth speaker prep	CVP	CVP	Standard Interior Equipment									
Luxury Package (Mandatory)												
Soft close residential kitchen drawers	N/A	LUX PKG	Solid hardwood slide fascia			•	•	13 cu. ft. Gas/Electric Refrigerator	N/A	OPT		
Integrated sound bar	N/A	LUX PKG	Handcrafted and glazed doors, drawers and trim			•	•	23 cu. ft. Residential Refrigerator + 1200W pure sine wave inverter	N/A	OPT		
Washer/Dryer prep (STD select HT models)	N/A	LUX PKG	Heavy-duty, 75 lb., full extension, steel ball-bearing drawer guides			•	•	2nd Power Awning	N/A	OPT		
LG® solid-surface kitchen countertop with bamboo sink cover and strainer	OPT	LUX PKG	5/8 inch tongue and groove joined plywood floor decking			•	•	32 inch LED TV in Master Bedroom	N/A	OPT		
50 amp service with dual A/C ducts and second A/C prep	OPT	LUX PKG	Shaw® residential carpeting with R2X® stain guard			•	•	32 inch LED TV in Bunk House (select models)	OPT	N/A		
Frameless windows	OPT	LUX PKG	Shaw residential carpet pad with R-value and sound dampening			•	•	32 inch LED TV in Outside Kitchen (select models)	OPT	OPT		
LED fireplace with 5,000 BTU electric space heater	OPT	LUX PKG	"Wood Plank" vinyl flooring (standard minimal carpeting)			•	•	Rolling island pantry (322RLOK, 338RETS)	N/A	OPT		
Standard Exterior Equipment												
4-Star Handling Package: • Dexter Axles with Nev-R-Adjust brakes and E-Z Lube hubs • Wet bolt fasteners and bronze bushings • Upgraded MORryde suspension • Upgraded Goodyear tires	•	•	LED interior lighting throughout			•	•	Wireless Backup/Review Camera kit	OPT	OPT		
HELIX Cooling System™ (industry exclusive): • Exterior-mounted 15,000 BTU "Whisper Quiet" A/C unit • Jayco exclusive insulated duct design • Directional and closeable A/C vents • Larger return air vents with user accessible filters	•	•	LED dimmer switches in main room and dining area			•	•	Sani-con® Turbo waste management system	OPT	OPT		
I-class cambered, structural steel I-beam frame	•	•	Central command center with built-in tank monitoring			•	•	Frameless windows	OPT	LUX PKG		
StrongholdVBL™ aluminum framed and vacuum bond laminated gel-coated fiberglass exterior walls (including rear wall and slide room end walls)	•	•	Tri-fold hide-a-bed sofa with residential sleep surface (select models)			•	•	Frameless Dual Pane Tinted Safety Glass Windows	OPT	OPT		
Magnum Truss™ Roof System (strongest tested roof in the industry) with one piece, seamless DiFlex II material	•	•	Swivel glider recliners (select models)			•	•	Generator Prep	OPT	N/A		
JaySMART™ (Safety Markers And Reverse Travel) LED Lighting (patent-pending)	•	•	Stainless steel kitchen sink			•	•	CVP - Customer Value Package			N/A - Not Available	STD - Standard
			Brushed nickel kitchen faucet with pullout sprayer			•	•	OPT - Optional			• - Standard	
			8 cu. ft. gas/electric refrigerator with freezer			•	•	LUX PKG - Luxury Package				
			Dual USB charging ports (kitchen and bedroom)			•	•					
			12V charging station			•	•					
			Extra 110V power outlets in kitchen and slide rooms			•	•					
			Bathroom skylight			•	•					
			LED backlit medicine cabinet with custom framed mirror (industry exclusive)			•	•					
			Bathroom stone and glass tile backsplash			•	•					
			Blue LED nightlights (bathrooms and bunkrooms)			•	•					
			Porcelain foot flush toilet			•	•					



KEYED-ALIKE LOCK SYSTEM



HARDWOOD SLIDE ROOM FASCIA



INDUSTRY EXCLUSIVE LED BACKLIT MIRROR

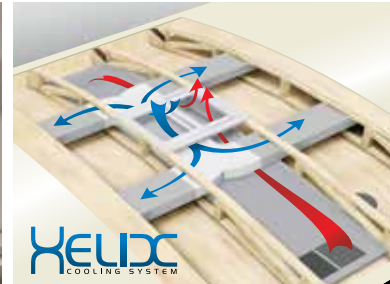

HELIX WHISPER QUIET COOLING SYSTEM WITH JAYCO-EXCLUSIVE DUCT DESIGN



LG SOLID-SURFACE KITCHEN COUNTERTOP WITH BAMBOO SINK COVER AND STRAINER



MORRYDE CRE3000 RUBBERIZED SUSPENSION



RESIDENTIAL SIMMONS MATTRESS



360 SIPHON ROOF VENT



SHAW RESIDENTIAL CARPETING WITH R2X STAIN GUARD, R-VALUE AND SOUND DAMPENING



POTS AND PANS DRAWER WITH 75 LB. CAPACITY



12V 3-ZONE FURRIION® AV SYSTEM WITH HDMI AND BLUETOOTH



INTEGRATED REAR 2-INCH RECEIVER HITCH



OPTIONAL AUTO-LEVELING UPGRADE FEATURES WI-FI REMOTE CONTROL VIA APP



- Large Holding Tank Capacities
- Extra-Large Battery Area
- Solar Prep to Rooftop and Ground

GENERATOR PREP (SELECT MODELS)



GO POWER! GROUND AND ROOFTOP SOLAR PREP



OPTIONAL FURRIION BACKUP CAMERA SYSTEM



OPTIONAL SANI-CON TURBO WASTE MANAGEMENT SYSTEM



FRAMELESS WINDOWS (OPTIONAL ON HT)

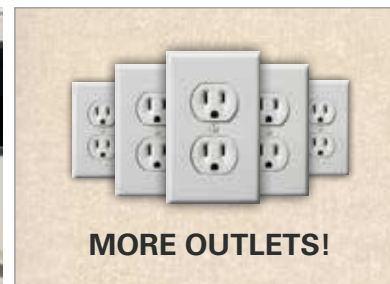

MORE OUTLETS!

STRATEGICALLY PLACED OUTLETS THROUGHOUT.



MORRYDE STEPABOARD (OPTIONAL, STD ON SELECT MODELS)

1 4 STAR HANDLING PACKAGE



DEXTER AXLES WITH NEV-R-ADJUST BRAKES
The Benchmark of the trailer industry!



DEXTER WET BOLT FASTENERS AND BRONZE BUSHINGS
Resists the wear-and-tear of towing.



MORRYDE RUBBERIZED SUSPENSION SYSTEM
Better absorbs and isolates road shock.



GOODYEAR ENDURANCE TIRES
Made in the U.S.A. and featuring the patented Durawall® technology.



* Jayco's Eagle Travel Trailer construction mirrors Eagle Fifth Wheel construction!



Eagle flaunts the industry's strongest vacuum-bonded lamination. We laminate each sidewall, rear wall, slide room wall, and slide room end walls for 16 minutes at 144 tons of pressure.

3 HELIX Whisper Quiet Cooling System: standard 15,000 BTU AC with specialty ducts dramatically reduces noise while increasing efficiency

4 BETTER BUILDING MATERIALS: Tongue and groove joined plywood is used to deck both the roof and the floor



Jayco's exclusive, patent-pending S.M.A.R.T. lighting increases safety and visibility

6



JAYCO'S ROOF **VS** OTHER ROOFS
4,500 POUNDS
ON A JAYCO ROOF VS. OTHER ROOFS

50% Stronger!



CLIMATESHIELD

7

Extend your camping season with the Jayco Climate Shield.

It protects against extreme heat and extreme freezing—even in temperatures as high as 100 degrees or as low as zero degrees (Fahrenheit).*

LIVING ROOM

0°F 70°F
100°F 69°F

KITCHEN

0°F 69°F
100°F 70°F

BATHROOM

0°F 71°F
100°F 68°F

HOLDING TANK

0°F 60°F
100°F 72°F

BEDROOM

0°F 71°F
100°F 71°F

*Jayco tested fifth wheels in zero degrees F and 100 degrees F weather over an extended period of time in a controlled environment, and all functions of the coach were fully operational. Testing was done in a completely controlled environment; therefore, temperatures during testing may not represent actual temperatures in nature and cannot account for elements such as wind or moisture. In actual use, unit may not perform as well. Supplier of cooling components does not guarantee anything better than 20 degrees difference from ambient temperature. In addition, outside components are subject to freezing and require steps to properly insulate. Jayco's limited warranty does not cover damage caused by freezing. To learn more about Climate Shield and testing done by Jayco, visit www.jayco.com.



Meet your Jayco Dealer _____

Travel with Confidence _____

Follow Jayco
#Jayco50



Jayco, Inc. | P.O. Box 460 | Middlebury, IN 46540 ☎ RVIA

Jayco reserves the right to make changes and to discontinue models without notice or obligation. Photography may show optional equipment or props used for decoration purposes only. RVs built for sale in Canada may differ to conform to Canadian codes. JAYCO and the JAYCO BIRD IN FLIGHT are registered trademarks of Jayco, Inc. Printed in USA 40K RB 7/18 © 2018 Jayco, Inc. 274880



At Jayco, we build our RVs to handle every adventure, then back them with our industry-leading 2-year limited warranty. We, with support from our select partners, have you covered for **2 camping seasons**. That's **730 days**. You won't find a better warranty in the business, because the only strings we attach are those that deliver the ultimate in reliability. That's the Jayco difference. So go explore. For a copy of our 2-year limited warranty with complete terms and conditions, please contact your local Jayco dealer.

See dealer for further information and prices. All information in this brochure and on www.jayco.com is the latest available at the time of publication approval.



2019 EAGLE FIFTH WHEELS



3 Generations of Camping!
Camp Adler - 1991





OUTSIDE KITCHEN



30.5MLOK MAIN INTERIOR

Eagle's best-selling half-ton towable fifth wheel series is now available in 2 unique interior designs: MODERN FARMHOUSE, a fresh look inspired by residential trends, features Farmhouse White wood tones, custom hardware, countertops, and flooring, with retro lighting, rustic accents, and more.



30.5MLOK MAIN INTERIOR



EAGLE HT BEDROOM



30.5MLOK MAIN INTERIOR

30.5MLOK KITCHEN



30.5MLOK MAIN INTERIOR



Beautiful hand-glazed brown maple woodwork enhances Eagle's other new interior design, *American Tradition*, shown here on an industry exclusive mid-living room with standard outside kitchen floor plan (shown with optional 13 cu. ft. refrigerator, theater seating, and exterior TV).

EAGLE HT FIFTH WHEEL FLOORPLANS

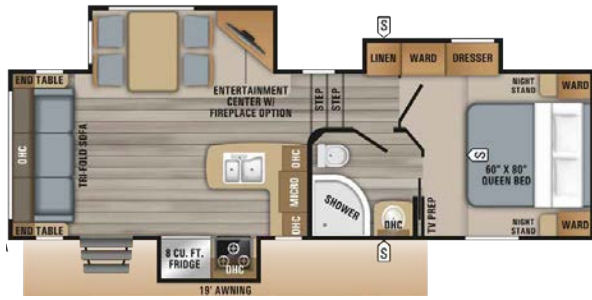

24.5CKTS OPTIONS: B, E

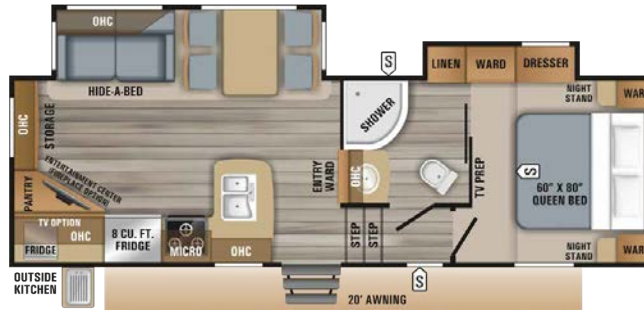

25.5REOK OPTIONS: A, B

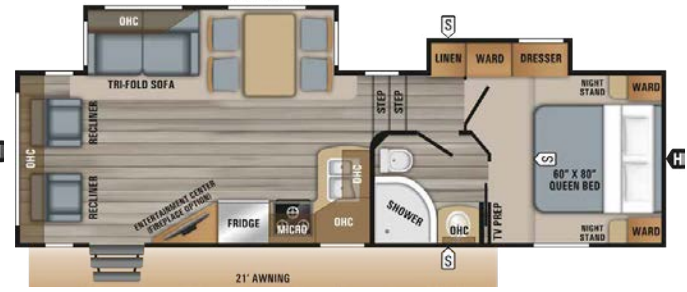

26.5RLDS OPTIONS: A, B



27.5RLTS OPTIONS: B, E

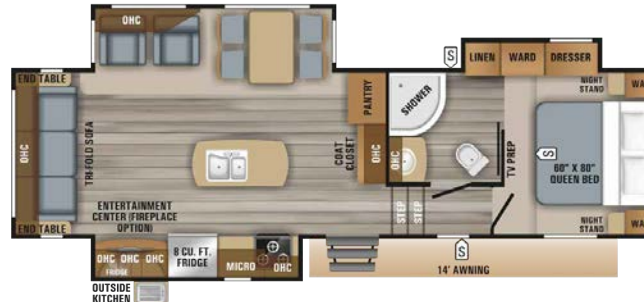

28.5RSTS OPTIONS: A, B



29.5BHDS OPTIONS: B, C, D



29.5BHOK OPTIONS: C, D, F

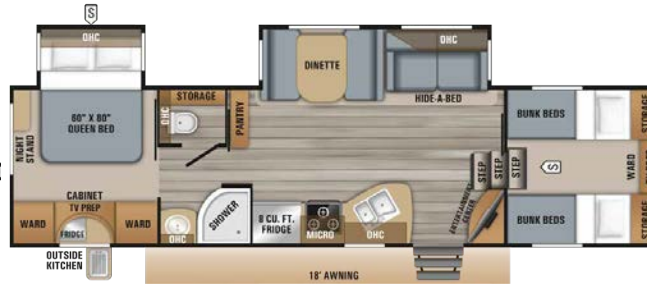

29.5FBDS OPTIONS: B, C, D

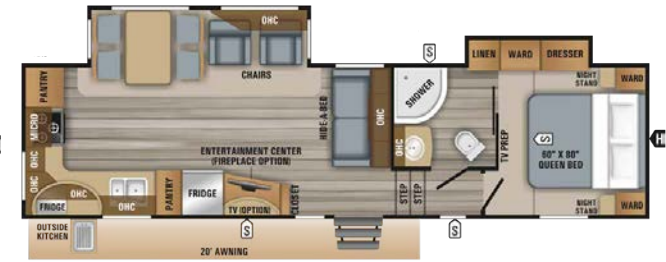

30.5MLOK OPTION: B



30.5CKTS OPTIONS: A, B, F



30.5MBOK OPTIONS: A, B, E, F



STANDARD INTEGRATED REAR 2 INCH RECEIVER HITCH WITH 300 POUND TONGUE CAPACITY.
3,000 LB. TOWING CAPACITY (EAGLE HT ONLY)

LEGEND

	STORAGE	MICRO	MICROWAVE
	TRAILER HITCH	OHC	OVERHEAD CABINETS
LAV	BATHROOM SINK	FRIDGE	REFRIGERATOR
MED	MEDICINE CABINET	WARD	WARDROBE

OPTIONS

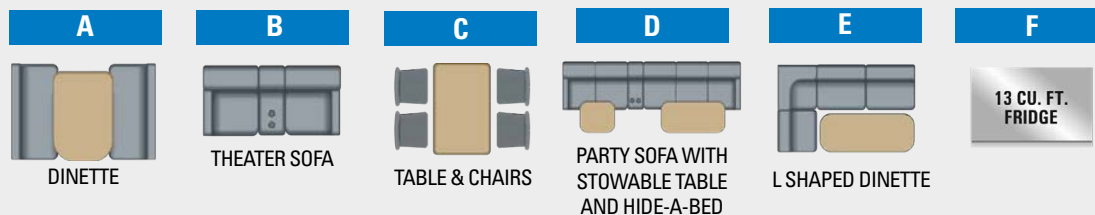

EAGLE HT FIFTH WHEEL SPECS

FLOORPLAN	TOTAL EXTERIOR LENGTH	EXTERIOR TRAVEL LENGTH*	EXTERIOR WIDTH	EXTERIOR HEIGHT (WITH A/C)	EXTERIOR HEIGHT (WITH OPT. BEDROOM A/C)	INTERIOR HEIGHT (UPPER DECK)	UNLOADED VEHICLE WEIGHT	DRY HITCH WEIGHT	GROSS VEHICLE WEIGHT RATING	CARGO CARRYING CAPACITY	FRESH WATER CAPACITY (INCLUDES WATER HEATER)	GREY WASTE WATER CAPACITY**	BLACK WASTE WATER CAPACITY	SLEEP CAPACITY
24.5KTS	29' 5"	28' 6"	8' 0"	12' 0"	12' 8"	6' 2"	7,460	1,340	9,950	2,490	49	65**	32.5	4 - 6
25.5REOK	29' 1"	28' 2"	8' 0"	12' 8"	12' 9"	6' 2"	7,700	1,375	9,995	2,295	49	65**	32.5	4 - 6
26.5RLDS	31' 6"	30' 5"	8' 0"	12' 8"	12' 8"	6' 2"	7,595	1,530	9,995	2,400	49	65**	32.5	4 - 6
27.5RLTS	31' 0"	30' 3"	8' 0"	12' 1"	12' 9"	6' 2"	7,970	1,560	9,995	2,025	49	65**	32.5	4 - 6
28.5RSTS	33' 0"	32' 2"	8' 0"	12' 1"	12' 8"	6' 2"	8,620	1,395	10,995	2,375	49	65**	32.5	4 - 6
29.5BHDS	34' 9"	34' 0"	8' 0"	12' 8"	12' 8"	6' 2"	8,825	1,715	10,995	2,170	49	73.5**	32.5	8 - 10
29.5BHOK	35' 6"	34' 9"	8' 0"	12' 0"	12' 8"	6' 2"	8,760	1,708	11,000	2,240	49	73.5**	32.5	8 - 10
29.5FBDS	34' 5"	33' 8"	8' 0"	12' 9"	12' 9"	6' 2"	8,640	1,595	10,500	1,860	49	65**	32.5	8 - 10
30.5CKTS	34' 3"	33' 4"	8' 0"	12' 2"	12' 8"	6' 2"	8,700	1,540	11,000	2,300	49	65**	32.5	4 - 6
30.5MBOK	36' 7"	35' 11"	8' 0"	12' 5"	13' 2"	6' 2"	10,110	1,840	11,950	1,840	81	65**	32.5	6 - 8
30.5MLOK	34' 5"	33' 9"	8' 0"	12' 8"	12' 8"	6' 2"	8,550	1,519	11,000	2,450	49	65**	32.5	4 - 6

* Distance from the pinbox to the bumper; total exterior length may be longer.

** Split tank

It is important for your safety and enjoyment that your tow vehicle be adequately sized and equipped to tow and handle the GVWR of the RV you select. Review weights and rating of your tow vehicle and consult a competent advisor for questions or advice. Whether you are new to RVing or a veteran, get a feel for the performance of your tow vehicle before heading out on the roadways. When you tow an RV, you must drive differently than when you drive a single vehicle. Practice hooking up, driving, backing up and braking in a safe environment or seek out professional instruction. Jayco affixes a weight label to each RV which lists weight information for that vehicle. See specifications chart above.

Unloaded Vehicle Weight (UVW): Sometimes referred to as "Dry Weight," UVW means the typical weight of this trailer as built at the factory; The UVW, as used in product literature and other promotional materials, does not include cargo, fresh water, propane, options or dealer-installed accessories.

Gross Vehicle Weight Rating (GVWR): GVWR means the maximum permissible weight of the trailer, including the UVW plus personal items, all cargo, fluids, options and dealer-installed accessories. The GVWR is equal to or greater than the sum of the UVW and the CCC.

Cargo Carrying Capacity (CCC): CCC means the maximum weight of personal items, food, fresh water, propane, tools, other cargo and dealer-installed accessories that can be carried by the trailer. CCC is equal to or less than GVWR minus UVW. The addition of options will decrease the CCC.

Hitch Weight (HW): The hitch weight, as used in product literature and other promotional materials, does not include cargo, fresh water, propane gas, options or dealer-installed accessories. The addition of these types of items will either add to or subtract from the stated hitch weight.



OUTSIDE KITCHEN



355MBQS MAIN INTERIOR

Eagle's popular mid-bunk floor plan, featuring MODERN FARMHOUSE décor, mixes contemporary kitchen styling with highly usable, custom furniture for a warm and welcoming home away from home (optional 13 cu. ft. refrigerator and theater seating shown).



355MBQS MAIN INTERIOR



EAGLE BEDROOM



355MBQS MAIN INTERIOR

355MBQS KITCHEN



355MBQS MAIN INTERIOR



Raised-panel cabinetry, custom hardwood maple ribbon trim, and contrasting chocolate accents highlight the *Americian Tradition* décor. Huge pantry space and a large island kitchen provide great versatility while housing extra guests (shown with optional tri-fold sofa in the bunk room).

EAGLE FIFTH WHEEL FLOORPLANS

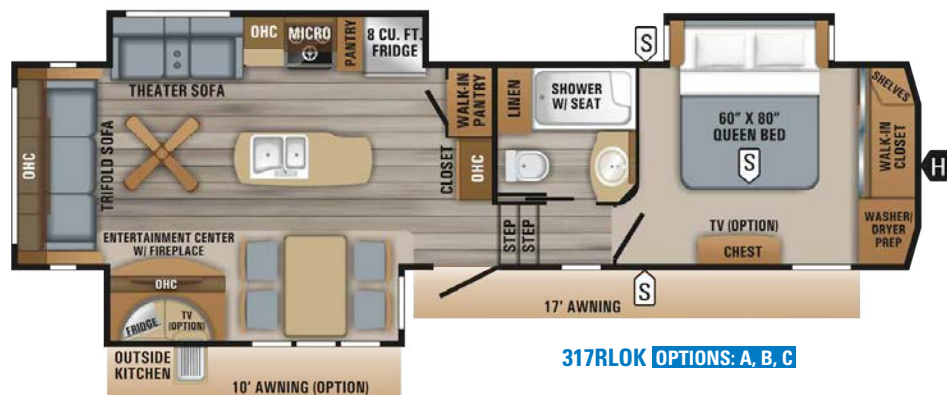

317RLOK OPTIONS: A, B, C

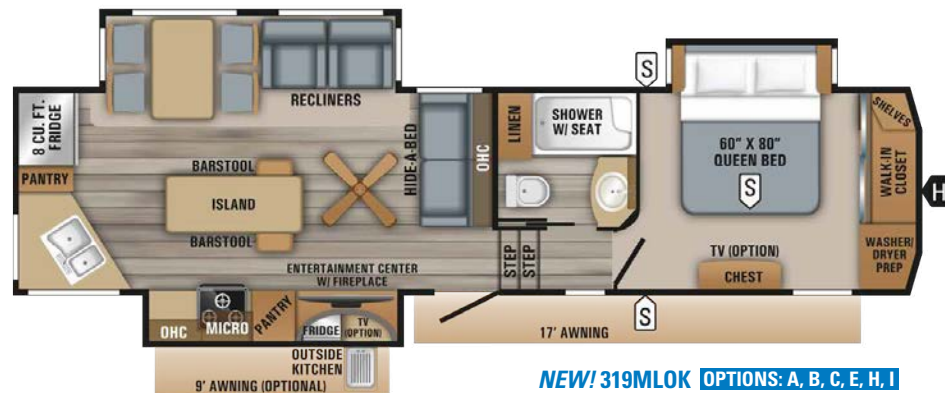

NEW! 319MLOK OPTIONS: A, B, C, E, H, I

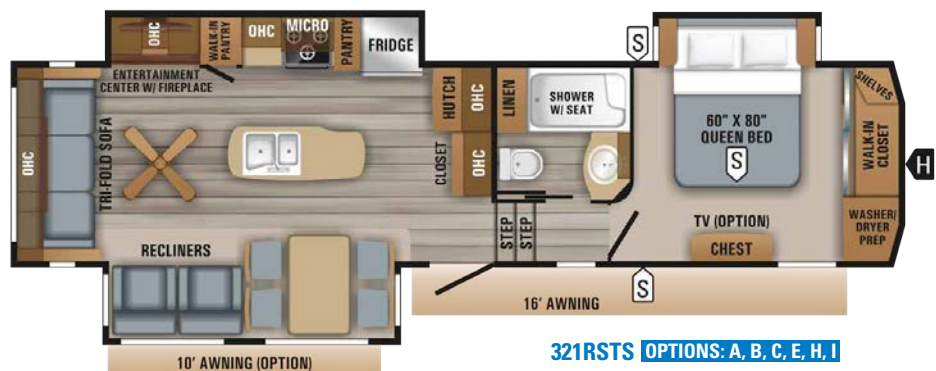

321RSTS OPTIONS: A, B, C, E, H, I

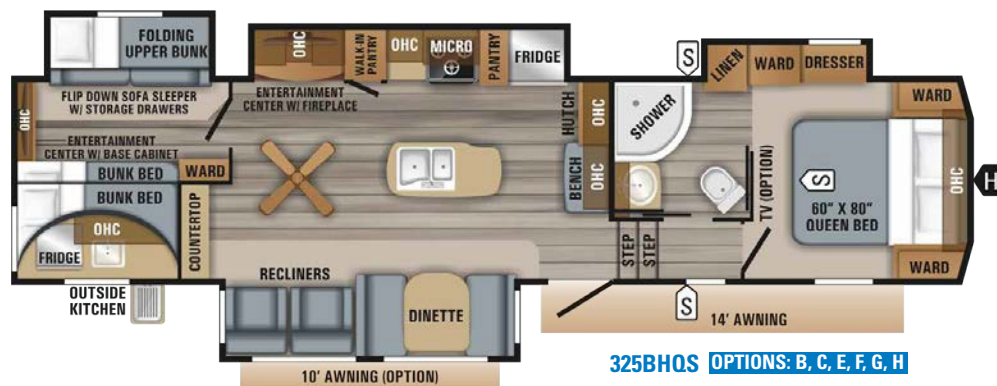

325BHQS OPTIONS: B, C, E, F, G, H

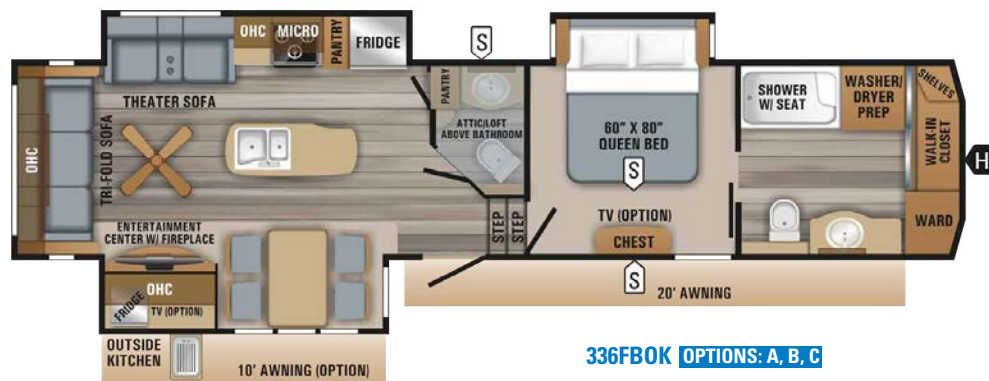

336FBOK OPTIONS: A, B, C

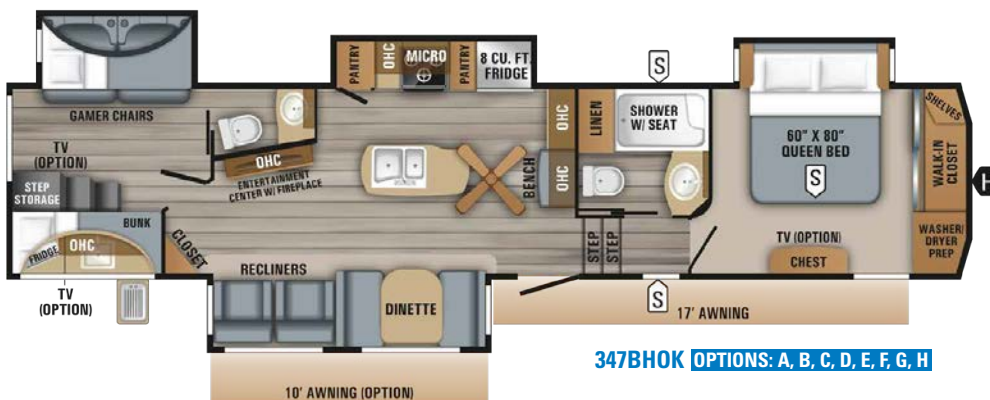

347BHOK OPTIONS: A, B, C, D, E, F, G, H

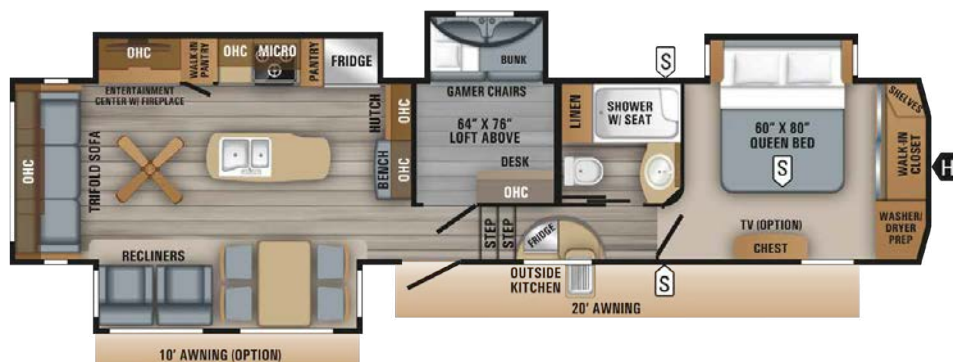

355MBQS OPTIONS: A, B, C, E, G, H, I

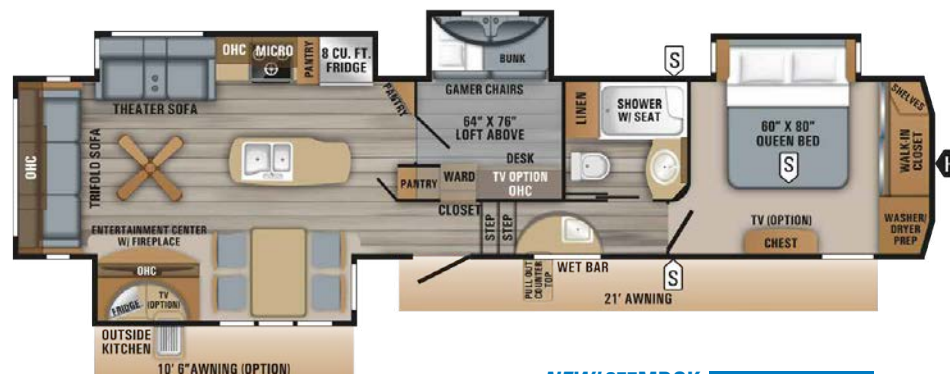

NEW! 357MDOK OPTIONS: A, B, C, G

LEGEND

	STORAGE	MICRO	MICROWAVE
	TRAILER HITCH	OHC	OVERHEAD CABINETS
LAV	BATHROOM SINK	FRIDGE	REFRIGERATOR
MED	MEDICINE CABINET	WARD	WARDROBE

OPTIONS

A	B	C	D	E	F	G	H	I
 KING BED	 13 CU. FT. FRIDGE OPTION	 21 CU. FT. RES. FRIDGE OPTION	 HIDE-A-BED	 THEATER SOFA	 TABLE & CHAIRS	 UPPER BUNK W/ TRI-FOLD SOFA	 PARTY SOFA WITH STOWABLE TABLE AND HIDE-A-BED	 DINETTE

EAGLE FIFTH WHEEL SPECS

FLOORPLAN	TOTAL EXTERIOR LENGTH	EXTERIOR TRAVEL LENGTH*	EXTERIOR WIDTH	EXTERIOR HEIGHT (WITH A/C)	EXTERIOR HEIGHT (WITH OPT. BEDROOM A/C)	INTERIOR HEIGHT (UPPER DECK)	UNLOADED VEHICLE WEIGHT	DRY HITCH WEIGHT	GROSS VEHICLE WEIGHT RATING	CARGO CARRYING CAPACITY	FRESH WATER CAPACITY (INCLUDES WATER HEATER)	GREY WASTE WATER CAPACITY**	BLACK WASTE WATER CAPACITY	SLEEP CAPACITY
317RLOK	36' 11"	36' 1"	8' 0"	13' 0"	13' 6"	6' 6"	10,680	1,983	12,995	2,315	81	87**	50	4
319MLOK	TBD	TBD	8' 0"	TBD	TBD	6' 6"	TBD	TBD	TBD	TBD	81	87**	50	4 - 6
321RSTS	37' 0"	36' 2"	8' 0"	13' 0"	13' 6"	6' 6"	10,605	2,065	12,700	2,095	81	87**	50	4 - 6
325BHQS	38' 8"	37' 10"	8' 0"	13' 4"	13' 6"	6' 6"	11,435	2,265	13,750	2,315	81	93.5**	50	8 - 10
336FBOK	40' 1"	39' 3"	8' 0"	13' 4"	13' 6"	6' 6"	11,290	2,128	13,750	2,460	81	87**	87**	4 - 5
347BHOK	41' 7"	40' 9"	8' 0"	13' 4"	13' 6"	6' 6"	12,300	2,402	14,850	2,550	81	95.5**	87**	8 - 10
355MBQS	42' 6"	41' 8"	8' 0"	12' 10"	13' 6"	6' 6"	12,155	2,505	14,995	2,840	81	87**	50	8 - 11
357MDOK	TBD	TBD	8' 0"	TBD	TBD	6' 6"	TBD	TBD	TBD	TBD	81	TBD	50	8 - 9

* Distance from the pinbox to the bumper; total exterior length may be longer.

** split tank

It is important for your safety and enjoyment that your tow vehicle be adequately sized and equipped to tow and handle the GVWR of the RV you select. Review weights and rating of your tow vehicle and consult a competent advisor for questions or advice. Whether you are new to RVing or a veteran, get a feel for the performance of your tow vehicle before heading out on the roadways. When you tow an RV, you must drive differently than when you drive a single vehicle. Practice hooking up, driving, backing up and braking in a safe environment or seek out professional instruction. Jayco affixes a weight label to each RV which lists weight information for that vehicle. See specifications chart above.

Unloaded Vehicle Weight (UVW): Sometimes referred to as "Dry Weight," UVW means the typical weight of this trailer as built at the factory; The UVW, as used in product literature and other promotional materials, does not include cargo, fresh water, propane, options or dealer-installed accessories.

Gross Vehicle Weight Rating (GVWR): GVWR means the maximum permissible weight of the trailer, including the UVW plus personal items, all cargo, fluids, options and dealer-installed accessories. The GVWR is equal to or greater than the sum of the UVW and the CCC.

Cargo Carrying Capacity (CCC): CCC means the maximum weight of personal items, food, fresh water, propane, tools, other cargo and dealer-installed accessories that can be carried by the trailer. CCC is equal to or less than GVWR minus UVW. The addition of options will decrease the CCC.

Hitch Weight (HW): The hitch weight, as used in product literature and other promotional materials, does not include cargo, fresh water, propane gas, options or dealer-installed accessories. The addition of these types of items will either add to or subtract from the stated hitch weight.

STANDARDS & OPTIONS

	Eagle HT	Eagle		Eagle HT	Eagle		Eagle HT	Eagle
Customer Value Package (Mandatory)			StrongholdVBL™ aluminum framed and vacuum bond laminated gel-coated fiberglass exterior walls (including rear wall and slide room end walls)	•	•	Bathroom skylight	•	•
Goodyear® Endurance® Tires (Made in U.S.A.! Load Range 'E')	CVP	CVP	Magnum Truss™ Roof System (strongest tested roof in the industry) with one piece, seamless DiFlex II material	•	•	LED backlit medicine cabinet with custom framed mirror (industry exclusive)	•	•
Dexter® Axles with Nev-R-Adjust® brakes and E-Z Lube® hubs	CVP	CVP	JaySMART™ (Safety Markers And Reverse Travel) LED Lighting (patent-pending)	•	•	Bathroom stone and glass tile backsplash	•	•
MORryde® CRE-3000™ rubberized suspension	CVP	CVP	High gloss, fiberglass front cap with built-in specialty LED lighting	•	•	Blue LED nightlights (bathrooms and bunkrooms)	•	•
15,000 BTU "Whisper Quiet" A/C	CVP	CVP	LED exterior lighting package	•	•	Porcelain foot flush toilet	•	•
Quick recovery gas/electric DSI water heater (17.8 gallon per hour)	CVP	CVP	Custom automotive-grade vinyl exterior graphics package	•	•	360 Siphon™ roof vent	•	•
Residential Queen (60 inch x 80 inch) Simmons® mattress with under-bed storage	CVP	CVP	Power service with detachable Powersmart™ LED shore power cord	30AMP	50AMP	Residential quilted bedspread and pillows	•	•
Electric patio awning with integrated LED lights	CVP	CVP	Dual 30 lb. propane bottles with auto regulator	•	•	Smart LED Reading Lights (with blue nightlight mode)	•	•
Custom machined aluminum rims	CVP	CVP	Sturdy, anti-slip aluminum entrance steps (Made in U.S.A.!) with blue LED light	•	•	CPAP prepped bedroom	•	•
Rear 2 inch receiver	CVP	CVP	Pass-through storage with Slam-latch™ baggage doors	•	•	Carbon monoxide and LP detector	•	•
LED HDTV with fully digital HDMI output	40"	50"	Digital TV antenna	•	•	Hardwood safety handrail on steps	•	•
12V AM/FM/CD/DVD/USB A/V system with Bluetooth® and HDMI®	CVP	CVP	Exterior marine-grade speakers	•	•	110V ceiling fan (FW only)	N/A	•
Stainless steel range with glass cover	CVP	CVP	Fully enclosed, LED lit universal docking center with quick connect outside shower, city water connection, and black tank flush	•	•	Options		
Stainless steel microwave with exhaust fan	CVP	CVP	Independent satellite and whole coach cable hookups	•	•	Canadian standards	OPT	OPT
Hidden hinges	CVP	CVP	Battery disconnect	•	•	Custom contemporary or traditional interior design (Industry First!)	OPT	OPT
Rain-proof EZ Breeze™ 350CFM bathroom power vent (patent pending, a class exclusive)	CVP	CVP	Water heater bypass	•	•	16" Goodyear Endurance tire upgrade	OPT	STD
Rooftop and ground solar prep by Go Power® (an industry first!)	CVP	CVP	Under-mounted spare tire	•	•	Freestanding rustic table with with leaf, storage, and 2 folding chairs	OPT	OPT
Upgraded friction hinge entrance door with XL grab handle	CVP	CVP	LP quick connect (outside grill prep)	•	•	Booth dinette (select models)	OPT	OPT
Wireless remote control system	CVP	CVP	Roof ladder	•	•	50 amp service with dual A/C ducting and 2nd A/C prep	OPT	LUX PKG
Keyed Alike™ lock system	CVP	CVP	"Industry's BEST" outside kitchen (select models)	•	•	2nd 15,000 A/C ducted in bedroom (requires 50 amp service)	OPT	OPT
Backup camera prep (rear observation)	CVP	CVP	Front electric landing gear	•	•	LED fireplace, 5,000 BTU electric heater (requires 50 amp service, N/A 29.5FBDS)	OPT	LUX PKG
Bluetooth speaker prep	CVP	CVP	Front electric tongue jack	N/A	N/A	Wall hugger theater seating (select models, STD on 322RLOK, 317RLOK, 336FBOK)	OPT	OPT
Luxury Package (Mandatory)			Front electric stabilizer jacks	N/A	N/A	2nd tri-fold hide-a-bed sofa (select models)	OPT	OPT
Soft close residential kitchen drawers	N/A	LUX PKG	Rear electric stabilizer jacks	OPT		LG HI-MACS® solid-surface kitchen countertops	OPT	LUX PKG
Integrated sound bar	N/A	LUX PKG	Standard Interior Equipment			Rear electric stabilizer jacks	OPT	STD
Washer/Dryer prep (N/A 325BHQS)	N/A	LUX PKG	Solid hardwood slide fascia	•	•	Electric auto-leveling system (in place of rear electric jacks)	OPT	OPT
LG® solid-surface kitchen countertop with bamboo sink cover and strainer	OPT	LUX PKG	Handcrafted and glazed doors, drawers and trim	•	•	King-sized Simmons® BeautyRest® mattress (N/A 325BHQS)	N/A	OPT
50 amp service with dual A/C ducts and second A/C prep	OPT	LUX PKG	Heavy-duty, 75 lb., full extension, steel ball-bearing drawer guides	•	•	13 cu. ft. gas/electric refrigerator (select models)	OPT	OPT
Frameless windows	OPT	LUX PKG	5/8 inch tongue and groove joined plywood floor decking	•	•	23 cu. ft. residential refrigerator + 1200W pure sine wave inverter	N/A	OPT
LED fireplace with 5,000 BTU electric space heater	OPT (SELECT MOD)	LUX PKG	Shaw® residential carpeting with R2X® stain guard	•	•	2nd power awning	N/A	OPT
Standard Exterior Equipment			Shaw residential carpet pad with R-value and sound dampening	•	•	MORryde "RPB" Rubber Pin Box	N/A	OPT
4-Star Handling Package:			IVC® Trekk™ "Wood Plank" vinyl flooring (standard minimal carpeting)	•	•	MORryde Orbital™ 90° Rubber Pin Box	OPT	N/A
• Dexter Axles with Nev-R-Adjust brakes and E-Z Lube hubs	•	•	LED interior lighting throughout	•	•	32 inch LED TV in master bedroom	N/A	OPT
• Wet bolt fasteners and bronze bushings			LED dimmer switches in main room and dining area	•	•	32 inch LED TV in bunk house (select models)	N/A	OPT
• Upgraded MORryde suspension			Central command center with built-in tank monitoring	•	•	32 inch LED TV in outside kitchen (select models)	OPT	OPT
• Upgraded Goodyear tires			Tri-fold hide-a-bed sofa with residential sleep surface (select models)	•	•	Rolling island pantry (322RLOK, 338RETS)	N/A	N/A
HELIX Cooling System™ (industry exclusive):			Swivel glider recliners (select models)	•	•	Wireless backup/review camera kit	OPT	OPT
• Exterior-mounted 15,000 BTU "Whisper Quiet" A/C unit	•	•	Stainless steel kitchen sink	•	•	Sani-con® Turbo waste management system	OPT	OPT
• Jayco exclusive insulated duct design			Brushed nickel kitchen faucet with pullout sprayer	•	•	Dry Camping Package (gen prep and extra propane capacity, select models)	OPT	OPT
• Directional and closeable A/C vents			8 cu. ft. gas/electric refrigerator with freezer	•	•	Frameless windows	OPT	LUX PKG
• Larger return air vents with user accessible filters			Dual USB charging ports (kitchen and bedroom)	•	•	Frameless dual pane tinted safety glass windows	OPT	OPT
Climate Shield™ zero-degree-tested weather protection:			12V charging station	•	•			
• Fully enclosed and heated underbelly (ducted)			Extra 110V power outlets in kitchen and slide rooms	•	•			
• High BTU output furnace								
• Double layer fiberglass batt insulation in ceiling and floor	•	•						
• Double sided radiant barrier insulation (roof, floor, cap, and slide room floors)								
• PEX plumbing								
I-class™ cambered, structural steel I-beam frame	•	•						

CVP - Customer Value Package	N/A - Not Available	STD - Standard
OPT - Optional	• - Standard	
LUX PKG - Luxury Package		



KEYED-ALIKE LOCK SYSTEM



HARDWOOD SLIDE ROOM FASCIA



INDUSTRY EXCLUSIVE LED BACKLIT MIRROR

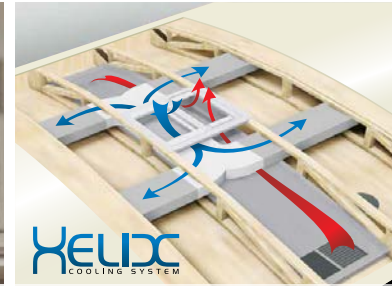

HELIX WHISPER QUIET COOLING SYSTEM WITH JAYCO-EXCLUSIVE DUCT DESIGN



LG SOLID-SURFACE KITCHEN COUNTERTOP WITH BAMBOO SINK COVER AND STRAINER



MORRYDE CRE3000 RUBBERIZED SUSPENSION



RESIDENTIAL SIMMONS MATTRESS



360 SIPHON ROOF VENT



SHAW RESIDENTIAL CARPETING WITH R2X STAIN GUARD, R-VALUE AND SOUND DAMPENING



POTS AND PANS DRAWER WITH 75 LB. CAPACITY



12V 3-ZONE FURRION® AV SYSTEM WITH HDMI AND BLUETOOTH



INTEGRATED REAR 2-INCH RECEIVER HITCH



OPTIONAL AUTO-LEVELING UPGRADE FEATURES WI-FI REMOTE CONTROL VIA APP



OPTIONAL DRY CAMPING PACKAGE WITH GEN PREP



GO POWER! GROUND AND ROOFTOP SOLAR PREP



OPTIONAL FURRION BACKUP CAMERA SYSTEM



OPTIONAL SANI-CON TURBO WASTE MANAGEMENT SYSTEM



FRAMELESS WINDOWS (OPTIONAL ON HT)

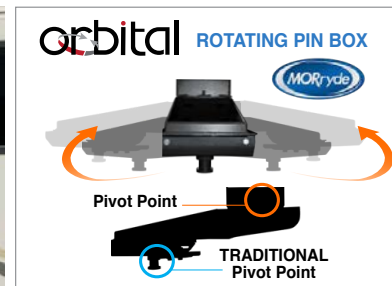

OPTIONAL MORRYDE ORBITAL PIN BOX (EAGLE HT FIFTH WHEEL ONLY)



OPTIONAL MORRYDE "RPB" RUBBER PIN BOX (EAGLE FIFTH WHEEL ONLY)

1 4 STAR HANDLING PACKAGE

- ★ **DEXTER AXLES WITH NEV-R-ADJUST BRAKES**
The Benchmark of the trailer industry!
- ★ **DEXTER WET BOLT FASTENERS AND BRONZE BUSHINGS**
Resists the wear-and-tear of towing.
- ★ **MORRYDE RUBBERIZED SUSPENSION SYSTEM**
Better absorbs and isolates road shock.
- ★ **GOODYEAR ENDURANCE TIRES**
Made in the U.S.A. and featuring the patented Durawall® technology.

* Upgrade to our 5-star handling package by adding an optional MORryde pin box



- 2 **STRONGHOLD VBL™** Eagle flaunts the industry's strongest vacuum-bonded lamination. We laminate each sidewall, rear wall, slide room wall, and slide room end walls for 16 minutes at 144 tons of pressure, then use aluminum strips to conceal unsightly vertical lines.
- 3 **HELIX Whisper Quiet Cooling System:** standard 15,000 BTU AC with specialty ducts dramatically reduces noise while increasing efficiency
- 4 **PIN BOX OPTIONS:** MORryde RPB or Orbital specialty pin box upgrades available
- 5 **BETTER BUILDING MATERIALS:** Tongue and groove joined plywood is used to deck both the roof and the floor
- 6 **JaySMART™ LIGHTING:** Jayco's exclusive, patent-pending S.M.A.R.T. (Safety Markers And Reverse Travel) lighting increases safety and visibility

7 MAGNUM ROOF SYSTEM

JAYCO'S ROOF **VS** OTHER ROOFS
4,500 POUNDS
ON A JAYCO ROOF VS. OTHER ROOFS

50% Stronger!



CLIMATESHIELD

Extend your camping season with the Jayco Climate Shield.

It protects against extreme heat and extreme freezing—even in temperatures as high as 100 degrees or as low as zero degrees (Fahrenheit).*

LIVING ROOM

0°F 70°F
100°F 69°F

KITCHEN

0°F 69°F
100°F 70°F

BATHROOM

0°F 71°F
100°F 68°F

HOLDING TANK

0°F 60°F
100°F 72°F

BEDROOM

0°F 71°F
100°F 71°F

*Jayco tested fifth wheels in zero degrees F and 100 degrees F weather over an extended period of time in a controlled environment, and all functions of the coach were fully operational. Testing was done in a completely controlled environment; therefore, temperatures during testing may not represent actual temperatures in nature and cannot account for elements such as wind or moisture. In actual use, unit may not perform as well. Supplier of cooling components does not guarantee anything better than 20 degrees difference from ambient temperature. In addition, outside components are subject to freezing and require steps to properly insulate. Jayco's limited warranty does not cover damage caused by freezing. To learn more about Climate Shield and testing done by Jayco, visit www.jayco.com.



Meet your Jayco Dealer _____

Travel with Confidence _____

Follow Jayco
#Jayco50



Jayco, Inc. | P.O. Box 460 | Middlebury, IN 46540 RVIA

Jayco reserves the right to make changes and to discontinue models without notice or obligation. Photography may show optional equipment or props used for decoration purposes only. RVs built for sale in Canada may differ to conform to Canadian codes. JAYCO and the JAYCO BIRD IN FLIGHT are registered trademarks of Jayco, Inc. Printed in USA 40K RB 7/18 © 2018 Jayco, Inc. 274881



At Jayco, we build our RVs to handle every adventure, then back them with our industry-leading 2-year limited warranty. We, with support from our select partners, have you covered for **2 camping seasons**. That's **730 days**. You won't find a better warranty in the business, because the only strings we attach are those that deliver the ultimate in reliability. That's the Jayco difference. So go explore. For a copy of our 2-year limited warranty with complete terms and conditions, please contact your local Jayco dealer.