

CAMEO

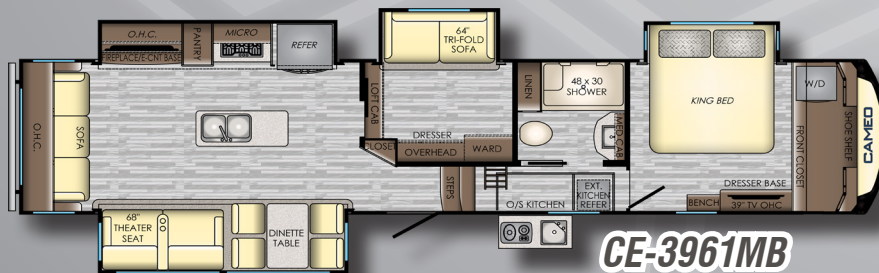

CROSSROADS
Recreational Vehicles

FLOORPLANS & SPECS

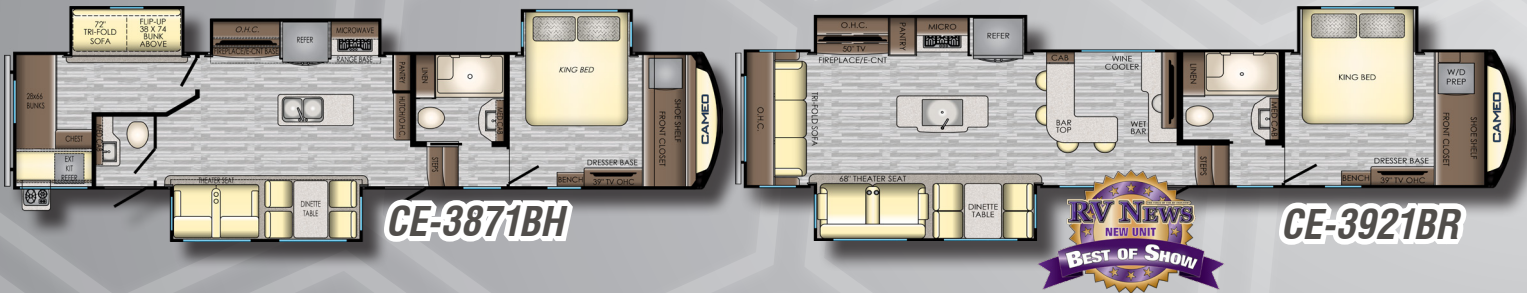

MODEL	CE-3201RL	CE-3701RL	CE-3801RK	CE-3871BH	CE-3921BR	CE-3961MB
DRY WEIGHT	11028	12246	12341	13168	12050	13106
HITCH WEIGHT	2344	2562	2510	2562	2334	2504
LENGTH	35' 7"	40' 1"	40' 3"	42' 0"	41' 8"	42' 6"
EXT. HEIGHT W/ A/C	13' 1"	13' 3"	13' 3"	13' 3"	13' 3"	13' 3"
FRESH WATER	64 Gal	64 Gal	60 Gal	64 Gal	64 Gal	60 Gal
BLACK WATER	44 Gal	44 Gal	44 Gal	89 Gal	44 Gal	44 Gal
GRAY WATER	44 Gal	44 Gal	89 Gal	44 Gal	89 Gal	89 Gal

*SEE WEBSITE FOR ADDITIONAL SPECS



CE-3801RK Bedroom w/ Windshield



Gourmet Kitchen includes Stainless Steel Appliances, & a Pullout Faucet



5 Function Tru-Sit Thomas Payne Massage Theatre Seating & Cup Holders



CE-3921BR Kitchen and Bar



Dual Flat Front 5,300BTU Fireplaces



Step Above Entry Steps

Cameo brings you twice the fun! Two TV's, two Fireplaces, two 15K A/C Units, two Awnings and much more, come standard with every Cameo. Stainless Steel Gourmet Kitchens and solid surface countertops make you feel right at home, while the Thomas Payne Theater Seats and the King size mattress provide next level comfort. New LED Accent lights throughout provide ambient lighting for every situation. The blue accented exterior, generator prep, and new Step Above entry steps help each Cameo stand out from the crowd. Take your camping experience to the next level with Cameo.

STANDARDS AND OPTIONS

STANDARDS

CABINETS

- Hardwood Cabinet Doors
- Full Extension 70lb Ball Bearing Drawer Glides
- Hidden Hinges

EXTERIOR DESIGN

- Wireless Backup Camera Prep
- Aerodynamic Profile
- Increased Turning Radius
- LED Hitch Pin Light for Easy Hookup
- Automotive Windshield - *VBM

EXTERNAL DOCKING STATION

- Exterior Hot/Cold Shower
- City Water Hook Up
- Black Tank Flush System
- Cable TV & Satellite Hook-Ups
- All Tank Pull Handles (VBM)
- Winterization Valve
- 110v Outlet

EXTERNAL STORAGE

- Slam Latch Baggage Doors w/ Magnetic Catches
- Pass Through Storage
- Additional Utility Storage
- Bauer Keyed Alike System Throughout

FLOOR CONSTRUCTION

- 5/8" Floor Decking
- 3" Aluminum Framing - 11" on Center
- Seamless Residential Heat Ducts
- Enclosed & Heated Water Lines

WALL CONSTRUCTION

- 2" Laminated Sidewall
- High Gloss Gel Coat Fiberglass Exterior
- EGS Steel Backers for Cabinets

ROOF CONSTRUCTION

- Double Truss at each A/C
- 3/8" Roof Decking
- Full Walk-on Roof
- 5" Radius Metal Roof Cap
- One Piece Alpha Ply II Roof Material w/ 12 Yr Warranty

FRAME/TIRES/SUSPENSION

- 16" F-Range Tires w/ Full Size Spare
- 8 Lug Aluminum Rims
- 2" Self Adjusting Brakes
- 6 Point Hydraulic Auto Level
- 12" Frame (10" on 3201RL)
- 7,000lb Axles
- Solid Step Entry Step
- 2" Receiver Hitch
- MORryde CRE 3000 Suspension w/ Wet Bolt
- Roto Flex Pin Box

TANKS/LP GAS SYSTEM

- 60 Gallon Fresh Water
- 84 Gallon Grey Water (VBM)
- 42 Gallon Black Water (VBM)
- (2) 30 lb LP Bottles w/ Auto Change

POWER

- Solar Prep
- Progressive 75 Amp/12V DC Converter
- 50 Amp Detachable Power Cord
- Dual Battery Box w/ Disconnect
- 110V Exterior Receptacle
- Battery Disconnect Switch
- 1,000 Watt Inverter w/ Residential Refer
- Generator Prep

HEAT & A/C

- Seamless One Piece in-Floor Duct
- 35,000 BTU Furnace
- Heat & A/C Duct in Bathroom
- 15,000 BTU A/C in Living Room & Kitchen
- 15,000 BTU A/C in Bedroom & Bathroom

APPLIANCES

- 18 ft³ Residential Refrigerator
- 12 ft³ Gas/Electric Refrigerator
- 30" OTR Microwave w/ Exhaust Fan
- 10 Gallon Gas/Electric DSI Water Heater
- Gourmet Kitchen

INTERIOR/LIGHTING

- 4" Round LED Accent Lights
- Pendant Kitchen Light w/ Ceiling Accents
- Decorative Dinette Fixture

KITCHEN

- Solid Surface Countertop
- Stainless Steel Sink Basin
- Pots & Pans Storage
- Large Residential Pantry
- High Rise Faucet w/ Pull Out Spray Hose
- Max Air Fan

LIVING ROOM

- 5 Function Tru-Sit Heated & Massage Theater Seating w/ Drink Holders
- Multiple USB Ports

BEDROOM

- King Bed
- Exclusive Dual Opposing Bedroom Slides - "Master Suites" (3631RL, 3801RK)
- Spacious Walk in Closet w/ Built in Shelving
- Closet Prepped for W/D

BATHROOM

- 48" Shower w/ Glass Doors
- Porcelain Foot Flush Toilet
- Large Mirrored Medicine Cabinet
- Domed Skylight in Shower
- Large Linen Closet

TWICE IS NICE PACKAGE:

- **DUAL** Large Exterior Scare Lights
- **DUAL** Awnings with LED Accent Lights
- **DUAL** USB Ports Minimum of 2 in Each Room
- **DUAL** Fireplaces (Living & Bedroom)
- **DUAL** HDTV's (Living & Bedroom)
- **DUAL** Power Vent Fans
- 2" Receiver Hitch

DECORS



*VBM - Varies by Model

www.crossroadsrv.com • 1140 W. Lake St Topeka, IN 46571 • (260) 593 - 3850

DISCLAIMER: Product information is as accurate as possible as of the date of publication of this brochure. All features, floor plans, and specifications in this brochure are subject to change without notice. Please also consult CrossRoads' web site at www.crossroadsrv.com for more current product information and specifications. Tow Vehicle Disclaimer. CAUTION: Owners of CrossRoads recreational vehicles are solely responsible for the selection and proper use of tow vehicles. All customers should consult with a motor vehicle manufacturer or their dealer concerning the purchase and use of suitable tow vehicles for CrossRoads products. CrossRoads disclaims any liability or damages suffered as a result of the selection, operation, use or misuse of a tow vehicle. CROSSROADS' LIMITED WARRANTY DOES NOT COVER DAMAGE TO THE RECREATIONAL VEHICLE OR THE TOW VEHICLE AS A RESULT OF THE SELECTION, OPERATION, USE OR MISUSE OF THE TOW VEHICLE. REFERENCE CROSSROADS RV COMPANY OWNERS MANUAL FOR LIMITED WARRANTY DETAILS. *Length is defined as the distance from the centerline of hitch pin/coupler to rear bumper of trailer.



Jan. 2019