



PRISM ELITE By Coachmen

PRISM
ELITE
By Coachmen



CoachmenRV.com

PRISM ELITE: JOIN THE COACHMEN LEGACY WITH UPSCALE LUXURY COMBINED WITH MERCEDES BENZ DRIVEABILITY.

BUILT ON THE MERCEDES-BENZ 3500 SPRINTER CHASSIS, THE PRISM ELITE OFFERS BOTH LUXURY AND DRIVEABILITY. IDEAL FOR EXTENDED TRIPS UP THE COAST OR ACROSS THE STATE, OR SIMPLY TRANSPORTING YOUR FAVORITE SOCCER PLAYERS TO THE WEEKEND TOURNAMENT. THIS MULTI-USE TOURING VEHICLE PROVIDES UNIQUE STYLING AND AMENITIES, INCLUDING INDUSTRY-LEADING WAREHOUSE STORAGE, AN AERODYNAMIC, STYLISH MOLDED FIBERGLASS FRONT CAP, AND AN EXTERIOR ENTERTAINMENT CENTER. THE PRISM ELITE IS THE PERFECT COMBINATION OF EXPERIENCE, DEPENDABILITY, AND VALUE FROM THE PREMIER CLASS C MOTORHOME BUILDER COUPLED WITH THE PRESTIGE OF THE MERCEDES-BENZ SPRINTER DIESEL CHASSIS.



CROSSFLEX™ WIFIRANGER

Even Cool™
By Coachmen

LAMILUX

SuperLite
Azdel Substrate
Fiberglass



EXTERIOR FEATURES

- Mercedes-Benz Sprinter Chassis**
 Reliable and fuel efficient, the Mercedes-Benz Sprinter Chassis has set the standard for driveability and standard equipped safety standards
- 2" Vacuum Bonded Laminated Sidewalls**
 Thick sidewalls utilizing this bonding method will ensure a lifetime of structural integrity
- Lamilux 4000 Color-Infused Fiberglass**
 The Industry leading thickness of Lamilux fiberglass provides a high gloss finish for years to come
- Azdel SuperLite Substrate with Aluminum Framing**
 Made in America, dry rot resistant, higher R-Values, and formaldehyde free. Superior substrate to traditional luan backing
- CrossFlex Roof/Membrane**
 Synthetic thermoplastic roof material provides a three times increase in puncture resistance compared to competition
- Solar Prep**
 Each Prism Elite is pre-wired for a solar panel. An available panel allows you the freedom to place the panel anywhere the sun shines, even when you want your motorhome is in the shade of a tree
- Armless Awning**
 Easy to operate providing quick and effortless operation without the low hanging leg of traditional awnings
- Molded Fiberglass Front Cap w/Front Window**
 A one-piece fiberglass cap provides an aerodynamic look and drive, durability, and provides additional storage or sleeping space
- Curved Wing Walls**
 Staying with the theme of aerodynamics, the Prism Elite wing walls compliment the cap while it transitions the Mercedes-Benz Chassis to the body of your coach
- Rear Fiberglass Cap**
 Stylish look, providing no exposed seams and adding structural support to the construction
- Integrated Fiberglass Running Boards**
 Not only providing an easy step in or out of the chassis cab door, but doing it with a high end look and feel
- Electronic Step at Entry Door**
 The retractable step provides a comfortable height for anyone to step in or out of your coach
- Exterior Entertainment Center**
 Standard with an outside TV giving you the freedom to watch your favorite movie or sporting event while sitting outside under your awning in the fresh air
- Exterior Storage**
 Industry leading exterior storage provides you space for the necessities and fun items to make the trip that much more fun
- Propane Capacity**
 All Prism Elites are standard with an 85lb propane tank giving you the convenience of an extra-long stay...the most for any Mercedes-Benz Sprinter Chassis
- Fresh Water Capacity**
 As much as 38 gallons of fresh water, making it a class-leader

FULL BODY PAINT OPTIONS



GLACIER



MIDNIGHT



SCARLET



CHOCOLATE



LUXURY BY

24EF SHOWN WITH CRYSTAL DECOR

DESIGN

INTERIOR FEATURES

- **Unique Floorplans**
Functional floorplans with the customer's travel needs in mind
- **Large High Gloss Epoxy Countertops**
Counter space that is seamless, lightweight, and durable
- **Large Closets**
Best in class closet space for maximizing organization options
- **Additional Pedestal Table**
Extra table for optional seating, dining, or entertaining
- **Upgraded Cabinetry**
Cabinets with a refined look and modern appeal



24EF SHOWN WITH CRYSTAL DECOR



24EF SHOWN WITH CRYSTAL DECOR



24EF SHOWN WITH CRYSTAL DECOR

INTERIOR FEATURES

- Even Cool A/C Ducting System**
 Insulated duct work system with mold inhibitor, creates a more efficient and consistent cooling with superior air quality
- Wi-Fi Ranger Sky4**
 Boosts weak Wi-Fi signal, secure network with Safesurf VPN, single login for all devices, auto-reconnect and LTE data ready
- Cabover Bunk**
 Large cabover bunk allows for more sleeping and storage capabilities while maintaining an aerodynamic and automotive appeal on the outside
- Large Sliding Windows**
 Allows for more natural air flow and ventilation
- Slide-in-Slide Entertainment Center (24EF Only)**
- Day/Night Window Shades**
 Provides a variety of shading options to meet your needs of comfort and privacy
- Soft Touch Ceiling**
 Padded ceiling absorbs sound for a more comfortable living atmosphere and is easier to clean



CRYSTAL



SOAPSTONE

DECOR

FLOORPLANS

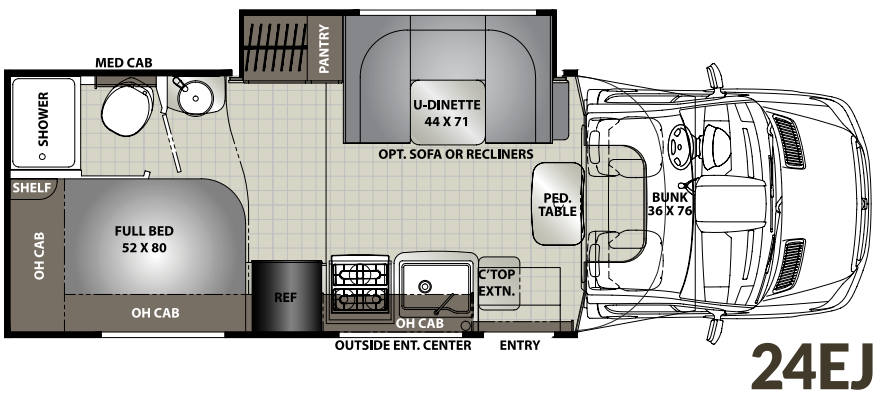
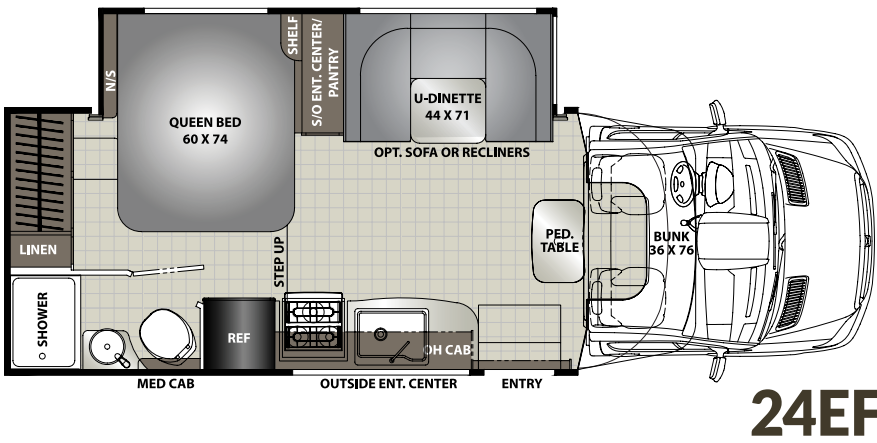
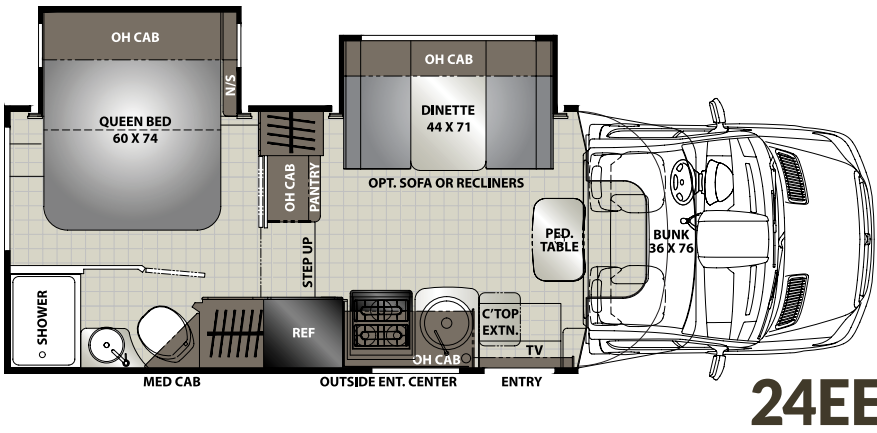

Optional Sofa



Optional Recliner

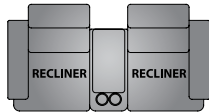

Standard Driver/Passenger Swivel Seats



Coachmen Owner "Digital Kit" App

Now you can have your Owner's Manual with you wherever you are. Download our FREE App from the App Store or Google Play and you'll have the information right at your fingertips.

PRISM ELITE SPECIFICATIONS

	24EE	24EF	24EJ
CHASSIS	3500 Sprinter	3500 Sprinter	3500 Sprinter
ENGINE	V6 3.0L	V6 3.0L	V6 3.0L
HORSE POWER	188	188	188
TORQUE	325	325	325
WHEEL BASE	170"	170"	170"
GVWR (LBS.)	11,030	11,030	11,030
GCWR (LBS.)	15,250	15,250	15,250
UVW (APPROX. LBS.)	TBD	10,025	9,709
CCC (APPROX. LBS.)	TBD	1,005	1,321
GAWR FRONT (LBS.)	4,410	4,410	4,410
GAWR REAR (LBS.)	7,720	7,720	7,720
INTERIOR HEIGHT	6' 9"	6' 9"	6' 9"
EXTERIOR WIDTH	7' 10"	7' 10"	7' 10"
EXTERIOR HEIGHT (WITH A/C)	10' 9"	10' 9"	10' 9"
EXTERIOR LENGTH (WITH HITCH)	24' 11"	24' 11"	24' 11"
HITCH WEIGHT (LBS.)	5,000	5,000	5,000
FUEL CAPACITY (GAL.)	26	26	26
LP CAPACITY (LBS.)	85	85	85
FRESH WATER CAPACITY (GAL.)	29	35	30
WATER HEATER CAPACITY (GAL.)	6	6	6
GREY TANK CAPACITY (GAL.)	32	32	32
BLACK TANK CAPACITY (GAL.)	35	35	32
EXTERIOR STORAGE (CU. FT.)	26	37	46
AWNING LENGTH	14'	14'	14'

GVWR (Gross Vehicle Weight Rating) is the maximum permissible weight of the unit when fully loaded. It includes all weights, inclusive of all fluids, occupants, cargo, optional equipment and accessories. For safety and product performance do NOT exceed the GVWR.

GCWR (Gross Combined Weight Rating) is the maximum permissible loaded weight of your motor home and any towed trailer or towed vehicle. Actual GCWR of this vehicle may be limited by the sum of the GVWR and the installed hitch receiver maximum capacity rating; see hitch rating label for detail.

GAWR (Gross Axle Weight Rating) is the maximum permissible weight, including cargo, fluids, optional equipment and accessories that can be safely supported by each axle.

UVW (Unloaded Vehicle Weight) * is the typical weight of the unit as manufactured at the factory. It includes all weight at the unit's axle(s), including full fuel, all fluids and LP Gas. The UVW does not include cargo, fresh potable water, additional optional equipment or dealer installed accessories.

*Estimated Average based on standard build optional equipment.

CCC (Cargo Carrying Capacity) ** is the amount of weight available for fresh potable water, cargo, passengers, additional optional equipment and accessories. CCC is equal to GVWR minus UVW. Available CCC should accommodate fresh potable water (8.3 lbs per gallon). Before filling the fresh water tank, empty the black and gray tanks to provide for more cargo capacity.

** Estimated average based on standard build optional equipment

Each Coachmen motorhome is weighed at the manufacturing facility prior to shipping. A label identifying the unloaded vehicle weight of the actual unit and the cargo carrying capacity is applied to every Coachmen motorhome prior to leaving our facilities.

The load capacity of your unit is designated by weight, not by volume, so you cannot necessarily use all available space when loading your unit.

Actual towing capacity is dependent upon your particular loading and towing circumstances, which includes the GVWR, GAWR and GCWR as well as adequate trailer brakes. Please refer to the Operator's Manual of your vehicle for further towing information.

All information contained in this brochure is believed to be accurate at the time of publication. However, during the model year, it may be necessary to make revisions and Coachmen reserves the right to make all such changes without notice, including prices, colors, materials, equipment and specifications as well as the addition of new models and the discontinuance of models shown in this brochure. Therefore, please consult with your Coachmen dealer and confirm the existence of any materials, design or specifications that are material to your purchase decision. 2/19

©Copyright 2019 Coachmen RV a Division of Forest River Inc. - All Rights Reserved.

YOUR PRISM ELITE DEALER

CUSTOMER SATISFACTION



www.ForestRiverBuyLocal.com



FREE MEMBERSHIP
www.coachmenowners.com

24/7 EMERGENCY ROADSIDE ASSISTANCE WITH VEHICLE PURCHASE*

TOWING	WINCH-OUT
JUMP-STARTS	MOBILE MECHANIC
TIRE CHANGES	TECHNICAL
FLUID DELIVERY	SUPPORT
LOCKOUT	DEALER LOCATOR
SERVICE	SERVICES



*VALID FOR 1 YEAR FROM DATE OF PURCHASE



Learn More
Scan this barcode using a QR Reader on your smart phone to learn more about Forest River.



A Berkshire Hathaway company.



Coachmen RV, a Division of Forest River, Inc.,
A Berkshire Hathaway Company

423 N. Main St., P.O. Box 30, Middlebury, IN 46540

To learn more about Coachmen RV and our products and see how Coachmen is making the easy life easier, visit www.coachmenrv.com