

NORTHWEST EDITION

SALEM

SALEM
CRUISE
LITE





263BHXL

SHOWN IN OYSTER
SOME FEATURES HAVE LIMITED AVAILABILITY





171RBXL

SHOWN IN MINERAL



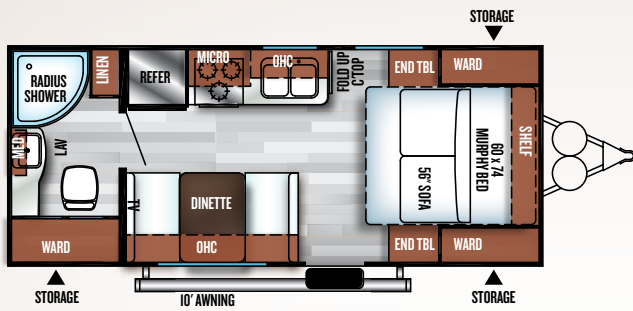

171RBXL

DRY WEIGHT:
4092

EXT. LENGTH:
23'

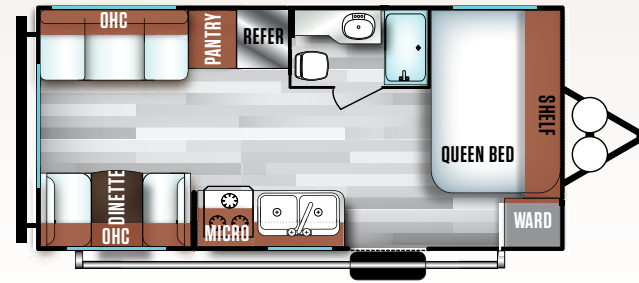

191RDXL

DRY WEIGHT:
4249

EXT. LENGTH:
23' 4"

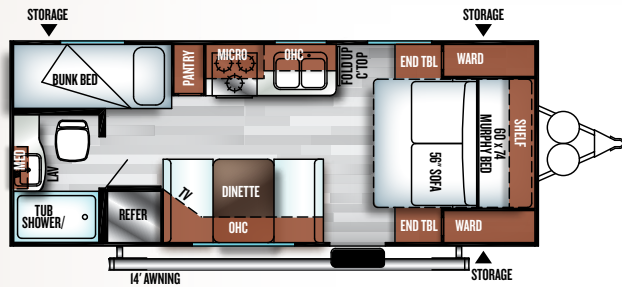

201BHXL

DRY WEIGHT:
4314

EXT. LENGTH:
24' 2"

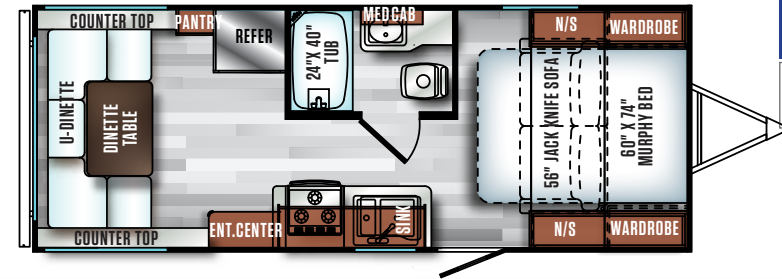

207RUXL

DRY WEIGHT:
4423

EXT. LENGTH:
25'

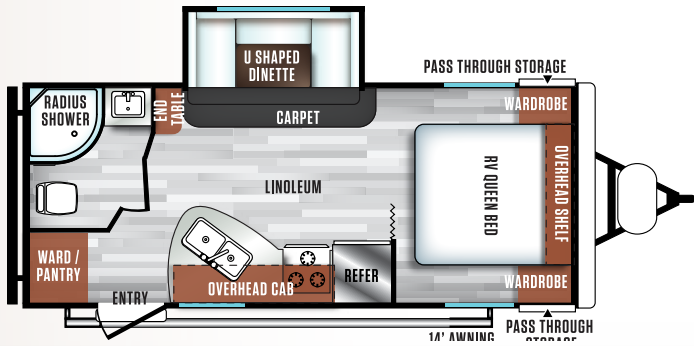

210RBXL

DRY WEIGHT:
4830

EXT. LENGTH:
25' 2"

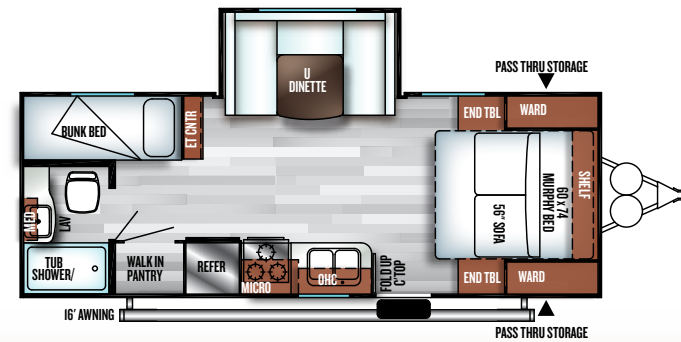

230BHXL

DRY WEIGHT:
4985

EXT. LENGTH:
26' 3"

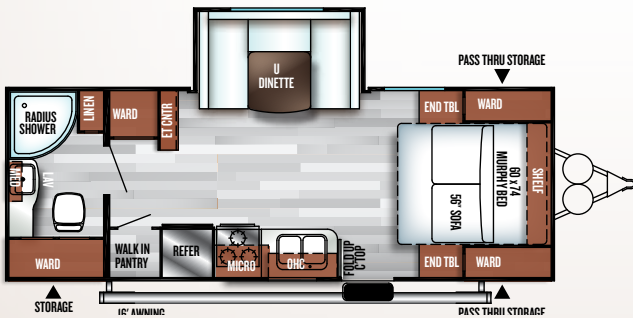

233RBXL

DRY WEIGHT:
5278

EXT. LENGTH:
26' 3"

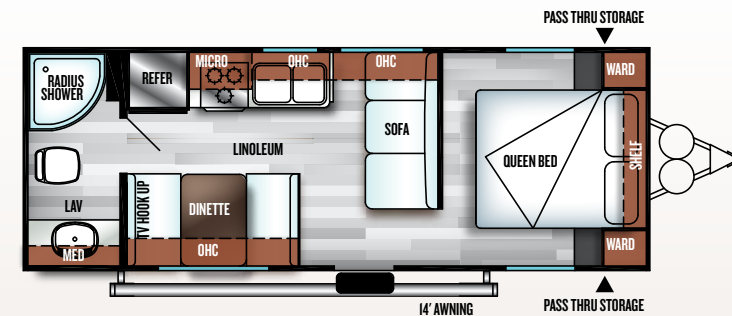

241QBXL

DRY WEIGHT:
4624

EXT. LENGTH:
26' 10"

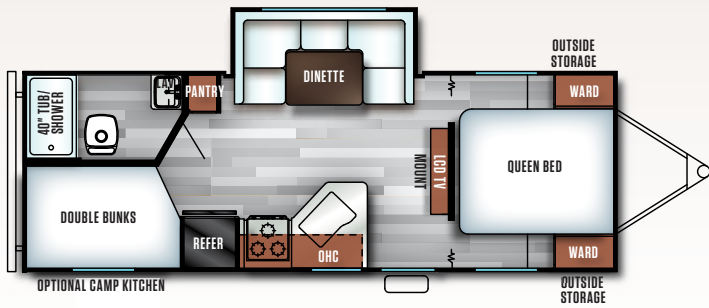

243BHX

DRY WEIGHT:
5492

EXT. LENGTH:
28' 2"

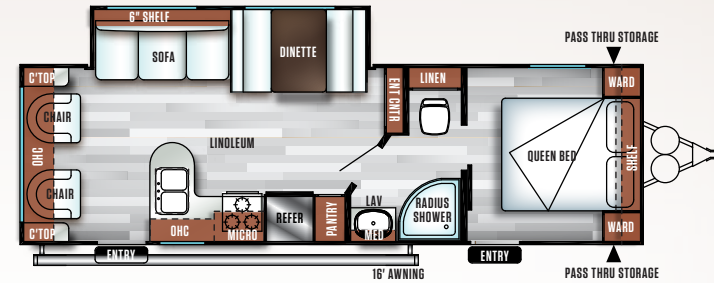

254RLX

DRY WEIGHT:
5793

EXT. LENGTH:
30' 8"

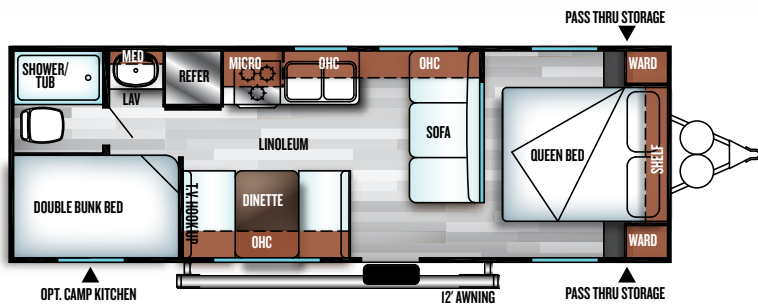

261BHX

DRY WEIGHT:
4448

EXT. LENGTH:
28' 7"

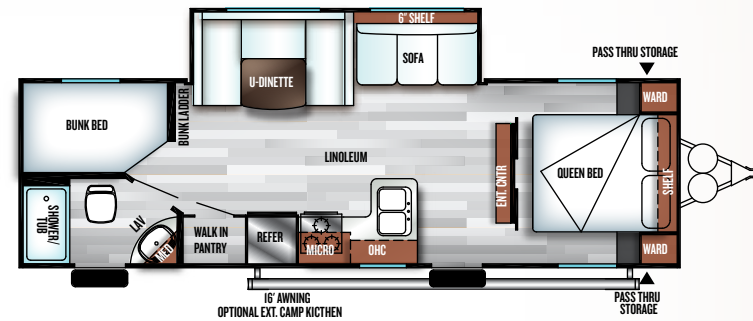

263BHX

DRY WEIGHT:
5866

EXT. LENGTH:
31' 11"

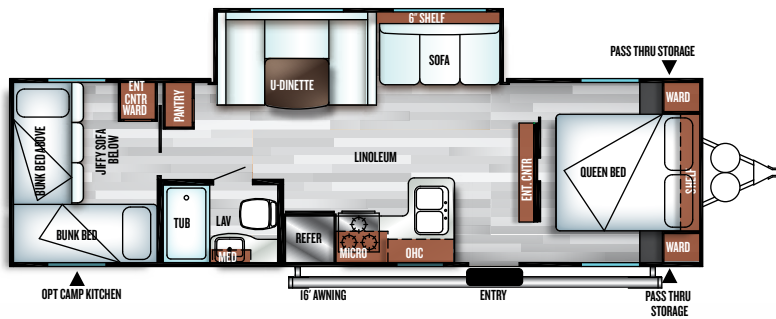

273QB

DRY WEIGHT:
6162

EXT. LENGTH:
33' 8"

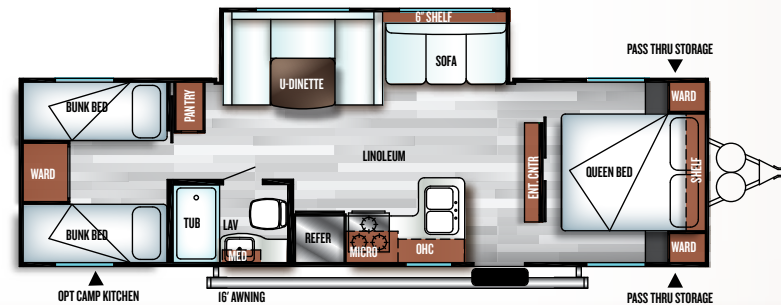

282QB

DRY WEIGHT:
6458

EXT. LENGTH:
33' 4"

	171RBXL	191RDXL	201BHX	207RUXL	210RBXL	230BHX	233RBXL	241QBXL	243BHX	254RLXL	261BHX	263BHX	273QHXL	282QBXL
GVWR	7,522	7,465	7,544	7,489	7,500	7,655	7,596	7,470	7,566	7,630	7,500	7,635	7,702	7,688
HITCH WEIGHT (LBS.)	522	465	544	489	500	655	596	470	566	630	500	635	702	688
UVW (LBS.)	4,092	4,249	4,314	4,423	4,830	4,985	5,278	4,624	5,492	5,793	4,448	5,866	6,162	6,458
CCC (LBS.)	3,430	3,216	3,230	3,066	2,670	2,670	2,318	2,846	2,074	1,837	3,052	1,769	1,540	1,230
EXTERIOR LENGTH	23' 0"	23' 4"	24' 2"	25' 0"	25' 2"	26' 3"	26' 3"	26' 10"	28' 2"	30' 8"	28' 7"	31' 11"	33' 8"	33' 4"
EXTERIOR HEIGHT	10' 1"	10' 3"	10' 1"	10' 1"	10' 3"	10' 3"	10' 3"	10' 1"	10' 1"	10' 3"	10' 1"	10' 3"	10' 3"	10' 3"
EXTERIOR WIDTH	96"	96"	96"	96"	96"	96"	96"	96"	96"	96"	96"	96"	96"	96"
FRESH WATER (GAL.)	42	29	42	46	61	42	42	29	46	61	29	61	61	61
GRAY WATER (GAL.)	32	42	32	42	28	32	32	28	74	32	28	74	32	32
BLACK WATER (GAL.)	32	42	32	42	32	32	32	32	32	42	42	32	42	42
AWNING SIZE (FT)	10	15	14	10	14	16	14	16	12	16	16	16	16	16

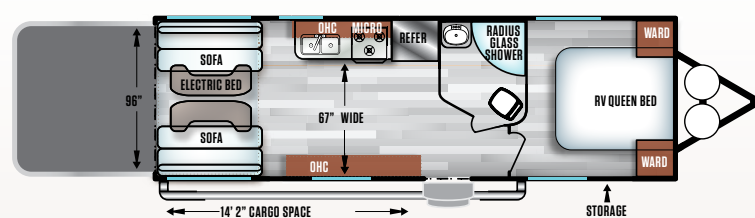
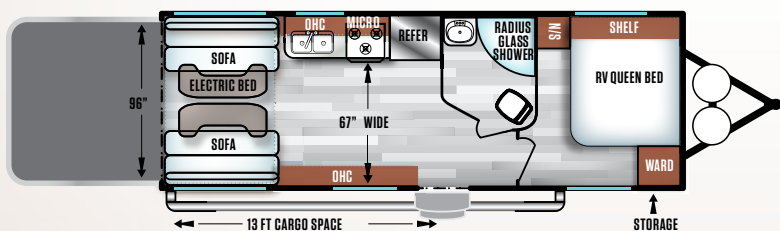



UNDERMOUNT SINK W/ FAUCET



OUTSIDE STEPS



GLASS COOKTOP COVER

CRUISE LITE STANDARDS & OPTIONS

STANDARD FEATURES

- Upgraded kitchen faucet
- 6-way adjustable hidden hinges
- Modern roller shades
- Large entertainment center, allows for larger TV (Some models)
- Aerodynamic front profile
- Mortise and tenon shaker style cabinet doors
- 3 Burner cooktop
- 13.5K A/C (Non-ducted)
- Diamond plate rock guard
- SolidStep entry steps
- Digital TV antenna w/ booster
- Cable / satellite ready
- Bluetooth stereo
- "Teddy bear" bunk mattress
- Shoe nook at the end of the main bed (Per floorplan)
- Large tables at U-dinette
- 2 Exterior speakers
- 2 - 20 lb. LP bottles w/ hard cover
- Extra large kitchen overhead cabinets
- Stainless steel look appliances
- Water heater by-pass
- Ball bearing drawer guides
- 6 Gal. Gas DSI water heater
- Radius shower enclosure (Per floorplan)
- Pass thru storage
- One piece kitchen backsplash
- High definition countertops

- Brushed nickel cabinet hardware
- Beauflor® linoleum flooring
- Black tank flush
- Outside shower
- Skylight over tub
- Radial tires with full spare and carrier
- Double door refrigerator
- Glass cooktop cover w/oven
- Undermount sink w/sink cover
- Flip-up countertop extension (Per floorplan)
- LP quick disconnect
- Power awning
- Power tonge jack
- Push button remote w/holster
- External LED strip lighting
- Solar prep and LED lights

POPULAR OPTIONS

- Fiberglass siding
- Backpack flip down rack
- Chrome wheels
- Tub surround (Per floorplan)
- Ducted A/C
- Enclosed holding tanks (Some models)
- 12 Volt heat strips
- Exterior camp kitchen (Some models)
- 2nd Bunk Window
- Power Stab Jacks

27RKSS

SHOWN IN MINERAL

SALEM POPULAR FEATURES

1. Undermount sink
2. 3 Burner / Glass cooktop cover
3. Extra deep kitchen cabinets
4. Premium faucet
5. Stainless steel look appliances
6. Modern roller shades
7. Beauflor linoleum
8. Additional storage



CONSTRUCTION BUILT TO LAST.

- | | | |
|---|--|--|
| 1 2" x 3" floor joists 12" on center | 8 Extra large full pass-thru storage | 15 Stain resistant carpet |
| 2 2" wall studs 16" or less on center | 9 Smooth rolled skirting | 16 One piece linoleum flooring |
| 3 30" fiberglass radius entry door | 10 In floor ducted heat | 17 Safety glass windows |
| 4 Aluminum siding | 11 Diamond plate rockguard | 18 A/C ducts |
| 5 5" bowed truss roof rafters | 12 3/8" roof decking (full walk-on roof) | 19 "Darco" anti-puncture underbelly wrap |
| 6 One piece seamless roof (12 yr. manufacturer defect warranty) | 13 LP bottle cover w/ easy access | 20 5/8" flooring |
| 7 R-7 fiberglass insulation throughout | 14 13.5K ducted roof, high output AC w/ quick cool | |

At Salem your satisfaction is serious business and it shows. Our commitment to your satisfaction includes:

A: Fiberglass option

B: Flip down rack option

C: 6 gallon GE DSI water heater with Quick Recovery

D: Central switch command center



27REIS

SHOWN IN OYSTER WITH CUSTOMER-SUPPLIED TV



FIBERGLASS OPTION



SHOWN WITH CUSTOMER-SUPPLIED TV

25RKS

DRY WEIGHT:
5794

EXT. LENGTH:
29' 1"

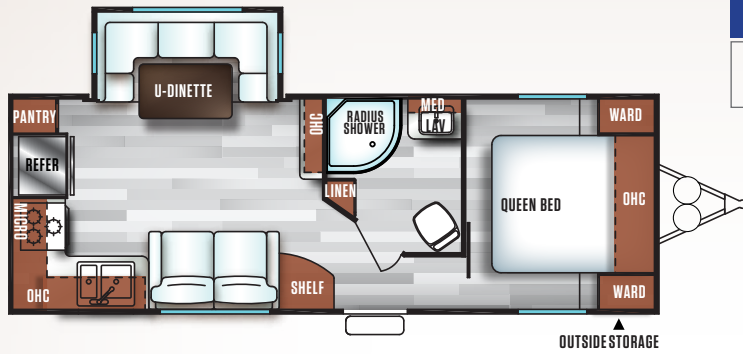

25RLS

DRY WEIGHT:
5987

EXT. LENGTH:
30' 9"

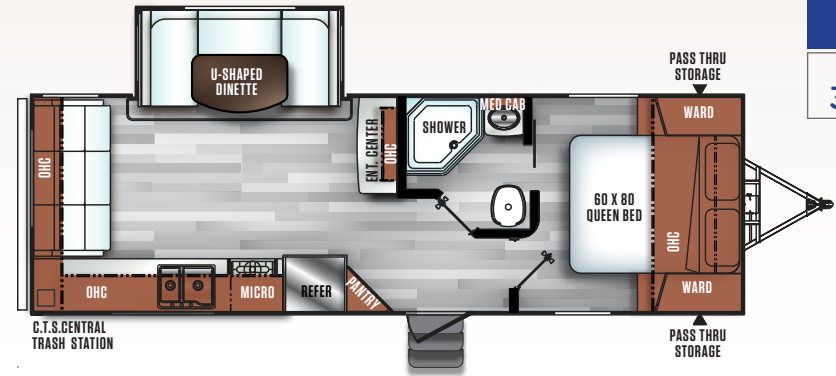

27DBK

DRY WEIGHT:
6898

EXT. LENGTH:
32' 4"

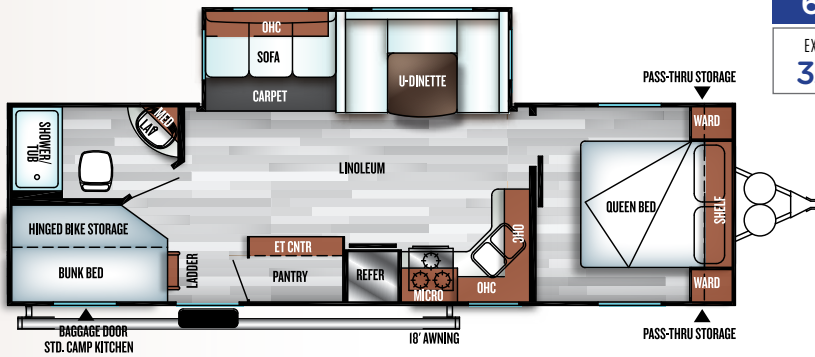

27RBK

DRY WEIGHT:
7346

EXT. LENGTH:
32' 7"

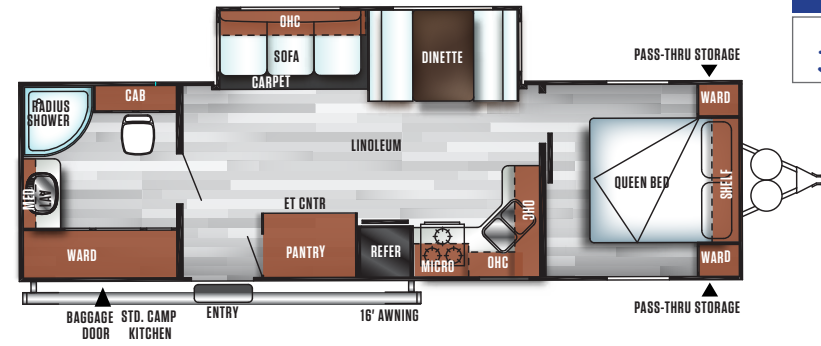

27REIS

DRY WEIGHT:
7365

EXT. LENGTH:
34' 1"

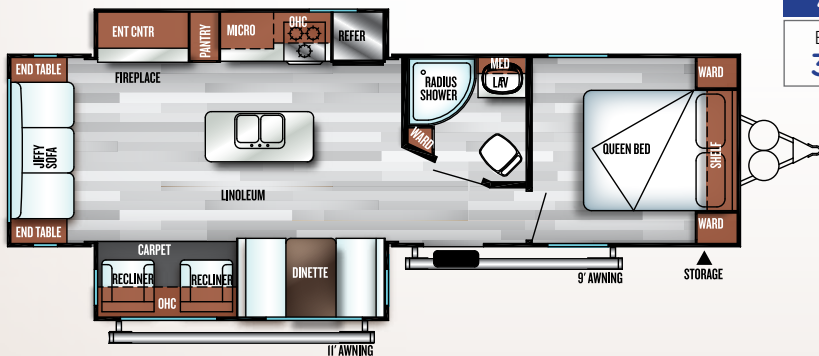

27RKSS

DRY WEIGHT:
6798

EXT. LENGTH:
33' 6"

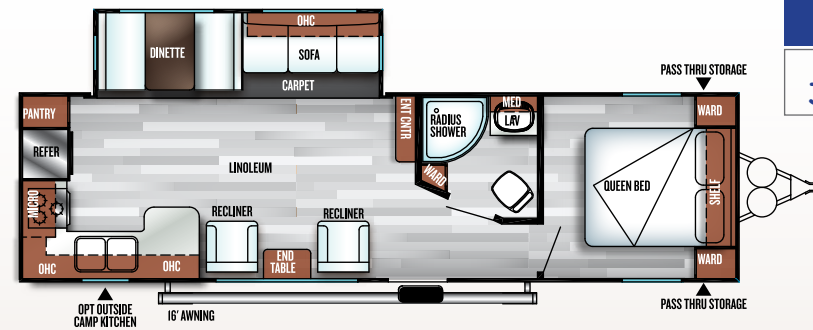

27RLSS

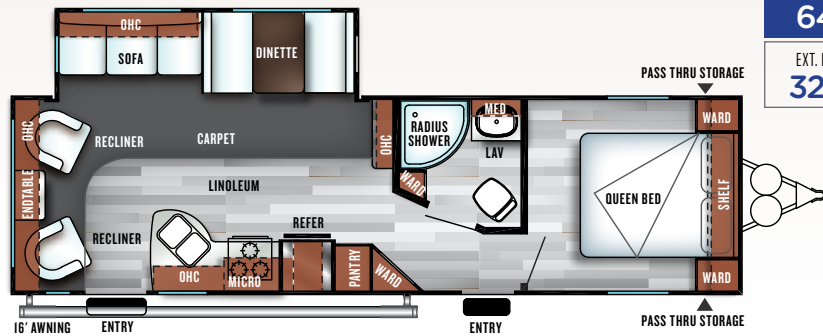

27TDSS

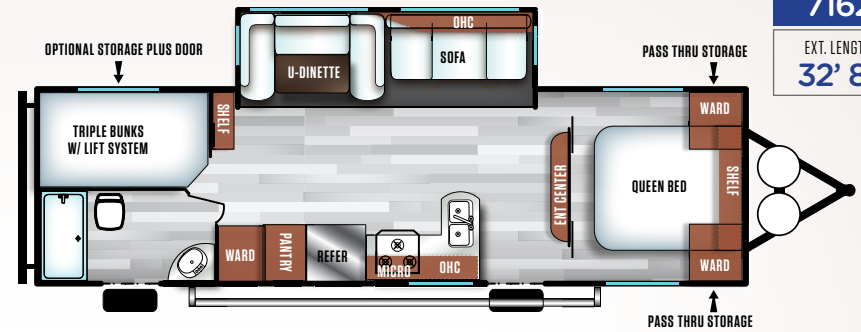

28CKDS

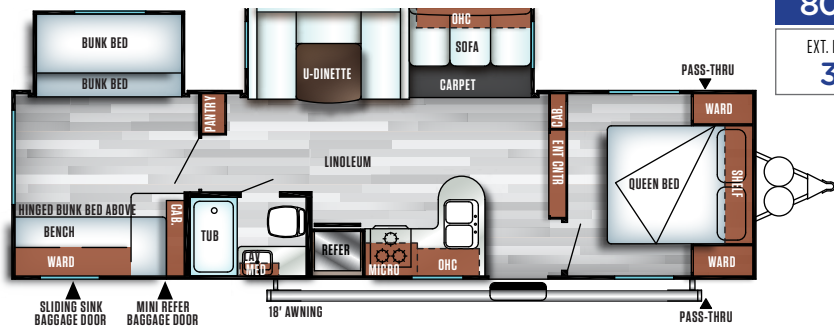

32BHDS

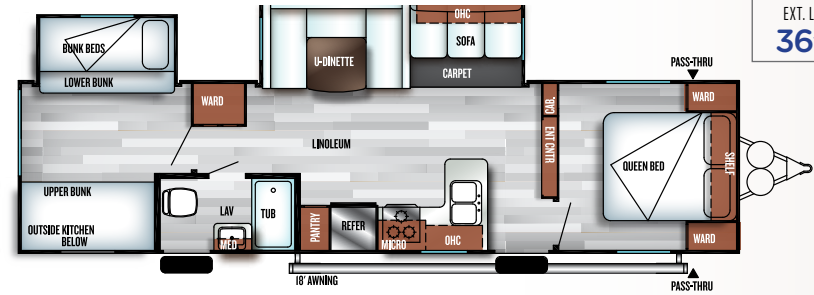

	25RKS	25RLS	27DBK	27RBK	27REIS	27RKSS	27RLSS	27TDSS	28CKDS	32BHDS
GVWR	7,578	7,597	9,488	9,538	9,535	9,660	9,497	9,610	9,676	11,070
HITCH WEIGHT (LBS.)	578	597	688	738	735	860	697	810	876	910
UVW (LBS.)	5,794	5,987	6,898	7,346	7,365	6,798	6,418	7,162	8,000	8,283
CCC (LBS.)	1,784	1,610	2,590	2,192	2,170	2,862	3,079	2,448	1,676	2,787
EXTERIOR LENGTH	29' 1"	30' 9"	32' 4"	32' 7"	34' 1"	33' 6"	32' 3"	32' 8"	35'	36' 2"
EXTERIOR HEIGHT	11' 3"	11'	11'	11' 5"	11' 5"	11' 3"	11' 3"	11' 3"	11' 5"	11' 5"
EXTERIOR WIDTH	96"	96"	96"	96"	96"	96"	96"	96"	96"	96"
FRESH WATER (GAL.)	61	61	61	61	61	61	61	61	61	61
GRAY WATER (GAL.)	66	66	64	42	33	66	66	74	32	32
BLACK WATER (GAL.)	42	42	28	33	42	42	42	32	42	32
AWNING SIZE (FT)	16	18	17	17	11 & 10	16	16	16	18	18

THE SALEM LINE-UP

YOUR SALEM DEALER

2018



SALEM



SALEM CRUISE LITE



SALEM VILLA | VILLA ESTATE



SALEM HEMISPHERE

Specification Definitions

GVWR (Gross Vehicle Weight Rating) - is the maximum permissible weight of the unit when fully loaded. It includes all weights, inclusive of all fluids, cargo, optional equipment and accessories. For safety and product performance do NOT exceed the GVWR.

GAWR (Gross Axle Weight Rating) - is the maximum permissible weight, including cargo, fluids, optional equipment and accessories that can be safely supported by a combination of all axles.

UVW (Unloaded Vehicle Weight)* - is the typical weight of the unit as manufactured at the factory. It includes all weight at the unit's axle(s) and tongue or pin and LP Gas. The UVW does not include cargo, fresh potable water, additional optional equipment or dealer installed accessories.

*Estimated average based on standard build optional

equipment.

CCC (Cargo Carrying Capacity)** - is the amount of weight available for fresh potable water, cargo, additional optional equipment and accessories. CCC is equal to GVWR minus UVW. Available CCC should accommodate fresh potable water (8.3 lbs per gallon). Before filling the fresh water tank, empty the black and gray tanks to provide for more cargo capacity.

** Estimated average based on standard build optional equipment

Each Forest River RV is weighed at the manufacturing facility prior to shipping. A label identifying the unloaded vehicle weight of the actual unit and the cargo carrying capacity is applied to every Forest River RV prior to leaving our facilities.

The load capacity of your unit is designated by weight, not by volume, so you cannot necessarily use all available space when loading your unit.

All information contained in this brochure is believed to be accurate at the time of publication. However, during the model year, it may be necessary to make revisions and Forest River, Inc., reserves the right to make all such changes without notice, including prices, colors, materials, equipment and specifications as well as the addition of new models and the discontinuance of models shown in this brochure. Therefore, please consult with your Forest River dealer and confirm the existence of any materials, design or specifications that are material to your purchase decision. Litho. U.S.A. FOR 1423 P/W: 201731.01

CUSTOMER SATISFACTION



www.ForestRiverBuyLocal.com

FREE MEMBERSHIP
to Forest River Owners' Group

www.forestriverfrog.com



Learn More
Scan this barcode using a QR Reader on your smart phone to learn more about Forest River.



A Berkshire Hathaway company.

Forest River, Inc. 55470 C.R. 1 Elkhart, IN 46515 | (574) 533-5934
www.forestriverinc.com/Salem | www.forestriveraccessories.com



PRE-DELIVERY INSPECTION FACILITY

20,000 square feet of quality assurance. The bare essentials for a premium product. This state-of-the-art facility gives immediate daily feedback to production for quality assurance in every unit built.

SALEM

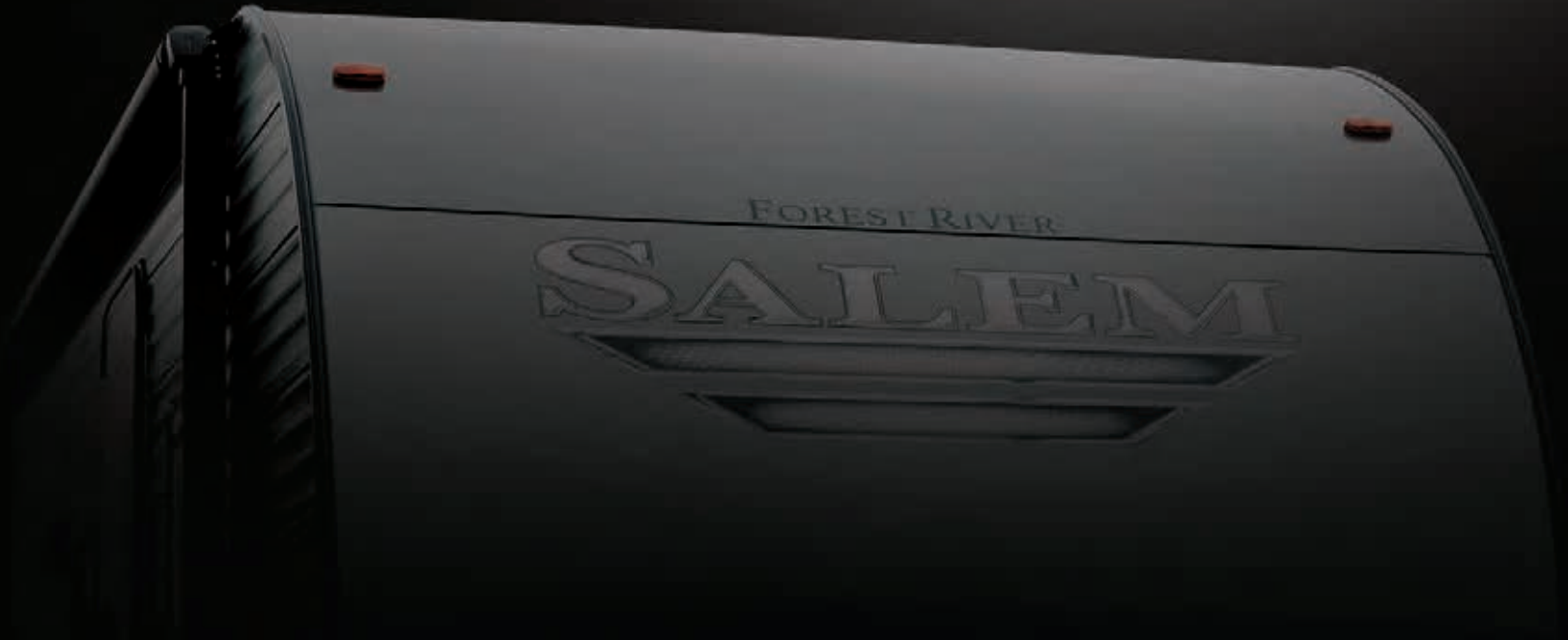

SALEM

BY FOREST RIVER



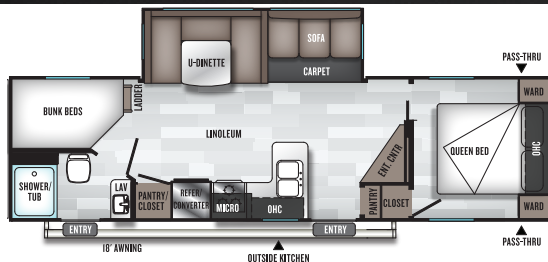

26DBUD

UVW = 6885

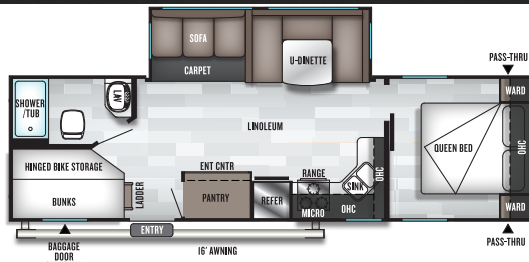

27DBK

UVW = 6380

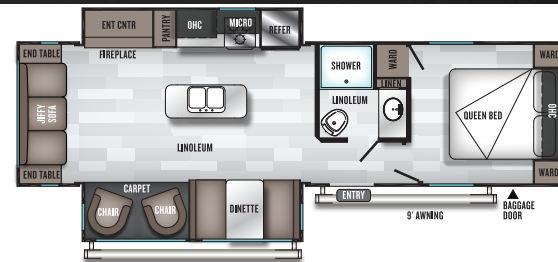

27RE

UVW = 7545

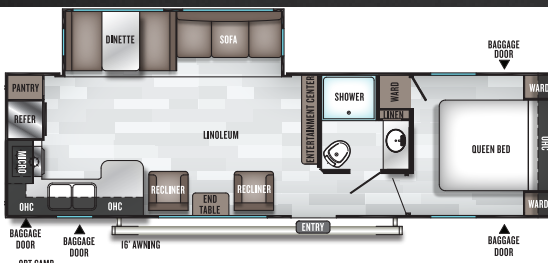

27RKS

UVW = 6750

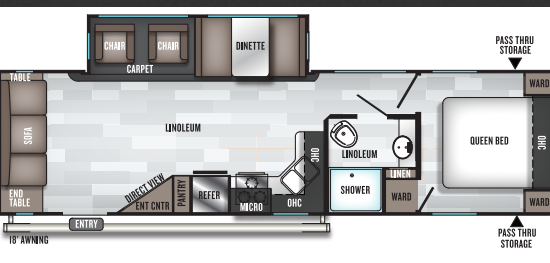

28RLSS

UVW = 6351

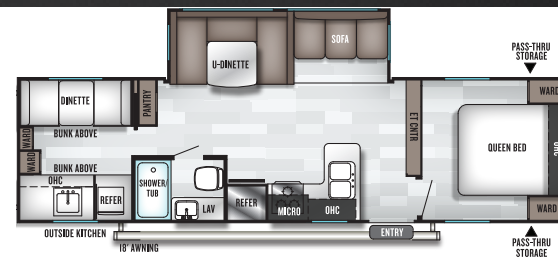

30KQBSS

UVW = 6780

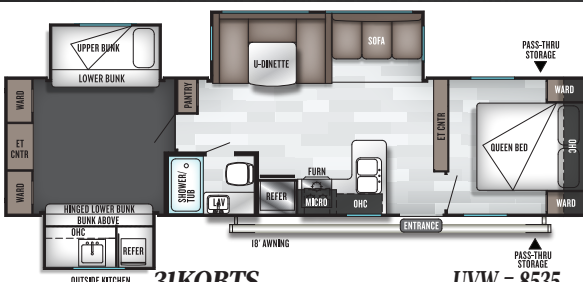

31KQBTS

UVW = 8535

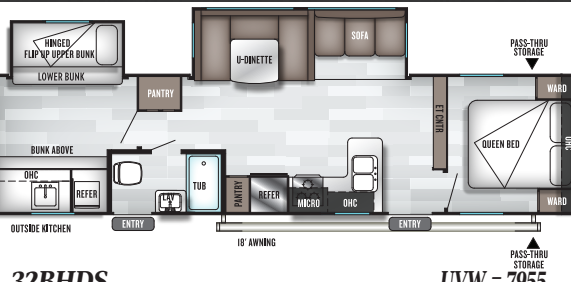

32BHDS

UVW = 7955

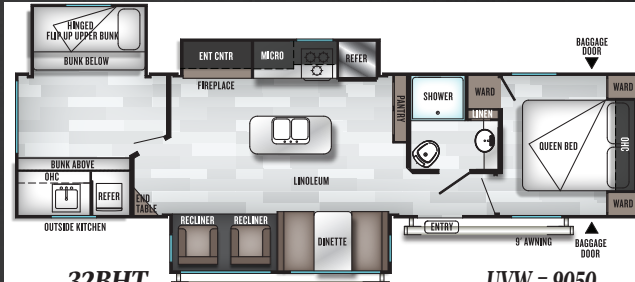

32BHT

UVW = 9050

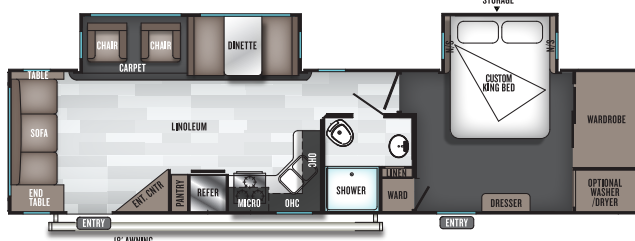

32RLDS

UVW = 8490

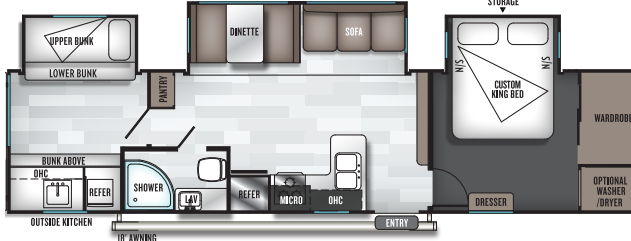

33TS

UVW = 9238

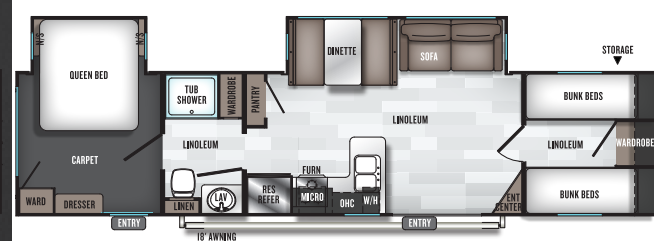

36BHDS

UVW = 8325

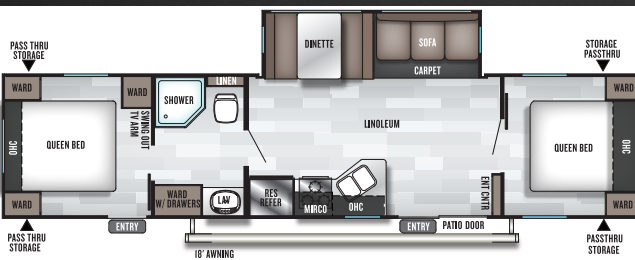

37BHSS2Q

UVW = 7600

	26DBUD	27DBK	27RE	27RKS	28RLSS	30KQBSS	31KQBTS	32BHDS	32BHT	32RLDS	33TS	36BHDS	37BHSS2Q
UVW	6885	6380	7545	6750	6351	6780	8535	7955	9050	8490	9238	8325	7600
Hitch Wt.	795	701	955	950	762	860	905	859	1080	980	1088	1015	970
Carrying Capacity	2672	1283	2332	1162	1373	2821	1292	1826	2192	1412	1852	3316	2271
Ext. Length	33'2"	32'0"	33'6"	33'7"	34'1"	33'0"	36'6"	35'8"	37'6"	38'	38'9"	38'8"	39'0"
Ext. Height	11'2"	11'4"	11'5"	11'2"	11'5"	11'2"	11'3"	11'2"	11'7"	11'2"	11'7"	11'2"	11'2"
Fresh Water	40	39	40	40	40	39	39	39	40	40	40	40	39
Gray Water	60	60	57	54	30	57	54	57	57	27	54	27	30
Black Water	30	30	38	27	30	27	27	30	38	27	30	38	27
Tire Size	15"	15"	15"	15"	15"	15"	15"	15"	15"	15"	15"	15"	15"

SALEM
360° TOURS



<https://lead.me/bbixY>



27RE (SHOWN IN OYSTER DECOR)



26DBUD (SHOWN IN MARBLE DECOR)

DETAILS MATTER.

WHERE AFFORDABILITY
AND LUXURY COLLIDE.



SALEM



OTHER BRANDS

Storage matters.

Our STOW AND GO storage system offering storage under dinette, couch and bed. Maximizes your storage space and makes preparation for camping a breeze.



SALEM



OTHER BRANDS

Refrigerators matter.

Stainless Steel 10.7 cu ft that is 78% larger than competition. Offering glass rather than wire shelves. Perfect for both dry camping and when plugged in.

Strong foundation matters.

JT-Strong Arms - Typically reserved for high-end fifth wheels, will make your trailer feel like it is sitting on a house foundation...Rock Solid Setup - Every time.

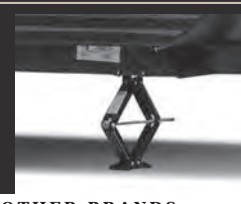

OTHER BRANDS



SALEM



SALEM



OTHER BRANDS

Stairs matter.

Entering your coach should be safe and easy. Our triple step system is unparalleled for safety and convenience.



Comfort matters.

Coleman Brand Air Conditioners are the leaders in quiet, and efficient systems. No more yelling over the noise. Enjoy comfort and quiet with Coleman.



OTHER BRANDS

VISIT FORESTRIVERINC.COM/SALEM

TO EXPERIENCE COMPLETE
STANDARDS & MUCH MORE

SPECIFICATION DEFINITIONS

GVWR (Gross Vehicle Weight Rating) - is the maximum permissible weight of the unit when fully loaded. It includes all weights, inclusive of all fluids, cargo, optional equipment and accessories. For safety and product performance do NOT exceed the GVWR.

GAWR (Gross Axle Weight Rating) - is the maximum permissible weight, including cargo, fluids, optional equipment and accessories that can be safely supported by a combination of all axles.

UVW (Unloaded Vehicle Weight)* - is the typical weight of the unit as manufactured at the factory. It includes all weight at the unit's axle(s) and tongue or pin and LP Gas. The UVW does not include cargo, fresh potable water, additional optional equipment or dealer installed accessories.

*Estimated average based on standard build optional equipment.

CCC (Cargo Carrying Capacity)** - is the amount of weight available for fresh potable water, cargo, additional optional equipment and accessories. CCC is equal to GVWR minus UVW. Available CCC should accommodate fresh potable water (8.3 lbs per gallon). Before filling the fresh water tank, empty the black and gray tanks to provide for more cargo capacity.

** Estimated average based on standard build optional equipment

Each Forest River RV is weighed at the manufacturing facility prior to shipping. A label identifying the unloaded vehicle weight of the actual unit and the cargo carrying capacity is applied to every Forest River RV prior to leaving our facilities.

The load capacity of your unit is designated by weight, not by volume, so you cannot necessarily use all available space when loading your unit.

THE SALEM LINE-UP



SALEM



SALEM CRUISE LITE



SALEM VILLA | VILLA ESTATE



SALEM HEMISPHERE

CUSTOMER SATISFACTION



www.ForestRiverBuyLocal.com

FREE MEMBERSHIP
to Forest River Owners' Group

www.forestrivermag.com



Learn More
Scan this barcode using a QR Reader on your smart phone to learn more about Forest River.



A Berkshire Hathaway company.

Forest River, Inc. 55470 C.R. 1 Elkhart, IN 46515 | (574) 533-5934
www.forestriverinc.com/Salem | www.forestriveraccessories.com



PRE-DELIVERY INSPECTION FACILITY

20,000 square feet of quality assurance. The bare essentials for a premium product. This state-of-the-art facility gives immediate daily feedback to production for quality assurance in every unit built.

24/7 EMERGENCY ROADSIDE ASSISTANCE WITH VEHICLE PURCHASE*

TOWING
JUMP-STARTS
TIRE CHANGES
FLUID DELIVERY
LOCKOUT
SERVICE

WINCH-OUT
MOBILE MECHANIC
TECHNICAL
SUPPORT
DEALER LOCATOR
SERVICES



*VALID FOR 1 YEAR FROM DATE OF PURCHASE

YOUR SALEM DEALER

2019

SALEM

BY FOREST RIVER

SALEM & CRUISE LITE



Extra Large Cabinets
with Base Shelf and
Frosted Glass Inserts

Mushroom Style
LED Interior Lights

Stainless Steel
Appliance Package

Recessed Stove
with Glass Cover

"High Definition"
Countertops

INTERIOR FEATURES

SOME FEATURES SHOWN HAVE LIMITED AVAILABILITY

SHOWN IN OYSTER

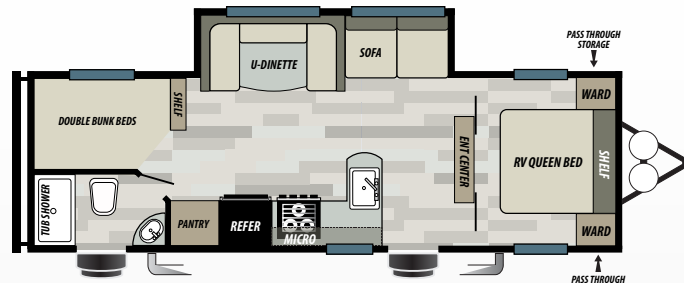

263BHXL

Modern Roller Shades
in Living Areas

Double-Stitched
pillow Back Jiffy Sofa

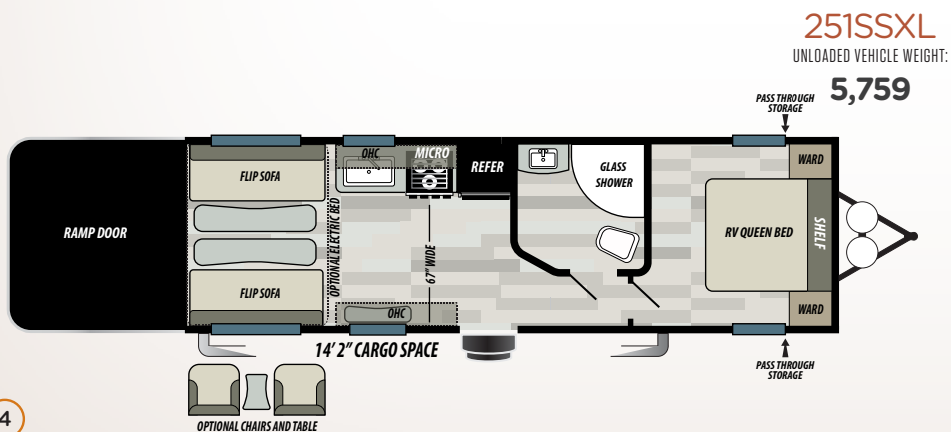
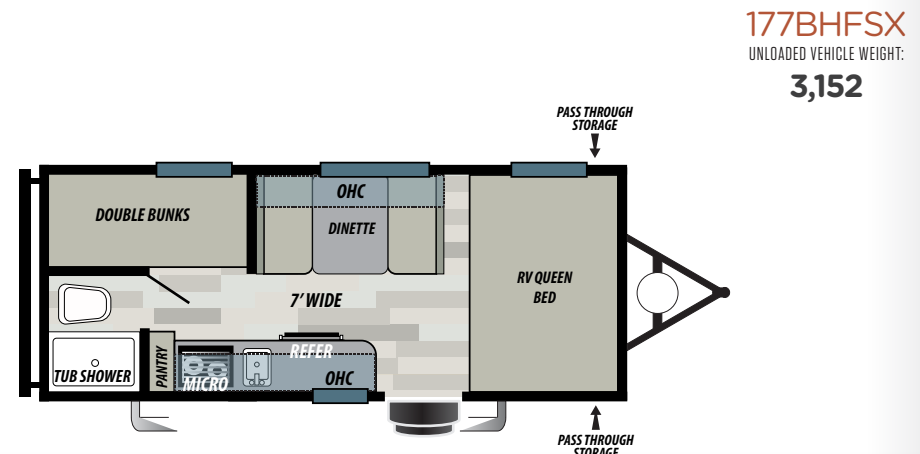
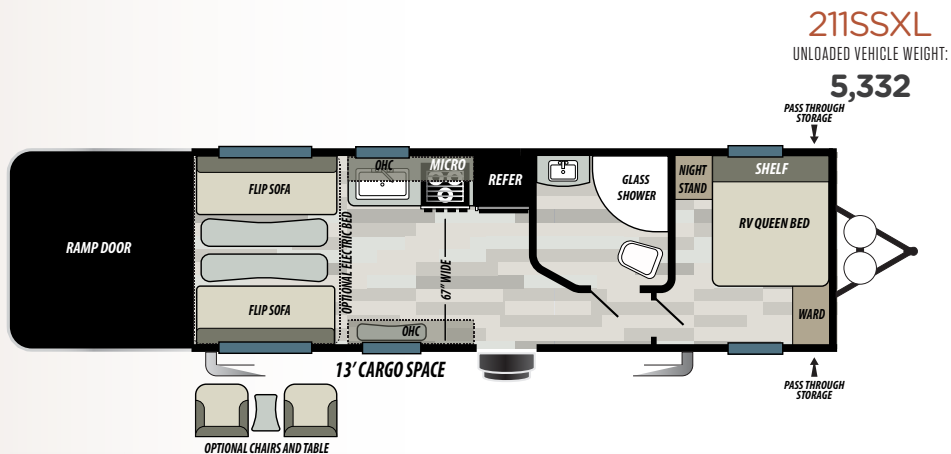
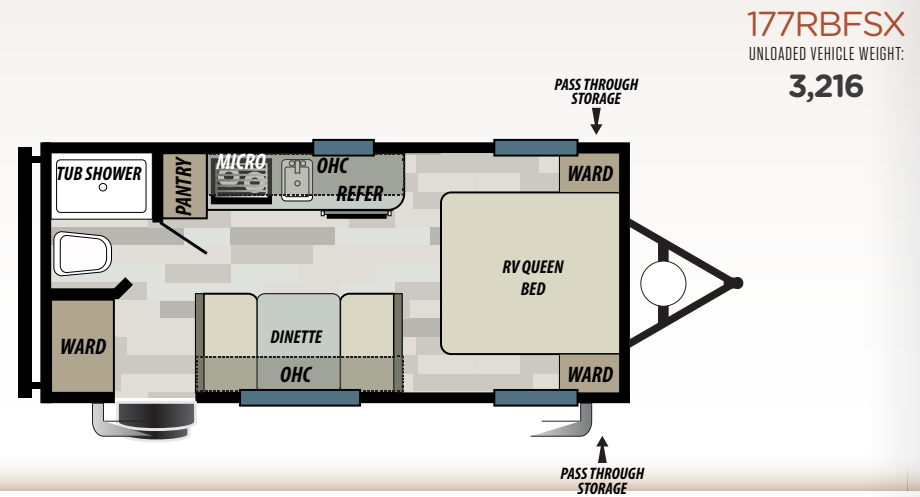
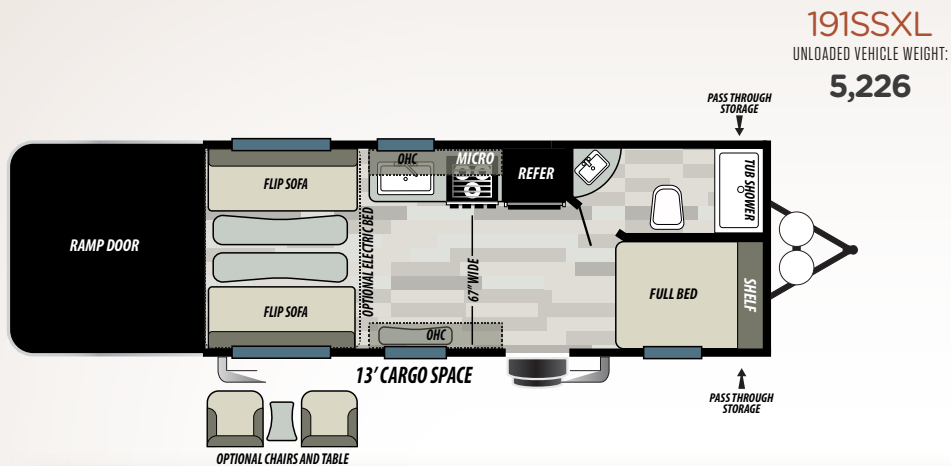

	191SSXL	211SSXL	251SSXL	177RBFSX	177BHFSX
HITCH WEIGHT (LBS)	710	890	835	410	380
AXLE WEIGHT (LBS)	8510	8690	8635	4310	4280
UNLOADED VEHICLE WEIGHT (LBS)	5226	5332	5759	3216	3152
CARGO CARRYING CAPACITY (LBS)	3322	3406	2914	1151	1185
EXTERIOR LENGTH (FT)	25' 9"	27' 5"	29' 5"	21' 6"	21' 6"
EXTERIOR HEIGHT (FT)	11' 10"	11' 10"	11' 10"	10' 3"	10' 3"
FRESH WATER (GAL)	56	56	56	28	28
GREY WATER (GAL)	40	35	35	22	22
BLACK WATER (GAL)	30	30	30	22	22
TIRE SIZE (IN)	15	15	15	15	15

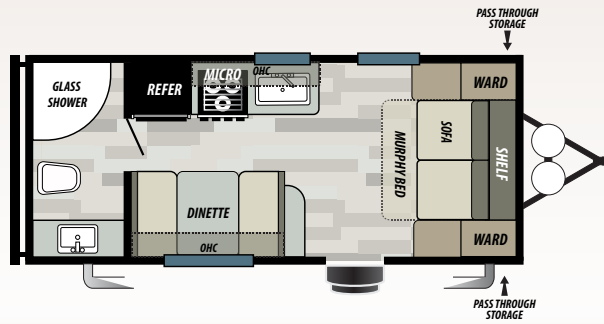

190RBXL
UNLOADED VEHICLE WEIGHT:
4,590

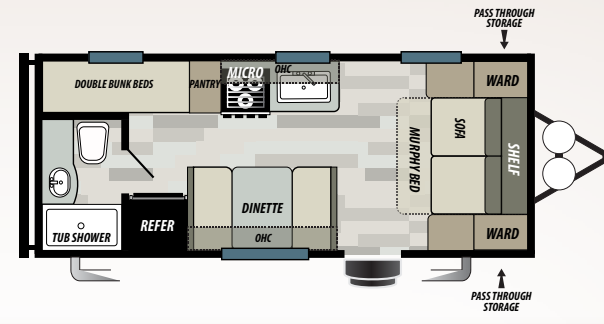

201BHL
UNLOADED VEHICLE WEIGHT:
4,211

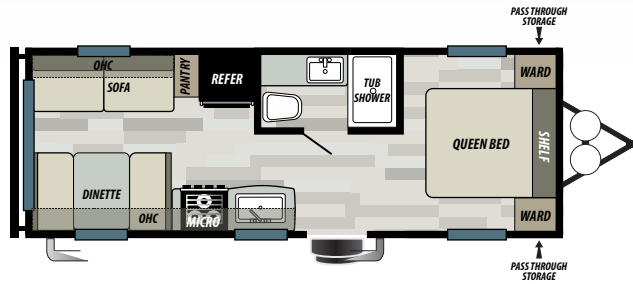

202RDXL
UNLOADED VEHICLE WEIGHT:
4,522

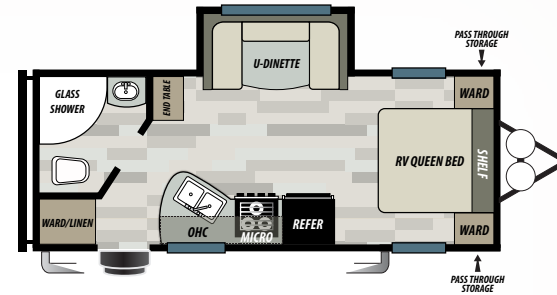

210RBXL
UNLOADED VEHICLE WEIGHT:
4,798

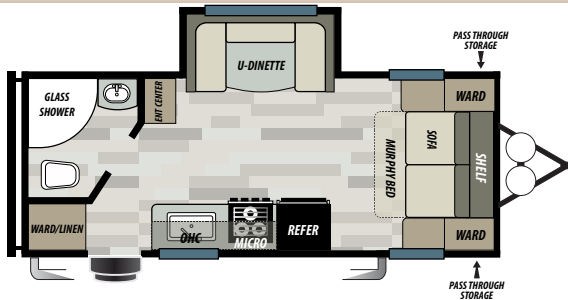

212RBXL
UNLOADED VEHICLE WEIGHT:
5,064

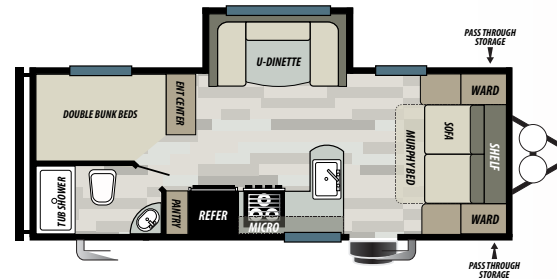

221BHL
UNLOADED VEHICLE WEIGHT:
5,241

SALEM CRUISE LITE FLOORPLAN KEY

Pillows and blankets shown on beds and bunks are for demonstration purposes only and do not come with your new coach.

OHC	MICRO
OVERHEAD CABINET	MICROWAVE
WARD	LAV
WARDROBE	BATHROOM SINK

	190RBXL	201BHL	202RDXL	210RBXL	212RBXL	221BHL
HITCH WEIGHT (LBS.)	570	465	552	540	610	665
AXLE WEIGHT (LBS.)	7570	7465	7552	7540	7610	7665
UNLOADED VEHICLE WEIGHT (LBS.)	4590	4211	4522	4798	5064	5241
CARGO CARRYING CAPACITY (LBS.)	3018	3292	3068	2780	2622	2462
EXTERIOR LENGTH (LBS.)	22' 8"	23' 8"	25' 10"	24' 8"	24' 4"	26' 5"
EXTERIOR HEIGHT (LBS.)	10' 1"	10' 4"	10' 4"	10' 10"	10' 10"	10' 10"
FRESH WATER (GAL.)	56	56	56	56	56	56
BLACK WATER (GAL.)	30	30	30	28	35	35
GREY WATER (GAL.)	30	30	22	30	30	30
TIRE SIZE (IN.)	15	15	15	15	15	15

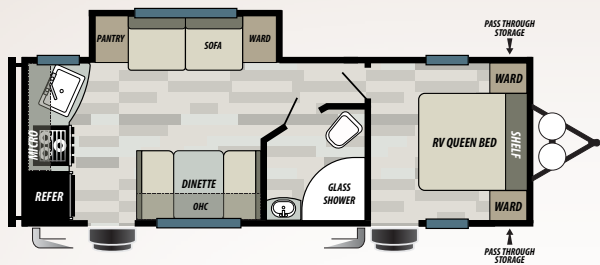

231RKXL
UNLOADED VEHICLE WEIGHT:
5,367

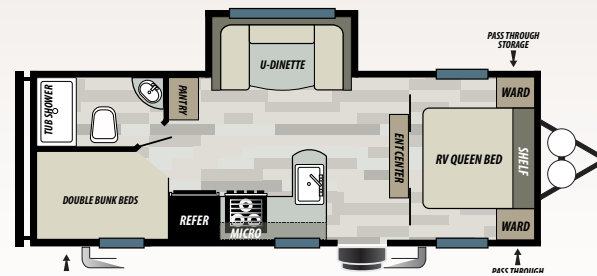

241BHXL
UNLOADED VEHICLE WEIGHT:
5,241

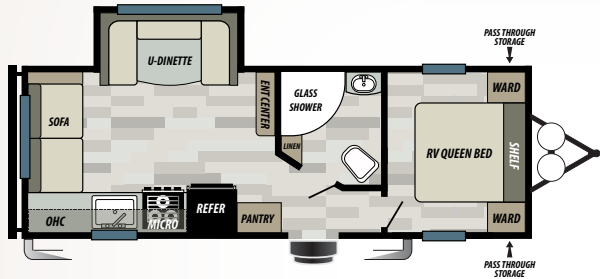

241RLXL
UNLOADED VEHICLE WEIGHT:
5,516

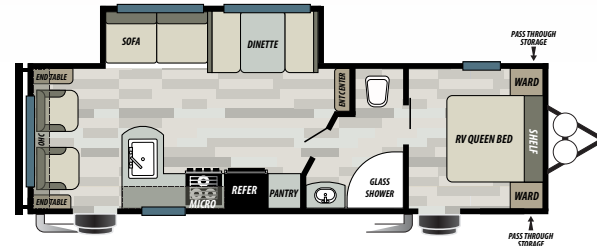

254RLXL
UNLOADED VEHICLE WEIGHT:
6,101

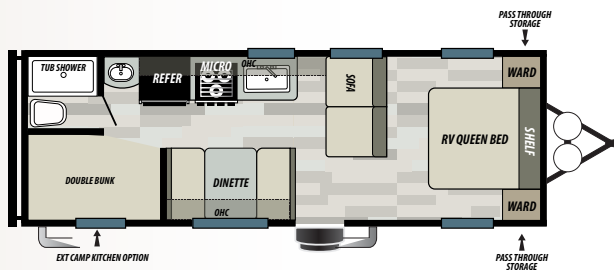

261BHXL
UNLOADED VEHICLE WEIGHT:
4,753

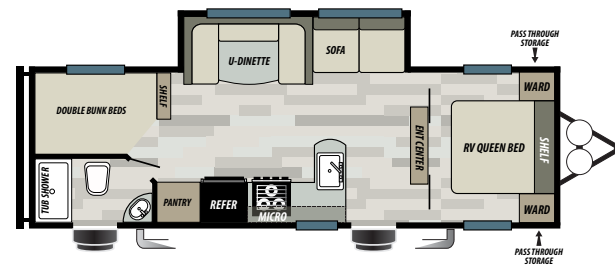

263BHXL
UNLOADED VEHICLE WEIGHT:
5,931

SALEM FLOORPLAN KEY

Pillows and blankets shown on beds and bunks are for demonstration purposes only and do not come with your new coach.

OHC	MICRO
OVERHEAD CABINET	MICROWAVE
WARD	LAV
WARDROBE	BATHROOM SINK

	231RKXL	241BHXL	241RLXL	254RLXL	261BHXL	263BHXL
HITCH WEIGHT (LBS.)	545	595	680	685	495	635
AXLE WEIGHT (LBS.)	7545	7595	7680	7685	7495	7635
UNLOADED VEHICLE WEIGHT (LBS.)	5367	5241	5516	6101	4753	5931
CARGO CARRYING CAPACITY (LBS.)	2216	2392	2202	1622	2780	1742
EXTERIOR LENGTH (LBS.)	27' 4"	28' 3"	28' 8"	30' 11"	28' 4"	31' 8"
EXTERIOR HEIGHT (LBS.)	10' 4"	10' 10"	10' 10"	10' 10"	10' 4"	10' 10"
FRESH WATER (GAL.)	56	56	56	56	56	56
BLACK WATER (GAL.)	30	35	35	30	28	65
GREY WATER (GAL.)	30	30	30	28	30	30
TIRE SIZE (IN.)	15	15	15	15	15	15

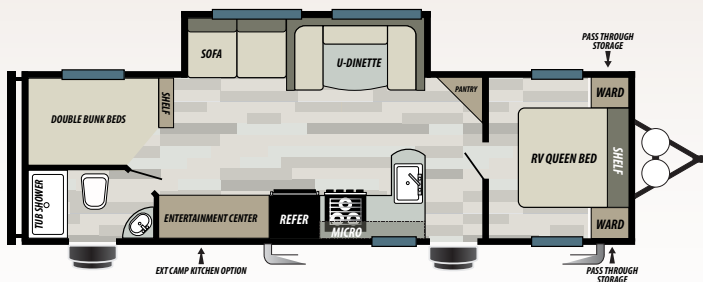

271BHXL
UNLOADED VEHICLE WEIGHT:
6,391

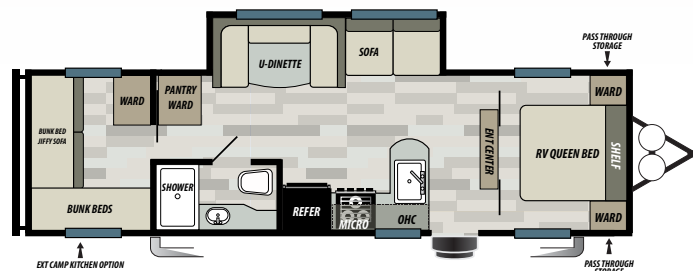

273QBX
UNLOADED VEHICLE WEIGHT:
6,156

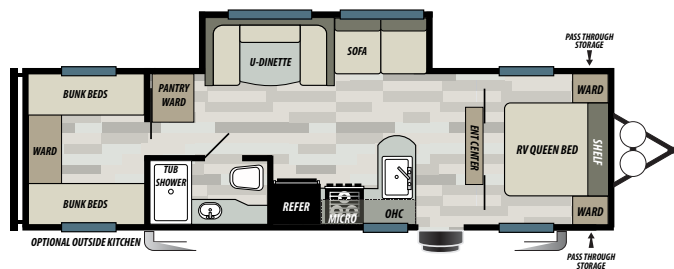

282QBX
UNLOADED VEHICLE WEIGHT:
6,495

	271BHXL	273QBX	282QBX
HITCH WEIGHT (LBS.)	775	760	705
AXLE WEIGHT (LBS.)	7775	7760	7705
UNLOADED VEHICLE WEIGHT (LBS.)	6391	6156	6495
CARGO CARRYING CAPACITY (LBS.)	1422	1642	1248
EXTERIOR LENGTH (LBS.)	32' 10"	33' 1"	32' 10"
EXTERIOR HEIGHT (LBS.)	10' 10"	10' 10"	10' 10"
FRESH WATER (GAL.)	56	56	56
BLACK WATER (GAL.)	65	28	30
GREY WATER (GAL.)	30	30	28
TIRE SIZE (IN.)	15	15	15

CRUISE LITE

STANDARDS & OPTIONS

STANDARD FEATURES

- New stainless steel single pole faucet
- New 6-way adjustable hidden hinges
- Large entertainment center, allows for larger TV (Some models)
- Aerodynamic front profile
- Mortise and tenon shaker style cabinet door
- 3 Burner cook top
- 13.5K A/C (Non-ducted)
- Textured rock guard
- Digital TV antenna w/ booster
- Cable / satellite ready
- Bluetooth stereo w/ remote (Limited time option*)
- "Teddy bear" bunk mattress
- 2 gas struts under main bed
- Shoe nook at the end of the main bed (Per floorplan)
- Large tables at U-dinette
- 2 Exterior speakers
- 2 - 20 lb. LP bottles w/ hard cover
- Extra large kitchen overhead cabinets
- Stainless steel microwave
- Water heater by-pass
- Single door refrigerator
- Ball bearing drawer guides
- 6 Gal. Gas DSI water heater
- Radius shower enclosure (Per floorplan)
- Pass thru storage
- One piece kitchen backsplash
- High definition countertops

- 78" Interior height
- Brushed nickel cabinet hardware
- Beauflor® linoleum flooring
- Manual awning

POPULAR OPTIONS

- Double door refer IPO single door
- Stabilizer jacks
- Range w/ oven IPO cook top
- Spare tire & carrier
- Ducted A/C
- Outside camp kitchen (Certain models)

LIMITED TIME OPTIONS

(Contact your local dealer for more information)

- Exterior LED light strip under awning
- Recessed stove top w/ glass stove cover
- Modern roller shades w/ autostop (Living, bed)
- Green pkg: Solar prep & LED mushroom lights
- Power awning w/ adjustable legs
- Power stab jacks and power tongue jack
- Push button remote w/ remote holster (Operates slides, stab jacks, awning, light)
- Bluetooth stereo with remote
- LED accent pkg
- Backup camera prep
- Stainless steel appliance package

* See your dealer for more details about our Limited Time Options



SHOWN IN OYSTER

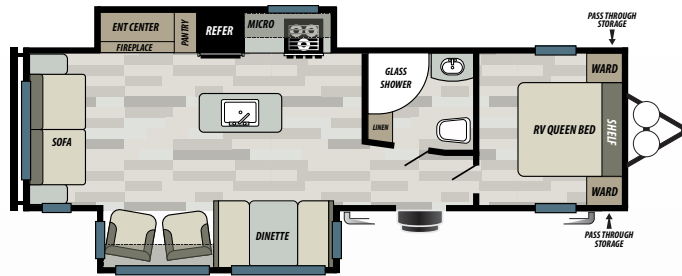

27REI

REAR LIVING COUPLE'S COACH

Just the two of us.

Enjoy your time away, in this incredibly spacious coach with a beautiful rear living area and maximized storage space.



SHOWN WITH CUSTOMER-SUPPLIED TV

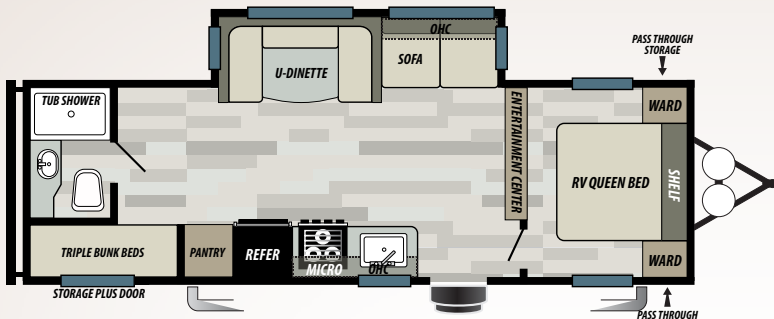

26TBUD
UNLOADED VEHICLE WEIGHT:
5,867

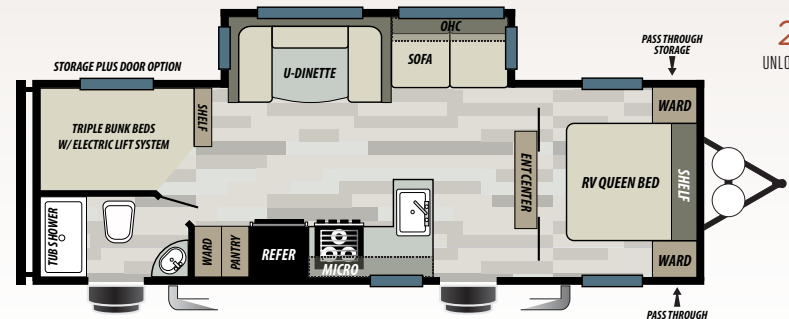

27TDSS
UNLOADED VEHICLE WEIGHT:
6,702

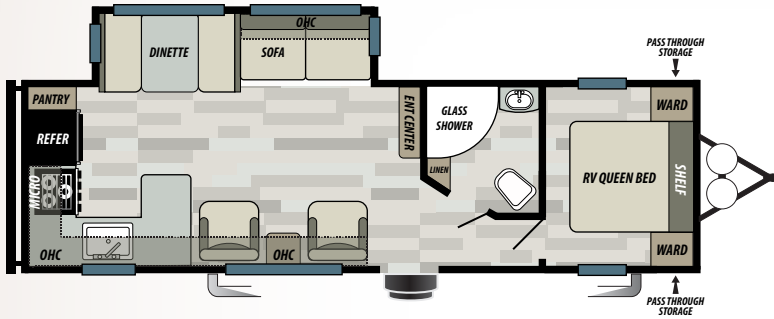

27RKSS
UNLOADED VEHICLE WEIGHT:
6,432

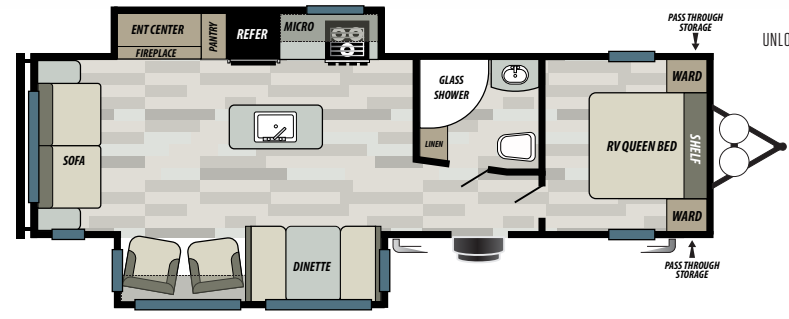

27REI
UNLOADED VEHICLE WEIGHT:
7,934

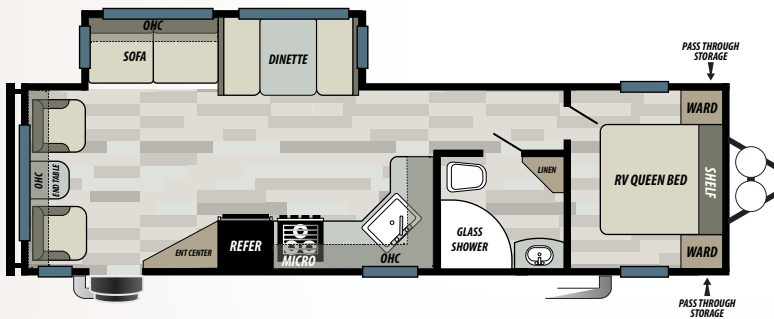

28RLSS
UNLOADED VEHICLE WEIGHT:
7,075

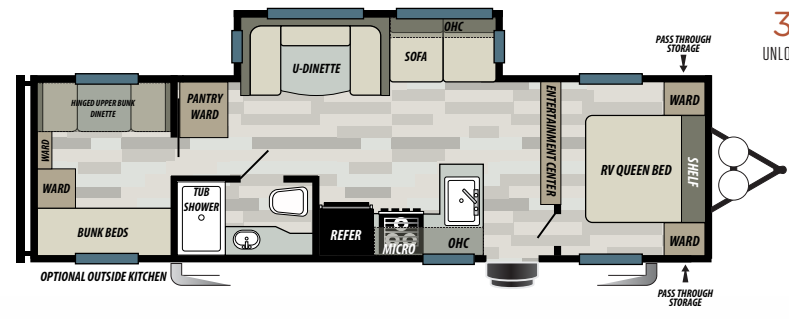

30QBSS
UNLOADED VEHICLE WEIGHT:
7,147

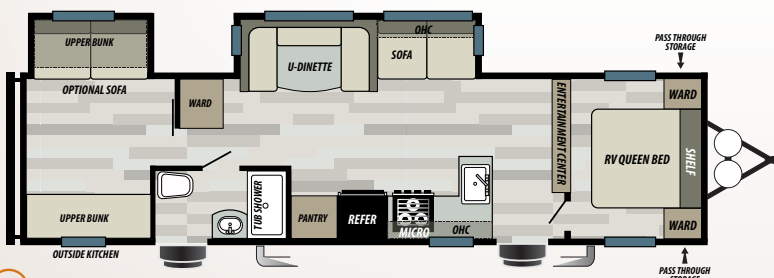

32BHDS
UNLOADED VEHICLE WEIGHT:
8,064

SALEM FLOORPLAN KEY

Pillows and blankets shown on beds and bunks are for demonstration purposes only and do not come with your new coach.

OHC
OVERHEAD CABINET
WARD
WARDROBE

MICRO
MICROWAVE
LAV
BATHROOM SINK

SALEM STANDARDS & OPTIONS

CONSTRUCTION & EXTERIOR

- 5/8" tongue & groove floor decking
- Full walk on one-piece seamless Roof w/ 12 year manufacturer defect warranty
- Extra large full pass through storage (Per floorplan)
- Cold crack and mildew resistant vinyl patio awning
- Safety glass windows
- Metal framed 30" smooth radius corner fiberglass main entry door
- Powder coated I-beam frame
- Cambered chassis
- Gas/Electric quick recovery DSI water heater
- Water heater by-pass
- 2" wall construction, 16" (or less) on center
- R-7 fiberglass insulation throughout
- Triple seal slide out system
- Flush floor electric slide out systems
- Swing arm entry assist handle
- Two marine grade exterior speakers
- Aerodynamic front radius profile
- Smooth aluminum front cap
- One-piece slip-resistant Beauflor® vinyl flooring

KITCHEN

- New Mortise and Tenon Shaker Style Cabinet Doors
- New Hidden hinges throughout
- Dometic® double door refrigerator (2 yr. warranty)

- High rise spring faucet (Limited Program Option)
- Residential Undermount Kitchen Sink
- Stainless steel finish microwave w/ carousel
- 3-Burner, high output range with oven (2 yr. warranty) Stainless steel finish on oven door
- Stainless steel finish range hood w/ 12-volt exhaust fan and light
- Full extension ball bearing drawer guides
- Knife rack (Behind cook top)
- Shelving in overhead cabinets in kitchen
- Central switch location for command center
- Brushed stainless finish hardware
- Abundant cabinet storage
- Large pots and pans drawer under dinette

LIVING ROOM

- 80" interior height
- Ducted 13,500 BTU roof air conditioner w/ quick cool
- Huge storage drawer under jiffy sofa
- Booth dinette (Most models) and U-shaped dinette (Some models)
- Large dinette picture window
- Digital antenna with booster
- Bluetooth FM stereo and four speakers
- Suburban® forced air DSI furnace w/ digital thermostat (2 yr. warranty)
- In-floor ducted heat

- Cable TV hookup living room and bedroom
- Wall switch controls for ceiling lights at living room and bathroom

BEDROOM

- NEW Denver mattress with pillow top in master bed (Limited program option)
- Strut lifted storage area under bed (Master bedroom)
- Bedside mirrored wardrobes w/ shelf above bed
- Bedside 110-volt power outlets (2)
- Increased space at the foot of the bed (Most models)
- Solid bedroom privacy doors (Most models)
- Shoe nook at the foot of the master bed
- Bedside hamper access (Most models)

BATHROOM

- 12-volt power bath roof exhaust vent
- Foot flush toilet
- Vinyl tub surround (Radius angle showers have an enclosure) (Select floorplans)

SECURITY AND SAFETY

- LP leak detector
- Smoke detector
- Carbon monoxide detector
- Fire extinguisher
- Welded heavy duty safety chains
- Electric brakes (All wheels)

- GFI receptacles
- ANSI 119.2 certified
- Meets all national highway administration specifications
- RVIA approved product

OPTIONS

- Stabilizer jacks
- Skylight over tub
- 30-lb LP bottles w/ cover and auto change-over
- 15,000 BTU ducted air w/ quick cool

LIMITED TIME OPTIONS

- (Contact your local dealer for more information)
- Denver 9" pillowtop mattress
- Exterior white LED light strip under awning
- LG Solid Surface Kitchen Countertops
- Modern roller shades w/ autoStop (Living, Bed)
- Residential designer spring faucet
- Green pkg: Solar prep & LED mushroom lights
- Power awning w/ adjustable legs
- Power stab jacks and power tongue jack
- Push button remote w/ remote holster (Operates slides, stab jacks, awning and light)
- Bluetooth stereo with remote
- Backup camera prep
- LED accent pkg

Contact your dealer for a complete list of options.

	26TBUD	27TDSS	27RKSS	27REI	28RLSS	30QBSS	32BHDS
HITCH WEIGHT (LBS.)	815	806	720	730	844	817	874
AXLE WEIGHT (LBS.)	7815	9999	9999	9999	9999	9999	9999
UNLOADED VEHICLE WEIGHT (LBS.)	5867	6702	6432	7934	7075	7147	8064
CARGO CARRYING CAPACITY (LBS.)	1986	3297	3567	2065	2913	2852	1935
EXTERIOR LENGTH (LBS.)	29' 1"	32' 4"	33' 6"	34' 1"	34' 9"	34'	36' 4"
EXTERIOR HEIGHT (LBS.)	11' 2"	11' 2"	11' 2"	11' 3"	11' 3"	11' 3"	11' 3"
FRESH WATER (GAL.)	56	56	56	56	56	56	56
BLACK WATER (GAL.)	34	75	65	60	80	65	58
GREY WATER (GAL.)	32	40	28	30	35	30	30
TIRE SIZE (IN.)	15	15	15	15	15	15	15

THE SALEM LINE-UP



SALEM



SALEM CRUISE LITE

Specification Definitions

GVWR (Gross Vehicle Weight Rating) - is the maximum permissible weight of the unit when fully loaded. It includes all weights, inclusive of all fluids, cargo, optional equipment and accessories. For safety and product performance do NOT exceed the GVWR.

GAWR (Gross Axle Weight Rating) - is the maximum permissible weight, including cargo, fluids, optional equipment and accessories that can be safely supported by a combination of all axles.

UVW (Unloaded Vehicle Weight)* - is the typical weight of the unit as manufactured at the factory. It includes all weight at the unit's axle(s) and tongue or pin and LP Gas. The UVW does not include cargo, fresh potable water, additional optional equipment or dealer installed accessories.

*Estimated average based on standard build optional equipment.

CCC (Cargo Carrying Capacity)** - is the amount of weight available for fresh potable water, cargo, additional optional equipment and accessories. CCC is equal to GVWR minus UVW. Available CCC should accommodate fresh potable water (8.3 lbs per gallon). Before filling the fresh water tank, empty the black and gray tanks to provide for more cargo capacity.

** Estimated average based on standard build optional equipment

Each Forest River RV is weighed at the manufacturing facility prior to shipping. A label identifying the unloaded vehicle weight of the actual unit and the cargo carrying capacity is applied to every Forest River RV prior to leaving our facilities.

The load capacity of your unit is designated by weight, not by volume, so you cannot necessarily use all available space when loading your unit.

All information contained in this brochure is believed to be accurate at the time of publication. However, during the model year, it may be necessary to make revisions and Forest River, Inc., reserves the right to make all such changes without notice, including prices, colors, materials, equipment and specifications as well as the addition of new models and the discontinuance of models shown in this brochure. Therefore, please consult with your Forest River dealer and confirm the existence of any materials, design or specifications that are material to your purchase decision. Litho. U.S.A. F0R 1507 P/W: 2018.04.10

FREE MEMBERSHIP
to Forest River Owners' Group

www.forestriverfrog.com



YOUR SALEM DEALER

CUSTOMER SATISFACTION



www.ForestRiverBuyLocal.com



Learn More

Scan this barcode using a QR Reader on your smart phone to learn more about Forest River.



A Berkshire Hathaway company.

Forest River, Inc. 920 W. Mayberry Ave. Hemet, CA 92543 | 255 S Pepper Ave. Rialto, CA 92376
www.forestriverinc.com/Salem | www.forestriveraccessories.com