

# Columbus

by Palomino



*Castaway*  
TRAVEL DESTINATION TRAILER

## CMT77MB

HITCH WEIGHT	1,301
UVW	11,650
GVWR	13,301
CCC	1,651
OVERALL LENGTH	39'-10 1/2"
EXT. HEIGHT	11'-10"
EXT. WIDTH	101"
FRESH WATER (gal.)	75gal
GREY WATER (gal.)	96gal
BLACK WATER (gal.)	39gal
AWNING SIZE	10' & 12'9"

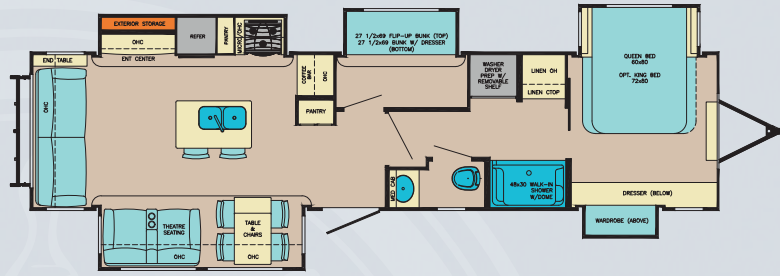

## CMT77MB

## CMT86FK

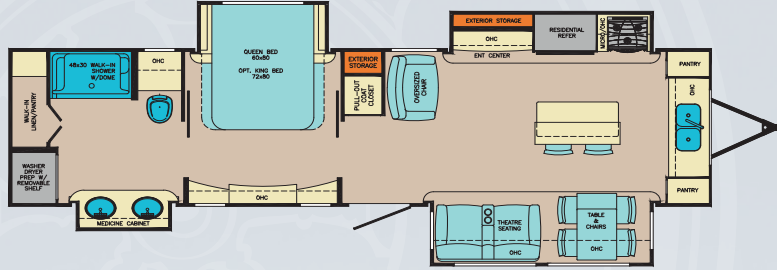

## CMT86FK

HITCH WEIGHT	1,620
UVW	11,144
GVWR	13,620
CCC	2,476
OVERALL LENGTH	37'-10 1/2"
EXT. HEIGHT	11'-10"
EXT. WIDTH	101"
FRESH WATER (gal.)	75gal
GREY WATER (gal.)	96gal
BLACK WATER (gal.)	39gal
AWNING SIZE	19' & 10'

### CONSTRUCTION

- 101" Wide Body
- All Welded Aluminum Frame Superstructure
- Vacuum Bonded Walls
- 5/8 Tongue-Groove Plywood Floor
- R40 Residential 5" Radius Wood Truss Roof
- 84" Interior Height
- 6"2" Height Slides (Living Area Slides)
- (5) Heat Ducts Out Of Traffic Areas
- Snap-In Ceiling Molding-No Staples Or Tape
- 12V Heat Pads On All Holding Tanks
- R38 Floor Insulation
- R40 Roof Insulation
- R11 Sidewall Insulation
- Ez Flex Dexter Axles Easylube Axles W/ Nev-R Adjust Brakes
- 16" Wheels W/Nitro Fill Tires

### INTERIOR

- Large Frameless Tinted Windows Throughout
- Hidden Hinges
- Dovetail Constructed Reinforced Doors And Drawers With Upgraded Hardware
- Upgraded Crack/Mold/Mildew-Resistant Flooring

- Upgrade True Solid Surface Countertops (Kitchen Only)
- Led Lights
- Solid Wood Slide Fascia
- 24 Ounce Carpet
- Pleated Day/Night Shades
- Large Entry Closet For Jacket / Shoe Storage (86FK)

### EXTERIOR

- Slam Latches On All Storage Doors
- Magnetic Compartment Door Holds
- Painted Fiberglass Front Cap With Window
- Utility Convenience Center
- Black Tank Flush
- Portable Water Proof Speaker W/Docking Station
- Electric Rear Stabilizer Jacks
- Outside Shower
- 2-30 Lb Lp Tanks With Auto Switch
- Full View Entry Door W/Window And Screen Door
- Power Awning W/Led Lighting
- 6000 Lb Axles
- Crank Down Spare Tire
- Flip Down Bike Rack
- White Exterior Sidewalls

### FURNITURE

- Power W/Usb Charging Residential Theater Seating W/Storage
- Oversized Sleeper Chair (86FK)
- Residential High End Dining Chairs With Storage

### BEDROOM

- Tv Hook Ups
- High End Bedspread / Pillows
- C-Pap Shelves

### APPLIANCES

- Upgrade 8 Cu Ft Refrigerator W/Adjustable Temp Settings And Raised Panel Doors
- 10 Gallon Water Heater W/Quick Recovery
- Washer / Dryer Prep
- 30" Residential Microwave
- 15000 Btu Coleman Serenity A/C
- 35000 Btu Furnace

### KITCHEN

- Pantry
- Storage For Sink Covers
- Recessed Solid Surface Sink Covers
- Residential Under Counter Storage

- Recessed Solid Surface Range Cover
- Residential Glass Backsplash
- Additional Lighting Above Sink Area
- Large Double Bowl Stainless Steel Sink
- Single Lever Faucet W/Pull Out Sprayer
- Trash Can With Dedicated Storage

### BATHROOM

- 48"X30" One Piece Fiberglass Shower W/Seat & Built In Shelves For Toiletries
- 3 Speed Power Vent
- Porcelain Toilet

### OPTIONS

- 13.5 Coleman Serenity Bedroom A/C
- Electric Fireplace
- 4 Slide Toppers
- 4 Point Electric Level Up
- Stackable Washer / Dryer
- Dual Pane Windows
- Keyless Entry Door Lock
- Mcd Uv Reflective Day Shades
- 32" Bedroom Led Tv W/Sound Bar
- 32" Bunkroom Led Tv (77Mb)
- 20Cu Ft Residential Refrigerator W/Inverter

- 12 Cu Ft Gas Electric Refrigerator
- King Bed
- Wood-Look Floor
- Tile-Look Floor
- Wireless Back Up Camera
- Metal Wrapped Awning
- 200 Watt Solar Panel (Installed) W/2 Batteries

Castaway Package (Forced Option) Includes:  
Full System Water Purifier, 50" Led Tv, Battery Disconnect, Electric Fireplace, Memory Foam Mattress, Sound Bar, Wireless Speaker, Hardwood Slide-Out Fascia, 2-Tone Aluminum Wheels, E-Rated Tires, 12V Heat Pads On All Tanks, Led Awning Lights, Syphon 360 Vent Covers, Pleated Day/Night Shades, 36" 4 Step Entry W/Handle, 36" Friction Hinge Entry Door, Go Power Solar Prep, Pull Down Faucet, My Rv System

# PALOMINO

COLUMBUS BY PALOMINO  
A Division Of Forest River, Inc.  
105-1/2 C.R. 14 • Middlebury, In 46540  
www.palominorv.com



**Learn More**  
Scan this barcode using a QR Reader on your smart phone to learn more about Forest River.



A Berkshire Hathaway company.

All information contained in this brochure is believed to be accurate at the time of publication. However, during the model year, it may be necessary to make revisions and Forest River, Inc., reserves the right to make all such changes without notice, including prices, colors, materials, equipment and specifications as well as the addition of new models and the discontinuance of models shown in this brochure. Therefore, please consult with your Forest River, Inc., dealer and confirm the existence of any materials, design or specifications that are material to your purchase decision.  
© 2019 Palomino RV. A division of Forest River, Inc., Berkshire Hathaway Company. 09/19 Columbus