

# FOREST RIVER VIBE





# MORE NEW STANDARD FEATURES ON EVERY VIBE!



## EXTERIOR STANDARD FEATURES

- E-Z LUBE AXLES
- HYPER LYTE CONSTRUCTION, AMAZINGLY LIGHT!!
- GEL COAT FIBERGLASS WITH CONTEMPORARY GRAPHICS PACKAGE
- LAMINATED "ALUMA FRAME" SIDE WALLS AND 2" LAMINATED FLOOR
- AERODYNAMIC FIBERGLASS FRONT CAP
- DUCTED 13.5 BTU AIR CONDITIONING
- HIGH EFFICIENCY A/C COOLING SYSTEM (LARGER DUCT WORK)
- CABLE & SATELLITE PREP
- DIGITAL TV ANTENNA W/BOOSTER
- EXTRA LARGE, ALUMINUM FRAMED, PASS THRU STORAGE
- ONE TOUCH ELECTRIC AWNING
- LED LIGHTED EXTERIOR SPEAKERS (2)
- XL GRAB HANDLE
- SAFE RIDE RV ROADSIDE ASSISTANCE
- HEATED AND ENCLOSED UNDERBELLY
- STABILIZER JACKS
- 2- 20# LP BOTTLES

## INTERIOR STANDARD FEATURES

- GLASS IN KITCHEN CABINETS
- 3-BURNER COOK TOP W/BLACK STAINLESS STEEL OVEN
- DOMETIC DOUBLE DOOR 6 CU. FT. GAS/ELECTRIC REFRIGERATOR W/STAINLESS FRONT
- 6 GAL. G/E DSI WATER HEATER
- DOMETIC PEDAL FLUSH TOILET
- THERMOFOIL WRAPPED KITCHEN COUNTERTOPS
- DELUXE WOOD BOOTH TABLE TOP
- FULL 80" CEILING
- HARD DOORS TO BEDROOMS FOR PRIVACY (NOT CURTAINS)
- DECORATIVE KITCHEN BACKSPLASH
- LARGE TRASH CAN W/DESIGNATED OUT-OF-THE-WAY AREA
- UPGRADED RESIDENTIAL STYLE CARPET
- FULL EXTENSION BALL BEARING DRAWER GUIDES

## FAMILY CAMPING PACKAGE

- FLUSH-MOUNT KITCHEN SINK COVER
- FLIP-UP COUNTERTOP EXTENSION (NOT AVAILABLE ON ALL FLOORPLANS)
- 2 - POTS/PANS DRAWERS
- SKYLIGHT OVER TUB
- FANTASTIC FAN
- SECOND BUNK WINDOW (NOT AVAILABLE ON ALL FLOORPLANS)
- COAT RACK
- BLACK TANK FLUSH
- RADIAL TIRES
- ALUMINUM WHEELS
- SPARE TIRE & CARRIER
- OUTSIDE SHOWER
- TEDDY BEAR BUNK MATS (NOT AVAILABLE ON ALL FLOORPLANS)
- UPGRADED HIDDEN HINGES ON CABINET DOORS
- BATTERY DISCONNECT

## PREMIUM PACKAGE

- SOLIDSTEP TRIPLE STEP (MAIN ENTRANCE ONLY)
- SEAMLESS COUNTERTOP WITH UNDERMOUNT SINGLE BOWL STAINLESS STEEL SINK & DESIGNER PULL-OUT FAUCET
- UPGRADED PILLOWTOP MATTRESS
- BLUETOOTH MP3/DVD/CD/ FM W/SOUND BAR
- SOLAR PANEL PREP
- POWER TONGUE JACK
- BACKUP CAMERA PREP
- LED AWNING LIGHT
- NEW TRUE STABILIZER JACKS W/JT STRONG ARMS
- ELECTRIC FIREPLACE W/CRYSTALS (NOT AVAILABLE ON ALL FLOORPLANS)
- UPGRADED BLACK/STAINLESS STEEL APPLIANCE PACKAGE
- DECORATIVE WINDOW TREATMENTS (LIVING ROOM ONLY)
- NIGHT SHADES
- 30" FRICTION HINGE ENTRY DOOR
- USB PORT PACKAGE

## PREMIUM PACKAGE [CONTINUED]

- LED INTERIOR LIGHTS
- MAGNETIC LATCHES ON ACCESS DOORS

## OPTIONS

- BACK PACK RACK
- 8 CU. FT. REFRIGERATOR
- 30# LP BOTTLES W/COVER
- OUTSIDE KITCHEN W/GRILL, FRIDGE, SINK W/DRAIN & METAL COUNTERTOP
- 12V HEATED STRIPS ON HOLDING TANKS
- TRI-FOLD SOFA SLEEPER
- 40" FLAT SCREEN TV
- 15K BTU DUCTED A/C IPO 13/5K
- 50 AMP SERVICE W/WIRE & BRACE FOR 2ND A/C
- 2ND 13.5K A/C IN BEDROOM (REQUIRES 50 AMP)
- 200 WATT SOLAR PANEL W/REGULATOR

## COUPLES COACH TRAVEL TRAILERS

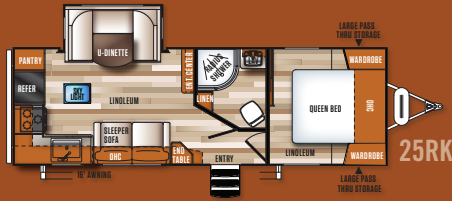

25RK

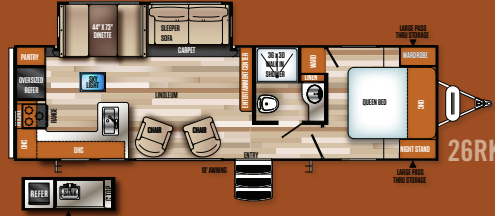

26RK

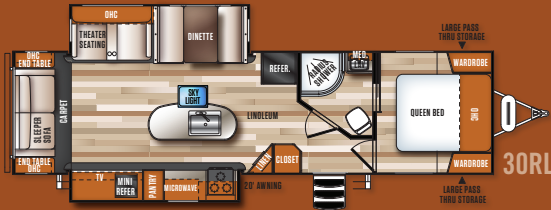

30RL



22RB



24RL



28RB

## FOREST RIVER VIBE

## BUNKHOUSE TRAVEL TRAILERS

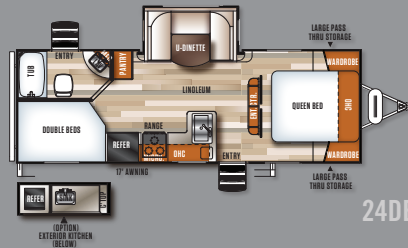

24DB



26BH

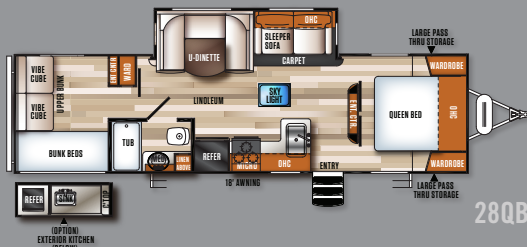

28QB



31BH

### COUPLES COACH TRAVEL TRAILERS

### BUNKHOUSE TRAVEL TRAILERS

MODEL	22RB	24RL	25RK	26RK	28RB	30RL	24DB	26BH	28QB	31BH
HITCH WEIGHT (lbs.)	536	633	611	768	840	750	629	755	896	866
UVW	5202	5627	5527	6684	7158	7392	5831	6053	6702	7608
CCC (CARGO CAP.)	2334	2006	2084	2884	2482	2158	1796	1702	2994	2058
EXTERIOR LENGTH	26' 0"	28' 10"	29' 10"	34' 8"	33' 2"	35' 10"	28' 8"	32' 10"	35' 1"	36' 10"
EXTERIOR HEIGHT	10' 10"	10' 10"	10' 10"	10' 10"	11' 0"	11' 2"	10' 10"	10' 10"	11' 0"	11' 0"
FRESH WATER (gal.)	44	45	44	44	44	44	44	44	44	44
BLACK WATER (gal.)	32	32	33	33	33	33	33	32	33	33
GREY WATER (gal.)	64	64	66	66	64	66	66	64	66	66
AWNING SIZE	16'	18'	16'	20'	18'	20'	17'	19'	18'	18'
TIRE SIZE	15"	14"	14"	15"	15"	15"	15"	15"	15"	15"





#### PRE-DELIVERY INSPECTION FACILITY

20,000 square feet of quality assurance. The bare essentials for a premium product. This state-of-the-art facility gives immediate daily feedback to production for quality assurance in every unit built.

#### CUSTOMER SATISFACTION



[www.ForestRiverBuyLocal.com](http://www.ForestRiverBuyLocal.com)

**24/7 EMERGENCY  
ROADSIDE ASSISTANCE  
WITH VEHICLE PURCHASE\***

---

TOWING  
JUMP-STARTS  
TIRE CHANGES  
FLUID DELIVERY  
LOCKOUT  
SERVICE

WINCH-OUT  
MOBILE MECHANIC  
TECHNICAL  
SUPPORT  
DEALER LOCATOR  
SERVICES

\*VALID FOR 1 YEAR FROM DATE OF PURCHASE

**FREE MEMBERSHIP**  
to Forest River Owners' Group

[www.forestriverfrog.com](http://www.forestriverfrog.com)

GVWR (Gross Vehicle Weight Rating) - is the maximum permissible weight of the unit when fully loaded. It includes all weights, inclusive of all fluids, cargo, optional equipment and accessories. For safety and product performance do NOT exceed the GVWR.

GAWR (Gross Axle Weight Rating) - is the maximum permissible weight, including cargo, fluids, optional equipment and accessories that can be safely supported by a combination of all axles.

UVW (Unloaded Vehicle Weight)\* - is the typical weight of the unit as manufactured at the factory. It includes all weight at the unit's axle(s) and tongue or pin and LP Gas. The UVW does not include cargo, fresh potable water, additional optional equipment or dealer installed accessories.

\*Estimated Average based on standard build optional equipment.

CCC (Cargo Carrying Capacity)\*\* - is the amount of weight available for fresh potable water, cargo, additional optional equipment and accessories. CCC is equal to GVWR minus UVW. Available CCC should accommodate fresh potable water (8.3 lbs per gallon). Before filling the fresh water tank, empty the black and gray tanks to provide for more cargo capacity.

\*\* Estimated average based on standard build optional equipment

Each Forest River RV is weighed at the manufacturing facility prior to shipping. A label identifying the unloaded vehicle weight of the actual unit and the cargo carrying capacity is applied to every Forest River RV prior to leaving our facilities.

The load capacity of your unit is designated by weight, not by volume, so you cannot necessarily use all available space when loading your unit.

All information contained in this brochure is believed to be accurate at the time of publication. However, during the model year, it may be necessary to make revisions and Forest River, Inc., reserves the right to make all such changes without notice, including prices, colors, materials, equipment and specifications as well as the addition of new models and the discontinuance of models shown in this brochure. Therefore, please consult with your Forest River dealer and confirm the existence of any materials, design or specifications that are material to your purchase decision.

**FOREST RIVER**  
**VIBE**



#### Learn More

Scan this barcode using a QR Reader on your smart phone to learn more about Forest River.



A Berkshire Hathaway company.

#### VIBE

1429 SE Uglow Ave, Dallas, OR 97338  
(503) 831-1200  
[www.forestriverinc.com/VIBE](http://www.forestriverinc.com/VIBE)  
[www.forestriveraccessories.com](http://www.forestriveraccessories.com)

#### YOUR LOCAL VIBE DEALER