

Carbon

TOY HAULERS

BUILT FOR

# THE ROAD AHEAD



FALL PREVIEW



Keystone RV  
Company

# The ultimate ownership experience.

The goal of Keystone RV Company is to surprise and delight our owners at each and every touchpoint. We're happy when our campers are happy, and we are committed to providing the very best ownership experience in the industry.



## 1 EASIER SHOPPING.

At Keystone, we make choosing an RV as easy as finding the Big Dipper on a dark summer night. With comprehensive online product information, Key Connect™ product advisors, and an unparalleled dealer network, we will help you select the perfect RV for your family's adventure.

## 2 INNOVATIVE THINKING.

The road's a nicer place when you have the industry's smartest features behind you. Keystone leads the pack in patented innovations that make our RVs safer, more comfortable, and easier to operate.

## 3 LONG HAUL QUALITY.

To keep you on the road, there are certain things we just won't build a Keystone RV without. Game-changing features like our Unified Wiring Standard, Tru-Fit™ five-point slide construction, and no-fail Tuf-Lok™ A/C duct joiners combined with exhaustive testing and inspections are some of the reasons why Keystone is able to offer our owners the industry's best 3-year limited structural warranty.

## 4 WORRY-FREE CUSTOMER SERVICE.

Wherever the road takes you, you're never too far from an authorized Keystone service center. We also offer live service assistance, ultra-fast parts shipping, online maintenance tips and tricks, and a single-point warranty claims policy. *That's* peace of mind.

## 5 KEYSTONE NATION.

When you choose Keystone, you become one of the largest camping families in the country. We're Keystone Nation. A friendly community where people share photos, travel tips and amazing stories – all in the spirit of camaraderie and adventure. Come join us.

Experience the Carbon lifestyle by visiting [#keystonecarbon](#)



# CARBON



---

## TOY HAULERS

---

### Never stop exploring.

Regardless if you're traveling down a dirt road to the dunes or the interstate to a theme park, Carbon is built for the road ahead. Equipped with all of the essentials for the road less traveled, Keystone RV's Carbon is a lighter weight and more affordable toy hauler, making it an enticing option for weekend warriors. With features like frame-welded tie-downs, painted front cap and floorplans built for entertaining, these haulers have brawn, brains and beauty that will thrill even the most seasoned adventurers.

For more information, please visit [keystonerv.com/carbon](http://keystonerv.com/carbon)



more product detail at  
[www.keystonerv.com/Carbon](http://www.keystonerv.com/Carbon)

## Carbon | TOYHAULERS

- EXCLUSIVE Omni-Chill™ technology, high efficiency A/C's for maximum cooling
- 5,000 lb. frame-welded tie-downs
- Solar panel prep on roof, standard
- 78" main entry door (largest height in the industry)
- Painted front cap
- Soft-close hardwood cabinet doors
- Furrion® backup camera prep
- Stainless steel appliances
- Dexter® E-Z Lube® 7,000 lb. axles with electric self-adjusting brakes
- 6-point hydraulic leveling system
- Solid-surface kitchen countertops
- Reclining furniture with heat, light and massage
- USB outlets in all sofa slide-outs
- 12 cu. ft. refrigerator (select models)
- F-rated tires
- Dyna Span® floor decking with 25-year warranty
- Dual-entry in every master bathroom
- Furrion® WiFi antenna
- 8' ramp door with spring-assist
- Three-zone stereo with DVD player
- KeyTV™ Keystone's revolutionary single-source, easy-to-use controller for over-the-air, cable and satellite television



### EXCLUSIVE Omni-Chill™

Simultaneous operation of three A/C units for max cooling (up to 8° cooler in lab testing)



### Frame-welded tie downs

Industry-leading 5,000 lb. capacity tie-downs for increased safety and security



### A Key Performance™ brand

Dedicated toy hauler design and manufacturing team to deliver a higher standard of durability and performance



### Automotive-grade painted caps

KeyGuard chip and rock protection



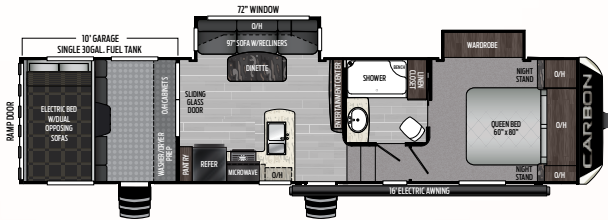

**337** | Tandem-axle, two slides, 10' garage  
Weight: 11710 LBS. | Length: 35' 11"

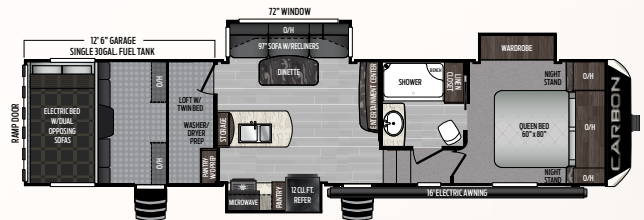

**347** | Tandem-axle, three slides, 12' 6" garage  
Weight: 12551 LBS. | Length: 38' 2"

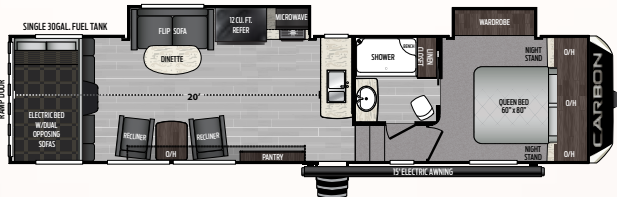

**349** | Open concept, tandem-axle, two slides, 20' garage  
Weight: 11417 LBS. | Length: 36' 11"

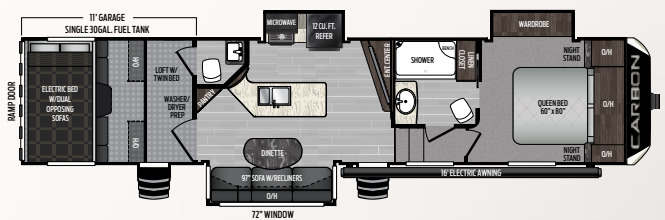

**357** | Tandem-axle, three slides, 1 1/2 bath, 11' garage  
Weight: 12842 LBS. | Length: 38' 11"

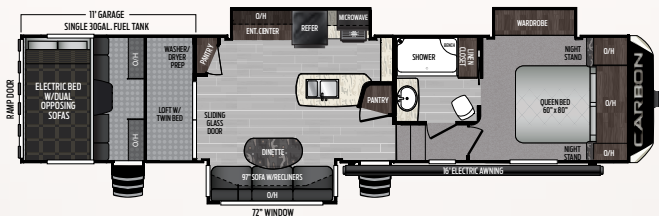

**364** | Tandem axle, three slides, 11' garage  
Weight: 12786 LBS. | Length: 38' 11"

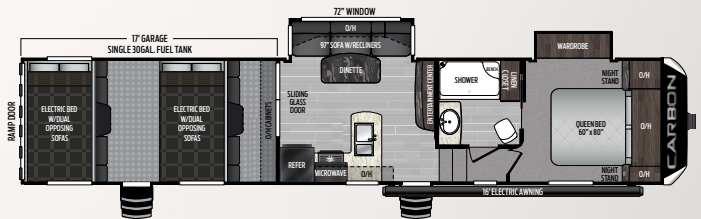

**387** | Triple-axle, two slides, 17' garage  
Weight: 13495 LBS. | Length: 42' 8"

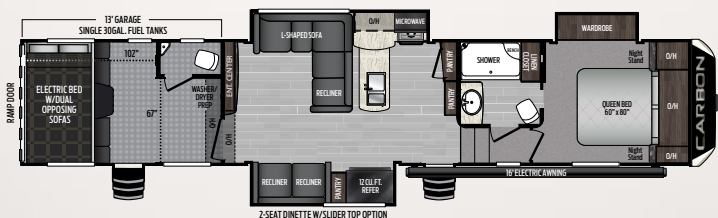

**403** | L-shaped sofa, 1 1/2 bath, triple-axle, 13' garage  
Weight: 14090 LBS. | Length: 43' 6"

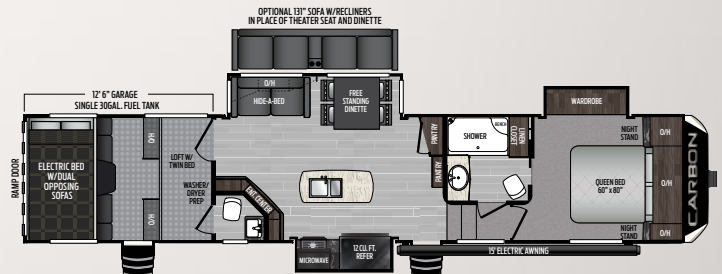

**417** | Island kitchen, 1 1/2 bath, triple-axle, 12' 6" garage  
Weight: 14116 LBS. | Length: 43'

## TOY HAULERS

MODEL	WEIGHT	CARRYING CAPACITY	HITCH WEIGHT	FRESH WATER	WASTE WATER	GRAY WATER	LPG	LENGTH*	WIDTH	HEIGHT	AWNING
337	11710	5045	2755	106	44	82	60	35' 11"	13' 2"	20'	20'
347	12551	4449	3050	106	44	82	60	38' 2"	13' 2"	15'	15'
349	11417	5303	2720	106	44	82	60	36' 11"	13' 2"	18'	18'
357	12842	4158	3060	106	82	82	60	38' 11"	13' 2"	15'	15'
364	12786	4214	3010	106	82	82	60	38' 11"	13' 2"	15'	15'
387	13495	5505	3260	106	44	82	60	42' 8"	13' 6"	20'	20'
403	14090	4910	3410	106	82	82	60	43' 6"	13' 6"	15'	15'
417	14116	4884	3385	106	82	82	60	43' 0"	13' 6"	15'	15'

DISCLAIMER: Product information is as accurate as possible as of the date of publication of this brochure. All features, floor plans, and specifications in this brochure are subject to change without notice. Please also consult Keystone's web site at [www.keystonerv.com](http://www.keystonerv.com) for more current product information and specifications. Tow Vehicle Disclaimer. CAUTION: Owners of Keystone recreational vehicles are solely responsible for the selection and proper use of tow vehicles. All customers should consult with a motor vehicle manufacturer or their dealer concerning the purchase and use of suitable tow vehicles for Keystone products. Keystone disclaims any liability or damages suffered as a result of the selection, operation, use or misuse of a tow vehicle. KEYSTONE'S LIMITED WARRANTY DOES NOT COVER DAMAGE TO THE RECREATIONAL VEHICLE OR THE TOW VEHICLE AS A RESULT OF THE SELECTION, OPERATION, USE OR MISUSE OF THE TOW VEHICLE. \*Length is defined as the distance from the centerline of hitch pin/coupler to rear bumper of trailer.



more product detail at  
[www.keystonerv.com/Carbon](http://www.keystonerv.com/Carbon)

## STANDARDS AND OPTIONS

INTERIOR	EXTERIOR
Omni-Chill™ high efficiency A/C's	Rota Flex pin box
5,000 lb. frame-welded tie-downs	Solar-panel prep on roof
Residential reclining furniture with heat, light, and massage	WiFi antenna
USB outlets in sofa slide-outs	Backup camera prep
Stainless steel 12 cu. ft. refrigerator (select models)	F-Rated Tires
Quick-recovery 12-gal. gas/electric DSI water heater	Convenience center (central location all system hook-ups)
Residential microwave	Outside shower—hot and cold with 25' coil hose
Stainless steel, 3-burner range w/ 22" oven	Black tank flush
Upgraded kitchen high-rise faucet	30 gallon Generator fuel tank with fuel station
Square, stainless steel sink	Exterior cable/satellite TV hook-up
Roll-up sink cover/drying rack	Rear LED spotlights
Solid surface kitchen countertops	Outdoor LED activity light
Soft-close hardwood cabinet doors	One-Touch electric awning with LED lighting
100 lb. full-extension, ball-bearing drawer guides	E-Z® radius steps
Night shades	Large, tinted safety glass windows (80% tint)
Power vent in master bathroom	Heated and lighted pass-through storage
Porcelain foot-flush toilet	Aluminum roof ladder
Fiberglass one-piece shower surround	Rain gutters with extended drip spouts
Shower skylight	Aluminum RAM air ventilation system (in garage)
Residential wood interior passage door	Painted front cap with LED recessed lighting
Cable TV and satellite prep	Spare tire
TV antenna with booster	Dexter® E-Z Lube® 7,000 lb. axles
Bedroom TV hook-up	12"x 2" self-adjusting brakes
Control panel with fuel gauge	Premium 8-lug 16" radial tires
Removable edged cargo carpet	Heated and enclosed underbelly
Automatic transfer switch with generator prep	Double welded aluminum construction
Battery quick-disconnect	8' spring-assisted ramp door
50 AMP service	Upgraded graphics with 5-year warranty
Ducted A/C (in garage)	5" pre-engineered roof truss rafters
LED lighting	One-piece TPO (12-year warranty)
Electric beds with dual opposing flip-down sofas	Electric front and rear jacks
Dyna Span® floor decking (25-year warranty)	12" I-Beams (select models)
50" LED HDTV in living room	78" main entry door with built-in shade
Interior speakers (4)	Large entry door grab handle
Exterior marine speakers (2)	
3-zone stereo with DVD player	<b>OPTIONS</b>
35,000 BTU furnace	Onan® 5,500 watt generator
Washer/dryer prep	Frameless dual-pane windows
Carbon monoxide detector	Rear patio with awning and patio steps
Smoke detector	6 point hydraulic level-up
LP gas detector	Three-season patio door (replaces pull-down screen)
Fire extinguisher	Front electric beds with dual opposing sofas (387 only)
Pull-down screen in cargo area	131" sofa in place of dinette and dual recliners (417 only)
	Dinette seat with slider-top (403 only)

# BUILT FOR THE LONG HAUL



PRINT 8.2018



**Keystone RV  
Company**