

Outback

PREMIUM TRAVEL TRAILERS
ULTRA-LITE TRAVEL TRAILERS

ADVENTURE ELEVATED



FALL PREVIEW



Keystone RV
Company

The ultimate ownership experience.

The goal of Keystone RV Company is to surprise and delight our owners at each and every touchpoint. We're happy when our campers are happy, and we are committed to providing the very best ownership experience in the industry.



**Keystone RV
Company**

1 EASIER SHOPPING.

At Keystone, we make choosing an RV as easy as finding the Big Dipper on a dark summer night. With comprehensive online product information, Key Connect™ product advisors, and an unparalleled dealer network, we will help you select the perfect RV for your family's adventure.

2 INNOVATIVE THINKING.

The road's a nicer place when you have the industry's smartest features behind you. Keystone leads the pack in patented innovations that make our RVs safer, more comfortable, and easier to operate.

3 LONG HAUL QUALITY.

To keep you on the road, there are certain things we just won't build a Keystone RV without. Game-changing features like our Unified Wiring Standard, Tru-Fit™ five-point slide construction, and no-fail Tuf-Lok™ A/C duct joiners combined with exhaustive testing and inspections are some of the reasons why Keystone is able to offer our owners the industry's best 3-year limited structural warranty.

4 WORRY-FREE CUSTOMER SERVICE.

Wherever the road takes you, you're never too far from an authorized Keystone service center. We also offer live service assistance, ultra-fast parts shipping, online maintenance tips and tricks, and a single-point warranty claims policy. *That's* peace of mind.

5 KEYSTONE NATION.

When you choose Keystone, you become one of the largest camping families in the country. We're Keystone Nation. A friendly community where people share photos, travel tips and amazing stories – all in the spirit of camaraderie and adventure. Come join us.

Experience the **Outback** lifestyle by visiting [#keystoneoutback](#)



OUTBACK



PREMIUM TRAVEL TRAILERS | ULTRA-LITE TRAVEL TRAILERS

Designed to exceed expectations.

Uncommon comfort. Stunning features. Innovative amenities. At Keystone Outback, details matter. We are passionate about crafting each and every one of our full-sized and ultra-lite travel trailers to include inventive details that surprise and delight our owners. From small things, like new built-in pet kennels (in most models)—to big things, like larger windows that bring in the natural beauty of the outside. Outback continues to redefine the camping adventure.

For more information, please visit keystone.com/outback



more product detail at
www.keystonerv.com/Outback

Outback | PREMIUM TRAVEL TRAILERS

- Durable automotive-grade painted front caps
- Drop-frame design on 300ML, 340BH and 335CG models with 25% more pass-through storage
- All baggage storage doors with metal slam latches
- Rock Run pull-out storage racks on 328RL, 330RL, and 341RD models
- Ultra-stable and secure MORryde® Step Above™ steps on main entries
- Extended living space with adjustable awnings on all models and a second awning on 328RL and 300ML models
- Convenient, integrated command center for power tongue jack and stabilizer jacks with optional auto-leveling upgrade
- All-new designer-inspired décor featuring contemporary finishes, islands, solid surface countertops, tile backsplash and feature walls
- KeyTV™ Keystone's revolutionary single-source, easy-to-use controller for over-the-air, cable and satellite television
- 50" televisions in (most models)
- Stunning 48" fireplaces (N/A 335CG)
- More usable counter space with Furrion® flush-mounted glass cooktop and 21" oven
- Galley slide rooms redesigned with easy-to-clean flooring
- Pull-out trash bins (300ML and 341RD models)
- Pop-up power blocks with 110V and USB outlets on free-standing tables and booth dinettes
- 30" x 40" bedroom picture window
- 60" x 80" mattresses (300ML, 335CG, and 340BH models)
- Pet kennels built into all bed bases
- Digital thermostat



MORryde® Step Above™

Total control over HVAC, awnings, lights and monitoring system from your smartphone



Furrion® Kitchen Appliances

Modern aesthetics and precise performance



EXCLUSIVE KeyTV™

Game-changing single-point control of over-the-air, cable and satellite feeds

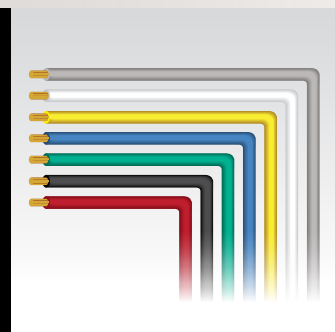

EXCLUSIVE color-coded Unified Wiring Standard

Easy-to-trace circuits simplifies and expedites electrical and entertainment system troubleshooting

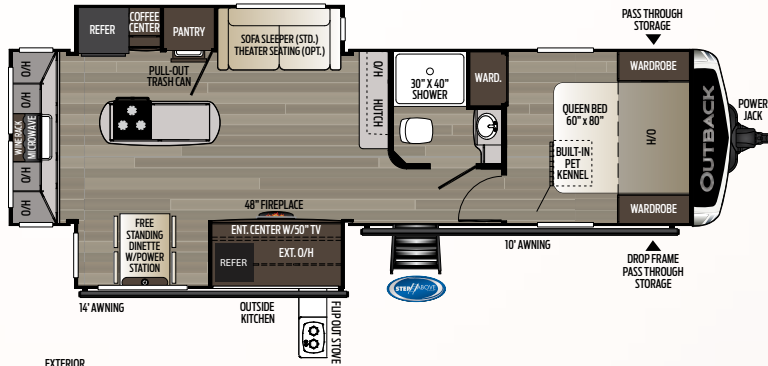

300ML

Mid-living room, two slides
Weight: 8095 LBS. | Length: 34' 3"

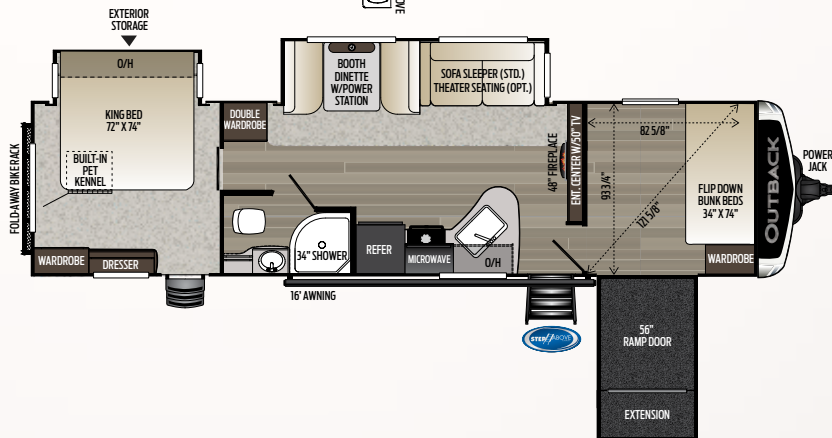

324CG

Cargo garage, two slides
Weight: 7967 LBS. | Length: 37' 4"

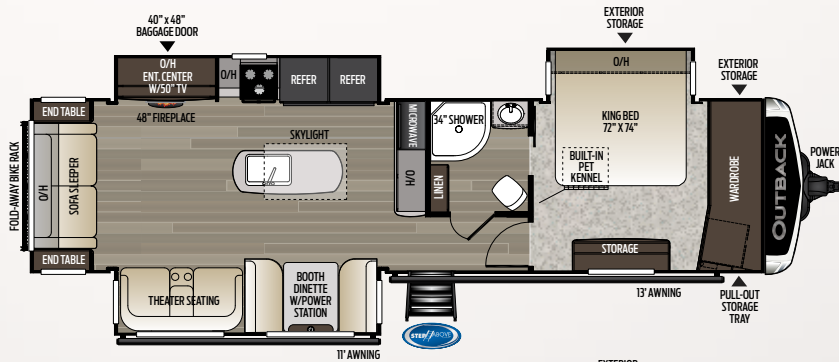

328RL

Rear living, three slides-inc. bedroom
Weight: 8680 LBS. | Length: 37' 10"

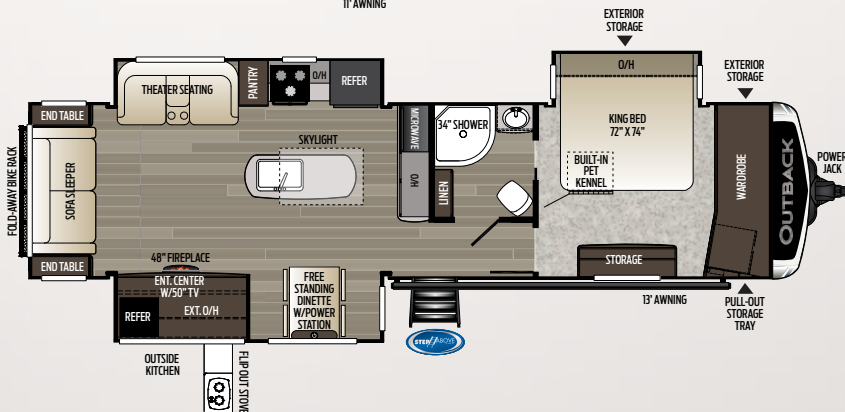

330RL

Rear living, three slides, outside kitchen
Weight: 8818 LBS. | Length: 37' 10"

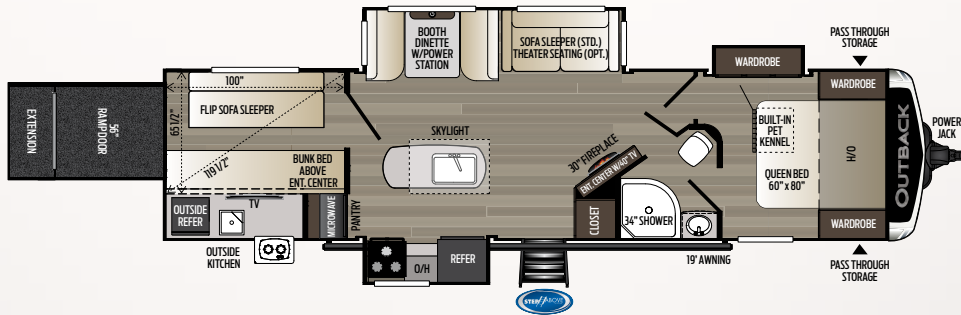

335CG

Cargo garage, two slides

Weight: 8245 LBS. | Length: 36' 5"

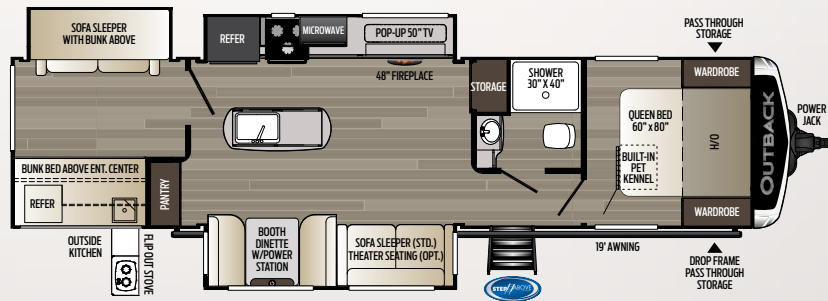

340BH

Three-slide bunkhouse, outside kitchen

Weight: 8660 LBS. | Length: 38' 5"

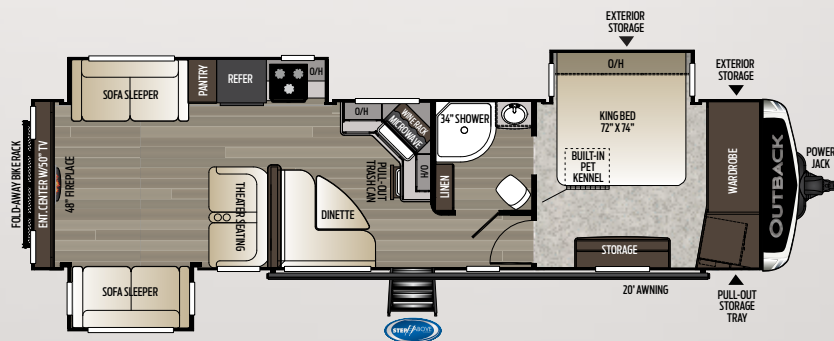

341RD

Rear den entertainment, three slides

Weight: TBD | Length: 38' 9"



more product detail at
www.keystonerv.com/Outback

Outback | ULTRA-LITE PREMIUM TRAVEL TRAILERS

- Durable automotive-grade painted front caps
- Ultra-stable and secure MORryde® Step Above™ steps on main entries
- Extended living space with adjustable awnings (all models)
- ASA back-up camera prep
- Friction-hinge entry doors
- 33% larger, 30-pound propane tanks on all models
- 28% larger, 60-gallon fresh water tanks on all models
- All-new designer-inspired décor featuring contemporary finishes, tile backsplash and feature walls
- KeyTV™ Keystone's revolutionary single-source, easy-to-use controller for over-the-air, cable and satellite television
- More usable counter space with Furrion®'s flush-mounted glass cooktop and low-profile hood vent
- LED accent lighting in dinette
- Pull-out trash bins (221UMD and 280URD models)
- Pop-up power blocks with 110v and USB outlets on free-standing tables and booth dinettes (n/a in the 210URS, 240URS, and 272UFL models)
- Porcelain toilets
- 60" x 80" mattresses (221UMD, 260UML, 261UBH, 280URB, 299URL, 301UBH models)
- Pet kennels built into bed bases (N/A 210URS, 240URS)
- Laundry chutes (N/A 210URS, 240URS, 272UFL)
- Digital thermostats



Furrion® Kitchen Appliances
Modern aesthetics and precise performance



EXCLUSIVE KeyTV™
Game-changing single-point control of over-the-air, cable and satellite feeds



EXCLUSIVE color-coded Unified Wiring Standard
Easy-to-trace circuits simplifies and expedites electrical and entertainment system troubleshooting

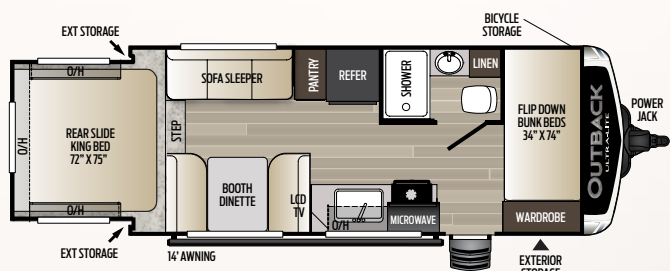

210URS | Double bunkhouse, rear bedroom slide
Weight: 4475 LBS. | Length: 23'

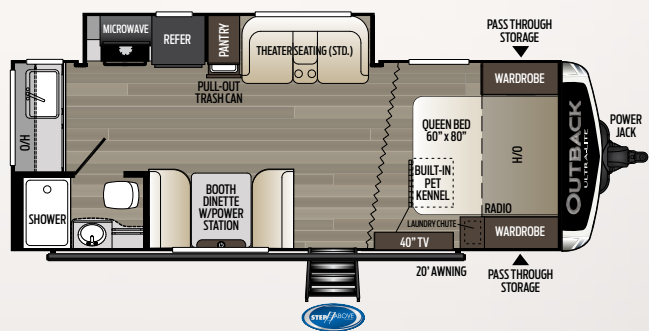

221UMD | Mid-dinette, rear bath
Weight: 4925 LBS. | Length: 26' 10"

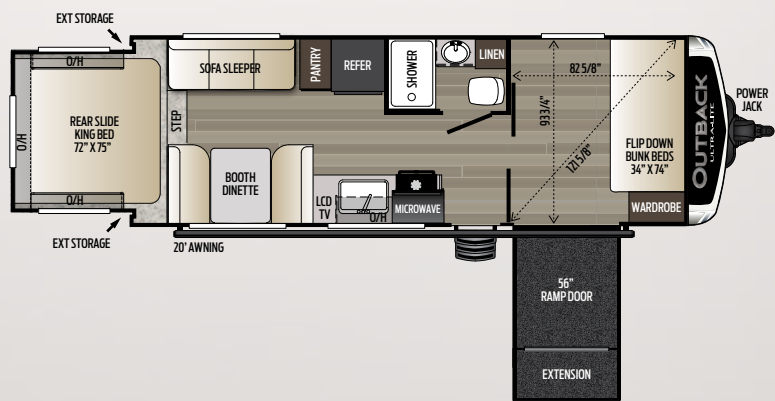

240URS | Cargo garage, rear bedroom slide
Weight: 5155 LBS. | Length: 28' 3"

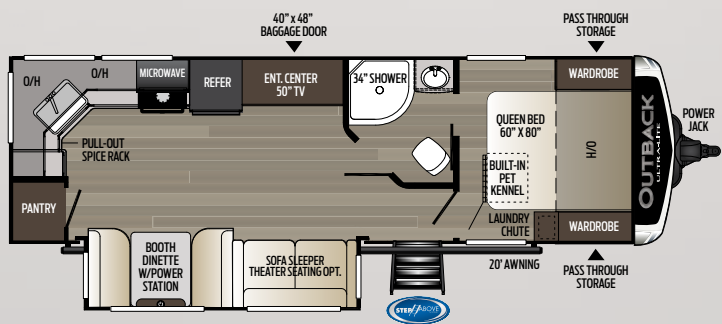

260UML | Mid-living room, rear kitchen
Weight: 5605 LBS. | Length: 30' 6"

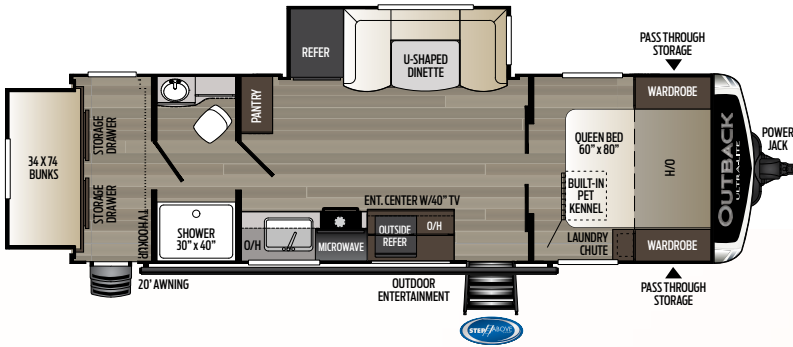

261UBH

Rear-slide bunkhouse

Weight: 5830 LBS. | Length: 30' 11"

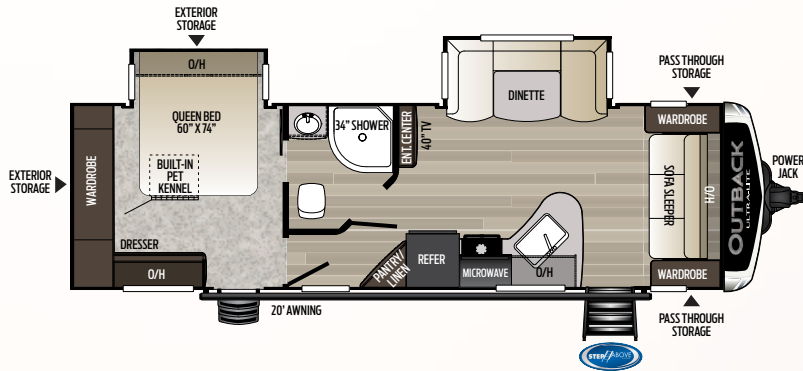

272UFL

Front living, two slides-inc. bedroom

Weight: 5970 LBS. | Length: 31' 9"

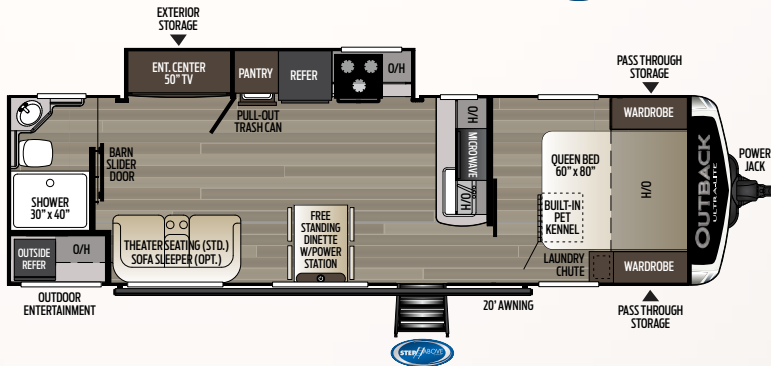

280URB

Rear bath, mid-living, outside entertainment

Weight: 5815 LBS. | Length: 32' 6"

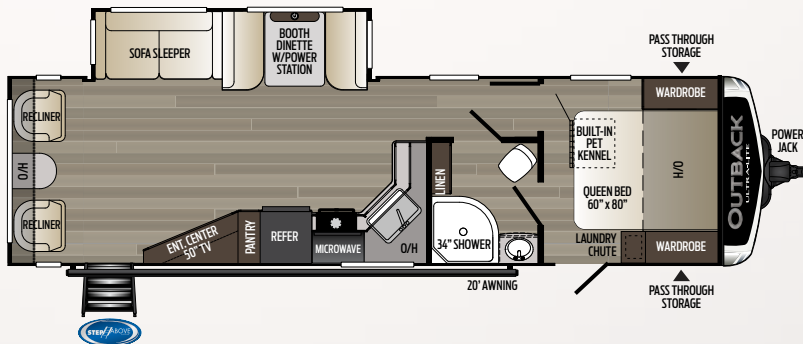

299URL

Rear living, dual entry bath

Weight: 5998 LBS. | Length: 33' 11"

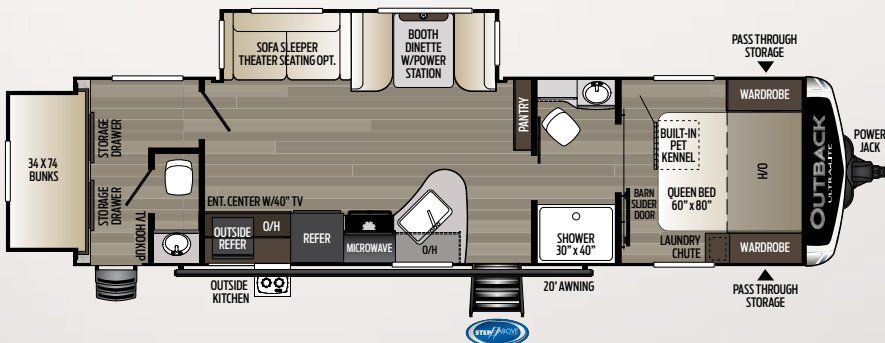

301UBH

Rear-slide bunkhouse, 1/2 bath

Weight: 6975 LBS. | Length: 34' 9"

Outback

MODEL SPECIFICATIONS

FULL-PROFILE PREMIUM TRAVEL TRAILERS

MODEL	WEIGHT	CARRYING CAPACITY	HITCH WEIGHT	FRESH WATER	WASTE WATER	GRAY WATER	LPG	LENGTH*	WIDTH	HEIGHT	AWNING
300ML	8095	1405	700	60	38	76	60	34' 10"	8'	11' 4"	14'/10'
324CG	8006	2494	870	60	38	76	60	37' 4"	8'	11' 4"	20'
328RL	8718	1782	1075	60	38	76	60	37' 10"	8'	11' 4"	11'/13'
330RL	8803	1697	1100	60	38	76	60	37' 10"	8'	11' 4"	13'
335CG	8109	2391	1180	60	38	76	60	37'	8'	11' 4"	19'
340BH	8660	1840	1220	60	38	76	60	38' 8"	8'	11' 4"	20'
341RD	TBD	TBD	TBD	60	38	76	60	38' 8"	8'	11' 4"	19'

ULTRA-LITE PREMIUM TRAVEL TRAILERS

MODEL	WEIGHT	CARRYING CAPACITY	HITCH WEIGHT	FRESH WATER	WASTE WATER	GRAY WATER	LPG	LENGTH*	WIDTH	HEIGHT	AWNING
210URS	4536	1964	485	60	30	30	60	23'	8'	10' 7"	14'
221UMD	4925	2275	495	60	30	30	60	27'	8'	10' 7"	19'
240URS	5081	2509	590	60	30	30	60	28' 3"	8'	10' 7"	20'
260UML	5605	1995	600	60	30	60	60	30' 6"	8'	10' 7"	20'
261UBH	5830	1770	575	60	30	30	60	30' 11"	8'	10' 7"	20'
272UFL	6035	1565	660	60	30	30	60	31' 9"	8'	10' 7"	19'
280URB	5815	1785	610	60	30	60	60	32' 6"	8'	10' 7"	20'
299URL	5998	1692	695	60	30	60	60	33' 11"	8'	10' 7"	20'
301UBH	6975	2025	690	60	60	60	60	34' 9"	8'	10' 7"	20'

DISCLAIMER: Product information is as accurate as possible as of the date of publication of this brochure. All features, floor plans, and specifications in this brochure are subject to change without notice. Please also consult Keystone's web site at www.keystonerv.com for more current product information and specifications. Tow Vehicle Disclaimer. CAUTION: Owners of Keystone recreational vehicles are solely responsible for the selection and proper use of tow vehicles. All customers should consult with a motor vehicle manufacturer or their dealer concerning the purchase and use of suitable tow vehicles for Keystone products. Keystone disclaims any liability or damages suffered as a result of the selection, operation, use or misuse of a tow vehicle. KEYSTONE'S LIMITED WARRANTY DOES NOT COVER DAMAGE TO THE RECREATIONAL VEHICLE OR THE TOW VEHICLE AS A RESULT OF THE SELECTION, OPERATION, USE OR MISUSE OF THE TOW VEHICLE. *Length is defined as the distance from the centerline of hitch pin/coupler to rear bumper of trailer.



more product detail at
www.keystonerv.com/Outback

DESIGNER PACKAGE *

- Coat hooks (most models)
- Utensil rack
- Innerspring mattress
- Bedspread
- LP cover
- MCD Roller shades
- Decorative wall lights
- Trash can

COMFORT PACKAGE *

- 15,000 BTU ducted air conditioner
- TV antenna/cable
- AM/FM/CD stereo with Bluetooth
- Microwave
- Entry assist handle

PREMIUM PACKAGE *

- Polar White medallion exterior fiberglass
- Theater seating (328RL, 330RL)
- Solid surface countertops w/pull-out faucet

POPULAR PACKAGE *

- Free-standing dinette
- Second air conditioner
- Bedroom 13,500 BTU air conditioner
- Theater seating (300ML, 324CG, 335CG, 340BH)

STANDARDS AND OPTIONS

	≡	OUT
LIVING AREA		
Upgraded furniture package	●	●
Pre-drilled and screwed hand-glazed ash cabinetry	●	●
Large panoramic windows	●	●
Vinyl flooring	●	●
40"/50" HDTV (most models)	●	●
MCD roller shades*	●	
Pleated shades		●
Vaulted ceiling	●	
USB charging port	●	●
LED lighting and (2) LED floor lights	●	●
Fireplace	●	
KITCHEN		
Deep, single basin sink with 3" drains	●	●
Trash can storage*	●	●
Two door 8 cu. ft. refrigerator	●	●
High-rise faucet w/pull-out sprayer*	●	●
Utensil tray	●	●
3-burner range with oven and microwave*	●	●
Upgraded pressed membrane countertops		●
Solid surface countertops*	●	
Skylights over islands	●	
BEDROOM		
Deluxe innerspring mattress	●	●
TV hook-up	●	●
Jalousie windows for maximum ventilation	●	●
USB charging port	●	●
Built-in pet kennel storage	●	●
BATHROOM		
Power roof vent and skylight over tub	●	●
Porcelain foot-flush toilet	●	●
Tub surround*	●	●
Radius shower (0B- N/A 300ML, 340BH) (0BUL- 260, 272, 299)	●	●
APPLIANCES		
AM/FM/CD stereo w/DVD player, MP3 hookup and Bluetooth enabled (N/A in 210URS, 240URS, and 250URS)	●	●
Two door 8 cu. ft. refrigerator (black)	●	●
Range with oven and microwave (3 burner)*	●	●
6-gallon gas/electric DSI water heater w/quick-recovery capacity of 16.2 gallons per hour	●	●
15,000 BTU AC wall thermostat and 35,000 BTU furnace	●	●
EXTERIOR		
Painted fiberglass front cap w/LED strip lights and rock guard	●	●
Polar White fiberglass with black framed, tinted safety glass windows	●	●
Black tank flush	●	●

	Premier Travel Trailers	Ultra-Lite Travel Trailers
	T	ULT
Assist entry grab handle	●	●
Heated enclosed underbelly	●	●
MORyde® steps (n/a on 210, 240 models)	●	●
30 lb. LP bottles	●	●
Backup camera prep (n/a on 210, 240 models)	●	●
Double welded dual battery brackets with battery disconnect	●	●
Exterior speakers	●	●
Dexter® E-Z Lube® axles	●	●
Exterior quick connect LP hook-up	●	●
Stabilizer jacks (4) with power tongue jack		●
Power stabilizer jacks with auto-leveling option	●	
Satellite prep	●	●
Slam-latch baggage doors with magnetic door holders	●	
Rear ladder (N/A 335CG)	●	
Water docking station	●	●
Friction-hinge entry door	●	●
Rear max cargo rack	●	
Welded aluminum walls with R-7 solid block foam insulation	●	●
ROOF		
5" radius, vaulted galvanized steel, tapered trusses on 16" centers	●	
Galvanized steel, trusses on 16" centers		●
3/8" roof decking	●	
One-piece TPO roof (tan)	●	●
R-14 equivalent blanket insulation	●	●
FLOOR		
2" welded aluminum laminated floor with R-10 equivalent block foam insulation	●	●
Wrapped vapor barrier	●	●
Polypropylene heated underbelly (encloses tanks and valves)	●	●
CHASSIS		
Powder coated NXG frame from BAL w/leaf spring equalizing suspension system	●	●
Dexter E-Z Lube® axles with 10" electric brakes	●	●
15" radial tires on aluminum wheels with spare* (301UBH)	●	
14" radial tires on aluminum wheels with spare		●
UTILITIES		
55-AMP converter	●	●
30 lb. LP bottles with auto changeover	●	●
Omni directional, hands-free TV/Radio antenna (going to Furion system)	●	●
50-AMP shore power line	●	
Optional 50-AMP shore power line 260,272,280,299,301		●
Detachable 30-AMP shore power line		●
Fire extinguisher, carbon monoxide detector, LP lead detector, smoke detector	●	●
Breakaway switch and safety chains	●	●
Manual slide backup on all electric slide-outs	●	●
RVIA	●	●

BUILT FOR THE LONG HAUL



PRINT 8.2018



**Keystone RV
Company**