



2019 GREYHAWK • GREYHAWK PRESTIGE



Beth + Steve on White Creek
1975



GREYHAWK

FEATURED FLOORPLAN 29MV:

- SOUNDSTREAM INFOTAINMENT SYSTEM W/ GPS
- RECESSED STAINLESS STEEL KITCHEN SINK W/ COVERS
- RAISED-PANEL CABINET DOORS
- CAB-OVER BUNK W/ 750 LB. WEIGHT CAPACITY
- ROLLER SHADES

INTERIOR DECOR SELECTIONS



EXTERIOR SELECTIONS



Premium Paint Option - Aurora



Aztec Silver Graphics



Premium Paint Option - Cameo



Premium Paint Option - Galactic

GREYHAWK FLOORPLANS



26Y



29MV



30X



30Z



31F



31FS



GREYHAWK PRESTIGE

FEATURED FLOORPLAN 29MVP:

- 30"X 82" PANORAMIC WINDOW W/ POWER SHADE
- RAISED-PANEL CABINET DOORS
- SOLID SURFACE KITCHEN COUNTERTOPS
- RECESSED SINK AND COOKTOP W/ COVERS

INTERIOR DECOR

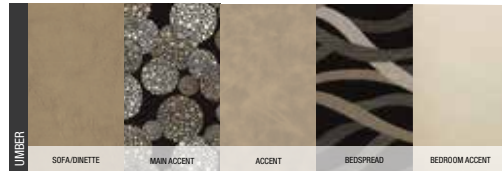
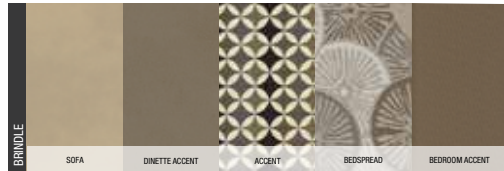

EXTERIOR SELECTIONS



Aztec Silver Graphics



Premium Paint Option - Desert Gold



Premium Paint Option - Celestial Blue

SPECS

MODELS		DIMENSIONS				TANKS (GALS.)			
MODEL	FLOORPLAN	EXTERIOR LENGTH	EXTERIOR WIDTH	EXTERIOR HEIGHT (WITH A/C)	INTERIOR HEIGHT	WHEEL BASE	FRESH WATER CAPACITY (GAL.) (INCLUDES WATER HEATER)	GREY WASTE WATER CAPACITY (GAL.)	BLACK WASTE WATER CAPACITY (GAL.)
GREYHAWK	26Y	28' 8"	100"	11' 6"	84"	181"	47	41	32
	29MV	32' 6"	100"	11' 6"	84"	223"	47	41	32
	30X	32' 6"	100"	11' 6"	84"	223"	47	41	31
	30Z	32' 6"	100"	11' 6"	84"	223"	43.5	41	31
	31F	TBD	100"	11' 6"	84"	223"	TBD	TBD	TBD
	31FS	32' 6"	100"	11' 6"	84"	223"	47	41	32
GREYHAWK PRESTIGE	29MVP	32' 6"	100"	11' 6"	84"	223"	47	41	32
	30XP	32' 6"	100"	11' 6"	84"	223"	47	41	31
	31FP	TBD	100"	11' 6"	84"	223"	TBD	TBD	TBD
	31FSP	32' 6"	100"	11' 6"	84"	223"	47	41	32

GREYHAWK PRESTIGE FLOORPLANS

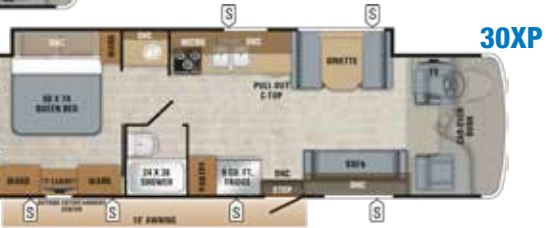

Gross Vehicle Weight Rating (GVWR): The maximum permissible weight of the motorhome, including the Unloaded Vehicle Weight (UVW) plus passengers, personal items, all cargo, fluids, options and dealer-installed accessories. The GVWR is equal to or greater than the sum of the UVW and the Cargo Carrying Capacity.

Gross Combined Weight Rating (GCWR): The maximum allowable combined weight of the motorhome used as a tow vehicle and the attached towed vehicle. It is important for your safety and enjoyment that you are aware of the weights and tow ratings of the RV you select. Consult a competent advisor for questions or advice. Whether you are new to RVing or a veteran, get a feel for the performance of your RV before heading out on the roadways. When you tow a vehicle with your RV, you must drive differently than when you drive a single vehicle. Practice hooking up, driving, backing up and braking in a safe environment or seek out professional instruction. Jayco affixes a weight label to each RV which lists weight information for that vehicle. Refer to that label to verify the vehicle will meet your requirements.



THE JAYCO DIFFERENCE

1. **One-piece seamless fiberglass front cap** for increased durability and protection
2. **82-inch x 30-inch automotive-bonded panoramic windshield in front cap** (Prestige models only)
3. **750-pound overhead bunk capacity** offers nearly 250 pounds more than the industry average for greater safety and peace of mind
4. **Integrated electric step** maximizes ground clearance and floor space
5. **Integrated third brake light** improves safety on the road
6. **Seatbelts** in every seating position
7. **Frameless windows** make exterior maintenance easier than ever and give the unit a sleek, modern look



To see a full list of standards and options, use your camera app to scan code.



GREYHAWK
PRESTIGE

JRIDE PLUS®

JRide Plus® is a powerful blend of precise handling and renowned stability. Hands down, it's the best ride. Experience JRide for yourself—visit your local dealer and take a test drive.

COMPUTER-BALANCED DRIVESHAFT Ensures smooth and efficient power transfer to the wheels

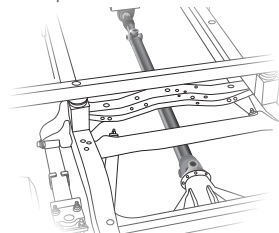

STANDARD FRONT STABILIZER BAR Reduces the body roll of a vehicle during cornering or over road irregularities

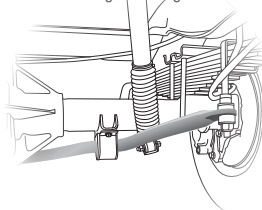

BILSTEIN® SHOCK ABSORBERS Feature a unique mono-tube gas-pressure design, providing optimum ride quality and vehicle control

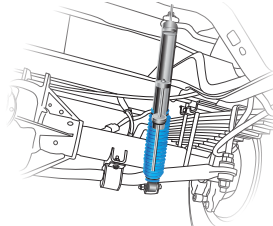

RUBBER ISOLATION MOUNTS Positioned near the tires to absorb road shock, dampen noise and minimize vibrations

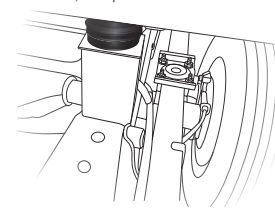

HEAVY-DUTY REAR STABILIZER BAR A larger bar and polyurethane bushings, instead of rubber, transfer power faster for extra support, more stability and easier handling

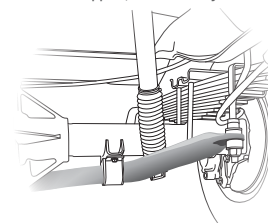

HELLWIG® HELPER SPRINGS Work with the chassis' existing springs to give the RV more support, improving stability under heavy loads

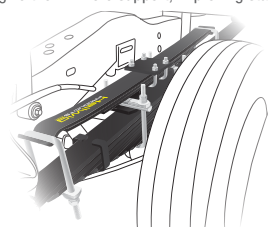

scan QR code for more information

Meet your Jayco Dealer



Follow Jayco
#Jayco50



Jayco, Inc. | P.O. Box 460 | Middlebury, IN 46540 © **RVIA** See dealer for further information and prices. All information in this brochure and on www.jayco.com is the latest available at the time of publication approval. Jayco reserves the right to make changes and to discontinue models without notice or obligation. Photography may show optional equipment or props used for decoration purposes only. RVs built for sale in Canada may differ to conform to Canadian codes. JAYCO and the JAYCO BIRD IN FLIGHT are registered trademarks of Jayco, Inc. Printed in USA 53K 7/18 ©2018 Jayco, Inc. 274891

Travel with Confidence



At Jayco, we build our RVs to handle every adventure, then back them with our industry-leading 2-year limited warranty. We, with support from our select partners, have you covered for **2 camping seasons** or **twenty-four thousand (24,000) miles** (mileage limitation applies to motorized products only), whichever occurs first, from the original date of purchase. You won't find a better warranty in the business, because the only strings we attach are those that deliver the ultimate in reliability. That's the Jayco difference. So go explore. For a copy of our 2-year limited warranty with complete terms and conditions, please contact your local Jayco dealer.



A year's access to Coach-Net™—the country's largest RV emergency road service.

