

2019 PRECEPT • PRECEPT PRESTIGE



2019 PRECEPT • PRECEPT PRESTIGE



Jean and Dan
Stratton State Park - 1994



2
YEAR
LIMITED
WARRANTY



PRECEPT

FEATURED FLOORPLAN 31UL

- SOUNDSTREAM INFOTAINMENT SYSTEM WITH GPS
- SOLID-SURFACE KITCHEN COUNTERTOPS WITH PULL OUT EXTENSION
- DAY/NIGHT ROLLER SHADES
- OPTIONAL DROP DOWN BUNK WITH 750LB. WEIGHT RATING

PRECEPT EXTERIOR SELECTIONS



PREMIUM FULL BODY PAINT
OTTER ROCK



PREMIUM FULL BODY PAINT
WARM SPRINGS



PREMIUM FULL BODY PAINT
OCEANCREST



SAHARA DREAM GRAPHICS

Gross Vehicle Weight Rating (GVWR): The maximum permissible weight of the motorhome, including the Unloaded Vehicle Weight (UVW) plus passengers, personal items, all cargo, fluids, options and dealer-installed accessories. The GVWR is equal to or greater than the sum of the UVW and the Cargo Carrying Capacity.

Gross Combined Weight Rating (GCWR): The maximum allowable combined weight of the motorhome used as a tow vehicle and the attached towed vehicle. It is important for your safety and enjoyment that you are aware of the weights and tow ratings of the RV you select.

Consult a competent advisor for questions or advice. Whether you are new to RVing or a veteran, get a feel for the performance of your RV before heading out on the roadways. When you tow a vehicle with your RV, you must drive differently than when you drive a single vehicle. Practice hooking up, driving, backing up and braking in a safe environment or seek out professional instruction. Jayco affixes a weight label to each RV which lists weight information for that vehicle. Refer to that label to verify the vehicle will meet your requirements.

PRECEPT FLOORPLANS



31UL



33U

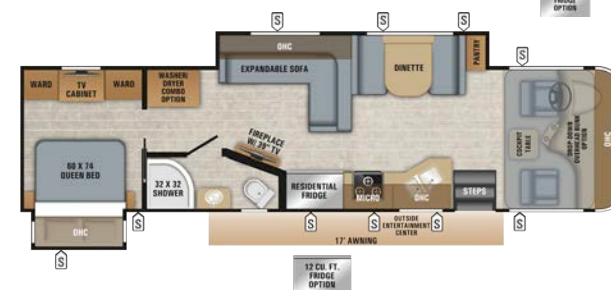

34G



36A





PRECEPT PRESTIGE FLOORPLANS



OPTION

THEATER SOFA



OPTION

THEATER SOFA



PRECEPT PRESTIGE EXTERIOR SELECTIONS



**PREMIUM FULL BODY PAINT
COSMIC**



**PREMIUM FULL BODY PAINT
NOCTURNAL**



**PREMIUM FULL BODY PAINT
SHORELINE**

INTERIOR DÉCOR SELECTIONS

CHATEAU					
	SOFA/DINETTE	MAIN ACCENT	ACCENT	BEDSPREAD	BEDROOM ACCENT
MINERAL					
	SOFA/DINETTE	MAIN ACCENT	ACCENT	BEDSPREAD	BEDROOM ACCENT

SPECS

MODELS		DIMENSIONS					TANKS (GALS.)		
MODEL	FLOORPLAN	EXTERIOR LENGTH	EXTERIOR WIDTH	EXTERIOR HEIGHT (WITH A/C)	INTERIOR HEIGHT	WHEEL BASE	FRESH WATER CAPACITY (INCLUDES WATER HEATER)	GREY WASTE WATER CAPACITY	BLACK WASTE WATER CAPACITY
PRECEPT	29V	32' 2"	101	12' 7"	84"	228"	72	40	50
	31UL	32' 9"	101	12' 7"	84"	228"	72	40	50
	33U	36' 3"	101	12' 7"	84"	228"	72	40	51
	34G	TBD	101	12' 7"	84"	TBD	72	40	51
	36A	38' 10"	101	12' 7"	84"	252"	72	40	40
PRECEPT PRESTIGE	36B	38' 8"	101	12' 7"	84"	252"	72	91	72
	36H	TBD	101	12' 7"	84"	252"	72	TBD	TBD
	36U	38' 2"	101	12' 7"	84"	252"	72	50	72



THE JAYCO DIFFERENCE

- 1. 120-inch panoramic windshield** equipped with oversized wiper blades to allow for maximum visibility
- 2. Exterior entertainment center** comes standard with an LED TV mounted on a swivel bracket
- 3. One-piece seamless fiberglass roof** offers unmatched durability
- 4. Lockable pass-through storage** with easy-to-use Slam-latch™ doors
- 5. Seatbelts in every seating position** secure the most precious cargo
- 6. Frameless windows** make exterior maintenance easier than ever and give the unit a sleek modern look

PRECEPT



To see a full list of standards and options,
Use your camera app to scan code.

PRECEPT
PRESTIGE



JRide Plus® is a powerful blend of precise handling and renowned stability. Hands down, it's the best ride.

Experience JRide Plus for yourself—visit your local dealer and take a test drive.

COMPUTER-BALANCED DRIVESHAFT

Ensures smooth and efficient power transfer from the engine to the wheels

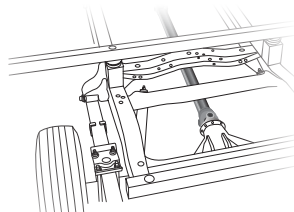

JOUNCE BUMPERS

Assist during extreme road occurrences to absorb impact and dampen excess road noise

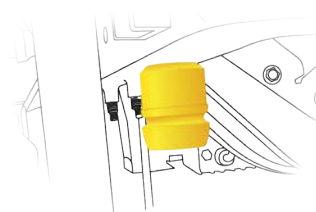

STANDARD REAR STABILIZER BAR

Reduces the body roll of a vehicle during fast cornering or over road irregularities

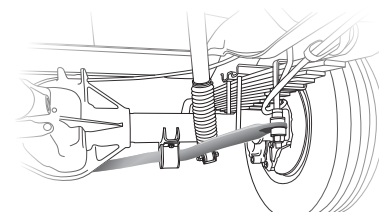

HEAVY-DUTY FRONT STABILIZER BAR

A larger bar and polyurethane bushings, instead of rubber, transfer power faster for extra support, more stability and easier handling

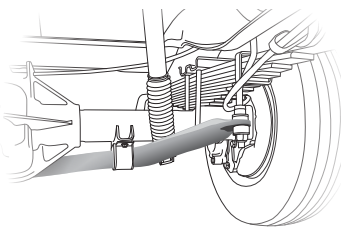

SACHS SHOCK ABSORBERS

Large-diameter tube design pairs gas and hydraulics to resist heat and pressure while independently adjusting to changing road conditions

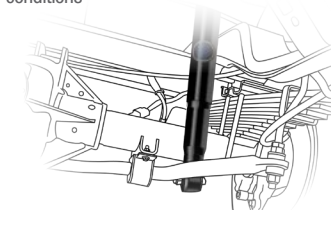

Use your camera
app to scan code
and learn more.



Meet your Jayco Dealer _____

Travel with Confidence _____



At Jayco, we build our RVs to handle every adventure, then back them with our industry-leading 2-year limited warranty. We, with support from our select partners, have you covered for **2 camping seasons or twenty-four thousand (24,000) miles** (mileage limitation applies to motorized products only), whichever occurs first, from the original date of purchase. You won't find a better warranty in the business, because the only strings we attach are those that deliver the ultimate in reliability. That's the Jayco difference. So go explore. For a copy of our 2-year limited warranty with complete terms and conditions, please contact your local Jayco dealer.

A year's access to Coach-Net™—the country's largest RV emergency road service.



Follow Jayco
#Jayco50



Jayco, Inc. | P.O. Box 460 | Middlebury, IN 46540 ☎ **RVA**

See dealer for further information and prices. All information in this brochure and on www.jayco.com is the latest available at the time of publication approval. Jayco reserves the right to make changes and to discontinue models without notice or obligation. Photography may show optional equipment or props used for decoration purposes only. RVs built for sale in Canada may differ to conform to Canadian codes. JAYCO and the JAYCO BIRD IN FLIGHT are registered trademarks of Jayco, Inc. Printed in USA 42K 7/18 © 2018 Jayco, Inc. 274895