

LAREDO

by Keystone



Super-Lite Travel Trailers | Super-Lite Fifth Wheels | Mid-Profile Fifth Wheels

The leader in
AFFORDABLE LUXURY



**Keystone RV
Company**

WWW.KEYSTONERV.COM/LAREDO



Enjoy the Life-Sized CAMPING EXPERIENCE.

The amenities in your home are life sized and they should be like that in your camper, too. Laredo doesn't settle for smaller RV sized features. Instead we make them "life sized" the way you are used to. Laredo enhances your camping experience by giving you the perfect combination of features, floor plans and value. Couple Laredo's "Life Sized" features with industry leading quality and customer service and sacrifice nothing in your home away from home.



330RL ENTERTAINMENT/LIVING ROOM

330RL BEDROOM



358BP SHOWN IN MADURO DECOR



358BP BUTLERS PANTRY



358BP KITCHEN



298SRL KITCHEN



298SRL BEDROOM WITH WARDROBE



MID-PROFILE FIFTH WHEELS

AFFORDABLE LUXURY FEATURES

- ✔ 18 CU. FT. GAS/ELECTRIC REFRIGERATOR
- ✔ SOLID SURFACE KITCHEN COUNTERTOPS
- ✔ FLUSH MOUNT STAINLESS STEEL SINK
- ✔ KING SIZE BED (SELECT MODELS)
- ✔ WASHER/DRYER PREP
- ✔ 50" LED HDTV
- ✔ FIREPLACE (SELECT MODELS)
- ✔ 32" BEDROOM TV (MOST MODELS)
- ✔ FIBERGLASS FRONT CAP WITH MAX TURN TECHNOLOGY
- ✔ POWER ADJUSTABLE AWNING
- ✔ 50 AMP SERVICE
- ✔ AUTO LEVEL SYSTEM
- ✔ FRICTION HINGE ENTRY DOOR W/SHADE
- ✔ FRAMELESS WINDOWS
- ✔ RAISED PANEL CABINET DOORS

FLOOR PLANS



WEIGHT 11055 **LENGTH** 36' 8" **325RL**



WEIGHT 10785 **LENGTH** 37' 7" **340FL**



WEIGHT 11257 **LENGTH** 38' 4" **342RD**



WEIGHT 11480 **LENGTH** 39' 9" **358BP**

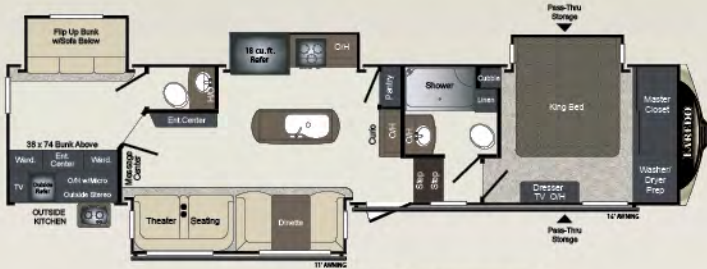

WEIGHT 12130 **LENGTH** 39' 9" **367BH**

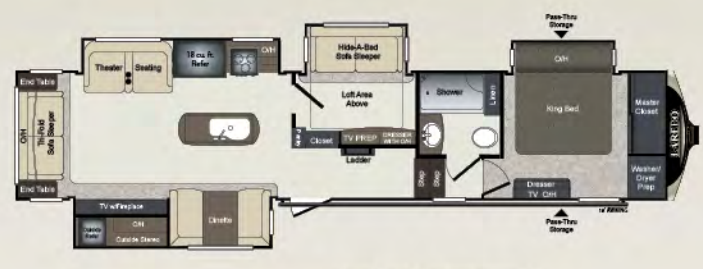

WEIGHT 12785 **LENGTH** 41' 6" **380MB**

FIFTH WHEEL WEIGHTS & MEASUREMENTS

| MODEL | SHIPPING WEIGHT | CARRYING CAPACITY | HITCH | LENGTH* | WIDTH | HEIGHT | FRESH WATER | WASTE WATER | GRAY WATER | LPG | AWNING |
|-------|-----------------|-------------------|-------|---------|-------|--------|-------------|-------------|------------|-----|---------|
| 325RL | 11055 | 1945 | 1910 | 36' 8" | 8' | 12' 7" | 66 | 44 | 78 | 60 | 16' |
| 340FL | 10785 | 2215 | 2220 | 37' 7" | 8' | 12' 7" | 66 | 34 | 68 | 60 | 19' |
| 342RD | 11257 | 1743 | 2065 | 38' 4" | 8' | 12' 7" | 66 | 44 | 78 | 60 | 18' |
| 358BP | 11650 | 2570 | 2225 | 39' 9" | 8' | 12' 7" | 66 | 44 | 78 | 60 | 19'/11' |
| 367BH | 12130 | 2230 | 2365 | 39' 9" | 8' | 12' 7" | 66 | 78 | 78 | 60 | 16'/11' |
| 380MB | 12785 | 2715 | 2385 | 41' 6" | 8' | 12' 7" | 66 | 44 | 78 | 60 | 20' |

*Length is defined as the distance from the centerline to the hitch pin/coupler to rear bumper of the trailer. SEE DISCLAIMER ON BACK PAGE



SUPER-LITE FIFTH WHEELS

AFFORDABLE LUXURY FEATURES

- ✓ STAMPED STEEL ARCHED ROOF RAFTERS
- ✓ 8 CU. FT. REFRIGERATOR
- ✓ SOLID SURFACE COUNTERTOPS
- ✓ KITCHEN ISLAND W/DUAL PULL-OUT TRASH CANS
- ✓ 40" LED HDTV
- ✓ 12V DVD/CD/AM/FM/MP3 PLAYER WITH BLUETOOTH
- ✓ 50 AMP SERVICE/PREPARED FOR SECOND AIR CONDITIONER
- ✓ ELECTRIC AWNING
- ✓ ROAD ARMOR SUSPENSION
- ✓ HEATED PASS-THRU STORAGE
- ✓ HITCH ASSIST MIRROR W/2 LED LIGHTS
- ✓ AUTO LEVELING
- ✓ FRICTION HINGE ENTRY DOOR W/SHADE
- ✓ RAISED PANEL CABINET DOORS

FLOOR PLANS



WEIGHT 7255 **LENGTH** 30' 4" **268SRL**

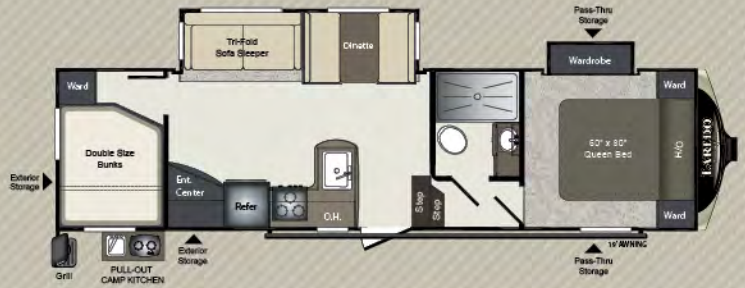

WEIGHT 8028 **LENGTH** 33' **285SBH**



WEIGHT 8445 **LENGTH** 33' 6" **290SRL**

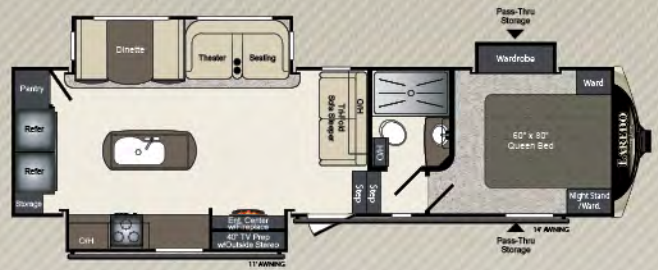

WEIGHT 8615 **LENGTH** 33' 6" **291SMK**



WEIGHT 9205 **LENGTH** 34' 2" **296SBH**

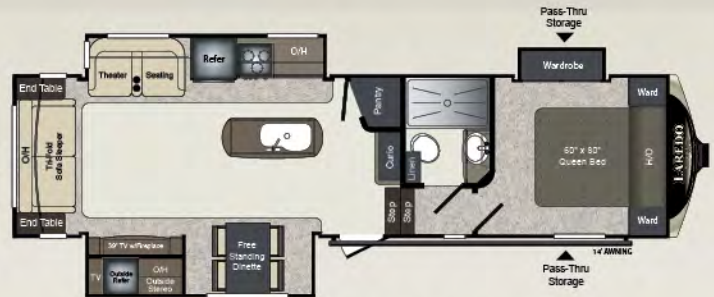

WEIGHT 8855 **LENGTH** 34' 6" **298SRL**

FIFTH WHEEL WEIGHTS & MEASUREMENTS

| MODEL | SHIPPING WEIGHT | CARRYING CAPACITY | HITCH | LENGTH* | WIDTH | HEIGHT | FRESH WATER | WASTE WATER | GRAY WATER | LPG | AWNING |
|--------|-----------------|-------------------|-------|---------|-------|--------|-------------|-------------|------------|-----|---------|
| 268SRL | 7255 | 2745 | 1385 | 30' 4" | 8' | 12' 4" | 43 | 30 | 60 | 60 | 18' |
| 285SBH | 8028 | 1972 | 1465 | 33' | 8' | 12' 4" | 43 | 30 | 60 | 60 | 19' |
| 290SRL | 8445 | 2055 | 1725 | 33' 6" | 8' | 12' 3" | 43 | 30 | 60 | 60 | 13'/11' |
| 291SMK | 8615 | 1885 | 1675 | 33' 6" | 8' | 12' 3" | 43 | 30 | 60 | 60 | 14'/11' |
| 296SBH | 9205 | 1395 | 1820 | 34' 2" | 8' | 12' 3" | 43 | 30 | 60 | 60 | 16' |
| 298SRL | 8855 | 1286 | 1390 | 34' 6" | 8' | 12' 3" | 43 | 30 | 60 | 60 | 14' |

*Length is defined as the distance from the centerline to the hitch pin/coupler to rear bumper of the trailer. SEE DISCLAIMER ON BACK PAGE



SUPER-LITE TRAVEL TRAILER

AFFORDABLE LUXURY FEATURES

- ✓ RESIDENTIAL FAUCET W/PULLOUT SPRAYER
- ✓ SOLID SURFACE COUNTERTOPS
- ✓ RADIUS CEILING
- ✓ 40" LED HDTV
- ✓ KING SIZE BED (SELECT MODELS)
- ✓ 50" WIDE, 6' 7" TALL SHOWER
- ✓ 50 AMP SERVICE/PREPARED FOR SECOND AIR CONDITIONER
- ✓ POWER ADJUSTABLE AWNING
- ✓ GRILL 'N CHILL OUTSIDE KITCHEN (SELECT MODELS)
- ✓ FIBERGLASS FRONT CAP W/ROCK GUARD PAINT PROTECTION
- ✓ TRAVEL TRAILER AUTO LEVELING (MOST MODELS)
- ✓ FRICTION HINGE ENTRY DOOR W/SHADE
- ✓ ALUMINUM WHEELS
- ✓ ALUMINUM ENTRY STEPS

FLOOR PLANS



WEIGHT 6090 **LENGTH** 26' 11" **225MK**



WEIGHT TBD **LENGTH** 29' 11" **250BH**



WEIGHT 6885 **LENGTH** 32' 5" **280RB**

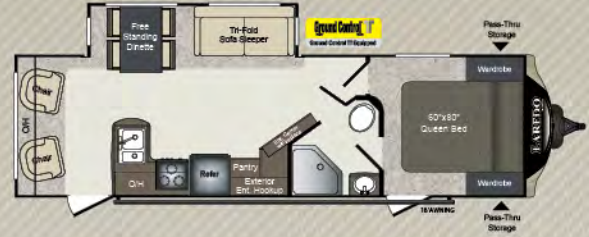

WEIGHT 6715 **LENGTH** 32' 10" **288RL**



WEIGHT 8288 **LENGTH** 37' **330RL**



WEIGHT 8585 **LENGTH** 38' **332BH**

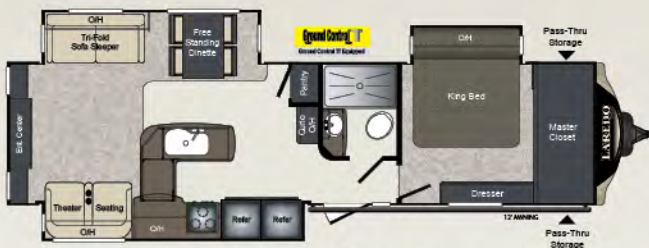

WEIGHT 8602 **LENGTH** 37' 1" **334RE**

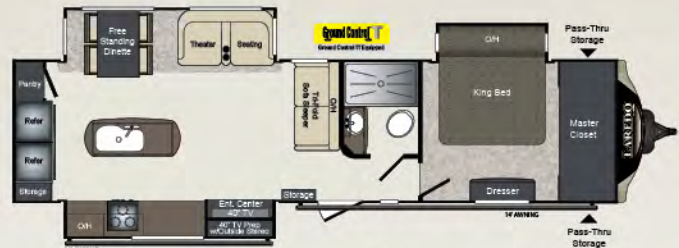

WEIGHT 8528 **LENGTH** 37' 11" **335MK**

TRAVEL TRAILER WEIGHTS & MEASUREMENTS

| MODEL | SHIPPING WEIGHT | CARRYING CAPACITY | HITCH | LENGTH* | WIDTH | HEIGHT | FRESH WATER | WASTE WATER | GRAY WATER | LPG | AWNING |
|-------|-----------------|-------------------|-------|---------|-------|--------|-------------|-------------|------------|-----|---------|
| 225MK | 6090 | 1910 | 745 | 26' 11" | 8' | 11' 1" | 43 | 30 | 60 | 60 | 18' |
| 250BH | TBD | TBD | TBD | 29' 11" | TBD | TBD | TBD | TBD | TBD | TBD | TBD |
| 280RB | 6885 | 1915 | 795 | 32' 5" | 8' | 11' 1" | 43 | 30 | 60 | 60 | 19' |
| 288RL | 6715 | 2085 | 860 | 32' 10" | 8' | 11' 1" | 43 | 30 | 60 | 60 | 18' |
| 330RL | 8288 | 1587 | 1075 | 37' | 8' | 11' 1" | 43 | 30 | 60 | 60 | 12' |
| 332BH | 8585 | 1375 | 1165 | 38' | 8' | 11' 1" | 43 | 30 | 60 | 60 | 8'/11' |
| 334RE | 8602 | 1398 | 1245 | 37' 1" | 8' | 11' 1" | 43 | 30 | 60 | 60 | 11' |
| 335MK | 8528 | 1472 | 1210 | 37' 11" | 8' | 11' 1" | 43 | 30 | 60 | 60 | 14'/11' |

*Length is defined as the distance from the centerline to the hitch pin/coupler to rear bumper of the trailer. SEE DISCLAIMER ON BACK PAGE

MID-PROFILE FIFTH WHEELS



STANDARDS AND OPTIONS

| EXTERIOR FEATURES |
|----------------------------------------------------------|
| Aerodynamic painted front cap |
| Fully enclosed underbelly |
| Heated, enclosed holding tanks & gate valves |
| Oversized lighted and heated pass-thru storage |
| Roto-cast storage for wet or greasy items |
| Exterior shower with hot & cold water |
| Exterior marine grade speakers |
| Rear ladder |
| Hybrid aluminum entry step |
| Electric front jacks w/adjustable snap pins |
| Hitch assist mirror & 2 LED lights w/Max Turn Technology |
| Outside 110V outlet & TV connection |
| Water works utility center |
| Battery disconnect |
| Solar panel prep |
| Backup camera prep |
| Electric slide out system w/manual override |
| Adjustable extended hitch pin |
| EZ lube axles |
| 12" electric brakes |
| INTERIOR FEATURES |
| Dinette w/storage below |
| 6' 3" slide room height |
| Ventilating windows on slide out end walls |
| Residential grade carpet |
| Stain resistant fabrics |
| Pleated shades |
| Designer window treatments |
| Solid wood steps to upper deck |
| Raised panel Mortise & Tenon cabinet doors |
| Friction hinge entry door with built-in shade |
| KITCHEN |
| Residential-size overhead cabinets |
| Sink covers |
| 60/40 deep-bowl stainless steel sink |
| High-rise faucet with pull-out sprayer |
| Linoleum floor with cold crack warranty |
| Ball bearing full extension drawer guides |
| BATHROOM FEATURES |
| Oversized shower (select models) |
| Foot pedal flush porcelain toilet |
| Medicine cabinet |
| Skylight over shower |
| Power roof vent |

| BEDROOM FEATURES |
|-----------------------------------------------------|
| King bed (N/A 340FL, 38H) |
| Designer matching headboard |
| Wardrobe storage |
| Reading lights |
| 32" bedroom TV (most models) |
| Washer/dryer prep (most models) |
| APPLIANCES AND UTILITIES |
| 12V AM/FM/CD/DVD home theater system with bluetooth |
| 18 Cubic foot refrigerator |
| Microwave with carousel |
| Range hood and light |
| 15,000 BTU ducted air conditioner |
| High output range with auto igniter |
| 2-30lb LP bottles with auto changeover |
| 35,000 BTU high-output furnace with auto ignition |
| Water heater bypass kit |
| Systems monitor panel |
| Cable & satellite connections |
| Easy care alumna-read folding triple entry step |
| SAFETY FEATURES |
| Break away switch |
| Tinted safety glass windows |
| GFI receptacles |
| Carbon monoxide detector |
| Smoke alarm |
| Propane gas leak detector |
| Fire extinguisher |
| BLACK LABEL PACKAGE |
| Automatic electric leveling system |
| Road armor suspension system |
| Hybrid aluminum entry step |
| Solid surface countertops |
| LIFE SIZE PACKAGE |
| 48"-50" residential showers |
| 50 amp service |
| Wired and braced for 2nd air conditioner |
| 18 cubic foot refrigerator |
| OPTIONS |
| 2nd 13.5K BTU air conditioner |
| Free standing dinette and chairs |
| Dual pane windows |

SUPER-LITE



STANDARDS

| EXTERIOR FEATURES |
|-----------------------------------------------------------|
| Aerodynamic painted front cap |
| Fully enclosed underbelly |
| Heated, enclosed holding tanks & gate valves |
| Oversized lighted and heated pass-thru storage |
| Exterior shower w/hot & cold water |
| Exterior marine grade speakers |
| Rear ladder |
| Hybrid aluminum entry step |
| Electric front jacks w/adjustable snap pins |
| Hitch assist mirror & 2 LED lights w/ Max Turn Technology |
| Outside 110V outlet & TV connection |
| Water works utility center |
| Electric awning with LED lights |
| Battery disconnect |
| Solar panel prep |
| Backup camera prep |
| Electric slide out system w/manual override |
| Adjustable extended hitch pin |
| EZ lube axles |
| 10" electric brakes |
| INTERIOR FEATURES |
| Dinette w/storage below |
| Ventilating windows on slide out end walls |
| Residential grade carpet and padding |
| Stain resistant fabrics |
| Pleated shades |
| Designer window treatments |
| Raised panel mortise & tenon cabinet doors |
| Solid wood steps to upper deck |
| Friction hinge entry door with built-in shade |
| KITCHEN |
| Residential-size overhead cabinets |
| Sink covers |
| 60/40 deep bowl stainless steel sink |
| High-rise faucet with pull-out sprayer |
| Linoleum floor with cold crack warranty |
| Ball bearing full extension drawer guides |
| BATHROOM FEATURES |
| Oversized 50"x30" showers |
| Foot pedal flush porcelain toilet |
| Medicine cabinet |
| Skylight over bath |
| Power roof vent |

BUILT
FOR THE LONG HAUL



INNOVATION THAT STARTS
WITH A SOLID FOUNDATION

WWW.KEYSTONERV.COM Keystone RV Company

FIFTH WHEELS

AND OPTIONS

| BEDROOM FEATURES |
|-----------------------------------------------------|
| 60" x 80" Innerspring mattress (most models) |
| Wardrobe storage |
| TV hook-up |
| Reading lights |
| APPLIANCES AND UTILITIES |
| 12V AM/FM/CD/DVD home theater system with bluetooth |
| 8 cubic foot refrigerator |
| Microwave with carousel |
| Range hood and light |
| 15,000 BTU ducted air conditioner |
| High output range with auto igniter |
| 2-30 lb. LP bottles w/auto changeover |
| 35,000 BTU high-output furnace w/auto ignition |
| Water heater bypass kit |
| Systems monitor panel |
| Cable & satellite connections |
| SAFETY FEATURES |
| Break away switch |
| Tinted safety glass windows |
| GFI receptacles |
| Carbon monoxide detector |
| Smoke detector |
| Propane gas leak detector |
| Fire extinguisher |
| BLACK LABEL PACKAGE |
| Automatic electric leveling system |
| Road Armor suspension system |
| Hybrid aluminum entry step |
| Solid surface countertops |
| LIFE SIZE PACKAGE |
| 50" residential showers |
| 50 amp service |
| Wired and braced for 2nd air conditioner |
| 8 cubic refrigerator |
| OPTIONS |
| 2nd 13.5K BTU air conditioner |
| Free standing dinette and chairs |
| Dual pane windows |

SUPER-LITE TRAVEL TRAILERS



STANDARDS AND OPTIONS

| EXTERIOR FEATURES |
|---------------------------------------------------------------|
| Aerodynamic painted front cap |
| Fully enclosed underbelly |
| Heated, enclosed holding tanks & gate valves |
| Oversized lighted pass-thru storage |
| Exterior shower w/hot & cold water |
| Exterior marine grade speakers |
| Rear ladder |
| Hybrid aluminum entry step |
| Front cap with rock guard protection and dual battery support |
| Outside 110V outlet & TV connection |
| Water works utility center |
| Battery disconnect |
| Auto leveling jacks |
| Solar panel prep |
| Backup camera prep |
| Electric slide out system w/manual override |
| EZ lube axles |
| 10" electric brakes |
| INTERIOR FEATURES |
| Dinette w/storage below |
| Ventilating windows on slide out end walls |
| Residential grade carpet and padding |
| Stain resistant fabrics |
| Pleated fabric shades |
| Designer window treatments |
| Raised panel mortise & tenon cabinet doors |
| Friction hinge entry door with built-in shade |
| Tri-fold sofa |
| KITCHEN |
| Residential-size overhead cabinets |
| Sink covers |
| Ball bearing full extension drawer guides |
| Single basin sink |
| High-rise faucet with pull-out sprayer |
| Linoleum floor with cold crack warranty |
| BATHROOM FEATURES |
| Oversized 50"x30" showers (most models) |
| Large radius shower |
| Foot pedal flush porcelain toilet |
| Medicine cabinet |
| Skylight over shower |
| Power roof vent |

| BEDROOM FEATURES |
|-----------------------------------------------------|
| Designer matching headboard |
| Wardrobe storage |
| Reading lights |
| 60" x 80" innerspring mattress (most models) |
| Recessed headboard with outlet |
| TV hook-up |
| APPLIANCES AND UTILITIES |
| 12V AM/FM/CD/DVD home theater system with bluetooth |
| Microwave with carousel |
| Range hood and light |
| 15,000 BTU ducted air conditioner |
| High output range with auto igniter |
| 2-30 lb. LP bottles w/auto changeover |
| 8 cubic foot refrigerator |
| LED Awning Lights |
| LED Ceiling Lights |
| High-Arch pull down kitchen faucet |
| 40" LED TV |
| 60" x 80" residential queen mattress |
| 50 Amp Service |
| Aluminum wheels |
| Radial tires |
| Arched ceiling |
| 15" tires |
| SAFETY FEATURES |
| Break away switch |
| Tinted safety glass windows |
| GFI receptacles |
| Carbon monoxide detector |
| Smoke detector |
| Propane gas leak detector |
| Fire extinguisher |
| BLACK LABEL PACKAGE |
| Automatic electric leveling system |
| Road Armor suspension system |
| Hybrid aluminum entry step |
| Electric stabilizer jacks (225, 250) |
| Solid surface countertops |
| LIFE SIZE PACKAGE |
| 50" residential showers |
| 50 Amp Service |
| Wired and braced for 2nd air conditioner |
| Power tongue Jack |
| 8 cubic refrigerator |
| OPTIONS |
| 2nd 13.5K BTU air conditioner |
| Free standing dinette |
| Dual pane windows |



MADURO DECOR AVAILABLE ON ALL MODELS

LAREDO

by Keystone



PURCHASING YOUR RV LOCALLY

It's up to you where you purchase your new Laredo, but may we suggest your local dealer? Not only does it help your local economy and provide jobs, but it will also give you an opportunity to develop a service relationship with someone that will come to know you and your coach.

Congratulations on finding the best built, best equipped, best value in the industry, and happy travels!



Product information is as accurate as possible at the date of publication of this brochure. Features, floor plans, and specifications are subject to change without notice. Please also consult Keystone's web site at keystonerv.com for more current product information and specifications. Tow Vehicle Disclaimer. CAUTION: Owners of Keystone recreational vehicles are solely responsible for the selection and proper use of tow vehicles. All customers should consult with a motor vehicle manufacturer or their dealer concerning the purchase and use of suitable tow vehicles for Keystone products. Keystone disclaims any liability or damages suffered as a result of the selection, operation, use or misuse of a tow vehicle. KEYSTONE'S LIMITED WARRANTY DOES NOT COVER DAMAGE TO THE RECREATIONAL VEHICLE OR THE TOW VEHICLE AS A RESULT OF THE SELECTION, OPERATION, USE OR MISUSE OF THE TOW VEHICLE.

*Length is defined as the distance from the centerline of the hitch pin/coupler to rear bumper of the trailer. 12/2017



2642 Hackberry Drive | PO Box 2000
Goshen, IN 46527-2000
(574) 535-2100



WWW.KEYSTONERV.COM/LAREDO

VISIT OUR WEBSITE TO VIEW INTERIOR PHOTOS, 360 VIRTUAL TOURS AND MUCH MORE.

YOUR LOCAL DEALER IS:



DECEMBER 2017