

Luxury

LUXURIOUS CAMPING DOWN TO THE LAST DETAIL

Cardinal

BY FOREST RIVER



3456RLX

ENTERTAIN IN STYLE

THE REAR LIVING AREA WITH STANDARD THEATER SEATS, 90" SOFA AND 58" POWER LIFT TV.



THE 3456RLX OFFERS LARGE OPPOSING SLIDES WITH AMPLE KITCHEN STORAGE, MULTIPLE COUNTERTOPS, FULL PANTRY WITH DRAWERS AND THEATER SEATING ACROSS FROM A 58" TV ON POWER LIFT. (Shown with Eclipse Decor and Kensington Walnut Wood Grain)



THE 3456RLX ALSO FEATURES OUR LARGEST BATHROOM WITH DUAL SINKS AND VANITIES AND AN ABUNDANCE OF LINEN STORAGE.

3850RLX

RESIDENTIAL COMFORT

THE BEDROOM HAS A CEDAR LINED CLOSET AND DRESSER DRAWERS, STACKABLE WASHER/DRYER PREP AND CORDLESS DYSON® VACUUM.



THE 3850RLX FEATURES OUR LARGEST "SHOW STOPPER" PANTRY WITH SOLID WOOD DRAWERS AND DOOR CABINETS. THIS OPEN FLOW FLOORPLAN HAS OFF DOOR STAIRS TO THE UPPER LEVEL WITH A HALLWAY CLOSET AND ENTRY INTO THE LARGE MASTER BEDROOM. (Shown with Sand Decor and Monticello Maple Wood Grain)

INTERIOR FEATURES



60/40 Mega Bowl
Stainless Steel Sink



Furrion® Cooktop and
Oversized Oven



LG® Solid Surface
Kitchen Countertops



Cedar Lined Closet
with Stackable
Washer Dryer Prep



15K BTU
Whisper Quiet A/C
(2nd and 3rd 13.5K
A/C's optional)



Kensington
Walnut

Monticello
Maple

Solid Walnut or Maple
Wood Throughout



Solid Wood Pull Out
Pantry Drawers
(3850RLX Shown)



LG® Residential
Refrigerator with
Water and Ice Feature



72" X 80" King Bed or
Optional 60" X 80"
Queen Bed

EXTERIOR FEATURES



MORryde® CRE 3000
Suspension



MORryde® Pin Box



MORryde®
StepAbove
Entry Steps



Dual Metal Wrapped
Awning with
LED Lights
(1-3950TZX)



200 Watt Solar
Panel Prep Standard.
Optional Roof Panel
Installed with Control
Screen.



Hehr® Frameless
Windows



All Welded Aluminum
Super Structure



Control Center with
Energy Management,
MyRV and WiFi
Ranger



Optional Full Body
Paint (See back cover
for full options)

WIDE BODY CONSTRUCTION

DECOR OPTIONS

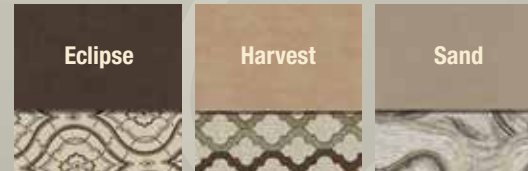

WOOD OPTIONS

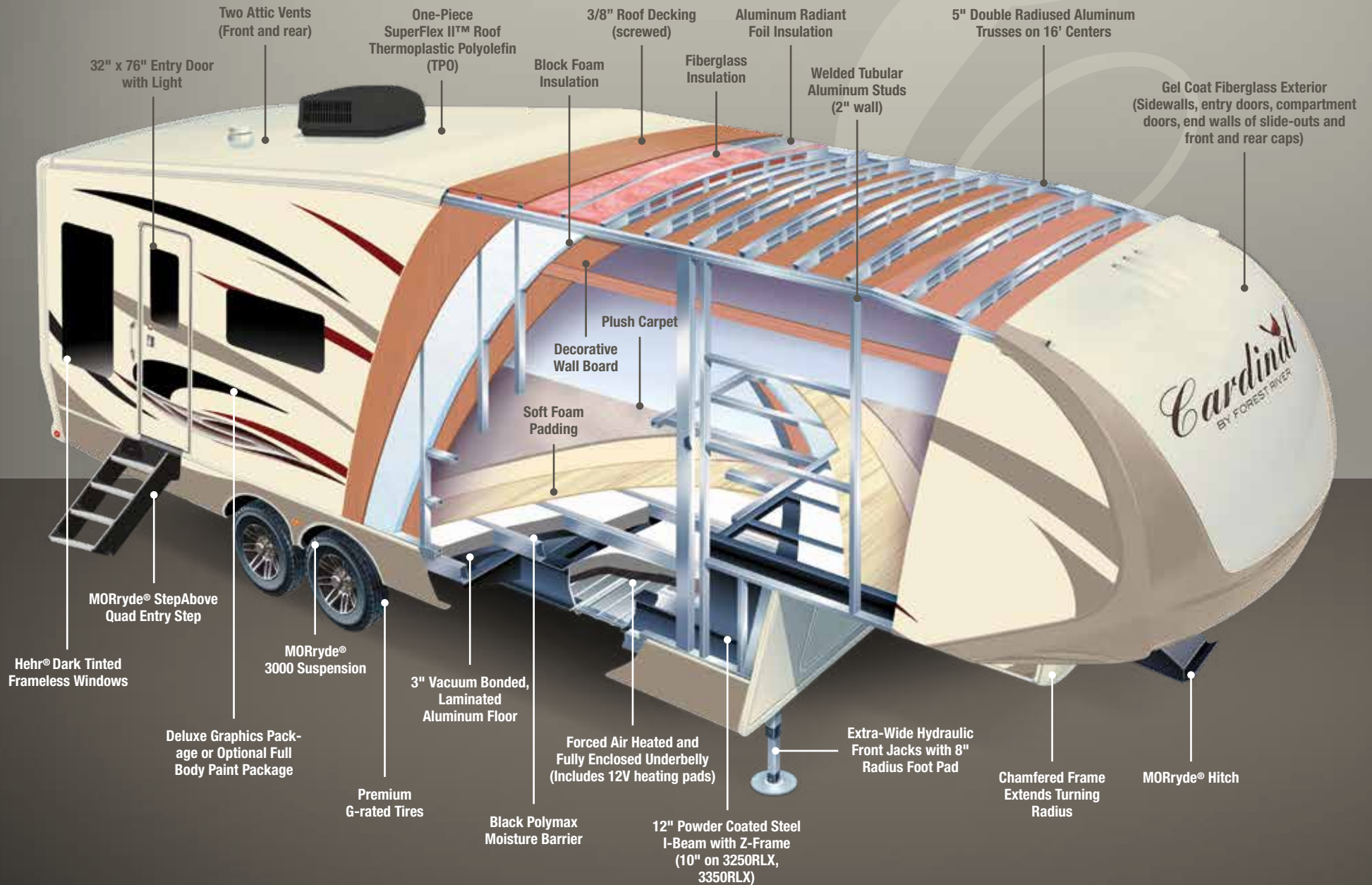
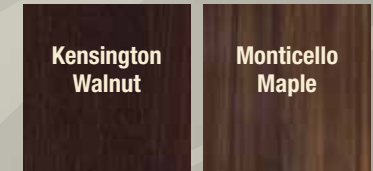

Luxury

LUXURIOUS CAMPING DOWN TO THE LAST DETAIL

Cardinal

BY FOREST RIVER



3250RLX



3350RLX



3456RLX



3525SOX

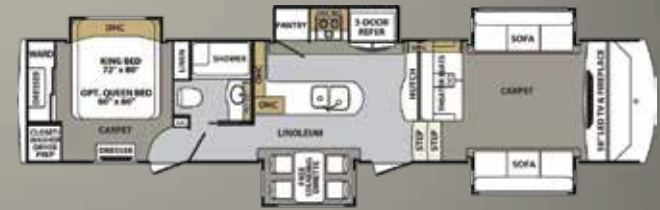

3825FLX



3850RLX



3875FBX

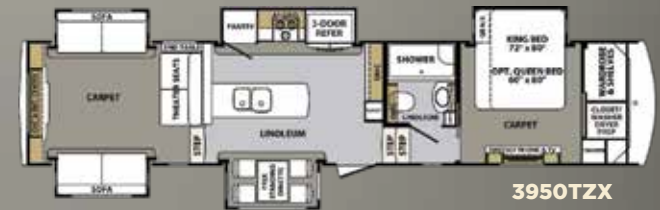

3950TZX



2018 CARDINAL LUXURY	3250RLX	3350RLX	3456RLX	3525SOX	3825FLX	3850RLX	3875FBX	3950TZX
LENGTH (Center of pin to rear of cap)	34' - 11"	35' - 7"	40' - 9"	40' - 9"	41' - 8"	39' - 6"	40' - 6"	41' - 1"
SHIPPING WEIGHT	12164	12504	13809	TBD	14168	13497	13758	14287
UVW	12223	12563	13868	TBD	14227	13556	13817	14346
HITCH WEIGHT	2244	2420	2495	TBD	2519	2649	2674	2766
GAWR	14000	14000	14000	14000	14000	14000	14000	14000
GVWR	16244	16420	16495	TBD	16519	16649	16674	16766
CARGO CARRYING CAPACITY (CCC)	4021	3857	2627	TBD	2292	3093	2857	2420
EXTERIOR HEIGHT	13' 6"	13'6"	13' 6"	13' 6"	13' 6"	13' 6"	13' 6"	13' 6"
EXTERIOR WIDTH	100"	100"	100"	100"	100"	100"	100"	100"
INTERIOR HEIGHT (Bedroom)	81"	81"	81"	81"	105"	81"	81"	81"
INTERIOR HEIGHT (Living Area)	105"	105"	105"	105"	81"	105"	105"	88"
TIRE SIZE	ST235/80R16G	ST235/80R16G	ST235/80R16G	ST235/80R16G	ST235/80R16G	ST235/80R16G	ST235/80R16G	ST235/80R16G
BRAKE SIZE	12"	12"	12"	12"	12"	12"	12"	12"
FRESH WATER	64 gal.	64 gal.	64 gal.	64 gal.	64 gal.	64 gal.	64 gal.	64 gal.
WASTE WATER	120 gal.	110 gal.	120 gal.	110 gal.	120 gal.	120 gal.	140 gal.	120 gal.
WATER HEATER	12 gal.	12 gal.	12 gal.	12 gal.	12 gal.	12 gal.	12 gal.	12 gal.
FURNACE	42000 BTU	42000 BTU	42000 BTU	42000 BTU	42000 BTU	42000 BTU	42000 BTU	42000 BTU
PATIO AWNING	14'	14'	19'	18'	6' - 6" & 14'	19'	18'	16'
EXTERIOR STORAGE (Cu. Ft.)	113	113	138	118	107	150	150	232

STANDARDS

INTERIOR

- Kensington Walnut or Monticello Maple Hardwood Raised Panel Glazed Cabinet Doors and Drawers
- Hardwood Cabinet Frames (Stiles)
- Crown Molding Cabinet Accents
- Crown Molding Ceiling Trim
- Residential Hidden Hinge Adjustable Cabinet Hardware
- Solid Wood (Baltic Birch) Drawer Boxes
- Ball Bearing, Full Extension Drawer Guides
- Beauflor® Flooring (7-Year Cold Crack Warranty)
- Residential Carpet
- Wainscoting
- Satin Nickel Plumbing Fixtures
- Solid Wood Slide-out Fascia Frame
- Decorative Solid Wood Frame Entry Door
- Solid Wood Exit Assist Handle
- Cathedral Ceilings Throughout

GALLEY

- LG® Solid Surface Polished Countertops with Under Mount Sink (15 Year warranty)
- Dual Bowl "Giant" Stainless Steel Kitchen Sink
- High Rise Single Handle Pull-down Kitchen Faucet
- Maxx Air Fan with Rain Sensor & Remote
- Flush Floor Galley Slides
- Coat Closet (Where applicable)
- Hardwood Drawers in Pantry

INTERIOR LED LIGHTING

- LED Lighting Throughout
- Indirect LED Lighting
- Decorative Ceiling Light above Dinette
- Ceiling Fan
- Pendant Lights in Galley
- Dimmer Switch (Living area only)

FURNITURE AND WINDOW COVERINGS

- 90" Three Seat Leather Rear Sofa with Hide-A-Bed
- Theater Seats with Lifetime Frame Warranty
- Free Standing Dinette Table with Dual Leafs and Lift-up Storage
- (4) Residential Chairs (2) with Flip-up Storage (2) Folding
- Day/Night Roller Shades (Living area)
- Night Roller Shades (Bedroom)
- Designer Hard Valance Window Treatments (Where available)
- Designer Soffits with LED Lighting (Where available)
- Solid Wood Window Frame Covering

BATHROOM

- Maxx Air Fan with Rain Sensor & Remote
- Solid Surface Polished Vanity Countertop with Integrated Bowl (Residential height) (Double bowl sinks on 3456RLX)
- Porcelain Toilet with Foot Flush
- "Mega" Fiberglass Molded Shower w/Seat
- Shower Skylight/Dome
- Glass Shower Door
- Adjustable Shower Head
- Medicine Cabinet with Mirrored Door
- Dedicated Heat and A/C Duct

BEDROOM

- 72" X 80" King Bed, Premium, Innerspring Mattress
- Solid Wood Head Board
- Designer Bedspread, Pillows and Sham
- Full Height Hanging Wardrobe
- Stackable/Combo Washer/Dryer Prep
- Washer/Dryer Dual Electrical Outlets (Operates Washer/Dryer at same time)
- Shoe Caddy
- Cubby Storage
- Chest of Drawers
- Cedar Lined Closet and Drawers
- Under Bed Storage
- Solid Hardwood Slide-out Fascia Frame
- 2 Reading Lights with Individual Controls
- 2 Bed Side Power Outlets

APPLIANCES

- Stainless Steel Residential Refrigerator with Inverter
- Furrion® RV Chef Collection Oven (Oversized)
- Furrion® RV Chef Collection Cooktop (3-Burner Residential)
- Range Cover Storage Compartment
- 30" Convection Microwave
- Dyson® DC35 Cordless Vacuum
- 42K BTU LP Furnace
- 15K Dometic® 15K Quiet Cool A/C
- Wired and Framed for Second and Third 13.5K Ducted Dometic® Quiet Cool A/C System
- Fireplace
- 12 Gal. Gas/Electric DSI Water Heater
- "Shurflo" On-demand High Output Water Pump (3 g/min at 55 psi)
- Dual 30 lb. Propane Bottles with Auto Switch Over
- LP Leak Detector
- Carbon Monoxide Detector

ELECTRONICS

- 58" LED TV (Main living area 3456RLX, 3825FLX, 3850RLX, 3875FBX, 3950TZX)
- 32" LED HDTV (Bedroom)
- Bose® Solo 5 Soundbar**
- JBL® Flip 4 Bluetooth Speaker**
- Samsung® Blu-Ray Player**
- Digital TV Antenna with Signal Booster
- "MyRV" Control Center – Smart Phone Compatible

- Cable TV Hook-ups (Main living, bedroom)
- Cable TV Hook-up (Exterior garage bulkhead)
- Satellite Prep (Roof mount)

EXTERIOR

- High-gloss Colored Gel Coat Exterior (Premium quality and thickness)
- Front Cap: Molded High-gloss Gel Coat Fiberglass with Extended Turning Radius (Chamfered Front)
- Rear Cap: Molded High-gloss Gel Coat Fiberglass
- Laminated Front Bulkhead with High Gloss Gel Coat Fiberglass
- Back-up Monitor Camera Prep
- 32" X 76" Entry and Screen Door with High Gloss Gel Coat Fiberglass
- 45° Angled Skirting
- Slam Latch 1.5" Thick Insulated Doors with High Gloss Gel Coat Fiberglass
- Slide End Walls: Laminated with High Gloss Gel Coat Fiberglass
- Automotive Hehr® Frameless Windows
- Hydraulic Slide Room Power
- Individual Slide Room Selector Switches
- Roof Ladder
- Dual Aluminum Wrapped Electric Power Awnings with LED Light Strip (N/A 3950TZX)
- Entry Assist Handle (XL – folding)
- 1.5" Aluminum Belt Rail with Caps (No exposed screws)
- Roto-cast Spun Seamless Water/Waste Tanks
- Enclosed and Heated Underbelly (Forced air heat)
- Thermostatically Controlled Tank Heat Pads (12 Volt Electric)
- Dual Roof Vents-Ventilated Attic
- LED Tail Lights And Rear Running Lights
- LP Quick Disconnect

SLIDE ROOM SEAL AND GASKET SYSTEM

- Aluminum "H" Frame Slide Room Perimeter
- Dual Neoprene Squeegee Seals
- Exterior and Interior "D" Seals
- Exterior "H" Seal

EXTERIOR LIGHTING

- LED Docking Lights (4 – mounted into front cap)
- Rear Cap Lighting: White Reverse and Red Running/Brake Lights
- Security Lights (2)
- Amber Patio Light
- Entry Door Auto Threshold Light
- LED Awning Lights

UTILITY DOCKING COMPARTMENT

- Light (12 Volt)

- Outside Shower (Hot and cold)
- Black Tank Flush System
- Fresh Water Heater Bypass Valve
- Full Coach Water Filtration System
- Winterizing Bypass System
- Protected/Insulated Pull Waste Valves
- Waste Hose Storage Tube
- Nautilus Control

CHASSIS/FOUNDATION

- I-beam "Z" Frame Powder Coated Chassis
- Chamfered Frame Technology
- 12" I-beam Frames (10" I-beam frame 3250RLX, 3350RLX)
- Dexter® 7,000 lb Axles
- Dexter® E-Z Lube Bearing Lubrication System and Nev-R-Adjust Brakes
- MORryde® 3000 Suspension System
- MORryde® 18K Extended Pin Box
- (8) Lug Hubs
- Aluminum Rims 16"
- Premium G-rated Tires
- Spare Tire (Inside storage mounted)
- Hydraulic Front Jacks
- 8" Radius Front Jack Pads
- Electric Rear Stabilizing Jacks
- MORryde® Step Above Quad Aluminum Entry Steps
- Pinless Front Jack Legs
- Flush Floor Slide Design with Steel Ramp and Glide Bar (Main slide rooms)
- Hydraulic Slide System with 2" Steel Rams
- Hydraulic Pump Station with Manual Override

CONSTRUCTION

- 100" Wide Body Construction
- Sidewalls: 2" Welded Aluminum Framed Vacuum Bonded Laminated Walls
- Roof: 5" Double Radiused Aluminum Trusses 16" on Centers
- Roof: Alpha Super Flex II TPO Roof Material
- Front Wall: Welded Aluminum Frame
- Rear Wall: Welded Aluminum Frame
- Floor: 3" Vacuum Bond Laminated with Welded Aluminum Trusses
- Bath/Bed Deck: Welded Aluminum Frame
- Slide End Walls: 2" Welded Aluminum Frame, Vacuum Bonded, Laminated
- Slide Roof: 2" Welded Aluminum Frame, Vacuum Bonded, Laminated
- Slide Floor: 1" Wood Flooring
- No Expansion Gaps

INSULATION

- Sidewalls: High Density Block Foam Insulation (R-9)
- Roof: Fiberglass Batten Insulation and Radiant Foil Insulation (R-38)
- Main Floor: High Density Block Foam Insulation and Radiant Foil Insulation (R-38)

- Sub floor: Honey Combed Polyurethane with Aluminum Radiant Foil Insulation and Direct Forced Air Heat
- Front Cap: Fiberglass Insulation and Radiant Foil Insulation (R-38)
- Rear Cap: Fiberglass Insulation and Radiant Foil Insulation (R-38)

ELECTRICAL SYSTEMS

- "MyRV" Control Center – Smart Phone Compatible
- 70 AMP Converter (Progressive Dynamics)
- 50 AMP Service
- Marine Grade Detachable 50 AMP Power Cord
- 12 Volt Battery Disconnect
- Battery Prep Box (2)
- Energy Management System (Second and third A/C prep 2 A/C's on 30 AMP)
- Roof-mounted Solar Prep

OPTIONS

INTERIOR

- Upgraded Premium Mattress
- Queen Bed (IPO King)
- Extra Dinette Chair
- (2) Recliners IPO Theater Seats
- Electric Theater Seats (N/A 3825FLX, 3950TZX)
- 18 Cu. Ft. 4-Door Gas/Electric Refrigerator
- Dishwasher
- 32" Galley TV (3825FLX, 3950TZX)
- Stackable Washer/Dryer
- Fantastic Fan with Rain Sensor – Bedroom (N/A with second AC)

EXTERIOR

- Full-body Paint Package
- 3, 4 or 5 Slide-out Awnings
- Low Profile 13,500 BTU Quiet Cool Ducted A/C in Bedroom
- Third Low Profile 13,500 BTU Quiet Cool Ducted A/C in Living Area
- Heat Pump for 15,000 BTU A/C (Main A/C)
- Dual Pane Frameless Windows with Safety Glass
- Generator Prep
- 5.5 LP Generator (Includes prep)
- "Level Up" 6-Point One Touch Automatic Hydraulic Leveling System
- Outside Ice Maker
- Bike Hitch
- Exterior Entertainment Center with 32" LED TV
- Hydraulic Disc Brakes
- 200 Watt Roof Mount Solar Panel
- Back-up Monitor Camera

- ** LUXURY ESSENTIAL CARDINAL CAMPING PACKAGE



PRE-DELIVERY INSPECTION FACILITY

20,000 square feet of quality assurance. The bare essentials for a premium product. This state-of-the-art facility gives immediate daily feedback to production for quality assurance in every unit built.

CUSTOMER SATISFACTION



www.ForestRiverBuyLocal.com

24/7 EMERGENCY ROADSIDE ASSISTANCE

For a worry-free ownership experience

Coach-Net[®]

Forest River includes one year of Coach-Net RV Technical & Roadside Assistance with each RV purchase. Whether new to the RV lifestyle or an experienced RV enthusiast, Forest River owners have 24/7 access to technical, operational and emergency road service coverage throughout the US & Canada. Coach-Net's fast, dependable service is just a phone call away.

FREE MEMBERSHIP
to Forest River Owners' Group

www.forestriverfrog.com



GVWR (Gross Vehicle Weight Rating) - is the maximum permissible weight of the unit when fully loaded. It includes all weights, inclusive of all fluids, cargo, optional equipment and accessories. For safety and product performance do NOT exceed the GVWR.

GAWR (Gross Axle Weight Rating) - is the maximum permissible weight, including cargo, fluids, optional equipment and accessories that can be safely supported by a combination of all axles.

UVW (Unloaded Vehicle Weight)* - is the typical weight of the unit as manufactured at the factory. It includes all weight at the unit's axle(s) and tongue or pin and LP Gas. The UVW does not include cargo, fresh potable water, additional optional equipment or dealer installed accessories.

*Estimated Average based on standard build optional equipment.

CCC (Cargo Carrying Capacity)** - is the amount of weight available for fresh potable water, cargo, additional optional equipment and accessories. CCC is equal to GVWR minus UVW. Available CCC should accommodate fresh potable water (8.3 lbs per gallon). Before filling the fresh water tank, empty the black and gray tanks to provide for more cargo capacity.

** Estimated average based on standard build optional equipment

Each Forest River RV is weighed at the manufacturing facility prior to shipping. A label identifying the unloaded vehicle weight of the actual unit and the cargo carrying capacity is applied to every Forest River RV prior to leaving our facilities.

The load capacity of your unit is designated by weight, not by volume, so you cannot necessarily use all available space when loading your unit.

All information contained in this brochure is believed to be accurate at the time of publication. However, during the model year, it may be necessary to make revisions and Forest River, Inc., reserves the right to make all such changes without notice, including prices, colors, materials, equipment and specifications as well as the addition of new models and the discontinuance of models shown in this brochure. Therefore, please consult with your Forest River dealer and confirm the existence of any materials, design or specifications that are material to your purchase decision.

LUXURY STANDARD



SILVER STAR (Optional Full Body Paint)



GARNET NIGHT (Optional Full Body Paint)



MOCHA PEARL (Optional Full Body Paint)



SILVER QUARTZ (Optional Full Body Paint)



Learn More

Scan this barcode using a QR Reader on your smart phone to learn more about Forest River.



A Berkshire Hathaway company.

CARDINAL

3603 S. Nappanee St, Elkhart, IN 46517
(574) 296-7700
www.forestriverinc.com/Cardinal
www.forestriveraccessories.com

YOUR LOCAL CARDINAL DEALER