

LONGHORN

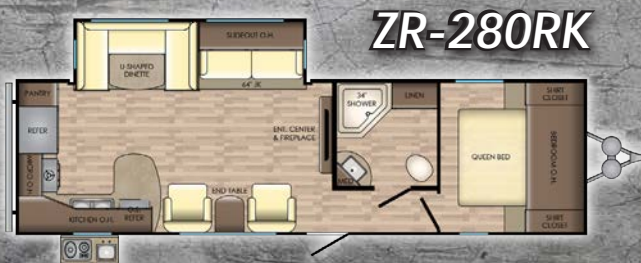

| MODEL | ZR-280RK | ZR-285RL | ZR-328SB | ZR-331BH | ZR-333DB |
|--------------------|--------------|--------------|--------------|--------------|--------------|
| DRY WEIGHT | 6570 | 6522 | 7734 | 8722 | 8196 |
| GVWR | 9610 | 9660 | 9740 | 10150 | 10400 |
| CARRYING CAP. | 3040 | 3138 | 2006 | 1428 | 2204 |
| HITCH WEIGHT | 808 | 864 | 942 | 974 | 904 |
| LENGTH | 32' 11" | 32' 11" | 36' 6" | 36' 11" | 37' 7" |
| EXT. HEIGHT W/ A/C | 11' 2" | 11' 2" | 11' 3" | 11' 3" | 11' 3" |
| FRESH WATER | 51 Gal | 51 Gal | 51 Gal | 51 Gal | 51 Gal |
| BLACK WATER | 44 Gal | 44 Gal | 44 Gal | 44 Gal | 88 Gal |
| GRAY WATER | 88 Gal | 44 Gal | 44 Gal | 44 Gal | 44 Gal |
| TIRE SIZE | ST225/75R15D | ST225/75R15D | ST225/75R15D | ST225/75R15D | ST225/75R15E |

LONGHORN

STANDARDS AND OPTIONS

STANDARDS

LIVING ROOM

- Designer Valances
- Wood Slide-Out Fascia (VBM)
- AM/FM Stereo System with Bluetooth & AUX Jack
- Fireplace (VBM)
- Wood Blinds
- Sleeper Sofa
- Woodgrain Linoleum
- Generous Storage - Doors Under Dinette
- Interior LED Lighting and Accents in Slides, Kitchen, Front Bedroom, & E-Center

KITCHEN

- Range Hood with Light & Exhaust Fan
- Wall Mounted Systems Monitor Panel
- Shaker Style Cabinet Doors
- Cherry Cabinet Doors and Drawers
- Range with 3-Burner Cook-Top
- 6 ft³ Refrigerator
- Steel Ball Bearing Drawer Guides
- Stainless Steel Faucet
- 60/40 Sink
- Stainless Steel Oven
- Stainless Steel Microwave
- Tile Backsplash

BATHROOM

- Large Lavatory Bowl
- Spacious Shower/Tub & One-Piece Surround
- Foot Flush Porcelain Toilet
- Mirrored Medicine Cabinet
- Shower Curtain with Curved Shower Track

BEDROOM

- 60" X 74" Mattress
- Cable TV Hook-up
- Coordinated Window Treatments
- Decorative Bedspread

EXTERIOR

- Fully Enclosed and Forced Air Heated Underbelly
- Backup Camera Prep
- Solar Prep
- Friction Hinge Entry Door
- Keyed-A-Like Exterior Doors
- Aerodynamic Front End
- Easy Open Entry Step
- Bumper with Drain Hose Storage and End Caps
- 2 Marine Grade Exterior Speakers w/ LED Lights
- Diamond Plate Front Stone Guard
- Molded Rain Gutters with 3" Drip Spouts
- 26" Radius Entry Door with Screen Door
- Large Assist Grab Handle
- Black Tank Flush

SAFETY

- Safety Chains
- Break Away Switch
- Electric Brakes on All Wheels
- Carbon Monoxide Detector
- Fire Extinguisher
- GFI Electrical Outlets
- Tinted Safety Glass
- 15" Radial Tires - Nitrogen Filled

CONVENIENCE

PACKAGE (STANDARD)

- Smoke Detector
- LP Detector
- 13,500 BTU A/C
- Awning
- Microwave
- Stabilizer Jacks (4)
- Power Vent in Bathroom
- TV Antenna
- Tub Surround
- Water Heater Bypass
- Quilted Bedspread

OPTIONS

- Upgraded Insulation
- Rear Ladder
- 39" TV
- 15K BTU Main A/C IPO 13.5K BTU
- Power Tongue Jack (Mandatory)
- Exterior Shower (Mandatory)
- LP Bottle Cover (Mandatory)
- Spare Tire and Carrier (Mandatory)
- Electric Awning with LED Light (Mandatory)
- Enclosed Underbelly (Mandatory) (Forced Air)
- Stainless Steel Oven w/ Range Top (Mandatory)
- 6 Gal Gas/Elec. DSI Water Heater (Mandatory)
- LCD Remote System (VBM) (Mandatory)
- 50 Amp Service w/ 2nd A/C Prep (2+ Slides Only)
- 2nd A/C in Bedroom (2+ Slides Only)

*VBM: Varies By Model