

 **FLEETWOOD RV**

LASTING DEPENDABILITY | FAMILY FAVORITE | FEATURE PACKED

www.fleetwoodrv.com

DISCOVERY

2018.5 FLEETWOOD RV CLASS A DIESEL



OUR VEHICLES CONNECT AND PROTECT
PEOPLE AROUND THE WORLD EVERYDAY.
www.revgroup.com



Vehicles for life

FLOORPLANS & EXTERIOR OPTIONS

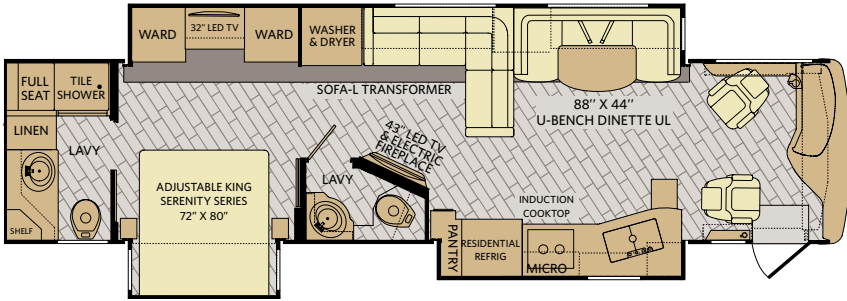
38K Options: 093, 217, 833

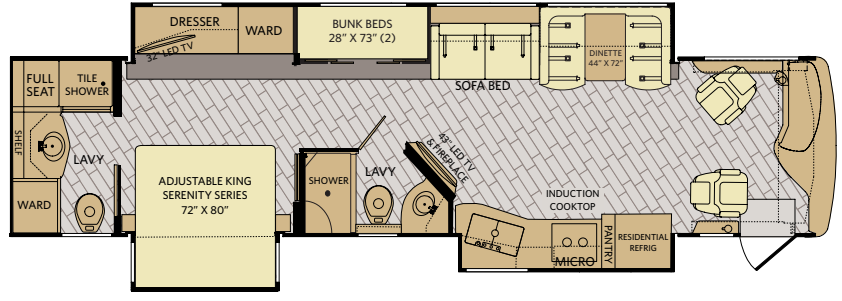

38N Options: 093, 217, 809 830, 883



38F Options: 093, 203, 217, 830

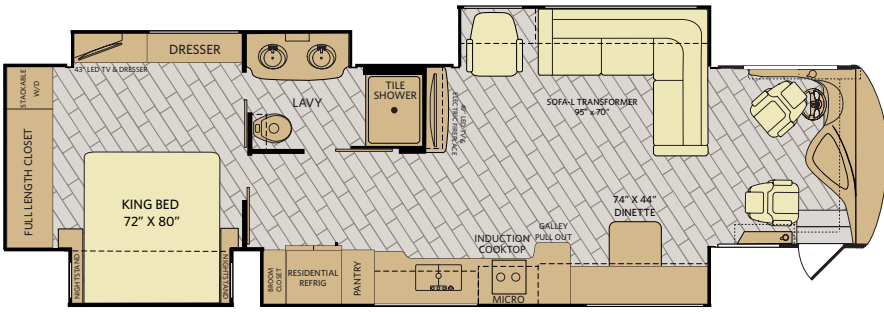

Available Options

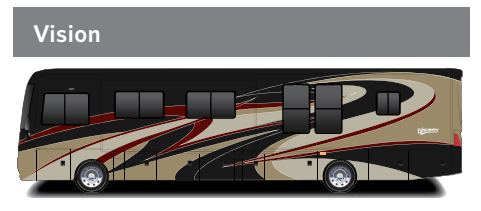
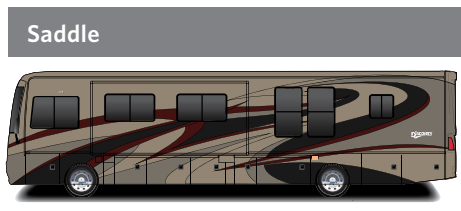
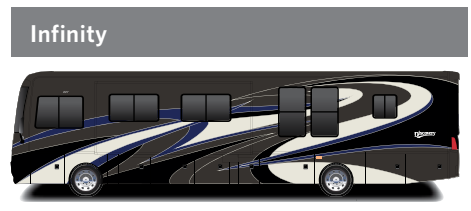
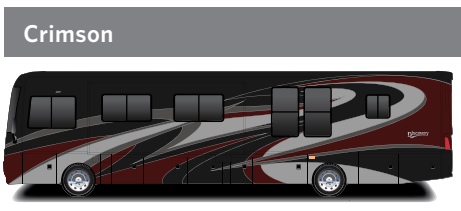
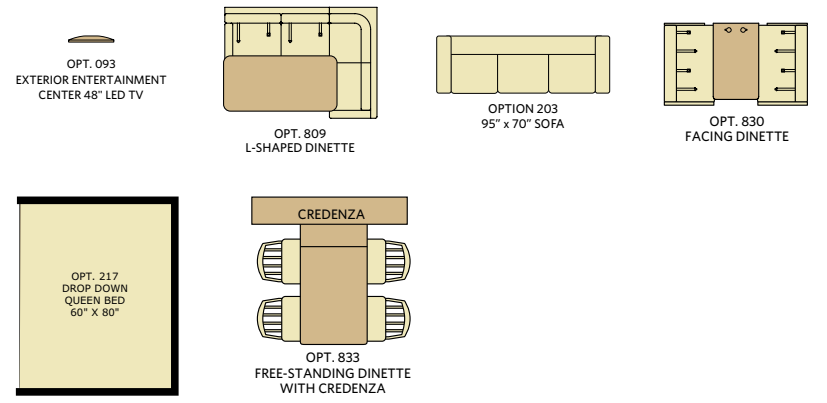

CELESTIAL REFLECTION



TIME SQUARE

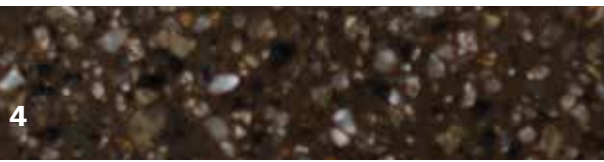

1 SOFA

2 LIVING ACCENT

3 BEDSPREAD

4 COUNTERTOP

5 FLOORING

6 CARPET



NOTTINGHAM CHERRY HIGH GLOSS



AUTUMN WHEAT HIGH GLOSS

CHASSIS

MODEL	38K	38N	38F
Wheelbase (inches)	252"	252"	263"
Front GAWR (lbs) ²	12,400	12,400	12,400
Rear GAWR (lbs) ² - 340HP/360HP	21,000	21,000	21,000
GCWR (lbs) ³ - 340HP/360HP	33,000/43,400	33,000/43,400	33,000/43,400
Hitch Rating Weight(lbs) [†]	10,000	10,000	10,000
Tongue Weight (lbs) [*]	1,000	1,000	1,000
Fuel Capacity (gal)	100	100	100

POWER BRIDGE® CHASSIS

Standard 340HP		Optional 360HP	
Model:	Freightliner® XCS Series	Model:	Freightliner® XC Series
Engine:	Cummins ISB 6.7L	Engine:	Cummins ISB 6.7L
Transmission:	Allison® 2,500 MH 6-Speed w/Electronic Shifter	Transmission:	Allison® 3,000 MH 6-Speed w/Electronic Shifter
Alternator:	Delcom Remy 160 Amp	Alternator:	Delcom Remy 160 Amp
Torque:	700 lb.-ft. @ 1,600 RPM	Torque:	800 lb.-ft. @ 1,800 RPM
Horsepower:	340HP	Horsepower:	360HP

DIMENSIONS AND CAPACITIES

MODEL	38K	38N	38F
Overall Length (inches) ⁴	38' 8"	38' 8"	40' 1"
Overall Height (with A/C)	12' 10"	12' 10"	12' 10"
Overall Width (maximum) ^{5,6}	102"	102"	102"
Interior Height (maximum)	84"	84"	84"
Interior Width (maximum)	96"	96"	96"
Patio Awning Width (feet & inches)	10' 8"	18'	19' 6"
Interior Storage (cu. ft.)	151	151	173
Exterior Storage (cu. ft.)	156	156	156
Fresh Water Holding Tank (gal)	100	100	100
Grey Water Holding Tank (gal)	75	75	75
Black Water Holding Tank (gal)	50	50	50
Aqua-Hot 400	S	S	S



DISCLAIMERS

- GVWR (Gross Vehicle Weight Rating) is the maximum permissible weight of this fully loaded motor home. The GVWR is equal to or greater than the sum of the (UVW) unloaded vehicle weight plus the (OCCC) occupant cargo-carrying capacity.
 - GAWR (Gross Axle Weight Rating) is the maximum permissible loaded weight a specific axle is designed to carry.
 - GCWR (Gross Combined Weight Rating) is the value specified by the motor home manufacturer as the maximum allowable loaded weight of this motor home with its towed vehicle. Towing and braking capacities may be different. Refer to Fleetwood and chassis manufacturer's manuals for complete information.
 - Length measured from front bumper to rear bumper (excludes accessories).
 - Excludes safety equipment and awnings.
 - Motor homes feature a body width over 96" which will restrict your access to certain roads. Before purchasing, you should research any state and/or province road laws which may affect your usage.
 - Tank manufacturer's listed water capacity (WC). Actual propane capacity is 80% of water listing as required by the safety code.
- † The chassis manufacturer recommends the installation of a supplemental brake control system to activate the brakes on the vehicle or trailer you are towing. Hitch receiver ratings expressed are maximum for the hitch receiver installed and may require the purchase of additional equipment that is dependent on the weight of the towed load. Consult with hitch receiver manufacturer for further information.
- * UVW and OCCC are found on the label containing the federal certification tag in each RV.
- ** Seatbelts and locations are shown in the brochure for display purposes only. Actual numbers and locations will vary by model.
- *** All 2018 REV Recreation Group motorhomes include a limited one year/15,000-mile coach warranty and three-year/45,000-mile structural warranty, whichever occurs first, and is fully transferable for the first 12 months.

FLEETWOOD MOTORHOME ASSOCIATION

As a Fleetwood RV owner, you're invited to become a member of the Fleetwood Motorhome Association (FMA). Becoming a member is the perfect way to meet other Fleetwood owners who love to travel across America and share in the RV lifestyle. Visit the FMA website at www.fma4fun.org to learn more and join the fun.

CONTACT US

To locate a dealer near you, visit our website at www.fleetwoodrv.com or call 1-800-322-8216. We can also be contacted at Fleetwood RV Customer Relations, P.O. Box 1007, Decatur, IN 46733.

IMPORTANT—PLEASE READ: Product information, photography and illustrations included in this publication were as accurate as possible at the time of printing. For further product information and changes, please visit our website at www.fleetwoodrv.com or contact your local Fleetwood RV dealer. Prices, materials, design and specifications are subject to change without notice. All weights, fuel, liquid capacities and dimensions are approximate. Fleetwood RV has designed its recreational vehicles to provide a variety of uses for its customers. Each vehicle features optimal seating, sleeping, storage and fluid capacities. The user is responsible for selecting the proper combination of loads (i.e., occupants, equipment, fluids, cargo, etc.) to ensure that the vehicle's capacities are not exceeded.

www.fleetwoodrv.com

©2017 REV Group, Inc. Printed in the USA. Inventory Control Number DIS18F1, 08/17. Model Year 2018, First Edition.