

Sunseeker

BY FOREST RIVER



GTS



A Berkshire Hathaway company.



MBS



TS



Shown in Truffle Decor with optional Weathered Teak cabinetry

Tasteful design, combined with a unique combination of style, value and preferred amenities make travel in the Sunseeker comfortable and loads of fun. Sunseeker's unique split level design provides maximum headroom in the living area, while still offering pass-through storage on every floorplan. Plus, all Sunseekers are "Certified Green" by TRA Certification.



This outdoor camp kitchen is standard on 2860DS.

Sunseeker
BY FOREST RIVER

STANDARD SERIES



**CLASS C TOP
FEATURES**

- ◆ 7' Ceiling height
- ◆ Crowned fiberglass roof
- ◆ 2" Thick gel coat sidewalls with Azdel "Superlight" composite
- ◆ Firestone Ride Right suspension
- ◆ Enclosed and heated tanks
- ◆ Water filtration system
- ◆ 7500 Lb. tow rating
- ◆ Windows in cab over bunk area
- ◆ Residential cabinetry
- ◆ Waste Master® RV sewer management system



Shown in Carmel Decor with optional Rustic Cherry cabinetry

DECOR
CARMEL



PEWTER

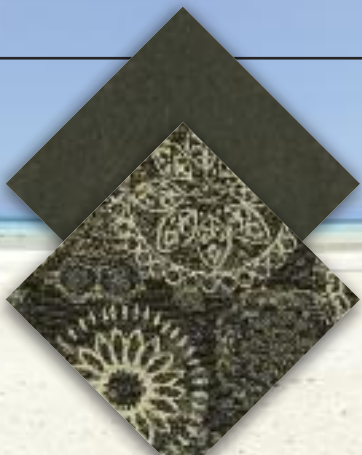

TRUFFLE

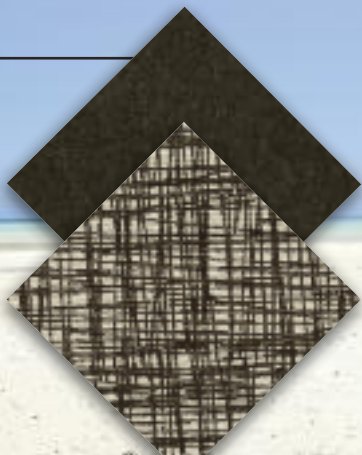

CABINETY

RUSTIC CHERRY



WEATHERED TEAK



Not available in LE Models

Sunseeker

BY FOREST RIVER

CLASS C FLOORPLANS

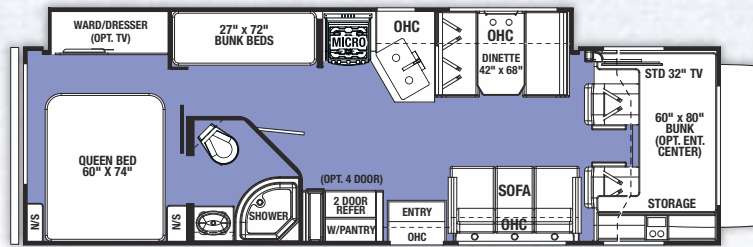
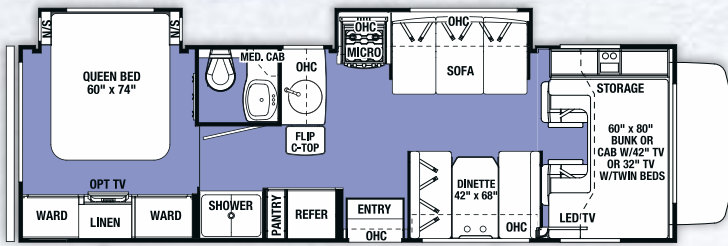
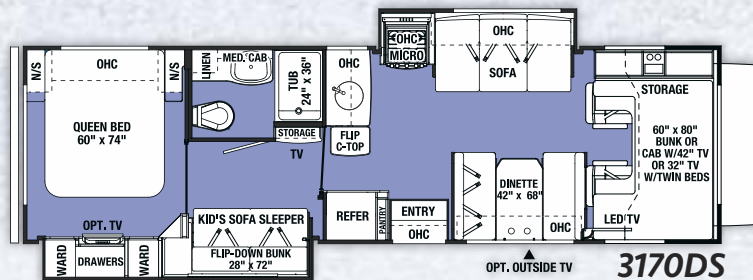
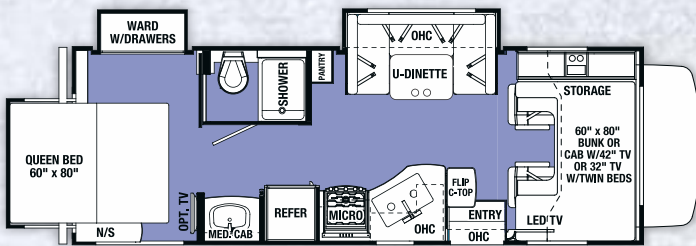
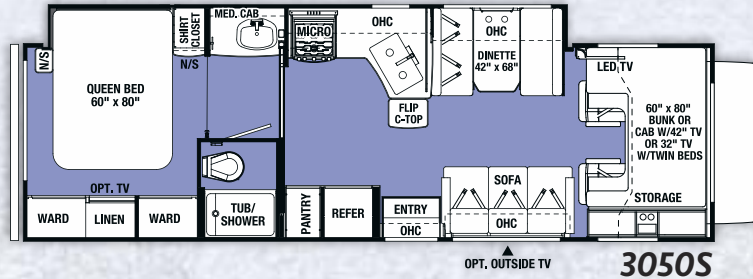
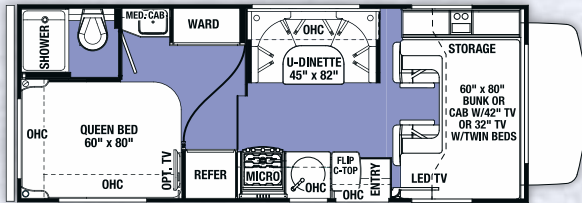
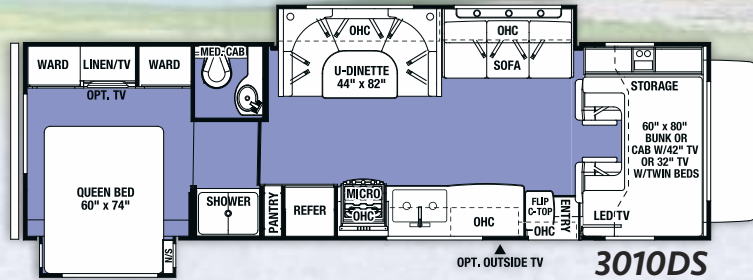
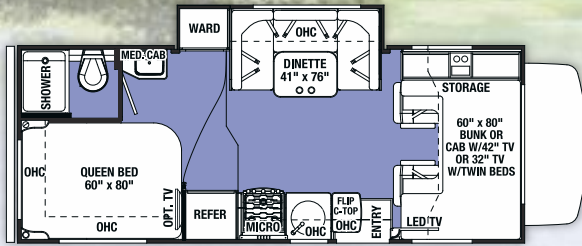

OPTIONS

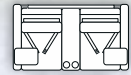

OPT. RECLINERS
3010DS



4-DOOR REFER
OPT. SIDE-BY-SIDE REFER

2860DS,
3010DS,
3050S

Sunseeker Ford • Chevy Chassis	2290	2300	2500	2860	3010	3050	3170	3270
Wheelbase	158" • 159"	158" • 159"	182" • 183"	202" • 203"	220" • NA	220" • NA	220" • NA	220" • NA
GVWR	12500 • 14200	12500 • 14200	14500 • 14200	14500 • 14200	14500 • NA	14500 • NA	14500 • NA	14500 • NA
GAWRR	8500 • 9600	8500 • 9600	9600 • 9600	9600 • 9600	9600 • NA	9600 • NA	9600 • NA	9600 • NA
GAWRF	4600 • 4600	4600 • 4600	5000 • 4600	5000 • 4600	5000 • NA	5000 • NA	5000 • NA	5000 • NA
UVW	0 • 10452	9950 • 9890	11721 • 11500	12300 • 12400	12400 • NA	12848 • NA	12500 • NA	TBD
GCWR	18500 • 20000	18500 • 20000	22000 • 20000	22000 • 20000	22000 • NA	22000 • NA	22000 • NA	TBD
CCC	2500 • 3748	2550 • 4310	2779 • 2700	2200 • 1800	2100 • NA	1652 • NA	2000 • NA	TBD
Fuel Capacity (Gal.)	55 • 57	55 • 57	55 • 57	55 • 57	55 • NA	55 • NA	55 • NA	TBD
Hitch Rating	5000/500 • 5000/500	5000/500 • 5000/500	7500/500 • 5000/500	7500/500 • 5000/500	7500/500 • NA	7500/500 • NA	7500/500 • NA	TBD
Length - Bumper To Bumper	24'-6" • 25'	24'-6" • 25'	26'-11" • 27'-5"	30'-9" • 31'-3"	32'-3" • NA	31'-11" • NA	32'-3" • NA	TBD
Exterior Height With A/C	11'-3"	11'-3"	11'-3"	11'-3"	11'-3"	11'-3"	11'-3"	11'-3"
Exterior Width	101"	101"	101"	101"	101"	101"	101"	101"
Interior Width	95.5"	95.5"	95.5"	95.5"	95.5"	95.5"	95.5"	95.5"
Interior Height Frt/Rear	84"/77"	84"/77"	84"/77"	84"/77"	84"/77"	84"/77"	84"/77"	84"/77"
Fresh/Grey/Black Water (Gal.)	44/39/39	44/39/39	44/39/39	44/39/39	44/39/39	44/39/39	44/39/39	44/39/39
L.P. Capacity (Gal.)	9.8	9.8	9.8	9.8	9.8	9.8	9.8	9.8
Awning Length	15'-6"	15'-6"	18'	16'	15'-6"	18'	11'	TBD
Water Heater (Gal.)	6	6	6	6	6	6	6	6
Exterior Storage (Cu. Ft.)	61	61	50	62.5	101.7	81.8	80	TBD

GVWR (Gross Vehicle Weight Rating) - is the maximum permissible weight of the unit when fully loaded. It includes all weights, inclusive of all fluids, occupants, cargo, optional equipment and accessories. For safety and product performance do NOT exceed the GVWR.

GCWR (Gross Combined Weight Rating) - is the maximum permissible loaded weight of your motor home and any towed trailer or towed vehicle. Actual GCWR of this vehicle may be limited by the sum of the GVWR and the installed hitch receiver maximum capacity rating; see hitch rating label for detail.

GAWR (Gross Axle Weight Rating) - is the maximum permissible weight, including cargo, fluids, optional equipment and accessories that can be safely supported by each axle.

UVW (Unloaded Vehicle Weight)* - is the typical weight of the unit as manufactured at the factory. It includes all weight at the unit's axle(s), including full fuel, all fluids and LP Gas. The UVW does not include cargo, fresh potable water, additional optional equipment or dealer installed accessories.

CCC (Cargo Carrying Capacity)** - is the amount of weight available for fresh potable water, cargo, passengers, additional optional equipment and accessories. CCC is equal to GVWR minus UVW. Available CCC should accommodate fresh potable water (8.3 lbs. per gallon). Before filling the fresh water tank, empty the black and gray tanks to provide for more cargo capacity.

*Estimated Average based on standard build optional equipment. ** Estimated average based on standard build optional equipment.

Each Forest River RV is weighed at the manufacturing facility prior to shipping. A label identifying the unloaded vehicle weight of the actual unit and the cargo carrying capacity is applied to every Forest River RV prior to leaving our facilities. The load capacity of your unit is designated by weight, not by volume, so you cannot necessarily use all available space when loading your unit. Actual towing capacity is dependent upon your particular loading and towing circumstances, which includes the GVWR, GAWR and GCWR as well as adequate trailer brakes. Please refer to the Operator's Manual of your vehicle for further towing information.

PAINT OPTIONS



AMBER Full body paint



STERLING Full body paint



STANDARD Exterior

Sunseeker

BY FOREST RIVER

HIGH QUALITY CONSTRUCTION



DARE TO COMPARE

Multi-Layered Laminated Roof System

1. Crowned Fiberglass Roof
2. Luan Decking
3. Block Foam Insulation
4. A/C Ducts
5. Tubular Aluminum Framing
6. Interior Ceiling Material

Vacuum-Bond Laminated Sidewalls

7. Decorative Interior Wall Board
8. Tubular Aluminum Framing
9. EGS Metal Backers
10. Block Foam Insulation
11. Opening Framed In Aluminum
12. Superlite Composite - Azdel
13. Gelcoat Fiberglass Exterior

Vacuum-Bond Laminated Floor System

14. Fiberglass Bottom Board
15. Block Foam Insulation
16. Seamless Floor Decking
17. Beauflor Flooring (In Some Areas)
18. Aluminum Framing



LARGE WINDOWS WITH BLACK-OUT ROLLER SHADES
Large panoramic windows for plenty of fresh air and natural light.



LED LIGHTING
LED lights generate almost no heat compared to incandescent lights and use substantially less power.



RESIDENTIAL STYLE CABINETRY
Sunseeker is appointed with ball bearing drawer glides and rich hardwood cabinetry.



USB CHARGING STATION
12V 4-port USB charging station (Living room/bedroom)



FULLY DUCTED AIR
All floorplans are ducted for better air flow throughout the coach and front cabover.



ENCLOSED BATTERIES
Two batteries in a single housing for easy access. (One battery LE and Transit)



MEMORY FOAM
Memory foam mattress will ensure a good nights sleep.



HEATED AND ENCLOSED HOLDING TANKS
The Sunseeker features a heated and enclosed utility station. Your tanks and valves are protected using warm air from the furnace. (N/A 2250 SLE, MBS and Transit Series)



KING JACK ANTENNA
This HD digitally amplified antenna enhances reception.



FIBERGLASS ROOF
Durable, easy to clean (R-18) crowned fiberglass sheds water and doesn't cause black streaks like a rubber roof.

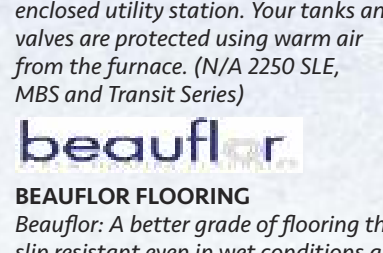

BEAUFLOR FLOORING
Beauflor: A better grade of flooring that is slip resistant even in wet conditions and highly resistant to tears. Unlike vinyl floors with paper backing, our backing remains stable in extreme hot or cold and is backed by a seven-year cold crack warranty.



WATER FILTRATION
This compact unit filters water for the entire coach, eliminating those unwanted contaminants and odors, ensuring safe drinking water for you and your family. (N/A LE Series)



SEAMLESS FRONT CAP
For enhanced aerodynamics



WASTE MASTER SEWAGE MANAGEMENT SYSTEM
Rugged for quick, easy and sanitary disposal of waste. (N/A LE and Transit)



SOLAR PREP



OUTSIDE SPEAKERS



WHOLE HOUSE ENTERTAINMENT
This multimedia system features AM/FM/DVD, Bluetooth, plus outside speaker control.



INTEGRATED STEP
Sunseeker's entry step is integrated into the sidewall. No more slippery, or damaged power steps.



OPTIONAL CAB OVER BUNK SAFETY NET
The overhead bunk is rated for 500 lbs.



POWER AWNING WITH LED STRIP
Extend and retract your awning with the push of a button. Both arms are adjustable to get just the right angle.



Pioneer IN-DASH STEREO SYSTEM
Pairs up with your smart phone to access GPS and other applications. (N/A on Transit or LE Series)



WINTERIZING TUBE
Easy access for quick maintenance includes bypass valve.



MAXX AIR FAN
Recirculates air throughout the entire coach.



7,500 LB. TOW CAPACITY
Ford E450 only (N/A on LE Series)

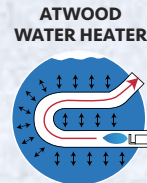

ATWOOD WATER HEATER
Atwood 18 GPH water heaters (6 gallon tank) out perform traditional 10 and 12 gallon tank water heaters. They're also 50% lighter and have no anode rod to replace.

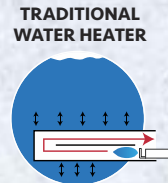

FIRESTONE RIDE-RITE
Adjustable air springs provide an improved ride and a better way to balance loads. (N/A LE or MBS Series)



360 siphon
RV VENT CAP
This holding tank vent cap eliminates odors and gases from the holding tanks and exhausts them out the roof, without the use of costly chemicals.

CHARGE WIZARD
Progressive Dynamics converter with the patented 4-stage Charge Wizard® system has been shown to increase the battery life by 2 to 3 times or more. The Charge Wizard constantly monitors battery voltage and battery usage then selects one of four operating modes to properly charge and maintain the battery. Boost, Normal, Storage and Equalization.



SUNSEEKER VS. THE COMPETITION



SUNSEEKER
2" Wall with Block Foam and Superlite (R-10)



SUPER LITE WALLS
All models use SuperLite composite instead of a wood substrate on the sidewalls. It is lightweight, formaldehyde free and is not affected by moisture.



COMPETITION
1.5" Wall with Luan (R-6)



LE Series are only available with standard Weathered Teak cabinetry.

Sunseeker LE Series is the industry's best value on the market today! Enjoy years of carefree travel with these well-built Class Cs.

Ford • Chevy	2250SLE	2850SLE	3250DSLE
Wheelbase	158" • 159"	TBD	220" • NA
GVWR	14200	14500	14500 • NA
GAWRR	9600	9600	9600 • NA
GAWRF	4600	5000	5000 • NA
UVW	9660 • 9640	TBD	12500 • NA
GCWR	20000	22000	22000 • NA
CCC	2840 • 4560	TBD	2000 • NA
Fuel Capacity (Gal)	55 • 57	55	55 • NA
Hitch Rating	5000/500	7500/500	7500/500 • NA
Length - Bumper To Bumper	23'-10" • 24'-4"	TBD	32'-3" • NA
Exterior Height With A/C	11'-3"	11'-3"	11'-3"
Exterior Width	101"	101"	101"
Interior Width	95.5"	95.5"	95.5"
Interior Height Frt/Rear	84"/77"	84"/77"	84"/77"
Fresh/Grey/Black Water (Gal)	33.5/32/27	44/39/39	44/39/39
L.P. Capacity (Gal)	9.8	9.8	9.8
Awning Length	14'	TBD	11'
Water Heater (Gal)	6	6	6
Exterior Storage (Cu. Ft.)	32	32	80

LE SERIES

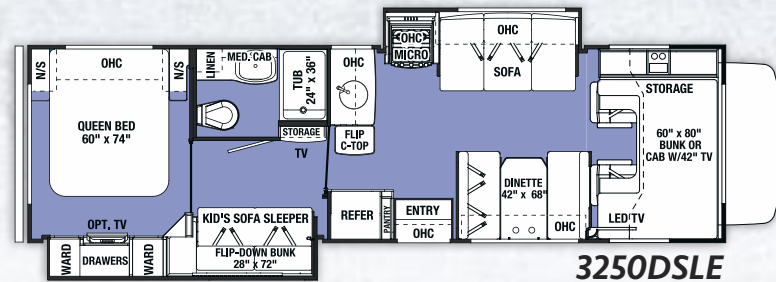
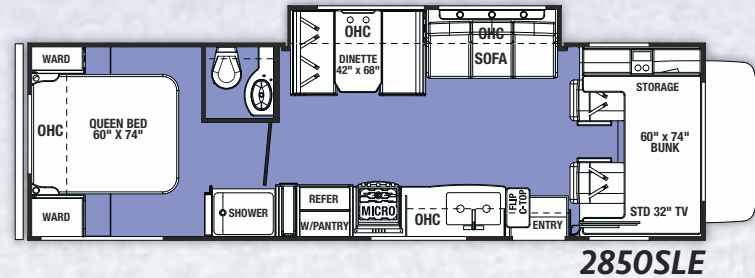
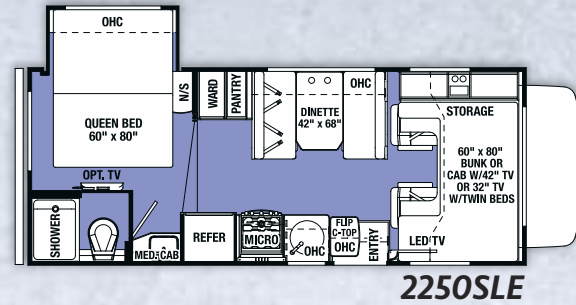



Shown in Pewter Decor with Rustic Cherry cabinetry.



GRAND TOURING SERIES

The streamlined GTS is the perfect vehicle for the ultimate getaway.

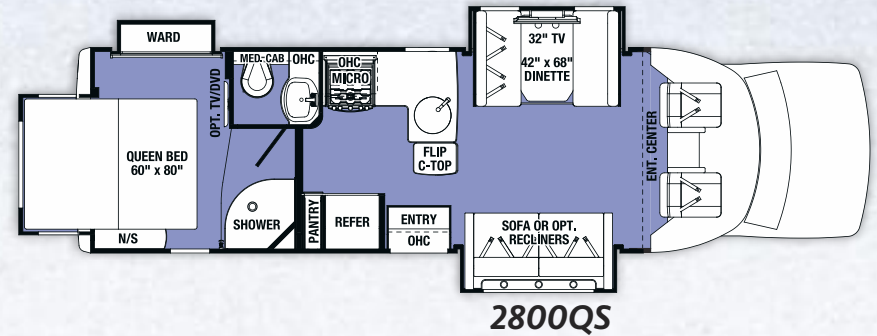
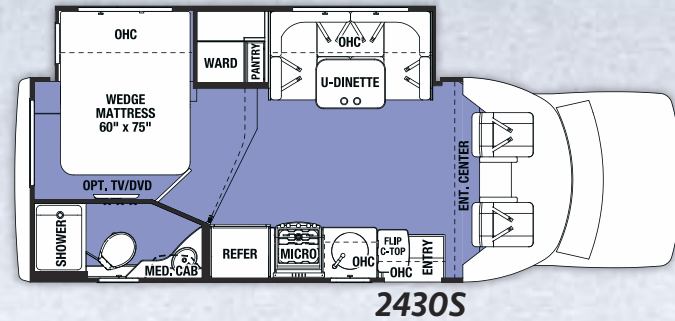

Sunseeker GTS	2430	2800
Wheelbase	176"	212"
GVWR	14500	14500
GAWRR	9600	9600
GAWRF	5000	5000
UVW	10920	11596
GCWR	22000	22000
CCC	3580	2904
Fuel Capacity (Gal)	55	55
Hitch Rating	7500/500	7500/500
Length - Bumper to Bumper	25'-9"	30'-4"
Exterior Height with A/C	10'-8"	10'-8"
Exterior Width	97"	97"
Interior Width	91"	91"
Interior Height Front/Rear	81"/75.5"	81"/75.5"
Fresh Water (Gal)	42/39/39	43/42/28
L.P. Capacity (Gal)	9.8	9.8
Awning Length	15'-6"	18'
Water Heater (Gal)	6	6
Exterior Storage (Cu. Ft.)	37.8	73

OPTIONS

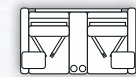

OPT. RECLINERS
2800QS



OPT. SOFA
2430S





MBS MERCEDES-BENZ® SERIES

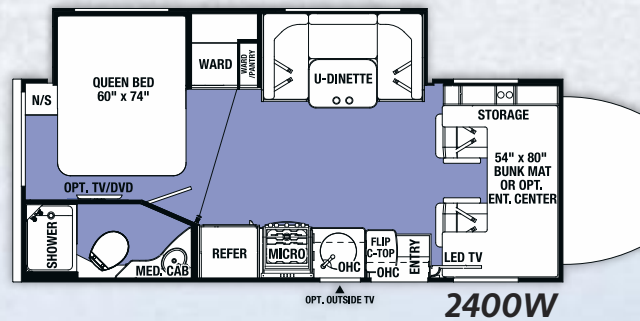
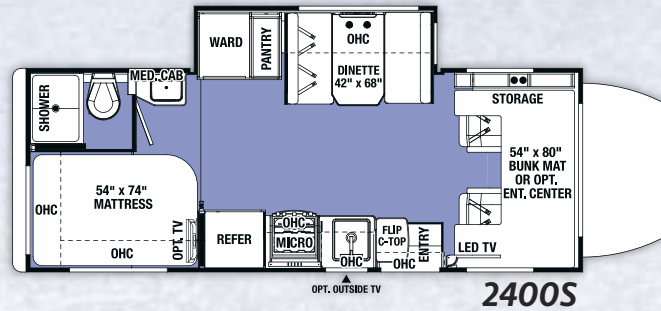
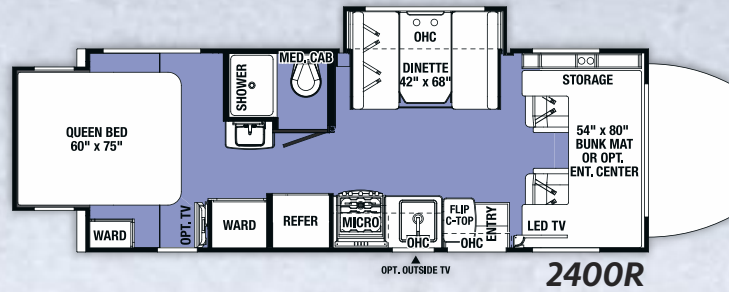

OPTIONS

MBS

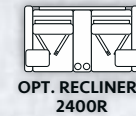

OPT. RECLINERS
2400R

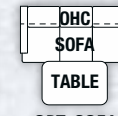

OPT. SOFA
2400R, 2400S,
2400W



Standard swivel seats
and booster cushions.



BlueTec Diesel Engine

BlueTec SCR Technology is one of the world's cleanest diesel engines, delivering more power, while producing fewer emissions. The 3.0l V-6

engine boasts
188 hp and
325 lb-ft
of rated
torque.

Shown with low profile Trekker cap option for aerodynamic styling and improved fuel economy. Seamless front cap is accented with LED light strips.



Sunseeker MBS	2400R	2400S	2400W
Wheelbase	170.3	170.3	170.3
GVWR	11030	11030	11030
GAWRR	7720	7720	7720
GAWRF	4080	4080	4080
UVW	9852	9700	9924
GCWR	15250	15250	15250
CCC	1178	1330	1106
Fuel Capacity (Gal)	26.4	26.4	26.4
Hitch Rating	4200/350	4200/350	4200/350
Length - Bumper To Bumper	24'-11"	24'-8"	24'-11"
Exterior Height With A/C	11'-3"	11'-3"	11'-3"
Exterior Width	94.5"	94.5"	94.5"
Interior Width	91"	91"	91"
Interior Height Frt/Rear	81"/74"	81"/74"	81"
Fresh/Grey/Black Water (Gal)	35/30/30	35/33/33	35/32/32
L.P. Capacity (Gal)	16.4	16.4	16.4
Awning Length	16'	15'-6"	16'
Water Heater (Gal)	6	6	6
Exterior Storage (Cu. Ft.)	75	67	50.3



Shown in Charcoal Decor

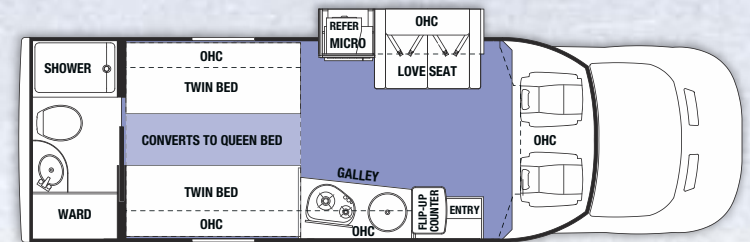

TS2370

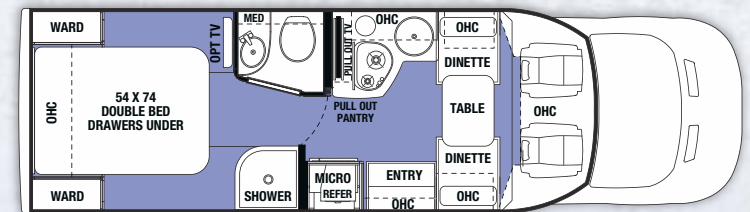

TS2390

Sunseeker TS	2370	2390
Wheelbase	178"	178"
GVWR	10360	10360
UVW	8706	8050
GCWR	13500	13500
CCC	1654	2310
Fuel Capacity (Gal.)	25	25
Hitch Rating (Lb.)	2000	2000
Length - Bumper to Bumper	25' - 6"	25' - 6"
Exterior Height with A/C	10' - 3"	10' - 3"
Exterior Width	87"	87"
Interior Width	84"	84"
Interior Height Front/Rear	78"	78"
Fresh/Grey/Black Water (Gal.)	35/29/29	35/29/29
L.P. Capacity (Gal.)	9.8	9.8
Awning Length	15'	15'
Exterior Storage (Cu. Ft.)	38	38
Seat Belts	4	4



TRANSIT SERIES

Ultra-Light Weight Maneuverability with Exceptional Fuel Efficiency

The ultra-light Sunseeker TS is engineered for fuel efficiency with eco-friendly building materials. These lightweight, Poplar cabinets are certified to be sustainably sourced from European forests.

DECOR

CHARCOAL

Transit Series is available in Charcoal decor only.



WARRANTY	SS	GTS	MBS	LE	TS
12 Months/12,000 mile basic limited warranty	S	S	S	S	S
Chassis warranty (see owners manual)					
SYSTEMS	SS	GTS	MBS	LE	TS
Battery disconnect	S	S	S	S	S
Water heater bypass	S	S	S	S	S
(2) Deep cycle coach batteries (1 battery in LE and Transit)	S	S	S	S	S
"Easy Access" battery in step-well	S	S	S	S	S
30 Amp service with detachable cord	S	S	S	S	S
60 Amp Progressive Dynamics converter	S	S	S	S	S
6 Gallon DSI gas/electric water heater	S	S	S	S	-
30,000 BTU furnace	S	S	S	S	-
Truma Combi water heater/furnace	-	-	-	-	S
Emergency start switch	S	S	-	S	S
Satellite/cable connection	S	S	S	S	S
13,500 BTU ceiling ducted roof air	S	S	S	S	S
4.0 KW Onan Microquiet generator	S	S	-	S	-
3.6 KW Onan LP generator	-	-	S	-	-
2.5 KW Onan LP generator	-	-	-	-	S
Automatic generator transfer switch	S	S	-	-	S
Firestone Ride-Rite air helper springs	S	S	-	-	-
Hellwig sway bar	-	-	S	-	-
Water filtration system	S	S	S	-	S
Heated, enclosed holding tanks and valves	S	S	-	-	-
Arctic Package (12V tank heaters)	O	O	S	O	O
15K BTU A/C with heat pump	O	O	O	O	O
CO ₂ , LP and smoke detector	S	S	S	S	S
Jack digital antenna	S	S	S	S	S
EXTERIOR	SS	GTS	MBS	LE	TS
2" Aluminum framed laminated sidewalls	S	S	-	S	-
1.5" Aluminum framed laminated sidewalls	-	-	S	-	S
Azdel Superlight composite substrate	S	S	S	-	-
Gel Coat exterior fiberglass	S	S	S	S	S
Block foam insulation	S	S	S	S	S
Power patio awning with LED light strip	S	S	S	S	S
Slide-out awnings	S	S	S	-	-
Fiberglass roof	S	S	S	S	S
One-piece fiberglass front cap	S	S	S	S	S
LED exterior lights	S	S	S	S	S
Stainless steel wheel liners	S	S	S	S	S
Valve stem extensions	S	S	S	-	-
Roto-cast storage compartments	S	S	S	S	S
Driver side security light	-	-	S	-	-
Aluminum running boards	S	-	-	O	-
Fiberglass running boards	-	S	S	-	S
110V, GFI protected exterior receptacle	S	S	S	S	S
Tinted sliding windows	S	-	-	S	-
Tinted frameless windows	-	S	S	-	S
Heated, remote exterior mirrors	S	S	-	-	-
7,500 Lbs. hitch, 7-pin connector (E450)	S	S	-	-	-
5,000 Lbs. hitch, 7-pin connector (Chevy/E350)	S	S	-	S	-
4,200 Lbs. hitch, 7-pin connector	-	-	S	-	-
Spare tire	S	S	S	S	S
Roof ladder (N/A 2400R, 2800QS)	S	-	S	S	-
Integrated entry step	S	S	-	S	S
Power entry step	-	-	S	-	-
Outside shower	S	S	S	-	S

	SS	GTS	MBS	LE	TS
Automatic leveling system (4-point)	O	O	-	O	-
Stabilizer jacks (2-point)	-	-	S	-	-
Full body paint	O	O	O	-	O
32" Outside 12V TV with speakers (3010DS, 3050S, 3170DS only)	O	-	-	-	-
19" Outside TV	-	-	O	-	-
Exterior grill with quick connect (standard 2860DS)	O	O	O	-	-
Black tank flush	S	S	S	-	S
19" Outside 12V TV with DVD and speakers	-	-	O	-	-
CAB AREA	SS	GTS	MBS	LE	TS
7" Touch screen radio with USB and Bluetooth	S	S	S	S	-
Cab area privacy curtain	S	S	S	S	S
Ultra leather driver and passenger seats	S	S	S	-	S
Power windows and door locks	S	S	S	S	S
Keyless entry (N/A Chevy)	S	S	S	S	S
Color back-up camera	S	S	S	S	S
Side view cameras	S	S	S	-	S
Removable cab mat	-	-	S	-	-
Swivel driver seat (N/A Chevy, Power)	O	O	S	-	-
Power driver seat (Ford only)	O	O	-	-	-
Swivel passenger seat (N/A Chevy)	O	O	S	-	-
KITCHEN	SS	GTS	MBS	LE	TS
Recessed 3-burner range with flush glass cover	S	S	S	S	-
Range hood with fan and light	S	S	S	S	-
Oven IPO drawer	S	O	O	S	-
Microwave oven	S	-	-	S	-
Convection microwave (Standard in 3050S)	O	S	S	-	S
6 Cu. ft. double door refrigerator	S	S	S	S	-
12 Cu. ft. four door refrigerator with ice maker (2860DS, 3010DS, 3050S)	O	-	-	-	-
5.3 Cu. ft. lightweight LP/Electric 110V Refrigerator	-	-	-	-	S
Raised wood refrigerator panel (N/A 12 cu. ft.)	S	S	S	-	-
Full extension ball bearing drawer guides	S	S	S	S	S
Flip-up countertop extension	S	S	S	S	-
BATHROOM	SS	GTS	MBS	LE	TS
Lightweight composite toilet with hand sprayer	S	S	S	S	S
Glass shower door	S	S	-	-	-
Lightweight Arcadia shower door	-	-	S	S	-
Towel bar, tissue, toothbrush and soap holder	S	S	S	S	S
Electric roof fan	S	S	S	S	S
Shower head with flexible extension	S	S	S	S	S
Shower skylight	S	S	S	S	S
BEDROOM	SS	GTS	MBS	LE	TS
Upgraded memory foam mattress	S	S	S	S	S
Bedspread	S	S	S	S	S
Black-out roller shades	S	S	S	S	-
Bedroom TV with DVD	O	O	O	-	O
LIVING ROOM	SS	GTS	MBS	LE	TS
Dream dinette (N/A with U-shape dinettes)	S	S	S	-	-
Visionary pull out sofa (60" x 74") (3010DS)	S	-	-	-	-
12V LED flat panel adjustable side TV	S	S	S	S	S
Cab over cabinets with 42" TV (IPO side TV)	O	-	-	-	-
Child seat head tethers in dinette	S	S	S	-	-
Maxx Air fan in living room	S	S	S	S	S
LED lighting throughout	S	S	S	S	S
Dual recliners IPO Sofa (3010DS, 2800QS, 2400R)	O	O	-	-	-
12V USB charging station	S	S	S	-	S



PRE-DELIVERY INSPECTION FACILITY

20,000 square feet of quality assurance. The bare essentials for a premium product. This state-of-the-art facility gives immediate daily feedback to production for quality assurance in every unit built.



Forest River, Inc. encourages our customers to purchase their Forest River products from a local dealership whenever possible for the following reasons:

- 1) Forest River, Inc. dealers are independently owned and operated businesses so priority service and scheduling is at their discretion and is often provided to customers that purchased their unit at that dealership.
- 2) Purchasing locally allows customers to establish meaningful relationships with a dealer, enhancing the RV experience through assistance with product questions, user tips or RV regulations for your state or country, and much more!
- 3) Canadian customers must meet requirements to bring an RV purchased out of the country to their home. These requirements may involve additional inspections and certifications, taxes and fees. Your local Canadian Dealer is a professional at meeting these requirements.
- 4) Scheduling timely warranty repairs and adjustments through a local dealership provides far greater flexibility and convenience to you, the customer!

It is the goal of Forest River, Inc. that all of our RV owners fully enjoy the RV experience and that customer satisfaction meets or exceeds their expectations!

24/7 EMERGENCY ROADSIDE ASSISTANCE

For a worry-free ownership experience Forest River includes one year of Coach-Net RV Technical & Roadside Assistance with each RV purchase. Whether new to the RV lifestyle or an experienced RV enthusiast, Forest River owners have 24/7 access to technical, operational and emergency road service coverage throughout the US & Canada. Coach-Net's fast, dependable service is just a phone call away.



Learn More
Scan this barcode using a QR Reader on your smart phone to learn more about Forest River.



A Berkshire Hathaway company.