

White Hawk 2018



Jayco

Generations of family fun.



2
YEAR
LIMITED
WARRANTY



Our Wings Get You There

Family fun happens when you spread your wings. Thanks to Jayco's amenity-packed floorplans, rock-solid construction and two full camping seasons of warranty coverage, you can. Greater peace of mind and added comfort mean better memories and lasting bonds. So go ahead. Hit the road—and let the good times fly.

Generations of Family Fun



Lengths: 28' 2" to 37' 10"*; Weights: 5,560 to 7,775 lbs.

*Estimated



2018 WHITE HAWK SOARS TO NEW HEIGHTS

Building on the legendary foundation of engineering and craftsmanship that's made it so popular, the 2018 White Hawk lineup features more than ten brand-new floorplans, extra high-gloss exteriors with slick linear graphics and completely reimagined interior stylings. Experience it for yourself.

WHAT'S NEW WITH WHITE HAWK—INSIDE AND OUT



EXTERIOR

- Available gelcoated fiberglass front cap with automotive windshield and LED lighting*
- American-made, nitro-filled Goodyear® Endurance® radial tires with automotive-style rims*
- Two-toned sidewalls with a brilliant gloss and fresh take on classic Jayco linear-style graphics
- Self-adjusting electric brakes
- Full LED lighting

*Pictured above

INTERIOR

- Stainless steel appliances and upgraded cooktops*
- 39-inch LED TVs standard with optional fireplace (requires 50-amp service)*
- Power roof vents standard in bathroom, master bedroom and optional Fan-Tastic Vent power fan in living area
- Updated materials, finishes and detailing throughout
- Additional LED lighting and larger windows
- Second A/C option in all models (requires 50-amp service)

Is your tow vehicle
WHITE HAWK ready?



Scan the QR code for complete towing guide resources



29BH INTERIOR FRONT TO BACK



29BH INTERIOR LED ACCENT LIGHTING UNDER DINETTE AND SOFA, ABOVE SLIDEOUT



29BH FULL KITCHEN



29BH BEDROOM CLOSET



31BH REAR BUNKHOUSE



29BH INTERIOR BACK TO FRONT

WHITE HAWK

This year's updated finishes, from the window treatments to the stainless steel in the kitchen and everywhere in between, look even better thanks to larger windows and added LED lighting.



29FLS FRONT CAP WITH LED LIGHTS



29BH A-FRAME-MOUNTED 2-BIKE CARRIER



23MRB MURPHY BED IN UP POSITION



23MRB MURPHY BED IN DOWN POSITION WITH WINDSHIELD FRONT VIEW



23MRB L-DINETTE

FLOORPLANS

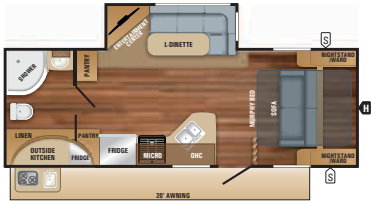

WHITE HAWK | 23MRB
Ext. Lgth: 28' 2" Ext. Ht: 131"
Unloaded Wt. (lbs): 5,560 Sleeps: 2-4

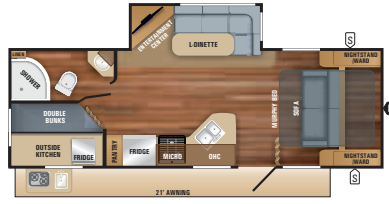

WHITE HAWK | 24MBH
Ext. Lgth: 29' 2" Ext. Ht: 131"
Unloaded Wt. (lbs): 5,680 Sleeps: 6-8

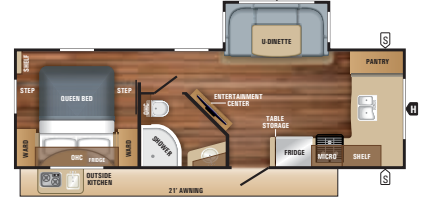

WHITE HAWK | 25FK OPTION A
Ext. Lgth: 30' 2" Ext. Ht: 132"
Unloaded Wt. (lbs): 5,720 Sleeps: 2-4

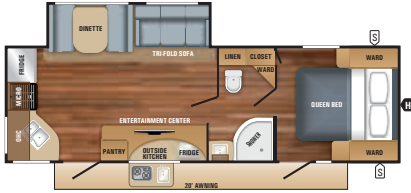

WHITE HAWK | 26RK OPTIONS: A, B
Ext. Lgth: 31' 2" Ext. Ht: 132"
Unloaded Wt. (lbs): 5,975 Sleeps: 2-6

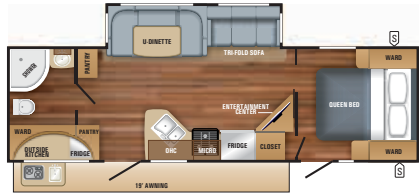

WHITE HAWK | 27RB OPTIONS: A, B
Ext. Lgth: 32' 8" Ext. Ht: 134"
Unloaded Wt. (lbs): 6,500 Sleeps: 2-6

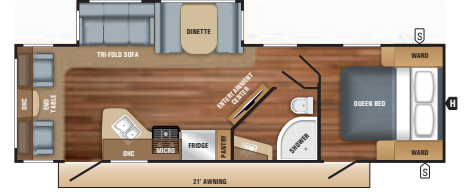

WHITE HAWK | 28RL
Ext. Lgth: 33' 4" Ext. Ht: 134"
Unloaded Wt. (lbs): 6,425 Sleeps: 2-6

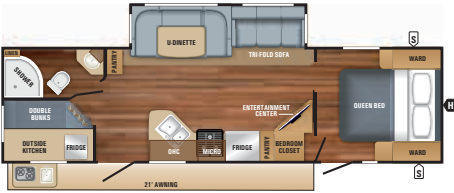

WHITE HAWK | 29BH OPTIONS: A, B
Ext. Lgth: 34' 7" Ext. Ht: 134"
Unloaded Wt. (lbs): 6,820 Sleeps: 2-6

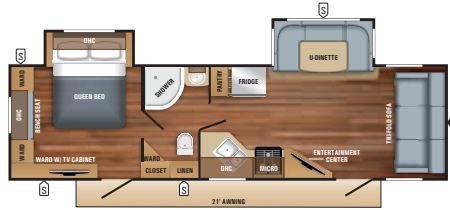

WHITE HAWK | 29FLS OPTION A
Ext. Lgth: 34' 5" Ext. Ht: 134"
Unloaded Wt. (lbs): 6,635 Sleeps: 4-6

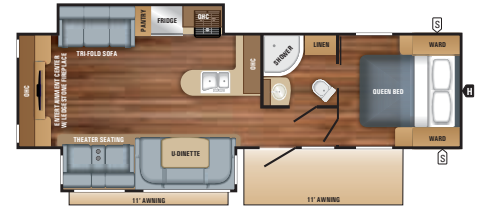

WHITE HAWK | 29RE OPTION A
Ext. Lgth: TBD Ext. Ht: TBD
Unloaded Wt. (lbs): TBD Sleeps: 4-6

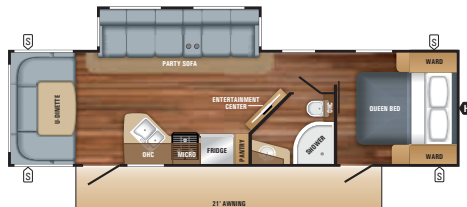

WHITE HAWK | 30RD
Ext. Lgth: 35' 2" Ext. Ht: 135"
Unloaded Wt. (lbs): 6,545 Sleeps: 5-6

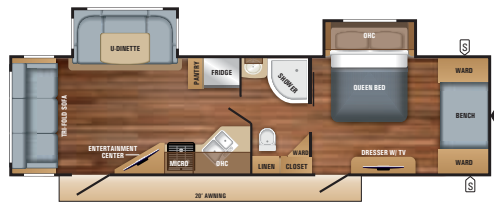

WHITE HAWK | 30RLS OPTIONS: A, C
Ext. Lgth: 36' 2" Ext. Ht: 135"
Unloaded Wt. (lbs): 6,710 Sleeps: 2-6

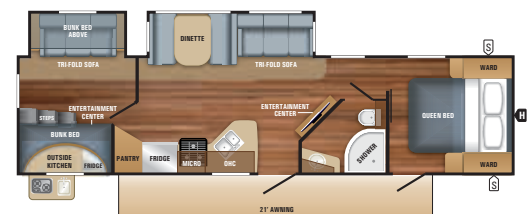

WHITE HAWK | 31BH OPTIONS: A, B
Ext. Lgth: 37' 6" Ext. Ht: 135"
Unloaded Wt. (lbs): 7,775 Sleeps: 4-8



WHITE HAWK | 31RL OPTION A
Ext. Lgth: 36' 11" Ext. Ht: 136"
Unloaded Wt. (lbs): 7,560 Sleeps: 4-6

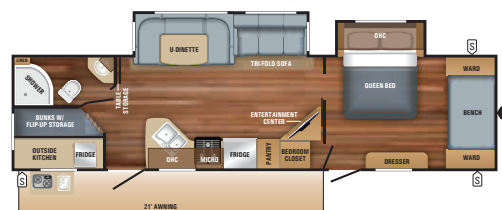

WHITE HAWK | 32BHS OPTIONS: A, B
Ext. Lgth: 37' 10" Ext. Ht: 136"
Unloaded Wt. (lbs): 7,475 Sleeps: 4-8

OPTIONS:

OPTION A



TABLE & CHAIR OPTION

OPTION B



THEATER SOFA OPTION

OPTION C

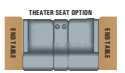

THEATER SEAT OPTION

FLOORPLAN LEGEND:

- STORAGE
- OVERHEAD CABINETS
- TRAILER HITCH
- REFRIGERATOR
- MICROWAVE
- WARDROBE

SPECS

MODELS	DIMENSIONS				WEIGHT (LBS.)				TANKS (GALS.)		
	FLOORPLAN	EXTERIOR TRAVEL LENGTH	EXTERIOR WIDTH	EXTERIOR HEIGHT WITH A/C	INTERIOR HEIGHT	UNLOADED VEHICLE WEIGHT	DRY HITCH WEIGHT	GROSS VEHICLE WEIGHT RATING	CARGO CARRYING CAPACITY	FRESH WATER CAPACITY (INCLUDES WATER HEATER)	GREY WASTE WATER CAPACITY
23MRB	28' 2"	96"	131"	81"	5,560	560	7,250	1,690	48	30.5	30.5
24MBH	29' 2"	96"	131"	81"	5,680	605	7,350	1,670	48	30.5	30.5
25FK	30' 2'	96"	132"	81"	5,720	725	7,500	1,780	48	61'	30.5
26RK	31' 2***	96"	132***	81"	5,975**	600**	7,700**	1,725**	48	61'	30.5
27RB	32' 8"	96"	134"	81"	6,500	610	8,200	1,700	48	61'	30.5
28RL	33' 4"	96"	134"	81"	6,425	650	8,150	1,725	48	61'	30.5
29BH	34' 7"	96"	134"	81"	6,820	730	8,500	1,680	48	61'	30.5
29FLS	34' 5"	96"	134"	81"	6,635	845	8,350	1,715	48	61'	30.5
29RE	TBD	96"	TBD	81"	TBD	TBD	TBD	TBD	48	TBD	30.5
30RD	35' 2"	96"	135"	81"	6,545	815	8,500	1,955	48	61'	30.5
30RLS	36' 2***	96"	135***	81"	6,710**	725**	8,500**	1,790**	48	61'	30.5
31BH	37' 6"	96"	135"	81"	7,775	795	9,500	1,725	48	61'	30.5
31RL	36' 11"	96"	136"	81"	7,560	810	9,250	1,690	48	30.5	30.5
32BHS	37' 10***	96"	136***	81"	7,475**	965**	9,250**	1,775**	48	61'	30.5

*Split tank **Estimated

Unloaded Vehicle Weight (UVW): Sometimes referred to as "Dry Weight," UVW means the typical weight of this trailer as built at the factory. The UVW, as used in product literature and other promotional materials, does not include cargo, fresh water, propane, options or dealer-installed accessories.

Gross Vehicle Weight Rating (GVWR): GVWR means the maximum permissible weight of the trailer, including the UVW plus personal items, all cargo, fluids, options and dealer-installed accessories. The GVWR is equal to or greater than the sum of the UVW and the CCC.

Cargo Carrying Capacity (CCC): CCC means the maximum weight of personal items, food, fresh water, propane, tools, other cargo and dealer-installed accessories that can be carried by the trailer. CCC is equal to or less than GVWR minus UVW. The addition of options will decrease the CCC.

Hitch Weight (HW): The hitch weight, as used in product literature and other promotional materials, does not include cargo, fresh water, propane gas, options or dealer-installed accessories. The addition of these types of items will either add to or subtract from the stated hitch weight.

It is important for your safety and enjoyment that your tow vehicle be adequately sized and equipped to tow and handle the GVWR of the RV you select. Review weights and rating of your tow vehicle and consult a competent advisor for questions or advice. Whether you are new to RVing or a veteran, get a feel for the performance of your tow vehicle before heading out on the roadways. When you tow an RV, you must drive differently than when you drive a single vehicle. Practice hooking up, driving, backing up and braking in a safe environment or seek out professional instruction. Jayco affixes a weight label to each RV which lists weight information for that vehicle. See specifications chart above.

STANDARDS AND OPTIONS

CUSTOMER VALUE PACKAGE (mandatory)

- 13,500-BTU A/C
- Spare tire and cover
- Microwave
- 6-gallon gas/electric auto-ignition water heater
- ABS propane bottle cover
- Bath skylight
- Outside shower
- Oven
- Tub surround
- Aluminum rims
- Power awning with LED light
- Electric tongue jack
- American-made, nitro-filled Goodyear® Endurance® radial tires

STANDARD EXTERIOR EQUIPMENT

- Aerodynamic, rounded front profile with front diamond plate
- Self-adjusting electric brakes
- Deluxe graphics package with two-toned sidewalls
- Tuff-Shell™ vacuum-bonded, laminated side, rear and front walls (including slideout room walls)
- Magnum Truss™ Roof System with seamless DiFlex II material
- 5/8-inch, tongue-in-groove plywood floor deck
- Fully enclosed underbelly
- Norco® NextGen frame with integrated A-frame
- G20 dark-tinted safety-glass windows
- 30-inch, friction-hinged main entry doors (most models)
- Swing-out grab handle
- Exterior TV bracket with 110V and cable outlets
- Outdoor camp kitchen (23MRB, 24MBH, 25FK, 26RK, 27RB, 29BH, 31BH, 32BHS)
- Slam-latch™ on front pass-through storage doors (select models)
- Marine-grade exterior speakers (2)
- Tracker-Wide™ axles with Super Lube™

- Galvanized steel, impact-resistant wheel wells
- Slideout rooms with double seals, barrier sponges and U-channel drip spouts
- Black tank flush system
- 30-amp service
- Dual 20-pound propane bottles with auto-regulator
- Solar prep
- Stabilizer jacks with sand pads (4)
- Furrion® mounted camera bracket for pre-wired rear backup prep
- Keyed-Alike™ lock system
- Detachable power cord
- Exterior LED lighting

STANDARD INTERIOR EQUIPMENT

- Solid hardwood jointed cabinets with screwed-and-glued lumbercore cabinet stiles
- Overhead cabinetry with smoked-glass inserts
- Large residential countertops
- Deep, split-bowl, acrylic sink with high-rise, pullout faucet and dry rack/sink cover combo
- 8-cubic-foot refrigerator with stainless front panels
- 3-burner, 9,000-BTU range
- Decorative backsplash
- Ball-bearing drawer glides with 75-pound capacity
- Arched interior ceiling
- LED lighting throughout
- Directional and closeable central A/C vents
- 39-inch LED TVs
- AM/FM/CD/DVD/Bluetooth® stereo with speakers
- Booth dinettes with removable storage tote(s) underneath (select models)
- Plywood dinette, bunk and bed bases
- Wood-grain accent paneling on select interior walls
- 60-inch x 80-inch queen beds with built-in storage totes (60-inch x 75-inch in Murphy bed models and 25FK)
- Jayco-exclusive Simmons® mattress with bedspread
- Full-height hanging wardrobes with adjustable shelves
- Solid wood door enclosures for master bedroom (n/a on Murphy bed models)

- Fixed bunks with 110V outlet and corner shelf
- Teddy bear soft-touch bunk mats (applicable models)
- Bathroom medicine cabinets
- Porcelain foot flush toilet
- Residential vinyl flooring with cold-crack resistance
- High-output auto-ignition furnace with wall thermostat
- 34-inch-radius shower with solid enclosure
- Stainless steel appliances with upgraded burner cooktop
- 14-inch x 14-inch powered roof vents in bathroom and main bedroom
- All-new full bedroom closet (27RB, 29BH, 32BHS)

OPTIONS

- Customer Value Package with 15,000-BTU A/C
- Fireplace (standard in 29RE) (requires 50-amp service)
- Kitchen skylight with shade
- Solid-surface kitchen countertops
- Freestanding table with chairs (4) in lieu of booth dinette (select models)
- Theater seating (select models)
- Second 13,500-BTU A/C (requires 50-amp service)
- 50-amp service with second A/C prep (required with second A/C or fireplace options)
- 30-pound propane bottles
- A-frame-mounted 2-bike carrier
- Glacier Package: Astro-Foil™ insulation added to main floor, slideout room floor and roof
- Power stabilizer jacks
- 5-way power remote (select models)
- 8-way power remote (select models)
- Front gelcoated and molded cap with LED lighting and windshield
- 2-foot x 4-foot exterior folding table in pass-through storage (select models)
- Outside bumper-mount grill
- Roof ladder
- Fan-Tastic Vent power roof vent (location varies by model)
- Sani-Con® Turbo waste management system
- Electric auto-leveling system (select models)
- Frameless, G20 dark-tinted windows

INTERIOR DÉCOR

SADDLE

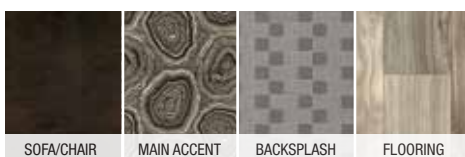

COCOA

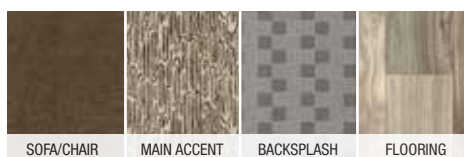

DESERT



TAKE A RIDE ON THE CAREFREE SIDE

Designed for camping comfort and convenience, Jayco RVs provide an easy-going, family-fun experience that relieves your stress. With countless features and reliable construction, you'll breathe easy no matter where your adventures take you and yours.



THE JAYCO DIFFERENCE

- 1. Main walls and slideout walls are vacuum-bonded** for 15-18 minutes using 144 tons of pressure to ensure a strong bond
- 2. Seamless residential vinyl**, laid over a 5/8-inch, tongue-and-groove plywood floor deck, stands up to family foot traffic and withstands cold, cracks and scratches
- 3. Lightweight materials and aerodynamic profile** for easier towing
- 4. American-made, nitro-filled Goodyear® Endurance® radial tires** with self-adjusting brakes
- 5. Magnum Truss Roof System** withstands 4,500 pounds—50 percent more than other roofs

JAYCO'S ROOF **VS** OTHER ROOFS



4,500 POUNDS ON A JAYCO ROOF VS. OTHER ROOFS

THE MAGNUM TRUSS™ ROOF SYSTEM **50 percent stronger**

- 6. 3/8-inch plywood roof decking** secured at every seam
- 7. Galvanized steel wheel wells** reinforced to protect while towing
- 8. Norco® NextGen frame with integrated A-frame** prevents the hitch from buckling
- 9. Large Slam-latch™ baggage doors**
- 10. Tuff-Shell™ vacuum-bonded** sidewalls, front and rear walls (including slideout room walls)



Meet your Jayco Dealer

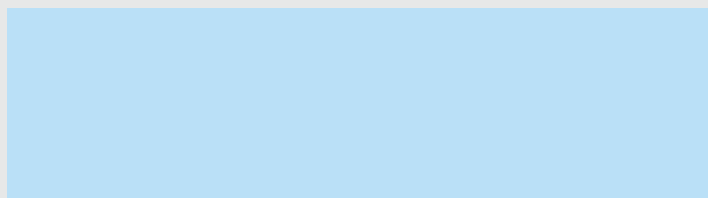

We work hard—so you can play hard. From finding the perfect Jayco for your family to providing flexible financing options and full-service support, we're here to help.

Travel with Confidence



At Jayco, we build our RVs to handle every adventure, then back them with our industry-leading 2-year limited warranty. We, with support from our select partners, have you covered for **2 camping seasons**. That's **730 days**. You won't find a better warranty in the business, because the only strings we attach are those that deliver the ultimate in reliability. That's the Jayco difference. So go explore. We have the warranty that will follow you anywhere. For a copy of our 2-year limited warranty with complete terms and conditions, please contact your local Jayco dealer.



Featuring Durawall® Technology—ENGINEERED to help you tow with confidence

eco advantage™

Jayco's long-term commitment to generations of family fun

After six years of increased efforts to eliminate waste, conserve energy and increase recycling, we've come a long way in building RVs that are not only better for your family—but also better for the planet.

Learn more at Jayco.com/EcoAdvantage

Follow Jayco



Jayco, Inc. | P.O. Box 460 | Middlebury, IN 46540 © **RVIA** See dealer for further information and prices. All information in this brochure and on www.jayco.com is the latest available at the time of publication approval. Jayco reserves the right to make changes and to discontinue models without notice or obligation. Photography may show optional equipment or props used for decoration purposes only. RVs built for sale in Canada may differ to conform to Canadian codes. JAYCO and the JAYCO BIRD IN FLIGHT are registered trademarks of Jayco, Inc. Printed in USA 70K 07/17 ©2017 Jayco, Inc. 274775