

QuickSilver™

by *Living' Lite*



TENT
CAMPERS



10.0 ▼ Aluminum Package Décor

Comfortable sleeping and dining accommodations are offered in every QuickSilver. No matter which way you turn, our generous windows provide fantastic vistas and zip up nice and tight at night.

Livin' Lite's QuickSilver Tent Campers feature an all-aluminum superstructure. With dry weights starting out around 700 pounds, there isn't a need to go buy a big truck to tow – your family passenger vehicle can pull it with ease!

Not only are they lightweight, they're incredibly durable. The front of the camper is protected with a tough black diamond plate rock guard. The aluminum-clad exterior is available in nine automotive paint colors. Additionally, the interior features all-aluminum construction, and the interior wallboard is Azdel®-backed, which is mold and mildew resistant. No wood, no rot!



10.0 ▼ Aluminum Package Décor

QuickSilver tent campers are versatile and lightweight, offering removable furniture, generous storage and best of all, all-aluminum construction, which means, NO ROT!



10.0 ▼ Aluminum Package Décor

Dinettes and L-lounges convert for extra sleeping spaces.



10.0 ▼ Aluminum Package Décor

The 10.0 flip-up kitchenette offers counter-height food prep, and the 14XL kitchenette includes a 2-burner cooktop.

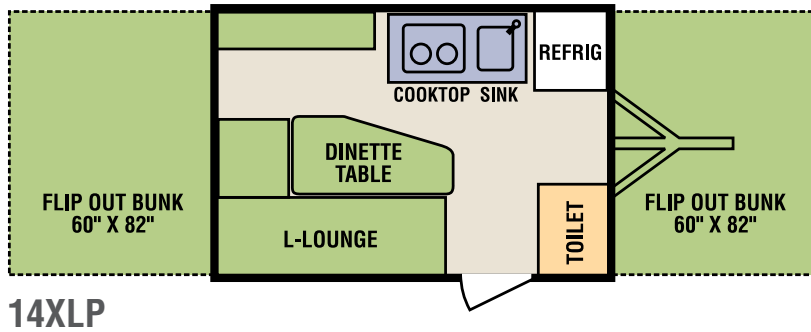
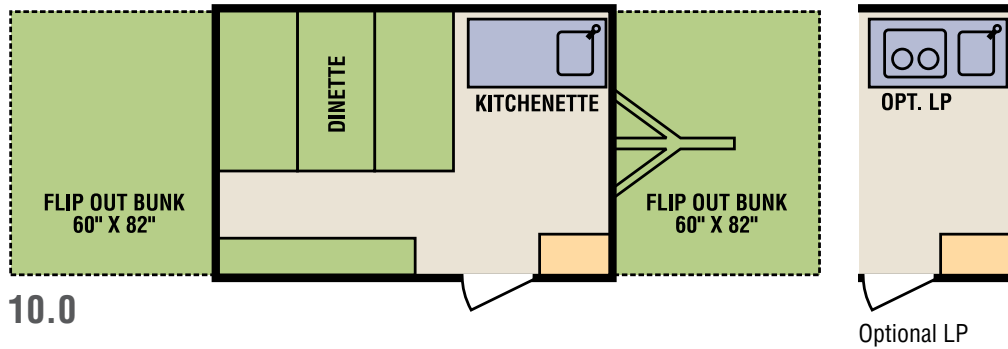
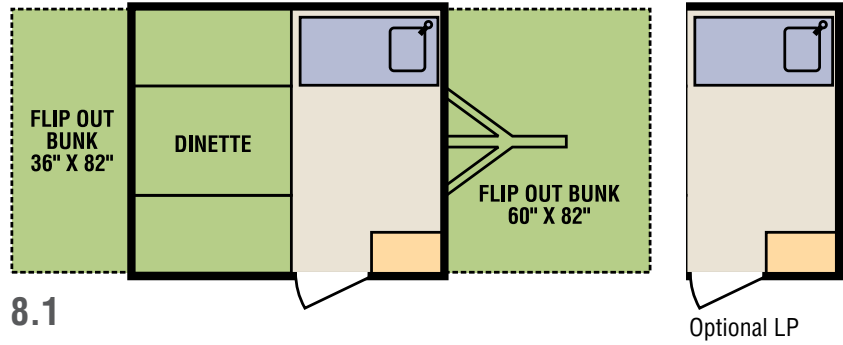
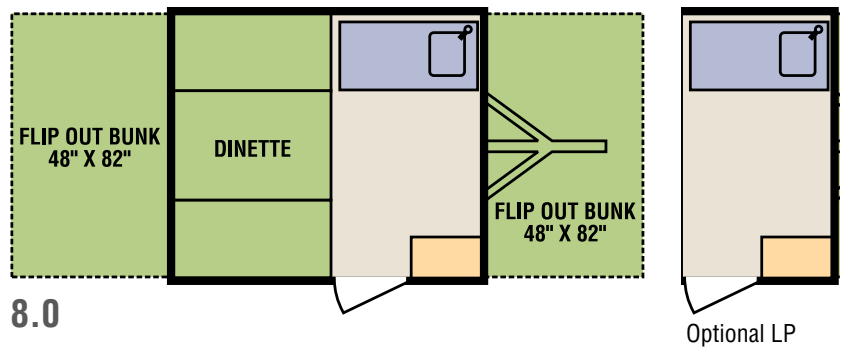
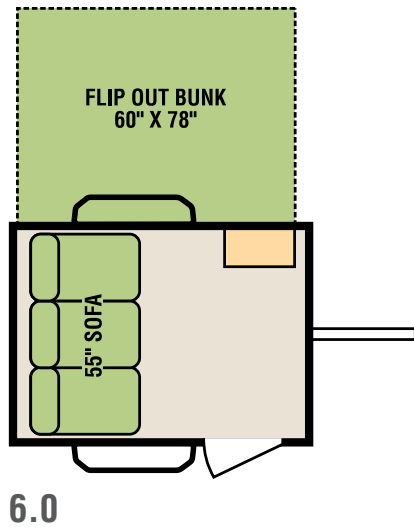

	6.0	8.0	8.1	10.0	14XLP
Unloaded Vehicle Weight* (lbs.)	712	1,040	1,040	1,190	1,765
Dry Hitch Weight* (lbs.)	86	185	185	135	210
Cargo Carrying Capacity (lbs.)	574	685	685	506	945
GVWR (lbs.)	1,286	1,685	1,685	1,696	2,710
Travel Height	4' 0"	4' 0"	4' 0"	4' 0"	4' 6"
Travel Width	6' 3"	7' 0"	7' 0"	7' 0"	7' 0"
Overall Travel Length	10' 0"	12' 0"	12' 0"	14' 0"	17' 5"
Camping Height	8' 0"	8' 2"	8' 2"	8' 2"	8' 6"
Overall Camping Length	10' 0"	16' 0"	16' 0"	20' 0"	20' 0"
Hitch Height (Standard)	17.5"	17.5"	17.5"	17.5"	17.5"
Hitch Height (Off Road Pkg.)	20"	20"	20"	20"	20"
Tire Size	12"	12"	12"	12"	13"
Sleep Capacity	3	6	6	6	6

*This weight reflects the rolling average unit weight for each model. Your trailer weight will vary according to optional equipment.

QuickSilver™

by Livin' Lite

2017 Décor



Aluminum Package – leather and cabinetry

2017 Exterior Colors



Crystal White



Silver Frost



Light Pewter



Charcoal Gray



Yellow



Orange



Victory Red



Indigo Blue



Black

Standards

Interior Features

- Aluminum Cabinetry (champagne color)
- Trek® Residential Freeze/Crack-Proof Linoleum
- Lightweight Composite Countertops
- Hand Pump Sink w/Water Tank & City Water Fill (N/A 6.0)
- Marine-Grade Vinyl Cushions
- 12V Fan/Light Package
- 12V & 110V Outlets
- Under-Seat Thermoformed Storage Compartments
- Thetford Cassette Toilet (14XLP only)

Exterior/Construction Features

- Extremely Lightweight Design
- All-Tubular Aluminum Frame
- Swivel Jack on Tongue
- Front/Rear Stabilizer Jacks
- Pre-Wired Zamp® Solar
- 30 Amp Converter w/25 Amp Output (6.0, 8.0, 8.1, 10.0)

- 30 Amp Converter w/35 Amp Output (14XLP only)
- Composite Material throughout (water & mold resistant)
- All-Weather Tonneau Cover
- Heavy Duty Tent w/Zippered Windows & Emergency Exits on Beds
- .40 Aluminum Siding w/Full-Body Automotive Paint (9 color choices)
- Radial Tires (sidewall & tread function independently, allowing additional tire flexibility. Ensures more ground contact, more stability & control)
- Aluminum Mag Rims
- Diamond Plate Exterior Trim
- Battery Box
- External Detachable Table
- NO WOOD – NO ROT

Options

- Electric Brakes (STD 14XLP)
- Aluminum Rear Storage Deck (STD 14XLP)
- 5,000 BTU Air Conditioner (6.0)

- 8,000 BTU Air Conditioner (8, 8.1, 10, 14XLP)
- 7-Way Plug (STD w/electric brake option & XLP)
- Awning
- Awning Room (incl. awning)
- Privacy Drapes
- RVIA/QAI/Canadian Standards
- RVIA Seal
- State Seal

XLP Package

HOT Water Package, incl. LP Water Heater, Water Pump, 20 GAL Fresh Water Tank, Hot/Cold Water at Sink, Outside Shower. (XLP ONLY)

LP Package

LP Stovetop & Furnace (STD 14XLP), Residential Countertop w/Sink (8.0, 8.1, 10.0)

Off-Road Package

15" all-terrain tires, extra clearance



Portions of this brochure were used with the expressed authority of Dexter Axle, but Dexter Axle is not responsible for the accuracy of the information contained herein.

Dealer: