

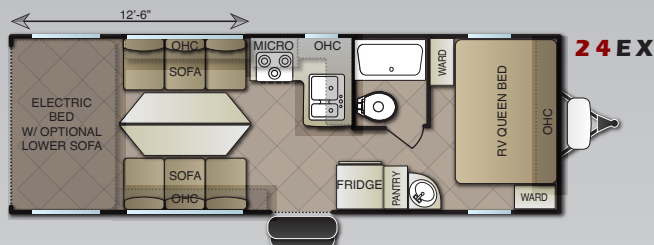

P R E M I U M   T O Y   H A U L E R S

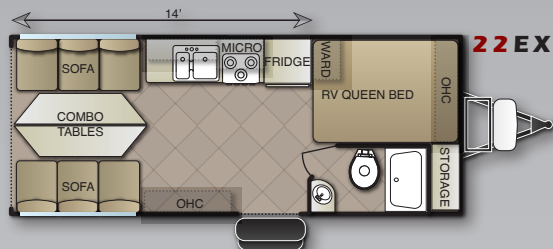

Pacific  
Coachworks®

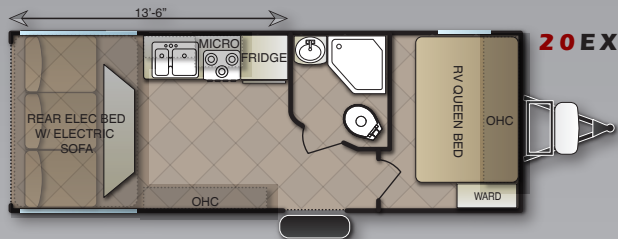

**INTERIOR FEATURES**

- A/C 13.5 BTU
- BLACKOUT WINDOW COVERS (CARGO AREA)
- FLUSH FLOOR TIE DOWNS
- LARGE DOUBLE DOOR FRIDGE
- OVEN W/ COOKTOP & RANGE HOOD
- LED LIGHTING
- MEDICINE CABINET
- METALL BALL BEARING DRAWER GUIDES
- PORCELAIN TOILET
- REAR ELEC BED (OPT ON 20EX)
- REAR ELEC SOFA (NA 22EX)
- ROLLER SHADE WINDOW COVERINGS
- SCREWED TOGETHER CABINET
- SKYLIGHT IN BATHROOM
- SOUND SYSTEM W/ AM/FM/CD/DVD/BT
- TUB SURROUND
- UPGRADED APPLIANCES
- UPGRADED FLOORING
- UPHOLSTERED WINDOW VALANCES

**EXTERIOR FEATURES**

- 20GAL FUEL STATION
- 102" WIDE BODY CONSTRUCTION
- 5,200LB AXLES
- AWNING - POWER W/ LED LIGHT STRIP
- ALUMINUM FRAMED FIBERGLASS SIDING
- BLACKED OUT WHEELS
- DSI WATER HEATER - 6GAL
- DUAL LPG TANKS W/ COVER
- FRESH WATER - 100GALS
- FRONT DIAMOND PLATE ROCKGUARD
- KEYLESS ENTRY DOOR
- LED RUNNING LIGHTS
- RADIUS INSULATED COMPARTMENT DOORS
- SANI FLUSH - BLACK TANK
- SOLAR READY
- SPARE TIRE W/ CARRIER
- STABILIZER JACKS (4)
- TOY LOCK SECURITY LOCK
- TV ANTENNA W/ CABLE
- UPGRADED 3M GRAPHICS
- WALK ON ROOF

**POPULAR OPTIONS**

- 160 WATT SOLAR W/ 300 WATT INVERTER
- ALUMINUM WHEELS
- BUNK LADDER
- CUSTOM CARPET KIT
- EXTERIOR FOLDING LADDER
- FLOOD LIGHT 12V DOOR SIDE
- GENERATOR 4.0 ONAN (24EX ONLY)
- HEATED TANKS - PADS
- MICROWAVE OVEN
- PATIO CABLES
- PORTABLE GENERATOR
- POWER HITCH
- PRESSURE SPRAYER
- REAR SCREEN WALL
- SINK COVER
- WALL MOUNTED TV

**SPECIFICATIONS**

MODEL	EXT LENGTH	EXT WIDTH	EXT HEIGHT	CARGO R/S	CARGO C/S	GVWR	AXLE WEIGHT	HITCH WEIGHT	UVW	PAY-LOAD	FRESH WATER	GREY WATER	BLACK WATER	FUEL
20EX	27'-2"	102"	11'-6"	6'-2"	13'	9,900lbs	4,775lbs	590lbs	5,365lbs	4,535lbs	106gal	40gal	40gal	20gal
22EX	25'-10"	102"	11'-6"	6'-2"	14'	9,900lbs	4,600lbs	636lbs	5,236lbs	4,664lbs	106gal	40gal	40gal	20gal
24EX	30'-10"	102"	11'-6"	12'-6"	17'	9,900lbs	5,435lbs	984lbs	6,419lbs	3,481lbs	106gal	40gal	40gal	20gal

NOTE: PCW reserves the right to change or discontinue at any time, without notice, prices, colors, materials, equipment, accessories, specifications, models, and packages, without incurring any obligations to make the same or similar changes to trailers. Unloaded vehicle weight (UVW) information is intended as a guide only and does not include water, fluids or popular options. Actual weight may vary. Payload capacity does not include the weight of water, fluids, or popular options. Weights and capacities are approximate and are subject to change without notice.



20EX IN RAVEN DECOR



24EX IN CARMEL DECOR





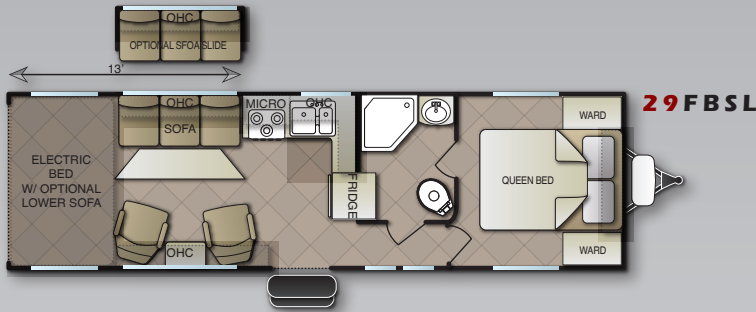
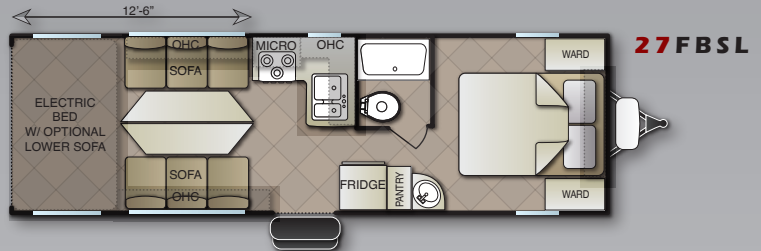
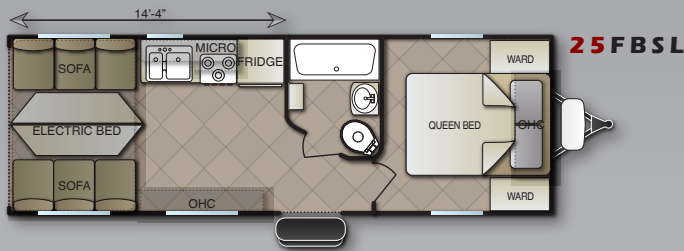

**INTERIOR FEATURES**

- A/C 13.5 BTU
- 2.500LBS CAPACITY TIE DOWNS
- BUNK LADDER
- COOK TOP W/ GLASS COVER
- CUSTOM CARPET KIT
- FRONT 60X80 PILLOW TOP QUEEN BED
- LARGE DOUBLE DOOR REFRIGERATOR
- LARGE OVEN
- LED LIGHTING W/ DIMMER
- METAL BALL BEARING DRAWER GUIDES
- MICROWAVE OVEN
- NEXT LEVEL FLOOR COVERING
- PORCELAIN TOILET
- REAR ELECTRIC BED
- ROLLER SHADE WINDOW COVERINGS
- SKYLIGHT IN BATHROOM
- SOLID SURFACE COUNTERTOPS
- STEREO/AMP/DVD/BT/SUB
- ABS TUB SURROUND

**EXTERIOR FEATURES**

- 20GAL FUEL TANK W/ PUMP STATION
- ALUMINUM FRAME FIBERGLAS SIDING
- AWNING - POWER W/ LED LIGHT STRIP
- BLACKED OUT WHEELS
- DSI WATER HEATER
- DUAL LPG TANKS W/ COVER
- EXTERIOR FOLDING LADDER
- FLOOD LIGHT
- FRONT DIAMOND PLATE
- GENERATOR 4.0 ONAN
- KEYLESS ENTRY
- LED LIGHTS
- SANI FLUSH - BLACK TANK
- SOLAR READY
- SPARE TIRE W/ CARRIER
- STABILIZER JACKS (4)
- TOY LOCK SECURITY SYSTEM
- TV ANTENNA W/ CABLE HOOK UP
- WALK ON ROOF

**POPULAR OPTIONS**

- 15,000 BTU AIR CONDITIONER
- 40GAL FUEL STATION (IPO 20GAL)
- 160W SOLAR PANEL W/ 300W INVERTER
- ALUMINUM WHEELS (IPO BLACK)
- FRONT FIBERGLASS CAP
- GLASS BATH ENCLOSURE
- HEATED TANKS - PADS
- LIVING ROOM SLIDE OUT (29&32)
- PATIO CABLES
- POWER STABILIZER JACKS
- POWER TONGUE JACK
- PRESSURE SPRAYER
- REAR "BIG AIR" LOUNGE
- REAR SCREEN WALL
- SINK COVER
- 32" TV LCD - CEILING MOUNT

\*Some Features, Packages and Options are not available on all models. Please consult your local sales representative for more information. NOTE: All Pacific Coachworks recreational vehicles are sealed with Sealtech.

**SPECIFICATIONS**

MODEL	EXT LENGTH	EXT WIDTH	EXT HEIGHT	CARGO R/S	CARGO C/S	GVWR	AXLE WEIGHT	HITCH WEIGHT	UVW	PAY-LOAD	FRESH WATER	GREY WATER	BLACK WATER	STD FUEL
25FBSL	29'-5"	102"	11'-6"	6'-1"	14'	9,900lbs	5,560lbs	1,012lbs	6,572lbs	3,328lbs	106gal	40gal	40gal	20gal
27FBSL	32'-7"	102"	11'-8"	13'	17'-2"	10,200lbs	6,180lbs	960lbs	7,140lbs	3,060lbs	106gal	40gal	40gal	20gal
29FBSL	34'-11"	102"	11'-8"	12'-8"	16'-10"	10,600lbs	6,360lbs	1,384lbs	7,744lbs	2,856lbs	106gal	40gal	40gal	20gal
32FBSL	37'-11"	102"	12'-3"	15'-8"	19'-10"	15,000lbs	TBD	TBD	TBD	TBD	106gal	40gal	40gal	20gal

NOTE: PCW reserves the right to change or discontinue at any time, without notice, prices, colors, materials, equipment, accessories, specifications, models, and packages, without incurring any obligations to make the same or similar changes to trailers. Unloaded vehicle weight (UVW) information is intended as a guide only and does not include water, fluids or popular options. Actual weight may vary. Payload capacity does not include the weight of water, fluids, or popular options. Weights and capacities are approximate and are subject to change without notice.



29FBSL IN CARMEL DECOR





# WIDE BODY SERIES

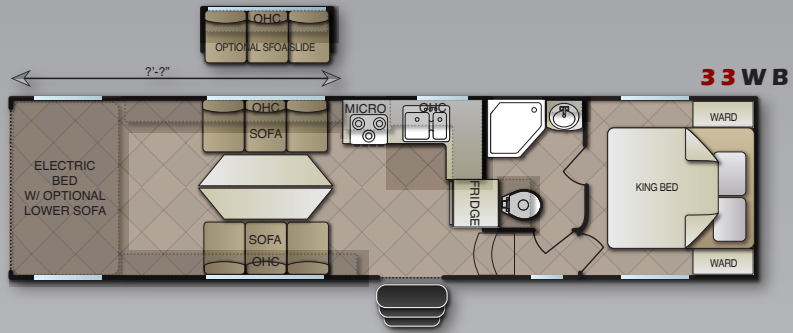

# NEXT LEVEL SERIES

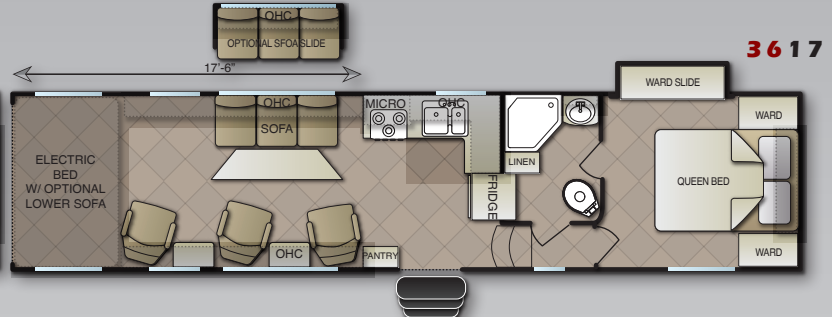
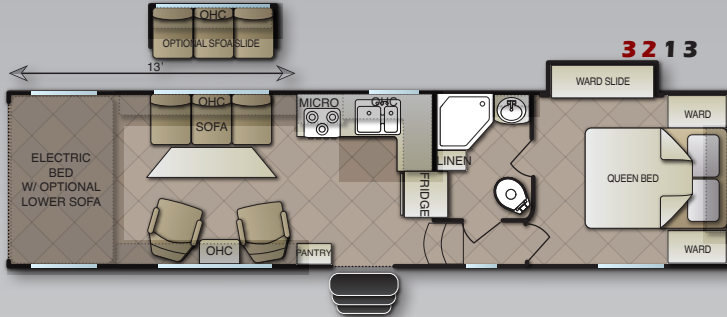

## INTERIOR FEATURES

- 13,500 BTU AIR CONDITIONER (WIDE BODY)
- 15,000 BTU AIR CONDITIONER (NEXT LEVEL)
- 30,000 BTU FURNACE (WIDE BODY)
- 40,000 BTU FURNACE (NEXT LEVEL)
- BUNK LADDER
- CUSTOM CARPET KIT
- DELUXE CEILING FAN (NEXT LEVEL)
- GLASS SHOWER ENCLOSURE
- HIGH RISE PULL OUT SPRAYER FAUCET
- KING SIZE PILLOW TOP BED (WIDE BODY)
- LARGE DOUBLE DOOR FRIDGE
- LED LIGHTING
- MICROWAVE OVEN
- PORCELAIN TOILET
- RANGE W/ FLUSH GLASS TOP (NEXT LEVEL)
- REAR ELECTRIC BED
- REAR "BIG AIR" LOUNGE
- ROLLER SHADE WINDOW COVERINGS
- SCREWED TOGETHER CABINETS
- SKYLIGHT IN BATHROOM
- PREMIUM SOUND SYSTEM
- SOLID SURFACE COUNTERTOP (NEXT LEVEL)
- TRUE QUEEN SIZE BED (NEXT LEVEL)
- UPGRADED NEXT LEVEL FLOORING

## EXTERIOR FEATURES

- 40GAL FUEL TANK W/ PUMP STATION
- 6,000LB AXLES
- 7,000LB AXLES (3213)
- TRIPLE AXLES (3617)
- 7' RADIUS RAMP DOOR (WIDE BODY)
- 8' RADIUS RAMP DOOR (NEXT LEVEL)
- ALUMINUM FRAME FIBERGLASS SIDING
- AWNING - POWER W/ LED LIGHT STRIP
- BEAVER TAIL REAR ENTRY (NEXT LEVEL)
- DSI WATER HEATER
- ENCLOSED TANKS
- EQUIFLEX SUSPENSION (NEXT LEVEL)
- EXTERIOR LADDER
- GENERATOR 4.0KW ONAN (WIDE BODY)
- GENERATOR 5.5KW ONAN (NEXT LEVEL)
- KEYLESS ENTRY
- POWER JACKS (FRONT)
- PRESSURE SPRAYER
- SANI FLUSH - BLACK TANK
- SLAM LATCH BAG DOORS (NEXT LEVEL)
- SOLAR READY
- SPARE TIRE W/ CARRIER
- TV ANTENNA W/ CABLE HOOK UP
- WALK ON ROOF

## POPULAR OPTIONS

- 15,000 BTU AIR CONDITIONER (STD ON NL)
- 160W SOLAR W/ 300W INVERTER
- A/C BEDROOM - 13,500 BTU
- LIVING ROOM SLIDE OUT
- PATIO CABLES
- RAMP PATIO FENCE
- REAR SCREEN WALL
- TV - BEDROOM 22"
- 32" TV LIVING ROOM

\*Some Features, Packages and Options are not available on all models. Please consult your local sales representative for more information. NOTE: All Pacific Coachworks recreational vehicles are sealed with Sealtech.

## SPECIFICATIONS

MODEL	EXT LENGTH	EXT WIDTH	EXT HEIGHT	CARGO R/S	CARGO C/S	GVWR	AXLE WEIGHT	HITCH WEIGHT	UVW	PAY-LOAD	FRESH WATER	GREY WATER	BLACK WATER	FUEL
29WB	34'-7"	102"	12'-9"	12'-4"	16'-4"	12,800lbs	7,155lbs	2,156lbs	9,311lbs	3,489lbs	120gal	50gal	50gal	40gal
33WB	38'-7"	102"	12'-9"	16'-4"	20'-4"	14,800lbs	TBD	TBD	TBD	TBD	120gal	50gal	50gal	40gal
3213	35'-9"	102"	13'	13'-6"	17'-6"	14,800lbs	6,695lbs	2,840lbs	9,535lbs	5,265lbs	170gal	50gal	50gal	40gal
3617	39'-9"	102"	13'	17'-6"	21'-6"	17,800lbs	9,830lbs	2,750lbs	12,580lbs	5,220lbs	170gal	50gal	50gal	40gal

NOTE: PCW reserves the right to change or discontinue at any time, without notice, prices, colors, materials, equipment, accessories, specifications, models, and packages, without incurring any obligations to make the same or similar changes to trailers. Unloaded vehicle weight (UVW) information is intended as a guide only and does not include water, fluids or popular options. Actual weight may vary. Payload capacity does not include the weight of water, fluids, or popular options. Weights and capacities are approximate and are subject to change without notice.



**INTERIOR FEATURES**

- 1 PIECE FIBERGLASS TUB SURROUND
- A/C 15K BTU - DUCTED
- BEAVER TAIL REAR ENTRY W/ STORAGE BIN
- BUNK LADDER
- CUSTOM CARPET KIT - CARGO AREA
- DIMMABLE LED LIGHTING
- DUBOUT CARPET PADDING - BEDROOM
- DUCTED FURNACE - 40,000 BTU
- GLASS FLUSH MOUNT COOK TOP
- GLASS SHOWER ENCLOSURE
- HIGH RISE PULL OUT GALLEY FAUCET
- LARGE DOUBLE DOOR REFRIGERATOR
- LARGE POTS AND PANS DRAWER IN GALLEY
- LINC PAD UNIVERSAL TECHNOLOGY
- MAX AIR VENT IN LIVING AREA
- MICROWAVE OVEN 30" RESIDENTIAL
- PORCELAIN TOILET
- REAR ELECTRIC BED W/ DINETTE
- ROLLER SHADE WINDOW COVERINGS
- SOLID SURFACE COUNTER TOPS
- PREMIUM SOUND SYSTEM
- TV LCD
- STAINLESS APPEARANCE APPLIANCES
- WASHER DRYER PREP

**EXTERIOR FEATURES**

- 20/40 GAL DUAL FUEL TANKS W/ PUMP
- 7,000LB TRIPLE AXLES
- 8' RAMP DOOR W/ GRAY FIBERGLASS
- ALUMINUM FRAME CONSTRUCTION
- AWNING - POWER W/ LED STRIP
- 16" ALUMINUM WHEELS
- DSI WATER HEATER - 10GAL
- ENCLOSED UNDERBELLY
- EQUA FLEX SUSPENSION
- EXTERIOR LADDER
- EXTERIOR UTILITY COMMAND CENTER
- GENERATOR 5.5KW W/ 50AMP SERVICE
- GROUND EFFECTS LIGHT PACKAGE
- KEYLESS ENTRY DOOR
- LIPPERT LEVEL UP SYSTEM
- PRESSURE WASHER
- ROTO FLEX FRONT HITCH
- SANI FLUSH - BLACK TANK
- SLAM LATCH COMPARTMENTS
- SOLAR READY
- SPARE TIRE
- TV ANTENNA W/ CABLE HOOK UP
- ULTRA HIGH GLOSS FIBERGLASS SIDING

**POPULAR OPTIONS**

- 160WATT SOLAR W/ 300WATT INVERTER
- 2ND LIFT BED AND DINETTE (3916 ONLY)
- A/C BEDROOM (13.5BTU)
- A/C CARGO AREA
- DIAMOND PLATE FLOOR - CARGO
- ELECTRIC REAR AWNING OVER RAMP
- FIREPLACE IN LIVING AREA
- PATIO SYSTEM
- REAR SCREEN WALL

\*Some Features, Packages and Options are not available on all models. Please consult your local sales representative for more information. NOTE: All Pacific Coachworks recreational vehicles are sealed with Sealtech.

**SPECIFICATIONS**

MODEL	EXT LENGTH	EXT WIDTH	EXT HEIGHT	CARGO R/S	CARGO C/S	GVWR	AXLE WEIGHT	HITCH WEIGHT	UVW	PAY-LOAD	FRESH WATER	GREY WATER	BLACK WATER	FUEL
3713	44'-3"	102"	13'-2"	13'	13'	20,800lbs	10,755lbs	3,906lbs	14,661lbs	6,139lbs	170gal	50gal	90gal	40gal
3813	44'-9"	102"	13'-2"	13'	13'	20,800lbs	11,410lbs	3,510lbs	14,920lbs	5,880lbs	170gal	100gal	90gal	40gal
3916	44'-9"	102"	13'-2"	16'	16'	20,800lbs	10,820lbs	3,160lbs	13,980lbs	6,820lbs	170gal	100gal	90gal	40gal

NOTE: PCW reserves the right to change or discontinue at any time, without notice, prices, colors, materials, equipment, accessories, specifications, models, and packages, without incurring any obligations to make the same or similar changes to trailers. Unloaded vehicle weight (UVW) information is intended as a guide only and does not include water, fluids or popular options. Actual weight may vary. Payload capacity does not include the weight of water, fluids, or popular options. Weights and capacities are approximate and are subject to change without notice.

## STANDARD FEATURES



OH CABINETS IN BEDROOM



ALL MODELS FIT 4 SEAT 1000 XP RZR



PULL DOWN ROLLER SHADES



ALL LED LIGHTS

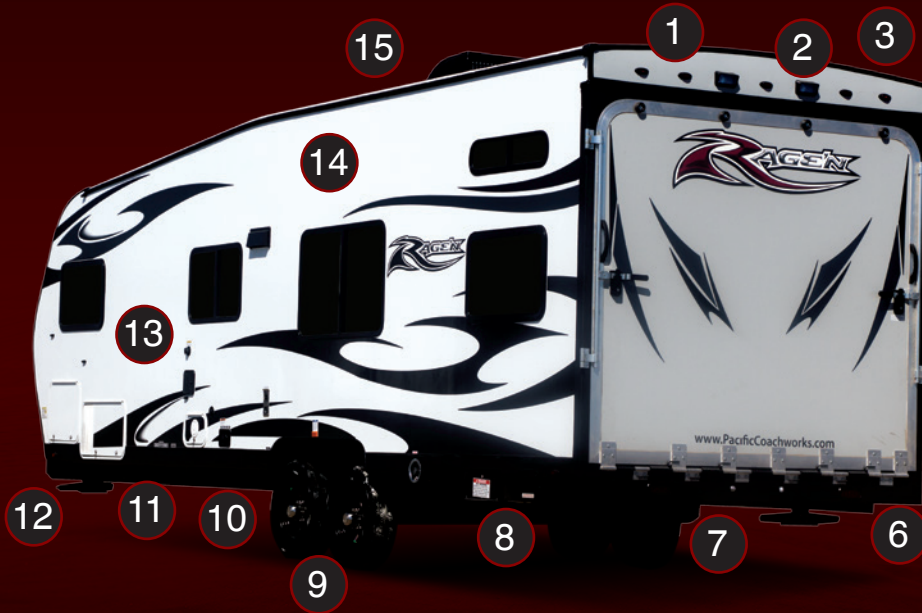

1. LED RUNNING LIGHTS
2. LED REAR RAMP LIGHTS
3. MAINTENANCE FREE ROOF W/ 10 YEAR 100% WARRANTY
4. RADIUS RAMP DOOR W/ 3,000LB CAPACITY
5. SELF LOCKING RAMP LATCHES
6. POWDER COATED I-BEAM CHASSIS
7. STANDARD SPARE TIRE W/ CARRIER
8. STANDARD FUEL STATION
9. 2 YEAR ROAD SIDE ASSISTANCE, TIRES AND WHEELS
10. STANDARD 106GAL FRESH (TT'S)
11. Z-STYLE OUTRIGGERS
12. STANDARD 4 CORNER STABILIZER JACKS
13. STANDARD BLACK TANK FLUSH
14. STANDARD ALUMINUM FRAMED FIBERGLASS SIDING
15. SOLAR READY



CARMEL DECOR

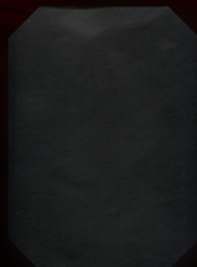

RAVEN DECOR

**Pacific Coachworks** is committed to providing the highest quality travel trailers, fifth wheels, and toy haulers at an unsurpassed value. We are dedicated to establishing lasting partnerships with trusted RV dealers, vendors, and suppliers, all of which are equally committed to conducting business with your best interests in mind. Our team is focused on exceeding customer expectations by providing the highest level of customer support and service.

**Pacific Coachworks**  
 3411 N. Perris Blvd  
 Perris, CA 92571  
 (951) 686-7294  
[www.pacificcoachworks.com](http://www.pacificcoachworks.com)

Find us on...     
 Contact Your Local Dealer



All information included in this brochure is the latest at the time of publication. Pacific Coachworks reserves the right to make changes and to discontinue models without notice or obligation. Photos in this brochure may show optional equipment or props used for photography purposes only. All recreational vehicles built by Pacific Coachworks, Inc. include a one year factory warranty.