



WESTERN EDITION



**THE FIRST NAME IN CAMPING.
THE TRUSTED NAME IN RVs.**





The Outdoor Company®



THE FIRST NAME IN **CAMPING**

For more than 100 years, millions of people have trusted the Coleman name to help them thrive in the great outdoors. These all-new Coleman RVs deliver on that same reputation, packing more camping conveniences into one value-packed product! With multiple floorplans to choose from and a number of residential-style features throughout, the campground awaits you and your Coleman RV.



GREAT INDOORS

With an expansive interior height of 82 inches, Coleman RVs offer taller sliderooms, roomier cabinets and larger windows for an even better camping experience. Combine that with hardwood cabinet doors, a 60-gal. fresh water capacity and a 6-gal. gas DSI water heater, and you're certain to feel at home wherever your travels take you.



SWEET DREAMS

The comfortable master bedroom features handy nightstands, mirrored cabinets, a bonus storage shelf and a queen-sized mattress.



ROOM TO RELAX

Coleman's oversized slideout creates a roomy living area with plenty of seating and sleeping space for family and guests.

NORTH AMERICA'S
TRUSTED
 NAME IN RVs



LED AWNING AND OUTDOOR SPEAKERS
 Enjoy more outside your RV with the LED power awning and outdoor speakers.



INTERIOR POWER COMMAND CENTER
 Control your lights, sliderooms, power awning and more all from one smart location.

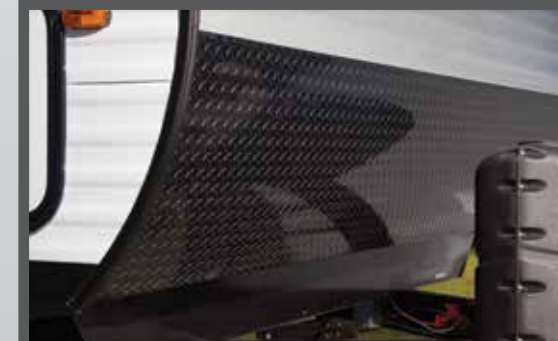

BLACK DIAMOND PLATE ROCK GUARD
 The black diamond-plate rock guard protects your RV from the rigors of the road.

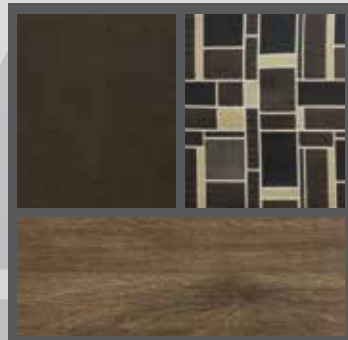

MACKINAC DECOR

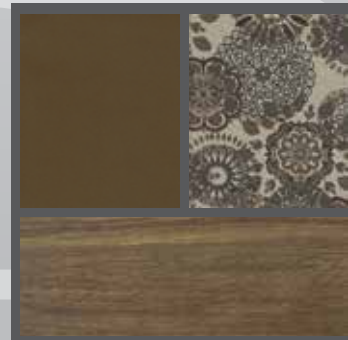

SHORELINE DECOR



OUTDOOR KITCHEN
 Select models feature an exterior kitchen, perfect for Coleman outdoor enthusiasts.



Lantern LT 17FQ



LANTERN LT

Whether you're a couple wanting to enjoy the great outdoors or a young family looking to create your own camping traditions, Lantern LT is a series that will appeal to you. With the wide array of features and upgraded interior amenities, you are sure to see why Coleman is one of the fastest-growing brands in the market.



LANTERN

Coleman's Lantern Series features spacious floorplans and one of the longest lists of amenities in its class. Combining old-world craftsmanship with over-the-top conveniences, like a power awning with LED lights, standard front and rear jacks and a solid-state converter with built-in battery charger, your family will love everything the Coleman Lantern offers to help you get away from it all.





The Outdoor Company®



THE FIRST NAME IN **CAMPING**

Every day is an adventure with Coleman, especially when you ramp up the fun with an outing in the Lantern SUT. Part toy hauler, part travel trailer, this model packs garage space for the toys, a HappiJac power bed for the guests and a private bedroom for the two leaders in the pack. Plus, the flush-floor cargo area doesn't sacrifice space to bulky wheel wells. Coleman, we believe in practical design.



FLEXIBLE INDOORS

With an interior height of 82 inches, 2,500-lb rated tie-downs, flat floor cargo area, and a Happi-Jac power bed, the Coleman Lantern SUT models give you the flexibility you need for your active lifestyle.



BUNKS UP

Take your gear and your toys with you.



BUNKS DOWN

Convert the cargo area into a plush bedroom.

THE FIRST NAME IN CAMPING. THE TRUSTED NAME IN RVs.

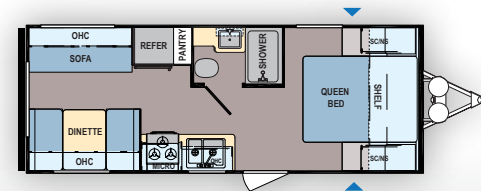

Lantern | 202RDWE
Ext. Length: **24' 11"** Ext. Height: **10' 10"**
Average Shipping Weight: **4,242** Sleeps **4-6**

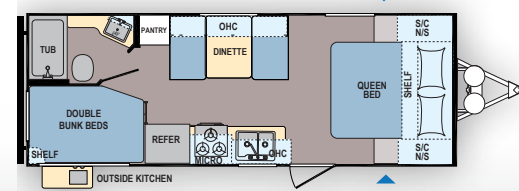

Lantern | 215BHWE
Ext. Length: **25' 11"** Ext. Height: **TBD**
Average Shipping Weight: **TBD** Sleeps **5-7**

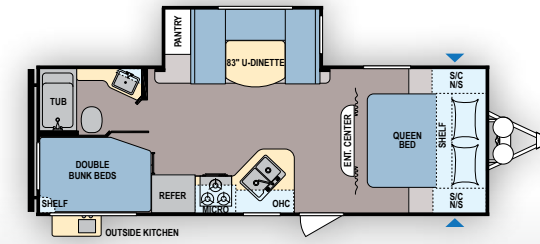

Lantern | 244BHWE
Ext. Length: **27' 7"** Ext. Height: **11' 4"**
Average Shipping Weight: **5,500** Sleeps **6-8**

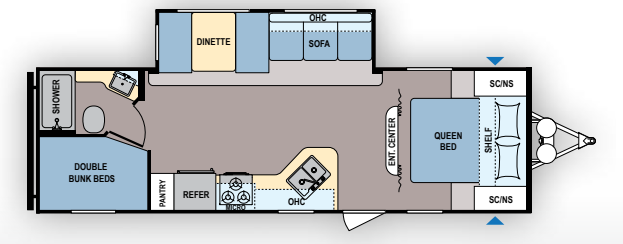

Lantern | 262BHWE
Ext. Length: **30' 7"** Ext. Height: **11' 4"**
Average Shipping Weight: **5,880** Sleeps **8-10**

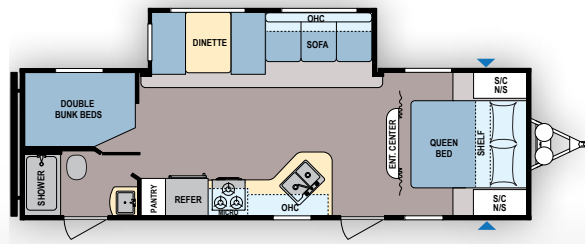

Lantern | 263BHWE
Ext. Length: **30' 7"** Ext. Height: **11' 4"**
Average Shipping Weight: **5,880** Sleeps **8**

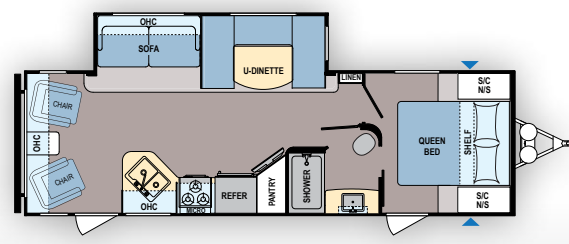

Lantern | 270RLWE
Ext. Length: **30' 8"** Ext. Height: **11' 2"**
Average Shipping Weight: **6,008** Sleeps **4-5**

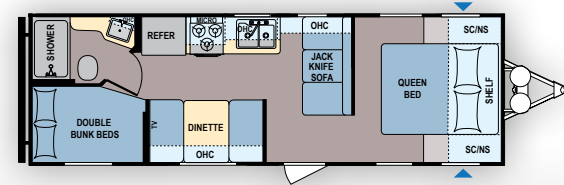

Lantern | 274BHWE
Ext. Length: **28' 7"** Ext. Height: **10' 4"**
Average Shipping Weight: **4,670** Sleeps **7-8**

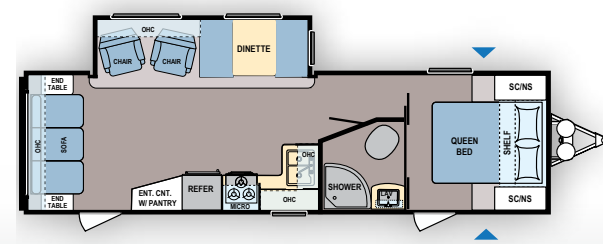

Lantern | 280RLWE
Ext. Length: **32' 6"** Ext. Height: **11' 3"**
Average Shipping Weight: **6,090** Sleeps **4-6**

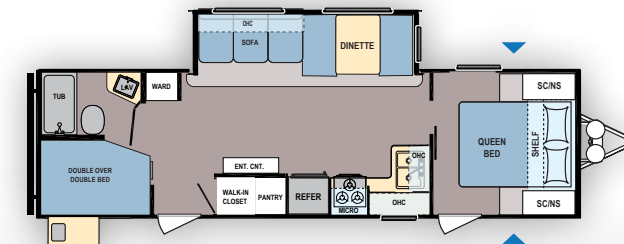

Lantern | 285BHWE
Ext. Length: **32' 9"** Ext. Height: **11' 3"**
Average Shipping Weight: **6,443** Sleeps **8-10**

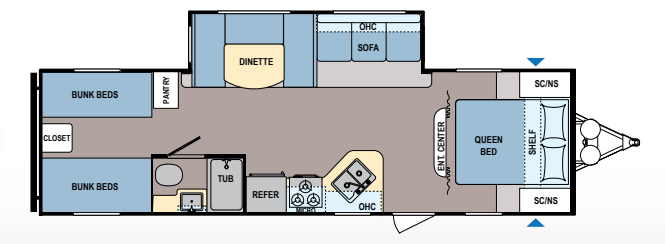

Lantern | 295QBWE
Ext. Length: **32' 8"** Ext. Height: **11' 3"**
Average Shipping Weight: **6,283** Sleeps **8-9**

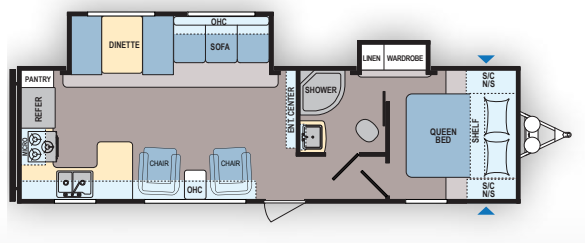

Lantern | 296RKWE
Ext. Length: **32' 11"** Ext. Height: **11' 6"**
Average Shipping Weight: **6,801** Sleeps **6**

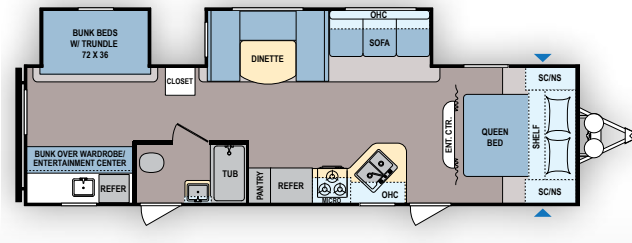

Lantern | 314BH
Ext. Length: **34' 9"** Ext. Height: **11' 6"**
Average Shipping Weight: **7,400** Sleeps **7-10**
Eastern Region production**

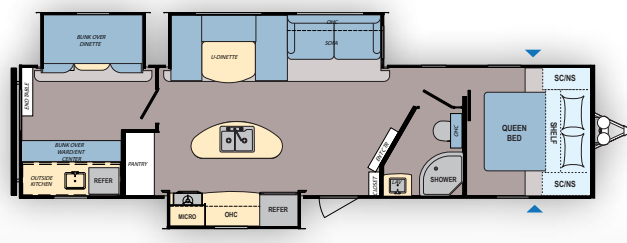

Lantern | 337BH
Ext. Length: **37' 11"** Ext. Height: **11' 3"**
Average Shipping Weight: **8,437** Sleeps **7-10**
Eastern Region production**

COLEMAN LANTERN SUT MODELS

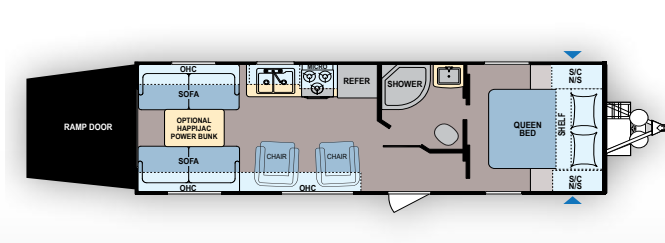

Lantern SUT | 250TQ
Ext. Length: **29' 7"** Ext. Height: **11' 4"**
Average Shipping Weight: **5,514** Sleeps **6**
Eastern Region production**

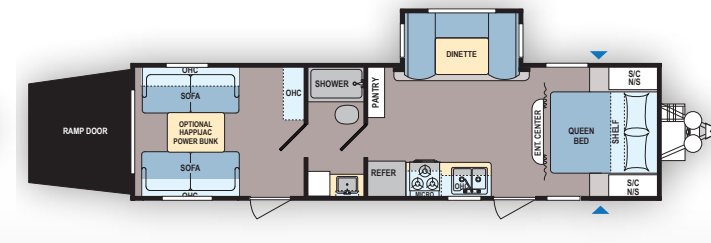

Lantern SUT | 300TQ
Ext. Length: **34' 10"** Ext. Height: **12' 4"**
Average Shipping Weight: **6,838** Sleeps **8**
Eastern Region production**

**Eastern Region: Model produced in Indiana

COLEMAN LANTERN LT MODELS

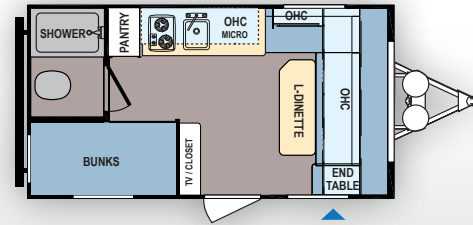

Lantern LT | 14BHWE

Ext. Length: **18' 9"** Ext. Height: **9' 0"**
Average Shipping Weight: **2,782** Sleeps **3-4**

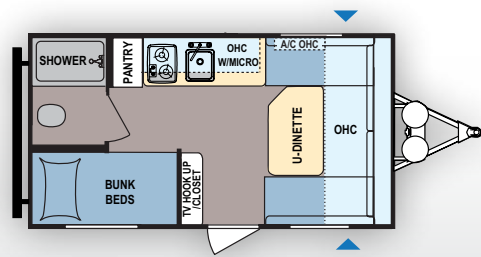

Lantern LT | 15BHWE

Ext. Length: **18' 9"** Ext. Height: **8' 8"**
Average Shipping Weight: **2,878** Sleeps **3-4**

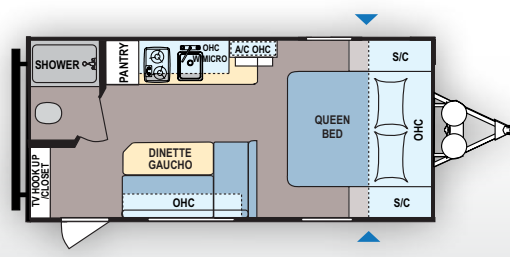

Lantern LT | 16FBWE

Ext. Length: **21' 5"** Ext. Height: **8' 8"**
Average Shipping Weight: **3,168** Sleeps **2-3**

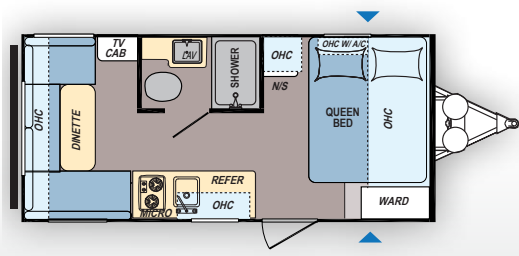

Lantern LT | 17RDWE

Ext. Length: **21' 2"** Ext. Height: **8' 10"**
Average Shipping Weight: **3,169** Sleeps **2-4**

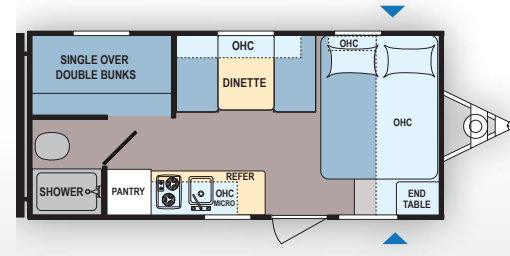

Lantern | 17FQWE

Ext. Length: **21' 5"** Ext. Height: **8' 8"**
Average Shipping Weight: **3,270** Sleeps **6**

COLEMAN LANTERN LT MODELS

- Awning
- Diamond plate
- Tinted safety-glass windows
- 28" entrance door
- Entry handle
- Single-entry step
- Porch light
- Rear stabilizer jacks
- E-Z Lube axles
- Radial tires with steel spoke rims
- Spare tire
- 20-lb. propane bottle
- 30-amp power cord
- Exterior outlet
- Solid-state converter with built-in battery charger
- 6-gal. gas water heater
- Water heater bypass kit
- 18,000-BTU furnace
- Acrylic kitchen sink with faucet
- 3.3 cu. ft. refrigerator
- 2-burner cooktop
- Range hood with 12V light and exhaust fan
- Microwave
- Full-extension drawer guides throughout
- Mini blinds throughout
- Residential-grade vinyl flooring

COLEMAN LANTERN SUT MODELS

- Stereo AM/FM/MP3/SC/AUX
- Interior speakers
- Bath/galley fan
- Shower curtain
- Foot pedal flush toilet
- OPTIONAL EQUIPMENT**
- 8,000-BTU air conditioner (mandatory)
- CSA upfit and seal

COLEMAN LANTERN MODELS

- Awning
- Diamond plate
- Tinted safety-glass windows
- 28" entrance door(s)
- Entry handle(s)
- Folding entry steps (double or triple on select models)
- Smooth-finish entry and baggage doors
- Large storage compartment
- Exterior TV connection on entry-door side
- Backers for rear ladder
- Front and rear jacks
- E-Z Lube axles
- Radial tires with nitro fill and silver spoke rims
- Dual 20-lb. propane bottles with ABS cover
- 30-amp power cord
- 120V exterior outlet

- Solid-state converter with built-in battery charger
- 13,500-BTU A/C
- 6-gal. gas DSI water heater with bypass kit
- Residential galley sink with high-rise faucet
- 6 cu. ft. double-door refrigerator
- 3-burner cooktop
- Range hood with 12V light and exhaust fan
- Microwave
- Interior power command center
- Full-extension drawer guides throughout
- Mini blinds throughout
- Residential-grade vinyl flooring
- Dinette storage compartment with side access (select models)
- Under-bed storage
- Upgraded Rest Easy mattress
- Bedroom TV hookup
- Backers for bedroom TV mount
- Luxury furniture
- 2 swivel rockers (select models)
- Cable/satellite TV hookup
- Stereo AM/FM/CD/AUX/Bluetooth
- Glass shower door (select models)
- Shower curtain rod (select models)
- Power bath fan
- Foot pedal flush toilet
- Medicine cabinet with mirror

COLEMAN LANTERN SUT MODELS

- 1,600-lb. rated rear ramp door
- 2,500-lb. rates recessed D-Rings
- Maximized storage flat floors
- Opposing rear fold-away sofas
- OPTIONAL EQUIPMENT (WESTERN REGION)**
- Yukon Package (mandatory)
- Spare tire and carrier
- 50 Amp Power with 2nd A/C prep (select models)
- 15,000-BTU A/C in place of 13,500 (select models)
- Happi-Jac power bed (250TQ, 300TQ only) (mandatory)
- Outside shower*
- Fully enclosed underbelly*
- CSA upfit and seal
- YUKON PACKAGE (Mandatory)**
- Power awning with LED patio light
- Exterior speakers
- Enclosed and insulated fresh water tank
- Oven with 3-burner range

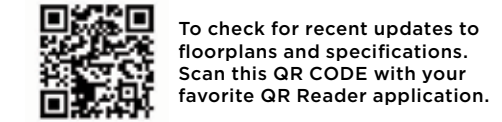

* 'WE' models only

SPECIFICATIONS

FLOORPLAN	14BHWE	15BHWE	16FBWE	17RDWE	17FQWE	202RDWE	215BHWE	244BHWE	262BHWE	263BHWE	270RLWE	274BHWE	280RLWE	285BHWE	295QBWE	296RKWE	314BH	337BH	250TQ	300TQ
*AVG SHIPPING WEIGHT (LBS)	2,782	2,878	3,168	3,270	3,270	4,242	TBD	5,500	5,880	5,880	6,008	4,670	6,090	6,443	6,283	6,801	7,400	8,437	5,514	6,838
CARGO CAPACITY (LBS)	1,068	972	682	678	580	3,358	TBD	2,100	1,720	1,720	1,592	2,930	3,590	3,237	3,397	2,879	2,280	2,739	4,166	2,842
DRY HITCH WEIGHT (LBS)	362	407	419	450	380	477	TBD	676	785	820	719	607	806	619	821	837	773	1,085	826	1,031
EXTERIOR HEIGHT (WITH A/C)	9'	8' 8"	8' 11"	8' 10"	8' 8"	10' 10"	TBD	11' 4"	11' 4"	11' 4"	11' 2"	10' 4"	11' 3"	11' 3"	11' 3"	11' 6"	11' 6"	11' 3"	11' 4"	12' 4"
**EXTERIOR TRAVEL LENGTH	18' 9"	18' 9"	21' 5"	21' 2"	21' 5"	24' 11"	25' 11"	27' 7"	30' 7"	30' 7"	30' 8"	28' 7"	32' 6"	32' 9"	32' 8"	32' 11"	34' 9"	37' 11"	29' 7"	34' 10"
EXTERIOR WIDTH	8'	8'	8'	8'	8'	8'	8'	8'	8'	8'	8'	8'	8'	8'	8'	8'	8'	8'	8'	8'
***FRESH WATER CAPACITY	27	27	27	27	27	60	60	60	60	60	60	60	60	60	60	60	60	60	60	60
BLACK WATER CAPACITY	28	28	28	28	28	42	42	42	42	42	42	42	42	42	42	42	42	42	42	42
GREY WATER CAPACITY	28	28	28	28	28	42	42	42	42	42	42	42	42	42	42	84	42	84	42	42
FURNACE BTU OUTPUT	19,000	19,000	19,000	19,000	19,000	25,000	25,000	25,000	30,000	25,000	30,000	25,000	30,000	25,000	25,000	30,000	30,000	25,000	20,000	30,000

*Our weights represent how most units are built, inclusive of many commonly-ordered options. **Length is defined as the distance from the centerline of hitch pin/coupler to rear bumper of trailer. ***Fresh water capacity includes water heater capacity.

NORTH AMERICA'S TRUSTED NAME IN RVs



Since 1900, the Coleman® Company, Inc. has led the world in the manufacture of camping gear and outdoor equipment. From the renowned Coleman lantern to stoves, tents, sleeping bags and coolers, Coleman's reputation for high-quality camping products is legendary.

Coleman's floorplans are not only loaded with added value and innovative features, they're designed to help your family get the most out of every camping experience.

After all, Coleman is Camping!

Whether your outdoor activities involve hiking, camping, fishing, hunting, boating, swimming, tailgating or simply relaxing, Coleman offers everything you need to satisfy your family's dreams.

We invite you to visit your nearest Coleman RV dealer today, and find out for yourself why Coleman is the most respected name in outdoor recreation.



Manufactured under license by:
Dutchmen Manufacturing, Inc.
PO Box 2000 • 2164 Caragana Court
Goshen, Indiana 46527
(574) 537-0600
www.dutchmen.com

YOUR LOCAL DEALER

Disclaimer: Product information is as accurate as possible as of the date of publication of this brochure. Features, floorplans and specifications are subject to change without notice. Please consult our website for more current product information and specifications. Coleman®, Dutchmen® and  are trademarks of The Coleman® Company, Inc., and are used under license.