

# INNSBRUCK

By Gulf Stream Coach

Where Experience and Innovation Come Together



*Our 323TBR with two entry doors and an optional outside kitchen*

*Young campers love our comfy, roomy bunks, like these Double-Double Bunks in the Model 2881SL.*



*Like all Innsbruck floor plans, the 323TBR offers comfortable furnishings, generous storage spaces, a fully-equipped kitchen, and state-of-the-art entertainment technology.*



*Sunroom option with freestanding table and four chairs - available on all Super Slide floor plans (295SBW shown).*



# WHEN IT COMES TO SOLID CONSTRUCTION, NO ONE PUTS IT TOGETHER LIKE WE DO

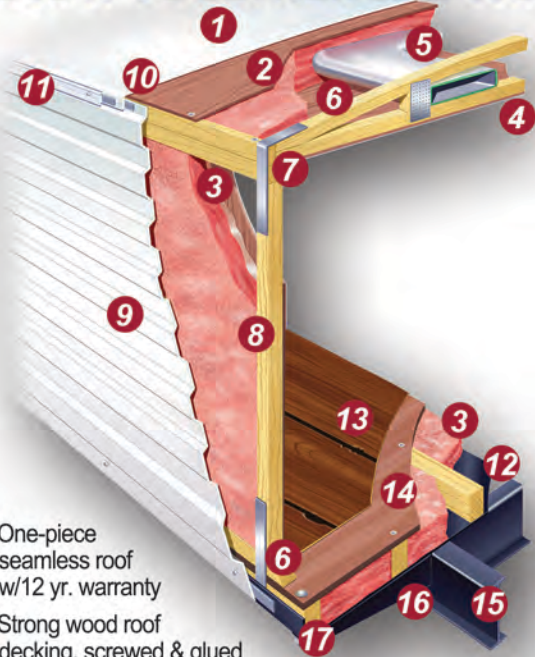

1. One-piece seamless roof w/12 yr. warranty
2. Strong wood roof decking, screwed & glued
3. Thick energy-saving blankets of hand-cut fiberglass insulation in ceiling, walls & floors; insulation bonded to walls to prevent settling
4. Reinforced truss-style roof construction
5. Insulated air conditioning ducts in insulated ceiling space
6. Interior ceiling board
7. Galvanized steel straps to increase roof-to-sidewall & side-wall-to-floor strength
8. Sturdy wood sidewall 16" on center, set on floor & screwed in for maximum strength
9. Aluminum siding w/baked enamel finish
10. Butyl caulk for better seal, fewer streaks
11. Drip rail to direct rain runoff away from unit
12. Tough polymax underbelly overlaps sides & ends to protect against moisture & debris
13. Durable heavy-gauge vinyl floor covering
14. 5/8" floor decking screwed & glued to floor joists, 13" on center
15. Powder-Coated I-Beam Steel Frame
16. Full-width steel outriggers for superior strength and support
17. Heavy gauge radius lower metal

# INNSBRUCK TRAVEL TRAILERS

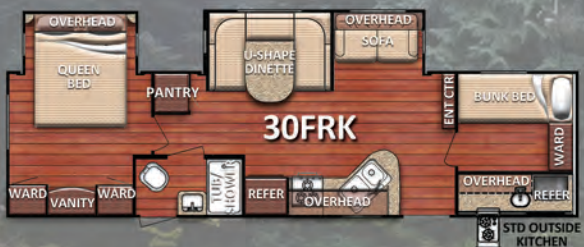

295SBW showing Sunroom option, Sofa, Entertainment Center with 50" HDTV and Fireplace options, His & Hers Swivel Rockers, and Kitchen Counter with extension.

## GET A PRICE QUOTE

Want a free, no-obligation price quote on your favorite Innsbruck floor plan? See our "Get A Price Quote" button online at [www.gulfstreamcoach.com](http://www.gulfstreamcoach.com).

# LODGE SERIES



# SE SERIES

SE Series Travel Trailers represent our most economical offerings. Specifications, features, and decor are subject to change. Check the SE Series Features List at [www.gulfstreamcoach.com](http://www.gulfstreamcoach.com), or ask your Dealer for more information.



# SPECIFICATIONS

Specifications are approximate and subject to change. Check the sticker on your unit for actual weights.

	Length	Width	Height w/AC	Furnace BTUs	Carrying Capacity	Hitch Weight	Dry Weight	Fresh Wtr. (gal)	Grey Tank (gal)	Black Tank (gal)
<b>TRAVEL TRAILERS</b>										
262RLS	31'3"	8'	10'9"	25K	2,050	870	6,690	51	37	37
276BHS	31'2"	8'	10'9"	25K	1,500	960	6,600	51	74	37
277DDS	31'2"	8'	10'9"	25K	1,520	958	6,620	51	74	37
278DDS	31'10"	8'	10'9"	25K	1,820	790	6,580	51	74	37
288ISL	33'2"	8'	10'9"	30K	2,430	910	7,060	51	74	37
295SBW	34'9"	8'	10'9"	30K	2,290	1,010	6,890	51	74	37
301TB	33'7"	8'	10'9"	30K	2,710	900	6,880	51	37	37
30FRK	35'8"	8'	10'9"	30K	3,390	1,120	7,836	51	37	37
323TBR	35'8"	8'	10'9"	30K	3,373	1,040	7,767	51	37	37
<b>LODGE SERIES</b>										
34FLS	38'8"	8'	10'9"	35K	3,314	1,340	8,066	N/A	37	37
406FLR	40'11"	8'	11'11"	35K	2,790	1,570	10,517	N/A	74	37
40DEN	40'10"	8'	11'11"	35K	1,610	1,420	9,670	N/A	74	37
408TBS	40'10"	8'	11'11"	35K	2,790	1,360	9,570	N/A	74	37
<b>SE SERIES</b>										
20QBG	24'11"	8'	10'9"	25K	3,040	640	4,600	51	37	37
275FBG	29'10"	8'	10'9"	25K	2,676	390	5,014	51	37	37
269BHG	30'8"	8'	10'9"	30K	1,710	820	6,110	51	37	37
36FRSG	38'8"	8'	10'9"	35K	3,314	1,340	8,066	N/A	37	37

Innsbruck Kitchens feature complete appliance packages, 60/40 Sinks, and extraordinary handcrafted Cabinets and Drawers for storage. Shown here, the stunning Rear Kitchen of the 295SBW.



# DECOR

Stylish, durable, Designer-approved choices



# INNSBRUCK

Where Experience and Innovation Come Together  
to Give You Unmatched Quality and Value

## STANDARD FEATURES

### Furnishings & Decor

- Solid Wood Cabinet Doors & Drawers
- Privacy Bedroom Doors
- Hi-Performance Wood Grain Vinyl Flooring
- Scald and Stain-Resistant Laminated Countertops
- Flip-Up Queen Bed w/Bedspread
- Wall Mirror (Some models)

### Heating, Cooling & Plumbing

- (2) 30 lb. LP Bottles w/Auto Change & EZ Access Cover (20 lb. in SE Models)
- Ducted 13,500 BTU Roof Air Conditioner (Optional in SE Models)
- 25,000 or 30,000 BTU Gas Furnace w/Insulated In-Floor Heat Ducts
- 6 Gal Quick Reovery Gas DSI Water Heater
- Monitor Panel for Tank Levels
- Water Tank and Pump (N/A in Lodge Series)
- Water Heater By-Pass Valve

### Electrical & Safety

- Cable TV Hook-Up
- 30 Amp Service w/45 Amp Converter w/Charger
- TV Antenna w/Signal Booster
- 12V Antenna Ready Jack
- Wall Mounted Light Switches
- Wall Mounted Fire Extinguisher
- Smoke Detector, Combo CO/LP Detector
- Lights for Patio, LP Tanks, and Hitch
- Safety Chains

### Kitchen & Bath

- 3-Burner Range w/Superburner & Oven (Opt. on SE)
- Power Range Hood w/Light
- 6.0 Cu. Ft. Double Door Refrigerator (Opt. on SE)
- Carousel Microwave Oven
- Full Extension Roller Bearing Drawer Guides
- 60/40 Kitchen Sink
- Wood Medicine Cabinet
- Shower Skylight and Shower Curtain
- Power Bath Vent
- Foot Flush Toilet
- Glass Door for Neo-Angle/Corner Showers

### Windows & Doors

- Radius Safety Glass Windows
- Mini-Blinds throughout (N/A in bunks)
- Window Treatments
- Radius Entry Door(s) w/Window & Deadbolt Lock

## STANDARD FEATURES (continued)

### Exterior

- Color-Coordinated Pull-Down Awning
- Radial Tires (Optional on SE Models)
- Lighted Pass-Thru Storage Area
- EZ-Fold Double or Triple Steps
- Radius Skirt Metal & Matching Fender Skirts (N/A in SE Models)
- Diamond Plate Lower Front (Opt. on SE Models)

### Key Construction Details

- One-Piece Seamless Roof w/12 year Warranty
- 2" x 4<sup>1/2</sup>" Truss-Style Crowned Roof System
- Sidewalls, Ceiling and Floor screwed, glued & tied together with steel straps for unmatched Uni-Body strength & resilience
- 2" x 6" Laminated Slide Room Header reinforced with solid 1/4" x 4" steel plate.
- 5/8" Floor Decking screwed and glued in place
- Hand-cut and glued fiberglass insulation
- Powder-coated Steel I-Beam Frame w/welded Outriggers

## LODGE SERIES

### Additional Standard Features

- Sliding Patio Door
- 10 Gal Gas DSI/110V Water Heater
- Residential Range
- Residential Refrigerator
- 6' 5" Slide Room Height
- Detachable Hitch
- Fiberglass Front
- 50 Amp Service w/65 Amp Converter w/Charger
- 35,000 BTU Furnace

## LODGE PACKAGE

### Available on Lodge Series only

- Pot & Pan Drawer (N/A 406FLR; 40DEN)
- Tub Surround
- Swing Away Grab Handle
- Outside Speakers
- Outside Shower
- Pull-Out Kitchen Faucet
- 2" Wood Blinds
- Residential Valances
- LED Interior Lights
- 15,000 BTU Air Conditioner
- Ceiling Fan (N/A 34FLS)

## SUPREME VALUE PACKAGE

### Available on Travel Trailers only

- Electric Awning
- CD/DVD Blue Tooth Stereo with (4) Interior and (2) Exterior Speakers
- Electric Hitch Jack
- LED Exterior Awning Lights
- LED Interior Lights
- Stainless Steel Appliance Package
- (4) Stabilizer Jacks
- Pleated Shades
- 6 Gal Gas/Electric 110V DSI Water Heater
- Intelli-View Monitor Panel
- Tub Surround
- Outside Shower
- Sofa Pillows
- Pot & Pan Drawer
- Swing-Away Grab Handle

## OTHER POPULAR OPTIONS

- 15,000 BTU Air Conditioner in place of 13,500 BTU
- 2nd 15,000 BTU Air Conditioner
- (2) Recliners in place of Barrel Chairs (N/A 262RLS)
- Tri-Fold Hide-A-Bed
- Stove Cover; Sink Cover
- Sun Room w/Dinette Table & 4 Chairs
- Swing Arm Bracket for TV
- 50" HDTV with Bracket (some Models)
- Fireplace with Brick Surround (N/A 262RLS, 30FRK)
- Electric Stabilizer Jacks
- 2nd Swing-Away Grab Handle
- Rear Ladder
- Fiberglass Exterior Walls
- Fully Enclosed Underbelly
- Aluminum Wheels
- Spare Tire
- 50 Amp Service w/Prep for 2nd AC (288ISL & above)
- Kids Kube (323TBR or 408TBS)
- Others - Ask your Dealer

See our newest pictures, floor  
plans, styles, and features at  
[www.gulfstreamcoach.com](http://www.gulfstreamcoach.com)



Pamper yourself with a comfy mattress, two windows, mirrored closet, wardrobe, overhead cabinets, AC outlets and a large night stand.



Join the fun outdoors with an optional Outside Kitchen, available on several models.

## Your New Innsbruck is backed by a 24 Month Warranty

In addition to a standard one-year warranty, Gulf Stream Coach, Inc. offers an exclusive 24 month warranty on structural components.\* In addition, major component manufacturers are providing 24 month warranties on their products installed in Gulf Stream units such as the refrigerator, antenna, furnace, water heater, air conditioner, awning, range, microwave and more.

See the written Gulf Stream Coach, Warranty for details.

\*For purposes of this warranty, 'Structural Components' shall be limited to the structure of the side walls, front & back walls, roof & floor.



Your Gulf Stream Coach Dealer:

