

# SIDEWINDER<sup>®</sup>

Fifth Wheel Toy Haulers





*3610DK | sandstorm décor*

The 3610DK boasts a sizable entertainment center with storage cabinets and a swing-arm TV offering better viewing angles. It includes a stainless steel appliance package, with a stainless-clad refrigerator, and a generous pantry in the kitchen, pots and pans drawer under the refrigerator, and plantation wood blinds.



All drawers boast 100-pound full-extension drawer glides.



3610DK loft with ladder for additional sleeping.



The 3610DK's oversized wraparound U-dinette table drops down to make a comfy sleeping surface.



The residential-grade sofa converts into a bed, and tinted windows slide open for excellent cross-ventilation.



Optional patio deck system and optional 3-season door.

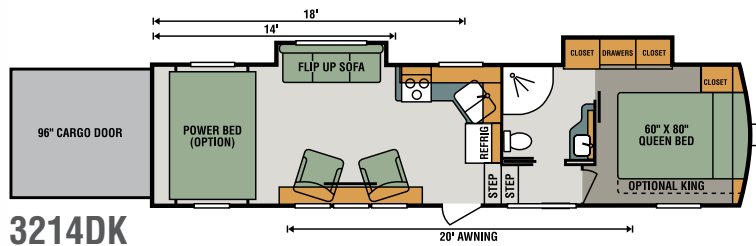

**3214DK**

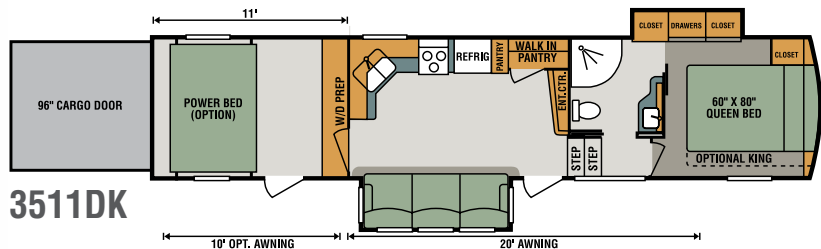

**3511DK**

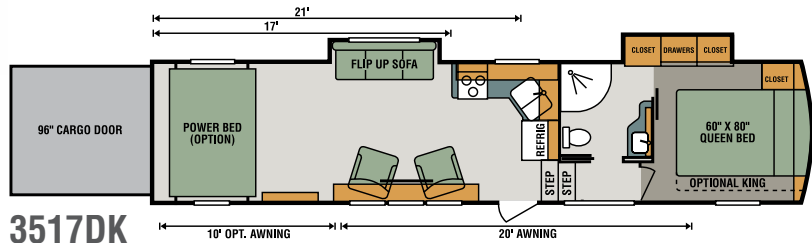

**3517DK**

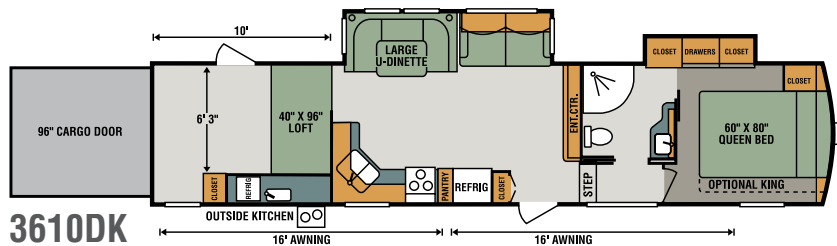

**3610DK**

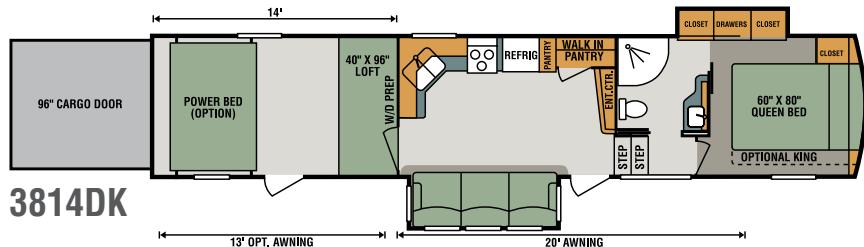

**3814DK**

Fifth Wheel Toy Haulers	3214DK	3511DK	3517DK	3610DK	3814DK
UVW (Unloaded Vehicle Weight)*	10,470	11,370	10,780	11,640	12,430
Dry Hitch Weight*	2,780	2,390	2,640	2,430	2,620
Dry Axle Weight*	7,690	8,980	8,140	9,210	9,810
NCC (Net Carrying Capacity)	4,525	3,625	4,215	3,355	4,570
GVWR	14,995	14,995	14,995	14,995	17,000
Interior Height	102"	102"	102"	102"	102"
Exterior Height	13' 4"	13' 4"	13' 4"	13' 4"	13' 4"
Exterior Width	101"	101"	101"	101"	101"
Exterior Length	34' 11"	38' 4"	37' 11"	38' 11"	41' 4"
Refrigerator (cu. feet)	8	8	8	8	8
Water Heater Cap. (gal. LP w/DSI)	12	12	12	12	12
Fresh Water Cap. (gal.)	116	116	116	100	116
Waste Water Cap. (gal.)	57	57	57	57	57
Gray Water Cap. (gal.)	57	97	57	57	57
LP Gas Cap. (lbs.)	60	60	60	60	60
Furnace BTUs (1,000s)	35	35	35	35	35
Tire Size	16"	16"	16"	16"	16"
Awning	20'	20'	20'	16'	20'
Optional 2nd Awning	N/A	10'	10'	16'	13'

\*This weight reflects the rolling average unit weight for each model. Your trailer weight will vary according to optional equipment.

### **Construction Features**

- 101" Wide-Body Construction
- Extra-Reinforced, Heavy Duty, High-Gloss Front Cap
- Radius Aerodynamic Front Cap (provides better turning radius & increased fuel economy)
- 2" x 3" Fully Welded Aluminum Floor Joists
- 2" x 2" Fully Welded Aluminum Sidewall Framing
- Lamilux® 4000 High-Gloss F/G
- Double-Insulated & Heated Holding Tanks (R-38 above & below tanks)
- R-11 2" Sidewalls (w/EGS metal backing strips to hold up all interior cabinets)
- One-Piece ABS Slideroom Bottoms
- Superflex® Roof Membrane w/ 12-Year Limited Warranty (a hybrid between TPO & rubber)
- Fully Vented Attic System
- 3/8" Roof Decking (fully walkable)
- 5/8" Tongue & Groove, Screwed & Glued Plywood Floor Deck
- Pex® In-Floor Heated Waterlines & Kitchen Gray Pipes (all waterlines & drains are located above all insulation)
- Fully-Enclosed & Heated Underbelly w/Directly Heated Holding Tanks

### **Construction Options**

- All-Weather Insulation PKG (roof, floor, ceiling, garage floor, end caps & tanks to R-38)
- 6-Point Electric Leveling
- Power Rear Stabilizer Jacks

### **Exterior Features**

- 7,000# Dexter® Axles w/Auto-Adjusting Brakes
- 8-Lug Heavy-Duty Aluminum Rims w/16" E-Range Nitro-Filled Radial Tires
- EZ Flex® Rubberized Suspension
- 4-Step Entry
- 100% Exterior LED Running Lights, Tail Lights & Backup Lights
- Carefree® Electric Awning w/Directional LED Light Bar at End of Awning
- Propane Bottles on Same Side of Coach for Easy Access
- Side Slam Latch Baggage Doors (where applicable) w/Magnet Catches for Full Access to Storage
- 50A Service w/Detachable Marine Power Cord
- 15,000 BTU Ducted Roof A/C
- 3" x 14" In-Floor Straight Line Heating System w/35,000 BTU Furnace
- 12 GAL Gas/Electric Hot Water Heater
- LED Floodlight by Entry Door & (2) LED Lights above Ramp Door
- LED Docking Light & Sewer Hookup Light
- Dual Swing-Away Assist Grab Handle

- Underneath Spare Tire w/Hoist
- Roof Ladder
- Heated Water Convenience Center (includes black tank flush, power fresh tank water fill, winterizing system, outside shower)
- Fully-Finished, Heated & Sealed Basement Storage Compartment (only available w/All-Weather Insulation Pkg)
- Heated & Enclosed Dump Valves
- Battery Disconnect
- Satellite Pre-Wire in Both the Convenience Center & Roof
- Outside Speakers on their own switch
- Generator prep w/Surge Protector
- 30 GAL Fuel Station w/Electric Pump

### **Exterior Options**

- Roto-Flex® Upgraded Hitch Pin
- 2nd 15,000 BTU Air Conditioner
- 2nd Lighted Patio Awning (N/A on 3214DK)
- Onan® 5500 Gas Generator
- Dual-Pane Windows
- Slideout Cover PKG
- G-Range Tires
- Backup Camera
- "Off the Grid" PKG (includes 160W solar panel, inverter & monitor panel)
- Ramp Door Patio Rails
- Toy Lock

### **Living Room/Kitchen Features**

- Solid-Surface Countertops
- Large residential Double-Bowl Stainless Steel Sink
- Pull-Out Sprayer Faucet
- Built-In Silverware Drawer
- Storage Shelf under Kitchen Sink
- All Kitchen OH Cabinets have Shelf & Extra-Tall Slide Lips
- Heavy-Duty 100# Drawer Glides on Every Drawer
- Baltic Birch Drawer Boxes
- Decorative Lighting above Many Cabinets
- Window in Kitchen (in most models)
- 5" Stainless Steel Cabinet Hardware
- Window Shades Throughout
- 3/8" Re-Bond Carpet Pad w/22 OZ Residential Carpet
- Stainless Steel Appliances
- Extra-Large Light Switches
- Faux Leather Vinyl Soft-Touch Ceiling
- Ceiling Crown Molding
- 100% LED Ceiling & Cabinet Lights w/Multiple On/Off Switches
- Deluxe Residential-Style Furniture
- Living Room HD Flat Panel TV on Bracket (includes exterior mount)

### **Living Room/Kitchen Options**

- Solid-Surface Matching Sink Covers
- Power Vent Fan (location varies)
- 12 CU FT Refrigerator Upgrade (3511, 3610, 3814 only)
- Folding Table

### **Garage/Ramp Area Features**

- Pull-Down Screen Wall
- Multiple D-Rings to Tie Down Cargo
- Built-in Dovetail
- Garage Entry Door (model specific)
- (2) Garage Ceiling Speakers
- Outside Garage Speaker Switches

### **Garage/Ramp Area Options**

- 3-Season Patio Door IPO Screen Wall
- Removable, Edged Carpet Kit (10' x 8')
- Happijac® Electric Bed & Rollover Sofas w/Table

### **Bathroom/Bedroom Features**

- Large Radius Shower w/Glass Door Enclosure
- Skylight Over Shower
- Porcelain Foot-Flush Toilet
- Extra-Wide Hall (going up into bedroom & pocket door from hall into the bathroom – most models)
- Towel Bar in Bathroom
- Power Vent Fan in Bathroom
- Extra-Large Under-Bed Storage
- Luxurious Bedspread & Pillow Shams
- Padded Headboard w/Hidden Storage

### **Bathroom/Bedroom Options**

- HD Flat Panel TV
- King-Size Bed Upgrade
- Upgraded Mattress

### **Bonus Features**

- 2-year Limited Warranty (see flyer)
- One of the lightest weight high profile, wide body, luxury Toy Hauler fifth wheels in the industry
- KZ RV has won the coveted DSI award 16 years.
- KZ RV's 44 years of building experience, coupled with its stable and dedicated Amish workforce and commitment to superb quality and low overhead, allows us to produce the lowest-priced fully featured fifth wheel available.



### 3511DK | sandstorm décor

Sidewinder's kitchens offer ample countertop space, a double-bowl stainless steel sink, pullout faucet and lots of cabinets. The kitchen/living area of the 3511DK boasts wide open space, stainless steel appliances, and a huge walk-in pantry. It comes standard with an eight-cubic-foot refrigerator and offers an optional upgraded twelve-cubic-foot refrigerator.



The 3511DK bedroom includes a large wardrobe slide, plus wardrobes on both sides of the bed when equipped with the standard queen bed. If you need more sleeping surface, an optional king bed is available. Features include a padded headboard with hidden flip-down storage and an overhead shelf with multiple outlets. The wardrobe slide extends into the bathroom and includes linen storage. An extended countertop offers more workspace, and a medicine cabinet. Added features include under-sink storage and under-countertop trashcan placement.



Sidewinder baths offer a large radius shower with glass enclosure, skylight, towel bar and porcelain toilet.



Shown here are the components of the optional Off the Grid Package, which includes a solar panel, power inverter and the monitor panel!



Inside the garage, you'll find additional storage, making the best use of available space.



Central Convenience Center, which includes an outside shower, black tank flush, winterization system, cable and satellite hookups and battery disconnect, all in a well-lit area.



The 3610DK's outside kitchen offers a lowered, easy-to-use sink, large refrigerator, pullout stove and lots of cabinet storage.



Portions of this brochure were used with the expressed authority of Dexter Axle, but Dexter Axle is not responsible for the accuracy of the information contained herein.



K-Z strongly encourages our retail customers to purchase from their local dealership whenever possible.

Dealer:



985 N 900 W • Shipshewana, IN 46565  
E-mail [kz@kz-rv.com](mailto:kz@kz-rv.com) • [www.kz-rv.com](http://www.kz-rv.com)

*Due to continual research and advances, manufacturer reserves the right to change specifications, design, price and equipment without notice, and assumes no responsibility for any error in this literature. Some items shown are not included as standard or optional equipment. ©2016KZ | 11/25/16 | 50M*