

**Dutchmen**  
Legendary Innovation. Trailblazing Value.



TOY HAULERS BY

**TRITON**  
BY VOLTAGE

DESIGNED FOR  
**LEGENDARY  
ADVENTURE**



# DESIGNED FOR LEGENDARY ADVENTURE.

Triton 3551

HARDWOOD CABINTRY

MAX FLOW AIR DUCTS

STAINLESS-STEEL APPLIANCES

KITCHEN HUTCH

SOLID-SURFACE COUNTERTOPS

## SLEEP SOUNDLY

The Triton features a 60x80-inch queen bed, while also providing a residential duvet cover, pleated night shades and a second 15,000-BTU air conditioner.

Triton 3551

## TRITON

**THE TRITON** is the titan of its industry delivering numerous upgraded features, such as residential furniture, a large electric awning, dual 15K A/C's and Tuff Ply garage flooring for extreme outdoor trips.



30-GALLON FUEL STATION



7,000LB AXLES



**BUNKS**

**REST  
OR  
PLAY**

**GARAGE**

## BUILT FOR MILES

- › Lay flat Happijac bed lift system helps load the tallest and widest toys in your collection.
- › Enjoy an upgraded sound system with multiple zones and primed with HDMI/AM/FM/CD/DVD and Bluetooth capabilities.
- › Tons of overhead storage, a 30-gallon fuel station and dynamic floorplans fit all your needs.



## TRANSFORMING YOUR LIVING SPACE

The rear of your RV is set to fit your needs, from beds, residential furniture, a large table perfect for dining or simply a spot to store your ATVs and dirt bikes.



## DELUXE BATHROOM

Designed for optimal comfort, Triton bathrooms feature hardwood cabinetry, a stainless-steel sink and full fiberglass shower.

## TRITON FLOORPLANS

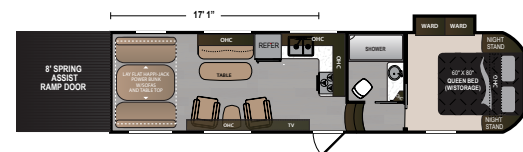

### TRITON | 2951

Ext. Length: 33' 6" Ext. Height: 13' 4"  
Average Shipping Weight: 10,300 Sleeps: 7

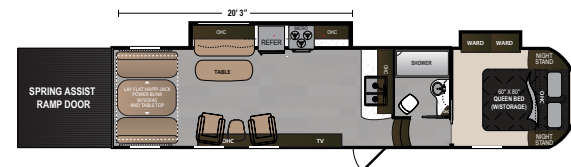

### TRITON | 3351

Ext. Length: 36' 5" Ext. Height: 13' 4"  
Average Shipping Weight: 11,230 Sleeps: 7

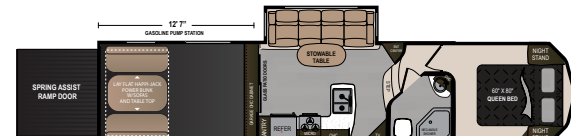

### TRITON | 3451

Ext. Length: 37' 8" Ext. Height: 13' 4"  
Average Shipping Weight: 11,190 Sleeps: 7

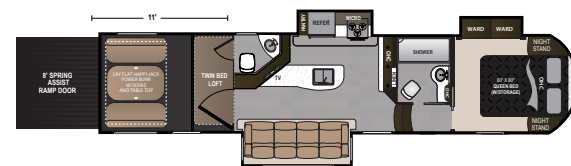

### TRITON | 3551

Ext. Length: 39' 0" Ext. Height: 13' 4"  
Average Shipping Weight: 12,784 Sleeps: 8

## TRITON DÉCOR

TIMBER

ECLIPSE

## TRITON SPECIFICATIONS

FLOORPLAN	DIMENSIONS			WEIGHTS (LBS.)			TANKS (GALS.)		
	EXTERIOR TRAVEL LENGTH	EXTERIOR WIDTH	HEIGHT (WITH A/C)	**AVERAGE SHIPPING WEIGHT	DRY HITCH WEIGHT	CARGO CARRYING CAPACITY	***FRESH WATER CAPACITY	GREY WATER CAPACITY	BLACK WATER CAPACITY
2951	33', 6"	100"	160"	10,458	2,494	6,342	92	76	38
3351	36', 5"	100"	160"	11,200	2,750	5,600	92	38	38
3451	37', 8"	100"	160"	11,295	2,614	5,505	92	68	38
3551	39', 0"	100"	160"	12,784	2,980	4,016	92	76	86

\*Length is defined as the distance from the centerline of hitch pin/coupler to rear bumper of trailer. \*\*Our weights represent how most units are built, inclusive of many commonly-ordered options. \*\*\*Fresh water capacity includes water heater capacity.

## TRITON STANDARDS AND OPTIONS

### MANDATORY FEATURES

Nitro Fill Tires
Rear Electric Jacks
Triton Exterior Package
Triton Garage Package
Triton Happijac Electric Bed and Roll Over Sofa System with Table
Triton Interior Package

7,000-lb Axles with Ultra Lube
7,040-lb Load Range E-Rated HD Tires (per Axle)
Fuel Tank w/ Pump Station (30-Gallons)
Fully Walkable Roof w/ TPO Superflex Material (12-Year Warranty)
Large Electric Awning with LED Lights
Omni Directional TV Antenna with AM/FM/Cable Booster
Spare Tire with Carrier
Tinted Safety Glass Windows
Upgraded Graphics with 3-Year Warranty

### TRITON INTERIOR PACKAGE

1.0 cu. ft. Microwave
15,000-BTU Bedroom A/C with Thermostat Sensor
3 Burner Range w/ Upgraded Burner
32"-39" LCD HD Main TV
60"x80" Queen Bed (Select Models)
8 cu. ft. Refrigerator w/ Pantry
Atwood 6-Gallon Gas Electric Water Heater w/DSI and 19.7 gal/hr Recovery
Bedroom TV Prep
Cable/Satellite Prep
Furion Stereo System with HDMI/AM/FM/DVD/Bluetooth
Pleated Night Shades throughout the entire coach
Range Hood with Fan and Lights
Residential Duvet Covers
Solid-Surface Kitchen Countertops
Stainless-Steel Kitchen Sink
Upgraded Residential Furniture

### TRITON GARAGE PACKAGE

2 Indoor/Outdoor Speakers
2,500-lb Tie Downs
Insulated Heat and A/C Ducts
Metal Ram Air Vents
Tuff Ply Garage Flooring

### GENERATOR OPTIONS

Generator Ready (Standard)
Onan 5.5 KW Gas Generator

### OPTIONS

12-Volt Tank Heaters with Interior Switches
Aluminum Ramp Door Patio System w/ Patio Awning
Dual Pane Safety Glass Windows

### CODES AND SEALS

CSA Construction Seal
RVIA Seal
State Seal (Where Applicable)
Winterization (October - April)

### TRITON EXTERIOR PACKAGE

1" Thick Baggage Doors
16" Aluminum Wheels
50-amp Service with 50' Cord and Indicator Lights

## Dutchmen—A North American Campground Classic.

Few manufacturers have built RVs for 25+ years, and only one has set the standard for innovation AND value. Dutchmen IS "A North American Campground Classic."



# MORE STANDARD FEATURES MORE VALUE

Dutchmen RVs turn more heads on the lot and in the campground than any other. Why? While other manufacturers offer features as options, Dutchmen tends to make those same features standard. Call it "bang for the buck," "more for your money," or simply "more value." **We've built a reputation for bringing RV owners more standard features for less money** for more than 25 years... and it's a reputation we plan to keep.

At Dutchmen, quality is our standard. **Every single Dutchmen RV that comes off the line receives its own pre-delivery inspection.** Typically, a competitor performs random inspections, meaning you won't find this commitment to quality anywhere else.



More than 300 Dutchmen dealers across North America and our industry-leading service center in Goshen, Indiana, combine for your peace of mind before, during and after the sale. Rest assured no matter where your travels take you, **the best-resourced RV manufacturing company in the world is behind you all the way.**

PO BOX 2000 • 2164 Caragana Court  
Goshen, Indiana 46527 Sales: 574.537.0600  
[www.dutchmen.com](http://www.dutchmen.com)

To check for recent updates to floorplans and specifications. **Scan this QR CODE** with your favorite QR Reader application.



[www.dutchmen.com](http://www.dutchmen.com)

Visit us online to see all of the Dutchmen brands, innovative models and spacious floorplans.

Your local dealer

From giving advice to servicing products, we consider our loyal dealers the best resource for learning about Dutchmen products.

TRI-HM0117-24K

**DISCLAIMER:** Product information is as accurate as possible as of the brochure publication date. All features, floorplans and specifications in this brochure are subject to change without notice. Please consult Dutchmen's website at [www.Dutchmen.com](http://www.Dutchmen.com) for current product information and specifications. Tow Vehicle Disclaimer. **CAUTION:** Owners of Dutchmen recreational vehicles are solely responsible for the selection and proper use of tow vehicles. All customers should consult with a motor vehicle manufacturer or their dealer concerning the purchase and use of suitable tow vehicles for Dutchmen products. Dutchmen disclaims any liability or damages suffered as a result of the selection, operation, use or misuse of a tow vehicle. **DUTCHMEN'S LIMITED WARRANTY DOES NOT COVER DAMAGE TO THE RECREATIONAL VEHICLE OR THE TOW VEHICLE AS A RESULT OF THE SELECTION, OPERATION, USE OR MISUSE OF THE TOW VEHICLE. REFERENCE DUTCHMEN MANUFACTURING OWNERS MANUAL FOR LIMITED WARRANTY DETAILS.**