

SPORTSMEN[®] *Classic*

ULTRA LIGHTWEIGHT TRAVEL TRAILERS





181BH

SPORTSMEN[®] *Classic*

The 2017 Sportsmen Classic offers a new front profile that allows for a 78" interior height, 12-volt dual USB port, LED lighting, plush pile bunkmats and comfortable seating throughout.

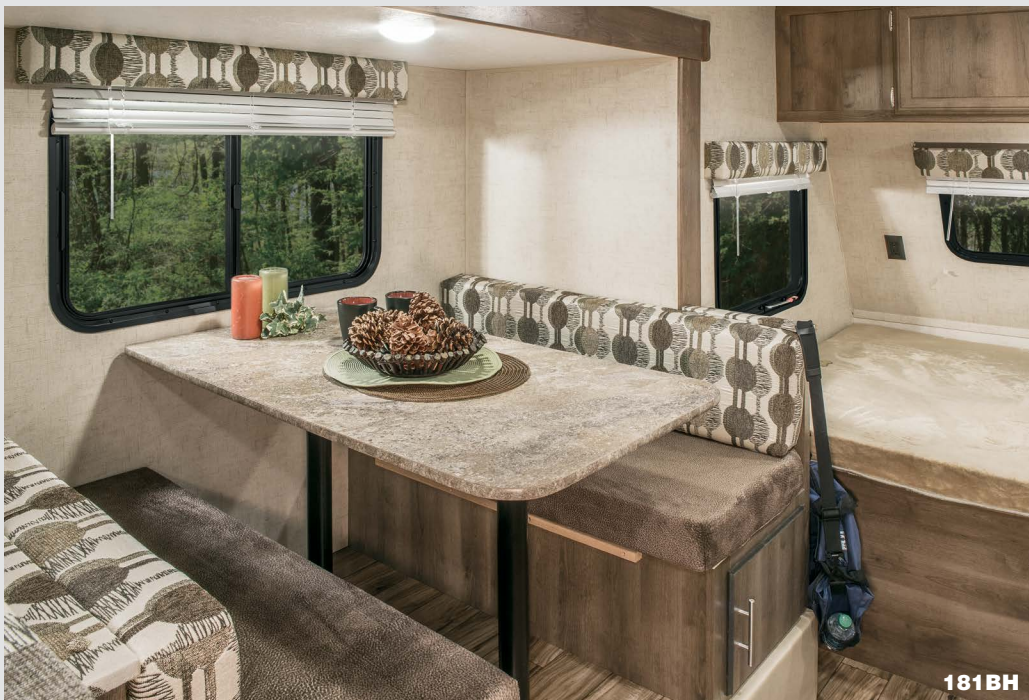

181BH

Large convertible dinettes offer spacious seating and under-seat storage.



181BH

Kitchens boast tons of storage, and include a deep, single-bowl sink that's large enough to fill pots, pans and pitchers.

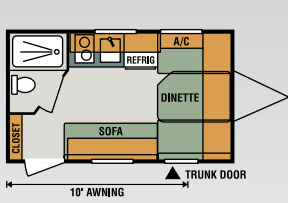

130RB

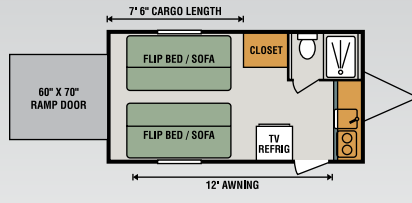

140TH Toy Hauler

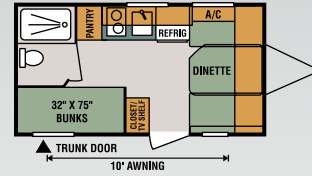

150BH

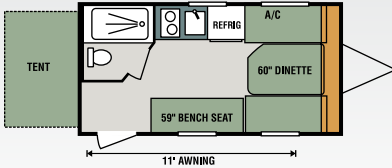

150RBT **NEW**

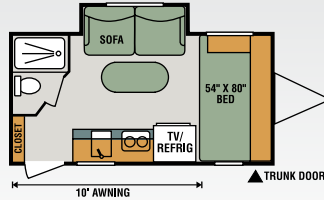

151RB

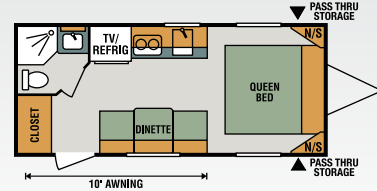

160QB

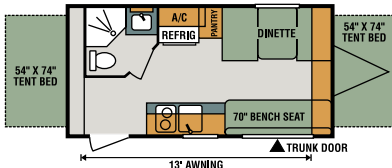

160RBT

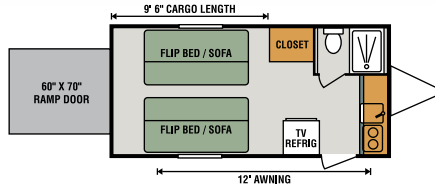

160TH Toy Hauler

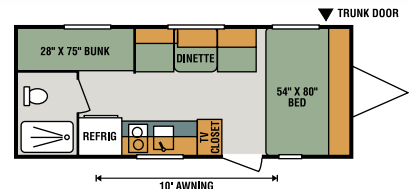

180BH

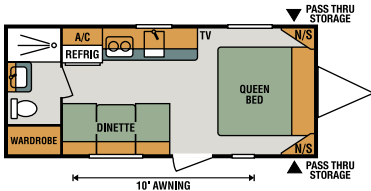

180QB

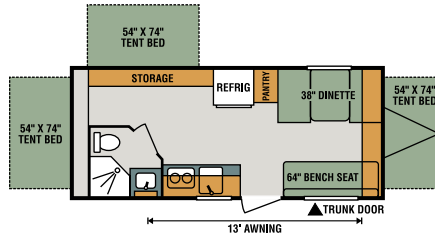

180RBT

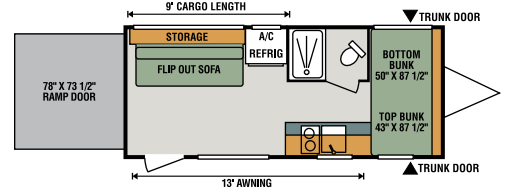

180TH Toy Hauler **NEW**

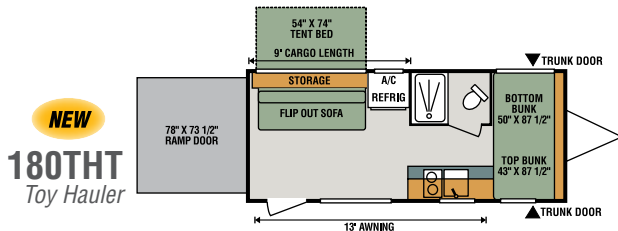

NEW
180THT
Toy Hauler

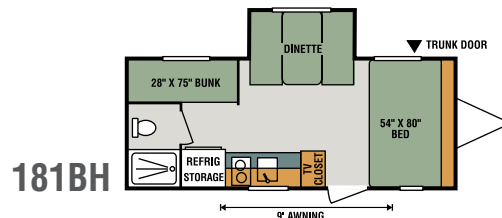

181BH

| Travel Trailers | 130RB | 140TH | 150BH | 150RBT | 151RB | 160QB | 160RBT | 160TH | 180BH | 180QB | 180RBT | 180TH | 180THT | 181BH |
|---|---------|--------|--------|--------|---------|---------|---------|--------|--------|---------|--------|--------|--------|--------|
| UVW (Unloaded Vehicle Weight)* | 2,126 | 2,400 | 2,263 | 2,300 | 2,530 | 2,740 | 2,696 | 2,530 | 2,623 | 2,713 | 3,116 | 3,210 | 3,330 | 2,840 |
| Dry Hitch Weight* | 323 | 350 | 343 | 320 | 420 | 376 | 336 | 400 | 346 | 336 | 426 | 440 | 410 | 370 |
| Dry Axle Weight* | 1,803 | 2,050 | 1,920 | 1,980 | 2,110 | 2,364 | 2,360 | 2,130 | 2,277 | 2,377 | 2,690 | 2,770 | 2,920 | 2,470 |
| NCC (Net Carrying Capacity) | 674 | 1,100 | 537 | 500 | 970 | 760 | 804 | 1,470 | 877 | 787 | 1,384 | 1,790 | 1,670 | 660 |
| GVWR | 2,800 | 3,500 | 2,800 | 2,800 | 3,500 | 3,500 | 3,500 | 4,000 | 3,500 | 3,500 | 4,500 | 5,000 | 5,000 | 3,500 |
| Interior Height | 78" | 78" | 78" | 78" | 78" | 78" | 78" | 78" | 78" | 78" | 78" | 78" | 78" | 78" |
| Exterior Height w/o Roof A/C (unless noted)** | 107" | 107" | 107" | 107" | 112" | 107" | 107" | 107" | 107" | 107" | 118" | 107" | 107" | 112" |
| Exterior Width | 84" | 90" | 84" | 84" | 84" | 90" | 90" | 90" | 84" | 90" | 90" | 90" | 90" | 84" |
| Exterior Length | 15' 10" | 17' 4" | 17' 2" | 17' 2" | 17' 11" | 21' 10" | 18' 10" | 19' 4" | 20' 6" | 21' 10" | 21' 3" | 21' 7" | 21' 7" | 20' 6" |
| Refrigerator (cu. feet) | 3 | 3 | 3 | 3 | 4 | 4 | 4 | 3 | 4 | 4 | 6 | 4 | 4 | 4 |
| Water Heater Cap. (gal. LP w/DSI) | 6 | 6 | 6 | 6 | 6 | 6 | 6 | 6 | 6 | 6 | 6 | 6 | 6 | 6 |
| Fresh Water Cap. (gal.) | 20 | 38 | 20 | 20 | 20 | 20 | 20 | 38 | 20 | 20 | 20 | 38 | 38 | 20 |
| Waste Water Cap. (gal.) | 9 | 5 | 9 | 9 | 9 | 32 | 24 | 5 | 9 | 32 | 24 | 32 | 32 | 9 |
| Gray Water Cap. (gal.) | 15 | 26 | 15 | 15 | 15 | 32 | 32 | 26 | 15 | 32 | 32 | 32 | 32 | 15 |
| LP Gas Cap. (lbs.) | 20 | 20 | 20 | 20 | 20 | 20 | 20 | 20 | 20 | 20 | 20 | 20 | 20 | 20 |
| Furnace BTUs (1,000s) | 20 | 20 | 20 | 20 | 20 | 20 | 20 | 20 | 20 | 20 | 20 | 20 | 20 | 20 |
| Tire Size | 13" | 14" | 13" | 13" | 14" | 14" | 14" | 15" | 14" | 14" | 13" | 15" | 15" | 14" |
| Awning | 10' | 12' | 10' | 11' | 10' | 10' | 13' | 12' | 10' | 10' | 13' | 13' | 13' | 9' |

*This weight reflects the rolling average unit weight for each model. Your trailer weight will vary according to optional equipment. **This exterior height is with roof A/C.



K-Z's new proprietary Aqualon Edge® fabric (used on all expandables) has a new hybrid coating that reduces heat gain inside the bunkend. It's 33% to 44% cooler than our competitor's material, plus, it boasts a 7-year warranty.

Standards

- K-Z Exclusive Tough Shield .030 Exterior Metal
- R-7 Insulation
- Front Diamond Plate
- Alum-a-Tough® Roofing w/12-Year Limited Warranty
- Tinted Windows
- Radial 13" or 14" Tires (F/P specific)
- Self-Adjust Electric Brakes
- Rear Bumper w/Sewer Hose Storage
- Digital TV Antenna
- Cable Hookup
- City Water Fill
- 12V Converter w/Charger
- LP Tank
- 2-Burner LP Hot Plate
- Microwave
- LP/Electric Refrigerator
- Single-Bowl Sink
- 6-Gallon LP DSI Water Heater
- Overhead Cabinets
- LED Interior Lights
- Shower & Toilet
- Tank Monitor Panel

K-Z Advantage Package (mandatory option)

- New Front Profile w/ 78" Interior Walls
- New Aqualon Edge® Material on EXPs w/7-Year Warranty
- 2-Tone EXT Sidewall Metal
- Folding Grab Handle
- Key-Alike Program for Baggage & Entry Doors
- (4) Scissor-Style Stabilizer Jacks
- 5/8" Tongue & Groove Plywood
- Power Awning w/LED Light Strip
- Nitrogen-Filled Tires
- Spare Tire & Carrier
- Exterior Speakers
- Solar Prep
- Backup Camera Prep
- 8,000 BTU A/C
- 20,000 BTU Furnace
- Plywood Bed Base
- Digital Media Stereo w/Bluetooth & NFC USB Port
- (2) 6.5" Interior Speakers
- 12V Dual USB Port
- Foot-Flush Toilet



New off-road package option includes aluminum rims with 15" mud tires, extra ground clearance, electronically-controlled heated holding tanks and double entry step.

181BH



Options

- Front Window (N/A on toyhaulers, 160RBT, 180RBT)
- Wireless Backup Camera System
- Retractable Screen Wall (toyhaulers only)
- 13,500 BTU A/C LowPro® (REQ 180RBT)
- 6.3 CU FT Refrigerator (REQ 180RBT – must OPT roof air)
- U-Dinette IPO STD Dinette (181BH only)

- 24" TV w/Inside/Outside Bracket (160QB, 180QB, 180TH, 180THT only)

Off-Road Package

- Aluminum Rims w/15" Mud Tires
- Extra Ground Clearance
- Electronic-Controlled Heated Holding Tanks
- Double Entry Step

Dealer:

RVIA



985 N 900 W • Shipshewana, IN 46565
E-mail kz@kz-rv.com • www.kz-rv.com

Due to continual research and advances, manufacturer reserves the right to change specifications, design, price and equipment without notice, and assumes no responsibility for any error in this literature. Some items shown are not included as standard or optional equipment. ©2016KZ | 2/16/17 | 25M