

# VENGEANCE

*Touring Edition*







381L12-6 GARAGE



---

# UNRIVALED LUXURY

FLOORPLANS THAT FIT YOUR NEEDS  
& FEATURES THAT YOU WANT.

---

VALUE THAT CAN'T BE BEAT.



# WHY BUY ANYTHING ELSE...



381L12-6  
BATHROOM



381L12-6  
LIVING AREA



# REVOLUTIONARY VALUE

EVERY TOURING EDITION COMES STANDARD WITH:

- > 3 A/C's w/ Power management system
- > Ramp Patio System w/Rear Power Awning
- > 6 point Hydraulic Self Leveling System
  - > Standard Insulation PLUS Package
- > Industry Leading Entertainment Package



40D12  
SIDE PATIO



40D12  
LIVING AREA



40D12  
REAR PATIO



40D12  
GALLEY



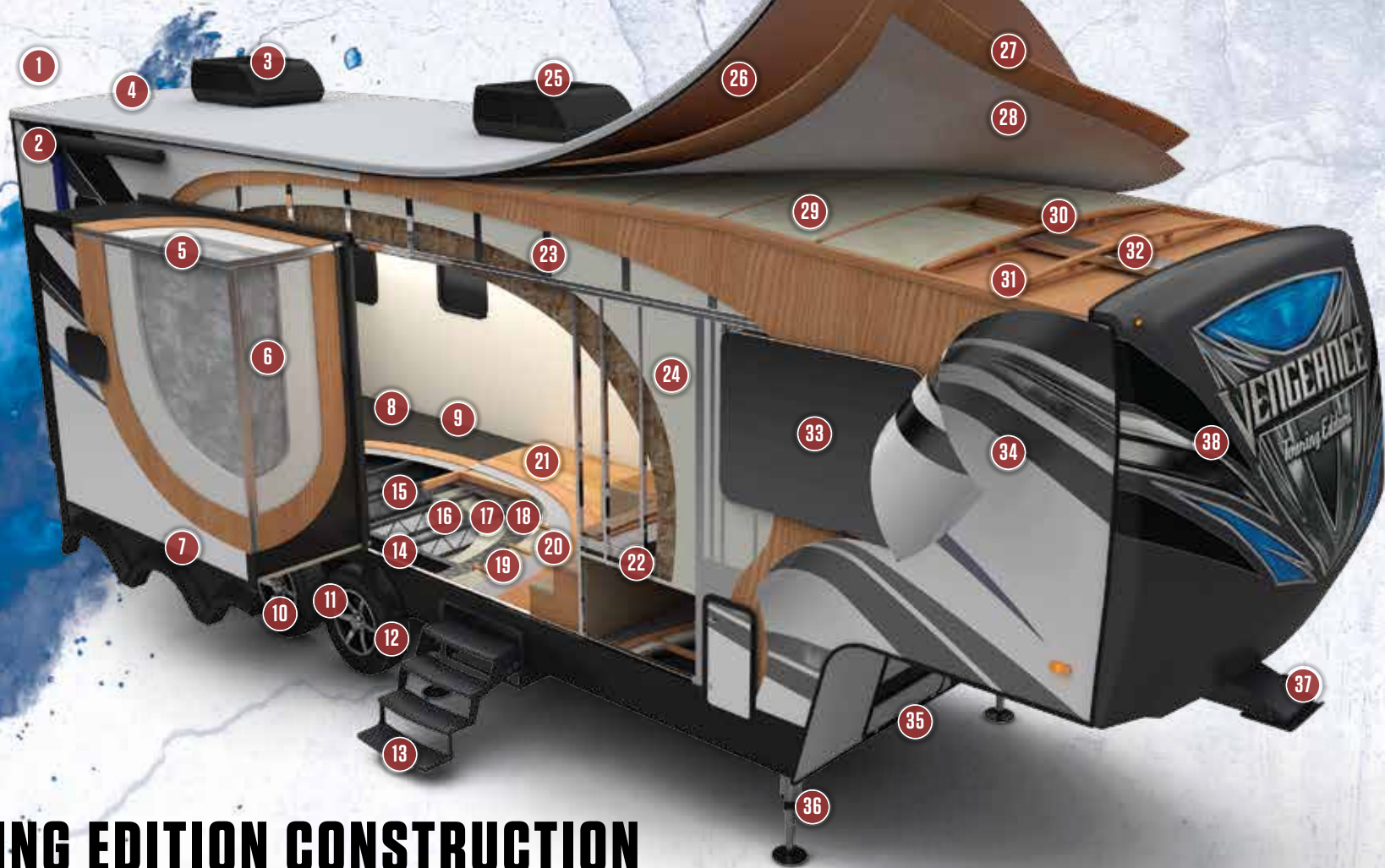

## TOURING EDITION CONSTRUCTION

QUALITY BUILT EVERY TIME.

- |   |  |    |  |    |  |
|---|--|----|--|----|--|
| 1 | Rear power awning (not shown)                        | 20 | Baton insulation                         | 30 | 13,500 BTU bedroom A/C                       |
| 2 | Dual power awnings w/ LED strip lighting             | 21 | Tongue in groove plywood floor           | 31 | 5" Bowed wood truss rafters                  |
| 3 | 13,500 BTU rear A/C w/ 5,000 BTU heat strips         | 22 | Aluminum framed laminated bed/bath floor | 32 | Aluminum A/C Ducting                         |
| 4 | Full walk-on roof                                    | 23 | 2" Welded aluminum wall studs            | 33 | Frameless tinted windows                     |
| 5 | Aluminum framed, vacuum bonded, slide out roof       | 24 | Block foam wall insulation               | 34 | Vacuum bonded fiberglass side walls          |
| 6 | Aluminum framed, vacuum bonded, slide out side walls | 25 | 15,000 BTU A/C                           | 35 | 102" Wide body                               |
| 7 | Alumifoil insulated slide out floors                 | 26 | One piece PVC roof material              | 36 | 6 point hydraulic self leveling              |
| 8 | 1" garage floor decking w/3,000 lb cargo capacity    | 27 | 3/8" Roof decking                        | 37 | Trail air rotoreflex hitch pin               |
| 9 | Tuff ply cargo flooring in garage                    | 28 | Alumifoil insulation layer               | 38 | Painted fiberglass front cap w/ LED Lighting |
|   |  | 10 | 7,000 lb. Axles                          |    |  |
|   |  | 11 | Equa Flex Suspension                     |    |  |
|   |  | 12 | Optional G-Rated Tires                   |    |  |
|   |  | 13 | 4 step entry steps (both entry doors)    |    |  |
|   |  | 14 | True wide I-Beam chassis                 |    |  |
|   |  | 15 | Fluted polypropylene enclosed underbelly |    |  |
|   |  | 16 | Alumifoil insulation layer               |    |  |
|   |  | 17 | Baton insulation layer                   |    |  |
|   |  | 18 | Polyethylene subfloor wrap               |    |  |
|   |  | 19 | 2x3 Wood floor joists                    |    |  |



# TOURING EDITION FLOORPLANS

QUALITY BUILT EVERY TIME.

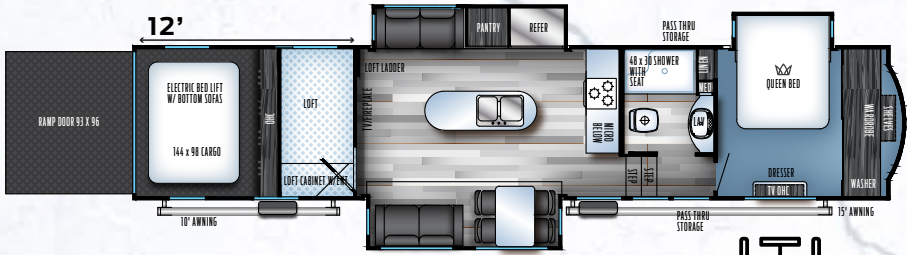

MODEL:  
**38D12**

EXTERIOR LENGTH: 42'10"  
SHIP WEIGHT: 14,877 LBS  
HITCH WEIGHT: 3,302 LBS

**TABLE & CHAIRS**

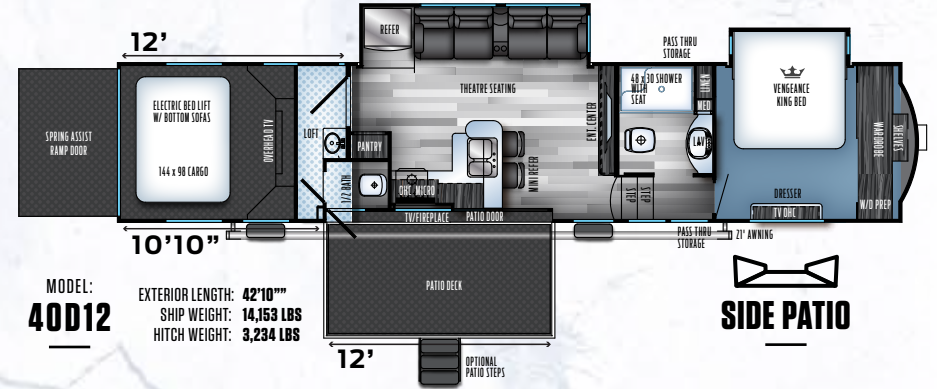

MODEL:  
**40D12**

EXTERIOR LENGTH: 42'10"  
SHIP WEIGHT: 14,153 LBS  
HITCH WEIGHT: 3,234 LBS

**SIDE PATIO**

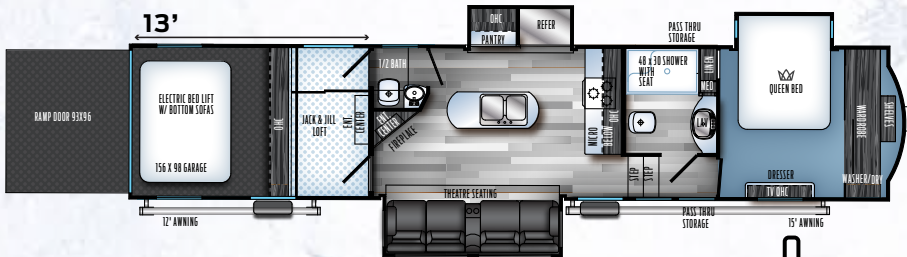

MODEL:  
**38L13**

EXTERIOR LENGTH: 42'10"  
SHIP WEIGHT: 14,776 LBS  
HITCH WEIGHT: 3,590 LBS

**BATH & 1/2**

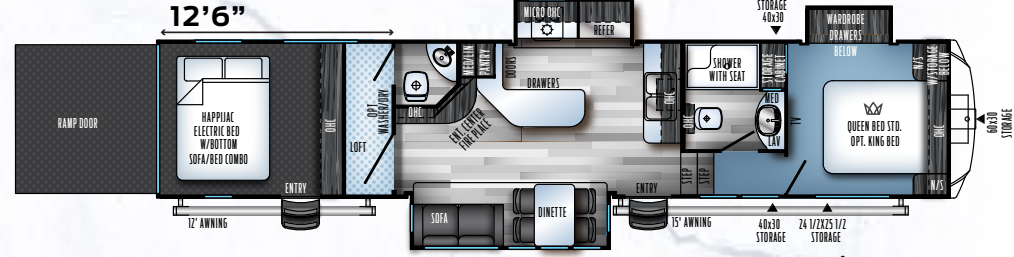

MODEL:  
**381L12-6**

EXTERIOR LENGTH: 43'4"  
SHIP WEIGHT: 14,221 LBS  
HITCH WEIGHT: 2,924 LBS

**NEW FLOORPLAN**



MODEL:  
**39R12**

EXTERIOR LENGTH: 42'10"  
SHIP WEIGHT: 14,686 LBS  
HITCH WEIGHT: 3,531 LBS

**RESIDENTIAL KITCHEN**

# VENGEANCE TOURING EDITION STANDARDS & OPTIONS

## EXTERIOR FEATURES

102" Wide Body  
InsulationPLUS Insulation Upgrade  
42,000 BTU Furnace  
15,000 BTU Ducted Living Room A/C  
13,500 BTU Garage A/C with 5,000 BTU Heat Strips  
Dedicated Garage Thermostat  
13,500 BTU Bedroom A/C  
Power Management System with Load Monitor  
5500 Watt Generator  
Wide Set I-Beams on Chassis  
40 Gallon Fuel Tank with Pump Station  
LP Quick Connect  
Dual Power Awnings with LED Lighting (N/A 40D12)  
30" Wide Entry Doors  
Fiberglass Front Cap with LED Lighting  
Aluminum Framed, Vacuum Bonded Laminated Side Walls  
Aluminum Framed Bed Deck  
Frameless Tinted Safety Glass Windows  
Lockable Quad Entry Steps  
Dual 30lb. LP Tanks  
Solar Prep  
100% LED Lighting  
15' Cable Toy Lock  
Crank Down Spare Tire with Carrier  
6 Point Automatic Hydraulic Self Leveling System  
Electric Blue Awning Arms  
Large Entry Assist Handle  
Aluminum Rims  
Storage Compartment Lights  
Dual Satellite Hook Up  
Black Tank Flush  
Cable TV Hook Up  
10 Gallon Gas/Electric DSI Water Heater  
12 Volt Disconnect  
50 Amp Service  
100 Amp Converter  
Easy Access Water Heater Bypass

Hydraulic Slide Out System w/ Selector Valve Switches  
Outside Shower with Hot and Cold Water Enclosed Underbelly  
Oversized Pass Through Storage  
Self Adjusting Brakes  
Ultra Lube Axles  
Convenience Center with LED Lighting

## INTERIOR FEATURES

Central Command Center  
Solid Surface Counter Tops in Kitchen  
Oversized Stainless Steel Kitchen Sink  
Solid Surface Sink Covers  
Upgraded Residential Pull Down Kitchen Faucet  
LED Accent Lighting  
Raised Panel Cabinet Doors Throughout  
Adjustable Residential Hidden Hinges  
Raised Panel Refer Fronts  
Adjustable Hidden Hinges  
Full Extension Ball Bearing Drawer Glides  
Solid Wood Drawer Frames  
Lumber-Core Cabinetry  
Screwed Cabinetry  
Composite Interior Steps  
100% LED Interior Lighting  
Power Kitchen Vent Fan  
22" Oven  
Recessed Glass Stove Top  
Microwave  
Roller Shades in Living Room  
Lighted Switches  
Heated Reclining Theater Seating  
Residential Crown Molding Throughout  
Fireplace with Stone Front  
Extra Tall Slide Height  
Pop Up Kitchen Power Strip  
Wood Loft Bunk Rail  
Steel Loft Ladder  
Large Walk In Shower with Bench  
Oversized Skylight Above Shower  
Porcelain Foot Flush Toilet

Power Exhaust Fan in Bathroom  
Large Bathroom Mirror  
Underlit Bathroom Counter Top on Dimmer Switch  
Residential Vessel Sink  
Solid Wood Bedroom Dresser Top  
Oversized Bedroom Closet with Shelves  
Washer/Dryer Prep  
Additional Cabinet and Cubby Bedroom Storage  
Night Shades in Bedroom  
Denver King Mattress (Per Model)  
Denver Queen Mattress (Per Model)

## GARAGE

5,000lb. Tie Downs Secured to Chassis  
Electric Bed Lift with Overstuffed Sofas  
Upgraded Waterproof Free Standing Table  
Black Out Blind Window Coverings  
Ramp Patio System  
1" Thick Garage Floors  
3,000Lb. Cargo Capacity  
24" Dovetail for Improved Load Angle  
Deluxe Pull Down Screen Wall  
Diamond Plate Base Board Wall Protection  
Oil and Gas Resistant Tuff Ply Flooring  
8' Ramp Door  
Ram Air Ventilation System  
Indoor/Outdoor Carpet  
Lighted Switches

## ENTERTAINMENT PACKAGE

### LIVING ROOM

42" Flat Screen TV  
Blue Ray Player  
Sound Bar with Bass and Surround Boost  
Satellite and Cable Hook Up  
TV Antenna with Boost  
Loft TV Hook Up

### > GARAGE

29" Flat Screen TV  
Touch Screen Bluetooth Stereo with CD/

### DVD

BOSE Marine Speakers with Interior and Exterior Brackets  
500 Watt Amplifier  
Upgraded Interior Speakers  
Indoor/Outdoor Speaker Selector Switch  
Upgraded Exterior Speakers  
Exterior Cable and Video Hook Up

### > BEDROOM

29" Flat Screen TV  
Satellite and Cable Hook Up

## PLATINUM PACKAGE

(not all items available on all models)  
20 Cubic Foot Residential Refer w/Inverter  
6 Point Hydraulic Leveling  
Back Up Camera Ready  
Collapsible Roof Ladder  
Collapsing Clothes Rod  
Equa Flex Suspension System  
Heated Reclining Theater Seats  
Multiple USB Charging Ports  
Quad LED Brake Lights  
Ramp Patio Awning  
Rear Loading Lights  
Slide out Selector Switches  
Trail Air Hitch Pin  
Upgraded 7,000# Axles  
Upgraded Hinged HappiJac Sofas with Fold Down Cup Holder  
Upgraded Ramp Patio System  
Waste Master

## OPTIONS

12 Cubic Foot Refrigerator IPO Residential Refrigerator with Inverter  
3 Seasons Wall  
Dual Pane Windows  
G Rated Tires (3 Axle)  
Ramp Patio Step w/Handrail  
Second Fuel Cell





### PRE-DELIVERY INSPECTION FACILITY

20,000 square feet of quality assurance. The bare essentials for a premium product. This state-of-the-art facility gives immediate daily feedback to production for quality assurance in every unit built.

# VENGEANCE

## Touring Edition

### FIFTH WHEELS

	<b>38D12</b>	<b>38L13</b>	<b>39R12</b>	<b>40D12</b>	<b>381L12-6</b>
Dry Hitch Weight	3302-lbs	3590-lbs.	3531 lbs	3234 lbs	2924-lbs.
Unloaded Vehicle Weight	14877-lbs	14776-lbs.	14686 lbs	14153 lbs	14221-lbs.
Axle Weight	11516-lbs	11127-lbs.	11096 lbs	10860 lbs	11238-lbs.
GVWR w/Brakes	19500-lbs	19500-lbs.	19500 lbs	19500 lbs	19500-lbs
Cargo Carrying Capacity	4623-lbs	4724-lbs.	4814-lbs	5347-lbs	5279-lbs.
Exterior Length	42' 10"	42' 10"	42' 10"	42' 10"	43'-4"
Exterior Height w/ AC	13'-4"	13'-4"	13'-4"	13'-4"	13'-4"
Exterior Width	102"	102"	102"	102"	102"
Grey Capacity	100 Gal.	100 Gal.	100 Gal.	100 Gal.	100 Gal.
Black Capacity	50 Gal.	50 Gal.	50 Gal.	50 Gal.	100 Gal.
Fresh Capacity	100gal	100gal	100gal	100gal	100gal
Awning Size	15' & 10'	15' & 12'	15' & 12'	21'	15' & 12'
Cargo Area Size-Off DS	144"	156"	144"	144"	150"
Cargo Area Size-DS	144"	156"	144"	120"	150"

### 24/7 EMERGENCY ROADSIDE ASSISTANCE

For a worry-free ownership experience Forest River includes one

year of Coach-Net RV Technical & Roadside Assistance with each RV purchase. Whether new to the RV lifestyle or an experienced RV enthusiast, Forest River owners have 24/7 access to technical, operational and emergency road service coverage throughout the US & Canada. Coach-Net's fast, dependable service is just a phone call away.

**Coach-Net®**  
RV Technical & Roadside Assistance



**Learn More**  
Scan this barcode using a QR Reader on your smart phone to learn more about Forest River.



A Berkshire Hathaway company.

YOUR VENGEANCE DEALER

### CUSTOMER SATISFACTION



[www.ForestRiverBuyLocal.com](http://www.ForestRiverBuyLocal.com)

All information contained in this brochure is believed to be accurate at the time of publication. However, during the model year, it may be necessary to make revisions and Forest River, Inc., reserves the right to make all such changes without notice, including prices, colors, materials, equipment and specifications as well as the addition of new models and the discontinuance of models shown in this brochure. Therefore, please consult with your Forest River, Inc., dealer and confirm the existence of any materials, design or specifications that are material to your purchase decision. Litho. U.S.A. P / W: 2014.09.05

### Specification Definitions

**GVWR (Gross Vehicle Weight Rating)** - is the maximum permissible weight of the unit when fully loaded. It includes all weights, inclusive of all fluids, cargo, optional equipment and accessories. For safety and product performance do NOT exceed the GVWR.

**GAWR (Gross Axle Weight Rating)** - is the maximum permissible weight, including cargo, fluids, optional equipment and accessories that can be safely supported by a combination of all axles.

**UVW (Unloaded Vehicle Weight)\*\*** - is the typical weight of the unit as manufactured at the factory. It includes all weight at the unit's axle(s) and tongue or pin and LP Gas. The UVW does not include cargo, fresh potable water, additional optional equipment or dealer installed accessories.

\*Estimated average based on standard build optional equipment.

**CCC (Cargo Carrying Capacity)\*\*** - is the amount of weight available for fresh potable water, cargo, additional optional equipment and accessories. CCC is equal to GVWR minus UVW. Available CCC should accommodate fresh potable water (8.3 lbs per gallon). Before filling the fresh water tank, empty the black and

gray tanks to provide for more cargo capacity.

\*\* Estimated average based on standard build optional equipment

Each Forest River RV is weighed at the manufacturing facility prior to shipping. A label identifying the unloaded vehicle weight of the actual unit and the cargo carrying capacity is applied to every Forest River RV prior to leaving our facilities.

The load capacity of your unit is designed by weight, not by volume, so you cannot necessarily use all available space when loading your unit.