



FORESTER

BY FOREST RIVER



GTS



MBS



TS



A Berkshire Hathaway company.



Tasteful design, combined with a unique combination of style, value and preferred amenities make travel in the Forester comfortable and loads of fun. Forester's unique split level design provides maximum headroom in the living area, while still offering pass-through storage on every floorplan. Plus, all Foresters are "Certified Green" by TRA Certification.

Control RV systems, access how-to videos, get product information and RV resources via an easy to use wireless touch screen with "My RV", the smart phone remote monitor system.



Shown in Chestnut Decor with optional Rustic Cherry cabinetry

FORESTER

BY FOREST RIVER

STANDARD SERIES



This outdoor camp kitchen is standard on 2861DS.





CLASS C TOP FEATURES

- ◆ "My RV" smart phone remote and monitor system
- ◆ 7' Ceiling height
- ◆ Crowned fiberglass roof
- ◆ 2" Thick gel coat sidewalls with Azdel "Superlight" composite
- ◆ Firestone Ride Right suspension
- ◆ Enclosed and heated tanks
- ◆ Water filtration system
- ◆ 7,500 Lb. tow rating
- ◆ Solid surface kitchen counter tops
- ◆ Residential cabinetry
- ◆ Stainless steel appliances
- ◆ Integrated entry step
- ◆ Waste Master® RV sewer management system

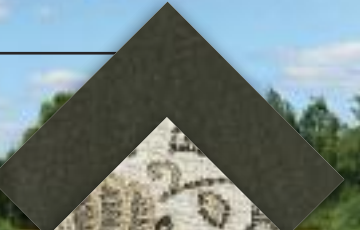

Shown in Cobblestone Decor with optional Rustic Cherry cabinetry

| | | | | | | | |
|--------------|---|---|--|----------------------|-----------------------|--|--|
| | ALMOND | COBBLESTONE | CHESTNUT | | | | |
| DECOR |  |  |  | | | | |
| | | | | RUSTIC CHERRY | WEATHERED TEAK | | |
| | | | | | | | |

Not available in LE Models

FORESTER

BY FOREST RIVER

CLASS C FLOORPLANS

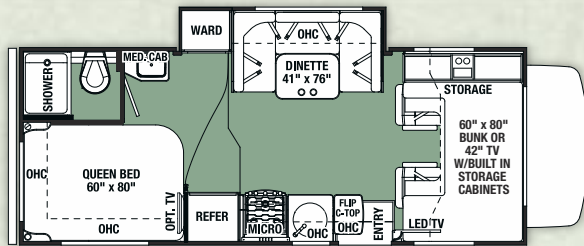

2291S

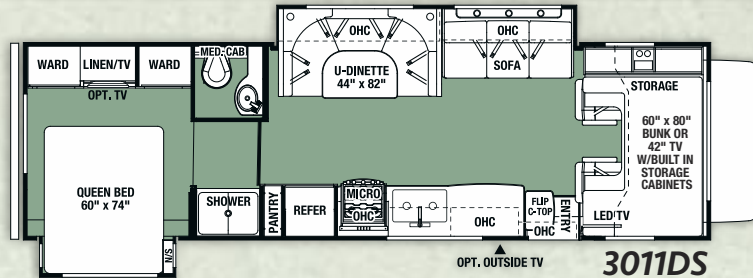

3011DS

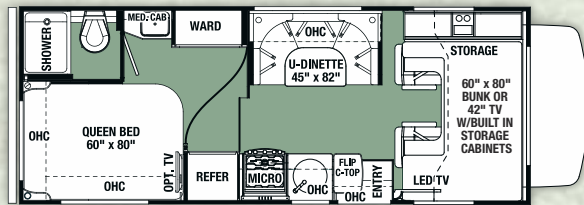

2301

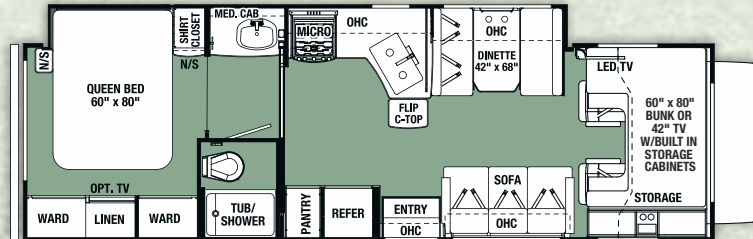

3051S

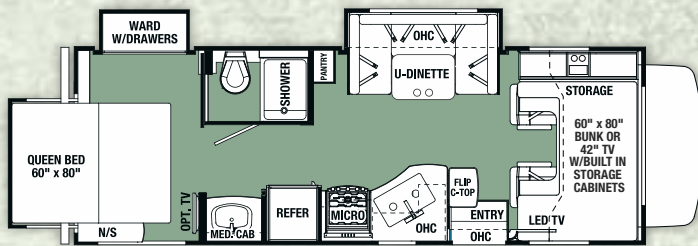

2501TS

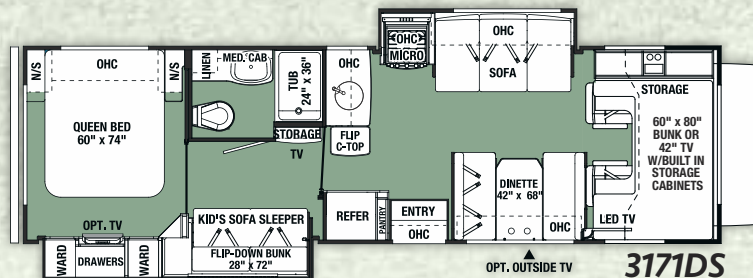

3171DS

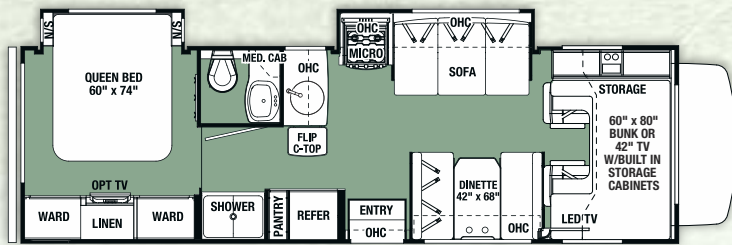

2861DS

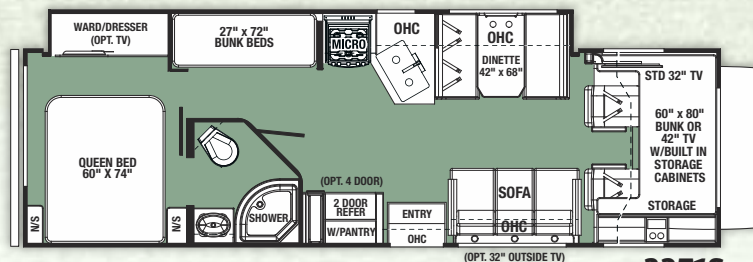

3271S

OPTIONS

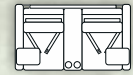

OPT. RECLINERS

3011DS



4-DOOR
REFER

OPT. SIDE-BY-SIDE
REFER

2861DS,

3011DS,

3051S

| Forester Ford • Chevy Chassis | 2291 | 2301 | 2501 | 2861 | 3011 | 3051 | 3171 | 3271 |
|-------------------------------|---------------------|---------------------|---------------------|---------------------|---------------|---------------|---------------|------------|
| Wheelbase | 158" • 159" | 158" • 159" | 182" • 183" | 202" • 203" | 220" • NA | 220" • NA | 220" • NA | 220" • NA |
| GVWR | 12500 • 14200 | 12500 • 14200 | 14500 • 14200 | 14500 • 14200 | 14500 • NA | 14500 • NA | 14500 • NA | 14500 • NA |
| GAWRR | 8500 • 9600 | 8500 • 9600 | 9600 • 9600 | 9600 • 9600 | 9600 • NA | 9600 • NA | 9600 • NA | 9600 • NA |
| GAWRF | 4600 • 4600 | 4600 • 4600 | 5000 • 4600 | 5000 • 4600 | 5000 • NA | 5000 • NA | 5000 • NA | 5000 • NA |
| UVW | 0 • 10452 | 9950 • 9890 | 11721 • 11500 | 12300 • 12400 | 12400 • NA | 12848 • NA | 12500 • NA | TBD |
| GCWR | 18500 • 20000 | 18500 • 20000 | 22000 • 20000 | 22000 • 20000 | 22000 • NA | 22000 • NA | 22000 • NA | TBD |
| CCC | 2500 • 3748 | 2550 • 4310 | 2779 • 2700 | 2200 • 1800 | 2100 • NA | 1652 • NA | 2000 • NA | TBD |
| Fuel Capacity (Gal.) | 55 • 57 | 55 • 57 | 55 • 57 | 55 • 57 | 55 • NA | 55 • NA | 55 • NA | TBD |
| Hitch Rating | 5000/500 • 5000/500 | 5000/500 • 5000/500 | 7500/500 • 5000/500 | 7500/500 • 5000/500 | 7500/500 • NA | 7500/500 • NA | 7500/500 • NA | TBD |
| Length - Bumper To Bumper | 24'-6" • 25' | 24'-6" • 25' | 26'-11" • 27'-5" | 30'-9" • 31'-3" | 32'-3" • NA | 31'-11" • NA | 32'-3" • NA | TBD |
| Exterior Height With A/C | 11'-3" | 11'-3" | 11'-3" | 11'-3" | 11'-3" | 11'-3" | 11'-3" | 11'-3" |
| Exterior Width | 101" | 101" | 101" | 101" | 101" | 101" | 101" | 101" |
| Interior Width | 95.5" | 95.5" | 95.5" | 95.5" | 95.5" | 95.5" | 95.5" | 95.5" |
| Interior Height Frt/Rear | 84"/77" | 84"/77" | 84"/77" | 84"/77" | 84"/77" | 84"/77" | 84"/77" | 84"/77" |
| Fresh/Grey/Black Water (Gal.) | 44/39/39 | 44/39/39 | 44/39/39 | 44/39/39 | 44/39/39 | 44/39/39 | 44/39/39 | 44/39/39 |
| L.P. Capacity (Gal.) | 9.8 | 9.8 | 9.8 | 9.8 | 9.8 | 9.8 | 9.8 | 9.8 |
| Awning Length | 15'-6" | 15'-6" | 18' | 16' | 15'-6" | 18' | 11' | TBD |
| Water Heater (Gal.) | 6 | 6 | 6 | 6 | 6 | 6 | 6 | 6 |
| Exterior Storage (Cu. Ft.) | 61 | 61 | 50 | 62.5 | 101.7 | 81.8 | 80 | TBD |

GVWR (Gross Vehicle Weight Rating) - is the maximum permissible weight of the unit when fully loaded. It includes all weights, inclusive of all fluids, occupants, cargo, optional equipment and accessories. For safety and product performance do NOT exceed the GVWR.

GCWR (Gross Combined Weight Rating) - is the maximum permissible loaded weight of your motor home and any towed trailer or towed vehicle. Actual GCWR of this vehicle may be limited by the sum of the GVWR and the installed hitch receiver maximum capacity rating; see hitch rating label for detail.

GAWR (Gross Axle Weight Rating) - is the maximum permissible weight, including cargo, fluids, optional equipment and accessories that can be safely supported by each axle.

UVW (Unloaded Vehicle Weight)* - is the typical weight of the unit as manufactured at the factory. It includes all weight at the unit's axle(s), including full fuel, all fluids and LP Gas. The UVW does not include cargo, fresh potable water, additional optional equipment or dealer installed accessories.

CCC (Cargo Carrying Capacity)** - is the amount of weight available for fresh potable water, cargo, passengers, additional optional equipment and accessories. CCC is equal to GVWR minus UVW. Available CCC should accommodate fresh potable water (8.3 lbs. per gallon). Before filling the fresh water tank, empty the black and gray tanks to provide for more cargo capacity.

*Estimated Average based on standard build optional equipment. ** Estimated average based on standard build optional equipment.

Each Forest River RV is weighed at the manufacturing facility prior to shipping. A label identifying the unloaded vehicle weight of the actual unit and the cargo carrying capacity is applied to every Forest River RV prior to leaving our facilities. The load capacity of your unit is designated by weight, not by volume, so you cannot necessarily use all available space when loading your unit. Actual towing capacity is dependent upon your particular loading and towing circumstances, which includes the GVWR, GAWR and GCWR as well as adequate trailer brakes. Please refer to the Operator's Manual of your vehicle for further towing information.

PAINT OPTIONS



MOCHA Full body paint



COBALT Full body paint



STANDARD Exterior

FORESTER

BY FOREST RIVER

HIGH QUALITY CONSTRUCTION

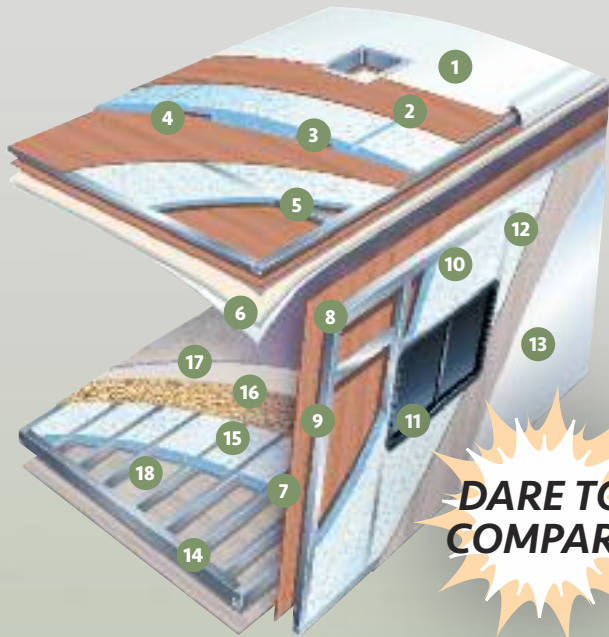

DARE TO COMPARE

Multi-Layered Laminated Roof System

1. Crowned Fiberglass Roof
2. Luan Decking
3. Block Foam Insulation
4. A/C Ducts
5. Tubular Aluminum Framing
6. Interior Ceiling Material

Vacuum-Bond Laminated Sidewalls

7. Decorative Interior Wall Board
8. Tubular Aluminum Framing
9. EGS Metal Backers
10. Block Foam Insulation
11. Opening Framed In Aluminum
12. Superlite Composite - Azdel
13. Gelcoat Fiberglass Exterior

Vacuum-Bond Laminated Floor System

14. Fiberglass Bottom Board
15. Block Foam Insulation
16. Seamless Floor Decking
17. Beauflor Flooring (In Some Areas)
18. Aluminum Framing



LARGE WINDOWS WITH BLACK-OUT ROLLER SHADES
Large panoramic windows for plenty of fresh air and natural light.



LED LIGHTING
LED lights generate almost no heat compared to incandescent lights and use substantially less power.



RESIDENTIAL STYLE CABINETRY
Forester is appointed with ball bearing drawer glides and rich hardwood cabinetry.



USB CHARGING STATION
12V 4-port USB charging station (Living room/bedroom)



FULLY DUCTED AIR
All floorplans are ducted for better air flow throughout the coach and front cabover.



ENCLOSED BATTERIES
Two batteries in a single housing for easy access. (One battery LE and Transit)



MEMORY FOAM
Memory foam mattress will ensure a good nights sleep.



HEATED AND ENCLOSED HOLDING TANKS
The Forester features a heated and enclosed utility station. Your tanks and valves are protected using warm air from the furnace. (N/A 2250 SLE, MBS and Transit Series)



KING JACK ANTENNA
This HD digitally amplified antenna enhances reception.



FIBERGLASS ROOF
Durable, easy to clean (R-18) crowned fiberglass sheds water and doesn't cause black streaks like a rubber roof.

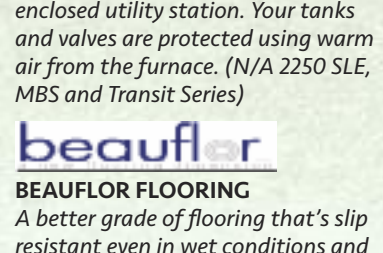

BEAUFLOR FLOORING
A better grade of flooring that's slip resistant even in wet conditions and highly resistant to tears. Unlike vinyl floors with paper backing, our backing remains stable in extreme hot or cold and is backed by a seven-year cold crack warranty.



WATER FILTRATION
This compact unit filters water for the entire coach, eliminating those unwanted contaminants and odors, ensuring safe drinking water for you and your family. (N/A LE Series)



SEAMLESS FRONT CAP
For enhanced aerodynamics



WASTE MASTER SEWAGE MANAGEMENT SYSTEM
Rugged for quick, easy and sanitary disposal of waste. (N/A LE and Transit)



SOLAR PREP



OUTSIDE SPEAKERS



WHOLE HOUSE ENTERTAINMENT
This multimedia system features AM/FM/DVD, Bluetooth, plus outside speaker control.



INTEGRATED STEP
Forester's entry step is integrated into the sidewall. No more slippery, or damaged power steps.



OPTIONAL CAB OVER BUNK SAFETY NET
The overhead bunk is rated for 500 lbs.



POWER AWNING WITH LED STRIP
Extend and retract your awning with the push of a button. Both arms are adjustable to get just the right angle.



Pioneer IN-DASH STEREO SYSTEM
Pairs up with your smart phone to access GPS and other applications. (N/A on Transit or LE Series)



WINTERIZING TUBE
Easy access for quick maintenance includes bypass valve.



MAXX AIR FAN
Recirculates air throughout the entire coach.



7,500 LB. TOW CAPACITY
Ford E450 only (N/A on LE Series)

CHARGE WIZARD

Progressive Dynamics patented 4-stage Charge Wizard® converter system can increase battery life by 2 to 3 times or more. It constantly monitors voltage and usage then selects one of four operating modes to properly charge and maintain the battery. Boost, Normal, Storage and Equalization.



ATWOOD WATER HEATER



ATWOOD WATER HEATER
Atwood 18 GPH water heaters (6 gallon tank) out perform traditional 10 and 12 gallon tank water heaters. They're also 50% lighter and have no anode rod to replace.

TRADITIONAL WATER HEATER



FIRESTONE RIDE-RITE

Adjustable air springs provide an improved ride and a better way to balance loads. (N/A LE or MBS Series)



360 siphon
RV VENT CAP

This holding tank vent cap eliminates odors and gases from the holding tanks and exhausts them out the roof, without the use of costly chemicals.



FORESTER VS. THE COMPETITION



FORESTER
2" Wall with Block Foam and Superlite (R-10)



SUPER LITE WALLS
All models use SuperLite composite instead of a wood substrate on the sidewalls. It is lightweight, formaldehyde free and is not affected by moisture.



COMPETITION
1.5" Wall with Luan (R-6)



LE Series shown in Chestnut decor. Only available with Weathered Teak cabinetry.

| Ford • Chevy | 2251SLE | 2851SLE | 3251DSLE |
|------------------------------|------------------|-------------|---------------|
| Wheelbase | 158" • 159" | 220" • NA | 220" • NA |
| GVWR | 14200 | 14500 | 14500 • NA |
| GAWRR | 9600 | 9600 | 9600 • NA |
| GAWRF | 4600 | 5000 | 5000 • NA |
| UVW | 9660 • 9640 | 11742 • NA | 12500 • NA |
| GCWR | 20000 | 22000 | 22000 • NA |
| CCC | 2840 • 4560 | 2758 • NA | 2000 • NA |
| Fuel Capacity (Gal) | 55 • 57 | 55 | 55 • NA |
| Hitch Rating | 5000/500 | 7500/500 | 7500/500 • NA |
| Length - Bumper To Bumper | 23'-10" • 24'-4" | 31'-5" • NA | 32'-3" • NA |
| Exterior Height With A/C | 11'-3" | 11'-3" | 11'-3" |
| Exterior Width | 101" | 101" | 101" |
| Interior Width | 95.5" | 95.5" | 95.5" |
| Interior Height Frt/Rear | 84"/77" | 84"/77" | 84"/77" |
| Fresh/Grey/Black Water (Gal) | 33.5/32/27 | 44/39/39 | 44/39/39 |
| L.P. Capacity (Gal) | 9.8 | 9.8 | 9.8 |
| Awning Length | 14' | 15'-6" | 11' |
| Water Heater (Gal) | 6 | 6 | 6 |
| Exterior Storage (Cu. Ft.) | 32 | 32 | 80 |

Forester LE Series is the industry's best value on the market today! Enjoy years of carefree travel with these well-built Class Cs.

LE SERIES

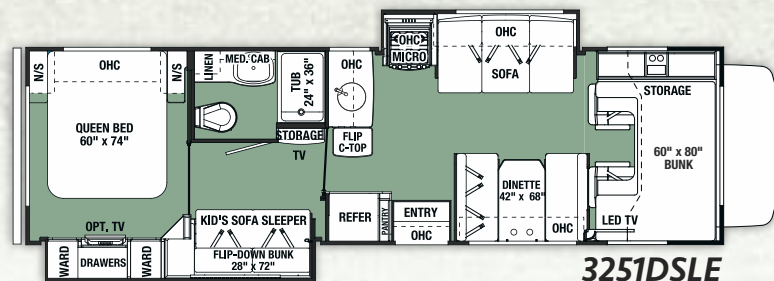
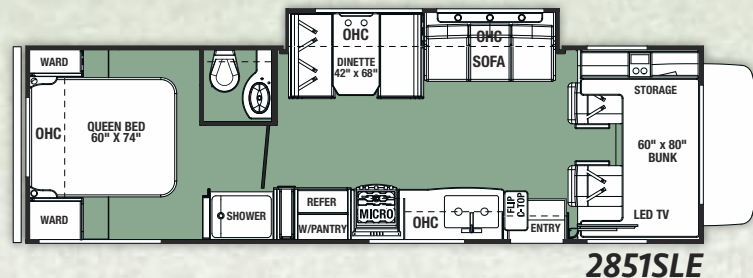
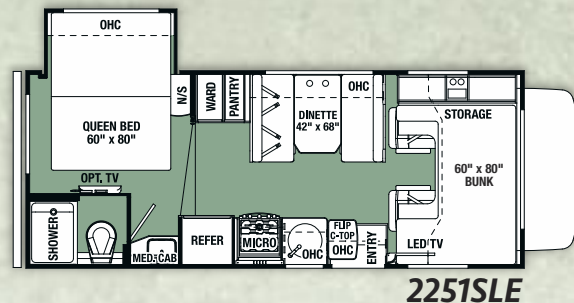



Shown in Almond Decor with Rustic Cherry cabinetry.



GRAND TOURING SERIES

The streamlined GTS is the perfect vehicle for the ultimate getaway.

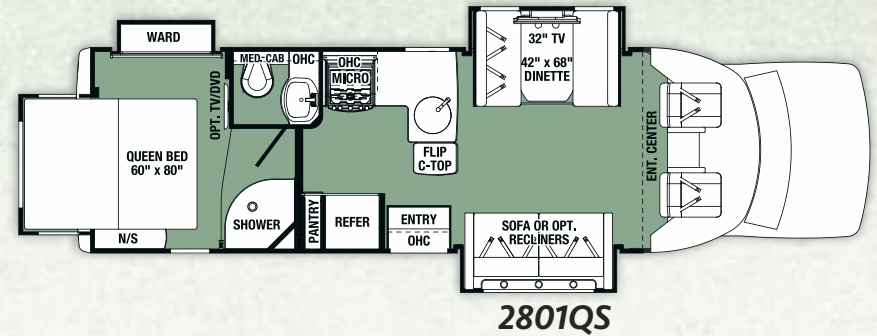
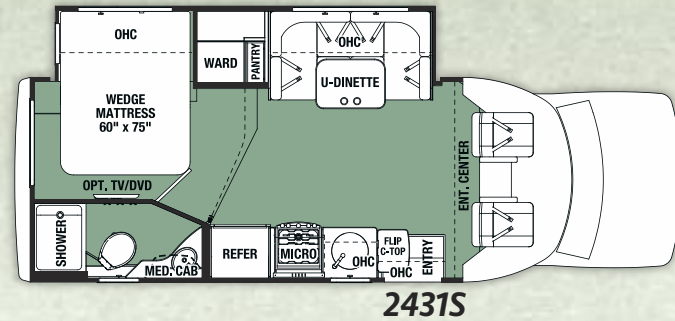

OPTIONS

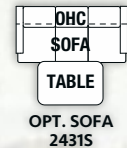

| Forester GTS | 2431 | 2801 |
|----------------------------|-----------|-----------|
| Wheelbase | 176" | 212" |
| GVWR | 14500 | 14500 |
| GAWRR | 9600 | 9600 |
| GAWRF | 5000 | 5000 |
| UVW | 10920 | 11596 |
| GCWR | 22000 | 22000 |
| CCC | 3580 | 2904 |
| Fuel Capacity (Gal) | 55 | 55 |
| Hitch Rating | 7500/500 | 7500/500 |
| Length - Bumper to Bumper | 25'-9" | 30'-4" |
| Exterior Height with A/C | 10'-8" | 10'-8" |
| Exterior Width | 97" | 97" |
| Interior Width | 91" | 91" |
| Interior Height Front/Rear | 81"/75.5" | 81"/75.5" |
| Fresh Water (Gal) | 42/39/39 | 43/42/28 |
| L.P. Capacity (Gal) | 9.8 | 9.8 |
| Awning Length | 15'-6" | 18' |
| Water Heater (Gal) | 6 | 6 |
| Exterior Storage (Cu. Ft.) | 37.8 | 73 |





MBS MERCEDES-BENZ® SERIES

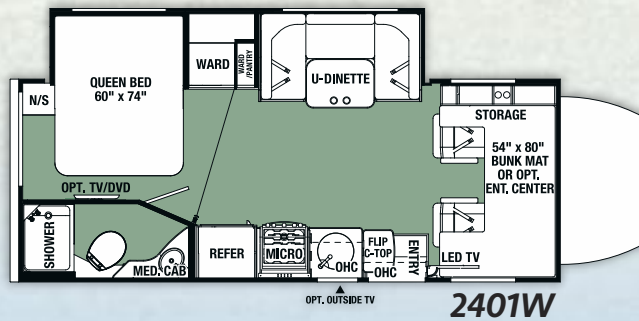
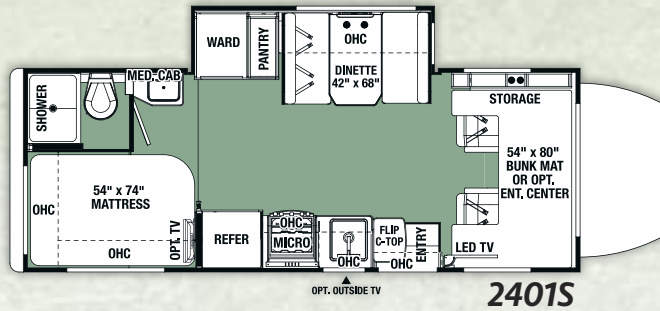
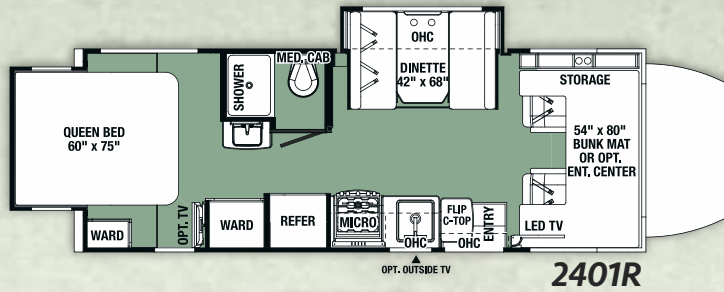

OPTIONS

MBS

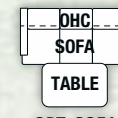
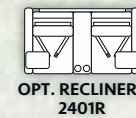

BlueTec Diesel Engine

BlueTec SCR Technology is one of the world's cleanest diesel engines, delivering more power, while producing fewer emissions. The 3.0l V-6 engine boasts 188 hp and 325 lb-ft of rated torque.

| Forester MBS | 2401R | 2401S | 2401W |
|------------------------------|----------|----------|----------|
| Wheelbase | 170.3 | 170.3 | 170.3 |
| GVWR | 11030 | 11030 | 11030 |
| GAWRR | 7720 | 7720 | 7720 |
| GAWRF | 4080 | 4080 | 4080 |
| UVW | 9852 | 9700 | 9924 |
| GCWR | 15250 | 15250 | 15250 |
| CCC | 1178 | 1330 | 1106 |
| Fuel Capacity (Gal) | 26.4 | 26.4 | 26.4 |
| Hitch Rating | 4200/350 | 4200/350 | 4200/350 |
| Length - Bumper To Bumper | 24'-11" | 24'-8" | 24'-11" |
| Exterior Height With A/C | 11'-3" | 11'-3" | 11'-3" |
| Exterior Width | 94.5" | 94.5" | 94.5" |
| Interior Width | 91" | 91" | 91" |
| Interior Height Frt/Rear | 81"/74" | 81"/74" | 81" |
| Fresh/Grey/Black Water (Gal) | 35/30/30 | 35/33/33 | 35/32/32 |
| L.P. Capacity (Gal) | 16.4 | 16.4 | 16.4 |
| Awning Length | 16' | 15'-6" | 16' |
| Water Heater (Gal) | 6 | 6 | 6 |
| Exterior Storage (Cu. Ft.) | 75 | 67 | 50.3 |

Shown with low profile Trekker cap option for aerodynamic styling and improved fuel economy. Seamless front cap is accented with LED light strips.





Shown in Charcoal Decor

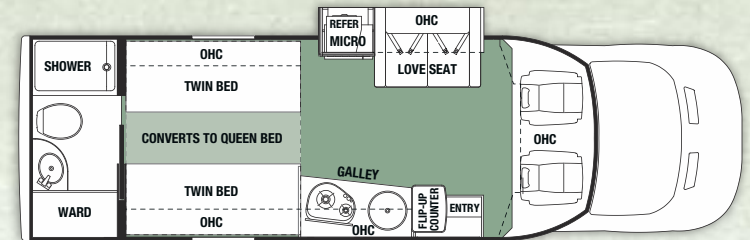

TS2371

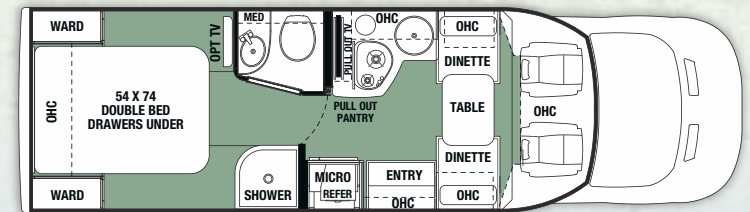

TS2391

| Forester TS | 2371 | 2391 |
|-------------------------------|----------|----------|
| Wheelbase | 178" | 178" |
| GVWR | 10360 | 10360 |
| UVW | 8706 | 8050 |
| GCWR | 13500 | 13500 |
| CCC | 1654 | 2310 |
| Fuel Capacity (Gal.) | 25 | 25 |
| Hitch Rating (Lb.) | 2,000 | 2,000 |
| Length - Bumper to Bumper | 25' - 6" | 25' - 6" |
| Exterior Height with A/C | 10' - 3" | 10' - 3" |
| Exterior Width | 87" | 87" |
| Interior Width | 84" | 84" |
| Interior Height Front/Rear | 78" | 78" |
| Fresh/Grey/Black Water (Gal.) | 35/29/29 | 35/29/29 |
| L.P. Capacity (Gal.) | 9.8 | 9.8 |
| Awning Length | 15' | 15' |
| Exterior Storage (Cu. Ft.) | 38 | 38 |
| Seat Belts | 4 | 4 |



TRANSIT SERIES

Ultra-Light Weight Maneuverability with Exceptional Fuel Efficiency

The ultra-light Forester TS is engineered for fuel efficiency with eco-friendly building materials. These lightweight, Poplar cabinets are certified to be sustainably sourced from European forests.

DECOR

CHARCOAL

Transit Series is available in Charcoal decor only.



| WARRANTY | FR | GTS | MBS | LE | TS |
|---|----|-----|-----|----|----|
| 12 Months/12,000 mile basic limited warranty | S | S | S | S | S |
| Chassis warranty (see owners manual) | | | | | |
| SYSTEMS | FR | GTS | MBS | LE | TS |
| Battery disconnect | S | S | S | S | S |
| Water heater bypass | S | S | S | S | S |
| (2) Deep cycle coach batteries (1 battery in LE and TS) | S | S | S | S | S |
| "Easy Access" battery in step-well | S | S | S | S | S |
| 30 Amp service with detachable cord | S | S | S | S | S |
| 60 Amp Progressive Dynamics converter | S | S | S | S | S |
| 6 Gallon DSI gas/electric water heater | S | S | S | S | - |
| 30,000 BTU furnace | S | S | S | S | - |
| Truma Combi water heater/furnace | - | - | - | - | S |
| Emergency start switch | S | S | - | S | S |
| Satellite/cable connection | S | S | S | S | S |
| 13,500 BTU ceiling ducted roof air | S | S | S | S | S |
| 4.0 KW Onan Microquiet generator | S | S | - | S | - |
| 3.6 KW Onan LP generator | - | - | S | - | - |
| 2.5 KW Onan LP generator | - | - | - | - | S |
| Automatic generator transfer switch | S | S | S | - | S |
| Firestone Ride-Rite air helper springs | S | S | - | - | - |
| Hellwig sway bar | - | - | S | - | - |
| Water filtration system | S | S | S | - | S |
| Heated, enclosed holding tanks and valves | S | S | - | - | - |
| Arctic Package (12V tank heaters) | O | O | S | O | O |
| 15K BTU A/C with heat pump | O | O | O | - | O |
| CO ₂ , LP and smoke detector | S | S | S | S | S |
| Jack digital antenna | S | S | S | S | S |
| EXTERIOR | FR | GTS | MBS | LE | TS |
| 2" Aluminum framed laminated sidewalls | S | S | - | S | - |
| 1.5" Aluminum framed laminated sidewalls | - | - | S | - | S |
| Azdel Superlight composite substrate | S | S | S | - | - |
| Gel Coat exterior fiberglass | S | S | S | S | S |
| Block foam insulation | S | S | S | S | S |
| Power patio awning with LED light strip | S | S | S | S | S |
| Slide-out awnings | S | S | S | - | - |
| Fiberglass roof | S | S | S | S | S |
| One-piece fiberglass front cap | S | S | S | S | S |
| LED exterior lights | S | S | S | S | S |
| Exterior skirt paint | S | S | S | - | S |
| Stainless steel wheel liners | S | S | S | S | S |
| Valve stem extensions | S | S | S | - | - |
| Roto-cast storage compartments | S | S | S | S | S |
| Driver side security light | S | S | S | - | - |
| Fiberglass running boards | S | S | S | - | S |
| 110V, GFI protected exterior receptacle | S | S | S | S | S |
| Tinted sliding windows | S | - | - | S | - |
| Tinted frameless windows | - | S | S | - | S |
| Heated, remote exterior mirrors | S | S | - | - | - |
| 7,500 Lbs. hitch, 7-pin connector (E450) | S | S | - | S | - |
| 5,000 Lbs. hitch, 7-pin connector (Chevy/E350) | S | S | - | S | - |
| 4,200 Lbs. hitch, 7-pin connector | - | - | S | - | - |
| Spare tire | S | S | S | S | S |
| Roof ladder (N/A 2401R, 2801QS) | S | - | S | S | - |
| Integrated entry step | S | S | - | S | S |
| Power entry step | - | - | S | - | - |
| Outside shower | S | S | S | - | S |
| Automatic leveling system (4-point) | O | O | - | O | - |
| Stabilizer jacks (2-point) | - | - | O | - | - |
| Full body paint | O | O | O | - | O |

| | FR | GTS | MBS | LE | TS |
|--|----|-----|-----|----|----|
| 32" Outside 12V TV (2701DS, 3011DS, 3051S, 3171DS only) | O | - | - | - | - |
| 19" Outside TV | - | - | O | - | - |
| Exterior grill with quick connect (standard 2861DS) | O | O | O | - | - |
| Black tank flush | S | S | S | - | S |
| CAB AREA | FR | GTS | MBS | LE | TS |
| 7" Touch screen radio with USB and Bluetooth | S | S | S | S | - |
| Cab area privacy curtain | S | S | S | S | S |
| Ultra leather driver and passenger seats | S | S | S | - | S |
| Power windows and door locks | S | S | S | S | S |
| Keyless entry (N/A Chevy) | S | S | S | S | S |
| Color back-up camera with rear view monitor | S | S | S | S | S |
| Side view cameras | S | S | S | - | S |
| Wood grain dash | S | S | S | - | - |
| Removable cab mat | - | - | S | - | - |
| Swivel driver seat (N/A Chevy, Power) | O | O | S | - | - |
| Power driver seat (Ford only) | O | O | - | - | - |
| Swivel passenger seat (N/A Chevy) | O | O | S | - | - |
| KITCHEN | FR | GTS | MBS | LE | TS |
| Recessed 3-burner range with flush glass cover | S | S | S | S | - |
| Stainless steel appliances | S | S | S | - | - |
| Range hood with fan and light | S | S | S | S | - |
| Oven IPO drawer | S | O | O | S | - |
| Microwave oven | S | - | - | S | - |
| Convection microwave (Standard in 3051S) | O | S | S | - | S |
| 6 Cu. ft. double door refrigerator | S | S | S | S | - |
| 12 Cu. ft. four door refrigerator with ice maker (2861DS, 3011DS, 3051S) | O | - | - | - | - |
| 5.3 Cu. ft. lightweight LP/Electric 110V refrigerator | - | - | - | - | S |
| Full extension ball bearing drawer guides | S | S | S | S | - |
| Flip-up countertop extension | S | S | S | S | - |
| Solid surface galley | S | S | S | - | - |
| BATHROOM | FR | GTS | MBS | LE | TS |
| Lightweight composite toilet with hand sprayer | S | S | S | S | S |
| Glass shower door | S | S | - | - | - |
| Lightweight Arcadia shower door | - | - | S | S | S |
| Towel bar, tissue, toothbrush and soap holder | S | S | S | S | S |
| Electric roof fan | S | S | S | S | S |
| Shower head with flexible extension | S | S | S | S | S |
| Shower skylight | S | S | S | S | S |
| BEDROOM | FR | GTS | MBS | LE | TS |
| Upgraded memory foam mattress | S | S | S | S | S |
| Bedsprad | S | S | S | S | S |
| Bedroom TV with DVD | O | O | O | - | O |
| Cedar lined closet | S | S | S | - | - |
| LIVING ROOM | FR | GTS | MBS | LE | TS |
| Dream dinette (N/A with U-shape dinettes) | S | S | S | - | - |
| Visionary pull out sofa (60" x 74") (3011DS) | S | - | - | - | - |
| 12V LED Flat panel adjustable side TV | S | S | S | S | S |
| Cab over cabinets with 42" TV (IPO side TV) | O | - | - | - | - |
| Black-out roller shades | S | S | S | S | - |
| Surround sound | S | S | S | S | - |
| Child seat head tethers in dinette | S | S | S | - | - |
| Maxx Air fan with rain/temp sensor and power dome | S | S | S | - | - |
| Dual recliners IPO Sofa (3011DS, 2801QS) | O | O | - | - | - |
| LED floor lighting | S | S | S | - | - |
| 12V USB charging station | S | S | S | - | S |

For more information please visit: www.forestriverinc.com/forester

914 CR 1 • Elkhart, In 46514
574.262.2212 • 800.445.2825



PRE-DELIVERY INSPECTION FACILITY

20,000 square feet of quality assurance. The bare essentials for a premium product. This state-of-the-art facility gives immediate daily feedback to production for quality assurance in every unit built.



Forest River, Inc. encourages our customers to purchase their Forest River products from a local dealership whenever possible for the following reasons:

- 1) Forest River, Inc. dealers are independently owned and operated businesses so priority service and scheduling is at their discretion and is often provided to customers that purchased their unit at that dealership.
- 2) Purchasing locally allows customers to establish meaningful relationships with a dealer, enhancing the RV experience through assistance with product questions, user tips or RV regulations for your state or country, and much more!
- 3) Canadian customers must meet requirements to bring an RV purchased out of the country to their home. These requirements may involve additional inspections and certifications, taxes and fees. Your local Canadian Dealer is a professional at meeting these requirements.
- 4) Scheduling timely warranty repairs and adjustments through a local dealership provides far greater flexibility and convenience to you, the customer!

It is the goal of Forest River, Inc. that all of our RV owners fully enjoy the RV experience and that customer satisfaction meets or exceeds their expectations!

24/7 EMERGENCY ROADSIDE ASSISTANCE

For a worry-free ownership experience Forest River includes one year of Coach-Net RV Technical & Roadside Assistance with each RV purchase. Whether new to the RV lifestyle or an experienced RV enthusiast, Forest River owners have 24/7 access to technical, operational and emergency road service coverage throughout the US & Canada. Coach-Net's fast, dependable service is just a phone call away.



Learn More
Scan this barcode using a QR Reader on your smart phone to learn more about Forest River.



A Berkshire Hathaway company.

All information contained in this brochure is believed to be accurate at the time of publication. However, during the model year, it may be necessary to make revisions and Forest River, Inc., reserves the right to make all such changes without notice, including prices, colors, materials, equipment and specifications as well as the addition of new models and the discontinuance of models shown in this brochure. Therefore, please consult with your Forest River dealer and confirm the existence of any materials, design or specifications that are material to your purchase decision ©2016 Forester - a Division of Forest River, Inc. - a Berkshire Hathaway Company 1/17

Your Local Forester Dealer