

TRAVEL TRAILER • FIFTH WHEEL

TOY HAULERS



Octane
SL by Jayco



TALON



SEISMIC

2+3
YEAR YEAR
LIMITED STRUCTURAL
WARRANTY

OCTANE SL



293 shown in Carbon interior design



HappiJac[®] shown in double bunk position



HappiJac[®] shown in seating position

161

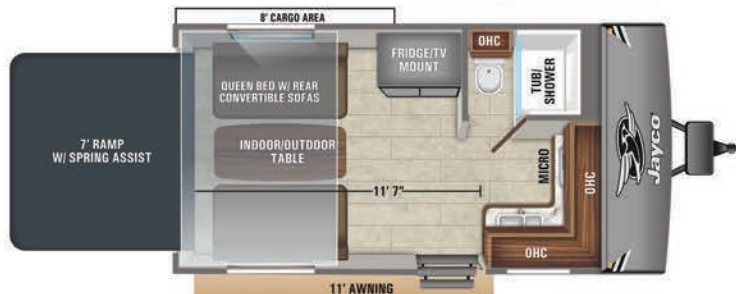

273

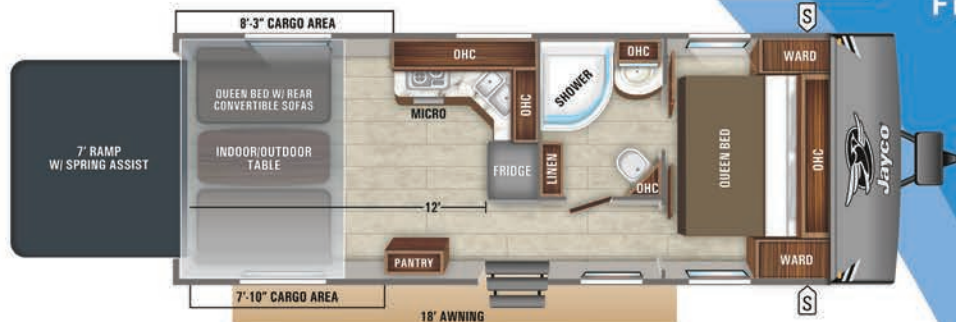

222

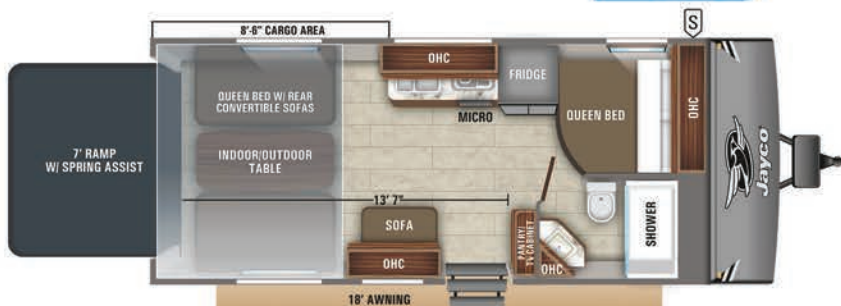

293

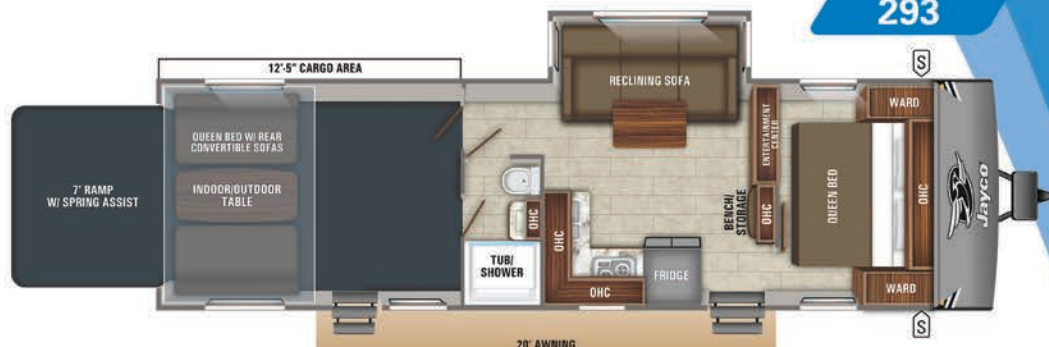

LEGEND

- STORAGE
- MICROWAVE
- OVERHEAD CABINETS
- REFRIGERATOR
- WARDROBE

INTERIOR DESIGN

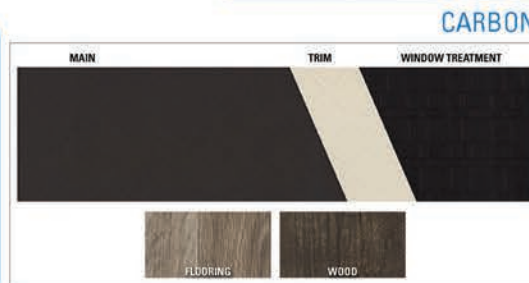

SPECS

FLOORPLAN	EXTERIOR TRAVEL LENGTH	EXTERIOR HEIGHT (WITH A/C)	INTERIOR HEIGHT	UNLOADED VEHICLE WEIGHT	DRY HITCH WEIGHT	GVWR	CARGO CARRYING CAPACITY	FRESH WATER CAPACITY (INCLUDING WATER HEATER)	GRAY WASTE WATER CAPACITY	BLACK WASTE WATER CAPACITY	SLEEPING CAPACITY
161	20' 8"	11' 4"	7' 5"	4,570	650	7,500	2,930	59	28	45	4
222	26' 5"	11' 5"	7' 5"	5,560	790	8,000	2,440	59	45	45	6
273	31' 0"	11' 5"	7' 5"	6,775	1,185	9,950	3,175	59	45	45	6
293	37' 11"	11' 8"	7' 5"	8,310	1,315	11,700	3,390	59	45	45	7-8

Some specs at the time of print may include estimates. For the most accurate information, please visit Jayco.com

Unloaded Vehicle Weight (UVW): Sometimes referred to as "Dry Weight," UVW means the typical weight of the trailer as built at the factory. The UVW, as used in product literature and other promotional materials, does not include cargo, fresh water, propane, options or dealer-installed accessories.

Gross Vehicle Weight Rating (GVWR): GVWR means the maximum permissible weight of the trailer, including the UVW plus personal items, all cargo, fluids, options and dealer-installed accessories. The GVWR is equal to or greater than the sum of the UVW and the CCC.

Cargo Carrying Capacity (CCC): CCC means the maximum weight of personal items, food, fresh water, propane, tools, other cargo and dealer-installed accessories that can be carried by the trailer. CCC is equal to or less than GVWR minus UVW. The addition of options will decrease the CCC.

Hitch Weight (HW): The hitch weight, as used in product literature and other promotional materials, does not include cargo, fresh water, propane gas, options or dealer-installed accessories. The addition of these types of items will either add to or subtract from the stated hitch weight.

It is important for your safety and enjoyment that your tow vehicle be adequately sized and equipped to tow and handle the GVWR of the RV you select. Review weights and rating of your tow vehicle and consult a competent advisor for questions or advice. Whether you are new to RVing or a veteran, get a feel for the performance of your tow vehicle before heading out on the roadways. When you tow an RV, you must drive differently than when you drive a single vehicle. Practice hooking up, driving, backing up and braking in a safe environment or seek out professional instruction. Jayco affixes a weight label to each RV which lists estimated weight information for that vehicle. See specifications chart above.

TALON



403T shown in Modern Farmhouse interior design



405T



405T shown in Vintage Wash Grey interior design



Garage with HappiJac beds

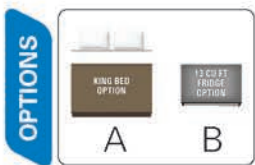

INTERIOR OPTIONS

MODERN FARMHOUSE

VINTAGE WASH GREY

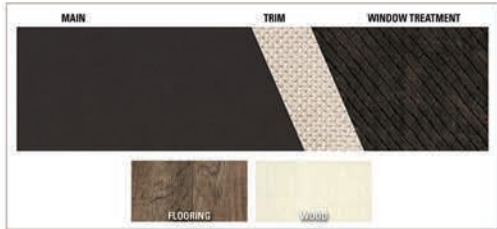

FLOORPLAN	EXTERIOR TRAVELW LENGTH	EXTERIOR HEIGHT (WITH A/C)	INTERIOR HEIGHT	INTERIOR HEIGHT (BEDROOM)	UNLOADED VEHICLE WEIGHT	DRY HITCH WEIGHT	GVWR	CARGO CARRYING CAPACITY	FRESH WATER CAPACITY (INCLUDING WATER HEATER)	GRAY WASTE WATER CAPACITY	BLACK WASTE WATER CAPACITY	SLEEPING CAPACITY
335T	38' 0"	13' 5"	8' 3"	6' 4"	11,170	2,365	16,000	4,830	166	87**	50	6-7
385T	41' 5"	13' 5"	8' 3"	6' 4"	12,000	2,710	16,900	4,900	166	87**	50	7-8
403T	41' 5"	13' 5"	8' 3"	6' 4"	12,425	2,985	16,500	4,075	166	87**	50	8-10
405T	41' 6"	13' 5"	8' 3"	6' 4"	13,070	2,805	16,999	3,929	166	87**	50	8-10

Some specs at the time of print may include estimates. For the most accurate information, please visit Jayco.com

**Split Tanks

Unloaded Vehicle Weight (UVW): Sometimes referred to as "Dry Weight," UVW means the typical weight of the trailer as built at the factory. The UVW, as used in product literature and other promotional materials, does not include cargo, fresh water, propane, options or dealer-installed accessories.

Gross Vehicle Weight Rating (GVWR): GVWR means the maximum permissible weight of the trailer, including the UVW plus personal items, all cargo, fluids, options and dealer-installed accessories. The GVWR is equal to or greater than the sum of the UVW and the CCC.

Cargo Carrying Capacity (CCC): CCC means the maximum weight of personal items, food, fresh water, propane, tools, other cargo and dealer-installed accessories that can be carried by the trailer. CCC is equal to or less than GVWR minus UVW. The addition of options will decrease the CCC.

Hitch Weight (HW): The hitch weight, as used in product literature and other promotional materials, does not include cargo, fresh water, propane gas, options or dealer-installed accessories. The addition of these types of items will either add to or subtract from the stated hitch weight.

It is important for your safety and enjoyment that your tow vehicle be adequately sized and equipped to tow and handle the GVWR of the RV you select. Review weights and rating of your tow vehicle and consult a competent advisor for questions or advice. Whether you are new to RVing or a veteran, get a feel for the performance of your tow vehicle before heading out on the roadways. When you tow an RV, you must drive differently than when you drive a single vehicle. Practice hooking up, driving, backing up and braking in a safe environment or seek out professional instruction. Jayco affixes a weight label to each RV which lists estimated weight information for that vehicle. See specifications chart above.

SEISMIC

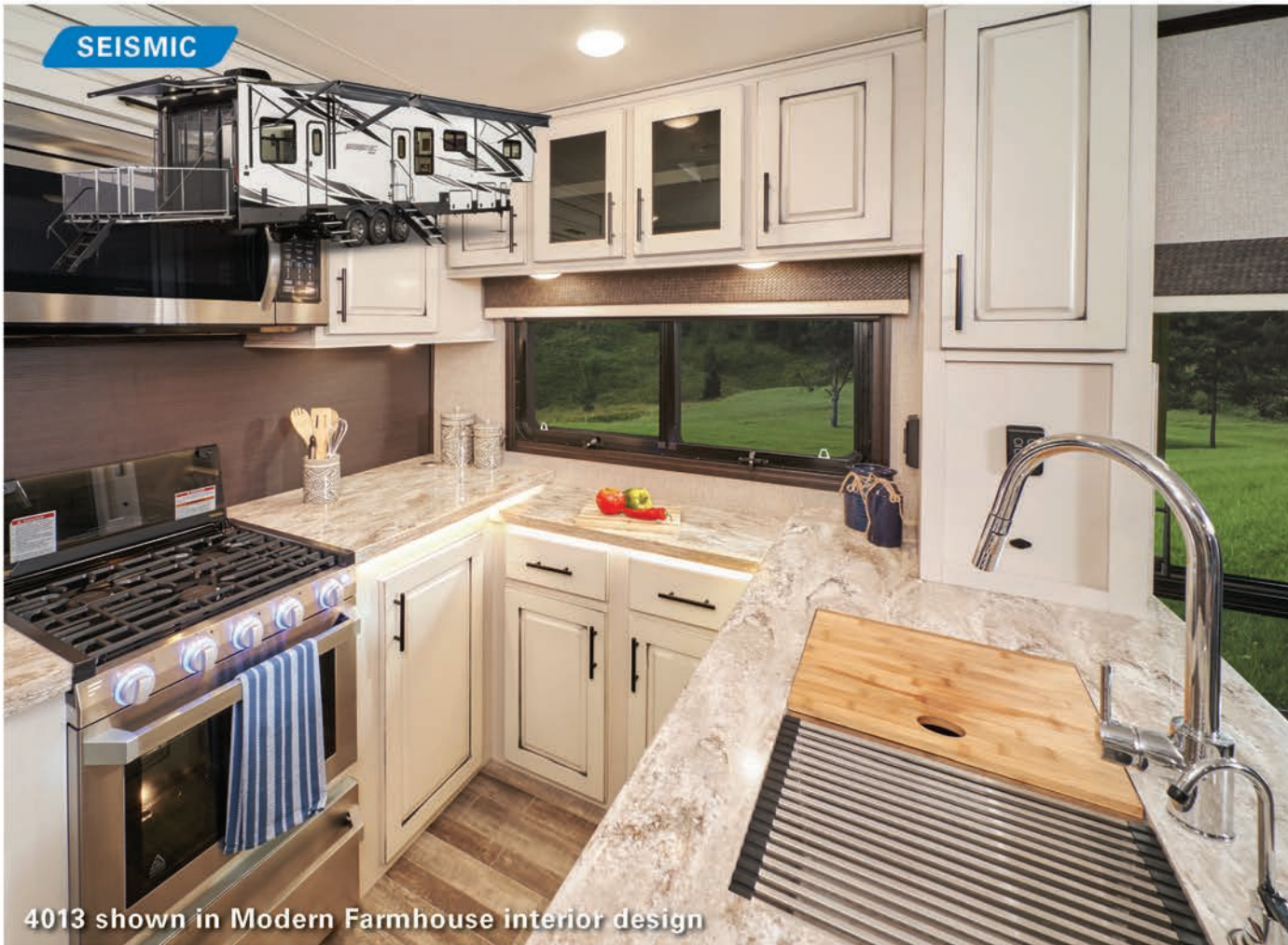

4013 shown in Modern Farmhouse interior design



Industry-first walk-in shower (N/A 3512 & 3815)



Seismic 4013



3815 shown in Cashmere Cottage interior design

3512



3815

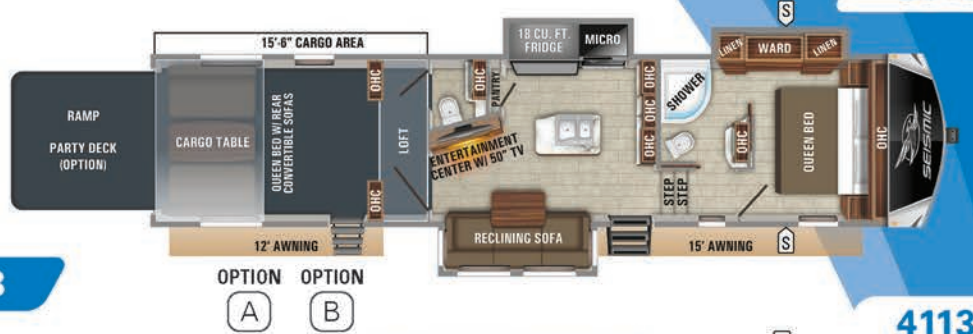

4013



4113



4212

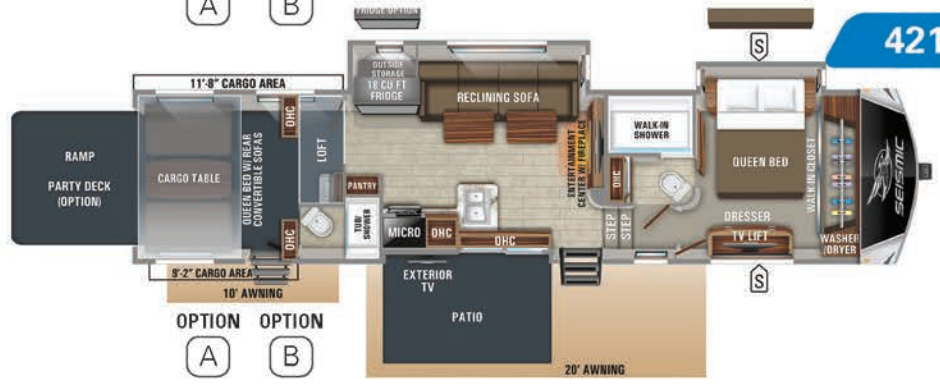

4125



SEISMIC FULL-BODY PAINT OPTIONS



METALLIC ICE

VELOCITY BLUE

LEGEND

- STORAGE
- MICRO MICROWAVE
- OHC OVERHEAD CABINETS
- FRIDGE REFRIGERATOR
- WARD WARDROBE

OPTIONS

- KING BED OPTION
- RESIDENTIAL FRIDGE OPTION

A

B

SEISMIC COMPETITIVE ADVANTAGES

Jayco's industry-leading 2 year limited customer warranty vs. 12 month warranties (industry standard)

Optional quick-set ramp patio system with patio steps

Patentes, optional Tailgater Camp Kitchen

Magnum Truss Roof System: the strongest rated roof in the industry
Standard Astro-Foil™ insulation on bath deck in pass-through storage, slide room floors and roof, main floor, ceiling and bedroom areas

First to offer full 2 inch block foam, fully insulated and vacuum bonded garage floor

Only manufacturer to list our temperature ratings with full water in our tanks for extended living (Dometic Freeze Chamber-tested)

Gelcoated slick fiberglass sidewalls

MORryde rubberized suspension with full 3 inch suspension travel and Goodyear nitrogen filled tires

Standard MORryde rubberized king pin for extra shock resistance

Oversized automotive style frameless windows with 80 percent tinted safety glass

Black tank flush for half bath and second full bath



Industry first 39 inch pop up TV in the bedroom with oversized panoramic window (bed slides only)

Segment exclusive walk-in shower

Dishwasher prep (select models)

Solid-surface countertops in kitchen/main bathroom

21 cu. ft. residential refrigerator with ice/water and 1,200-watt inverter (optional)

MCD roller day/night shades

Standard 15,000 BTU Whisper Quiet A/Cs (bedroom, living room); optional third 15,000 BTU A/C in garage (non-ducted)

Room for up to 6 house batteries with disconnect

CASHMERE COTTAGE

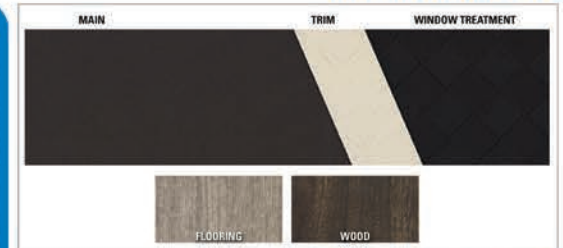

MODERN FARMHOUSE

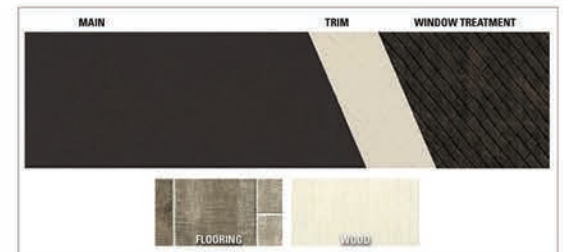

INTERIOR OPTIONS

SPECS

FLOORPLAN	EXTERIOR TRAVEL LENGTH	EXTERIOR HEIGHT (WITH A/C)	INTERIOR HEIGHT	INTERIOR HEIGHT (BEDROOM)	UNLOADED VEHICLE WEIGHT	DRY HITCH WEIGHT	GVWR	CARGO CARRYING CAPACITY	FRESH WATER CAPACITY (INCLUDING WATER HEATER)	GRAY WASTE WATER CAPACITY	BLACK WASTE WATER CAPACITY	SLEEPING CAPACITY
3512	41' 9"	13' 2"	8' 3"	6' 4"	13,970	3,340	17,450	3,480	112	87**	87**	6-7
3815	44' 10"	13' 3"	8' 3"	6' 4"	14,705	3,710	19,995	5,290	112	87**	87**	6-7
4013	45' 9"	13' 4"	8' 3"	6' 4"	15,205	3,735	20,695	5,490	112	87**	50	8-10
4113	45' 8"	13' 4"	8' 3"	6' 4"	15,915	3,715	20,695	4,780	112	87**	87**	8-10
4125	45' 8"	13' 3"	8' 3"	6' 4"	14,970	3,505	20,695	5,725	112	87**	50	8-9
4212	45' 1"	13' 3"	8' 3"	6' 4"	15,725	3,480	20,695	4,970	112	87**	87**	8-10

Some specs at the time of print may include estimates. For the most accurate information, please visit Jayco.com

**Split tanks

Unloaded Vehicle Weight (UVW): Sometimes referred to as "Dry Weight," UVW means the typical weight of the trailer as built at the factory. The UVW, as used in product literature and other promotional materials, does not include cargo, fresh water, propane, options or dealer-installed accessories.

Gross Vehicle Weight Rating (GVWR): GVWR means the maximum permissible weight of the trailer, including the UVW plus personal items, all cargo, fluids, options and dealer-installed accessories. The GVWR is equal to or greater than the sum of the UVW and the CCC.

Cargo Carrying Capacity (CCC): CCC means the maximum weight of personal items, food, fresh water, propane, tools, other cargo and dealer-installed accessories that can be carried by the trailer. CCC is equal to or less than GVWR minus UVW. The addition of options will decrease the CCC.

Hitch Weight (HW): The hitch weight, as used in product literature and other promotional materials, does not include cargo, fresh water, propane gas, options or dealer-installed accessories. The addition of these types of items will either add to or subtract from the stated hitch weight.

It is important for your safety and enjoyment that your tow vehicle be adequately sized and equipped to tow and handle the GVWR of the RV you select. Review weights and rating of your tow vehicle and consult a competent advisor for questions or advice. Whether you are new to RVing or a veteran, get a feel for the performance of your tow vehicle before heading out on the roadways. When you tow an RV, you must drive differently than when you drive a single vehicle. Practice hooking up, driving, backing up and braking in a safe environment or seek out professional instruction. Jayco affixes a weight label to each RV which lists estimated weight information for that vehicle. See specifications chart above.

5-STAR / 4-STAR HANDLING PACKAGE

(Seismic)

(Talon)

This Handling Package is a Jayco exclusive, a powerful blend of high-end, American-made components that make pulling a luxury fifth wheel a breeze.



DEXTER AXLES WITH NEV-R-ADJUST BRAKES
The Benchmark of the trailer industry!



GOODYEAR BEAST TIRES
Made in the U.S.A. and featuring the patented Durawall® technology.



DEXTER SHACKLES WITH WET BOLT FASTENERS AND BRONZE BUSHINGS
Resists the wear-and-tear of towing.



MORRYDE RUBBERIZED SUSPENSION SYSTEM
Better absorbs and isolates road shock.



MORRYDE PIN BOX
Allows pin box to travel forward and backward as well as side-to-side, creating a smoother tow. (optional on Talon)

Two *Unique & Beautiful* Concepts

Every fixture, fabric and feature has been carefully selected and expertly installed. The result is an aesthetic that's extraordinary- with Jayco's famous high level of live-ability. Led by Interior Designer Stacy Stewart, our design, product development and engineering teams set out to answer the call for more choice in RV interiors and developed a market-disrupting design concept that could be expertly crafted without hampering production.

**True interior design.
More choice.
Mindful craftsmanship.**

JAYCOMMAND

THE JAYCOMMAND™ SYSTEM PUTS RVERS IN FULL CONTROL OF THEIR UNIT. THE SYSTEM WAS CUSTOM-BUILT BY OUR PRODUCT DEVELOPMENT TEAMS SO THAT OWNERS CAN MONITOR AND CONTROL KEY RV OPERATIONS FROM A PHONE OR A TABLET.



GOODYEAR



MADE IN USA
Featuring Durawall®
Technology - ENGINEERED
to help you tow with confidence



OCTANE SL STANDARDS & OPTIONS

STANDARD EXTERIOR EQUIPMENT

Fully integrated A-frame
Keyed Alike™ lockable baggage doors
Dark tinted, safety glass privacy windows
30 amp power service
13,500-BTU roof-mounted AC
Enclosed battery storage box with locking door
Water heater bypass system
Water system winterization kit
LED exterior lights
(2) 20 lb. LP bottles with cover
Electric Tongue Jack
Heated, enclosed underbelly

STANDARD INTERIOR EQUIPMENT

Solid hardwood cabinet doors and drawers
Heavy duty, 75 lb., full extension, steel ball-bearing drawer guides
2 burner range
Deep double bowl, stainless steel 50/50 sink with cutting board cover (1)
High-rise kitchen faucet
Auto ignition furnace with wall thermostat
Command center (select models)
USB charging port
Vinyl flooring throughout
ABS tub/shower surround
Bathroom medicine cabinet
Bathroom exhaust vent
Glass shower door (select models)
A/C ducts in front bedroom (select models)
Under bed storage with gas struts (select models)
Power queen beds with rear convertible sofa and folding armrests with cup holders
LED lighted countertop edge
LED interior lights

RAMP AND CARGO EQUIPMENT

Radius cornered ramp door, 2,500 lb. capacity, 96 in. wide ramp door opening
High intensity rear ramp lights (2)
Spring assist ramp door with non-skid flooring
Garage vent ports
Overhead storage cabinets

CUSTOMER VALUE PACKAGE (MANDATORY)

Nitrogen-filled Goodyear® Endurance tires
102 in. wide body construction
Aluminum rims
17.8 gal./hour quick recovery gas/electric water heater
Convection microwave oven
AM/FM/CD/DVD/Bluetooth® with (2) interior speakers and (2) exterior marine-grade speakers
Stainless steel appliances
Seamless kitchen and bathroom countertops
Indoor/outdoor dinette table
Digital TV antenna
Pleated night shades
2 in. block foam floor, vacuum-bonded and laminated
I-Class™ cambered structural-steel I-beam frame
Magnum Truss™ Roof System
Nev-R-Adjust® self-adjusting brakes
Spare tire and carrier
Diamond plate rock guard
Black tank flush
LED taillights
Bar-lock latches with keyed ramp door locks
D-rings anchored to steel chassis
Stabilizer jacks (4)
Exclusive designer exterior graphics package
Ducted roof A/C
Matching Aztek Gray radius fiberglass front wrap and ramp door
Roof and side-mounted solar prep
Backup camera prep (in two locations)
8 cu. ft. double door refrigerator
Rear electric queen beds with rollover sofa, folding armrests, & cup holders
Power awning with LED lights

OPTIONS

Customer Value Package with 15,000 BTU roof A/C
Fiberglass sidewalls
40 gal. fuel station
50 amp service with 2nd A/C prep (select models)
2nd 13,500 BTU A/C in bedroom (select models)
Retractable screen wall
Ramp patio system

TALON & SEISMIC STANDARDS & OPTIONS

STANDARD EXTERIOR EQUIPMENT

	Talon	Seismic
Wide-body structural steel I-beam construction	S	S
Stronghold VBL™ aluminum framed and vacuum bond laminated gel-coat fiberglass exterior walls (including rear wall and slide room end walls)	S	S
Magnum Truss™ Roof System (strongest tested roof in the industry) with one-piece, seamless DiFlex II material	S	S
Climate Shield™ zero-degree tested weather protection: Fully enclosed and heated underbelly (ducted), 35,000 and 40,000 BTU output furnace, Double layer fiberglass batt insulation in ceiling and floor, Double sided radiant barrier insulation (roof, floor, cap, and slide room floors), PEX plumbing	S	S
HELIX Cooling System™ (industry exclusive): Exterior-mounted 15,000 BTU "Whisper Quiet" A/C unit, Jayco exclusive insulated dual duct design, Directional and closeable A/C vents, Larger return air vents with user accessible filters	S	S
JaySMART™ (Safety Markers And Reverse Travel) LED lighting (patent-pending)	S	S
Painted fiberglass front cap with built-in specialty LED lighting	S	S
Custom automotive-grade vinyl exterior graphics package	S	S
LED exterior lighting package	S	S
Detachable Powersmart™ LED shore power cord	S	S
Dual 30 lb. propane bottles with auto regulator	S	S
Pass-through storage with Slam-latch™ baggage doors	S	S
Digital TV antenna with Wi-Fi prep	S	S
Exterior marine-grade speakers	S	S
Fully enclosed, LED-lit Nautilus universal docking center: Selectable water connections, Quick connect outside shower, Black tank flush, winterization and sanitation, Independent satellite and whole coach cable hookups	S	S
Water heater bypass	S	S
Battery disconnect	S	S
Under-mounted spare tire (Goodyear® Endurance®, Made in USA)	S	S
LP quick-connect	S	S
Folding roof ladder	S	S
Slide topper/ awning prep	S	S

STANDARD INTERIOR EQUIPMENT

	Talon	Seismic
Solid hardwood slide fascia	S	S
Handcrafted and glazed doors, drawer and trim	S	S
Heavy-duty, 75 lb., full-extension, steel ball-bearing drawer glides	S	S
5/8 in. tongue and groove joined plywood main floor decking	S	S
Shaw® residential carpeting with R2X® stain guard (Made in USA)	S	S
Shaw® "Wood Plank" vinyl flooring (Made in USA, standard minimal carpeting)	S	S
LED interior lighting throughout	S	S
LED dimmer switches in main room	S	S
JAYCOMMAND™ "Smart RV" system powered by BMAPRO®	S	S
SuperSofa with heat, massage, and LED lighting (N/A 392T)	S	S
Stainless steel kitchen sink	S	S
Brushed nickel kitchen faucet with pullout sprayer	S	S
18 cu. ft. Norcold Polar Max 2-way refrigerator with ice maker	S	S

STANDARD INTERIOR EQUIPMENT (CONT.)

	Talon	Seismic
8 cu. ft. gas/electric RV refrigerator with freezer	S	
Dual USB charging ports	S	S
Bluetooth® speaker prep	S	
12V charging station	S	S
Bathroom skylight	S	S
LED backlit medicine cabinet with custom framed mirror (industry exclusive)	S	S
Bathroom stone and glass tile backsplash	S	S
Blue LED nightlights	S	
Porcelain foot flush toilet	S	S
Residential quilted bedspread and pillows	S	S
Gas-strutted under-bed storage	S	S
Hardwood safety handrail on steps	S	S
Bathroom hallway window	S	S
CPAP prepped bedroom	S	S
Carbon monoxide and LP detector	S	S
LED fireplace with 5,000 BTU electric space heater (select models)	S	S

RAMP AND CARGO EQUIPMENT

	Talon	Seismic
Hinged spring-assist, radius-cornered ramp door, 2,500 lb. capacity, 93-3/8 in. wide opening with anti-slip, non-skid flooring	S	S
LED high-intensity, ramp lights	S	S
Tuff-ply, rubberized garage floor liner	S	S
2 in. block-foam insulated garage floor	S	S
Garage D-rings mounted to steel frame	S	S
Steel backers in floor for wheel chocks	S	
24 in. x 72 in. garage entry door with step light	S	S
Vent ports and tinted power roof vent	S	S
HappiJac® electric-lift Queen beds/ convertible sofas with folding armrests and cup holders	S	S
Pull-down ramp door screen	S	S
Dual 30 gal. fuel tanks with timer (1 dedicated to generator)		S
40 gal. fuel tank with timer	S	

CUSTOMER VALUE PACKAGE (MANDATORY)

	Talon	Seismic
MORryde® StepAbove™ entrance steps (main entrance) with blue LED light	CVP	CVP
Equalizer Hydraulic auto-leveling system with oversized foot pad		CVP
JAYCOMMAND™ "Smart RV" system powered by BMAPRO		CVP
Drinking Water System™ (patent-pending)		CVP
15,000 BTU "Whisper Quiet" A/C	CVP	CVP
2nd 15,000 BTU A/C ducted in bedroom		CVP
50 amp service with dual A/C ducts and second A/C prep	CVP	
Electric awning with integrated LED lights	CVP	
Dual electric patio awning with integrated LED lights		CVP
10 gal. quick-recovery gas/electric DSI water heater (20 gal. per hour)	CVP	CVP

	Talon	Seismic
Residential Queen (60 in. x 80 in.) Serta® mattress with under-bed storage	CVP	CVP
Central vacuum system		CVP
Custom machined aluminum rims	CVP	CVP
LED HDTV with fully digital HDMI output	CVP	CVP
12V AM/FM/CD/DVD/USB A/V system with Bluetooth® and HDMI®	CVP	CVP
Stainless-steel range with glass cover	CVP	CVP
Bellavati® solid-surface kitchen countertop with bamboo sink cover and strainer		CVP
Stainless-steel microwave with exhaust fan	CVP	
Convection microwave		CVP
Integrated sound bar		CVP
32 in bedroom TV		CVP
Oversized 36 in. wide residential shower (select models)		CVP
MCD® day/night roller shades in living room		CVP
Washer/ dryer prep		CVP
Keyed Alike™ lock system (single key for all doors/locks)	CVP	CVP
Rooftop and ground solar prep by Go Power®	CVP	CVP
Backup camera prep (rear observation, 2 locations)	CVP	CVP
Cellular prep for antenna and JAYCOMMAND™ "Smart RV" system		CVP
Tire Pressure Monitoring System	0	CVP
Hidden hinges		CVP
Lamilux high gloss gel-coated exterior sidewalls		CVP
Frameless dark tinted safety glass windows		CVP
Rain-proof EZ Breeze™ 350CFM bathroom power vent	CVP	
Upgraded friction hinge entrance door with XL grab handle	CVP	
5,500W Onan® micro-quiet gas generator (CARB-certified)	0	CVP
Wireless remote control system		CVP

4-STAR HANDLING PACKAGE (MANDATORY)

	Talon	Seismic
Goodyear® Endurance® "Beast" Tires (Made in USA)	4	
7,000 lb. Dexter® Axles with Nev-R-Adjust® brakes and E-Z Lube® hubs	4	
MORryde® CRE-3000™ rubberized suspension	4	
Wet bolt fasteners and bronze bushings	4	

5-STAR HANDLING PACKAGE

	Talon	Seismic
Goodyear® Endurance® tires (Made in the USA, Load Range 'E')		5
7,000 lb. Dexter® Axles with Nev-R-Adjust® brakes and E-Z Lube® hubs		5
MORryde® CRE-3000™ rubberized suspension		5
Wet bolt fasteners and bronze bushings		5
MORryde® pin box		5

PLATINUM PACKAGE (MANDATORY)

	Talon	Seismic
JAYCOMMAND "Smart RV" system powered by BMAPRO	P	
6-point electric auto-leveling system	P	
LG® solid-surface kitchen countertop with bamboo sink cover and strainer	P	
Generator prep	P	
Washer/dryer prep	P	
Soft-close residential kitchen drawers	P	

OPTIONS

	Talon	Seismic
Canadian Standards (CSA)	0	0
Custom interior design choices (Industry first!)	0	0
Customer Value Package with 15,000 BTU A/C and heat pump		0
Extreme Weather Package		0
15,000 BTU drop-in cargo area A/C		0
5,500-watt Onan® gas generator	0	
Serta® King residential foam-top mattress	0	0
2nd 15,000 BTU A/C ducted in bedroom		0
Flip-down bunk (392T only)		0
U-dinette (in place of SuperSofa; 335T, 385T, 403T)		0
13.5 cu. ft. gas/electric refrigerator (403T / 405T)		0
21 cu. ft. residential refrigerator and 1,200W pure sine wave inverter		0
MORryde® "RPB" Rubber Pin Box	0	
2nd Power Awning	0	
Party deck with "quick set" folding rails, rear entry steps, and manual awning	0	
3 season removable garage wall		0
Outside kitchen (395T only)	0	
Patented outside tailgater camp kitchen		0
32 in. LED TV in master bedroom		0
32 in. LED TV in garage		0
Cargo TV		0
Wireless backup/rear view camera kit		0
KICKER® sound system upgrade	0	0
Tire pressure monitoring system	0	S
Overlander Solar Kit (solar controller and roof-mounted 190W panel)	0	0
Sani-con® Turbo waste management system	0	0
Frameless dual-pane tinted safety glass windows	0	0



50 percent Stronger

4,500 lbs. on a Jayco roof vs. other roofs



Jayco's roof vs. Other roofs

CLIMATE SHIELD



LIVING ROOM	KITCHEN	BATHROOM	HOLDING TANK	BEDROOM
0°F 70°F	0°F 69°F	0°F 71°F	0°F 60°F	0°F 71°F
100°F 69°F	100°F 70°F	100°F 68°F	100°F 72°F	100°F 71°F

Extend your camping season with the Jayco Climate Shield. (N/A Octane SL)

It protects against extreme heat and extreme freezing—even in temperatures as high as 100 degrees or as low as zero degrees (Fahrenheit).*

*Jayco tested fifth wheels in zero degrees F and 100 degrees F weather over an extended period of time in a controlled environment, and all functions of the coach were fully operational. Testing was done in a completely controlled environment; therefore, temperatures during testing may not represent actual temperatures in nature and cannot account for elements such as wind or moisture. In actual use, unit may not perform as well. Supplier of cooling components does not guarantee anything better than 20 degrees difference from ambient temperature. In addition, outside components are subject to freezing and require steps to properly insulate. Jayco's limited warranty does not cover damage caused by freezing. To learn more about Climate Shield and testing done by Jayco, visit www.jayco.com.

2+3
YEAR | YEAR
LIMITED | STRUCTURAL
WARRANTY

Travel with Confidence

NO ONE OFFERS A BETTER WARRANTY
At Jayco, we build our RVs to handle every adventure, then back them with our **industry-leading 2+3 warranty**. Our 2-year limited warranty has you covered for **2 camping seasons**. That's **730 days**. In addition, our 3-year structural warranty has you covered for **3 camping seasons or 1,095 days**. You won't find a better warranty in the business, because the only strings we attach are those that deliver the ultimate in reliability. That's the Jayco difference. So go explore. For a copy of our 2-year limited + 3-year structural warranty with complete terms and conditions, please contact your local Jayco dealer.



Jayco, Inc. | P.O. Box 460 | Middlebury, IN 46540 © ~~RVIA~~
See dealer for further information and prices. All information in this brochure and on www.jayco.com is the latest available at the time of publication approval. Jayco reserves the right to make changes and to discontinue models without notice or obligation. Photography may show optional equipment or props used for decoration purposes only. RVs built for sale in Canada may differ to conform to Canadian codes. JAYCO and the JAYCO BIRD IN FLIGHT are registered trademarks of Jayco, Inc. Printed in USA 12/19 ©2019 Jayco, Inc.

Meet your Jayco Dealer

Follow Jayco
#LetsJayco

