

The New 2006

Montana

Mountaineer Edition



Quality, Value and Style - Where it counts.



Huge fully vented windows provide a scenic view from the comfort of this rear lounge Mountaineer. You can enjoy nature while relaxing in residentially designed swivel rockers or the optional recliner/glidors in this 329RLT floor plan, shown here in Autumn Harvest decor. The higher sidewall profile design offers ample headroom for larger overhead cabinetry and space for a single pedestal table and four chairs with oak-framed backs.

Montana *Mountaineer Edition*

Luxuriously Appointed Residentially Designed Travel Trailers and Fifth Wheels

Montana *Mountaineer Edition*

Montana continues to be the best selling brand fifth-wheel in the business. Its unique appeal results from listening closely to our customers and implementing their preferences for traditional residential styling and comfort. The Montana's quality durability and construction have become legendary for those customers who want the best while pursuing an RV lifestyle.

The Montana Mountaineer Edition offers excellent quality and value with contemporary style and floor plan amenities that make traveling with friends and family more enjoyable and affordable.

Quality, Value and Style - Where it counts.



The 329RLT features an entertainment center complete with a slide out computer work station, abundant storage space, as well as a surround sound stereo system and built-in television.



Beauty shows in every careful detail.

Introducing the all-new redesigned Montana Mountaineer Edition.

The Mountaineer Edition offers the same quality, value and durability as the original Montana with a sporty new look and contemporary style, preferred by many of today's RV buyers. Additionally, the Mountaineer Edition is designed to offer greater affordability and floor plan versatility.

Our new "Juniper Garden" decor provides the contemporary style sought by many of today's our customers.



Mountaineer's slide-out bedroom features a 60"x80" queen bed in the slide-out area and convenient bedside shelves. The mirrored closet spans 92" along the entire front wall with a hanging clothes rod and reinforced shelf.



Fine Recreational
Vehicles for
Life's Best Times

Autumn Harvest bedroom decor.



Shown in 303RLD
"Juniper Garden"
decor with
optional free
standing table and
chairs.



Juniper Garden bedroom decor.

Comfort is knowing you have
everything you need.

An extra large chest of six drawers
with full extension drawer glides provide
maximum bedroom storage and the entertainment
center with satellite prep is big enough to
accommodate today's larger 20" televisions.





This spacious 329RLT kitchen floorplan offers an L-shaped workspace for ultimate convenience in storage, meal preparation, and entertaining. The new "Mountain Cherry" cabinetry with oiled bronze lights and hardware compliments the modern decor ensemble. All Mountaineers offer residential quality cabinetry with screwed together cabinet faces with solid hardwood doors and drawer fronts. A high-arching designer faucet with deep bowl sinks and deluxe appliances complete the perfect kitchen.

Room to move when you are on the go.

Ask any experienced RV owner and he or she will tell you storage is a priority. We've planned carefully so that you can travel with all the items which are important to your leisure time, and we've positioned the storage, inside and out, so it is easy to access. There is room for clothing, linens, equipment and outdoor furniture, so go ahead, take it along.

Storage space is ample and easy to access

1. The slide-out pantry has metal drawer glides, a shelf for high packages, and a separate waste container area below.

2. Mountaineer's standard bicycle rack extends from the rear bumper frame, supporting up to 200 pounds. The rack allows you to store bikes or other large items which do not fit easily into the pass-thru bay. The ABS plastic storage tray and vertical steel support beam allows items to be transported safely and securely during travel.

3. The huge under-seat storage drawer beneath the booth dinette is easy to access without disturbing diners.

4. Ample under-bed storage has room for bedding or other larger items.

5. The pass thru storage bay with optional slide tray is intelligently designed to allow cargo items to remain clear of plumbing pipes. Side swing baggage doors on the off-door-side allows easy access to your cargo without the doors hitting the bedroom slide room. Fully enclosed dump valves prevent winter freeze-ups.

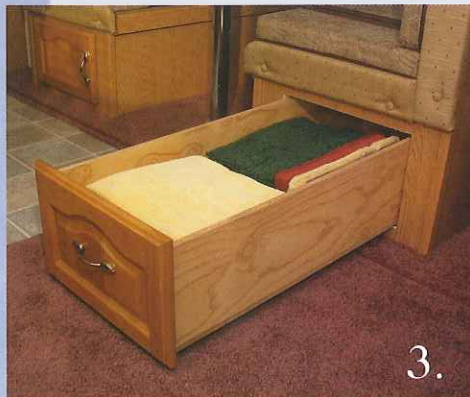



Towability plus exterior features set Mountaineer apart in Value and Quality

Constructed with Total Surround Aluminum Plus™ framing in the walls, roof and floors, Mountaineer weighs 700-1,500 pounds less than comparable wood-framed brands. Further, Mountaineer achieves huge weight reduction through the use of laminated sidewalls, which also provide superior strength and higher insulation values. The Mountaineer line is loaded with state-of-the-art details like its seamless one-piece underbelly which improves air flow while it protects the underbody and insulates the holding tanks. As for value, we believe you will agree there is no match in its category, even as you observe Mountaineer's uncompromising luxury. Mountaineer offers structure, exterior style and efficiency which matches its remarkable interior quality.



The fully enclosed and heated underbelly allows for extended seasonal use.

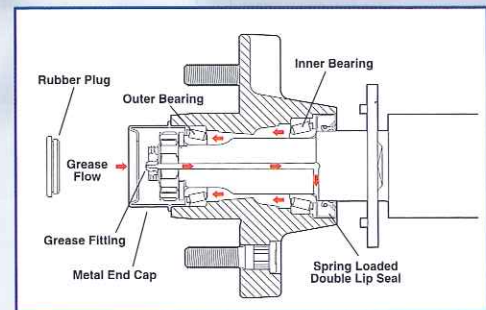

Easy lube axles can be lubricated without removing the wheel.

Spacious accommodations provide room for you and your guests.



NEW! SIDE-AISLE BATHROOM

offers unmatched space and privacy with full access to and from the bedroom and living areas while the bathroom is in use. Our solid pocket door offers significantly more bedroom privacy than the typical accordion doors used by competitors.

*Mountaineer Life,
easy and carefree.*

Just what you've always wanted

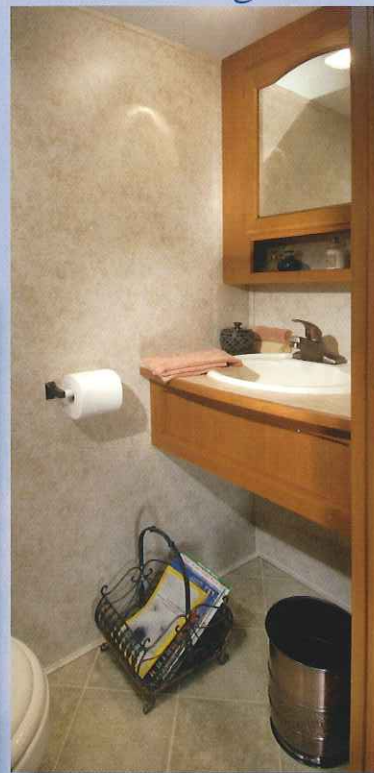

NEW! DOUBLE-SINK WALK-THROUGH BATHROOM

provides added space for you and your guests. We include a second bathroom sink and medicine cabinet to support additional travelers or simply to provide every couple with their own personal space to get ready for the day and store toiletries. Solid fore and aft doors increase privacy and allow access from either the bedroom or living areas.

Travel Trailers

Fifth Wheels

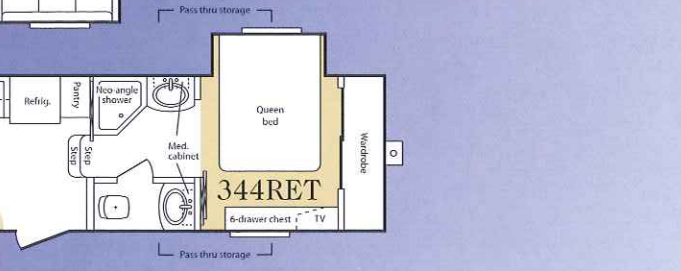
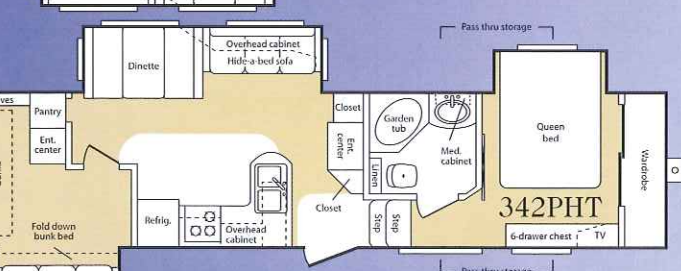
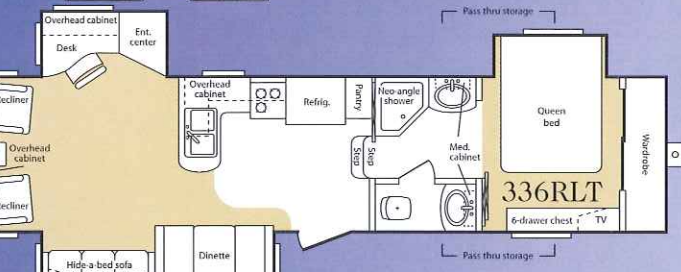
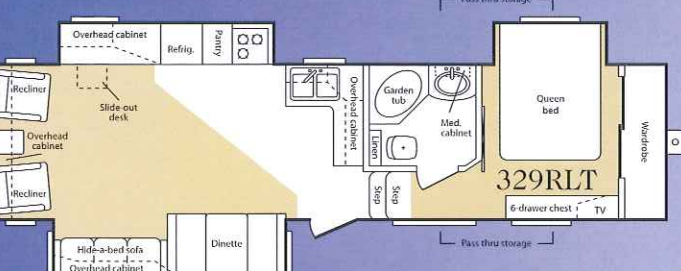
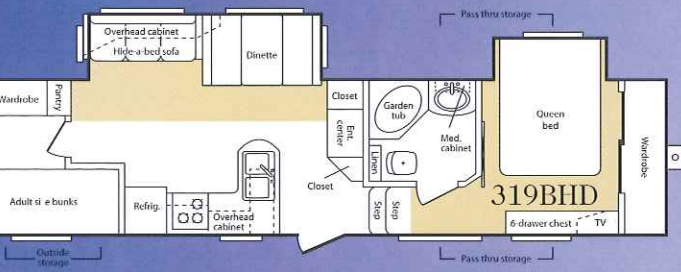
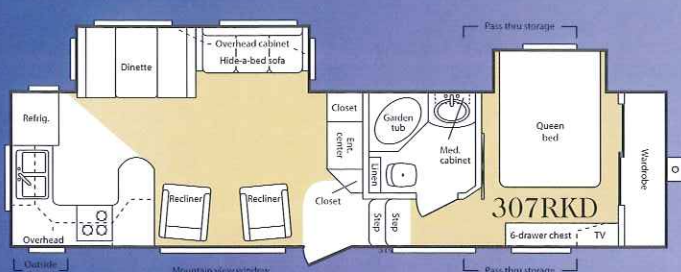
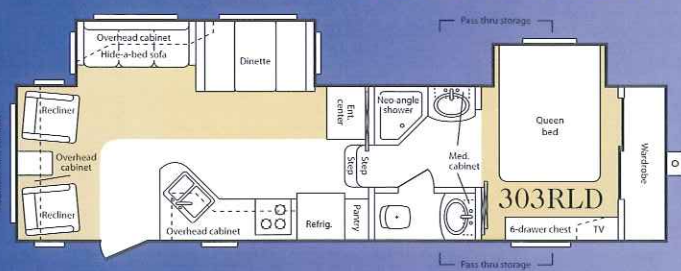
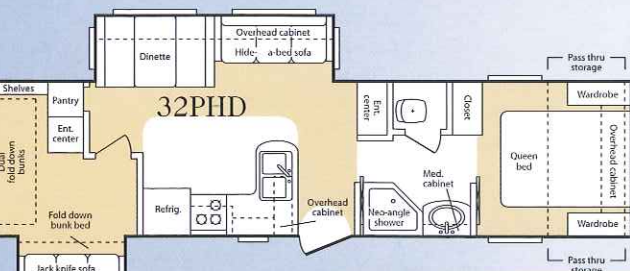
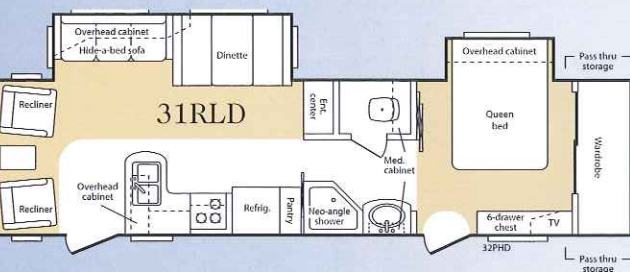
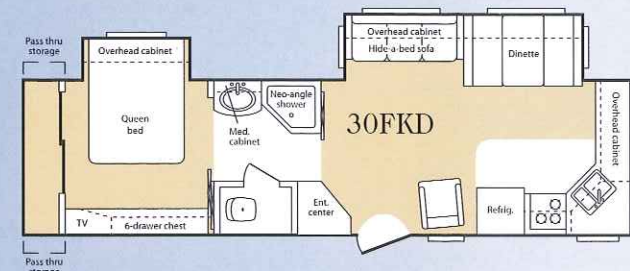
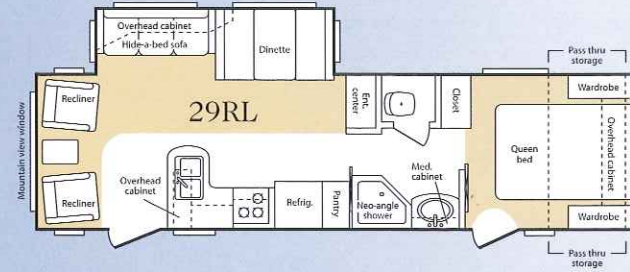
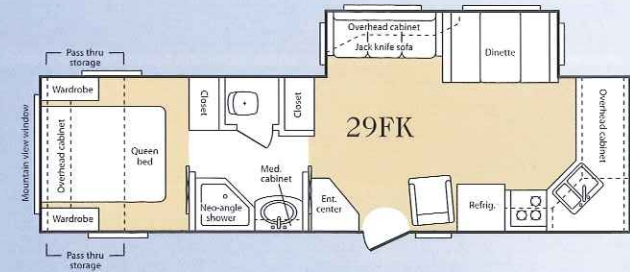
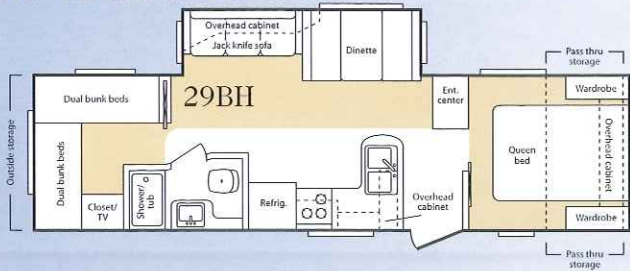

Structural Integrity

Roof (R-14)

1. One-Piece EPDM rubber roof membrane
2. Aluminum radius roof transition molding (Fifth-Wheels only.)
3. 3/8" Structurewood roof decking
4. 5" Fabricated steel truss rafter
5. Fiberglass insulation
6. Ceiling decking
7. Vinyl ceiling
8. Insulated, foam-core air conditioning duct

Sidewalls (R-9)

1. Gel-Coated Filon™ fiberglass
2. 1/8" luan board
3. Second layer 1/8" luan board with seams staggered
4. Solid block insulation foam
5. Interior decorator board
6. 2" Welded aluminum wall studs
7. Electro-galvanized sheet metal backing strips
8. Radius corner blocks
9. Extended hitch pin (FW)

Floor (R-14)

1. Heavy-duty steel I-Beam
2. 3" Welded aluminum floor joists on 16" centers
3. 3" Large-capacity heat duct
4. Full radius wrap aluminum enclosure
5. Steel outriggers
6. Fiberglass insulation
7. 5/8" Seamless floor decking
8. Carpet pad
9. Residential-grade carpeting with stain protectant
10. 2" Heat duct from furnace to under-belly
11. Enclosed and insulated water lines
12. Heavy-duty 1/4" one-piece under-belly

Specifications

ITEM	29BH	29FK	29RL	30FKD	31RLD	32PHD	303RLD	307RKD	319 BHS	329RLS	336RLT	342PHT	344RET
Gross Dry Wt (UWV)	7180	TBD	7125	TBD	TBD	TBD	9345	9455	9680	9885	10205	10430	10325
Carrying Capacity	2820	TBD	2875	TBD	TBD	TBD	2765	2910	2460	2305	2045	2080	2030
Hitch	920	TBD	850	TBD	TBD	TBD	1950	2205	1980	2030	2090	2355	2195
Exterior Length	33'	33'	33'	34'1"	35'7"	36'3"	33' 6"	33' 9"	35' 5"	34' 11"	35' 11"	36' 3"	36' 3"
Exterior Width	8'	8'	8'	8'	8'	8'	8'	8'	8'	8'	8'	8'	8'
Ext Height - Top of A/C	11' 0"	11'0"	11' 0"	11'1"	11'1"	11'1"	12'9"	12'9"	13'	12'9"	12'9"	13'	12'9"
Fresh Water Capacity	40	40	40	60	60	60	60	60	60	60	60	60	60
Waste Water Capacity	38	38	38	38	38	38	38	38	38	38	38	38	38
Grey Water Capacity	76	76	76	76	76	76	76	76	76	76	76	76	76

GVWR = Gross Dry Weight + Carrying Capacity

Due to continuous product improvement, modifications may be made without prior notification or obligation. UNLOADED-VEHICLE-WEIGHT is calculated as base unit with standard equipment only.

Interior

Living Area

	1500 TT	TT	FW
6'8" interior head room	S	S	NA
Residential carpeting and upholstery with fabric protector	S	S	S
Entertainment center	S	S	S
Tall slide room with "plate depth" overhead cabinets	S	S	S
Swivel rocker(s) (Most models)	S	S	S
Hide-a-bed sofa (except 29BH)	S	S	S
Pleated window shades	S	S	S
12v rechargeable flashlight near exit*	M	M	M
Deluxe oiled bronze decorative lighting	S	S	S

Kitchen

Solid "Mountain Cherry" hardwood cabinet doors with cathedral tops	S	S	S
Heavy-duty steel drawer glides with ball bearing rollers	S	S	S
Cabinet toe kicks	M	M	M
Lighted range hood with fan	S	S	S
Wide deep drawers - real "Mountain cherry" wood	S	S	S
Residential-size overhead "Mountain cherry" cabinets	S	S	S
Deluxe bowl kitchen sink with oiled-bronze high-arch faucet	S	S	S
Dual sink cover cutting boards	S	S	S
Garbage can	S	S	S
Oak knife holder in countertop	S	S	S
Silverware tray	S	S	S

Bathroom

Deluxe porcelain toilet	M	M	M
Larger residential-size bath sink	S	S	S
Tub / shower with oiled bronze enclosure	S	S	S
Medicine cabinet - large mirrored door	S	S	S

Bedroom

Deluxe innerspring 60" x 80" mattress	NA	S	M
Deluxe innerspring 60" x 74" mattress	S	NA	NA
Quilted bedspread and 2 pillow shams	S	S	S
Overhead TV cabinet and outlet	M	NA	NA

Appliances

8 cu.ft. double-door refrigerator	S	S	S
Deluxe microwave oven	M	M	M
15,000 BTU ducted roof air conditioner with wall-mount thermostat and "Quick Cool"	M	M	M
High-output range with automatic ignitor and 22" oven	M	M	M
25" Stereo television	M	M	M
TV antenna and booster	M	M	M
Satellite dish prep	M	M	M

Utilities

Water heater by-pass kit	M	M	M
6-gallon gas/electric DSI water heater	S	S	S
Systems monitor panel	S	S	S
30-amp electrical service	S	S	NA
50 AMP electrical service	NA	O	S
Automatic ignition furnace with in-floor ducts	S	S	S
Phone jack	S	S	S
Cable TV hook-up	S	S	S
Carbon monoxide detector	S	S	S

S = Standard Feature
O = Option

M = Moving to Montana Package
1 = Requires 50-amp service.

Exterior

	1500 TT	TT	FW
15" Wheels and tires on TT's	S	S	NA
16" Wheels and tires (on fifth wheels only)	NA	NA	S
2" laminated fiberglass exterior walls	S	S	S
5" fabricated steel truss rafters	S	S	S
Molded fiberglass front end cap	NA	NA	S
Block foam insulation in sidewall (R-9)	S	S	S
Residential fiberglass insulation in floor and roof	S	S	S
Fully enclosed and heated underbelly	S	S	S
Enclosed and heated holding tanks and water lines	S	S	S
Hitch and security light	S	S	S
Extra wide 30" entrance door	S	S	S
Radius baggage doors with locking latches	S	S	S
Smooth-operating, easy-to-use entrance steps	S	S	S
Radius wrap lower walls	S	S	S
Easy lube axles	M	M	M
Deluxe patio awning	M	M	M
One-piece, full walk-on rubber roof	S	S	S
Dark tinted windows	M	M	M
Safety glass windows	M	M	M
Exterior shower	S	S	S
Roof ladder	S	S	S
Aluminum bumper cover	NA	S	S
Outstanding exterior storage	S	S	S
Extended hitch pin	NA	NA	M
Heavy-duty steel I-Beam frame	S	S	S

Options

Exterior

Power tongue jack	NA	O	NA
Slide awning - main room	NA	O	O
Slide awning - bedroom	NA	O	O
Slide awning - third room	NA	NA	O
"Mountain Gold" wheels	NA	O	O
Pass through slide tray	NA	O	O

Decor

Free-standing dinette with 4 chairs	NA	O	O
High back recliner(s) in place of swivel rocker(s)	NA	O	O
L-shaped Hide-a-Bed sofa with hidden storage	NA	O	O
Free-standing end table with lamp	NA	NA	O
High-back desk chair	NA	O	O

Equipment

Bedroom 13,500 BTU A/C1	NA	O	O
Power vent fan	NA	O	O
10-gallon gas/electric DSI water heater	NA	O	O
Ceiling fan	NA	NA	O

Value Package

Crank-down stabilizer jacks	•	•	•
Fold-away entry/exit handle	•	•	•
Security light, door-side	•	•	•
Security light, road-side	•	•	•
Sky dome over tub or shower	•	•	•
Raised "Mountain Cherry" refrigerator front	•	•	•
Range cover	•	•	•
Bookshelf, AM/FM, CD, Stereo cassette	•	•	•
Electric front jacks	NA	NA	•
Under-mount spare tire and carrier	NA	NA	•
Bumper mount tire and carrier	•	•	NA

Your Mountaineer Dealer:

Mountaineer is a product of:



Keystone RV Company



2642 Hackberry Drive Goshen, IN 46526
(574) 535-2100 www.keystone-mountaineer.com

Product information and photography are as accurate as possible at the time of publication. Colors and finishes are photographic representations and may appear differently when viewing actual materials. Some features shown are optional. Features, prices and specifications are subject to change without notice. Check with your selling dealer for the latest equipment and specifications.

MR 11/05