



Eagle



Serial #: 1UJCA0BT6T1WC0153  
Model: 365UKTS EAGLE FW

Model Year: 2026 Dealer Name: HILLTOP CAMPER AND RV  
7324 NOVOTNY ROAD  
BRainerd, MN 56401  
USA

## Standard Equipment

THE FOLLOWING ITEMS ARE STANDARD ON THIS MODEL

### STANDARD EXTERIOR EQUIPMENT

- 1.5 in. fresh water drain valve
- 5 in. Magnum Truss™ with plywood roof decking
- Alpha Ply TPO roof membrane (thickest roof membrane with Limited Lifetime Warranty)
- 50-amp detachable power cord
- LED lighting in pass through area
- Auto-grade vinyl graphics
- Automotive style front cap with max turn radius (painted on select models)
- Black tank flush
- Additional dump valve at termination
- LED light & switch at termination
- Climate Shield™ zero-degree tested weather protection:
- \* Fully enclosed and heated underbelly (ducted)
- \* 35K BTU furnace
- \* Double layer fiberglass batt insulation in ceiling and floor
- \* Double sided radiant barrier insulation (roof, floor and behind cap)
- \* PEX plumbing
- Commercial grade rubber flooring in pass through area
- Dual 30 lb. LP bottles
- Factory installed roof ladder
- Galvanized steel coated outside kitchens
- HELIX Cooling System™ (industry exclusive):
- \* Insulated dual duct design
- \* Directional and closeable A/C vents
- \* Larger return air vents with user accessible filters
- Independent satellite and cable hookups (outside kitchens and/or pass through storage areas)
- LED exterior lighting package
- LP quick connect for gas griddle (next to JayPort®)
- Metal slam latch baggage doors
- Nautilus 2.5 water connections
- Nitrogen filled undermount spare tire (16 in.)
- Quick connect water connections (door side hot/cold and off door side cold only)
- Slide topper/awning prep
- Stronghold VBL™ walls (laminated sidewalls, rear walls and slide out walls)
- Rear camera prep

### 4 STAR HANDLING PACKAGE

- Dexter® Axles with NEV-R-Adjust® brakes and E-Z Lube® hubs
- 16 in. Rainier "H" Rated tires
- MORyde® CRE-3000™ rubberized suspension
- Wet bolt fasteners with bronze bushings

### COMFORT PLUS PACKAGE

- 15K BTU "Whisper Quiet" bedroom A/C
- BMP® Bluetooth® light switches throughout
- King bed (72 in. x 80 in.) mattress with under-bed storage
- Larger exterior baggage door sizes
- Second power awning (dimmable LED lights) (select models)
- 16 cu. ft. 12V refrigerator
- LED lights with dimmer switches and motion activated (throughout interior)
- SpartanLync TPMS Monitoring
- JAYCOMMAND™ "Smart RV System" (Pro Tablet)
- Custom padded headboard with cellphone holders
- Extended roll-top dinette table

### STANDARD INTERIOR EQUIPMENT

- 2-piece high gloss bathroom surround
- Teak seat shower prep
- 5/8 in. tongue-and-groove plywood flooring
- 75 lb. full extension drawer guides
- 30" x 22" shower skylight
- Bedroom TV, SAT, cable prep
- C.P.A.P. prepped bedroom (both sides)
- Extra 120V power outlets in kitchen and slide rooms (where applicable)
- Gas strutted under bed storage
- High Sheen handcrafted door/drawer fronts
- Medicine cabinet with custom framed mirror
- Kitchen faucet with pull-out sprayer
- Porcelain foot flush toilet
- Residential vinyl flooring throughout (NO CARPET)
- Theater seating (select models)
- Tri-fold hide-a-bed sofa with residential memory foam sleep surface (select models)
- USB-C 12V charging ports (multiple locations throughout)
- Water shutoff at all faucet locations
- NuVoH2O water treatment system (filters included)
- 100% no floor heat vents
- 4" interior ceiling fan lighting (4K lumen)

### CUSTOMER VALUE PACKAGE

- 15K BTU "Whisper Quiet" A/C and bedroom A/C prep
- 4K Ultra LED HD Smart TV in living room (varies from 50" to 65")
- 50-amp service with dual A/C ducts
- 60K BTU on-demand tankless water heater
- Custom-machined aluminum rims
- Electric patio awning (integrated dimmable LED lights with JAYCOMMAND™)
- Hidden hinges on cabinet doors
- Interior "Blue Sync" Audio Connect with MB Quart Sound (TV & phone)
- Exterior "Blue Sync" Audio Connect with MB Quart Sound (TV & phone)
- Keyed-Alike™ lock system
- MORyde Step Above™ entrance steps (main entrance) with blue LED light
- Rain-proof bathroom power vent
- Rear 2 in. towing receiver (4-pin connector on fifth wheels only)
- Winegard Air 360 + antenna & router prep (NOW 5G)
- Inverter pre-wire (multiple locations throughout)
- Overlander 1 Solar Package (200W panel and 30-amp solar controller) (FORCED)

### LUXURY PACKAGE

- Blackout roller shades with reflective side throughout
- Electric auto-leveling
- JayPort® 2 in. mount (for outside accessories)
- Residential style glass shower door
- Washer/dryer prep (select models)
- GE 30 in. over-the-range black and stainless microwave with exhaust fan
- GE black and stainless 21 in. range with edge to edge grates
- Multi-Function "All-in-one" black stainless-steel kitchen sink
- Magnetic catches for all drawers & doors
- Solid surface kitchen countertop(s)
- LED fireplace with 5K BTU electric space heater
- Exterior light & outlet at the JayPort® location

## Optional Equipment

OPTIONAL EQUIPMENT INSTALLED ON THIS VEHICLE BY MANUFACTURER

Base price	79,875.00
USA STANDARDS	n/c
CUSTOMER VALUE PACKAGE	6,263.00
LUXURY PACKAGE	7,493.00
FOUR STAR HANDLING PACKAGE	3,743.00
COMFORT PLUS PACKAGE	6,750.00
OVERLANDER 1 SOLAR PACKAGE	n/c
STANDARD CAMPING PACKAGE	n/c
TINTED SAFETY GLASS	n/c
WINDOWS	n/c
STANDARD BRAKE	n/c
FOLDABLE DINETTE CHAIRS(2)	293.00
FURNITURE CUP HOLDER	
TABLES-1 PAIR	113.00
KING BED	n/c

UNIT TOTAL

104,530.00

DEALER INSTALLED OPTIONS

Manufacturer's Suggested Retail Price

\$104,530.00

TOTAL AMOUNT DOES NOT INCLUDE STATE AND LOCAL TAXES OR LICENSE FEES. THE PRICE SHOWN ABOVE MAY OR MAY NOT BE REPRESENTATIVE OF THE ACTUAL SELLING PRICE OF SIMILAR RECREATIONAL VEHICLES IN YOUR AREA.

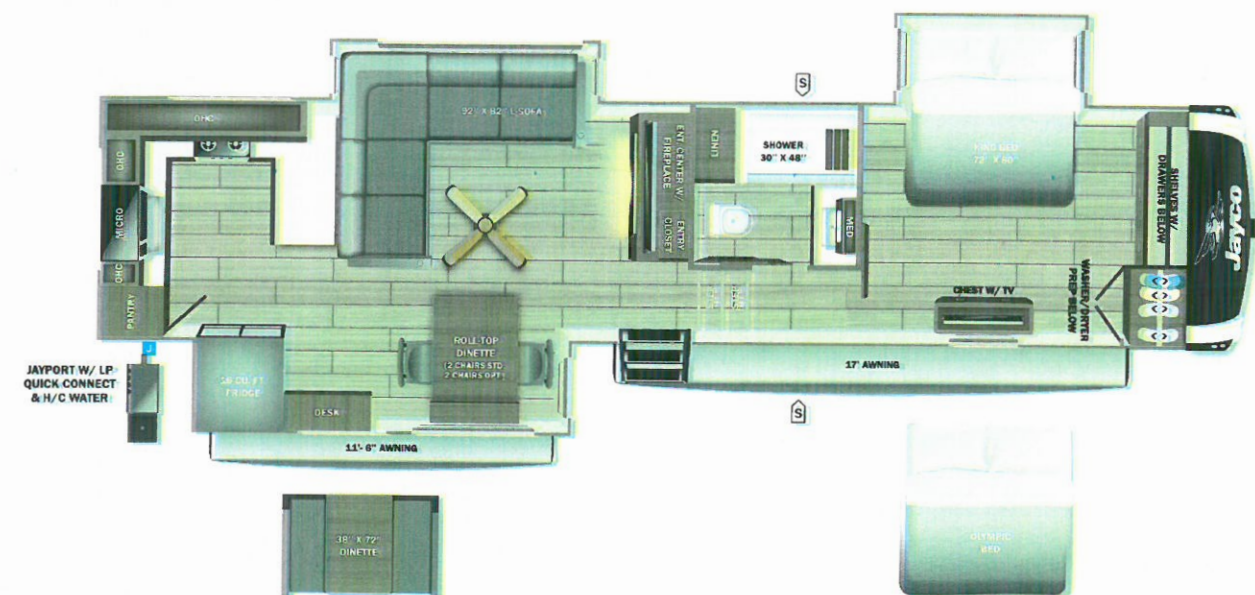

UVW

11327 lbs



Sleeps



Length

37' 1.75"

### DIMENSIONS

Exterior height:.....159.38"

Exterior width:.....97.00"

### WEIGHTS

GVWR:.....13400

GAWR (front):.....6000

GAWR (rear):.....6000

Approx. Gross Cargo Carrying

Capacity (GCCC):.....2073

### TIRES

Tire size (front):.....

Tire size (mid):.....

Tire size (rear):.....

Tire size (spare):.....

### CAPACITIES

Fresh water tank (gals.):...81.00

Gray water tank (gals.):...87.00

Black water/toilet tank

(gals.):.....50.00

Propane (lbs.):.....60

Propane (gals.):.....14

Water heater (gals.):.....0.25

### SEATING & SLEEPING

\*\*\*Some dimensions may be rounded and may vary from the actual dimensions\*\*\*

\*\*\*Weights may be estimated calculations and may vary from the actual weight

- refer to the vehicle weight labels for actual weights\*\*\*

Floorplans, features and specifications are subject to change without notice.

**2+3**  
YEAR | YEAR  
LIMITED | STRUCTURAL  
WARRANTY