



Jay Flight SLX



Serial #: 1UJBC0AK3T1YF0182  
Model: 197MB JAY FLIGHT SLX TT

Model Year: 2026 Dealer Name: Hilltop Camper and RV  
5701 STATE HIGHWAY 29 S  
ALEXANDRIA, MN 56308  
USA

Standard Equipment

Optional Equipment

THE FOLLOWING ITEMS ARE STANDARD ON THIS MODEL

OPTIONAL EQUIPMENT INSTALLED ON THIS VEHICLE BY MANUFACTURER

STANDARD EXTERIOR EQUIPMENT

- 30-amp service
- 8,000 BTU wall mount A/C (single axle models)
- 13,500 BTU Roof A/C (double axle models)
- Axles with electric, self-adjusting brakes and easy-lube hubs
- Exterior cable TV hookup
- Fully-integrated A-frame
- Galvanized-steel, impact resistant wheel wells
- Large exterior downspouts
- LP quick connect (outside grill prep) [N/A on Sport Edition]
- Magnum Truss™ Roof System
- Nitrogen filled radial tires
- PVC roofing membrane (limited lifetime warranty)

CUSTOMER VALUE PACKAGE

- 8 cu. ft. 12V refrigerator
- Backup camera prep
- Bathroom skylight
- Bathroom vent
- Detachable power cord
- Entry door with window and shade prep
- Fitted bed sheet
- G20 dark tinted privacy windows
- Keyed-Alike™ entry and baggage doors
- Large folding entry door grab handle
- LED interior and exterior light
- Microwave oven
- On-demand tankless water heater
- Power awning with LED lights
- Range hood
- MoRyde Step Above® entry steps
- Spare tire with cover
- Stabilizer jacks
- Tub/shower surround
- Window shades

STANDARD INTERIOR EQUIPMENT

- 300 lb. rated single bunk beds
- 600 lb. rated double bunk beds
- Digital TV antenna
- Heavy-duty, 75 lb., full-extension, steel ball-bearing drawer guides
- High rise kitchen faucet
- Marine-grade toilet with foot flush
- Plywood bed platforms
- Queen mattress
- Residential-style hidden cabinet door hinges
- Residential-style kitchen countertops
- Shower curtain with curved shower track (select models)
- Solid hardwood cabinet doors with screwed stile construction and hidden hinges
- Vinyl flooring throughout

Base price	26,468.00
USA STANDARDS	n/c
CUSTOMER VALUE PACKAGE	5,250.00
OVERLANDER SOLAR PACKAGE	443.00
13,500 BTU ROOF MOUNTED AC	593.00
FIBERGLASS SIDEWALL	899.00
BLACK SPOKE RIMS	n/c

UNIT TOTAL 33,653.00

DEALER INSTALLED OPTIONS

Manufacturer's Suggested Retail Price \$33,653.00

TOTAL AMOUNT DOES NOT INCLUDE STATE AND LOCAL TAXES OR LICENSE FEES. THE PRICE SHOWN ABOVE MAY OR MAY NOT BE REPRESENTATIVE OF THE ACTUAL SELLING PRICE OF SIMILAR RECREATIONAL VEHICLES IN YOUR AREA.

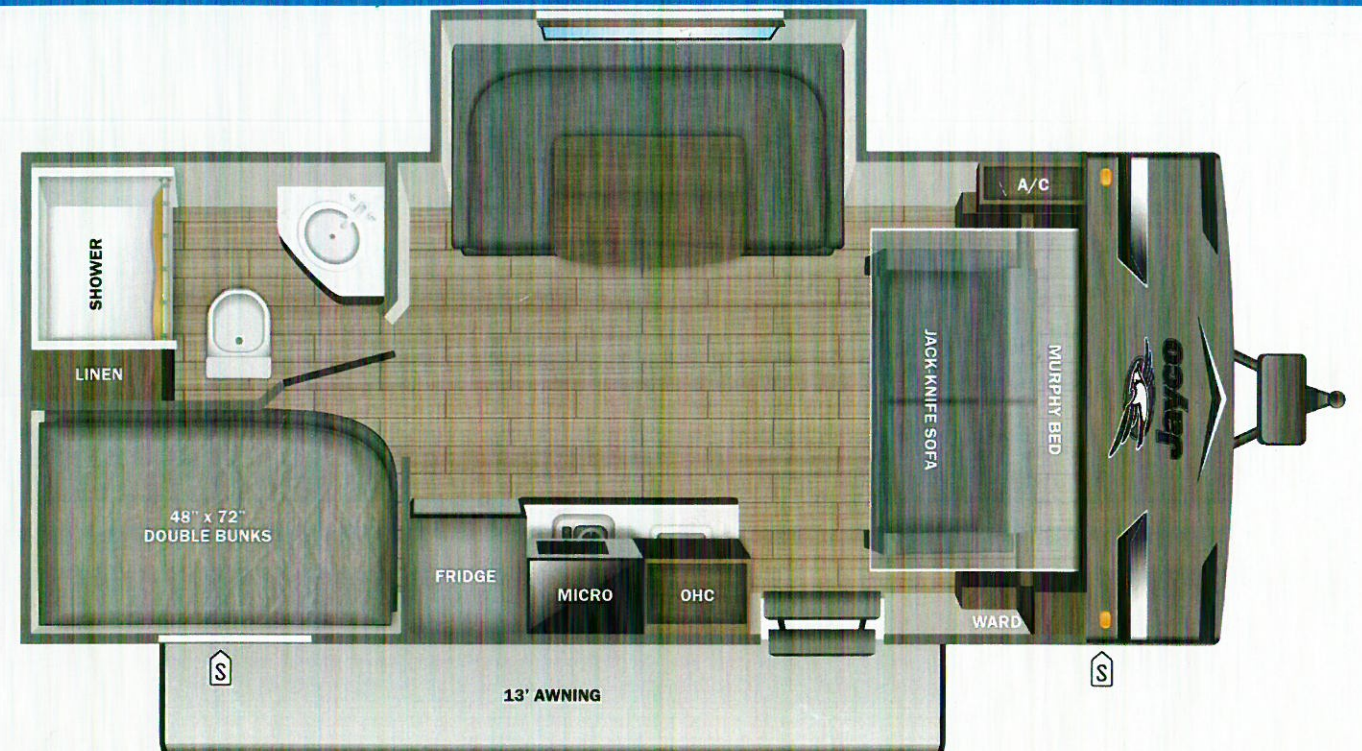

UVW  
4318 lbs



Sleeps



Length  
23' 7"

DIMENSIONS

Exterior height:.....114.75"  
Exterior width:.....96.00"

WEIGHTS

GVWR:.....4995  
GAWR (front):.....4400  
GAWR (rear):.....0  
Approx. Gross Cargo Carrying Capacity(GCCC):.....677

TIRES

Tire size (front):.....ST225/75R15E  
Tire size (mid):.....  
Tire size (rear):.....  
Tire size (spare):.....ST225/75R15E

CAPACITIES

Fresh water tank (gals.):...30.00  
Gray water tank (gals.):...39.00  
Black water/toilet tank (gals.):...39.00  
Propane (lbs.):.....20  
Propane (gals.):.....4  
Water heater (gals.):.....0.25

SEATING & SLEEPING

\*\*\*Some dimensions may be rounded and may vary from the actual dimensions\*\*\*

\*\*\*Weights may be estimated calculations and may vary from the actual weight

- refer to the vehicle weight labels for actual weights\*\*\*

Floorplans, features and specifications are subject to change without notice.

